

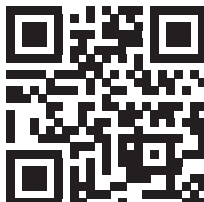



**RHINO-RACK®**2500 **SPORTZ** SUPPLEMENT SHEET

VEHICLE		KIT	CROSSBAR	
Toyota HiluxSingle Cab pickup		DK447-F	SZ126	
RUNNING DATES	10/15-			
VEHICLE NOTES				
<div>VISIT THE ONLINE CALCULATOR FOR CURRENT SYSTEM LOAD LIMIT DATA</div> <div></div>	<div>DYNAMIC ROAD LOAD LIMIT (NOTE: DIFFERENT ON AND OFF ROAD CARGO LIMIT)</div> <div>*USE THE VEHICLE MANUFACTURER'S MAXIMUM ROOF ALLOWANCE IF IT IS LOWER THAN THE FIGURE LISTED</div>			
	<div> LOAD LIMIT</div> <div>UP TO <div>35 kg * 77 lb</div></div>	<div> SYSTEM WEIGHT</div> <div><div>2.5 kg 6 lb</div></div>	<div><div> ON ROAD CARGO LIMIT</div><div>OR</div><div> OFF ROAD CARGO LIMIT (ON ROAD CARGO LIMIT / 2)</div></div> <div><div>UP TO <div>32.5 kg 72 lb</div></div><div>UP TO <div>16 kg 36 lb</div></div></div>	

## PAD AND CLAMP DETAILS

**CLAMP ID:**  
**SUB0667****PLATE ID:**  
**M311****PAD ID:**  
**M697****CLAMP ID:**  
**SUB0667****PLATE ID:**  
**M311****PAD ID:**  
**M698**

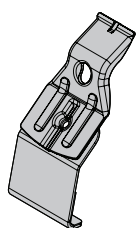
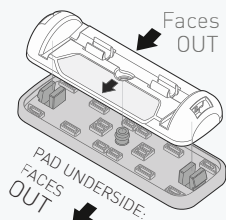
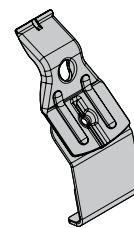
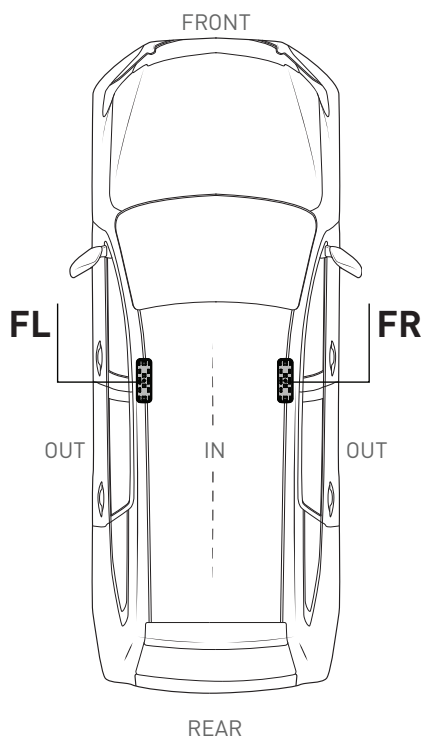
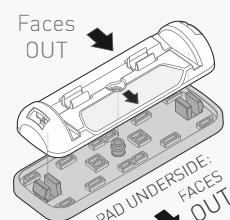
## MEASUREMENT STRIPS

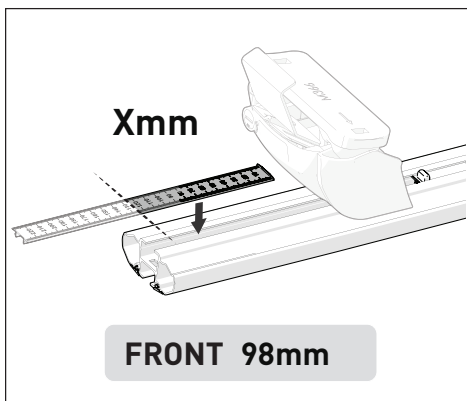

## VEHICLE POSITIONING

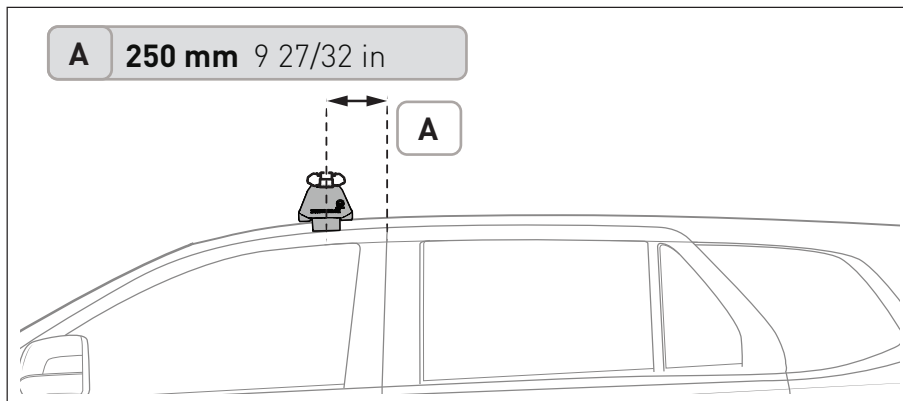

## NOTES FOR DEALERS / FITTERS

It is your responsibility to ensure these fitting instructions are given to the end user or client.

Document No: R4605  
Issue No: 1  
Issue Date: 23-Dec-24