

**RHINO-RACK®**2500 **SPORTZ** SUPPLEMENT SHEET

VEHICLE	KIT	CROSSBAR
Isuzu DMAX Gen2 Space cab TF (single Centre bar)	DK330F	SZ126
RUNNING DATES	2012- 2020	
VEHICLE NOTES		

VISIT THE ONLINE
CALCULATOR FOR CURRENT
SYSTEM LOAD LIMIT DATA

**DYNAMIC ROAD LOAD LIMIT** (NOTE: DIFFERENT ON AND OFF ROAD CARGO LIMIT)***USE THE VEHICLE MANUFACTURER'S MAXIMUM ROOF ALLOWANCE IF IT IS LOWER THAN THE FIGURE LISTED**

LOAD LIMIT

UP TO **35 kg ***
77 lb



SYSTEM WEIGHT

— **2.5 kg** =
6 lb



ON ROAD CARGO LIMIT

UP TO **32.5 kg**
72 lb

OR

OFF ROAD CARGO LIMIT
(ON ROAD CARGO LIMIT / 2)

UP TO **22 kg**
48 lb

PAD AND CLAMP DETAILS

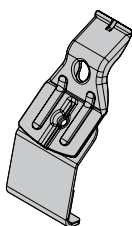

CLAMP ID:
SUB0247

PLATE ID:
M311

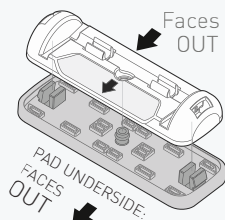

PAD ID:
M505

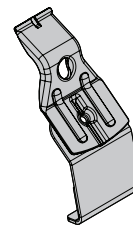
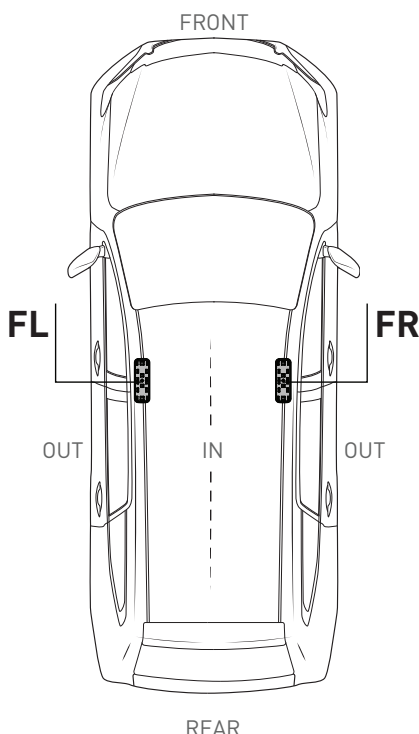

CLAMP ID:
SUB0247

PLATE ID:
M311

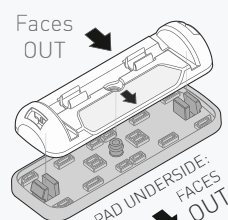

PAD ID:
M506

MEASUREMENT STRIPS

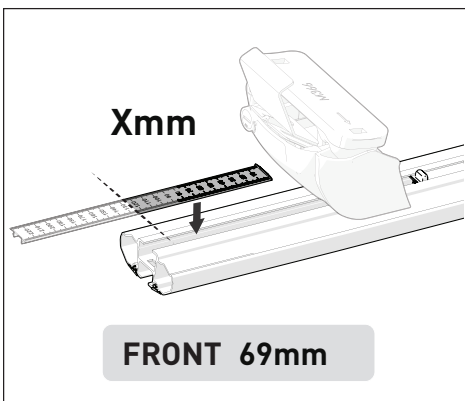

VEHICLE POSITIONING

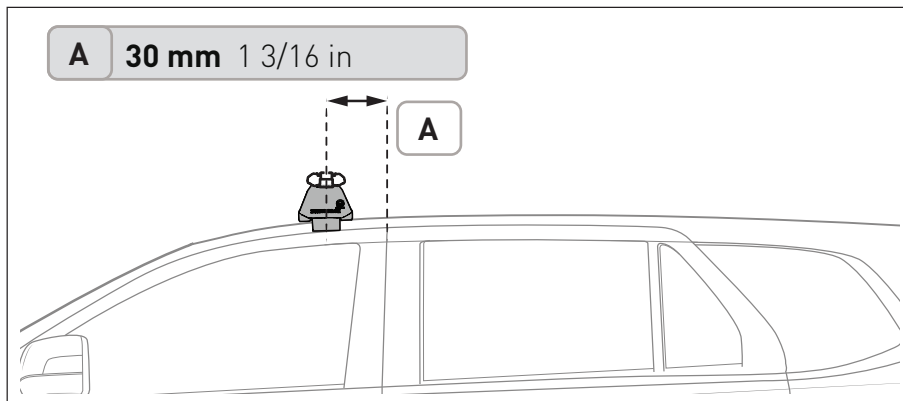

NOTES FOR DEALERS / FITTERS

It is your responsibility to ensure these fitting instructions are given to the end user or client.

Document No: R4517

Issue No: 1

Issue Date: 23-Dec-24