

**RHINO-RACK®**2500 **SPORTZ** SUPPLEMENT SHEET

VEHICLE	KIT	CROSSBAR
Ford Ranger PX (T6)/Mazda BT50 single cab	DK324F	SZ126
RUNNING DATES	2011 - 2022	
VEHICLE NOTES		

VISIT THE ONLINE  
CALCULATOR FOR CURRENT  
SYSTEM LOAD LIMIT DATA

**DYNAMIC ROAD LOAD LIMIT** (NOTE: DIFFERENT ON AND OFF ROAD CARGO LIMIT)**\*USE THE VEHICLE MANUFACTURER'S MAXIMUM ROOF ALLOWANCE IF IT IS LOWER THAN THE FIGURE LISTED**

LOAD LIMIT

UP TO **35 kg \***  
**77 lb**



SYSTEM WEIGHT

— **2.5 kg** =  
**6 lb**



ON ROAD CARGO LIMIT

UP TO **32.5 kg**  
**72 lb**

OR

OFF ROAD CARGO LIMIT  
(ON ROAD CARGO LIMIT / 2)

UP TO **16 kg**  
**36 lb**

## PAD AND CLAMP DETAILS

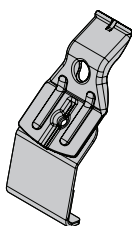

**CLAMP ID:**  
**SUB0145**

**PLATE ID:**  
**M311**

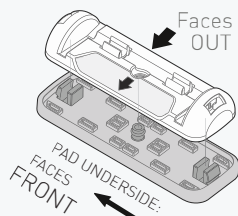

**PAD ID:**  
**142609**

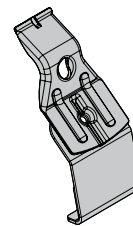
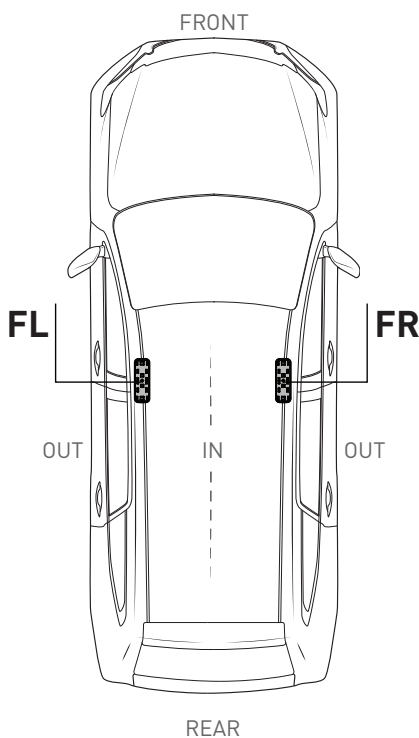

**CLAMP ID:**  
**SUB0145**

**PLATE ID:**  
**M311**

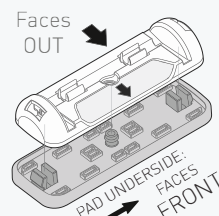

**PAD ID:**  
**142609**

## MEASUREMENT STRIPS

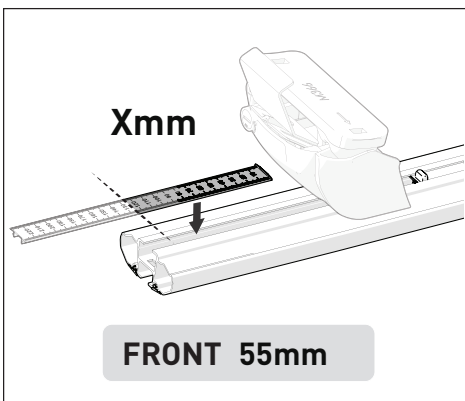

## VEHICLE POSITIONING

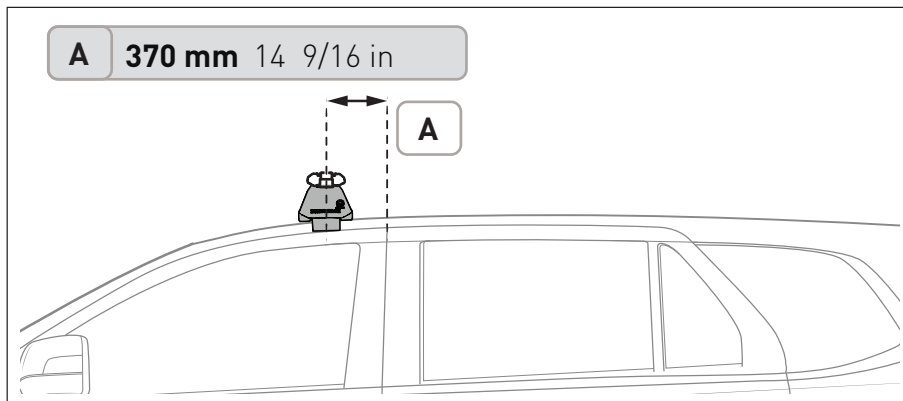

## NOTES FOR DEALERS / FITTERS

It is your responsibility to ensure these fitting instructions are given to the end user or client.

Document No: R4491

Issue No: 1

Issue Date: 08-Jan-25