



VEHICLE		KIT	CROSSBAR
Mercedes-Benz A-Class 5dr Hatch W168		DK040	SZ118
RUNNING DATES	10/98- 04/05		
VEHICLE NOTES			



***USE THE VEHICLE MANUFACTURER'S MAXIMUM ROOF ALLOWANCE IF IT IS LOWER THAN THE FIGURE LISTED**



LOAD LIMIT

UP TO **75 kg ***
165 lb



SYSTEM WEIGHT

— 5 kg =
11 lb —



ON ROAD CARGO LIMIT

UP TO **70 kg**
154 lb



OFF ROAD CARGO LIMIT
(ON ROAD CARGO LIMIT / 2)

OR

UP TO **35 kg**
77 lb

PLATE ID:
M311

PAD ID:
M367

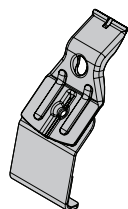

CLAMP ID:
SUB0146

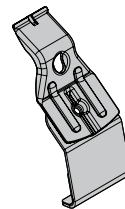
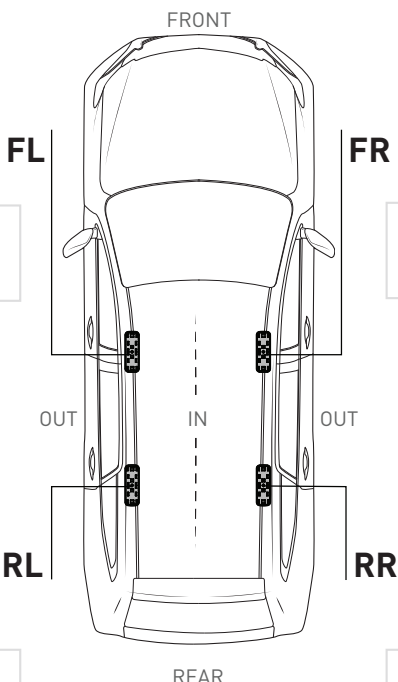

CLAMP ID:
SUB0146

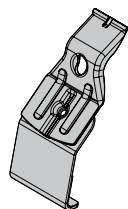
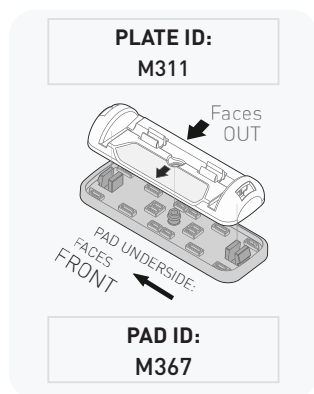

CLAMP ID:
SUB0146

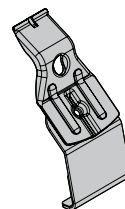

CLAMP ID:
SUB0146

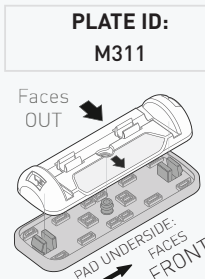
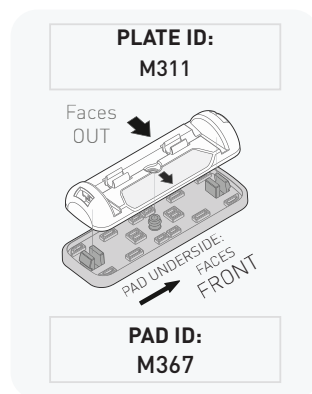

PAD ID:
M367

FRONT 67mm

REAR 86mm

Page. 1

It is your responsibility to ensure these fitting instructions are given to the end user or client.

Document No: R4158

Issue No: 1

Issue Date: 17-Dec-24