



RHINO-RACK

RVP58 Supplement - Mazda 3 04/09 - 12/13

Important: Please read these instructions carefully prior to installation.
 Please refer to your fitting instruction to ensure that the Roof Rack System is installed in the correct location.
 Check the contents of kit before commencing fitment and report any discrepancies.
 Place these instructions in the vehicle's glove box after installation is complete.

Maximum load carrying capacity: 75kg / 165lbs.

Build the crossbar assembly as per RVL/ RCL instructions.

1 Locate the mount point covers in the roof ditch. Slide the covers out of the ditch mould and expose the mounting points in the ditch. Install bases and crossbars as per corresponding instructions. Keep covers in a safe place.

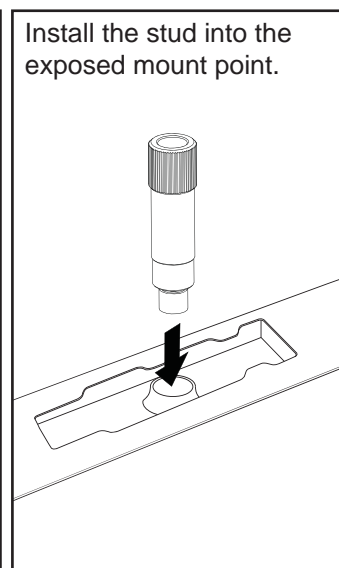
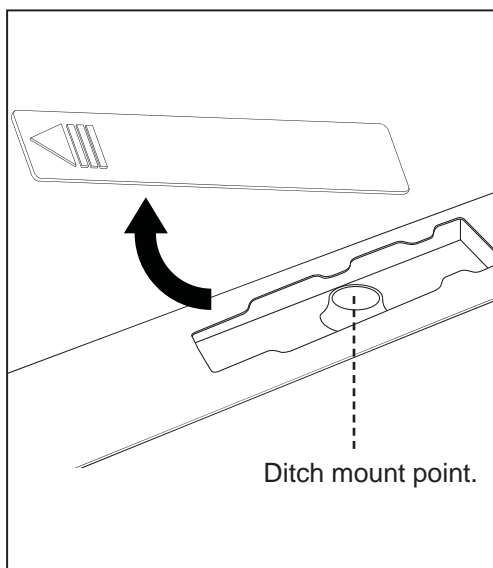
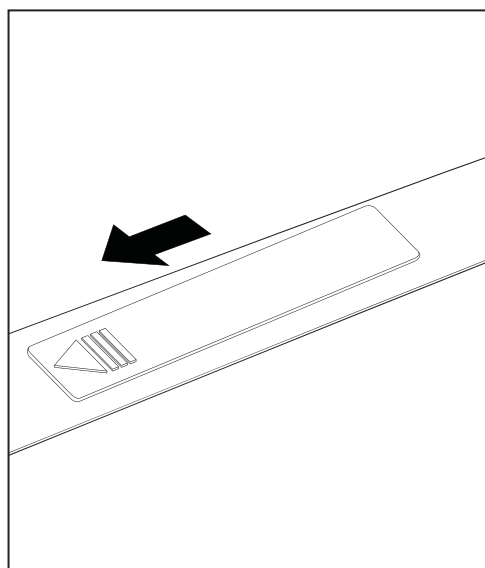

Leg kit: RVL4
Front bar: 939mm
Rear bar: 912mm
Base kit: RCP51-BK

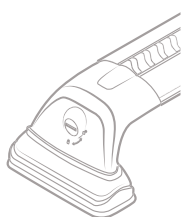

Leg kit: RCL4
VA Bar: VA118S/B
Base kit: RCP51-BK

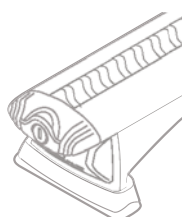

Leg kit : RCL4
HD Bar: RB1250
Spacers: QMHD05
Base kit : RCP51-BK

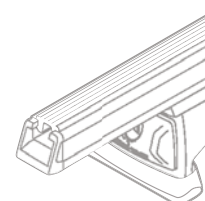

Note Vortex crossbars can be cut to length to fit this vehicle. Measure the desired length out **from the centre of the Vortex Bar** and create a reference with a marker. Carefully cut the bar at these markings using a Saw with an Alloy Cutting Blade.

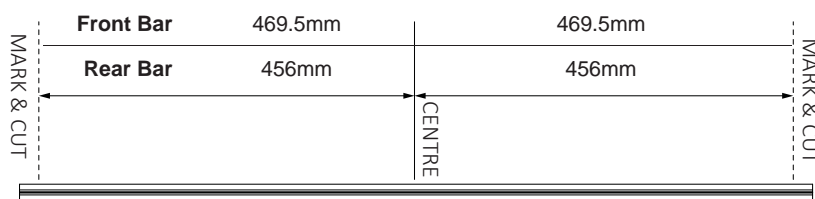

Cut the Bar at the required length.

