



# RHINO-RACK

## RVP50 Supplement - Triton Double Cab MQ

**Important:** Please read these instructions carefully prior to installation.  
 Please refer to your fitting instruction to ensure that the Roof Rack System is installed in the correct location.  
 Check the contents of kit before commencing fitment and report any discrepancies.  
 Place these instructions in the vehicle's glove box after installation is complete.

**Maximum load carrying capacity: 75kg / 165lbs.**

Build the crossbar assembly as per RVL/ RCL instructions.

**1** Starting at the front of the vehicle, carefully lift the ditch mould.

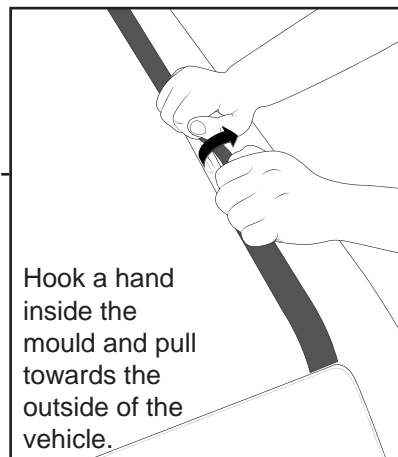
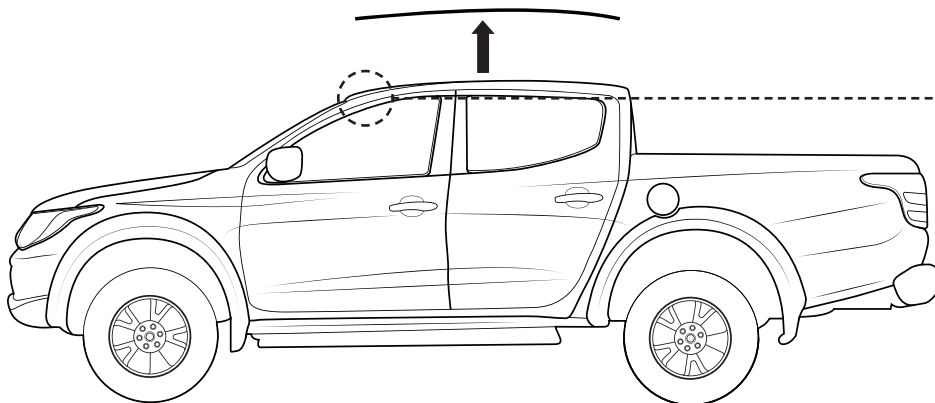

Hook a hand inside the mould and pull towards the outside of the vehicle.

**2** Lay the mould next to the ditch. With a pen, mark the point where the mould would sit over the thread on the brackets in the ditch.

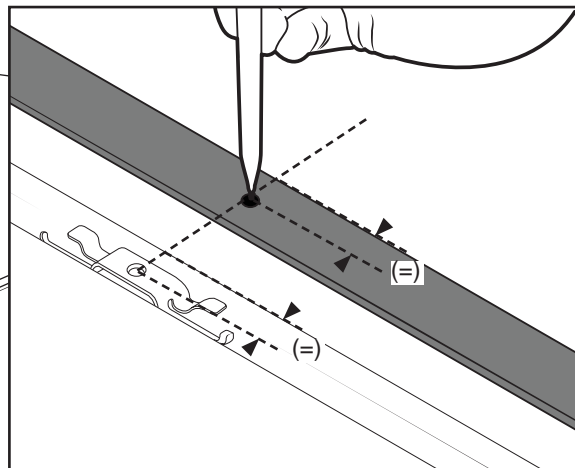
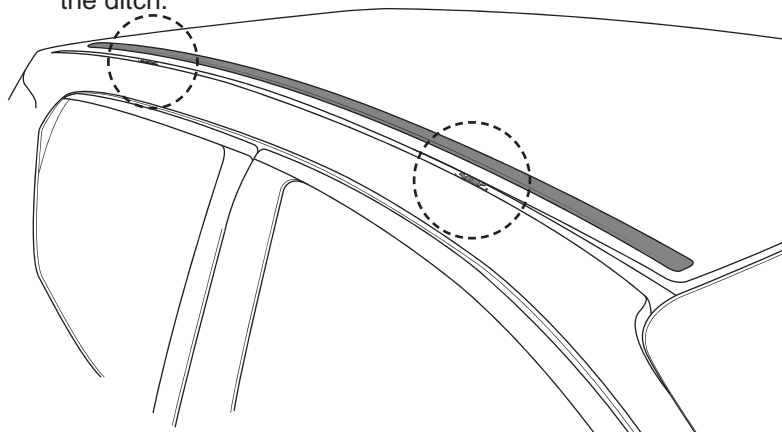

**3** Use a 3mm drill bit and create a pilot hole on the references made previous. Check position is correct and then open up with an 11mm drill bit.

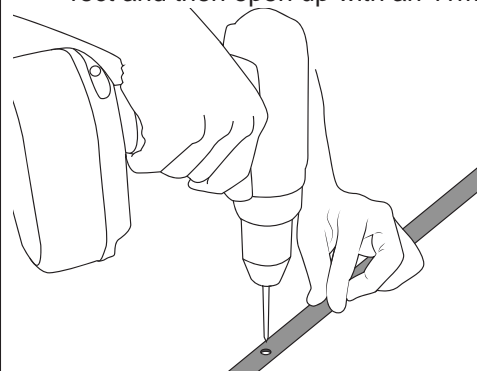

**Tip:** Drill with an 11mm bit halfway from the outside, flip the mould over, then drill through from the under-side.

**4** Use a dremel and a fine sand head, clean up the holes made in previous step. A de-burring tool can be helpful.

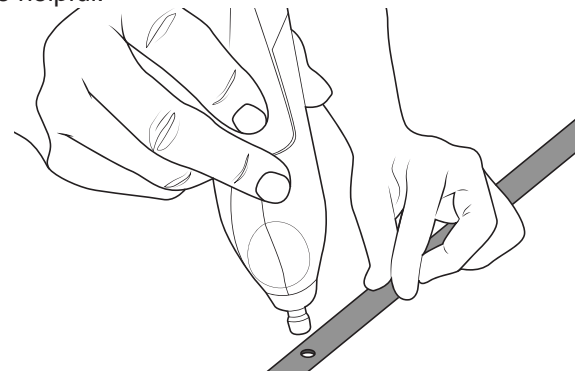



# RVP50 Supplement - Triton Double Cab MQ

**5** Install the M8 studs into the brackets in the ditch.

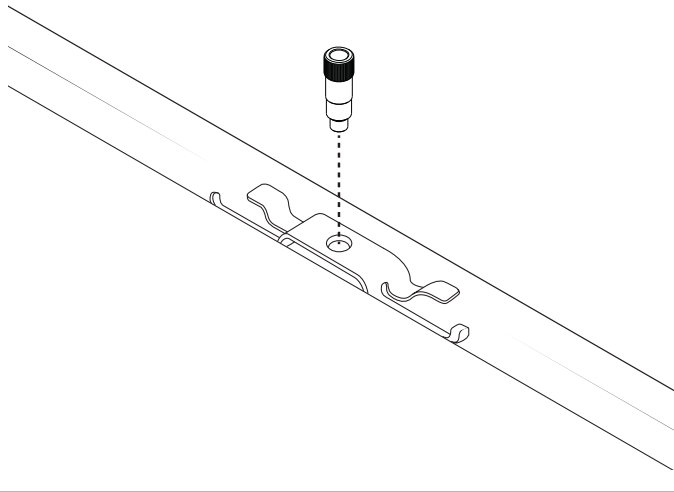

**6** Replace the ditch mould. The studs will poke through the holes drilled in the mould.

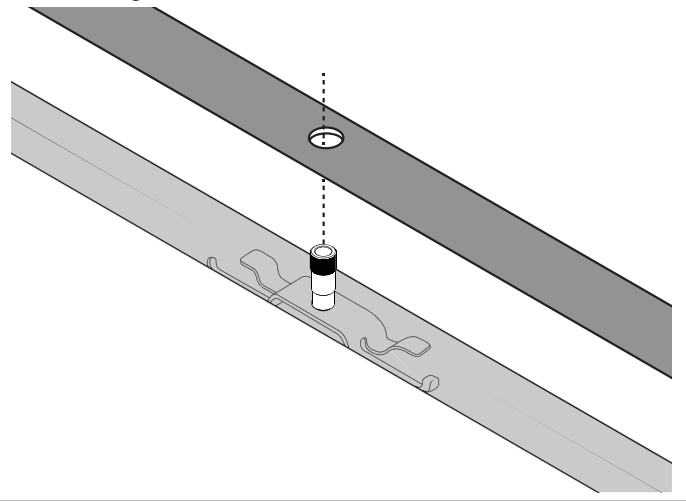

**Leg kit:** RVL4  
**Front bar:** 940mm  
**Rear bar:** 860mm  
**Base kit:** RCP47-BK

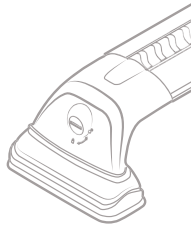

**Leg kit:** RCL4  
**VA Bar:** VA126S/B  
**Base kit:** RCP47-BK

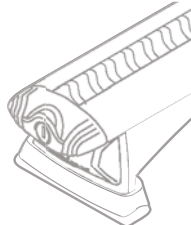

**Leg kit:** RCL4  
**HD Bar:** RB1250S/B  
**Spacers:** QMHD05  
**Base kit:** RCP47-BK

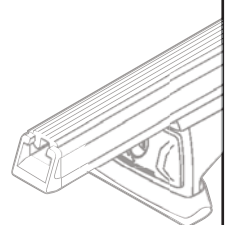

Note: When installing RCP47-BK and leg kit, tighten to 3-4 Nm while visually watching the roof panel. Over tightening can damage the roof of the vehicle.

**Note** Vortex crossbars can be cut to length to fit this vehicle. Measure the desired length out **from the centre of the Vortex Bar** and create a reference with a marker. Carefully cut the bar at these markings using a Saw with an Alloy Cutting Blade.

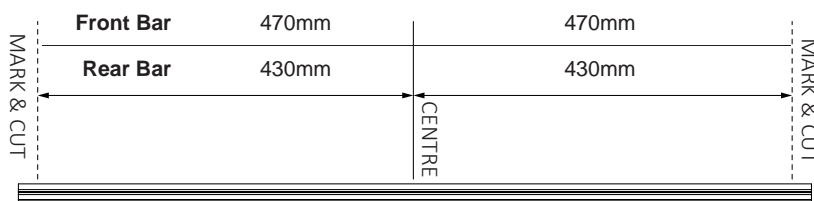

Cut the Bar at the required length.

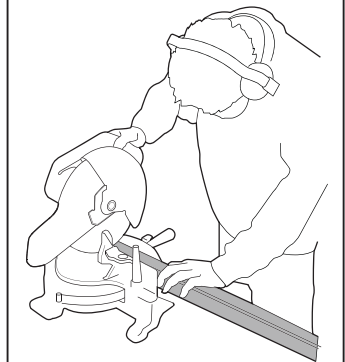

Prepared By: Kayle Everett

Authorised: Chris Murty

Document: R1214

Date: 01/03/18 Issue: 03