



RHINO-RACK

Aerodynamic & Heavy Duty Roof Rack Systems

RSS141 & RSS141F Rhino Sportz - Holden RA Rodeo 3/03 Onwards

RSS141 = 50kg & RSS141F = 25kg

Place these instructions in the vehicle's glove box after installation is complete.

Important: Please read these instructions carefully prior to installation.
Please refer to your fitting instruction to ensure that the roof racks are installed in the correct locations.
Check the contents of kit before commencing fitment and report any discrepancies.

Parts List

| Item | Component Name | Qty. | Part No. |
|------|-------------------------------------|------|-----------|
| 1 | Sportz Aero Bar Rubber Buffer | 2 | R011 |
| 2A | Sportz Aero Bar Front 93.5mm | 1 | A155 |
| 2B | Sportz Aero Bar Rear 92mm | 1 | A155 |
| 3 | 10G x 1/2 Pan Head Phillips Screw | 4 | B045 |
| 4 | M6 x 32mm Button Hd Security Screw | 4 | B064 |
| 5 | M6 x 12.5mm Flat Washer | 4 | W003 |
| 6A | Sportz Track Leg Left | 2 | M013 |
| 6B | Sportz Track Leg Right | 2 | M014 |
| 7A | Sportz Rubber Pad Left | 2 | M018 |
| 7B | Sportz Rubber Pad Right | 2 | M019 |
| 8A | Holden Rodeo Clamp | 4 | 745 |
| 8B | M6 Cage Nut | 4 | N017 |
| 8C | 40mm Black Tape | 1 | Z011 |
| 8D | 21mm x 136mm Diecut Antislip Rubber | 4 | Z018 |
| 9 | 5mm Security Allen Key & Handle | 1 | H011&H013 |
| 10 | Fitting Instruction | 1 | RS43 |

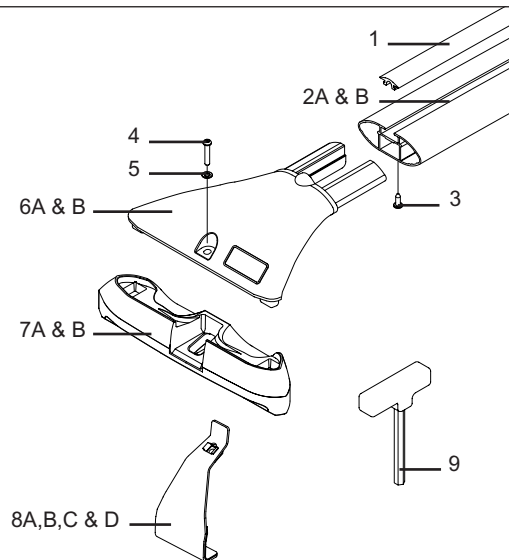

Care Instruction

Clean vehicle roof, prior to fitting your Rhino Sportz roof rack remove all dirt and grease.

Tools Required

Tape measure
5mm allen key, provided in kit

Layout

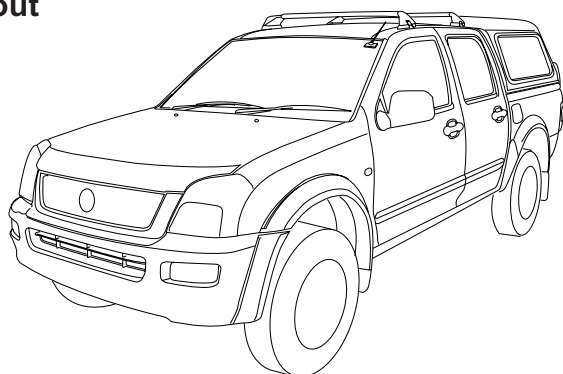

Insert the support legs fully into the crossbars. From the underside of the crossbar insert self-tapping screw into the hole provided and screw into the support leg to secure the leg to the crossbar.

1

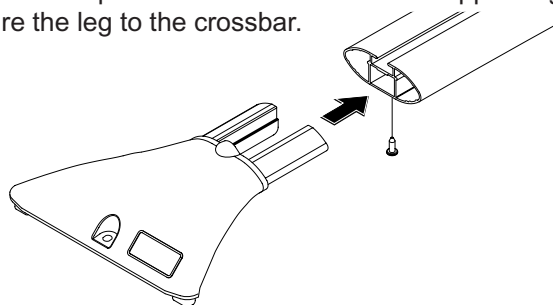

Insert the crossbar buffer strip into the top of the crossbar.

2

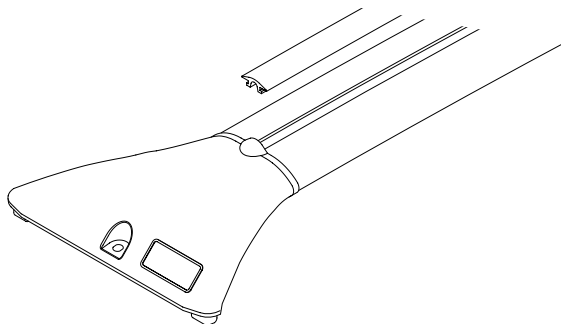

The front bar position from centre of clamp (A) and door (B) is to measure 300mm. The distance between centre clamp (A) and centre of clamp (C) is to measure 800mm.

3

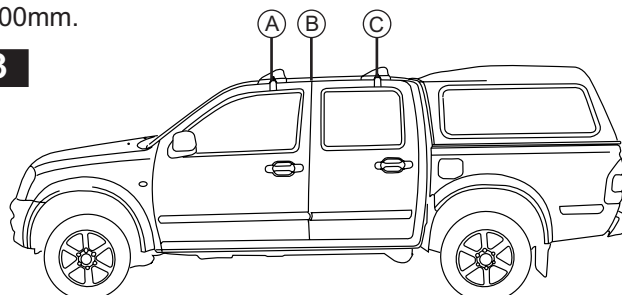

Place the four pads onto the vehicle roof. Ensure that the pads marked right are on the right hand (driver) side of the vehicle and the pads marked left are on the left hand (passenger) side of the vehicle. The arrows on the four pads must be facing forward.

4

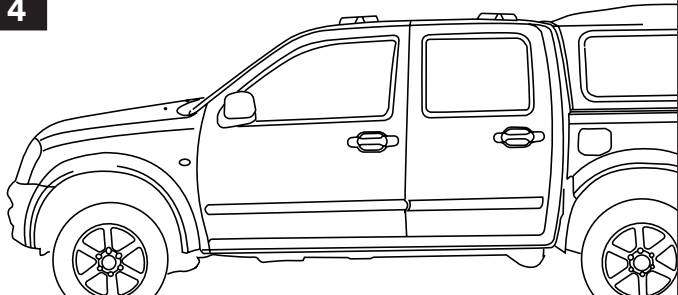

Open all four doors and remove the bottom door seal.

5

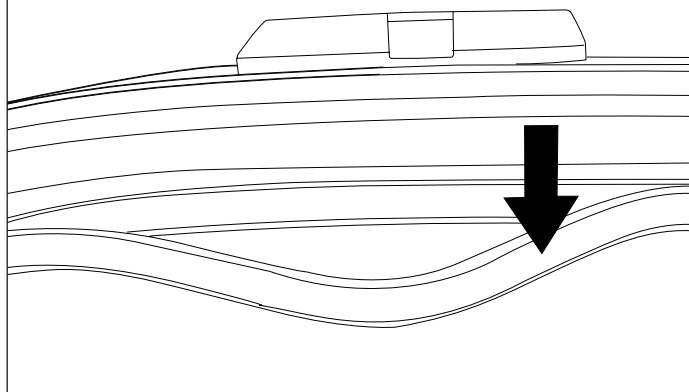

Hook the end of the strap onto the roof as shown in diagram and insert the cage nut into the pad recess. Repeat operation on all doors.

6

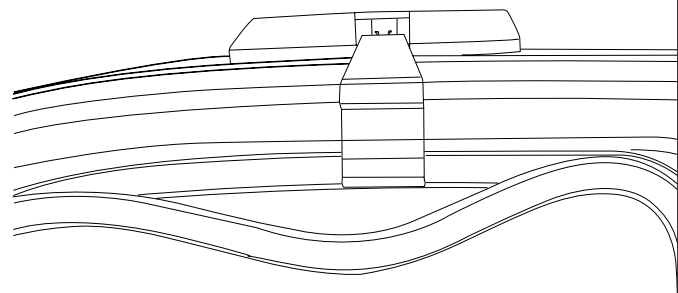

Place the support leg onto the rubber pad.

7

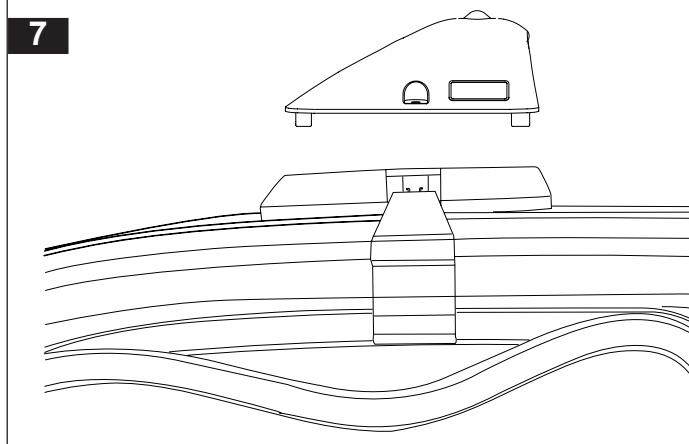

Assemble flat washers onto the security bolts, insert the bolt through the leg bolt hole and screw into the cage nut attached to the strap. Leave all bolts loose.

8

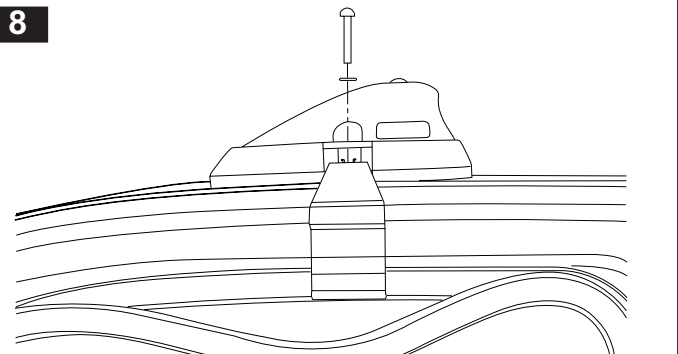

Check the position of the front and rear crossbars and pads as per the dimensions in step 3. The dimension should be measured on both sides of the vehicle.

9

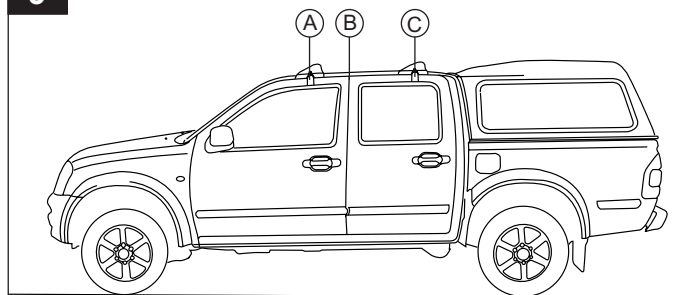

Progressively tighten evenly each pair of security bolts until a 10mm clearance gap is obtained between the base of the support leg and the upper surface of the strap. The handle of the allen key can be used to set the 10mm clearance gap. Refit bottom door seal.

Important: Do not over tighten screws as this may result in roof damage. Close all doors and check strap fitment. Ensure that all doors close correctly.

10

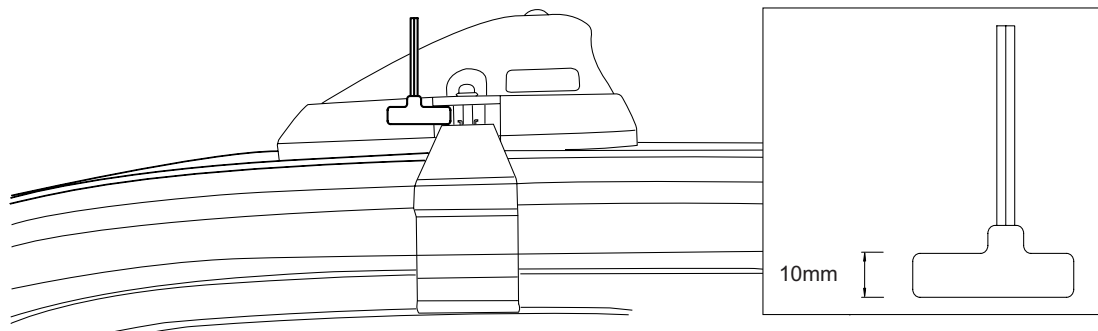

Important Information

RECOMMENDATIONS

Refer to your fitting instruction to ensure that the roof racks are installed in the correct locations.

Note that the vehicles roof load rating may be less than the roof rack load rating.

It is essential that all screw/bolt connections are checked after driving a short distance when you first install your Rhino-Rack. Screw/bolt connections should be checked again at regular intervals (probably once a week is enough, depending on road conditions, usage, loads and distances travelled). You should also check the Roof Racks each time they are refitted.

Roof racks and accessories should be cleaned and all screw threads should be lubricated at regular intervals. Always clean the vehicle roof and the mounting brackets before fitting the roof bars.

Rhino-Rack offers a 3 Year warranty to the original purchaser of the roof rack systems and accessories. Rhino-Rack cannot be held responsible for incorrect mounting of the Roof racks or for usage that exceeds production tolerances.

Make sure to fasten the load securely. Please ensure that all loads are evenly distributed and that the centre of gravity is kept as low as possible.

USE ONLY NON-STRETCH FASTENING ROPES AND STRAPS

SENSITIVITY TO CROSSWINDS, BEHAVIOUR IN CURVES AND BRAKING

The handling of the car changes when you transport a load on the roof. For safety reasons, we recommend you exercise extreme care when transporting wind resistant loads.

Special consideration must be taken into account when braking.

PLEASE REMOVE ROOF RACKS WHEN PUTTING VEHICLE THROUGH AUTOMATIC CAR WASH

LOAD RATINGS

Maximum permissible load is 50kg per pair of roof racks (include the weight of the roof bars, 5kg). When roof racks are to be used in off-road conditions, please build a safety factor of 1.5 into this load limit. Although the roof racks are tested and approved to AS1235-2000, Australian road conditions can be much more rigorous. However, increasing the number of crossbars does not increase the vehicles maximum permissible roof loading.

IMPORTANT NOTE FOR DEALERS AND FITTERS

Rhino-Rack cannot be held responsible for incorrect mounting of units or usage that exceeds production tolerance. If any of these fitting instructions are unclear to you, the fitter, please contact Rhino-Rack. It is your responsibility to ensure instructions are given to the end user or supplier.

Rhino-Rack
3 Pike Street, Rydalmere,
NSW 2116, Australia.
(Ph) (02) 9638 4744
(Fax) (02) 9638 4822

Document No: RS-43
Prepared By: Sheila Oliveira
Authorised By: Gary England

Issue No: 01
Issue Date: 16/10/2003

These instructions remain the property of Fetovu Pty Ltd T/as Rhino-Rack and may not be used or changed for any other purpose than intended.