



# RHINO-RACK

Aerodynamic & Heavy Duty Roof Rack Systems

**RSP08 - Rhino Sportz Two Bar System, VW Caddy, VW Caddy Maxi.**

**RSP11 - Rhino Sportz Two Bar System, Renault Kangoo, Nissan Kubistar.**

**Important:** Please read these instructions carefully prior to and during installation.  
Check the contents of kit before commencing fitment and report any discrepancies.

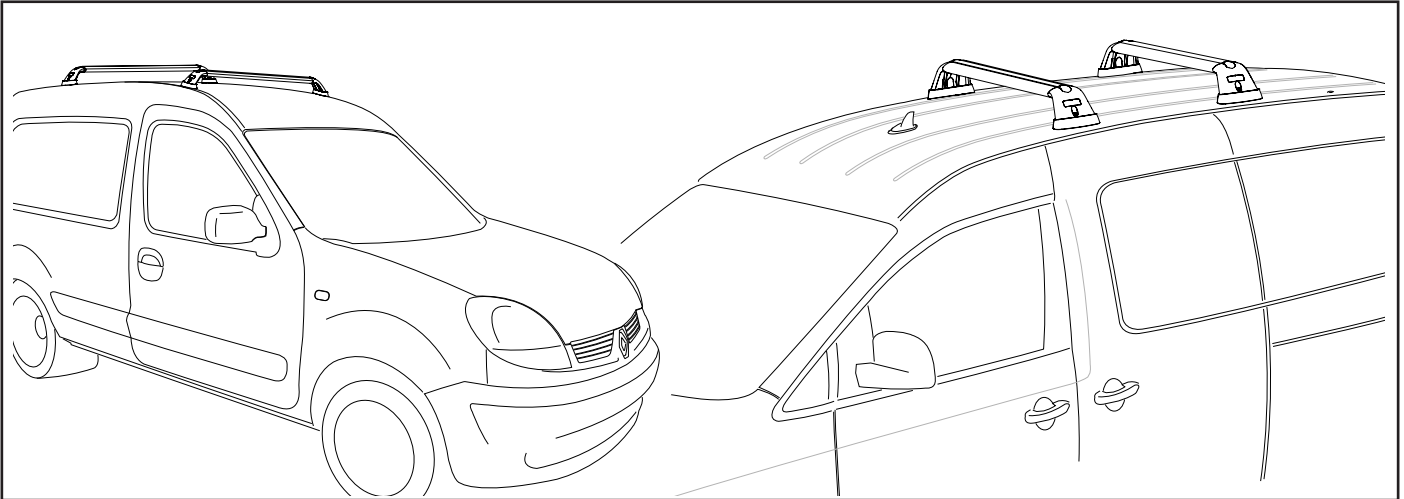

Clean roof prior to installation.

## Important Information

**Maximum carrying capacity:** **VW Caddy/Caddy Maxi 100kg.** Evenly distributed over the crossbars.  
**Renault Kangoo/Nissan Kubistar 80kg.** Evenly distributed over the crossbars.

**Recommendations:**

It is essential that all bolt connections be checked after driving a short distance when you first install your crossbars. Bolt connections should be checked again at regular intervals (probably once a week is enough, depending on road conditions, usage, loads and distances travelled). You should also check the crossbars each time they are re-fitted.

Make sure to fasten your load securely. Ensure all loads are evenly distributed and centre of gravity is kept as low as possible.

**Use only non-stretch fastening ropes or straps.**

**Caution:** The handling characteristics of the vehicle changes when you transport a load on the roof. For safety reasons we recommend you exercise extreme care when transporting wind-resistant loads. Special consideration must be taken into account when cornering and braking.

**Please remove crossbars when putting vehicle through an automatic car wash.**

**Load ratings:**

Maximum permissible load for Caddy Maxi and Caddy is 100kg per pair of crossbars, for Kangoo/Kubistar is 80kg. When crossbars are to be used in off-road conditions, please build a safety factor of 1.5 into this load limit. **67kg** for Caddy/Caddy Maxi. **53kg** for Kangoo/Kubistar. Although the crossbars are tested and approved to AS1235-2000, off-road conditions can be much more rigorous. However, increasing the number of crossbars does not increase the vehicles maximum permissible roof loading.

**Note for Dealers and Fitters:**

It is your responsibility to ensure instructions are given to the end user or client.

Rhino-Rack  
3 Pike Street, Rydalmere,  
NSW 2116, Australia.  
(Ph) (02) 9638 4744  
(Fax) (02) 9638 4822

Document No: RS-83  
Prepared By: Craig Jones  
Authorised By: Gary England

Issue No: 04  
Issue Date: 11/02/2011

These instructions remain the property of Rhino-Rack Australia Pty. Ltd. and may not be used or changed for any other purpose than intended.



# Rhino Sportz - RSP08, RSP11

## Parts List

Item	Component Name		Qty	Part No.
1A	Front buffer 845mm	Caddy/Caddy Maxi	1	R011
1B	Front buffer 780mm	Kangoo/Kubistar	1	R011
2A	Rear buffer 805mm	Caddy/Caddy Maxi	1	R011
2B	Rear buffer 780mm	Kangoo/Kubistar	1	R011
3A	Front crossbar 845mm	Caddy/Caddy Maxi	1	A155
3B	Front crossbar 780mm	Kangoo/Kubistar	1	A155
4A	Rear crossbar 805mm	Caddy/Caddy Maxi	1	A155
4B	Rear crossbar 780mm	Kangoo/Kubistar	1	A155
5	M6 x 27mm security screw		4	B063
6	M6 spring washer		4	W004
7	M6 flat washer		4	W003
8	RSP sportz Leg		4	M094
9	10G x 1/2" pan head phillips screw		4	B045
10	M8 x 25mm button head bolt		4	B140
11	M8 spring washer		4	W019
12	M8 flat washer		4	W030
13	M8 rubber O-ring		4	C299
14A	RCP FL-RR mounting pads		2	M187
14B	RCP FR-RL Mounting Pads		2	M188
15	Mounting pad cover plate		4	M126
16	5mm security allen key		1	Seckey-S
17	Fitting instruction		1	RS-83

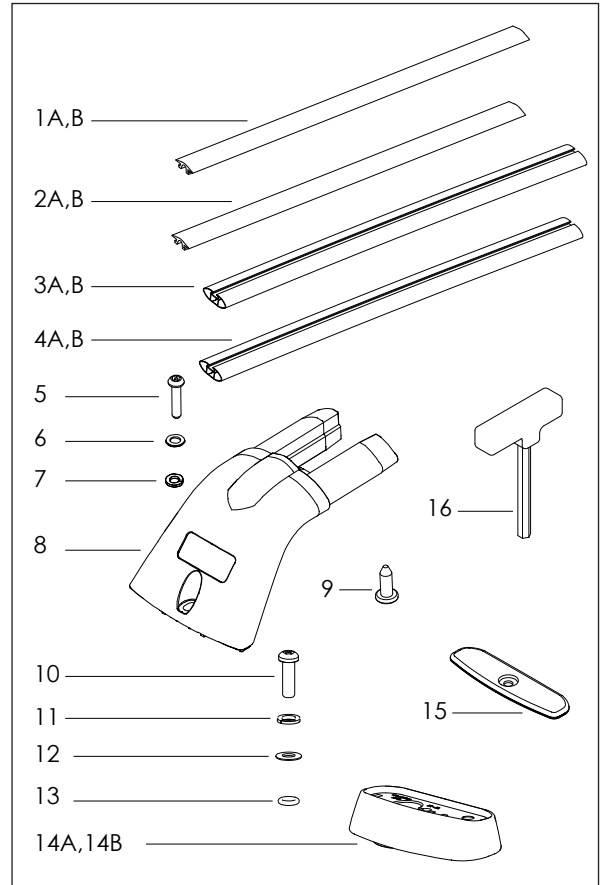

### Tools Required:

5mm security allen key, included.  
Phillips head screwdriver.

Rubber mallet.  
Torques drive.

1

VW Caddy  
VW Caddy Maxi

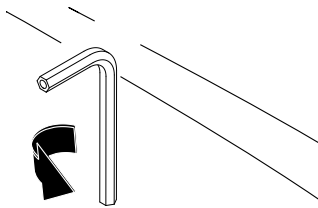

Renault Kangoo  
Nissan Kubistar

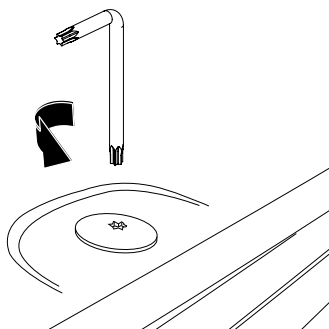

### VW Caddy/Caddy Maxi

Remove the roof plugs using 5mm allen key provided. Store the screws for replacement when racks are removed.

### Renault Kangoo/Nissan Kubistar

Remove the roof plugs using Torques drive. Store the screws for replacement when racks are removed.



# Rhino Sportz - RSP08, RSP11

## 2 Roof pad orientation 2 bar system.

The top surface of the pads have FR-RL and FL-RR marked on them.

FR - RL = Front Right.  
FR - RL = Rear Left.  
FL - RR = Front Left.  
FL - RR = Rear Right.

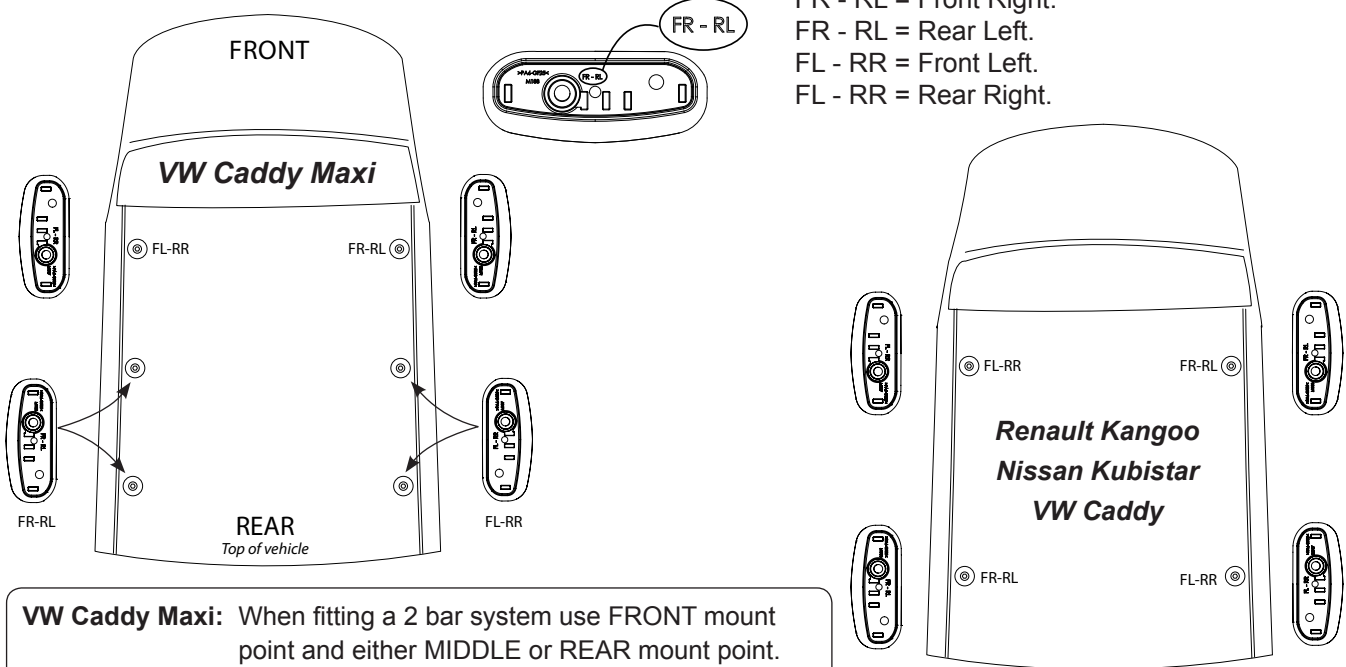

**VW Caddy Maxi:** When fitting a 2 bar system use FRONT mount point and either MIDDLE or REAR mount point. This depends on length of load being carried.

## 3

M8 x 25mm bolt

M8 spring washer

M8 flat washer

O-ring

outside of vehicle.

Front Right

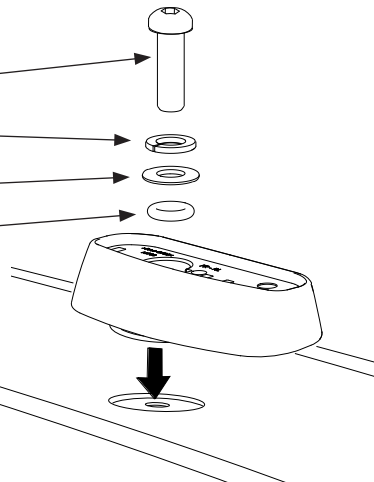

### Fit pads to roof.

Insert the M8 bolt/washer assembly through the pad. Fasten to the roof using the allen key provided. **Do not fully tighten at this stage.**

## 4 Attach legs.

- Insert Sportz legs into crossbars, a rubber mallet may be required to knock the legs in place.
- Fasten leg to crossbar using phillips head screw.

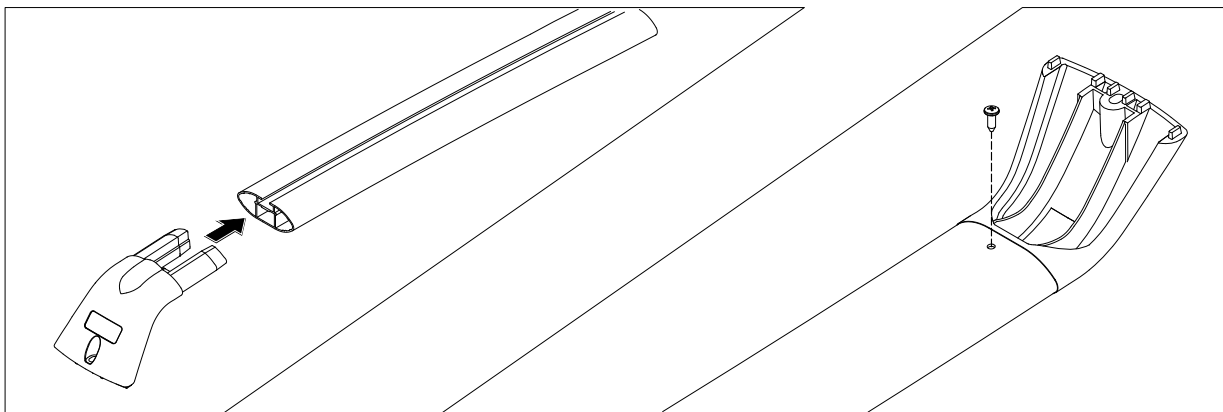



# Rhino Sportz - RSP08, RSP11

**5**

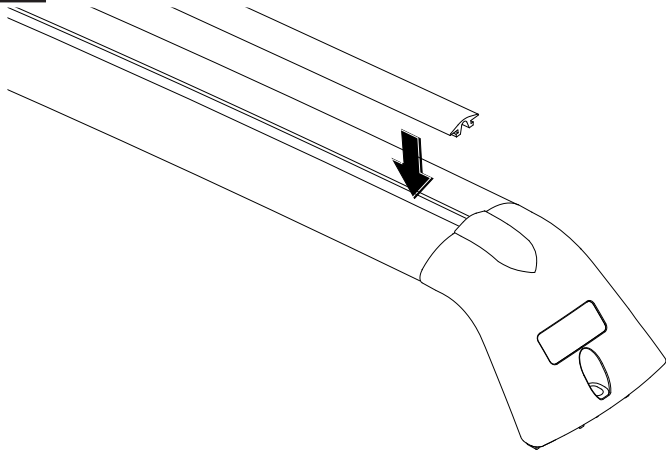

Insert correct length buffer strip into top of crossbar.

Caddy	FRONT	= 845mm
Caddy	REAR	= 805mm
Caddy Maxi	FRONT	= 845mm
Caddy Maxi	REAR	= 805mm
Kangoo/Kubistar	FRONT	= 780mm
Kangoo/Kubistar	REAR	= 780mm

**6**

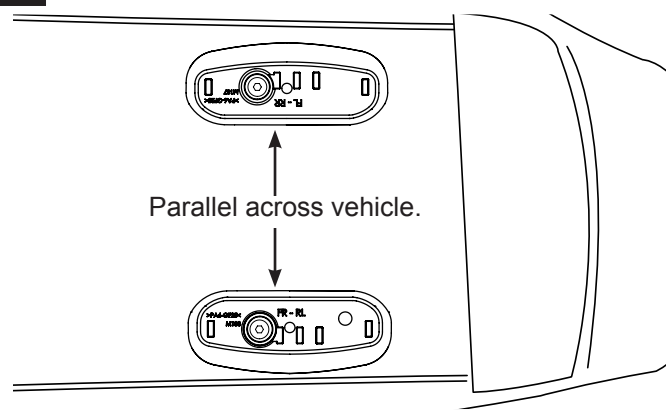

### Align pads.

Before tightening make sure the opposing pads are parallel across the vehicle.

**Tighten roof pads to 4-5 Nm.**

### 7 Fit pads to roof.

Place the RSP leg onto the pad. Insert screw and washer assembly through leg and into the pad. Use the allen key supplied to tighten. **Tighten to 3-4 Nm, DO NOT OVERTIGHTEN.**

