

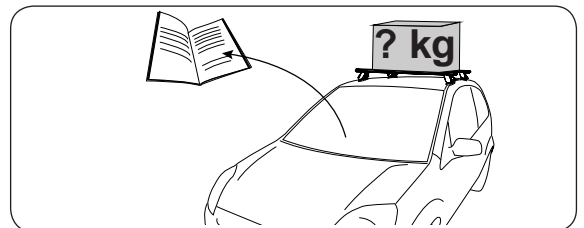

RHINO-RACK

WARNING!

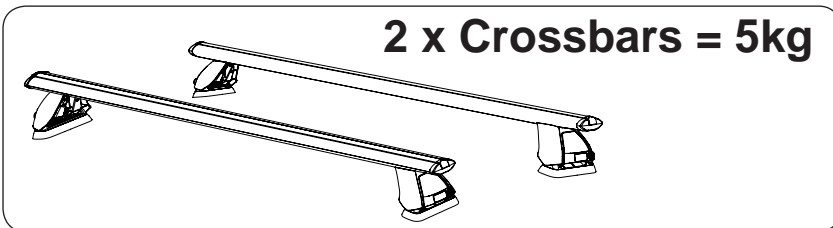
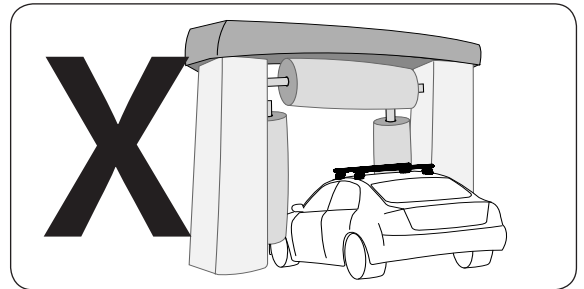
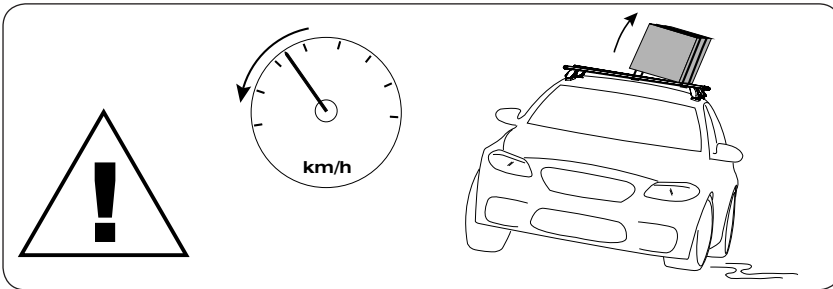
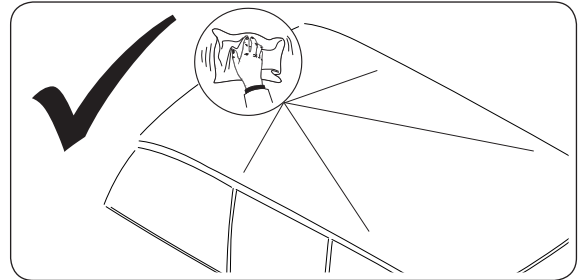
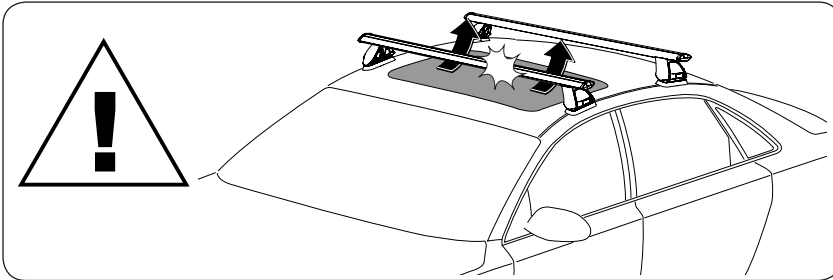
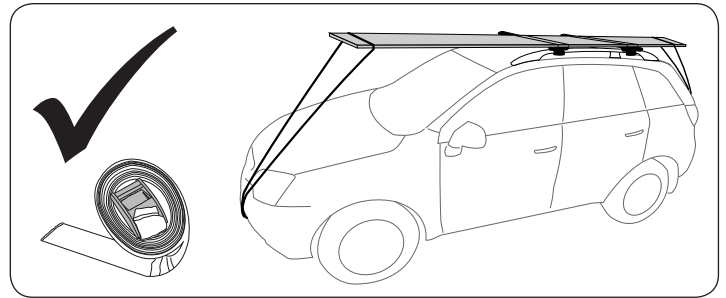
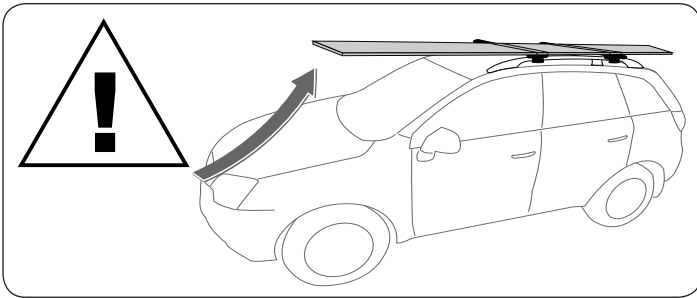

WARNING! Important Load Carrying Instructions

With utility vehicles, the cabin and the canopy move independently. Roof racks and vehicle can be damaged if the item transported is rigidly fixed at points on both the cabin and canopy. Instead, rigidly fix to either the cabin roof racks or the canopy roof racks.

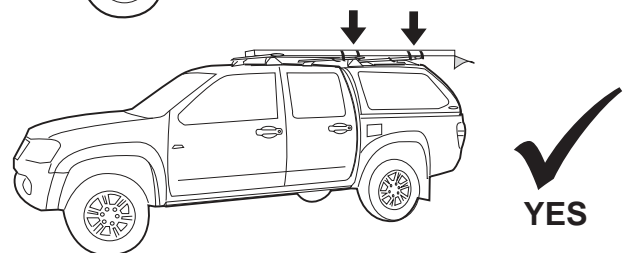
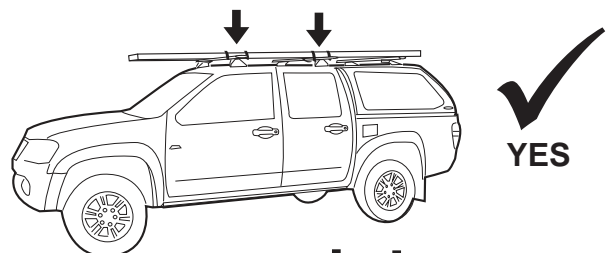
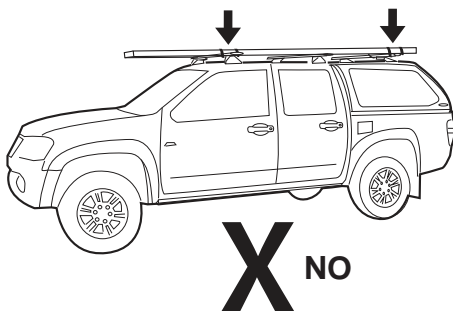

- Please refer to your vehicle manufacturers handbook for maximum roof load capacity.
- Any load transported on Roof Racks must be evenly distributed.
- Instructions are to remain with the vehicle.
- Do not attempt to fit the roof racks to your vehicle unless you fully read and understand the fitting instructions provided.
- Please direct any questions to the dealer from where the roof racks were purchased.



RHINO-RACK

RSP03 - Toyota LandCruiser Prado, Lexus GX Sportz Crossbar System

Parts List

Item	Component Name	Qty.	Part No.
1	Sportz Rubber Buffer	3	R011
2	Sportz Bar	3	A155
3	M6 x 32mm Button Head Security Screw	6	B064
4	M6 Spring Washer	6	W004
5	M6 x 12.5mm Flat Washer	6	W003
6	Sportz Narrow Base Short Leg	6	M094
7	10G x 1/2" Pan Head Phillips Screw	6	B045
8	Cover Plate Pad - RSP/RCP	6	M126
9A	M8 x 50mm Button Head Cap Screw	8	B126
9B	M8 x 40mm Button Head Cap Screw	4	B127
10	M8 Spring Washer	12	W019
11	M8 x 17mm Flat Washer	12	W020
12	7mm x 4mm O-Ring	12	C299
13A	Toyota Prado Front Left Pad	1	M111
13B	Toyota Prado Front Right Pad	1	M112
13C	Toyota Prado Middle Left Pad	1	M113
13D	Toyota Prado Middle Right Pad	1	M114
13E	Toyota Prado Rear Left Pad	1	M115
13F	Toyota Prado Rear Right Pad	1	M116
14	10mm x 3mm O-Ring	12	C088
15	5mm Security Allen Key & Handle	3	H011&H013
16	Fitting instruction	1	RS52

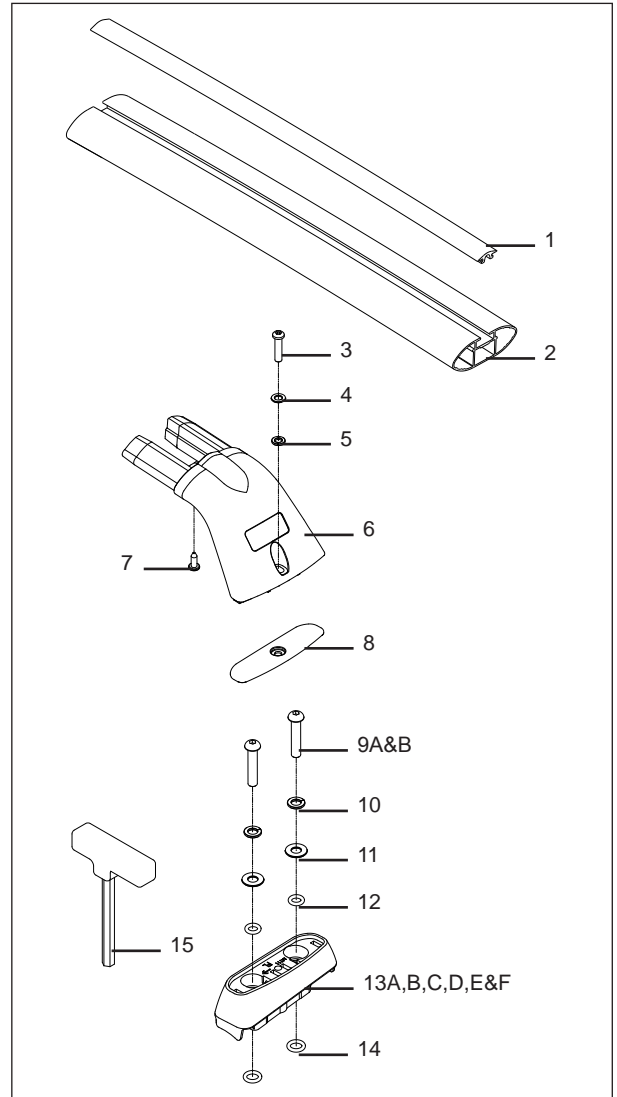

Tools Required.

Security Allen key, provided in kit
 Phillips head screw driver
 12mm socket wrench
 Small Flat Blade Screwdriver
 Rubber mallet.

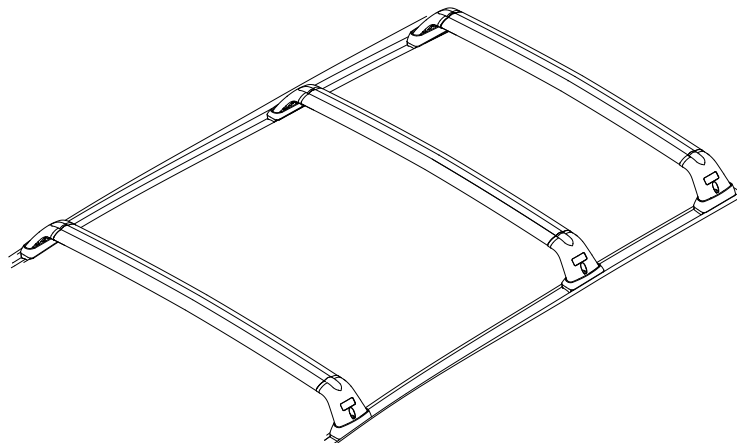

Remove the roof rack attachment point covers, exposed bolts and brackets. Store covers, bolts and brackets in a safe place. **Note: The existing bolts and washers are not used to fit the mounting pads.**

1

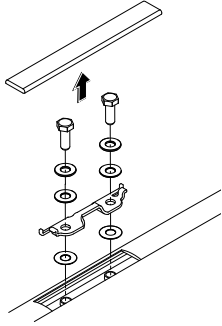

Place the 10mm large o-rings onto the protruding plastic tubes.

2

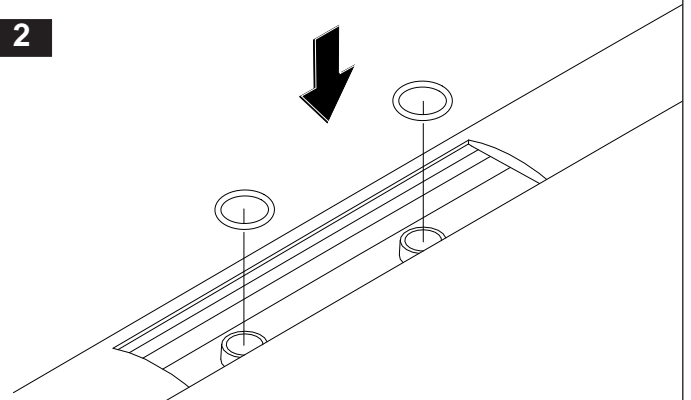

Insert the support leg into the crossbars.

3

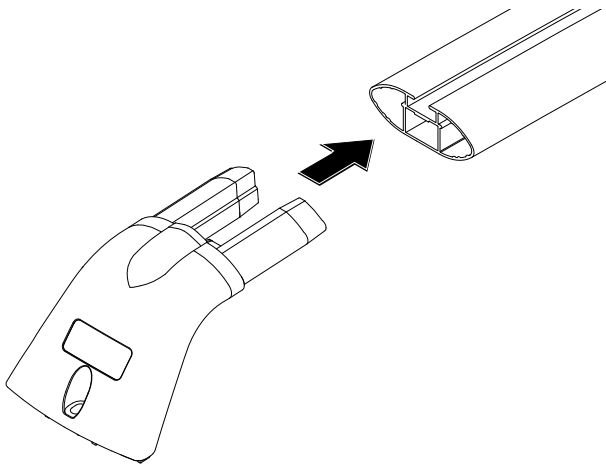

From the underside of the crossbar insert the phillips screw into the hole provided and screw into the support leg to secure the leg to the crossbar.

4

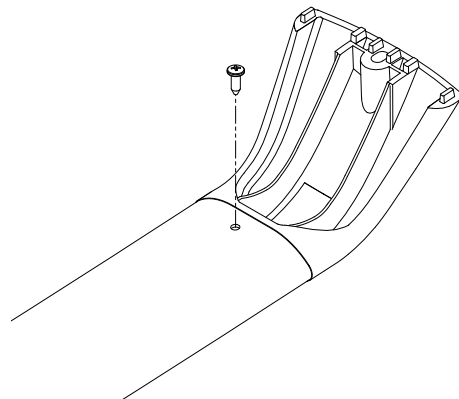

Collect all mounting pads supplied and identify position codes and direction arrows on each pad. The arrow must point to the front of the vehicle. The right hand side is the driver's side.

The mounting pad position code is as follows:

FL - Front Left Side Pad
FR - Front Right Side Pad

ML - Middle Left Side Pad
MR - Middle Right Side Pad

RL - Rear Left Side Pad
RR - Rear Right Side Pad

5

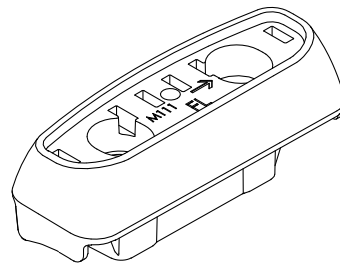
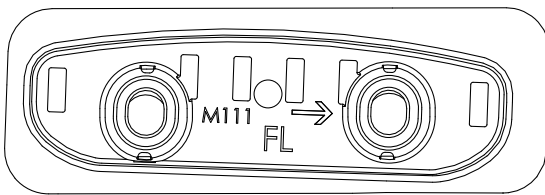

Insert the mounting pad into the mounting pad recess. Using the mounting pad layout as a guide, place the pads onto their respective positions.

6

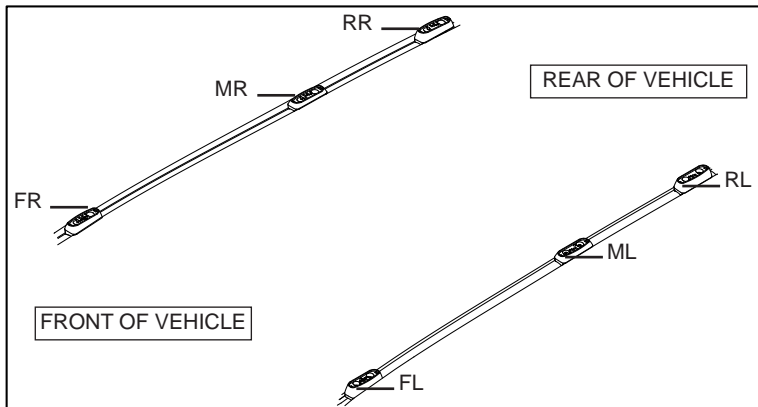
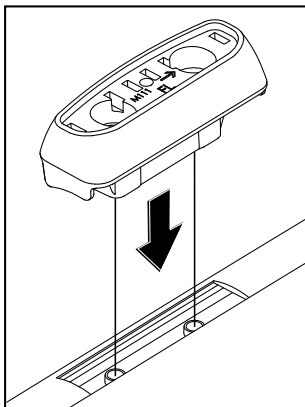

Place the M8 spring washer, M8 flat washer and 7mm small o-ring onto the M8 screws. Ensure that the o-ring is fully pushed up under the flat washer.

Note: For the front and rear mounting pads use the M8 x 50mm screws.
For the middle mounting pads use M8 x 40mm screws.

7

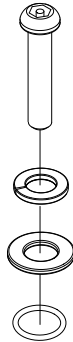

Insert the assembled screws through the mounting pads and screw into the nutserts in the vehicle's roof. Tighten all bolts using the allen key provided. Recommended tightening torque 6 Nm. **Do not over tighten.**

8

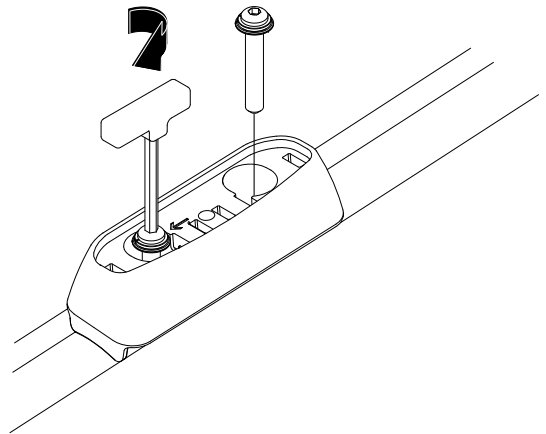

Insert the support leg assemblies into the mounting pads. The crossbars are identified as Front, Middle and Rear, refer to the crossbar layout in diagram 6.

9

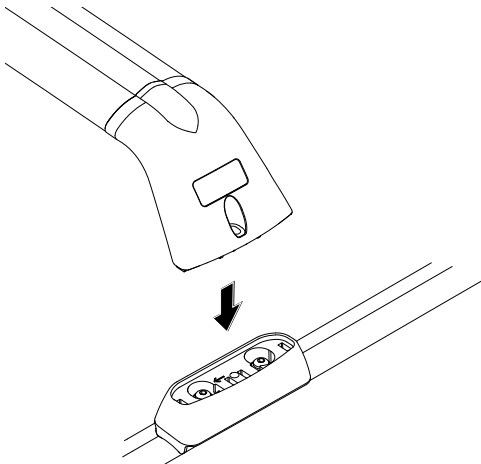

Place the M6 spring washer and M6 flat washer onto the M6 x 32mm security screw.

10



Use the allen key to tighten the support leg attachment screws to secure the crossbars. Recommended tightening torque 3-4 Nm. **Do not over tighten.**

11

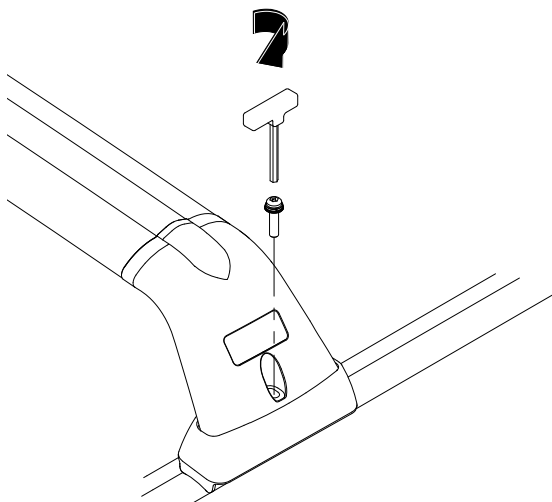

Removing Crossbars

When removing the Rhino Sportz rack, unscrew the attachment screws and remove the crossbars. The mounting pads can remain attached to the roof if desired. Store the Rhino Sportz aerorack and hardware in a safe place. Alternatively, use M6 hardware to mount M126 cover plates (please refer to separate instruction sheet).

Refitting Crossbars

To refit the crossbar assemblies, place the crossbars onto the mounting pads in their preset positions. Insert the M6 screw assembly as per instruction 10, using the short end of the security allen key, tighten the bolt as recommended in instruction 11.

Important Information

RECOMMENDATIONS

Please refer to your fitting instruction to ensure that the Rhino Sportz roof racks are installed in the correct locations.

The vehicles roof load rating may be less than the Rhino Commercial roof rack load rating.

It is essential that all screw/bolt connections are checked after driving a short distance when you first install your Rhino-Rack. Screw/bolt connections should be checked again at regular intervals (probably once a week is enough, depending on road conditions, usage, loads and distances travelled). You should also check the Roof Racks each time they are refitted.

Roof Racks and accessories should be cleaned and all screw threads should be lubricated at regular intervals. This will help avoid damage to your vehicles paint surface. Always clean the vehicle roof and the mounting brackets before fitting the roof bars.

Rhino-Rack offers a 3 year warranty to the original purchaser of Rhino-Rack Systems and Accessories. Rhino-Rack cannot be held responsible for incorrect mounting of the racks or for usage that exceeds production tolerances.

Make sure to fasten the load securely. Please ensure that all loads are evenly distributed and that the centre of gravity is kept as low as possible.

USE ONLY NON-STRETCH FASTENING ROPES AND STRAPS

SENSITIVITY TO CROSSWINDS, BEHAVIOUR IN CURVES AND BRAKING

The handling of the car changes when you transport a load on the roof.

For safety reasons, we recommend you exercise extreme care when transporting wind resistant loads. Special consideration must be taken into account when braking.

PLEASE REMOVE ROOF RACKS WHEN PUTTING VEHICLE THROUGH AUTOMATIC CAR WASH

LOAD RATINGS

Maximum permissible load is 100kg per set of three bar roof racks (include the weight of the roof bars, 5kg). When Roof Racks are to be used in off-road conditions, please build a safety factor of 1.5 into this load limit (67kg per set). Although the Roof Racks are tested and approved to AS1235-2000, Australian road conditions can be much more rigorous. Increasing the number of crossbars does not increase the vehicles maximum permissible roof loading.

NOTE FOR DEALERS AND FITTERS

It is your responsibility to ensure instructions are given to the end user or supplier.

Rhino-Rack
3 Pike Street, Rydalmere,
NSW 2116, Australia.
(Ph) (02) 9638 4744
(Fax) (02) 9638 4822

Document No: RS-52
Prepared By: Sheila Oliveira
Authorised By:

Issue No: 02
Issue Date: 22/03/2012

These instructions remain the property of Rhino-Rack Australia Pty Ltd T/as Rhino-Rack and may not be used or changed for any other purpose than intended.