

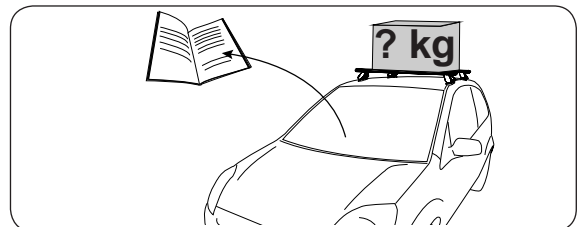

# RHINO-RACK

## WARNING!

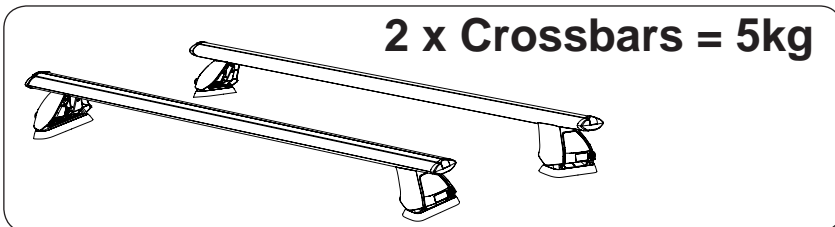
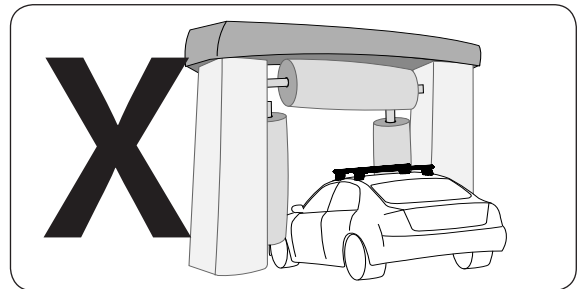
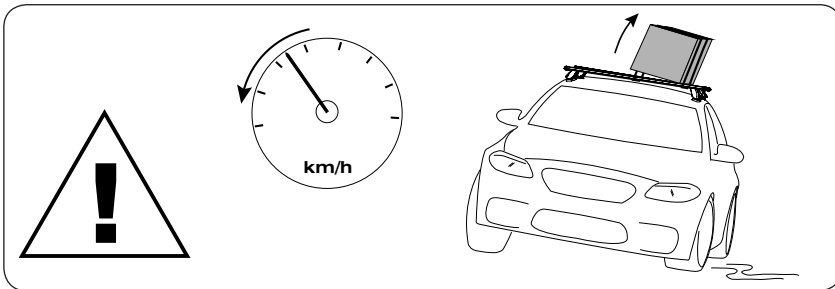
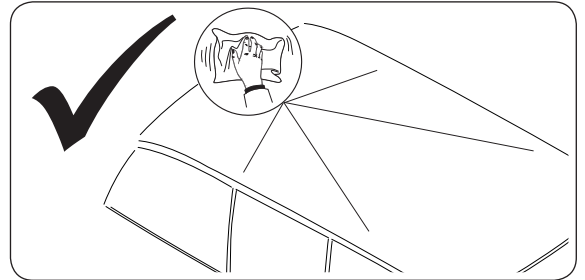
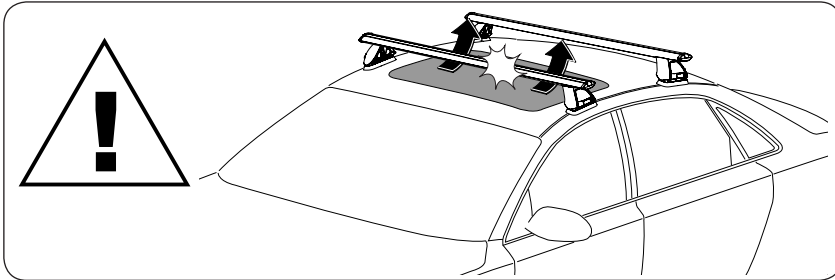
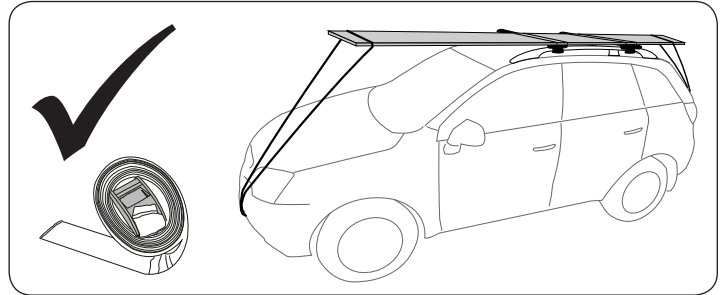
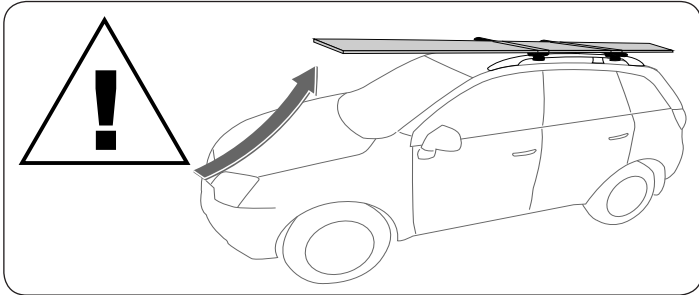

### WARNING! Important Load Carrying Instructions

With utility vehicles, the cabin and the canopy move independently. Roof racks and vehicle can be damaged if the item transported is rigidly fixed at points on both the cabin and canopy. Instead, rigidly fix to either the cabin roof racks or the canopy roof racks.

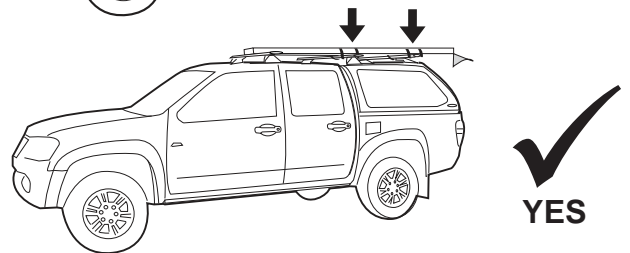
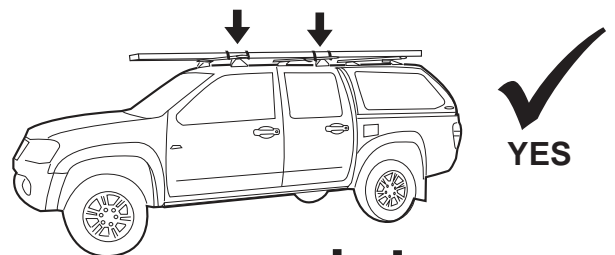
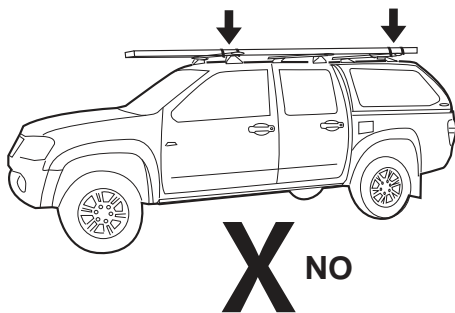

- Please refer to your vehicle manufacturers handbook for maximum roof load capacity.
- Any load transported on Roof Racks must be evenly distributed.
- Instructions are to remain with the vehicle.
- Do not attempt to fit the roof racks to your vehicle unless you fully read and understand the fitting instructions provided.
- Please direct any questions to the dealer from where the roof racks were purchased.



# RHINO-RACK

## RSF2 / RSF3 - Rhino Sportz

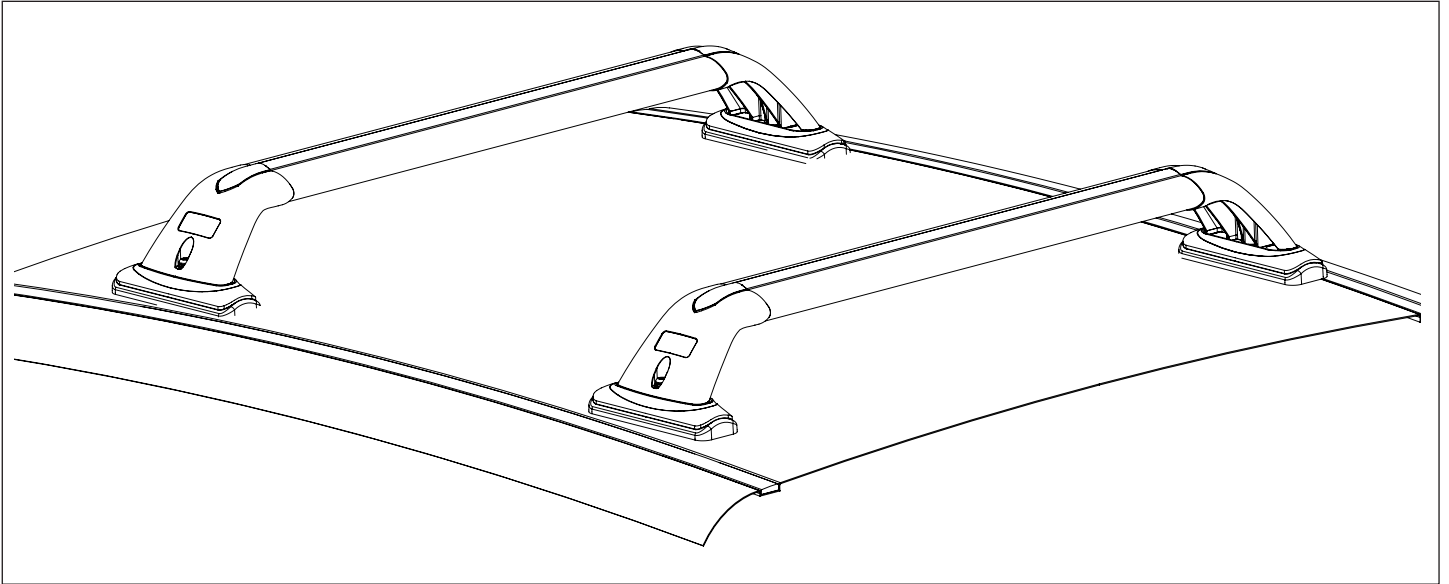

### Maximum carrying capacity:

Please refer to your vehicle manufacturers handbook for maximum carrying capacity of your roof racks. Load being transported must be evenly distributed over the crossbars. Keep the loads centre of gravity as low as possible. Please include weight of the roof racks (5kg/11lbs) when accounting for maximum load capacity.

### Use only non-stretch fastening ropes or straps.

### Recommendations:

It is essential that all bolt connections be checked after driving a short distance when you first install your roof racks. Bolt connections should be checked again at regular intervals (once a week is enough, depending on road conditions, usage, loads and distances travelled). You should also check the roof racks each time they are re-fitted. Always make sure to fasten your load securely. Long loads (e.g. canoes and kayaks) must be secured front and rear with non-stretch fastening ropes or straps.

### Roof racks must be removed when putting vehicle through an automatic car wash.

**Caution:** The handling characteristics of the vehicle changes when you transport a load on the roof. For safety reasons we recommend you exercise extreme care when transporting wind-resistant loads. Special consideration must be taken into account when cornering and braking.

### Off-road use:

When crossbars are to be used in off-road conditions, please build a safety factor of 1.5 into this load limit for off-road use. Although the crossbars are tested and approved to AS1235-2000, Off-road conditions can be much more rigorous. However, increasing the number of crossbars does not increase the vehicles maximum permissible roof loading.

### Note for Dealers and Fitters

It is your responsibility to ensure this fitting instruction is given to the end user or client

Rhino-Rack  
3 Pike Street, Rydalmere,  
NSW 2116, Australia.  
(Ph) (02) 9638 4744  
(Fax) (02) 9638 4822  
[www.rhinorack.com.au](http://www.rhinorack.com.au)

Document No: R153  
Prepared By: Craig Jones  
Authorised By: Chris Murty

Issue No: 01  
Issue Date: 16/12/2011

These instructions remain the property of Rhino-Rack Australia Pty Ltd and may not be used or changed for any other purpose than intended.

# RSF2 / RSF3 - Rhino Sportz

## Parts List

Item	Component Name	Qty	Part No.
1	Crossbar	2	RRC026
2	Rubber buffer strip	2	R011
3	Accessory flap	4	M183
4	M6 x 27mm security screw	4	B063
5	M6 spring washer	4	W004
6	M6 flat washer	4	W003
7	Leg (Low RSF2 / High RSF3)	4	M509/M561
8	Top pad	4	M508
9	M6 curved nut	4	N060
10	10G self tapper	4	B045
11	M6 curved nut retainer	4	M510
12	5mm Rivet	16	H042
13	Fixed pad	4	M507
14	PVC foam	4	C135
15	5mm security allen key	1	SecKey-S
16	Fitting Instruction	1	R153

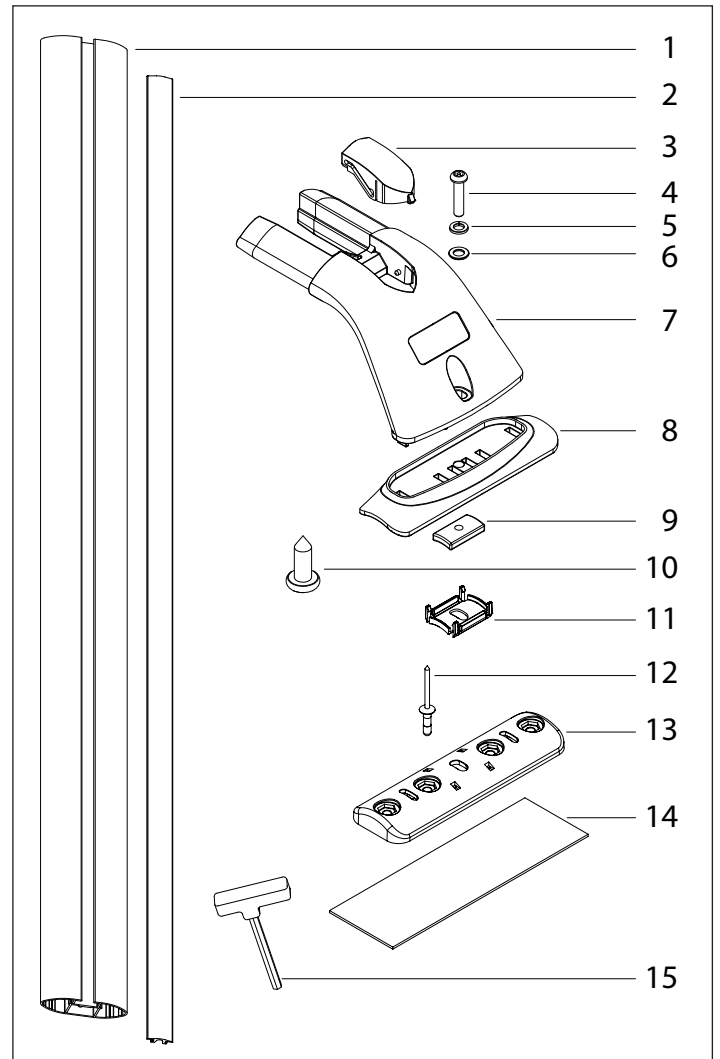

## Tools Required

5mm security Allen key, included.

Masking tape.

Marking pen.

Utility knife.

Tape measure.

Rubber mallet.

Phillips head screwdriver.

Rag.

Vacuum cleaner.

Pneumatic or hand rivet gun.

Power or Battery drill.

5mm drill bit.

Drill stop.

Cold galvanising solution.

Cotton buds.

Caulking gun

Selleys Butyl Mastic sealer (non hardening sealer).



# RSF2 / RSF3 - Rhino Sportz

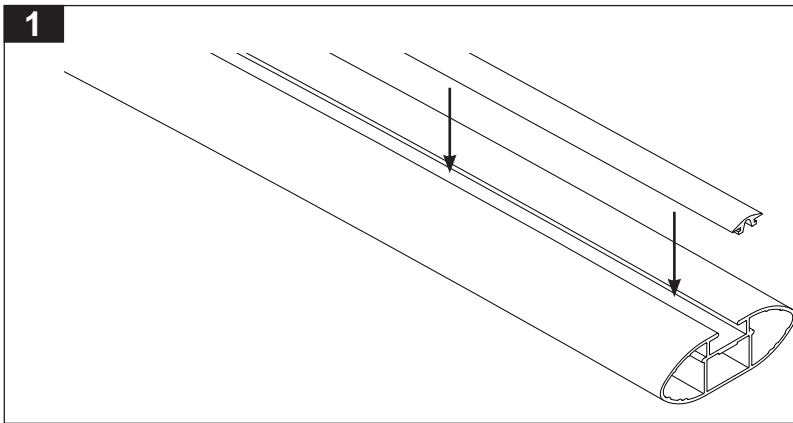

Insert corresponding length rubber buffer strip into front and rear crossbars.

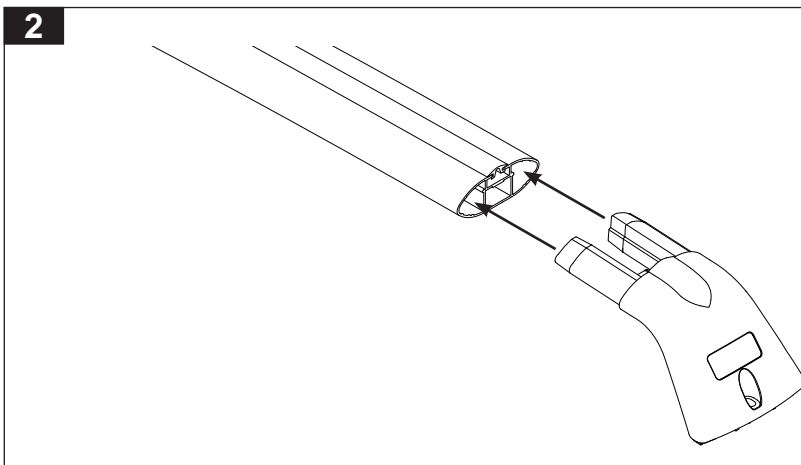

Insert legs into crossbars. A rubber mallet may be used to knock them in.

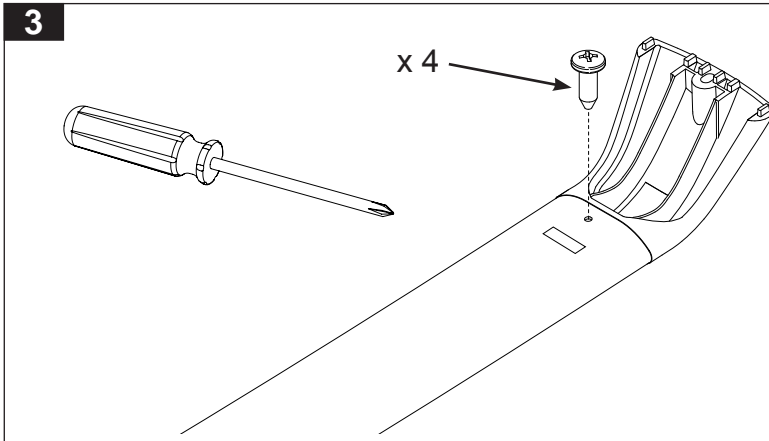

From underside of crossbar insert phillips head screw to secure the leg.

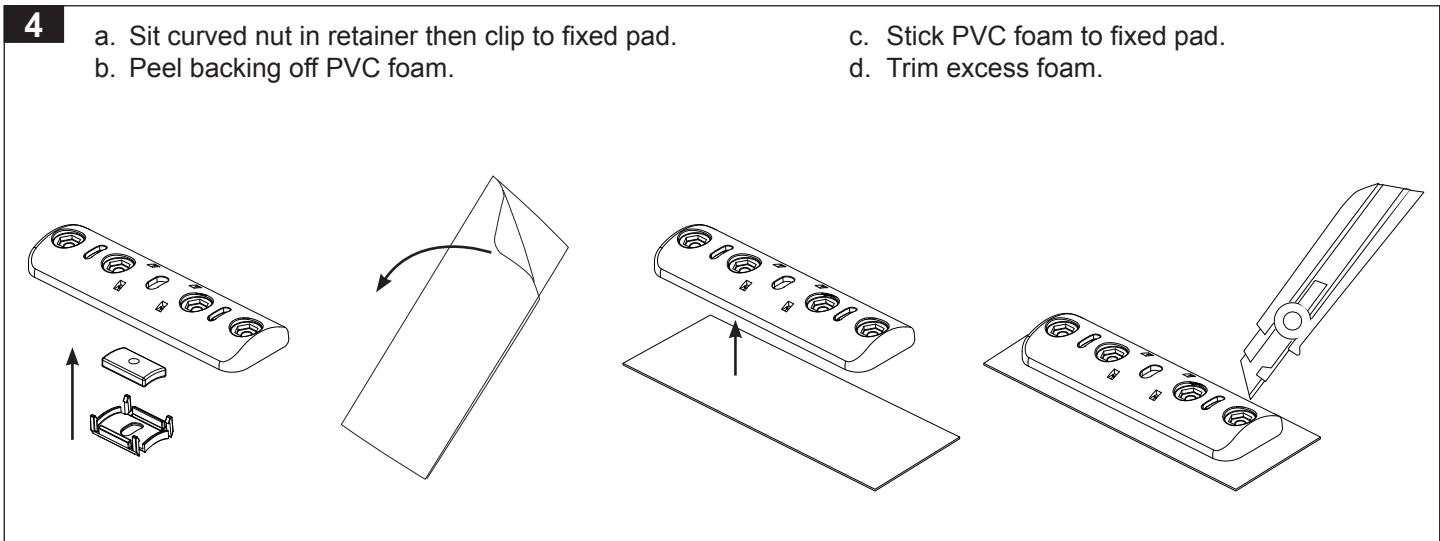

# RSF2 / RSF3 - Rhino Sportz

5

Assemble front & rear roof rack. DO NOT fully tighten M6 screw.  
Refer Roof Rack Application Chart below for vehicle and measurements.

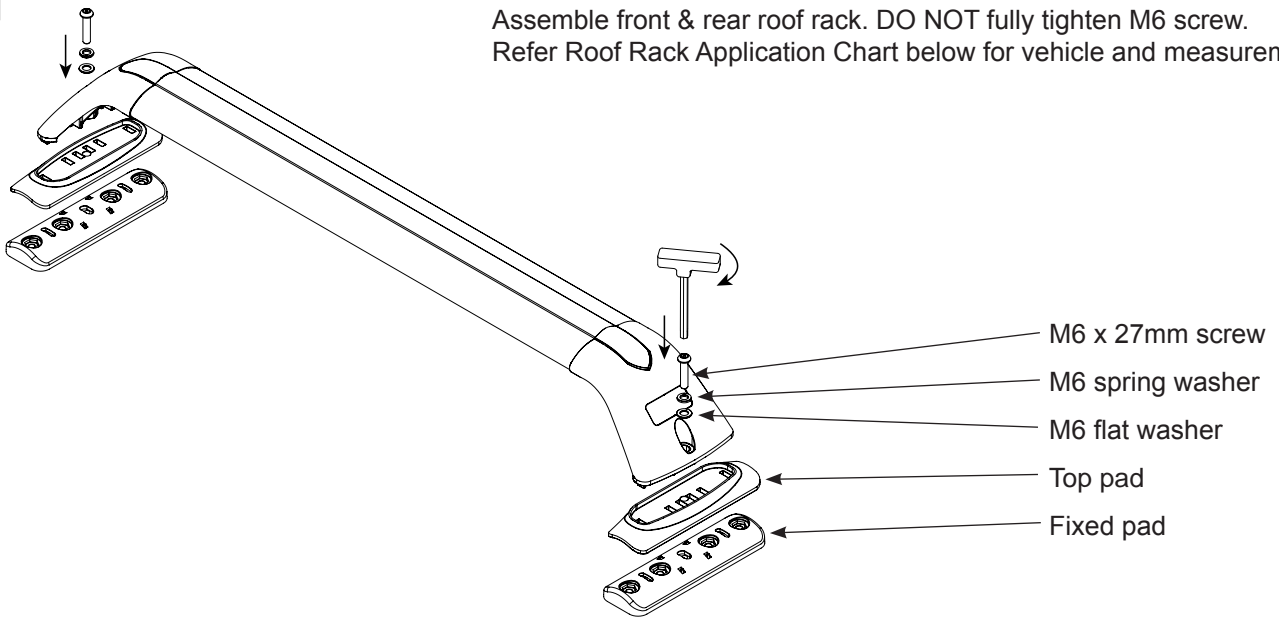

6

Apply masking tape to roof turret, refer measurements in Roof Rack Application Chart page 6.

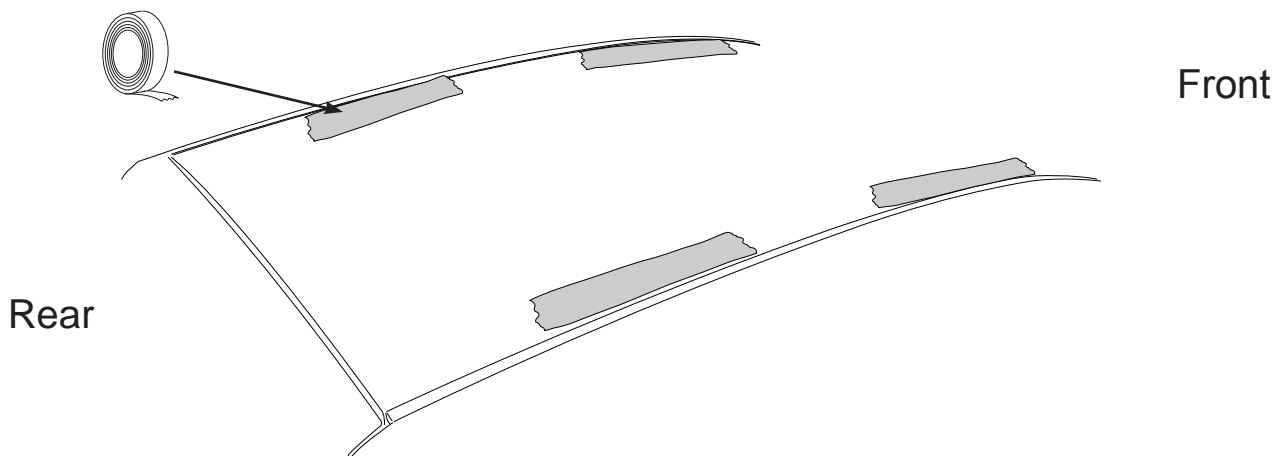

7

Mark centrelines for base pad, refer measurements in Roof Rack Application Chart page 6.

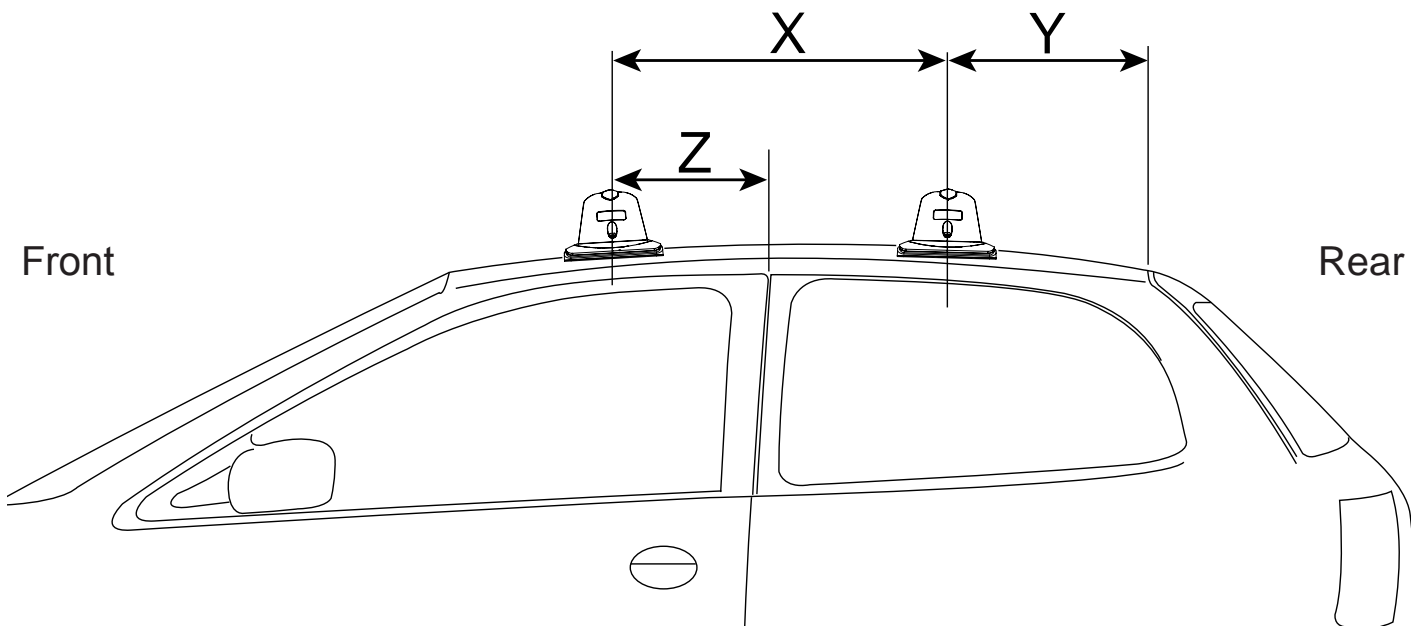

# RSF2 / RSF3 - Rhino Sportz

## Roof Rack Application Chart

Part No.	Vehicle	Date	Crossbar Front	Crossbar Rear	Measurements		
					X	Y	Z
RSF3/732/688	Toyota Yaris 3dr	2012-	732mm	688mm	720mm	400mm	N/A
RSF2/746/671	Toyota Yaris 5dr	05-11	746mm	671mm	750mm	N/A	250mm

# RSF2 / RSF3 - Rhino Sportz

**8** Make sure roof racks are parallel across vehicle.

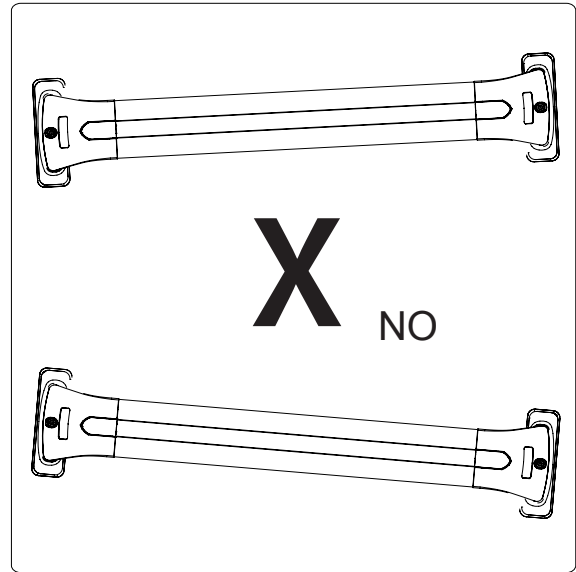
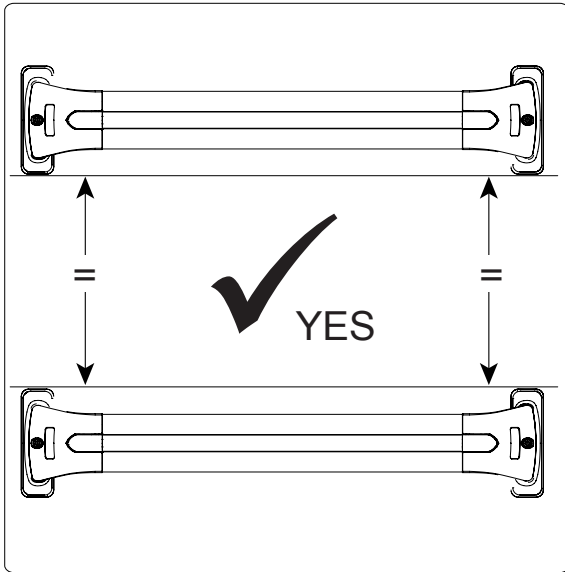

**9** a. Mark a line around all four bases.  
b. Remove and disassemble base from roof rack leg.

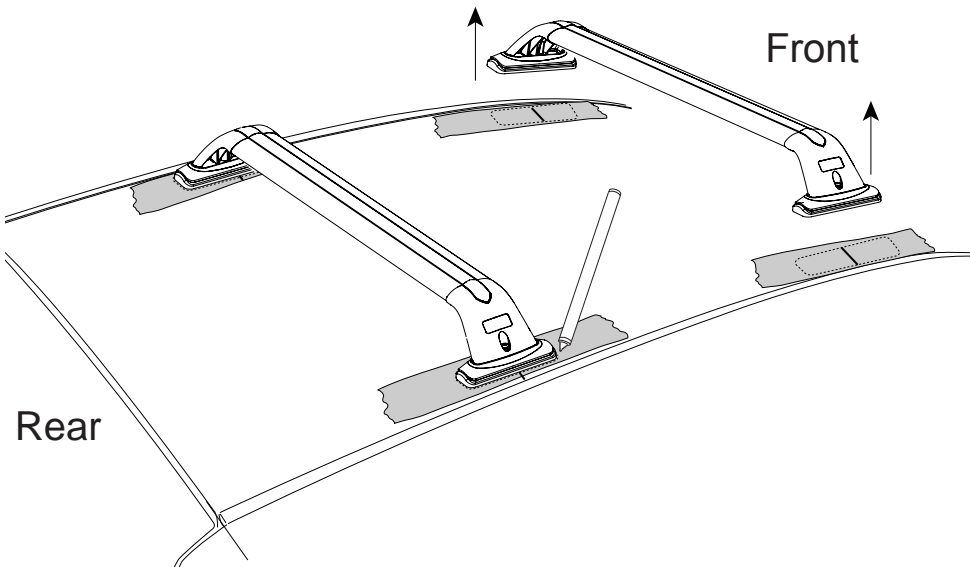

a.

b.

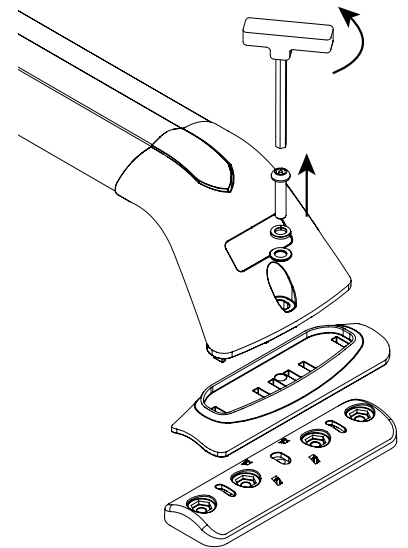

**10** Line up each base on marked lines. Use base pad as a template to mark 4 holes on masking tape for drilling.

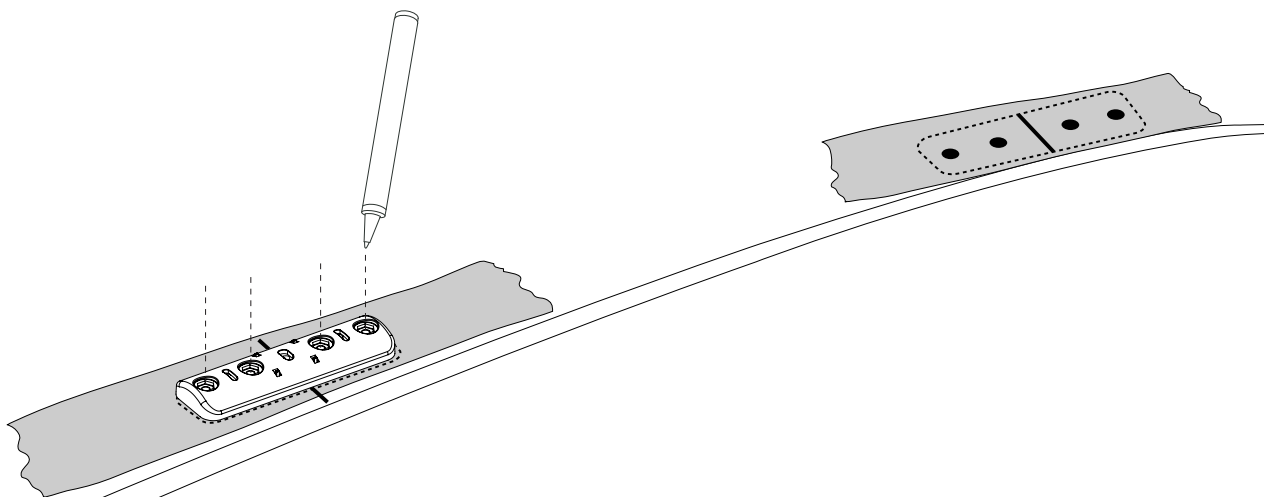

# RSF2 / RSF3 - Rhino Sportz

- 11** It is recommended a drill stop be used to prevent vehicle damage by drilling too deep. Drill through roof panel. Check each hole as you go to make sure the base pad lines up.

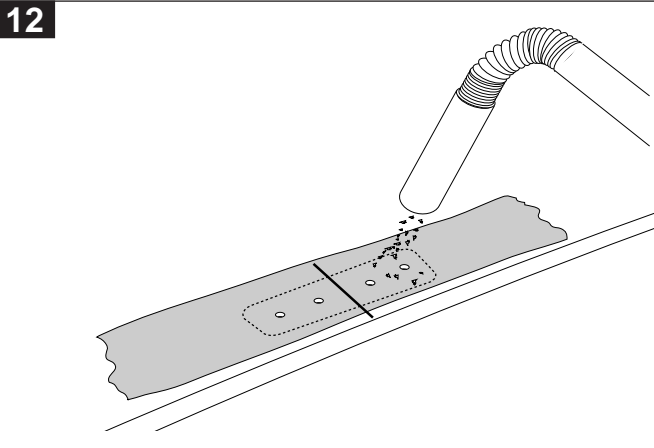
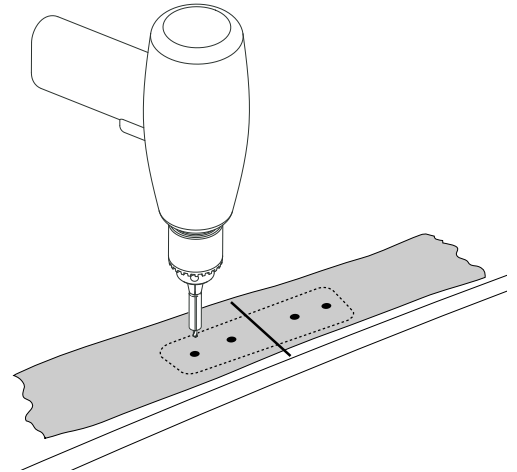
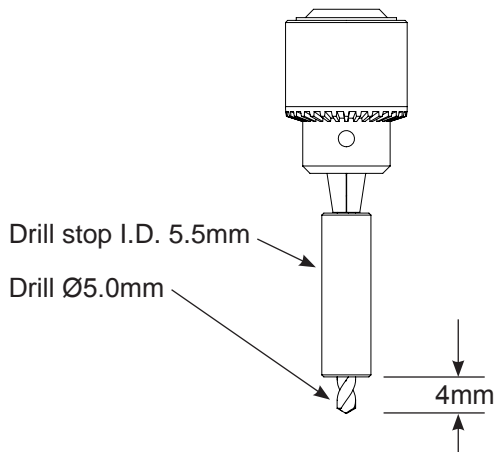

To prevent scratching, use a vacuum cleaner to remove drill swarf.

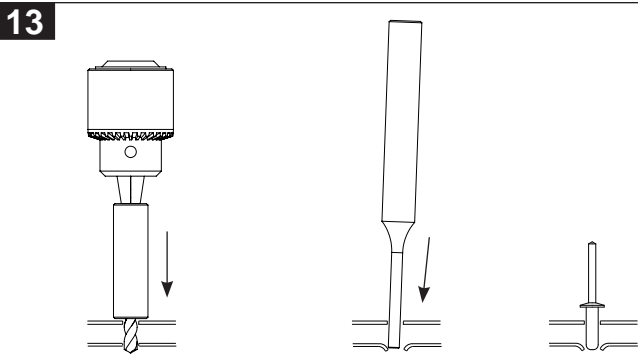

\* Only complete this step if necessary.

If a second skin is encountered, adjust drill stop and drill through second skin. Use a pin punch to peen over the lower hole which allows clearance for rivet.

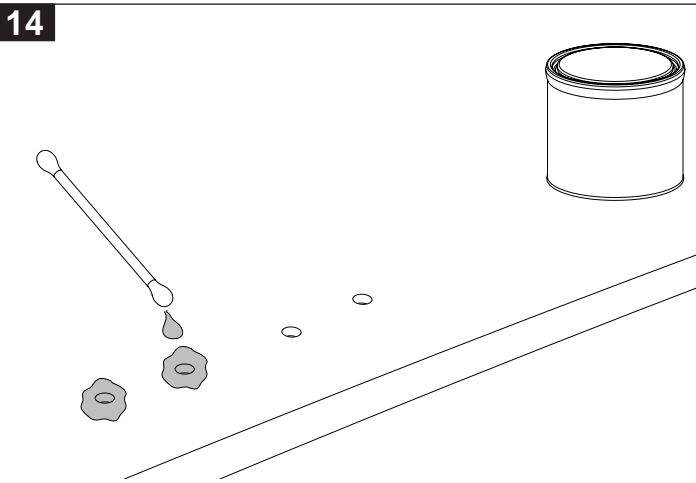

REMOVE masking tape.  
Apply Cold Galvanising solution in and around holes completely covering any bare metal.



# RSF2 / RSF3 - Rhino Sportz

15

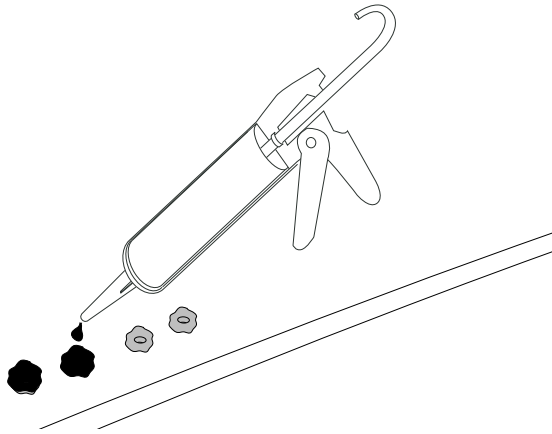

Apply Butyl Mastic non hardening sealer in and around holes.

16

Rivet each pad in place.

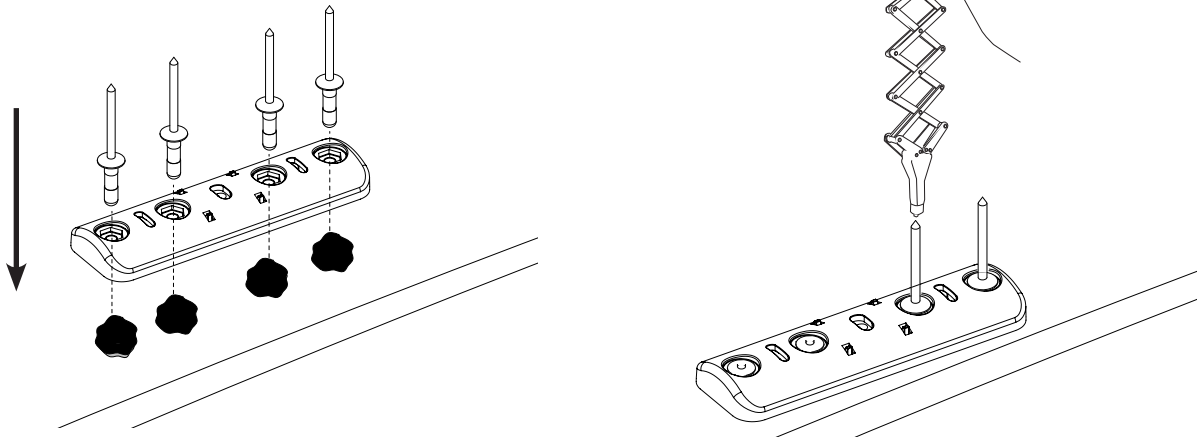

17

Attach crossbars and legs to base pads. Tighten M6 screws 3-4 Nm.

