

RHINO-RACK®

Reconn Platform

Toyota Tacoma Gen 2&3

63100

Important:

1. Check the Rhino-Rack website to ensure you have the latest issue of these instructions.
2. Please refer to your fitting instruction to ensure that the accessory is installed correctly.
3. Check the contents of kit before commencing fitment and report any discrepancies.
4. Place these instructions in the vehicle's glove box after installation is complete.
5. These instructions must be followed for warranty to be upheld.

Fit Time: 90 mins

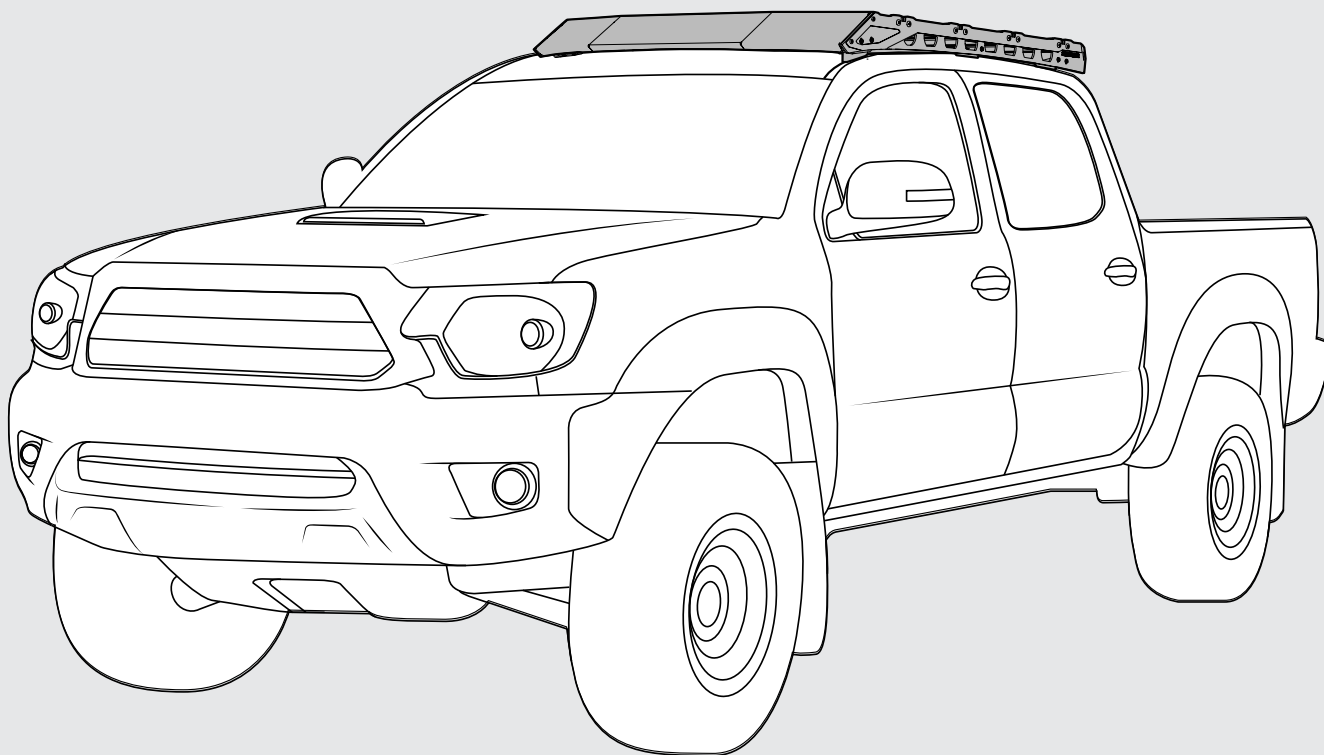

RHINORACK.COM

Document No: 520-RFI-00199

Issue No: 01

Issue Date: 02/10/2024

Toyota Tacoma Gen 2&3

DYNAMIC LOAD LIMIT:

***USE THE VEHICLE MANUFACTURER'S MAXIMUM ROOF ALLOWANCE IF IT IS LOWER THAN THE FIGURE LISTED**



CARGO

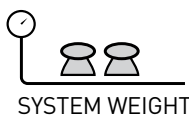

SYSTEM WEIGHT

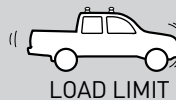

LOAD LIMIT

OR



Max
kg

UP TO **129KG**
284lbs

+ **21KG**
47lbs

=

UP TO **150 KG**
331 lbs

***VEHICLE
MANUFACTURER'S
ROOF LOAD LIMIT**



STATIC LOAD LIMIT: UP TO 250KG / 551LBS*

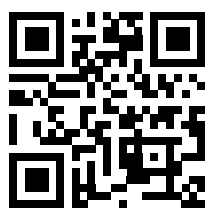

VISIT THE ONLINE
CALCULATOR FOR
CURRENT SYSTEM
LOAD LIMIT DATA

VEHICLE HEIGHT ADDED (mm/in)

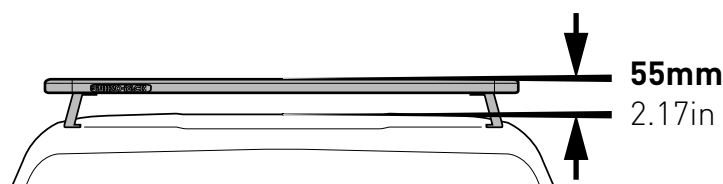

55mm
2.17in

Exercise extreme care when transporting wind-resistant loads. Special consideration must be taken when cornering and braking.

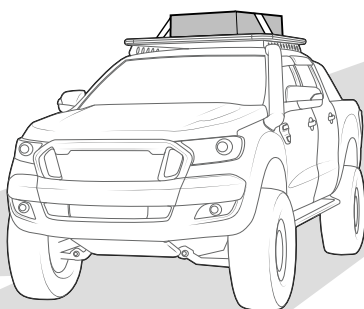

Off-road conditions can be much more rigorous. Extreme care must be taken on any driven path that does not contain a surface protection layer (tar/bitumen).

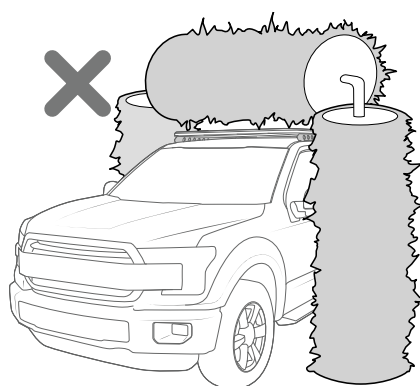

Racks must be removed when vehicle is put through an automatic car wash.



Ensure Ladder is well supported on the ground to support tent. Take extreme caution when climbing heights above 1.2m/4ft.



Do NOT obstruct windscreen camera sensors

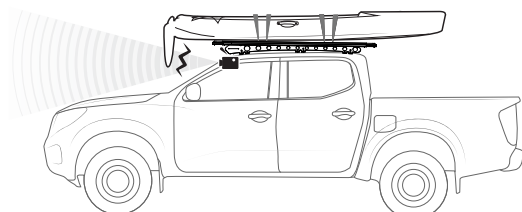

Warranty for roof rack system will be void if the front of the kayak is not secured to the bonnet

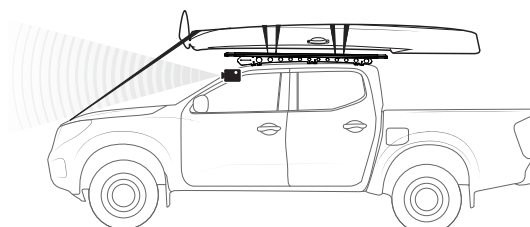

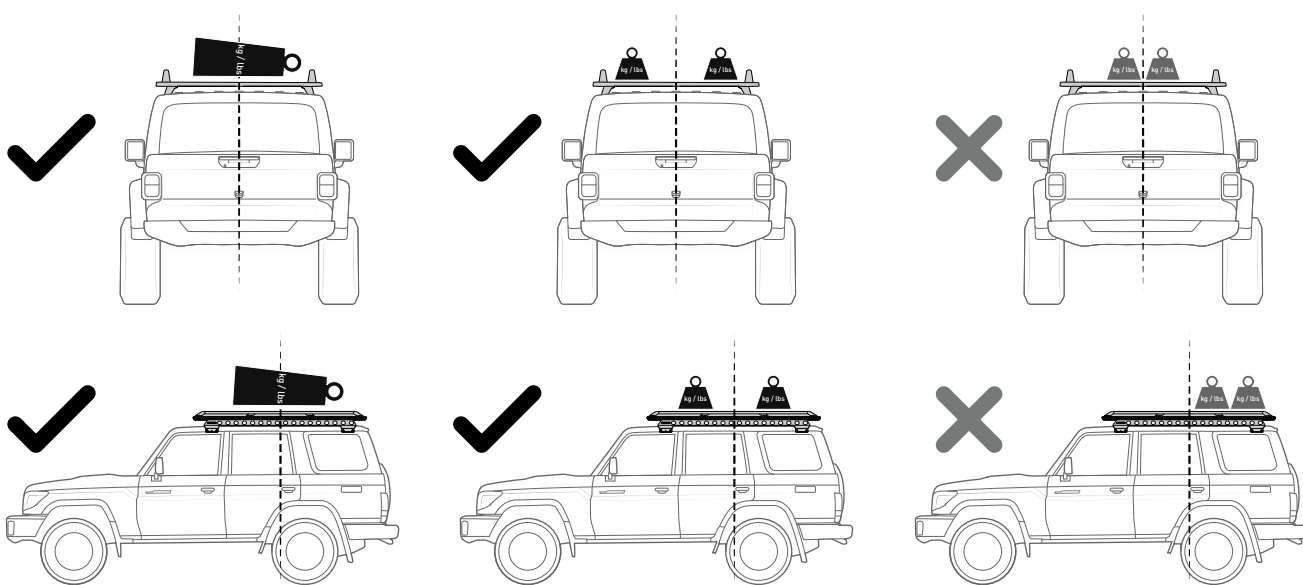

Distribute loads evenly and laterally/longitudinally as low as possible over the span.

Avoid point loads concentrated at the front or rear.

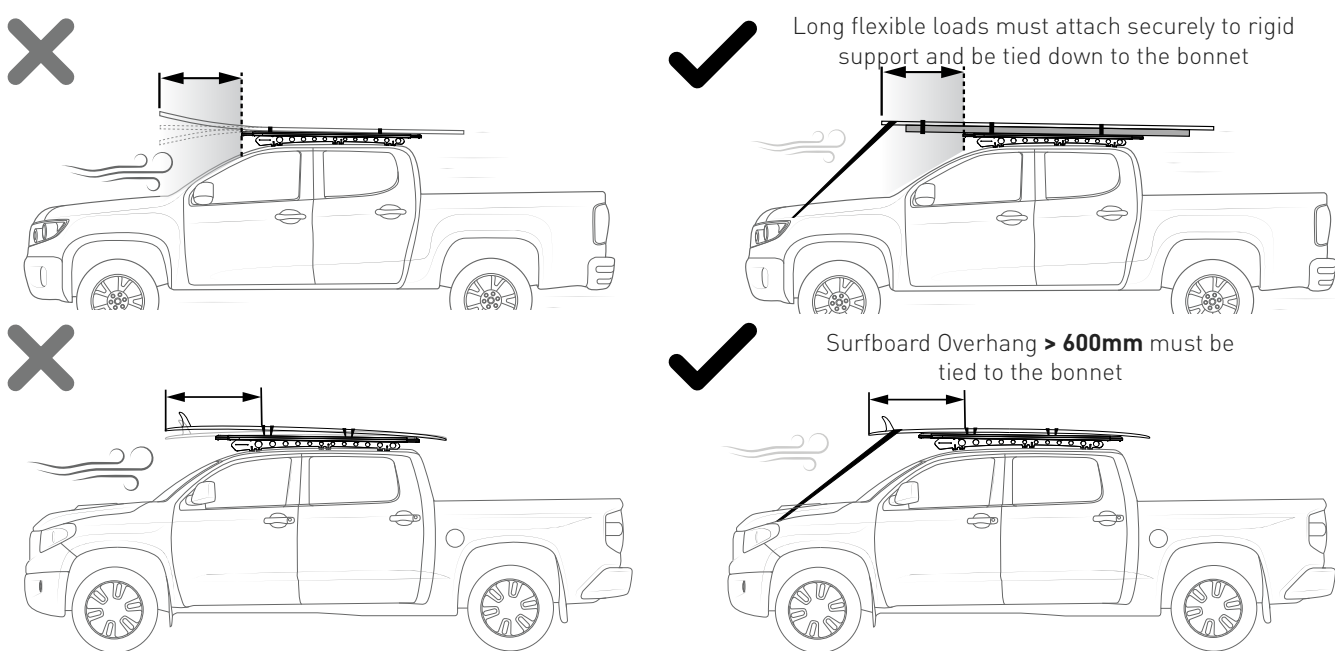

Long flexible loads must attach securely to rigid support and be tied down to the bonnet

Surfboard Overhang > 600mm must be tied to the bonnet

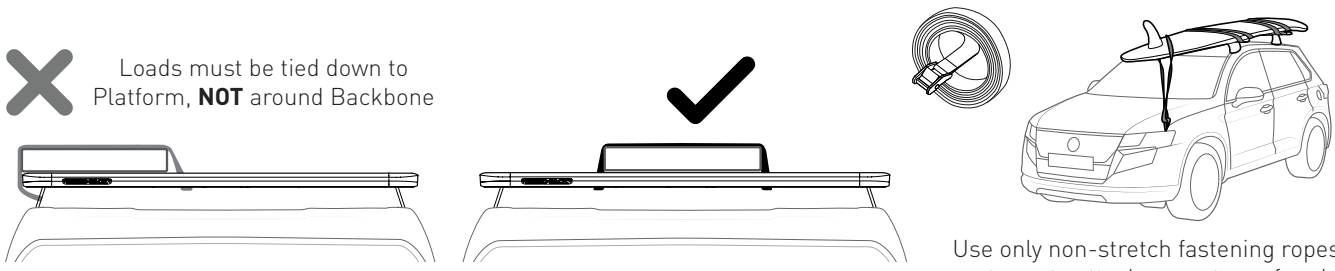

Loads must be tied down to Platform, **NOT** around Backbone

Use only non-stretch fastening ropes or straps to attach cargo to roof racks

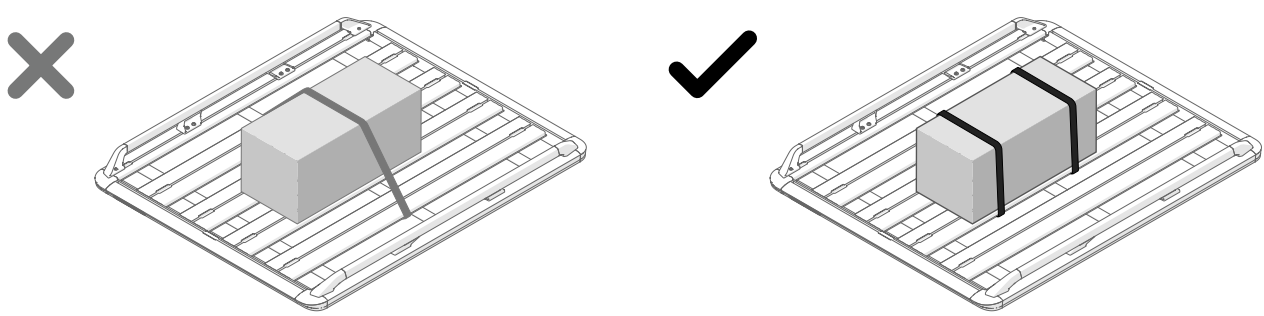



Ensure sunroof will not collide with roof rack system.

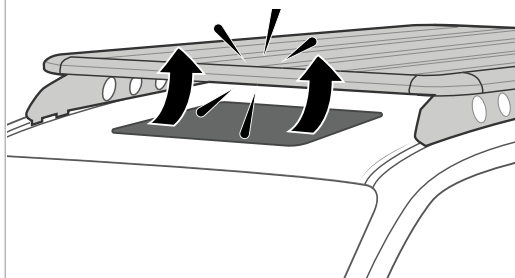

Find another copy of the instruction manual here



Youtube.com/Rhinorackaustralia

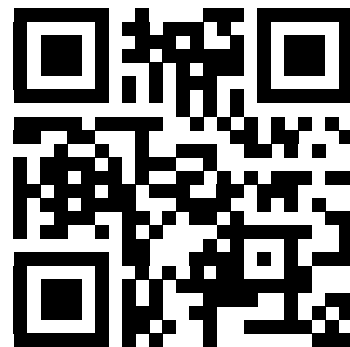

In service maintenance checks

- All bolts should be checked after driving a short distance when you first install your roof racks to ensure none have loosened.
- All bolted connections should be checked again at regular intervals (weekly is recommended, depending on road conditions, usage, loads and distances travelled).
- All bolted connections should be checked each time they are re-fitted.
- Off-road conditions are more rigorous. Check all bolted connections and your load more regularly.
- Ensure that your total vehicle manufacturer's GVM (gross vehicle mass) and gross axle weights are not exceeded (refer to vehicle owner's manual).

Note for Dealers and Fitters

It is your responsibility to ensure these fitting instructions are given to the end user or client. These instructions remain the property of Rhino-Rack Australia Pty. Ltd. and may not be changed or used for any other purpose than intended.

Torque Settings

Throughout this instruction manual, an impact driver can be used to speed up installation. However, it is important to ensure that the final turns are completed with a torque wrench to achieve the required torque rating.

Take caution when using an impact driver, as excessive torque can result in stripped threads.

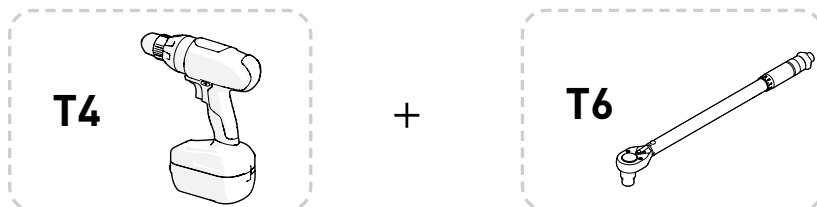

Torque Settings:

Unless stated otherwise in these instructions, all fasteners should be set to the following torque settings:

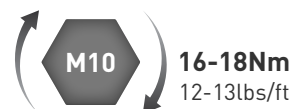

What you should have

To complete this build/ fit you will need.

RECONN SYSTEM COMPONENTS

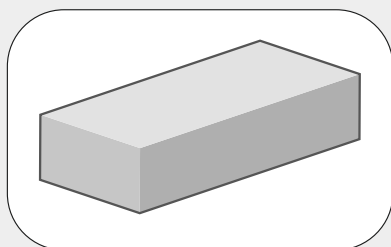

63100

x1

+

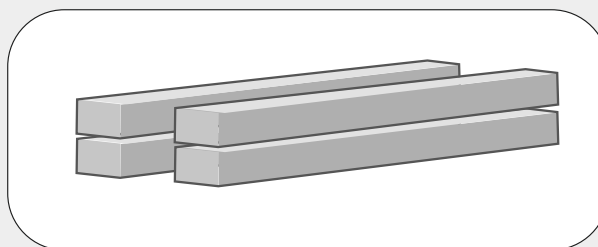

RDB120P

x4

Parts List

<div>Blade - Left Side</div> <div>Blade - Right Side</div> <div>A x1</div> <div>B x1</div>	<div>Fairing Weldment</div> <div>C x1</div>	<div>Spacer Block</div> <div>D x6</div>
<div>Trim Plate</div> <div>E x2</div>	<div>Front Leg</div> <div>F x2</div>	<div>Middle Leg</div> <div>G x2</div>
<div>Stiffening Plate</div> <div>H x2</div>	<div>Rear Leg</div> <div>I x2</div>	<div>M8 x 16 Flat Washer</div> <div>J x10</div>
<div>M8 x 40 Torx Socket Trilobular Screw</div> <div>K x16</div>	<div>M6 x 16 Hex Head Flanged Bolt with T30</div> <div>L x2</div>	<div>M6 x 50 Hex Head Flanged Bolt with T30</div> <div>M x10</div>
<div>M6 X 19 Sealing Washer</div> <div>N x12</div>	<div>M8 X 20 Torx Socket T30</div> <div>O x10</div>	<div>M6 X 16 Torx Socket T30</div> <div>P x4</div>
<div>Butyl Patches</div> <div>Q x12</div>	<div>T30 x 100mm Torx Drive 1.4 hex driver</div> <div>R x1</div>	
<div>Instructions</div> <div>S x1</div>	<div>Reconn Deck Bar</div> <div>RDB120P x4</div>	<div>Tools Required:</div> <div>T1 - Tape Measure</div> <div>T2 - Cutting Tool</div> <div>T3 - Marker/Pen</div> <div>T4 - Impact Driver</div> <div>T5 - Cleaning Rag</div> <div>T6 - Torque Wrench (13mm Socket)</div>

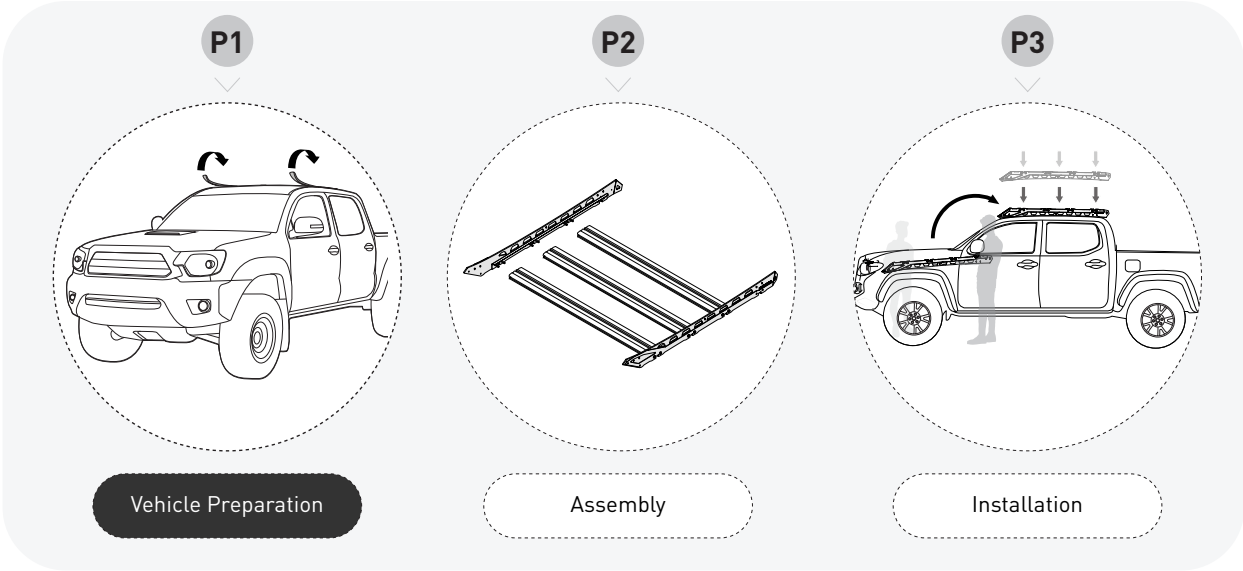

P1

1 Measure and mark the ditch trim from the front (**measurements stated in the table**)

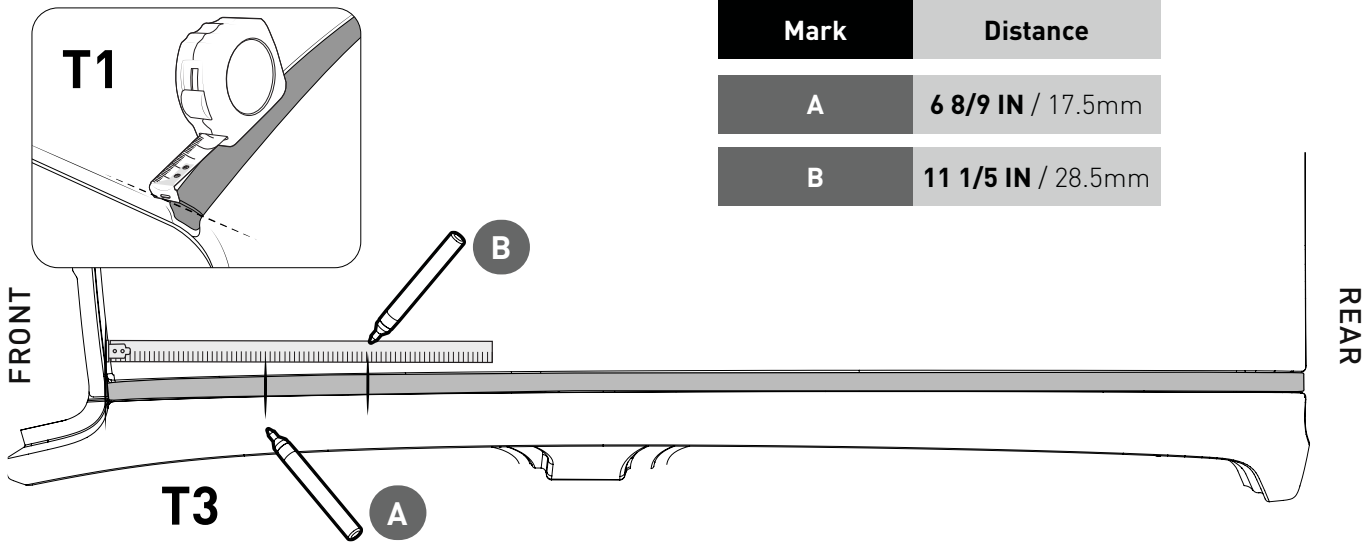

2 Measure and mark the ditch trim from the Rear (**measurements stated in the table**).

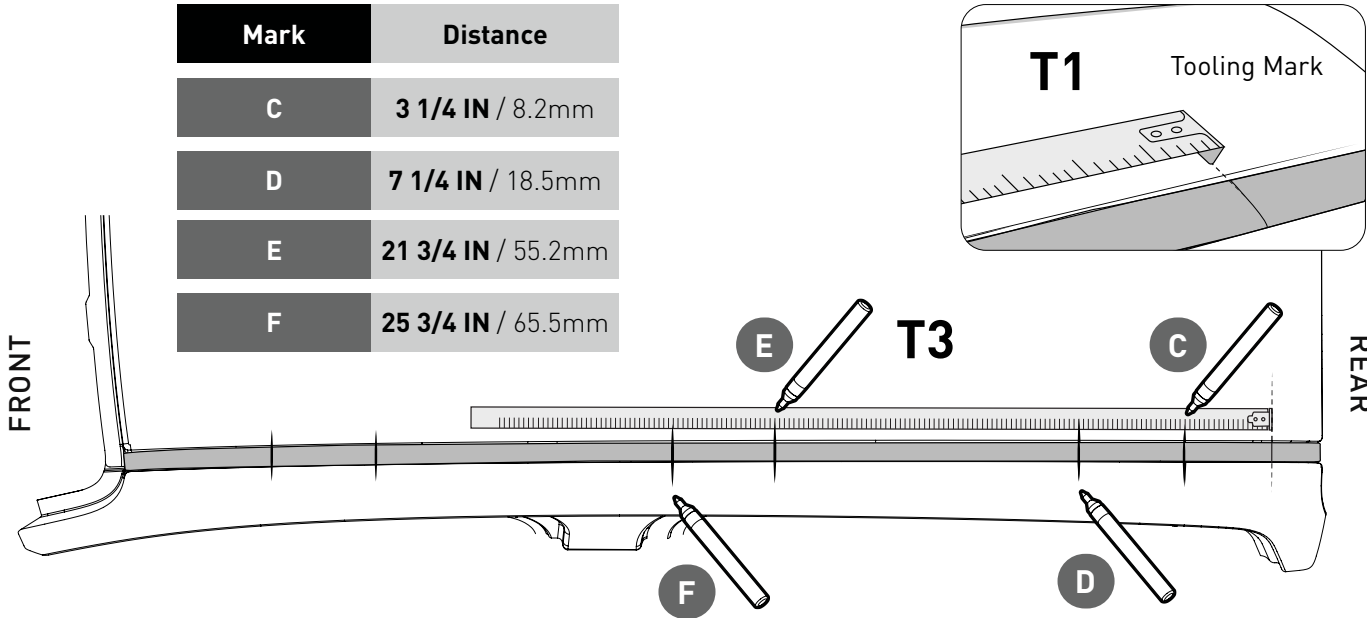

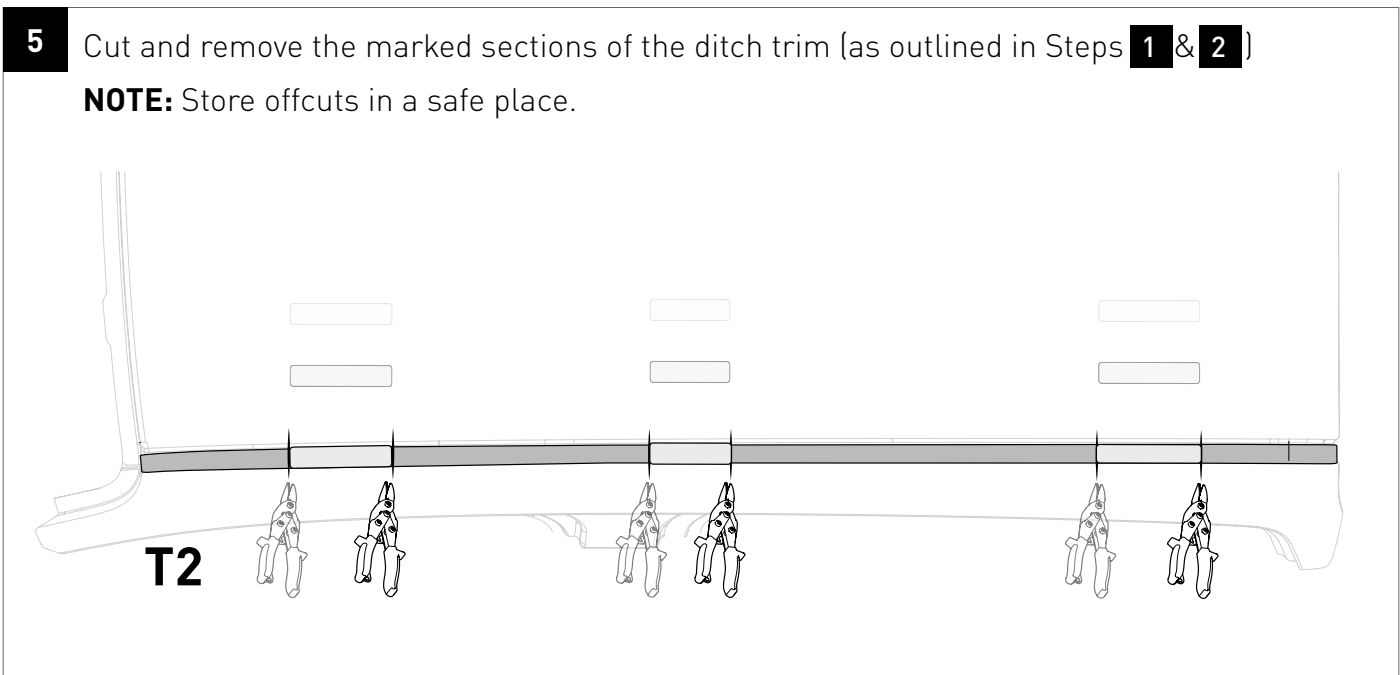
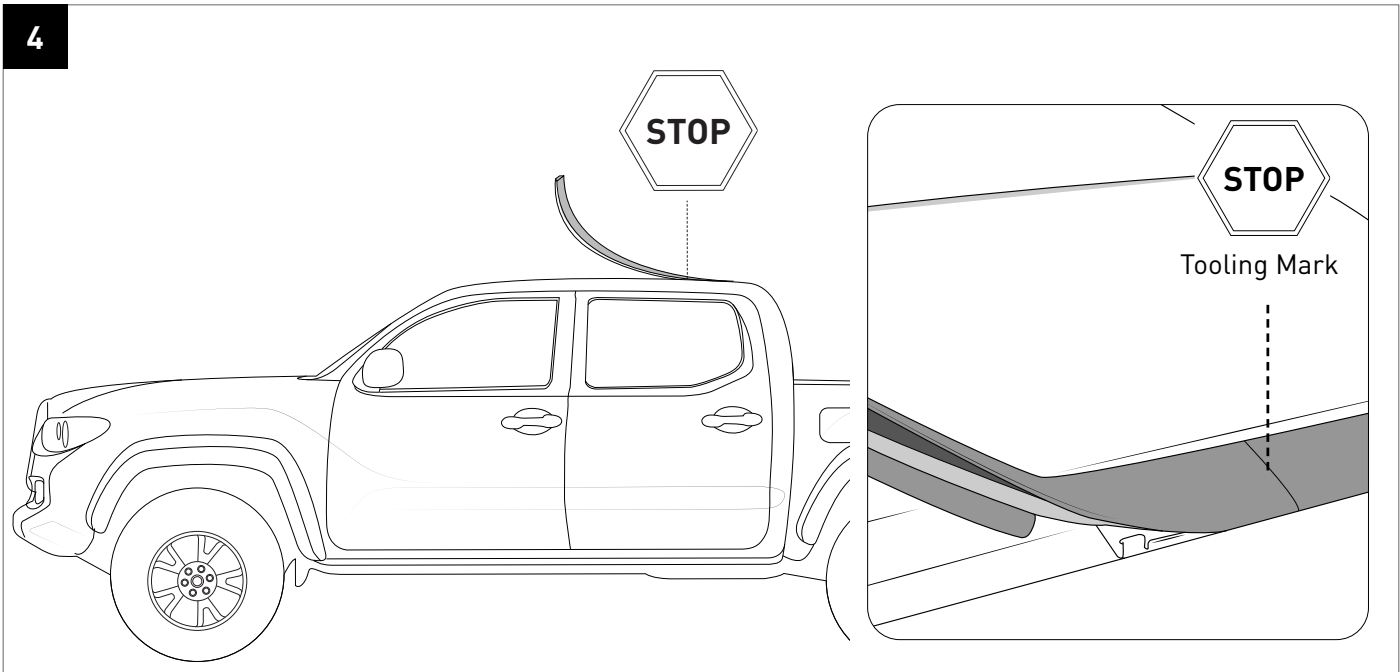
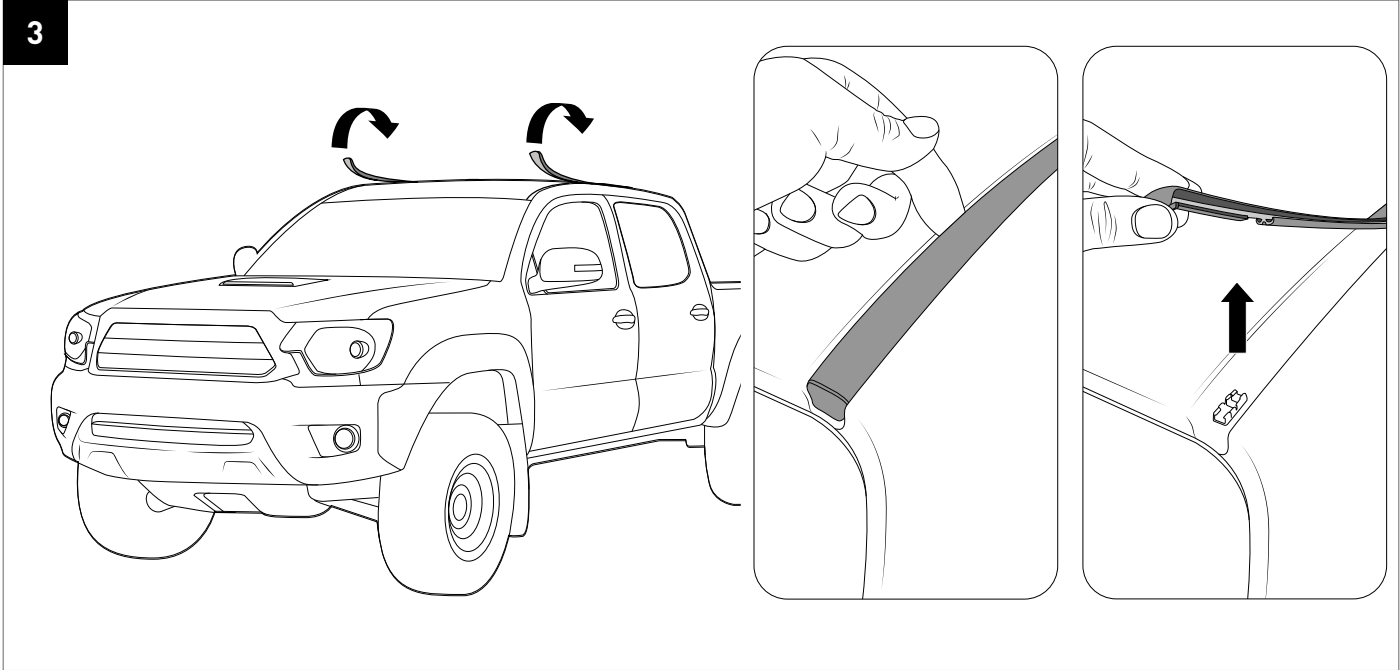

- 6** Remove tape found underneath ditch trim.

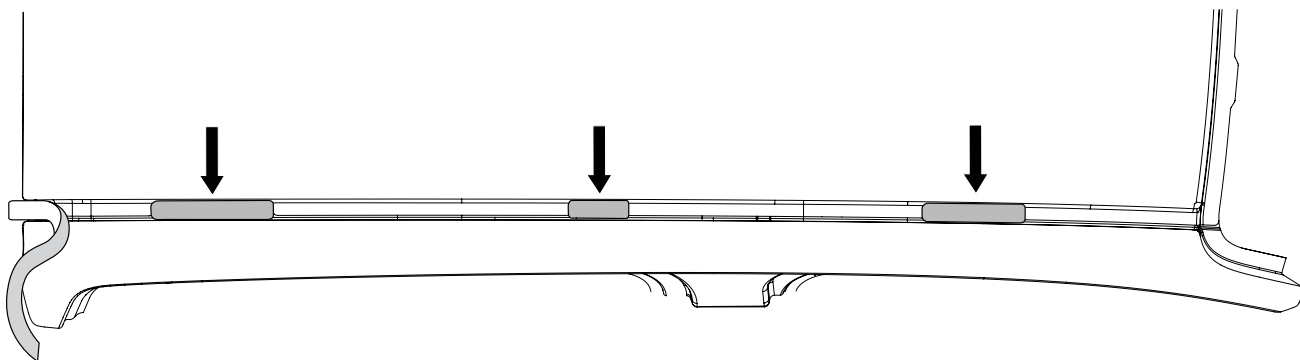

7

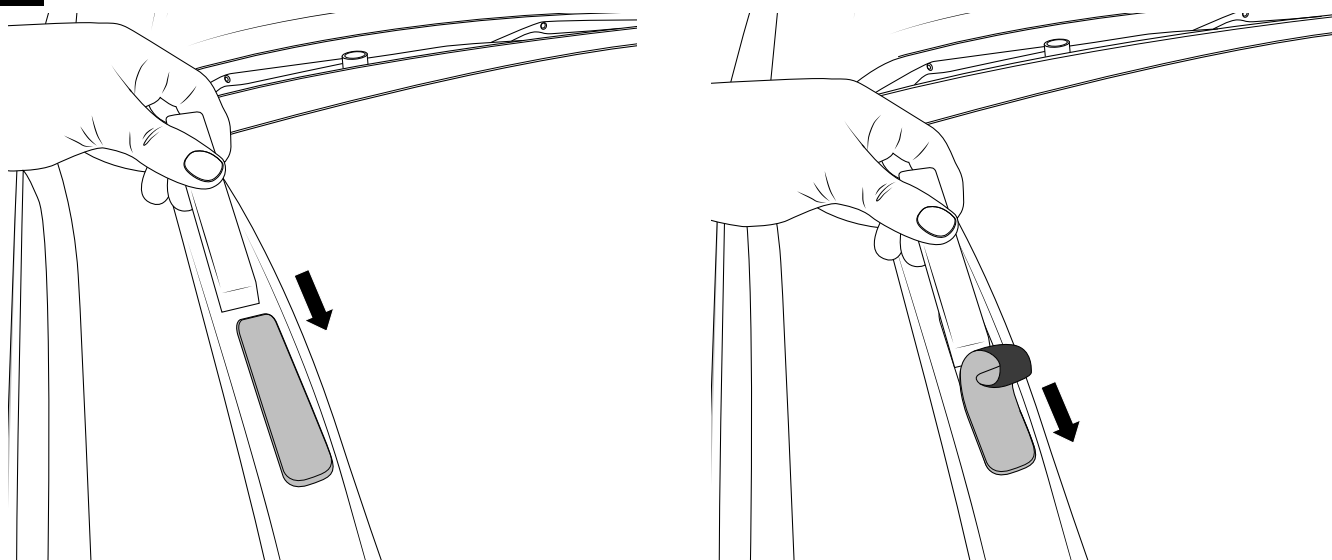

- 8** Clean surface to prepare for the next step.

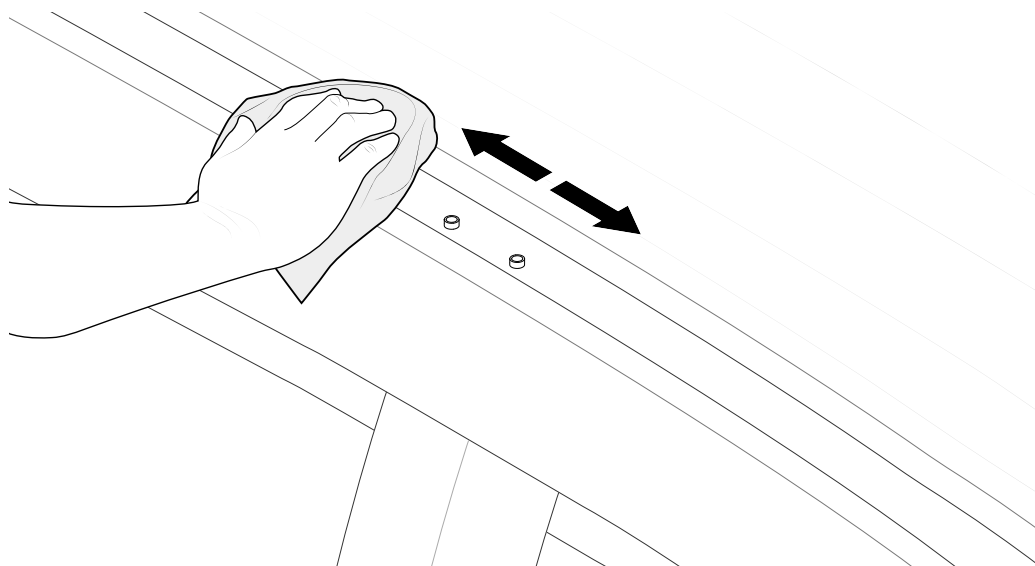

T5



- 9** Stick butyl patches co-centric to the 5 holes located in the ditch of the vehicle.

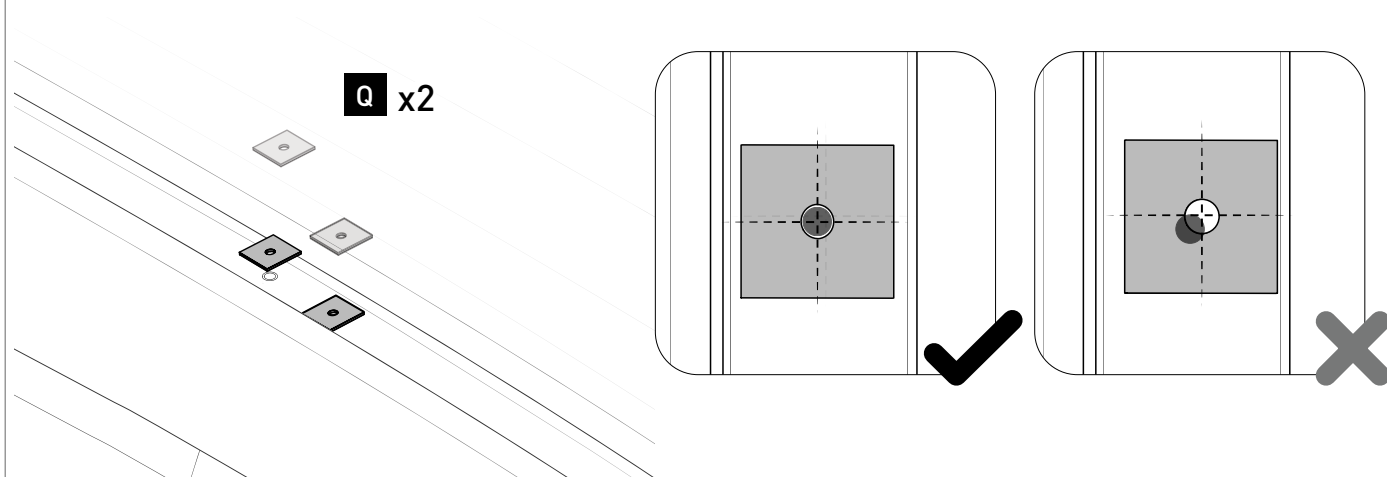

- 10** Ensure all fixture points are covered with a butyl patch (Q).

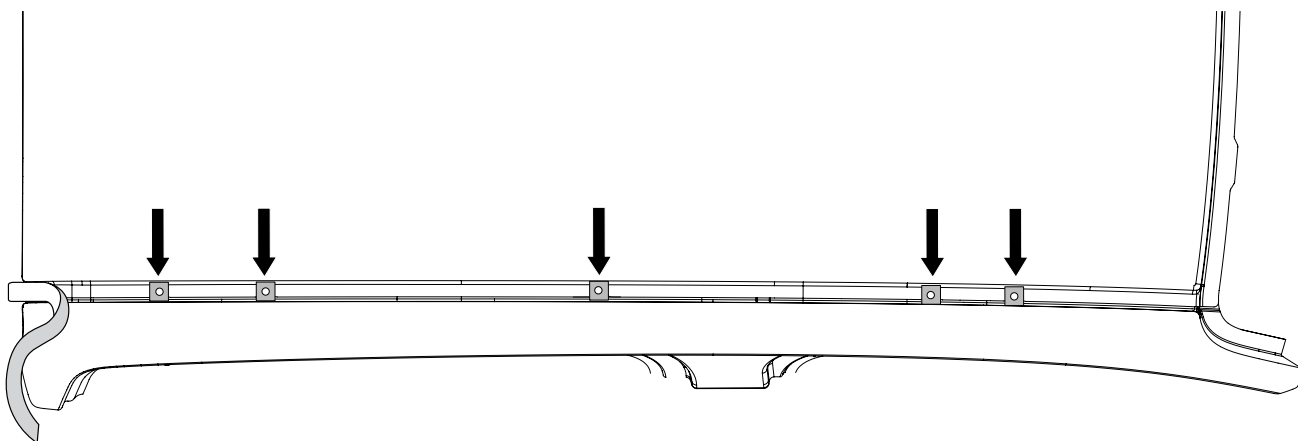

- 11**

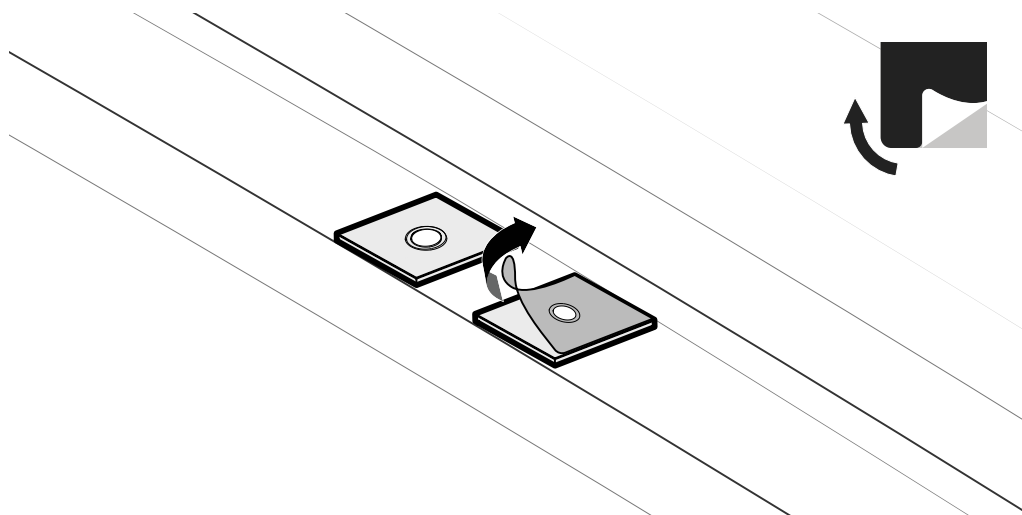

- 12** Attach spacer blocks on top of the butyl patches at the front, middle and rear.

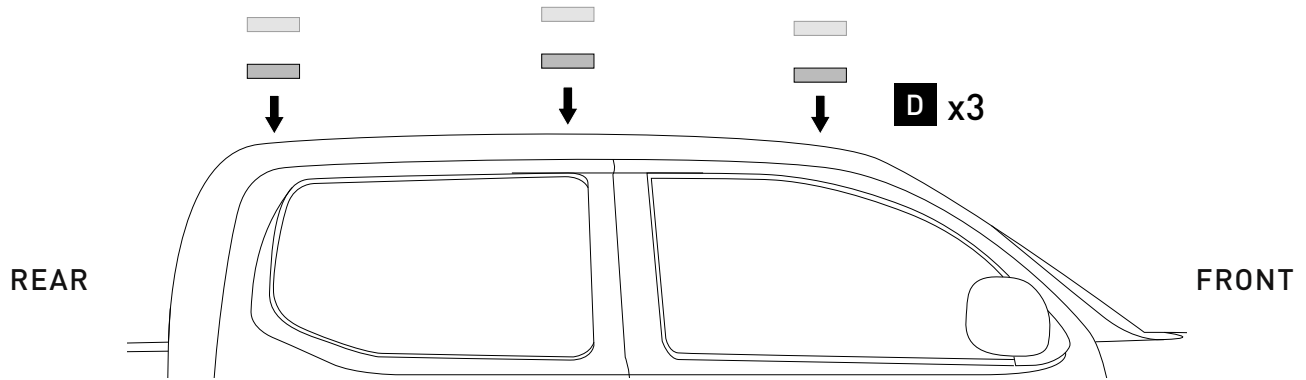

13



Indent on spacer block **D** should always face the front of the vehicle.

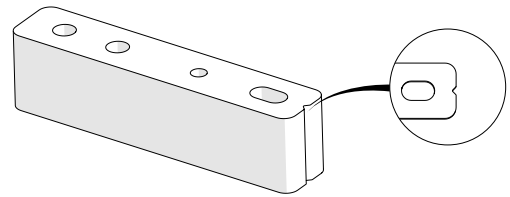

Front placement:

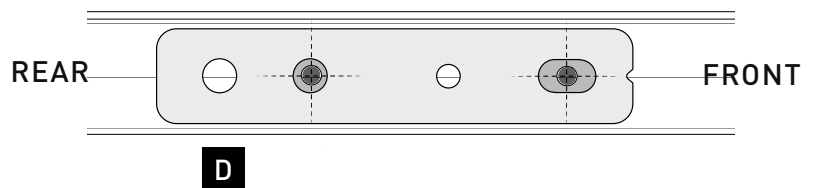

Middle placement:

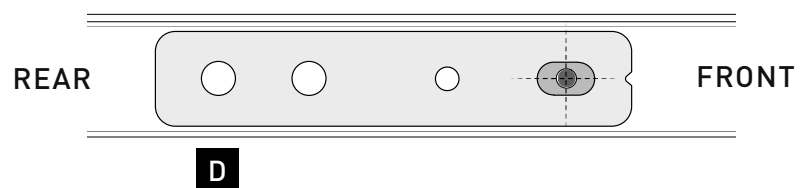

Rear placement:

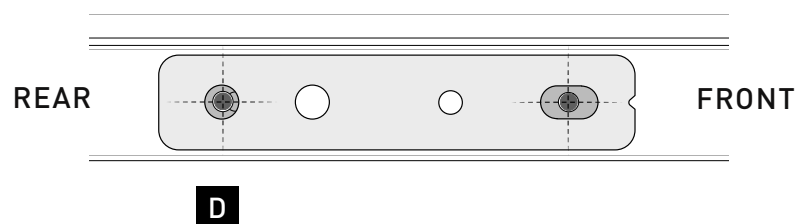

14

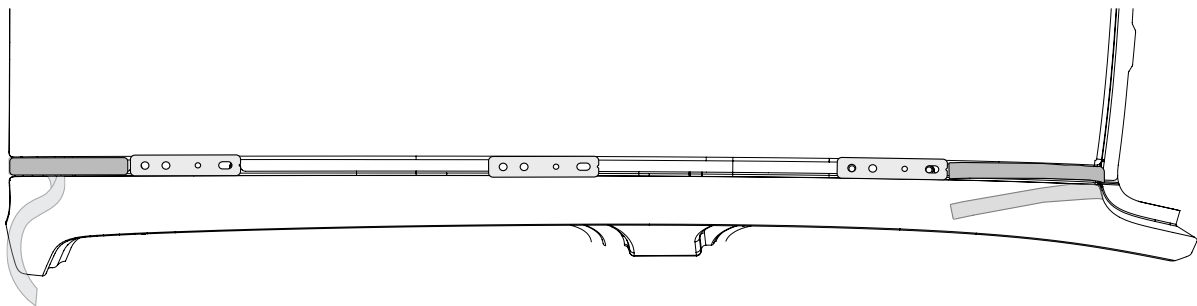

15

NOTE

Internal trim parts can be reinstalled based on preference. Additional 3M tape may be required for reinstallation.

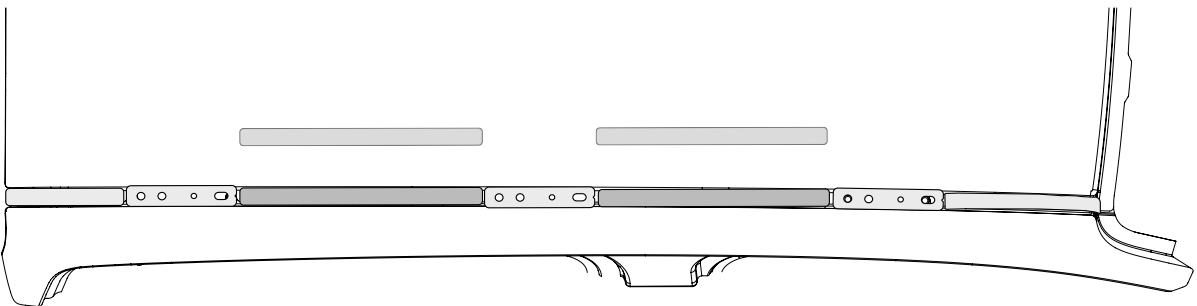

16

Repeat steps 1 to 15 on the right side of the vehicle.

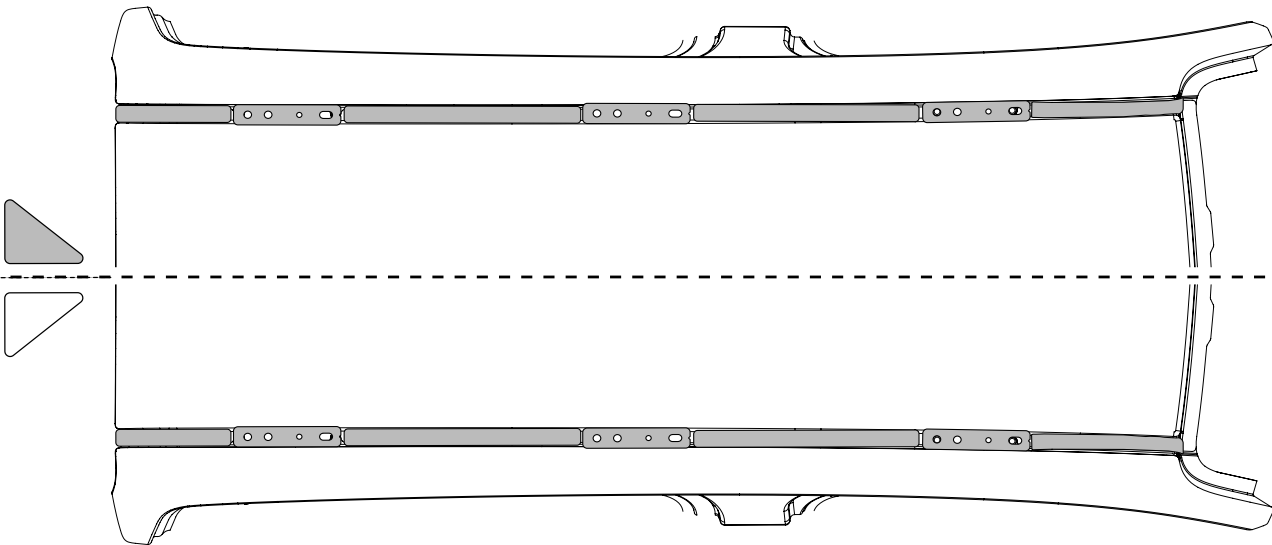

Vehicle Preparation Complete.

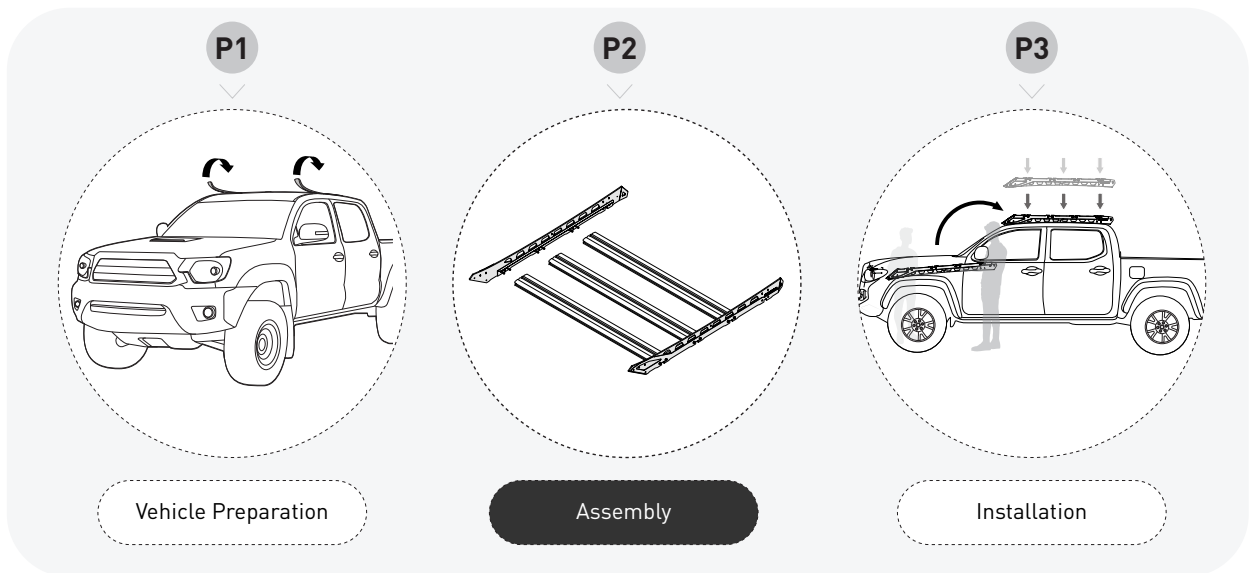

P2

NOTE

The rear ends angle inward toward the center of the vehicle, indicating the left and right blades.

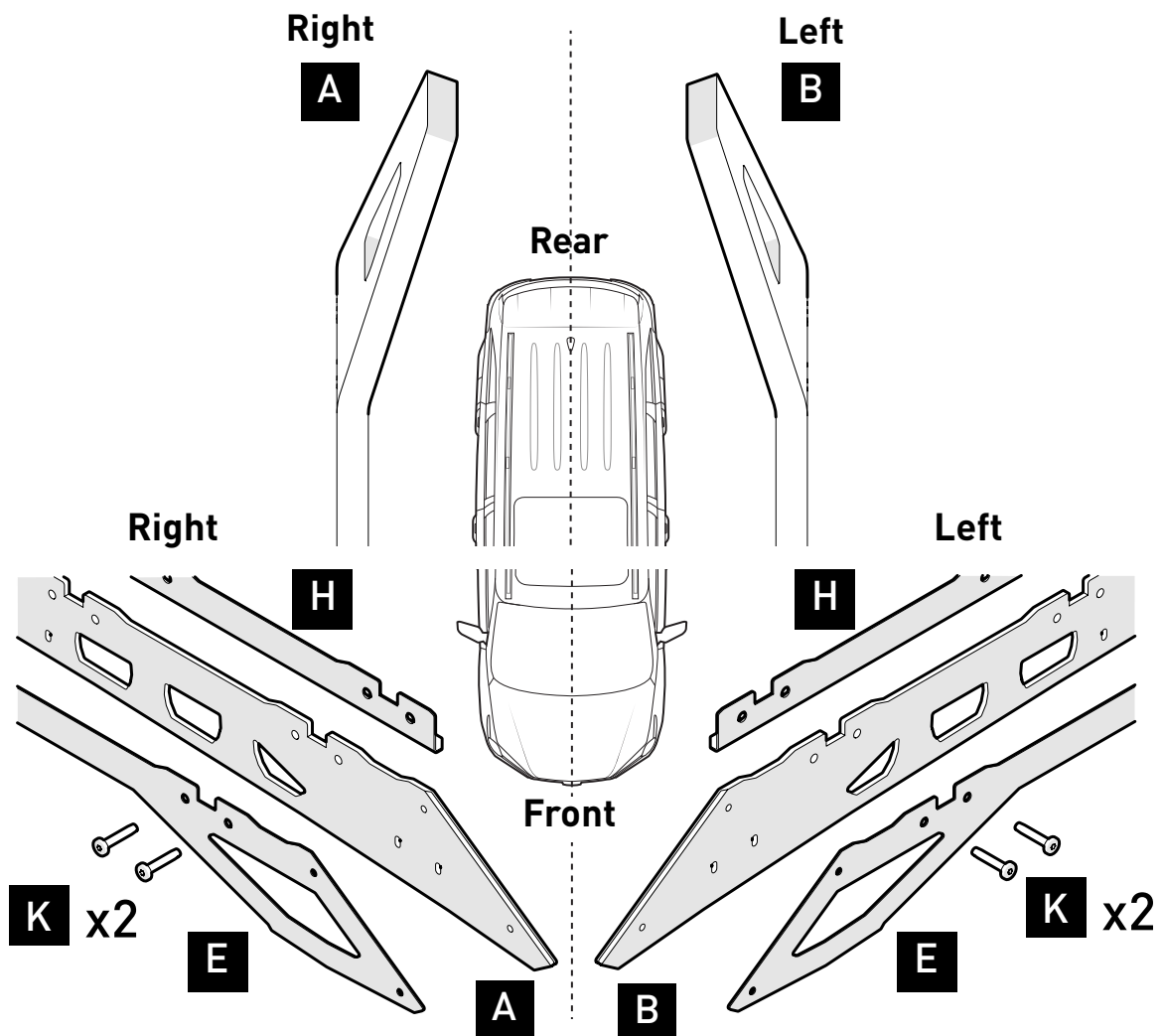

- 17** Loosely assemble **2x bolts** at each of the **3 indicated locations** on **left side blade**.

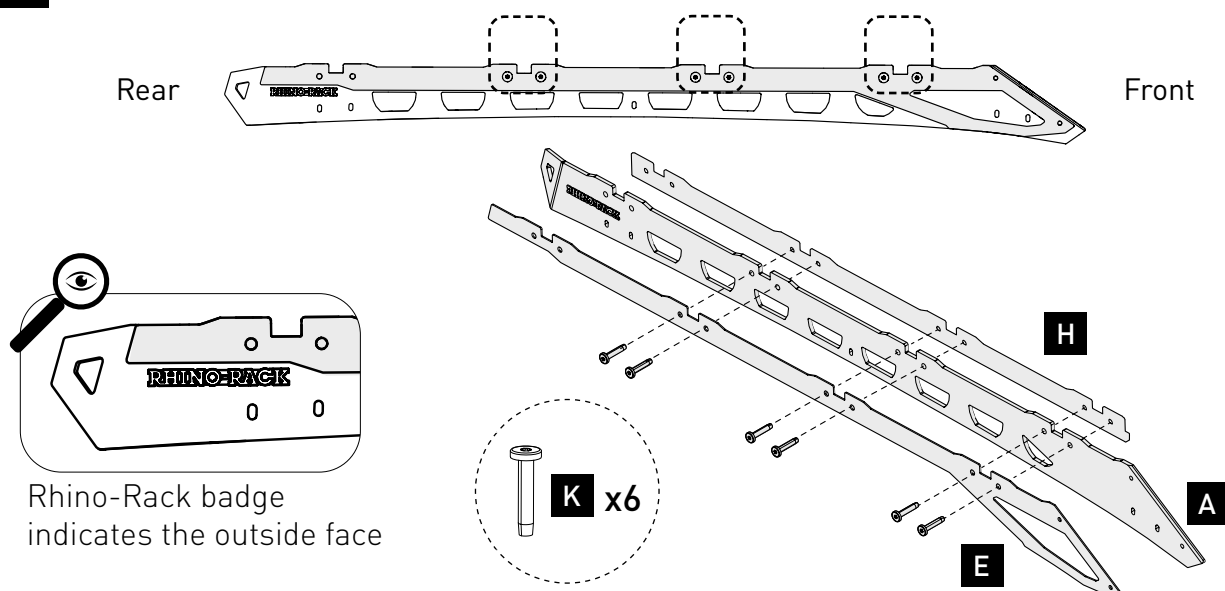

- 18** Loosely assemble **2x bolts** at each of the **3 indicated locations** on **right side blade**.

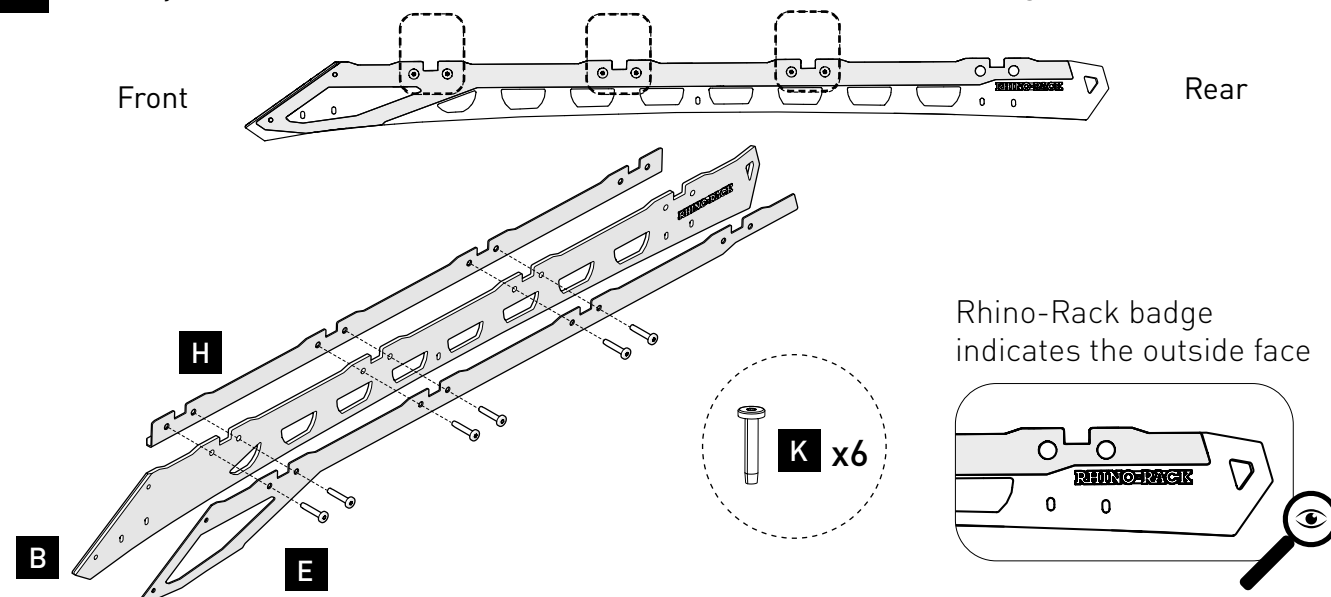

- 19** Ensure that **H** is positioned correctly on both left & right blades.

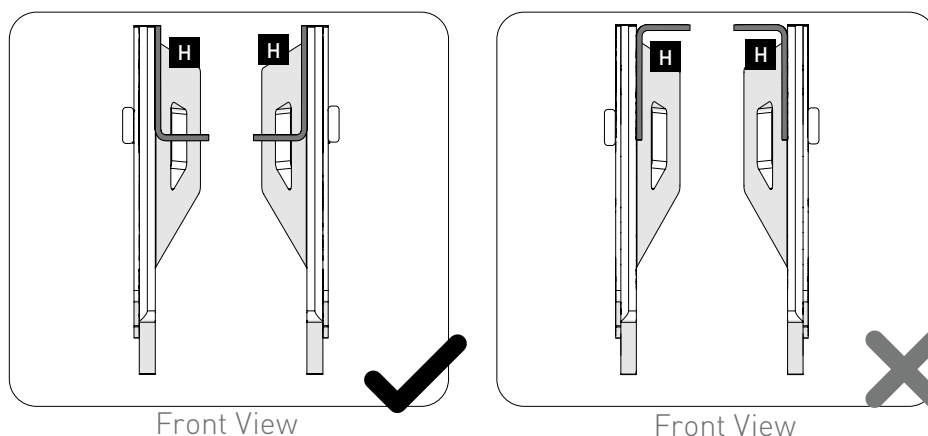

20 Flip blade assemblies.

NOTE

Upside-down Rhino-Rack badge indicates the correct orientation

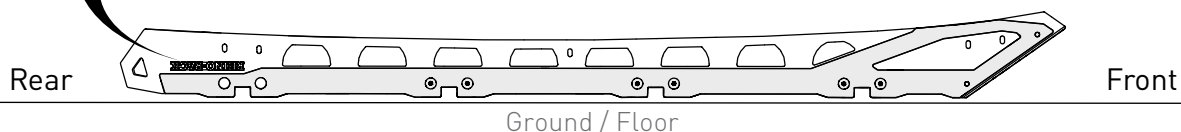
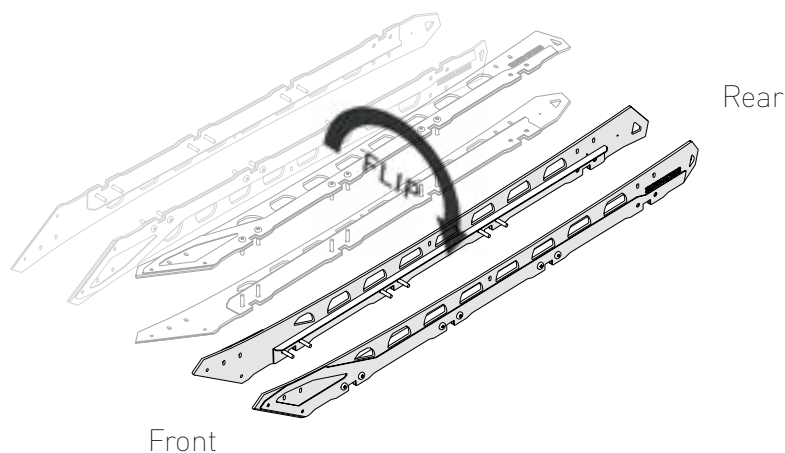
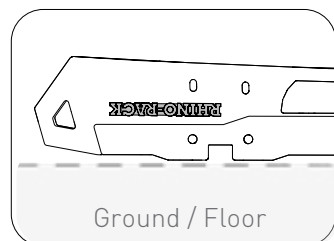

21 For easier handling, use **K** screws pre-tap **3x RDB120P** bars at both ends.

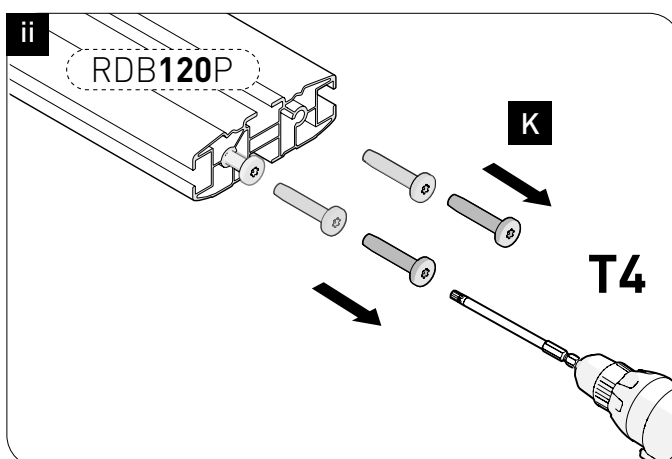
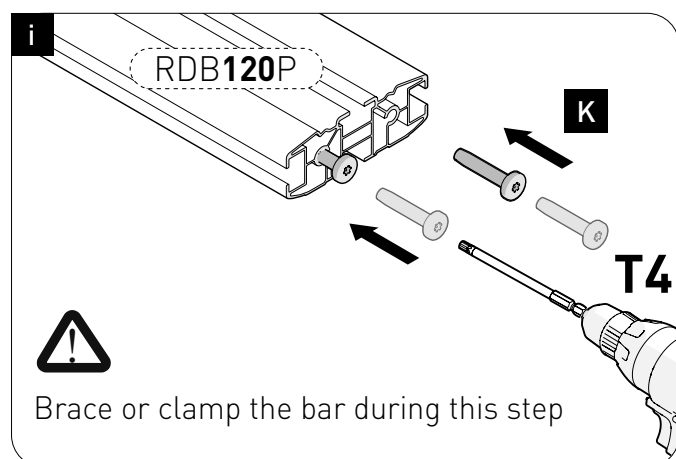

22 Screw **3x RDB120P** bars to right hand blade assembly.

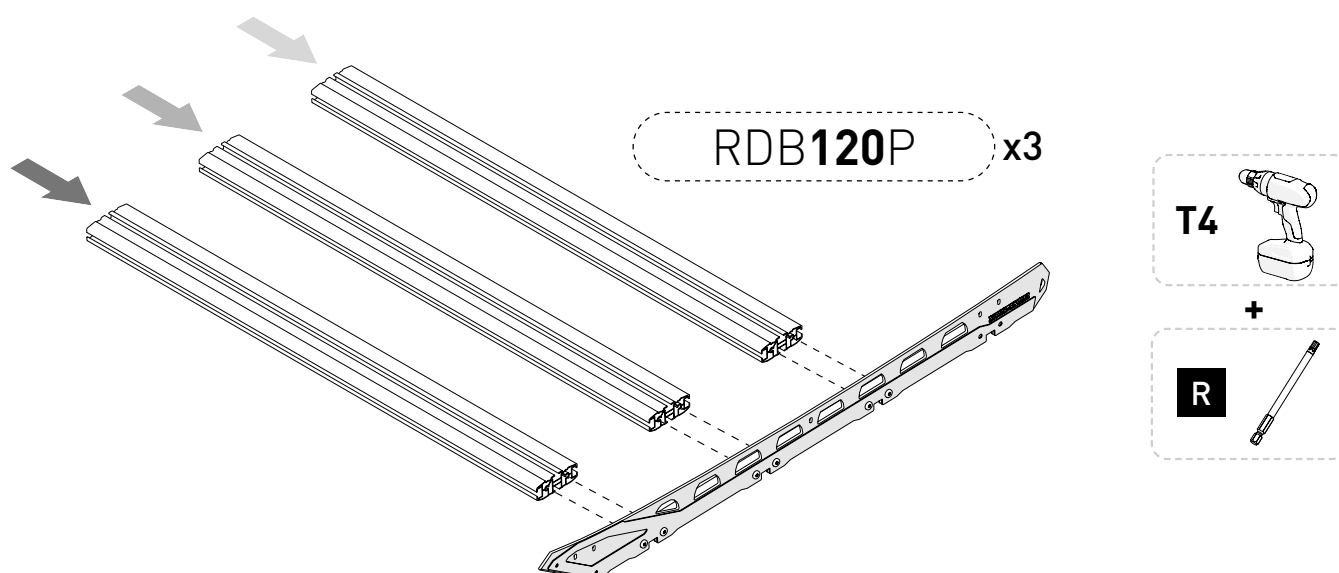

23

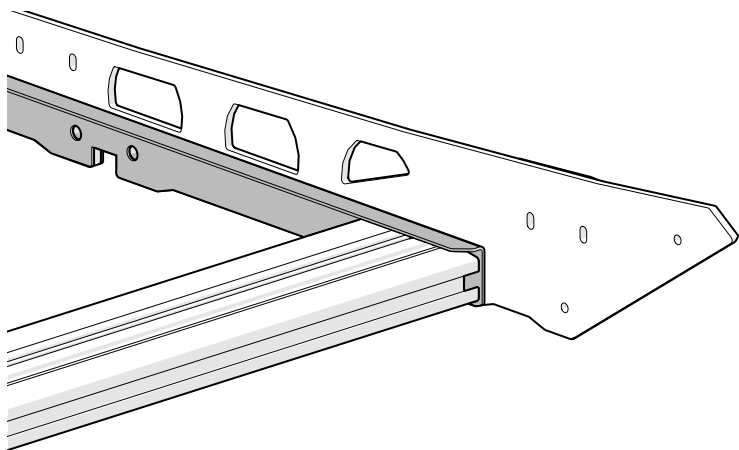

NOTE

Ensure **RDB120P** Bars sit under **H**

24

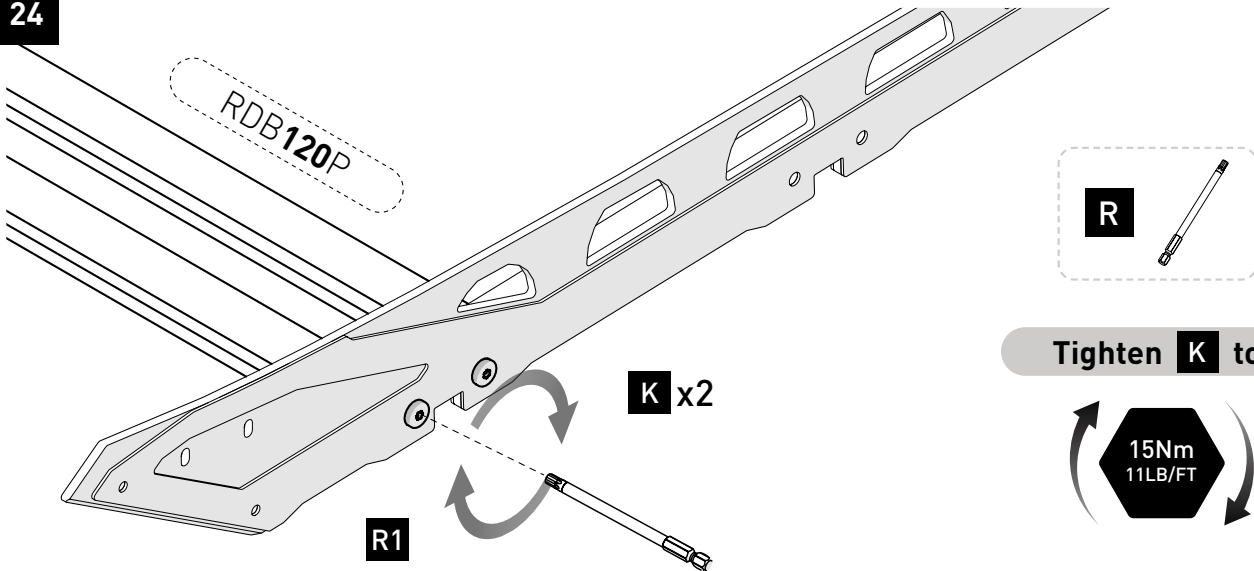

25

Repeat steps **22** to **23** on left hand blade assembly.

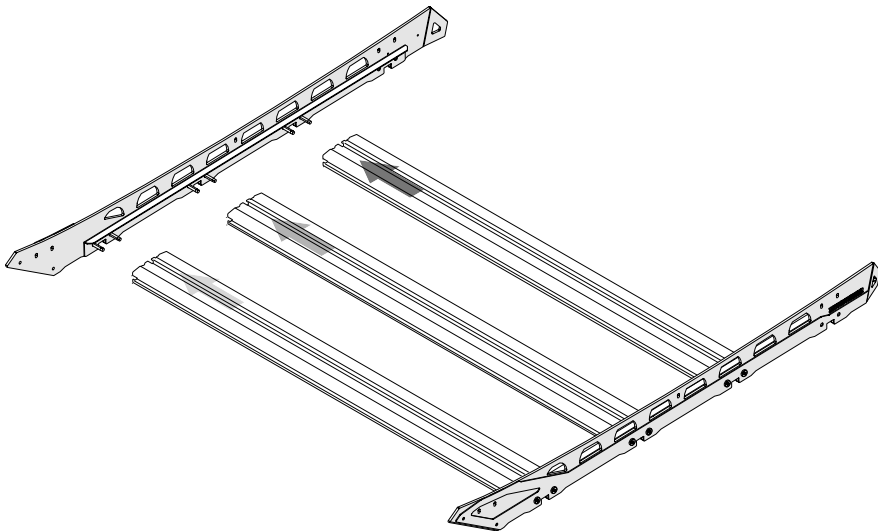

26

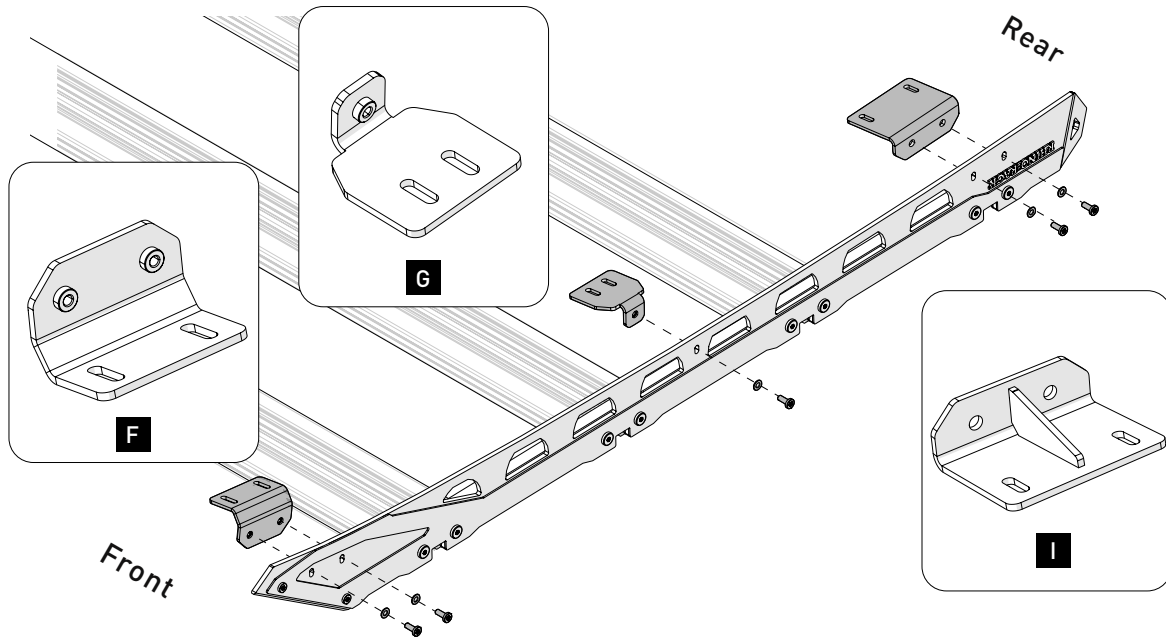

27

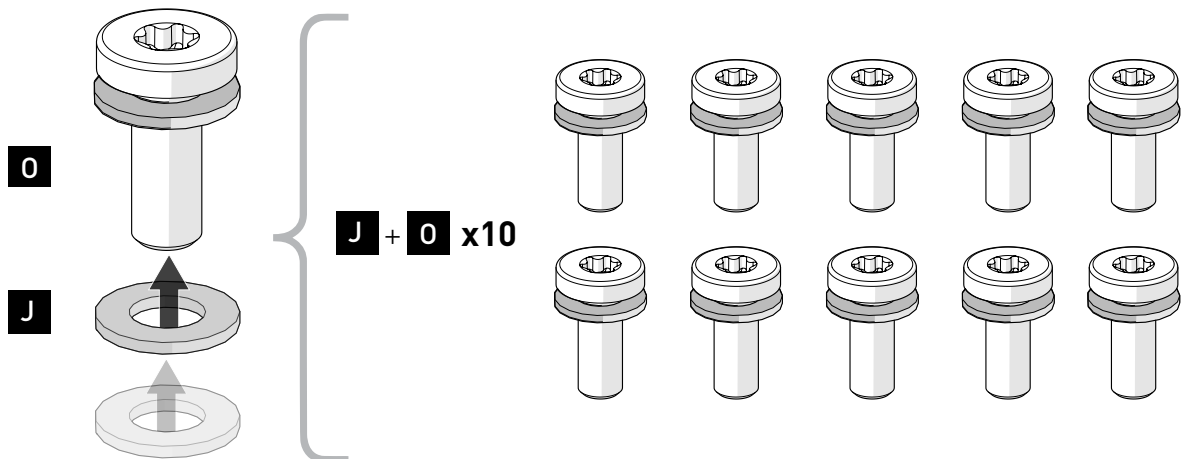

28

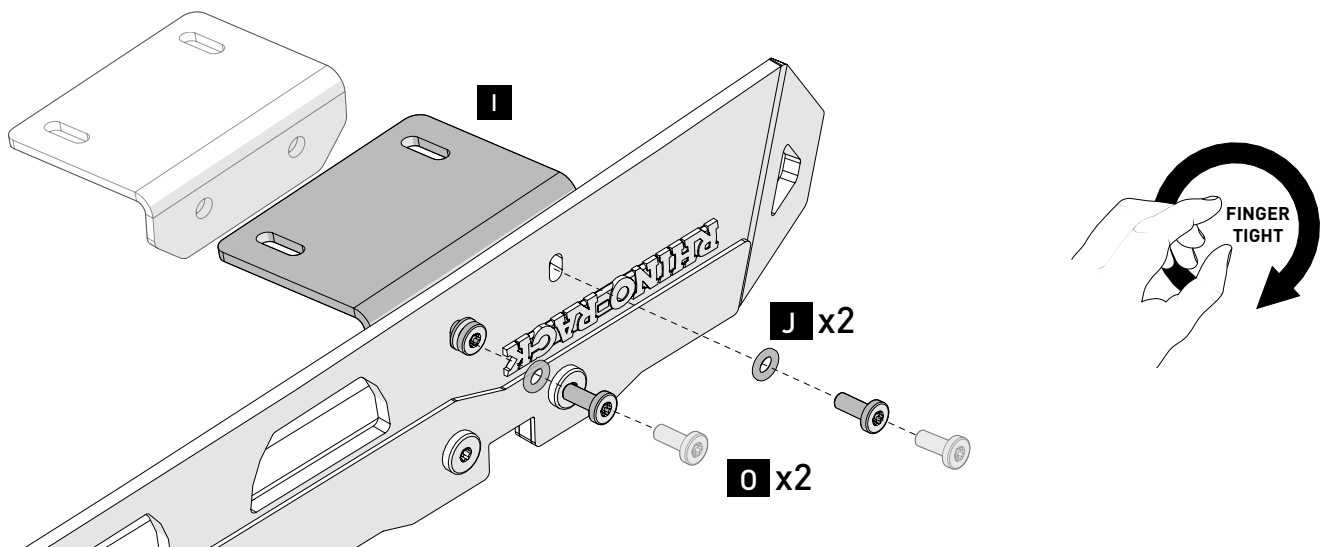

29

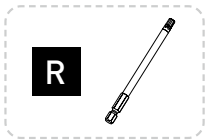
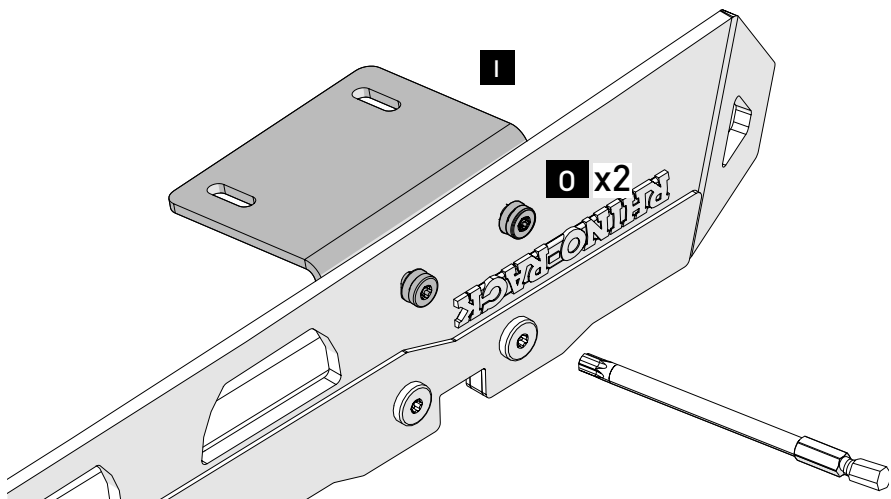

Tighten **O** to



30

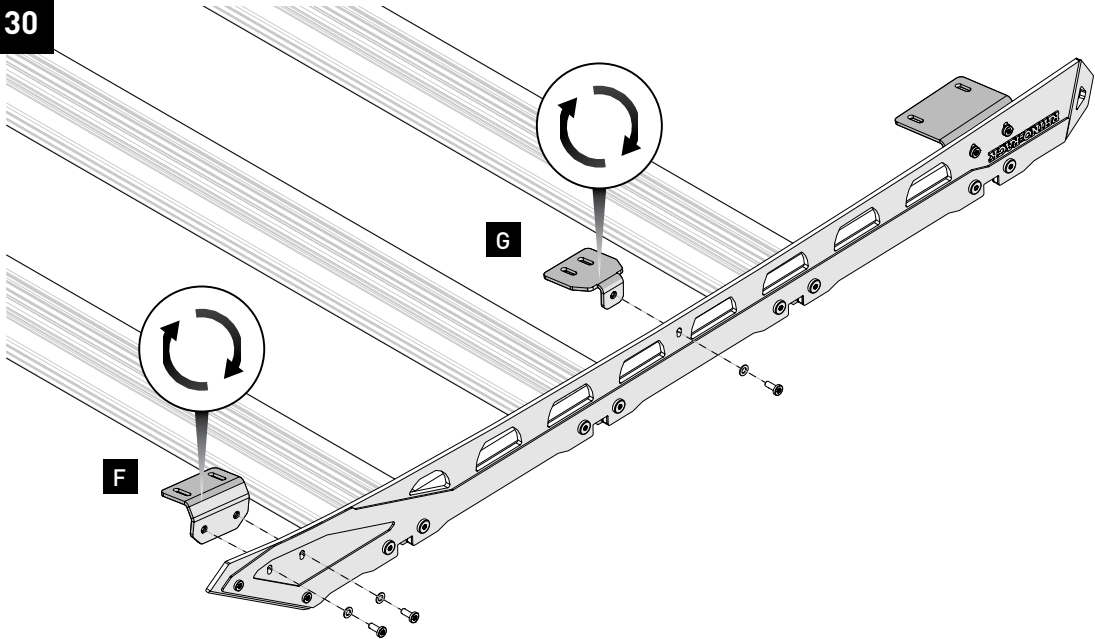

31

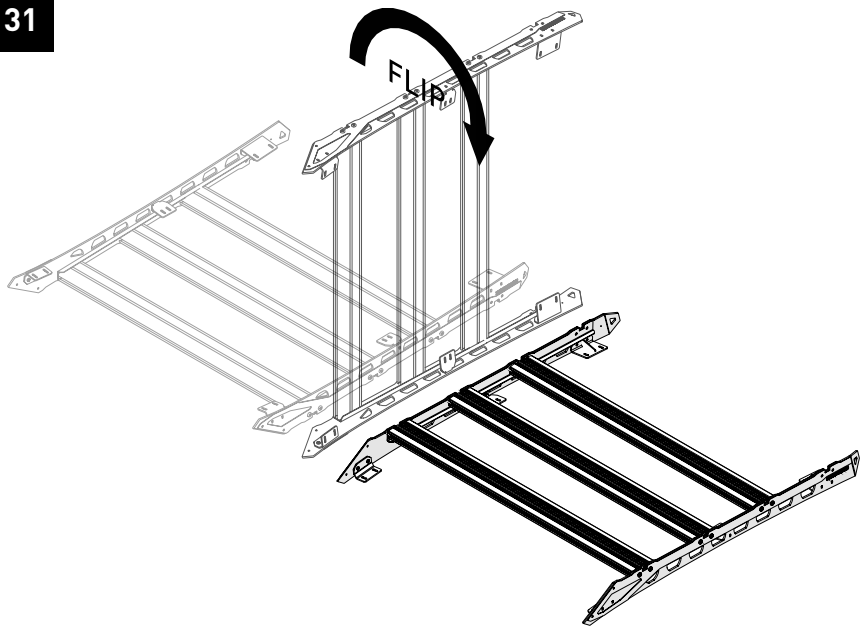

NOTE

Upright Rhino-Rack badge indicates the correct orientation.

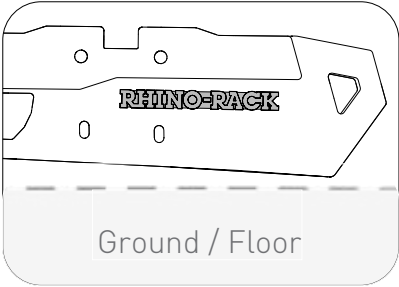

Assembly Complete.



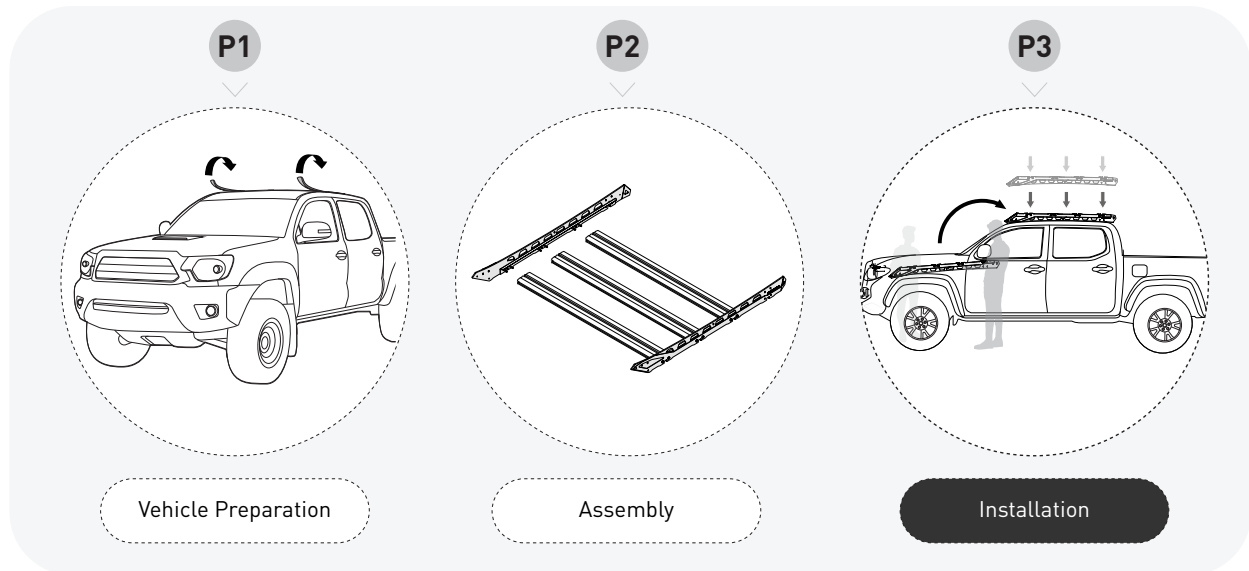

P3

32 Lift Recon platform onto vehicle, carefully placing feet on **Spacer Blocks** (**D**).

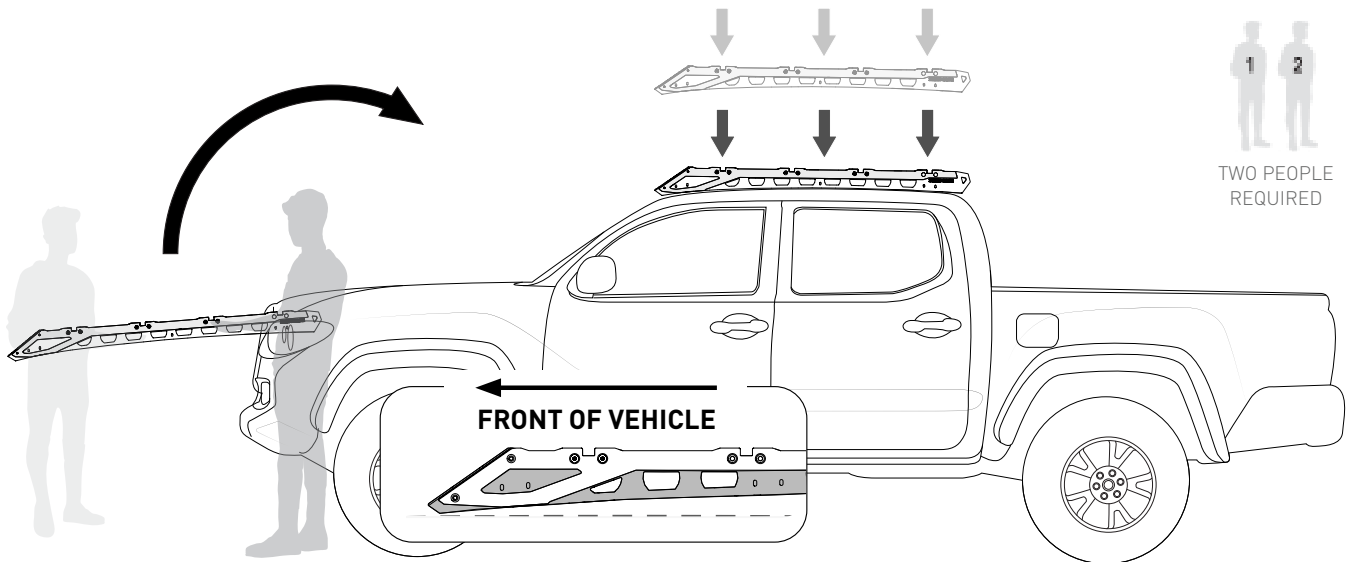

33

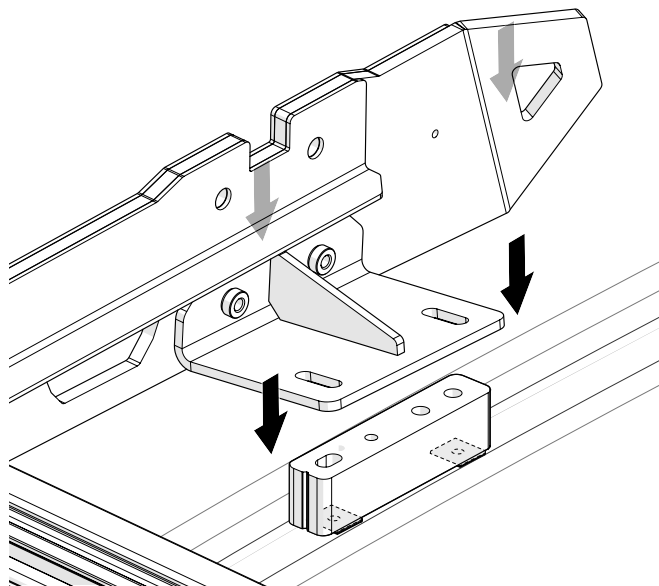
**NOTE**

Take Caution when lowering onto spacer blocks to avoid dislodging or shifting out of position.

34 Align holes in in feet to holes in Spacer Blocks.

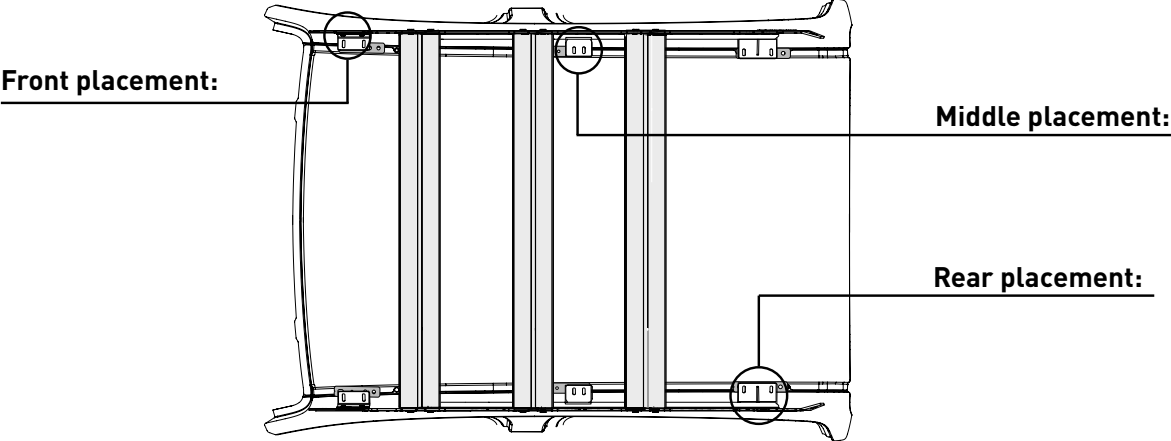

IMPORTANT: Ensure the feet align correctly with the holes and the butyl patch (installed in Steps **9** & **10**). Failure to do so may result in potential water leakage.

35

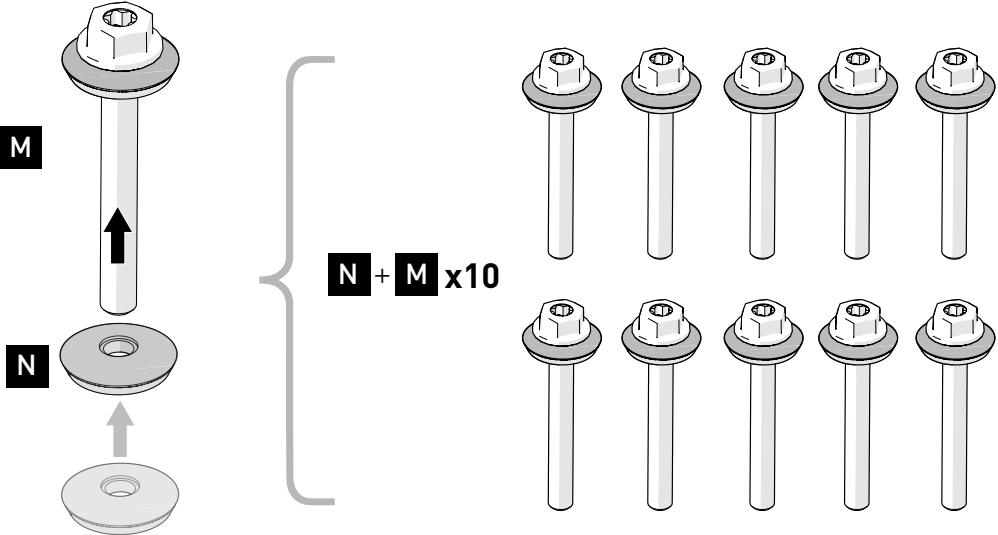

36

Front placement:

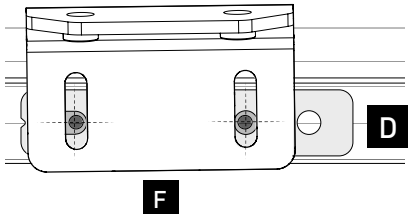

Middle placement:

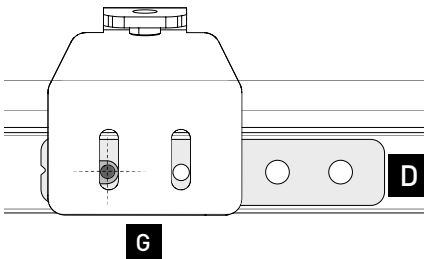

Rear placement:

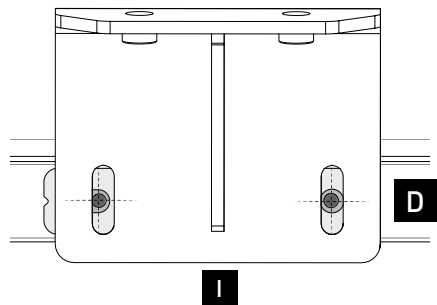

37 Install bolts into the foot holes indicated in Step **36** on both sides.

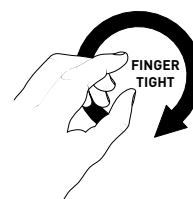
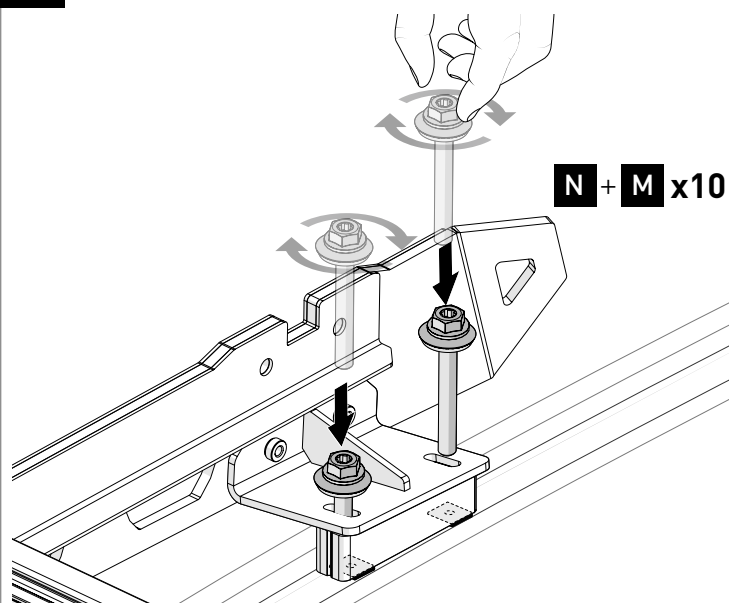

NOTE

Only install bolts in holes that have a **Butyl Patch (Q)** installed below.

38

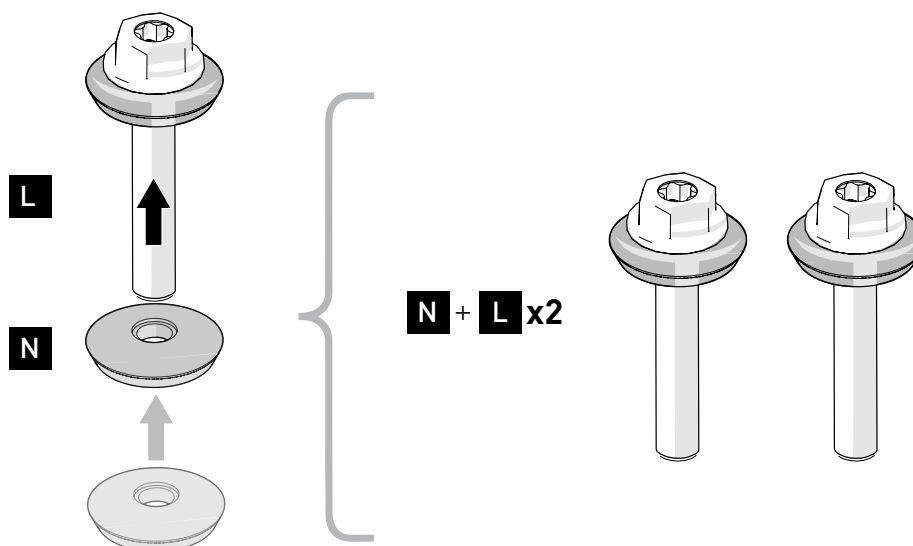

39 Finger-tighten **L** bolts in the remaining holes located on the rear side of the middle foot.

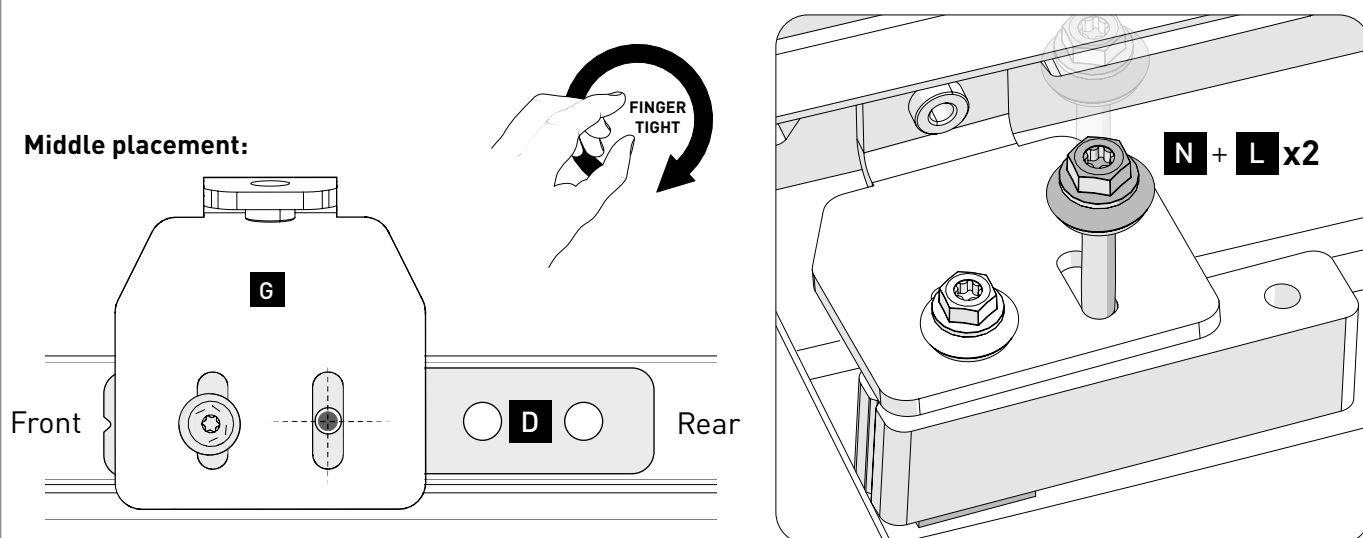

40

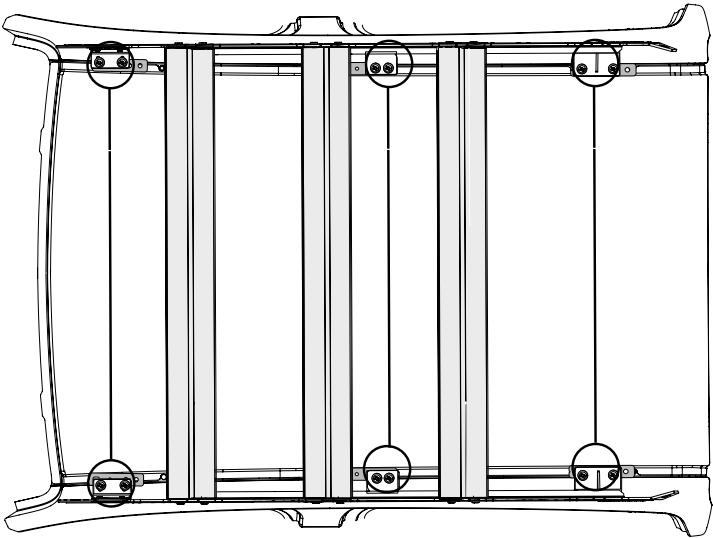

NOTE

Ensure all screws are located and finger-tightened before proceeding.

41

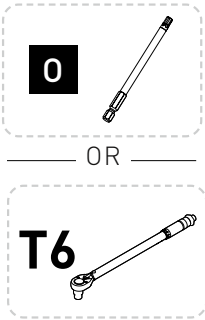
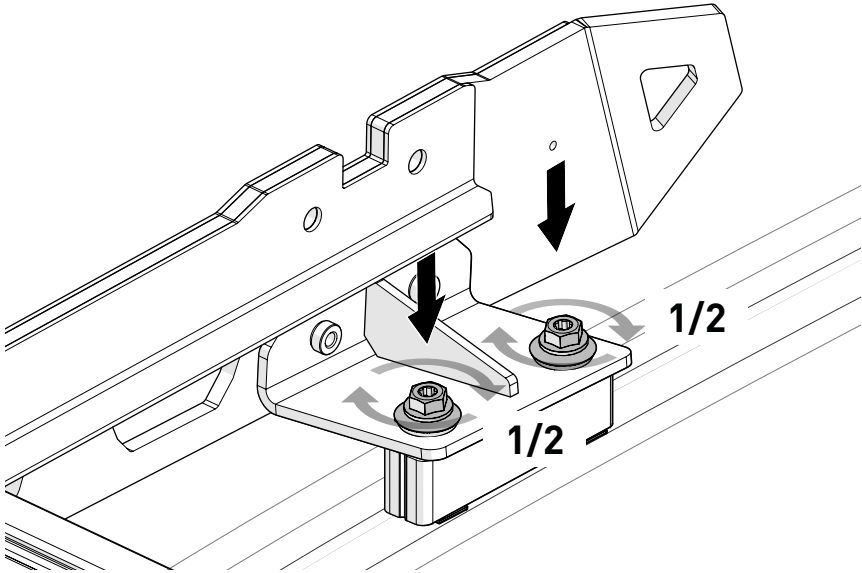

42

Incrementally tighten all bolts until **6Nm** is achieved.

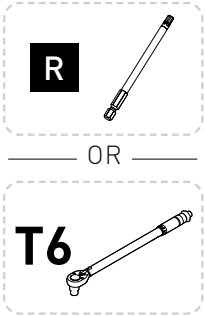
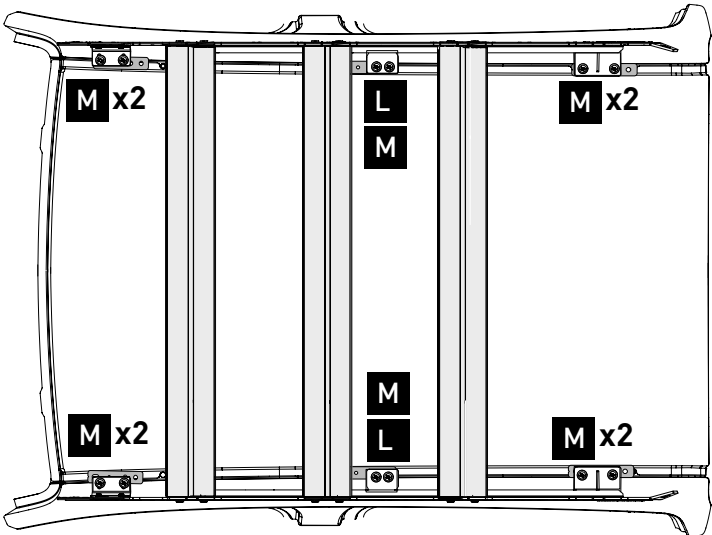

Tighten **L** & **M** to

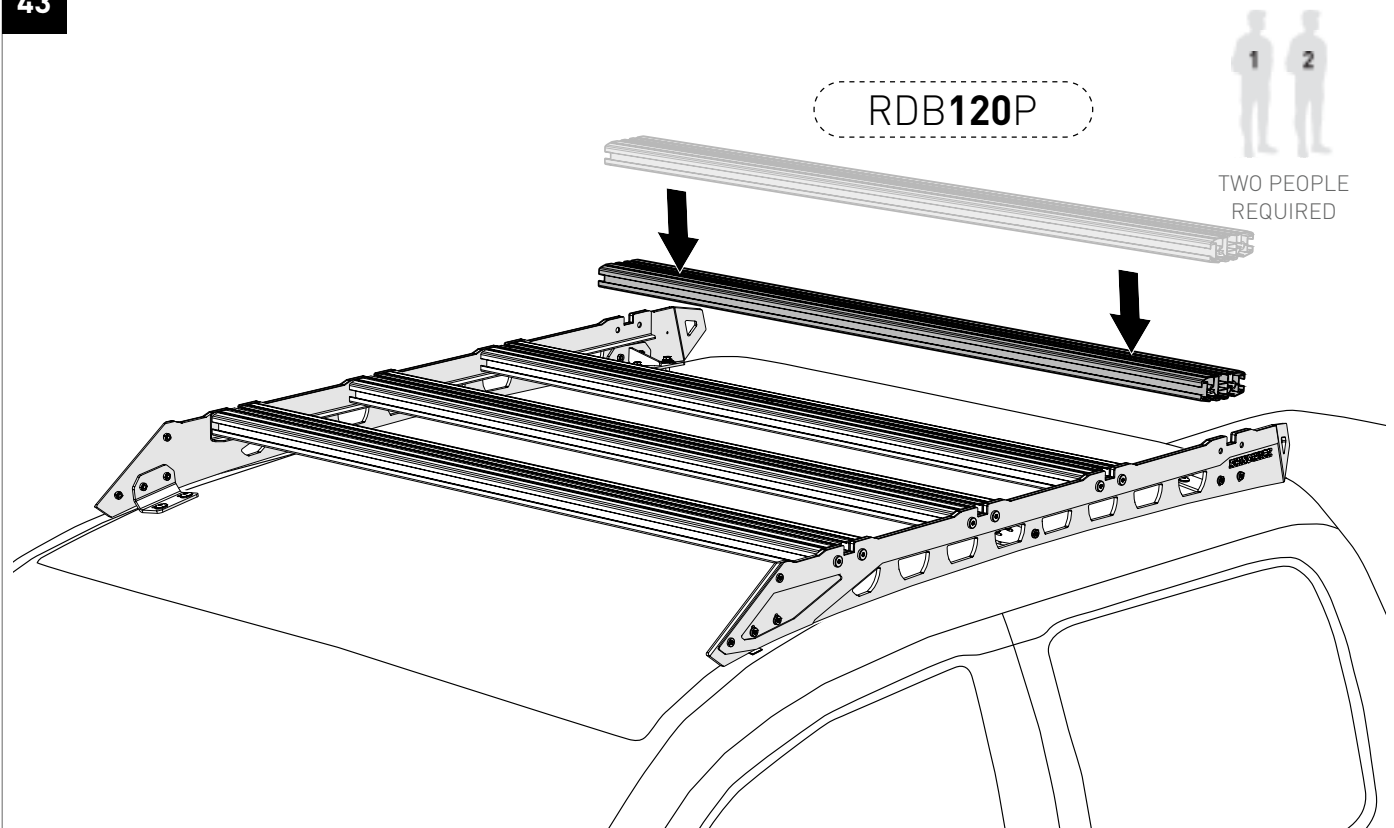

43

**NOTE**

You may need to loosen **K** & **O** screws for easier alignment during installation.

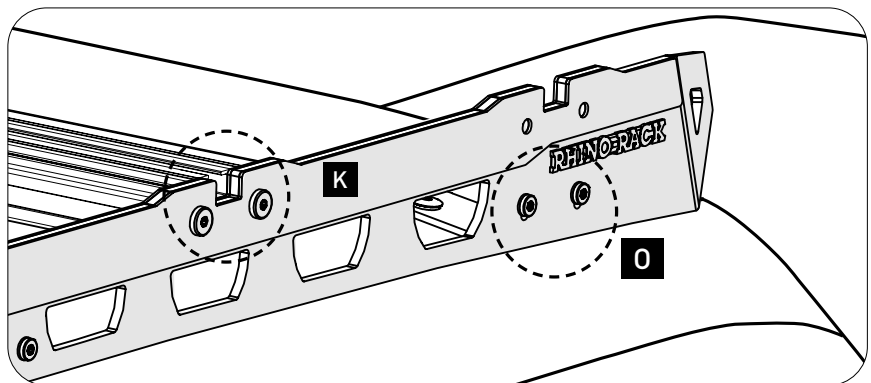

44

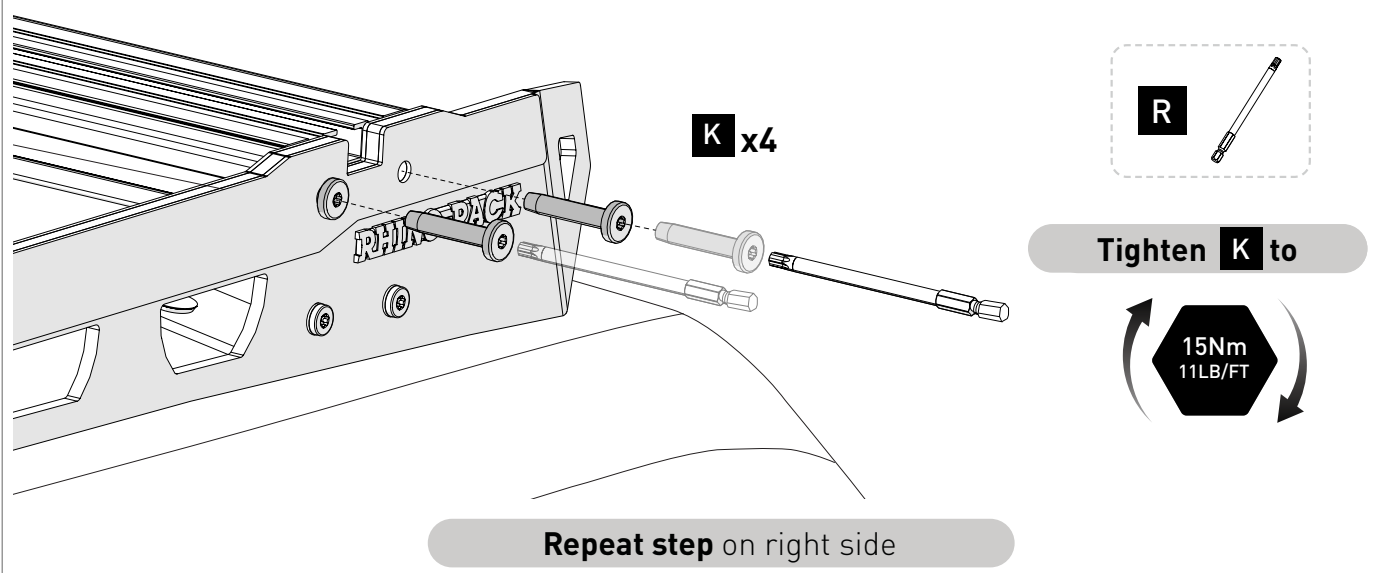

45

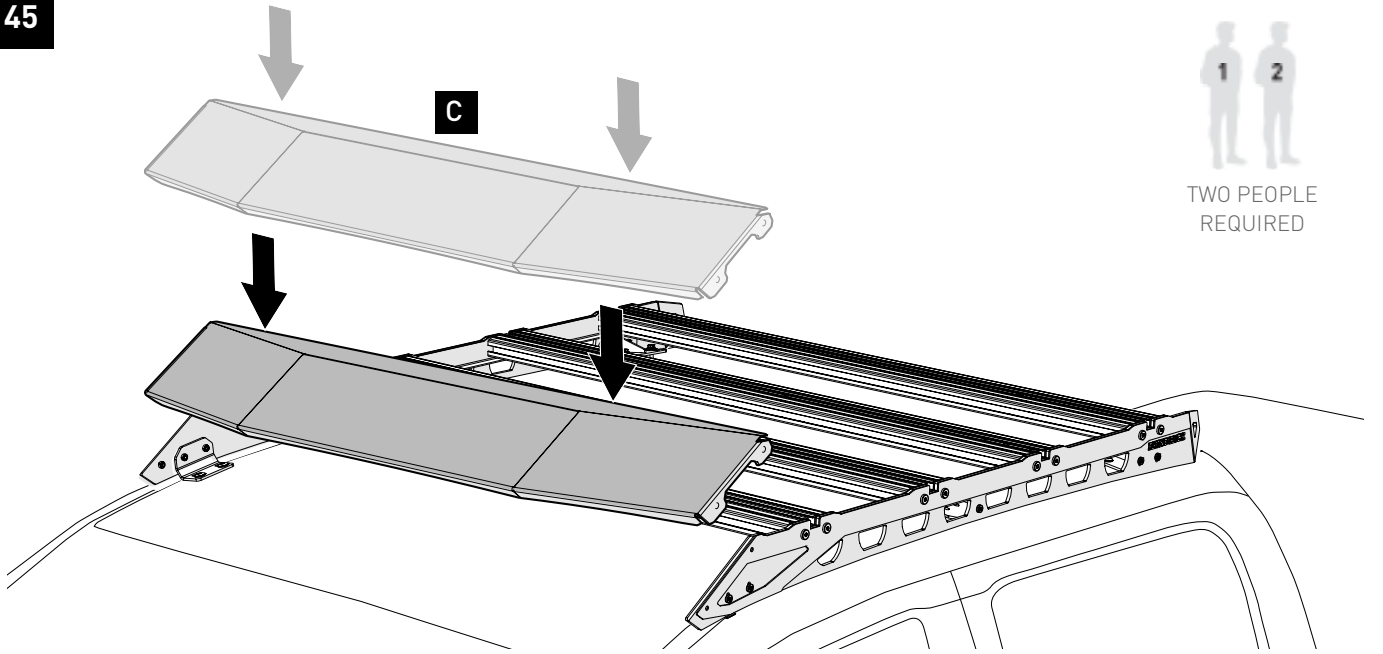

46

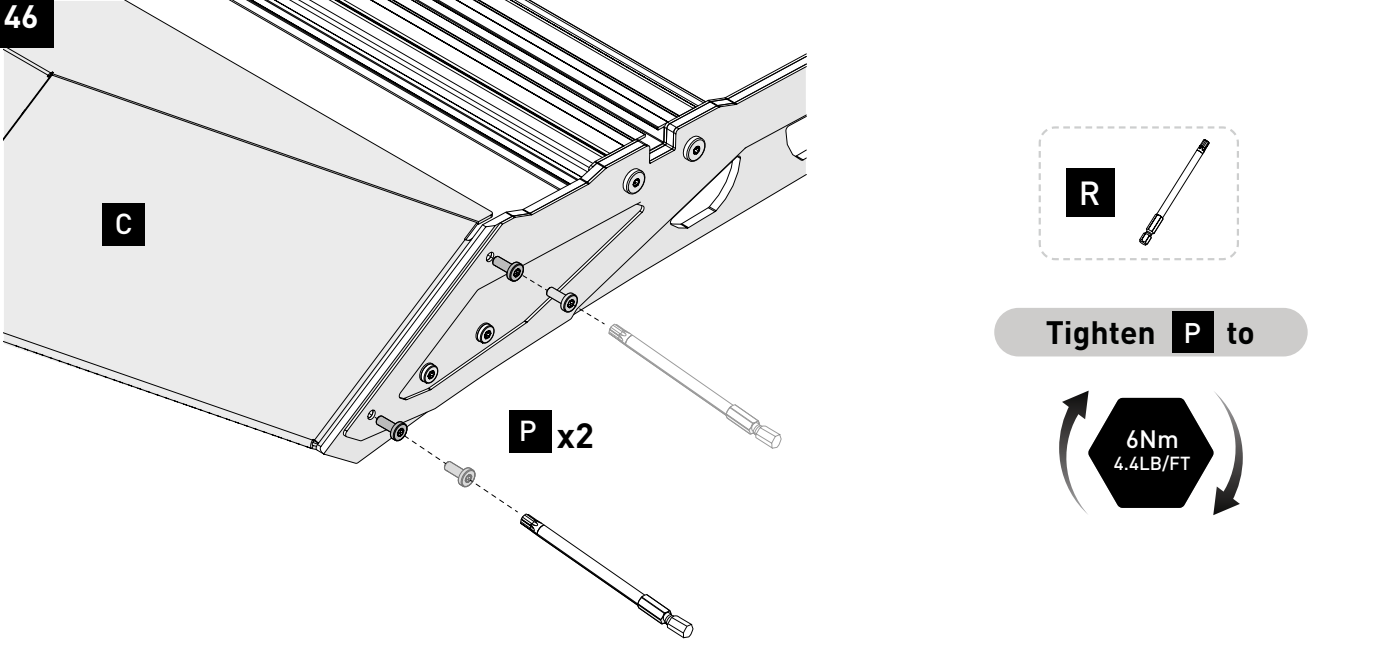

Repeat step on right side of Fairing Weldment (C).

Installation Complete.



RHINORACK.COM

Rhino-Rack AUSTRALIA

22A Hanson Pl,
Eastern Creek, NSW, 2766

Rhino-Rack USA

Unit D, 2450 Airport Blvd,
Aurora, CO, 80011