



**CONTROLLED**

# RHINO-RACK

## RTV Tarago/ Estima Track Mount Supplement

**Important:** Please read these instructions carefully prior to and during installation.  
Check the contents of kit before commencing fitment and report any discrepancies.

- 1** Using masking tape, cover the roof ditch of the vehicle. With the ditch covered, tape over the roof adjacent to the ditch moulding, running along its length.

Parts used: Vortex: RTV148, RLT600, VA118S/B.  
Heavy Duty Bar: RTV148, 1250S/B, QMHD05.

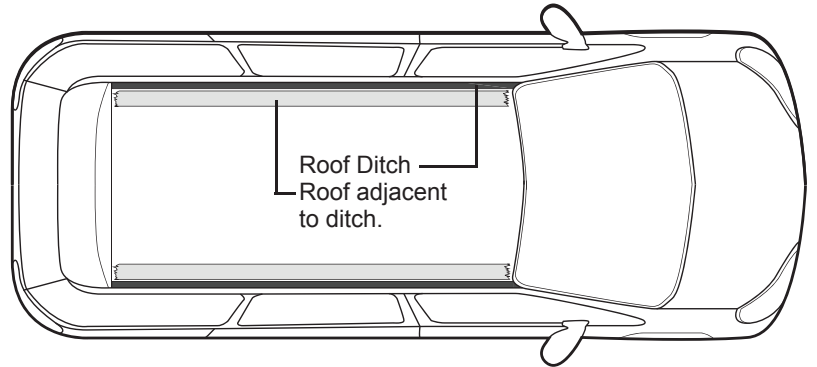
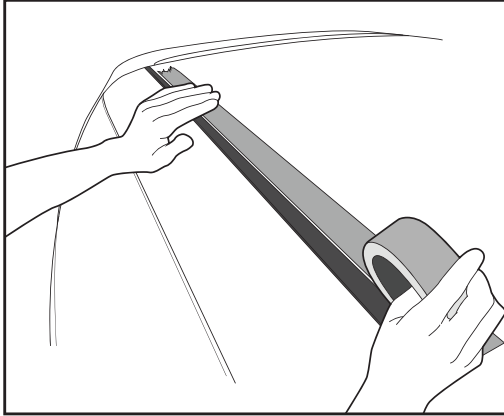

- 2** Place the Tracks on the masking tape 240mm from the Trunk Door Jamb. The Track should follow beside the contour of the roof ditch moulding.

The Track should follow beside the contour of the roof ditch moulding.

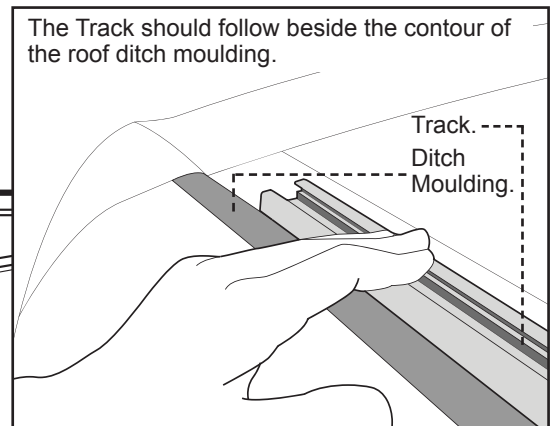
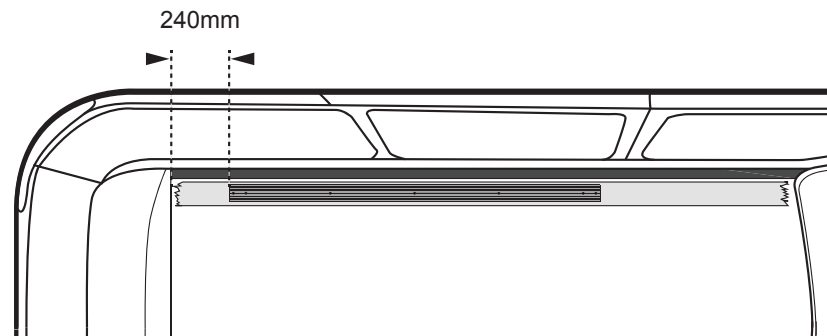

- 3** Spot Mark all holes in the Track.

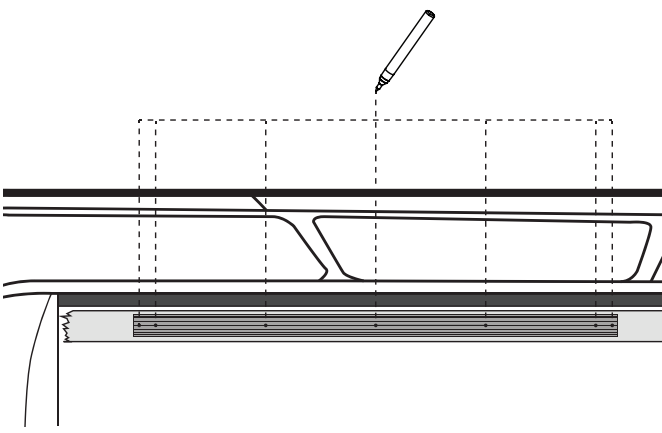

- 4** Remove the Tracks. Use a hole punch and create a reference point in the roof. Do not pierce the roof. Remove the Masking Tape.

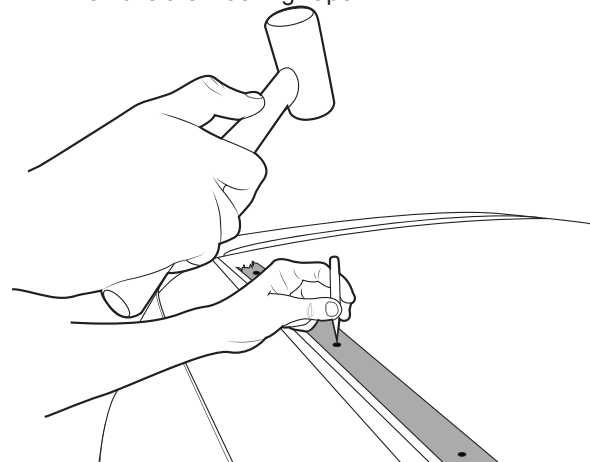

Rhino-Rack  
3 Pike Street, Rydalmere,  
NSW 2116, Australia.  
(Ph) (02) 9638 4744  
(Fax) (02) 9638 4822

Document No: R883  
Prepared By: Kayle Everett  
Authorised By: Chris Murty

Fit Time: 1 Hour  
Issue No: 01  
Issue Date: 08/12/15

These instructions remain the property of Rhino-Rack Australia Pty. Ltd. and may not be used or changed for any other purpose than intended.



# RTV Tarago/ Estima Track Mount Supplement

**5** Drill through the roof at the points previously made.

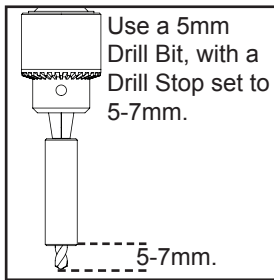

Use a 5mm Drill Bit, with a Drill Stop set to 5-7mm.

**Tip:** If it is possible, it is recommended to use an additional person to vacuum while you are drilling. This will reduce the amount of swarf entering the hood lining or inner roof panel.

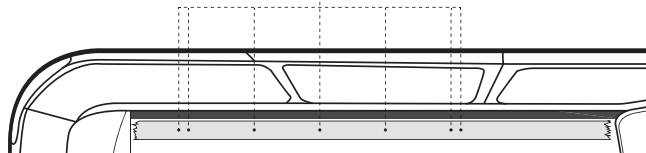

**6** 1: Vacuum any swarf from the area. Remove the Masking Tape. 2: Using Cold Galvanising Paint, cover all drilled areas and any exposed body work.

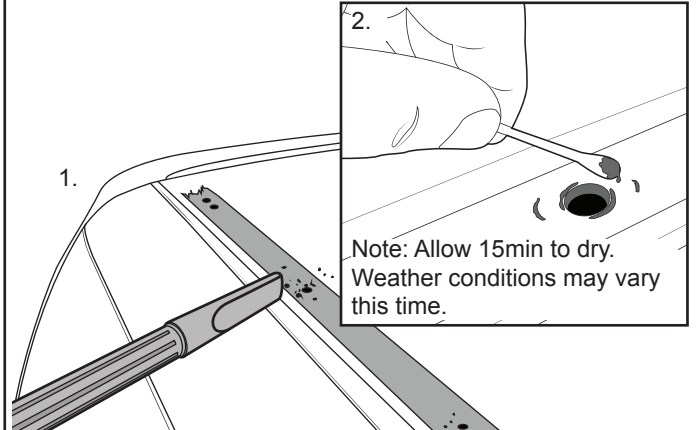

Note: Allow 15min to dry. Weather conditions may vary this time.

**7** Peel off the one side of backing tape on the Butyl Patches provided. Place these carefully over all holes drilled. Remove the top layer of backing tape as shown.

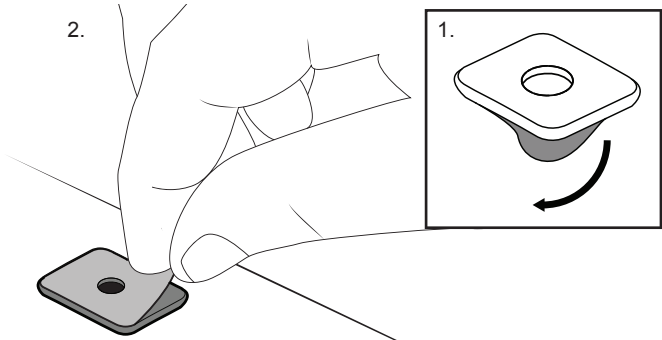

**8** Insert the End Caps and hold in place with Rivets. Place a Rivet in each of the holes along the Track.

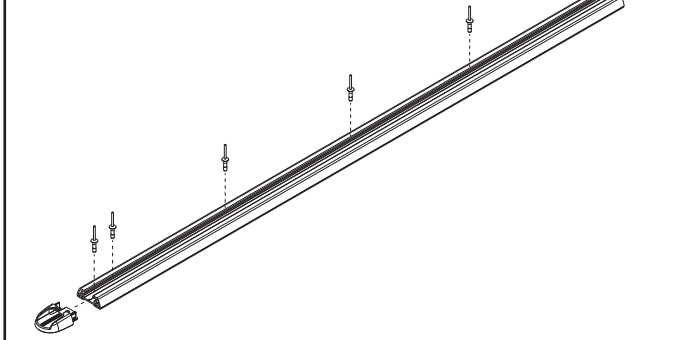

**9** Using either a Pneumatic or Concertina type Rivet Gun (not a small hand gun), rivet the Track into place. Make sure all Rivets are seated firmly onto the base of the Track, place the Rivet Gun onto the Rivet with a Rivet Spacer and gently tap on the back to ensure the rivet is seated before compressing. **Check Track alignment carefully before starting. Start at the front and move towards the rear.**

**Note:** The Track will stand high at the rear when installing from the front. Minor force will be needed to flex the Track down while riveting.

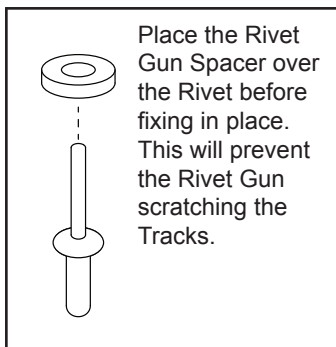

Place the Rivet Gun Spacer over the Rivet before fixing in place. This will prevent the Rivet Gun scratching the Tracks.

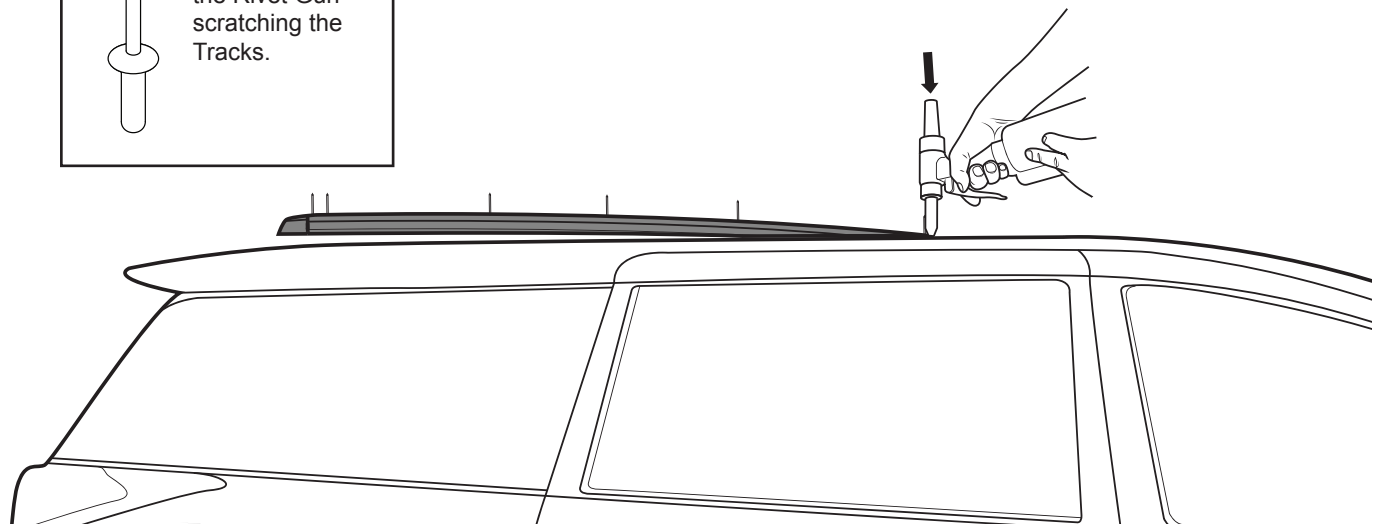

**Install Crossbars as per instructions**