



RHINO-RACK

Aerodynamic & Heavy Duty Roof Rack Systems

RTS514 MERCEDES Sprinter CDi SWB - Rhino Track Mount. RTS523 MERCEDES Sprinter CDi MWB - Rhino Track Mount.

Important: Please read these instructions carefully prior to installation.
Please refer to your fitting instruction to ensure that the roof racks are installed in the correct locations.
Check the contents of kit before commencing fitment and report any discrepancies.
Place these instructions in the vehicle's glove box after installation is complete.

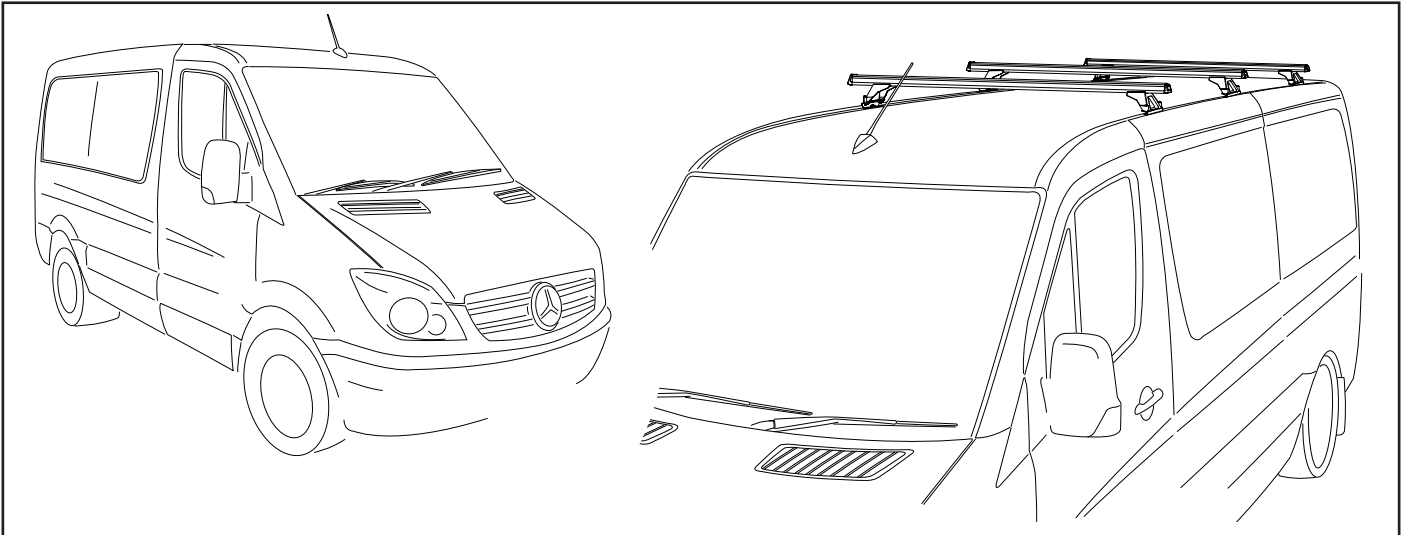

Care Instruction: Wash vehicle roof especially the mounting points prior to installation.

Important Information

Maximum carrying capacity: 100kg

Recommendations:

It is essential that all bolt connections be checked after driving a short distance when you first install your cross bars. Bolt connections should be checked again at regular intervals (probably once a week is enough, depending on road conditions, usage, loads and distances travelled). You should also check the cross bars each time they are re-fitted.

Make sure to fasten your load securely. Please ensure that all loads are evenly distributed and that the centre of gravity is kept as low as possible.

Use only non-stretch fastening ropes or straps.

Sensitivity to cross winds, behaviour in curves and braking.

The handling characteristics of the vehicle, changes when you transport a load on the roof. For safety reasons, we recommend you exercise extreme care when transporting wind-resisting loads; special consideration must be taken into account when braking.

Please remove cross bars when putting vehicle through an automatic car wash.

Load Ratings:

Maximum permissible load is 100kg per pair of cross bars (include the weight of the cross bars, 5kg). When cross bars are to be used in off-road conditions, please build a safety factor of 1.5 into this load limit. Although the cross bars are tested and approved to AS1235-2000, Australian road conditions can be much more rigorous. However, increasing the number of cross bars does not increase the vehicles maximum permissible roof loading.

Note for Dealers and Fitters:

It is your responsibility to ensure instructions are given to the end user or client.

Rhino-Rack
3 Pike Street, Rydalmere,
NSW 2116, Australia.
(Ph) (02) 9638 4744
(Fax) (02) 9638 4822

Document No: RR-162
Prepared By: Craig Jones
Authorised By: Gary England

Issue No: 03
Issue Date: 10/11/2008

These instructions remain the property of Rhino-Rack Australia Pty. Ltd. and may not be used or changed for any other purpose than intended.



MERCEDES Sprinter CDI - Rhino Track Mount

Parts List

NOTE: Assistance by a second person may be required to tighten nuts from inside the van.

Item	Component Name	SWB Qty	MWB Qty	Part No.
1	Track End Cap LEFT	2	2	M134
2	M6 x 15mm T-bolt	12	16	B095
3a	Track LEFT & RIGHT 2215mm	2	-	A382
3b	Track LEFT & RIGHT 2875mm	-	2	A381
4	Track End Cap RIGHT	2	2	M135
5	M6 x 19mm Flat Washer	12	16	W025
6	M6 Nyloc Nut	12	16	N013
7	5mm Rivet	4	4	H004
8	Fitting Instruction	1	1	RR-162

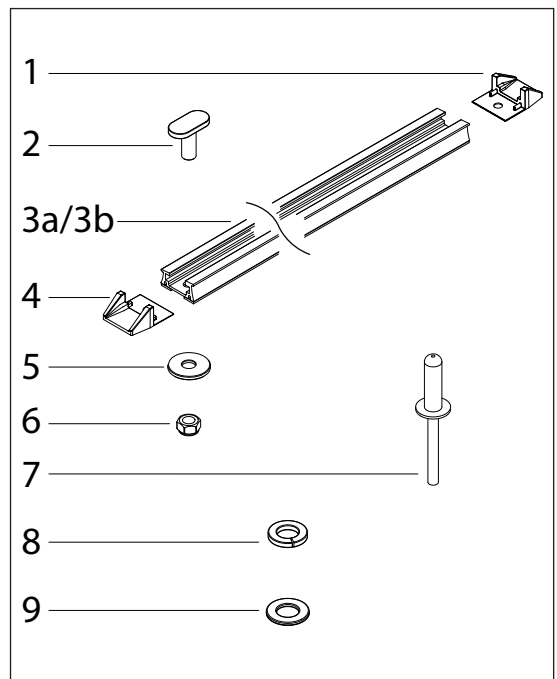

Tools Required:

10mm Spanner or Socket.
Cold Galvanising solution.
Silastic Sealant.
Pneumatic or Concertina rivet gun.

Drill & 5mm drill bit.
Vacuum Cleaner.
Flat Head Screwdriver.
Caulking Gun.

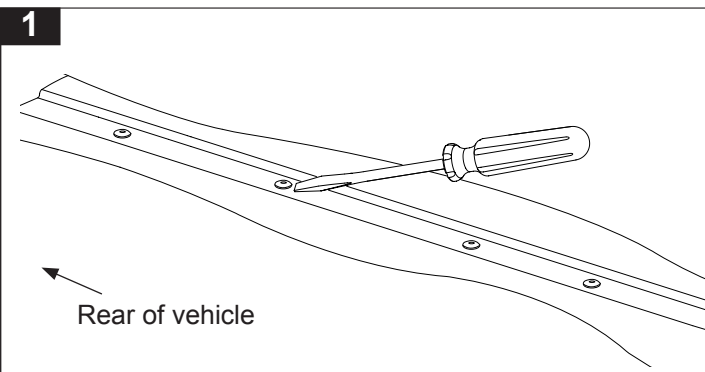

Remove plastic roof plugs:

Plastic plugs in the roof channel need to be removed in order to fit the track. Use a flat head screwdriver from the top to help lever the plugs out or push the plugs out from inside the vehicle. To eliminate rust, be careful not to scratch the paint work.

2 Secure Tracks for drilling of rivet holes:

Tracks are Right and Left handed. Lay the track over the holes and use at least three M6 x 15mm t-bolts to locate track. The higher edge of each track face towards inside of vehicle when installed.

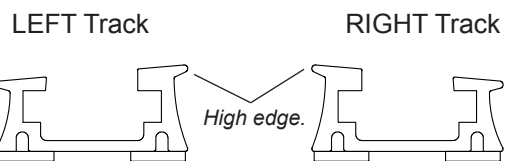

Tracks viewed from REAR.

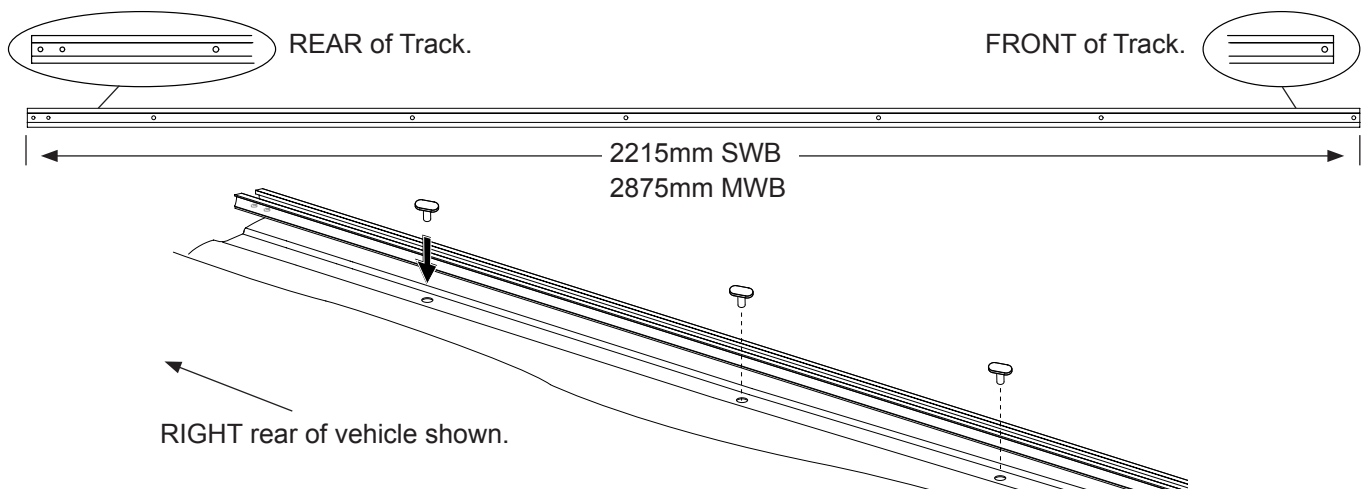



MERCEDES Sprinter CDi - Rhino Track Mount

3

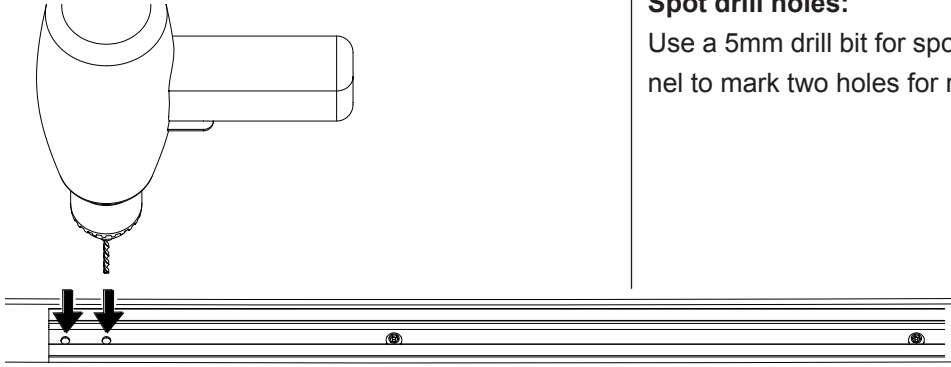

Spot drill holes:

Use a 5mm drill bit for spot drilling the rear of roof channel to mark two holes for riveting.

4

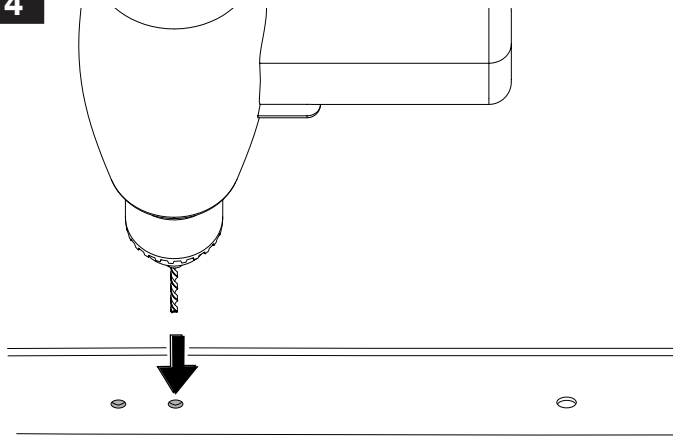

Remove track:

Remove the screws and track. Peel the white backing strip off the foam tape. Drill through the roof in two positions each side.

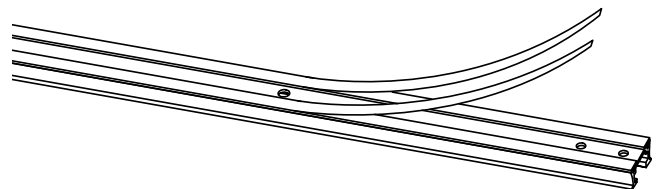

5

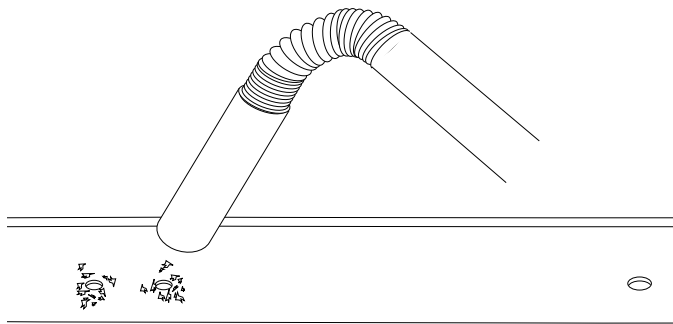

Remove drill swarf:

Use a vacuum cleaner to remove swarf from the roof. This will minimise swarf entering the hole and avoid scratching. Wipe after with a rag.

6

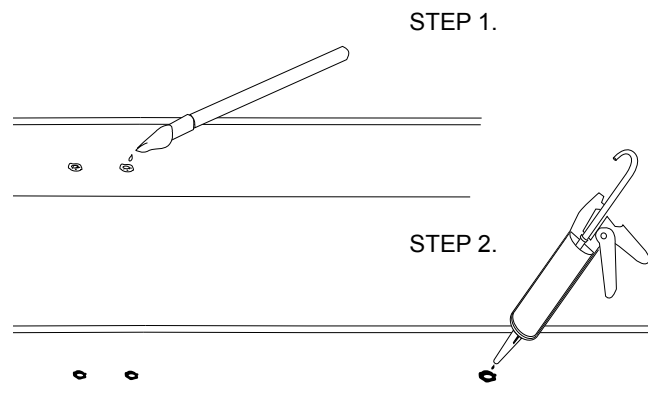

Apply galvanising solution and sealer:

STEP 1. Apply a liberal amount of cold galvanising solution to the inside and surrounds of the drilled holes only. Allow cold galvanising solution to touch dry, ten minutes or so.

STEP 2. Apply a liberal amount of silastic sealer in and around **all** holes to prevent water leaks.



MERCEDES Sprinter CDI - Rhino Track Mount

7 Correct orientation of end caps:

Use the part numbers on the end caps to match with tracks as shown below. The end cap tab with the hole slides under the track and is located with a rivet at the rear and a screw at the front. **Refer to Instruction # 2 for track orientation. IMPORTANT:** End caps must be in place before ends of tracks are riveted.

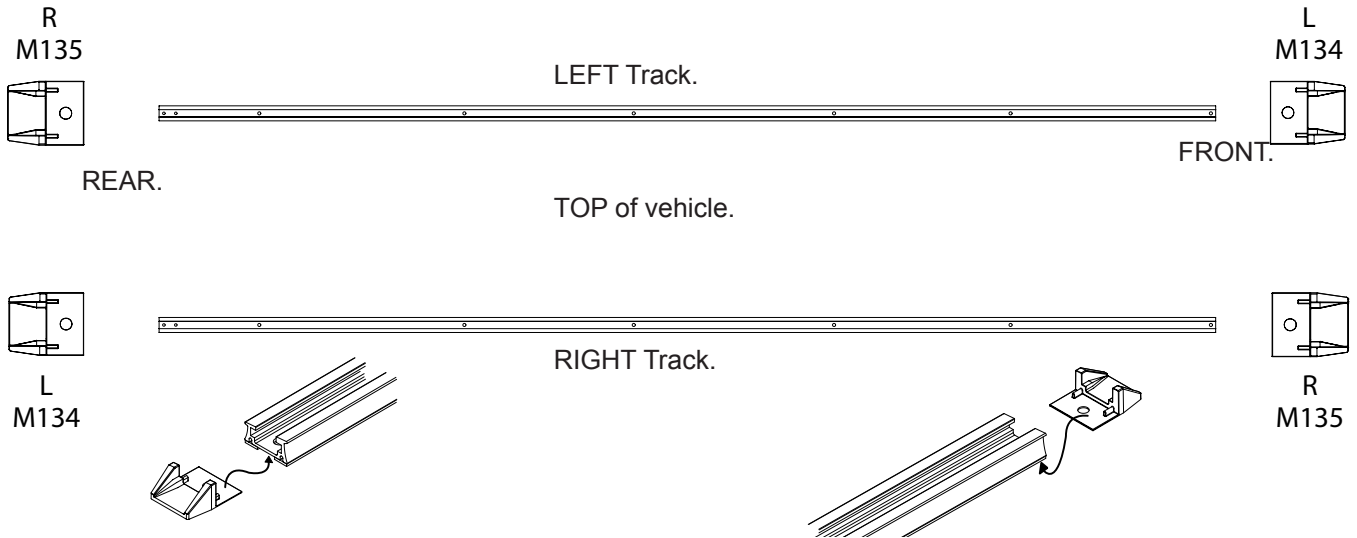

8 Attach track to roof:

Place the track on and check that all holes line up. Make sure the rear end cap is sitting under the track before riveting. Put rivets and screws in to locate. Loosely attach the nyloc nuts and washers to the screws from inside the van.

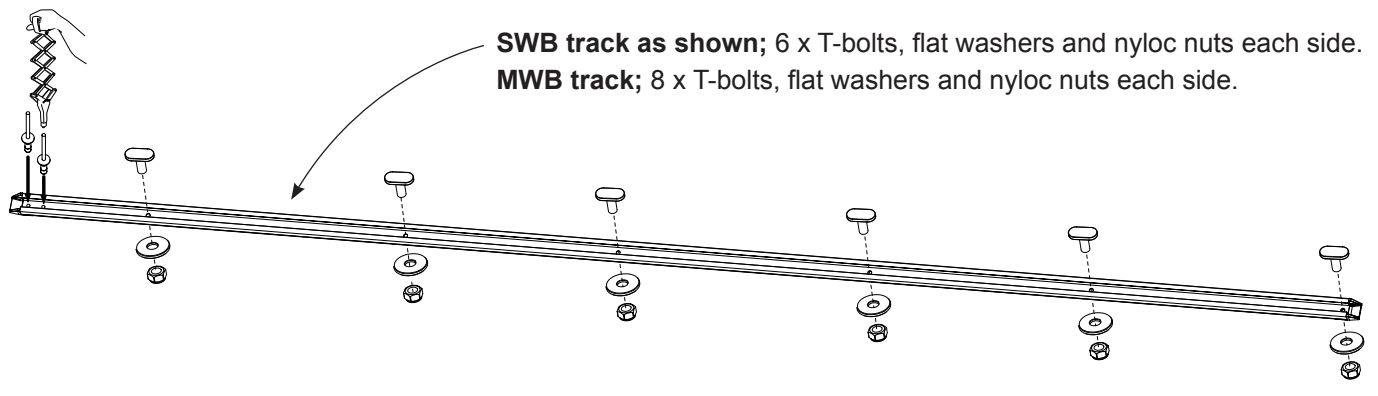

9

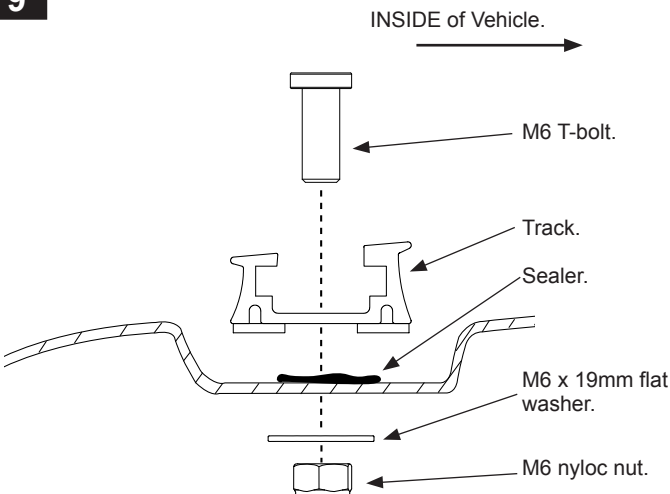

Fasten track to roof:

Assistance by a second person may be required to tighten the nyloc nut inside the van while holding down the T-bolt from outside the van. **Tighten M6 nyloc nut to 3-4 Nm.**