

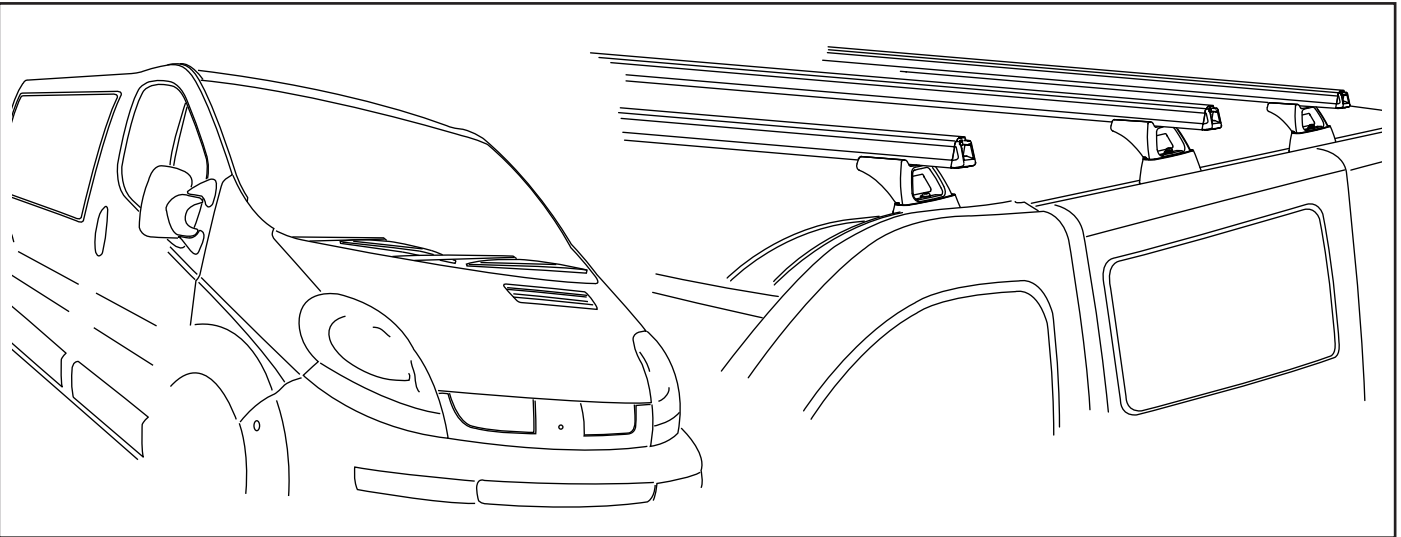

RHINO-RACK

**RLCP14 Rhino Heavy Duty - Two, Three and Four Cross Bar System.
2001 on Renault Trafic, Nissan Primastar, Vauxhall Vivaro, Opel Vivaro.**

Important: Please read these instructions carefully prior to installation.
Please refer to your fitting instruction to ensure that the roof racks are installed in the correct locations.
Check the contents of kit before commencing fitment and report any discrepancies.
Place these instructions in the vehicle's glove box after installation is complete.



Care Instruction: Wash vehicle roof especially the mounting points prior to installation.

Important Information

Maximum carrying capacity: 100kg evenly distributed over the crossbars.

Recommendations:

It is essential that all bolt connections be checked after driving a short distance when you first install your crossbars. Bolt connections should be checked again at regular intervals (probably once a week is enough, depending on road conditions, usage, loads and distances travelled). You should also check the crossbars each time they are re-fitted.

Make sure to fasten your load securely. Please ensure that all loads are evenly distributed and that the centre of gravity is kept as low as possible.

Use only non-stretch fastening ropes or straps.

Sensitivity to crosswinds, behaviour in curves and braking.

The handling characteristics of the vehicle, changes when you transport a load on the roof. For safety reasons, we recommend you exercise extreme care when transporting wind-resisting loads; special consideration must be taken into account when braking.

Please remove crossbars when putting vehicle through an automatic car wash.

Load Ratings:

Maximum permissible load is 100kg per pair of crossbars (include the weight of the crossbars, 5kg). When crossbars are to be used in off-road conditions, please build a safety factor of 1.5 into this load limit, 66kg off-road. Although the crossbars are tested and approved to AS1235-2000, off-road conditions can be much more rigorous. However, increasing the number of crossbars does not increase the vehicles maximum permissible roof loading.

Note for Dealers and Fitters:

It is your responsibility to ensure instructions are given to the end user or client.

Rhino-Rack
3 Pike Street, Rydalmere,
NSW 2116, Australia.
(Ph) (02) 9638 4744
(Fax) (02) 9638 4822

Document No: RR-317
Prepared By: Andy Wana
Authorised By: Chris Murty

Issue No: 06
Issue Date: 22/10/2013

These instructions remain the property of Rhino Rack Australia Pty. Ltd. and may not be used or changed for any other purpose than intended.



Parts List

Item	Component Name	Qty	Part No.
1	Rubber buffer 1800mm (Sold Separately)	1-4	
2	Crossbar 1800mm (Sold Separately)	1-4	
3	End cap	2-8	M002
4	FRONT Right Pad	0-1	M318
5	FRONT Left Pad	0-1	M319
6	5mm security allen key	1	H021
7	M10 channel nut	2-8	N024
8	M6 x 27mm security screw	2-8	B063
9	M6 spring washer	2-20	W004
10	M6 x 12.5mm flat washer	2-20	W003
11	RLCP Leg	2-8	M559
12	MIDDLE/REAR Pad	2-6	M320
13	M6 angled nut and foam	2-14	N048
14	M10 x 25mm bolt	2-8	B071
15	M10 shakeproof washer	2-8	W021
16	M10 x 38mm flat washer	2-8	W022
17	M6 x 20mm security screw	0-12	B062
18	Fitting instruction	1	RR-317

Note: The two crossbar system uses the front fixing point. Single crossbar kits are available.

Tools Required:

- Security allen key, provided in kit.
- 16mm or 5/8" spanner.
- Rubber mallet.
- Tape measure.

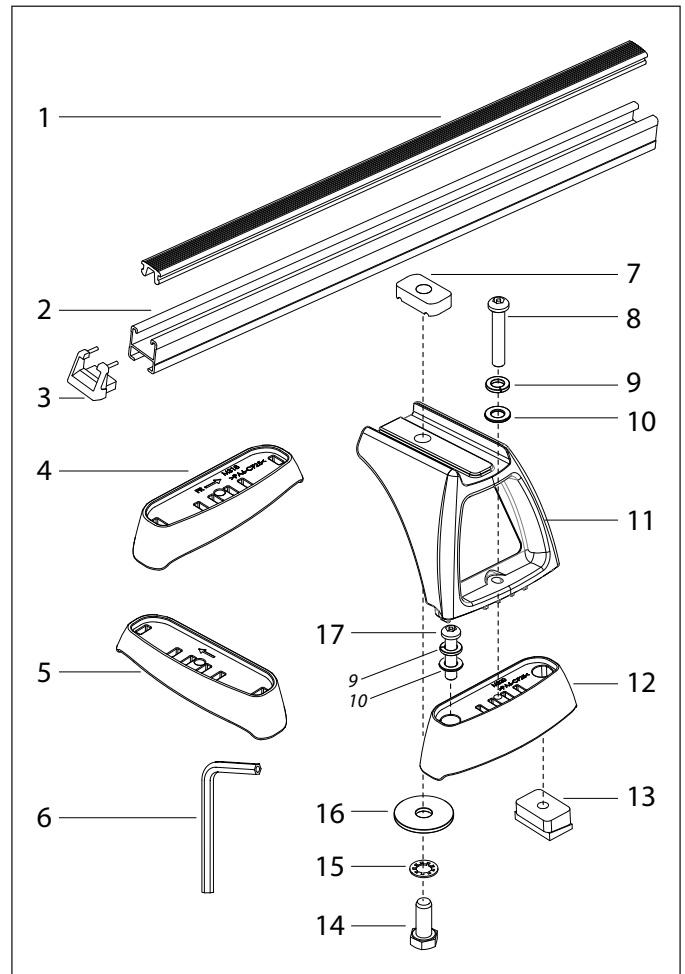

Place the appropriate M6 nuts (Front or Rear) into the "U" shape fixing points on the roof with the foam side facing down.

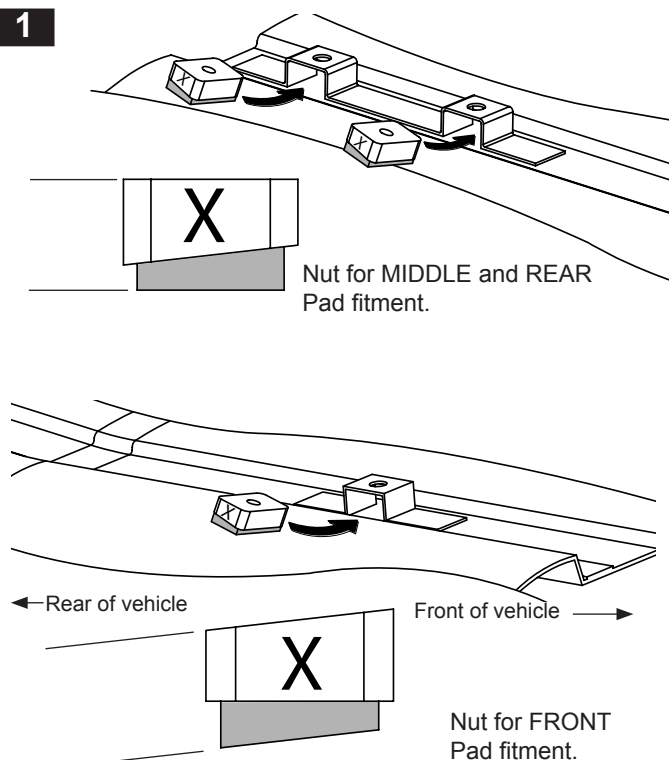

Assemble the spring and flat washers onto the M6 x 20mm (Middle/Rear pads) and M6 x 27mm security screw (Front pad). Insert the screws through the top holes and into the M6 nuts. Tighten to 3-4N/m with the supplied security allen key.

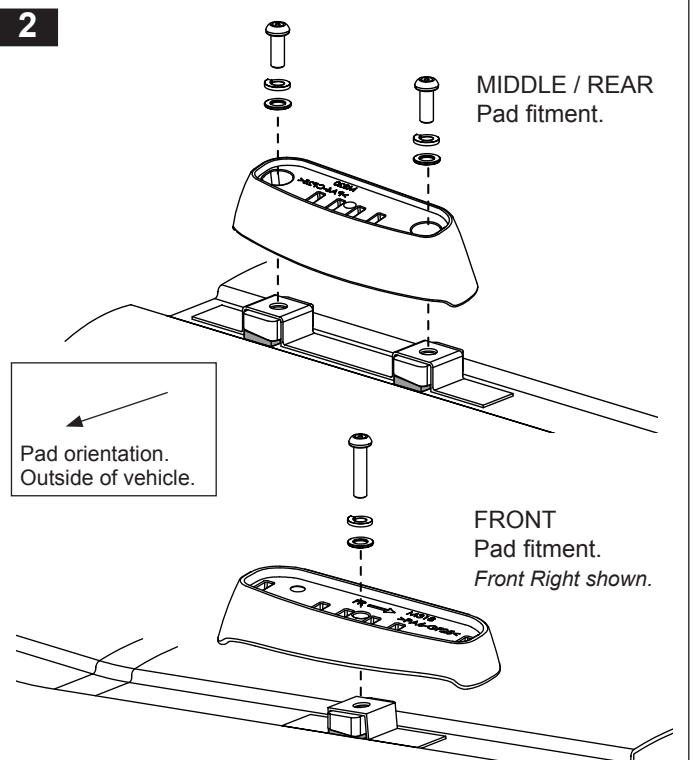



Rhino Heavy Duty - Renault Trafic, Nissan Primastar, Vauxhall Vivaro, Opel Vivaro.

Place an RLCP leg onto each pad. Assemble the spring and flat washers onto the M6 x 27mm security bolts. Insert the bolts through the leg and into the M6 angled nuts.

3

Middle/Rear LEFT

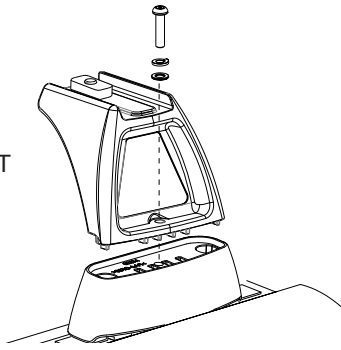

Front LEFT

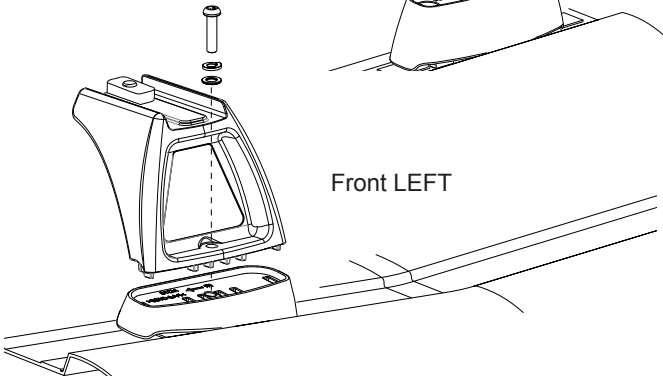

Finger tighten the leg attachment bolts only at this stage. Final adjustment and tightening occurs later.

4

Middle/Rear RIGHT

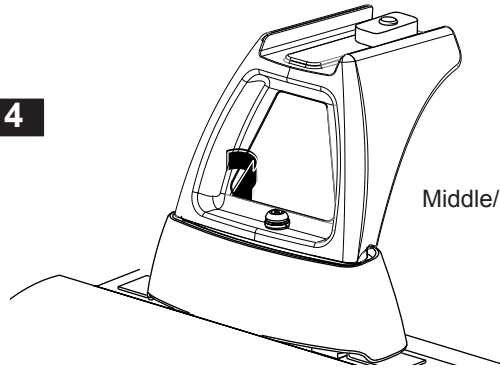

Front RIGHT

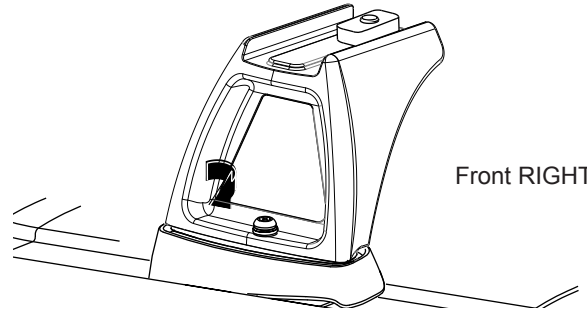

Place the crossbar onto the support legs. Push the crossbar attachment bolt up and turn the bolt so that the channel nut is located fully across the crossbar. **Finger tighten the M10 crossbar attachment bolts.** Check that the channel nut is fully located across the crossbar.

5

Channel Nut **MUST** lie across the bar when tight.

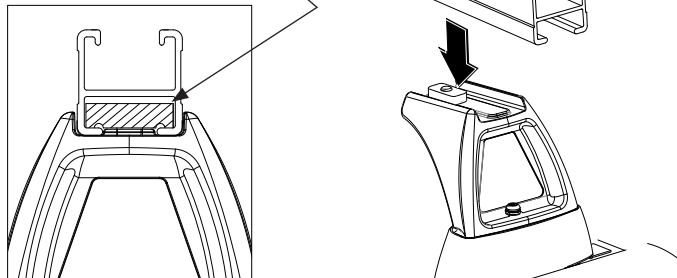

On all legs tighten the two M6 Security screws to 3-4Nm. **DO NOT OVER TIGHTEN.**

6

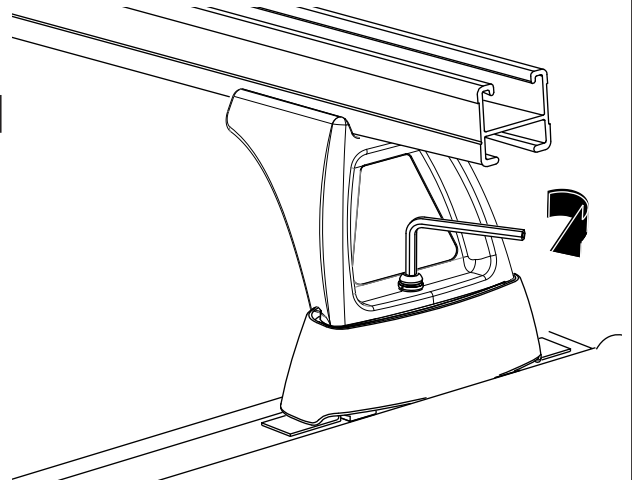

Cross bar over hang (A) must be equal both sides, re-adjust if required. Use a 5/8 or 16mm spanner to tighten all crossbar attachment bolts to 15-17Nm. **DO NOT OVER TIGHTEN.**

7

Equal Over hang

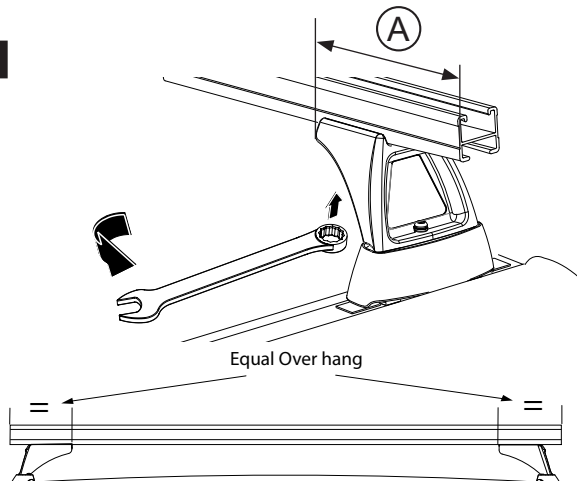

Insert the crossbar buffer strip into the top of the crossbar, check that the rubber is fully inserted, then fit the end caps into the crossbar ends, a rubber mallet maybe required to fit the end caps.

8

