

# RHINO-RACK®

## Reconn-Deck Fit Kit (Toyota Hilux SR5 A-Deck) RD-FK5

**Important:**

1. Check the Rhino-Rack website to ensure you have the latest issue of these instructions.
2. Please refer to your fitting instruction to ensure that the roof racks are installed in the correct locations.
3. Check the contents of kit before commencing fitment and report any discrepancies.
4. Place these instructions in the vehicle's glove box after installation is complete.
5. These instructions must be followed for warranty to be upheld.

**Fit Time:** 3 hours

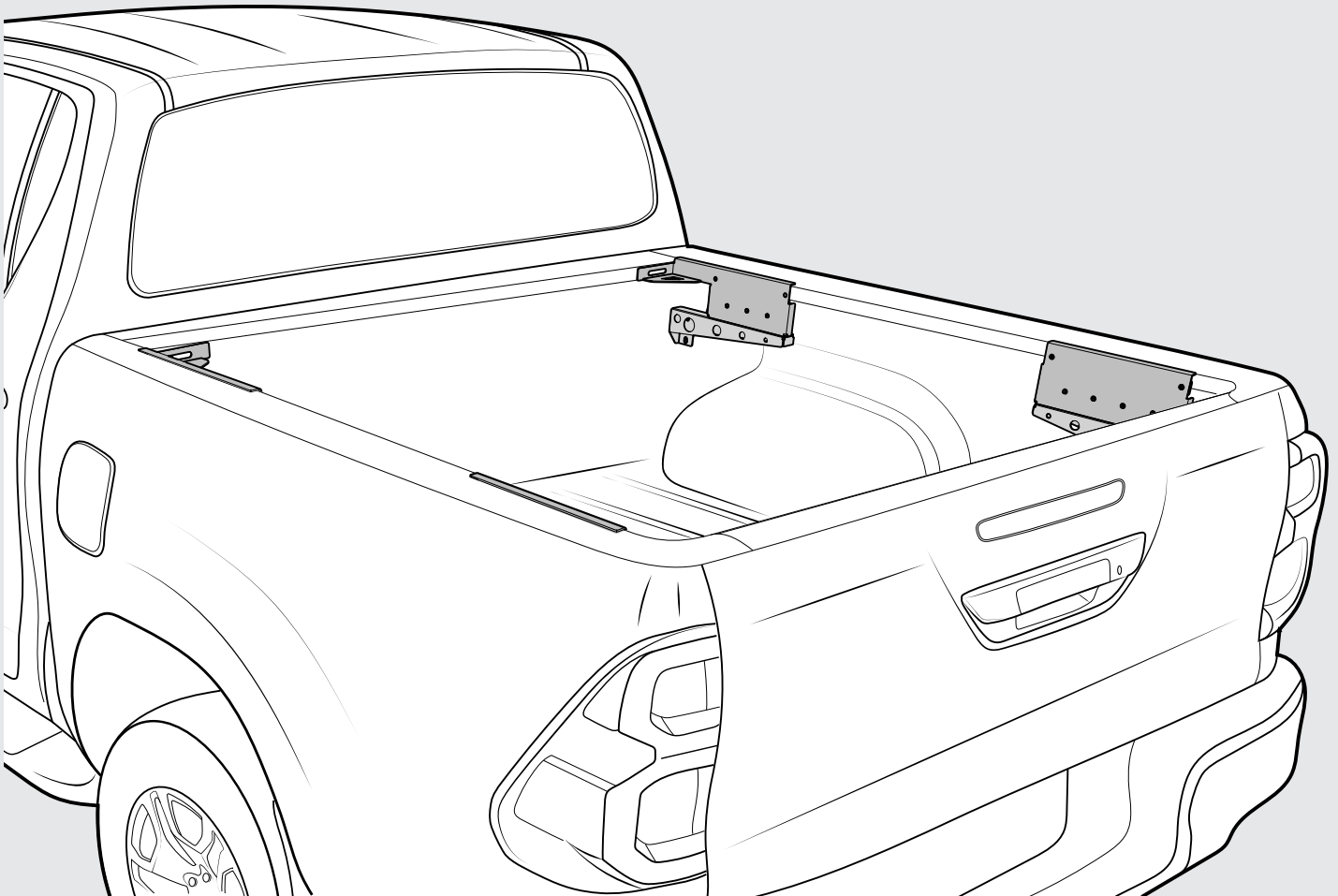

**RHINORACK.COM**

Doc. No: 520-RFI-00117

Issue No: 02

Issue Date: 11/04/2023

## System Components

To complete the Reconn-Deck system you will need the base, tower & bar kits (accessories are recommended)

### RECONN-DECK SYSTEM COMPONENTS

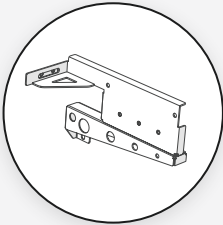
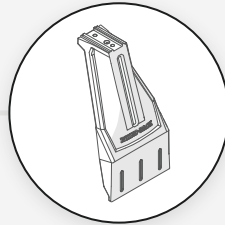
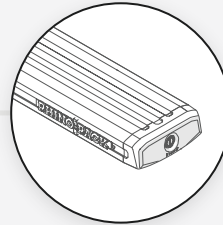
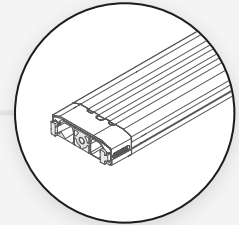
**BASE**

**TOWER**

**BAR**

**ACCESSORY**

## Warning

- Check part number or kit is correct for use with your vehicle.
- Do not attempt to fit system to your vehicle unless you fully understand these fitting instructions. Please direct any questions regarding fitting to the dealer from where it was purchased from.
- Off-road conditions can be rigorous. Extreme care must be taken on any driven path that does not contain a surface protection layer.
- Always ensure you fasten your load securely.
- Use only non-stretch fastening ropes or straps to attach cargo to your load.

## In service maintenance checks

- All bolt connections should be checked after driving a short distance when you first install your roof racks.
- All bolted connections should be checked again at regular intervals (weekly is recommended, depending on road conditions, usage, loads and distances travelled).
- All bolted connections should be checked each time they are re-fitted.
- Off-road conditions are more rigorous. Check all bolted connections and your load more regularly.
- Ensure that your vehicle manufacturer's GVM, and gross axle weights are not exceeded (refer to vehicle owner's manual).

### Torque Settings:

Unless stated otherwise in these instructions, all fasteners should be set to the following torque settings:



## Note for Dealers and Fitters

It is your responsibility to ensure these fitting instructions are given to the end user or client. These instructions remain the property of Rhino-Rack Australia Pty. Ltd. and may not be used or changed for any other purpose than intended.

## Join the herd!

We love creating our products for you and hope you love using them too. For complete peace of mind, register your product at [www.rhinorack.com/warranty](http://www.rhinorack.com/warranty). This way, we can quickly help you with any future approved fitment warranty claims. And remember – never to forget to Make Space For Adventure!

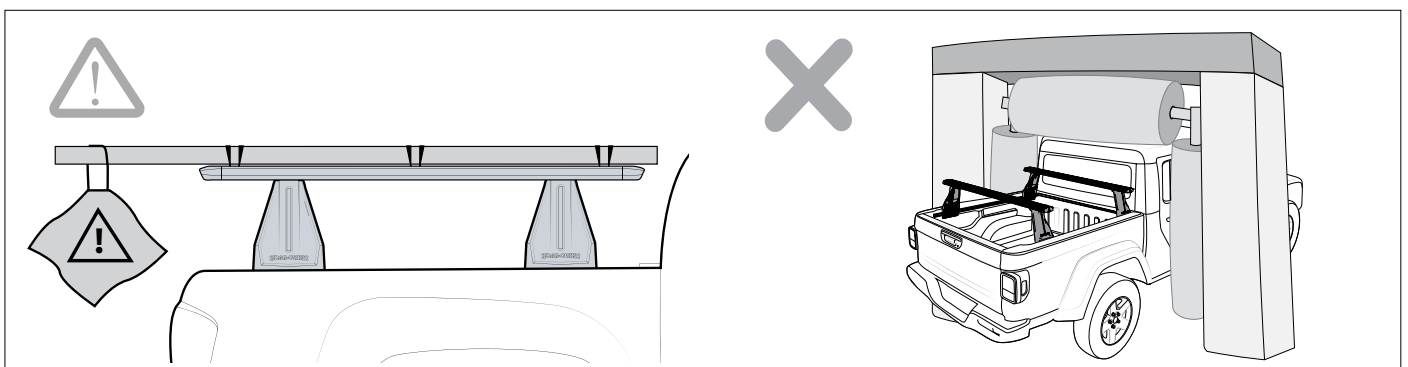
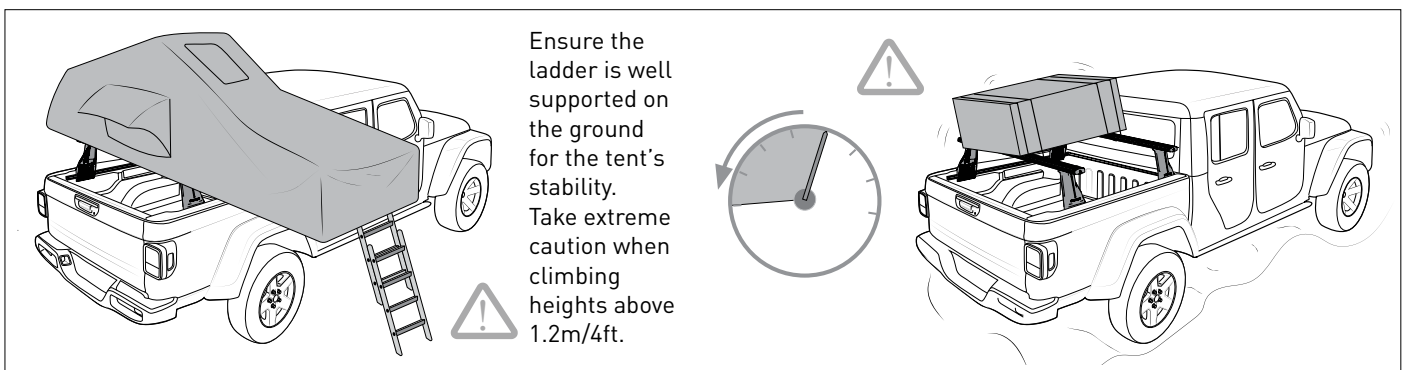
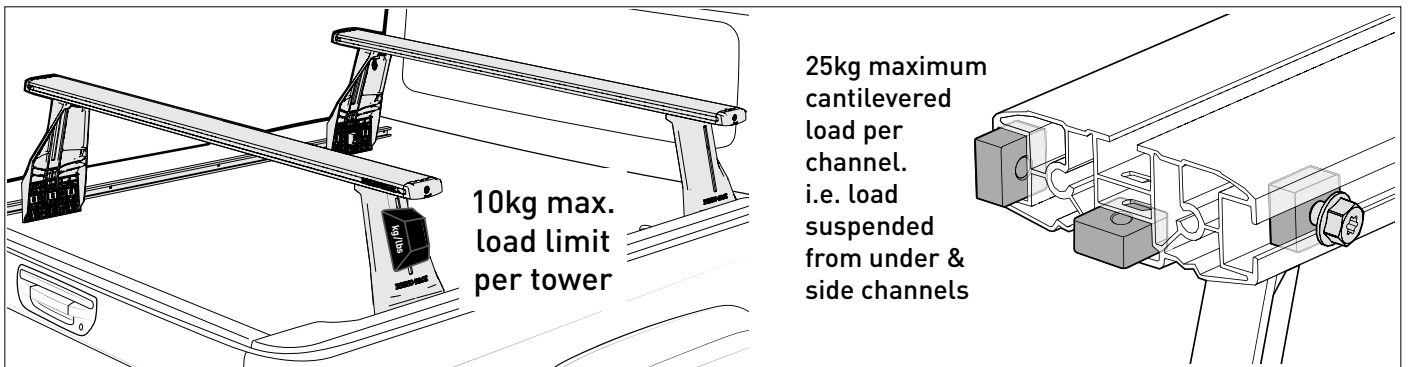
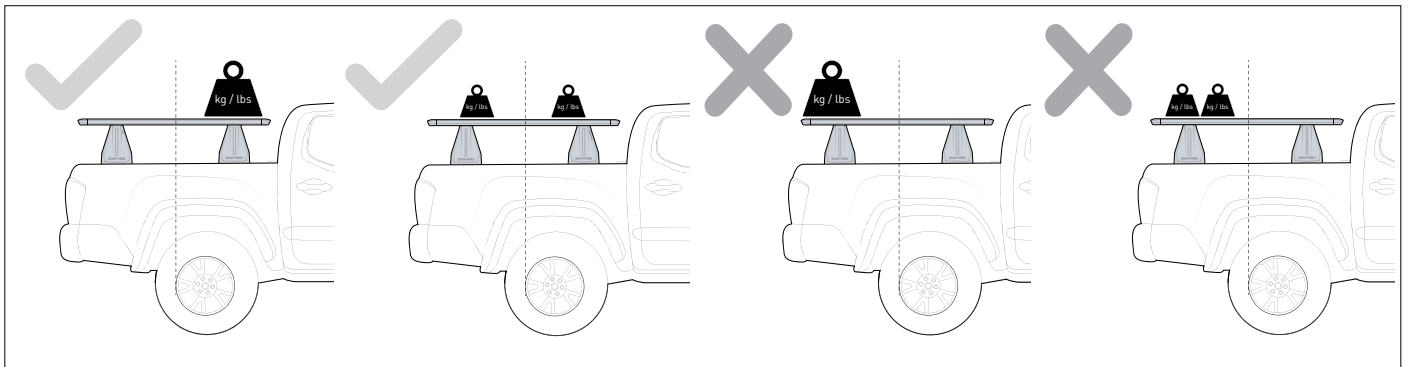
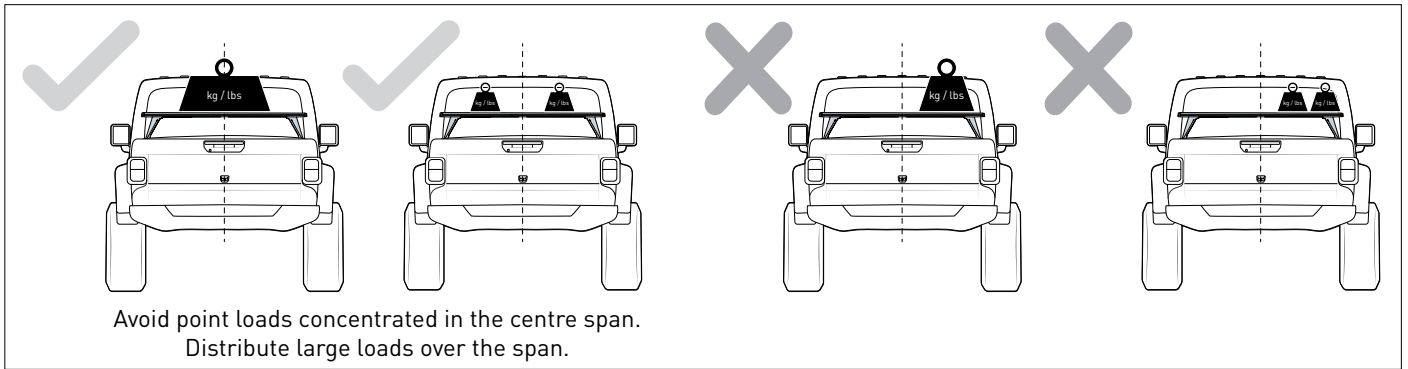

**BASE Parts List**

LHS Front Support Bracket

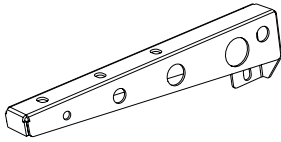
**A x1**

RHS Front Support Bracket

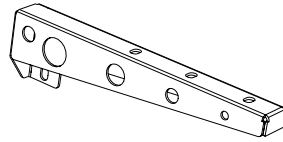
**B x1**

LHS Front Main Bracket

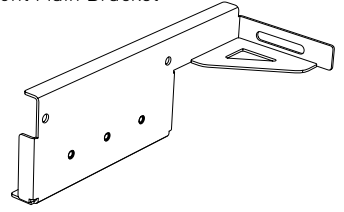
**C x1**

RHS Front Main Bracket

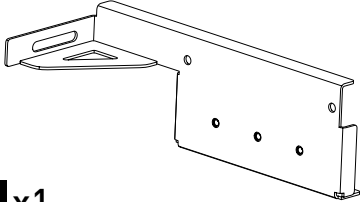
**D x1**

RHS Rear Support Bracket

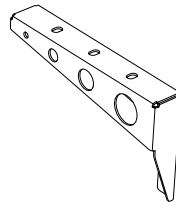
**E x1**

LHS Rear Support Bracket

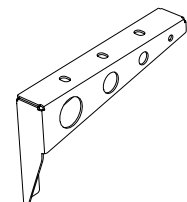
**F x1**

Rear Main Bracket

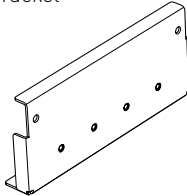
**G x2**

Rear Backing Plate

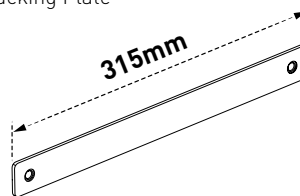
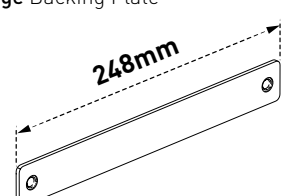
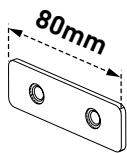
**H x2**Front **Large** Backing Plate**I x2**Front **Small** Backing Plate**J x2**

M8 x 20 Hex Head Flanged Bolt

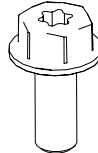
**K x20**

M8 x 30 Hex Head Flanged Bolt

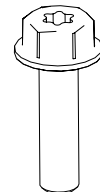
**L x24**

40 x 400mm Rubber Bumpon

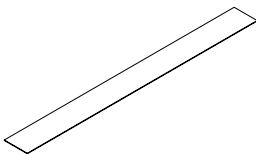
**M x3**

60 x 400mm Rubber Bumpon

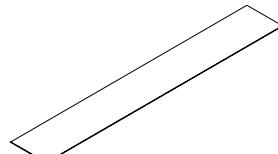
**N x10**

M8 x 50 Socket Head Cap Screw

**O x1**

Fitting Instruction

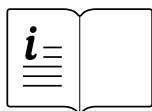
**P x1****Tools Required****T1** - 13mm Socket Wrench**T2** - Marker**T3** - Drill, 3mm Drill Bit + Drill Stop**T4** - Drill, 9mm Drill Bit + Drill Stop**T5** - Torque Wrench**T6** - Vacuum**T7** - Phillips Head Screw Driver**T8** - Scalpel**T9** - Cold Galvanising Paint + Cotton buds**T10** - Centre/Transfer Punch + Mallet**T11** - Die Grinder (If roll bar previously fitted)**T12** - Knife, Steel Rule + Flat Bench  
(for cutting rubber bumpon)**T13** - 75mm Extension bar + 13mm Socket**T14** - T40 Torx Allen Key**T15** - Cleaning Cloth**Safety Gear**



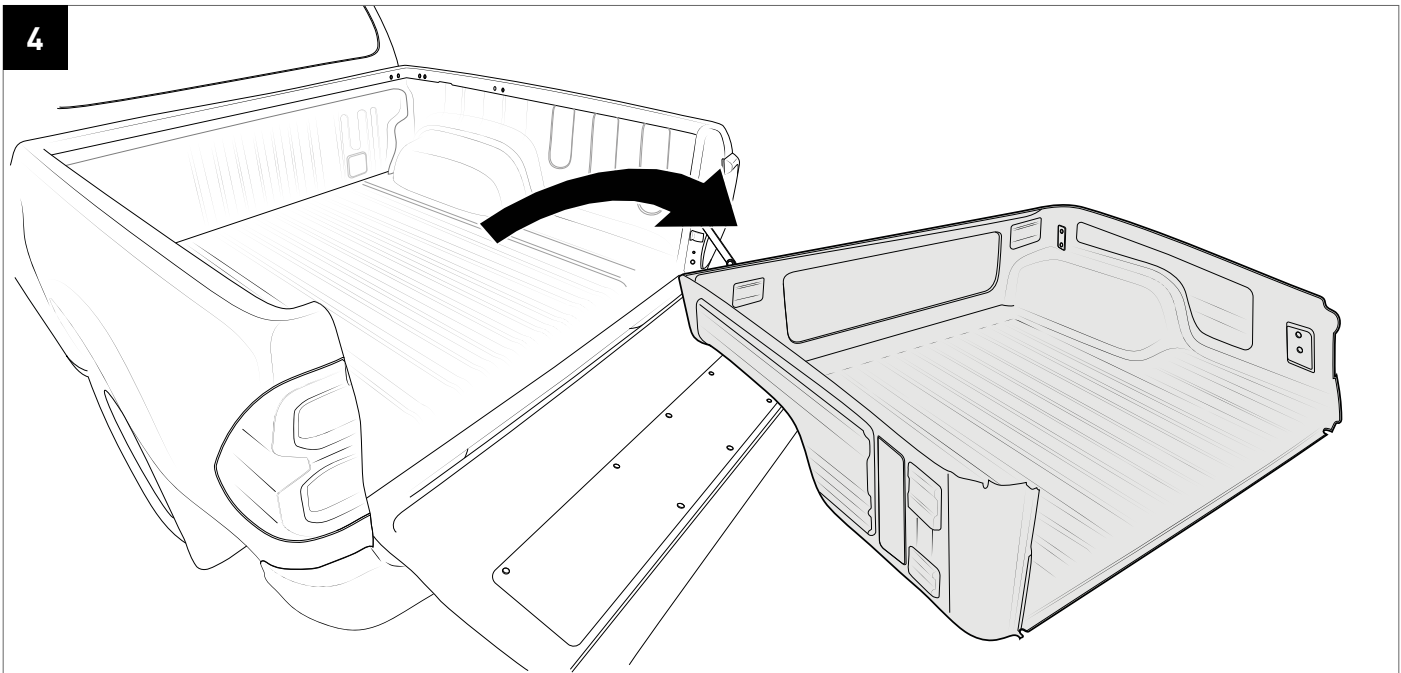
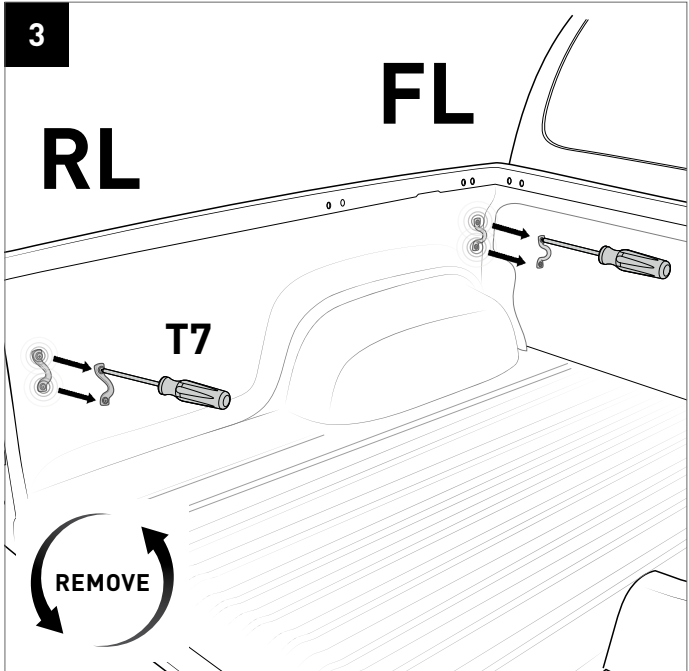
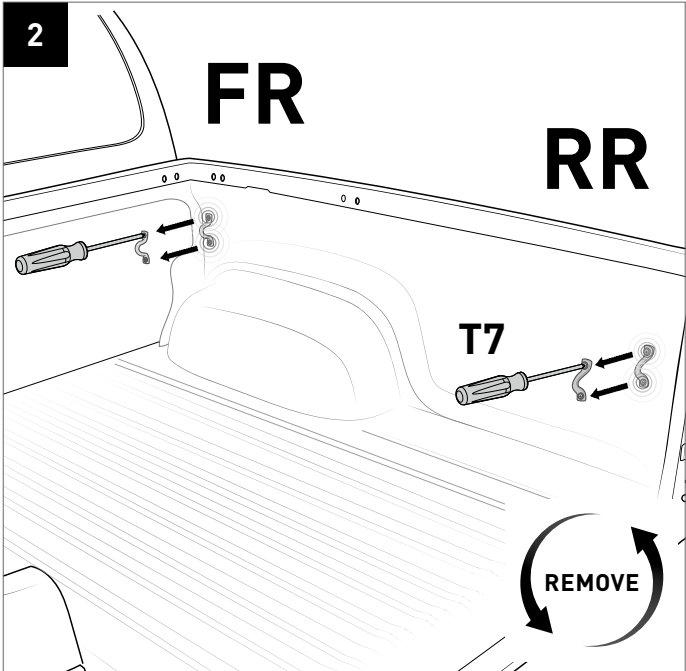
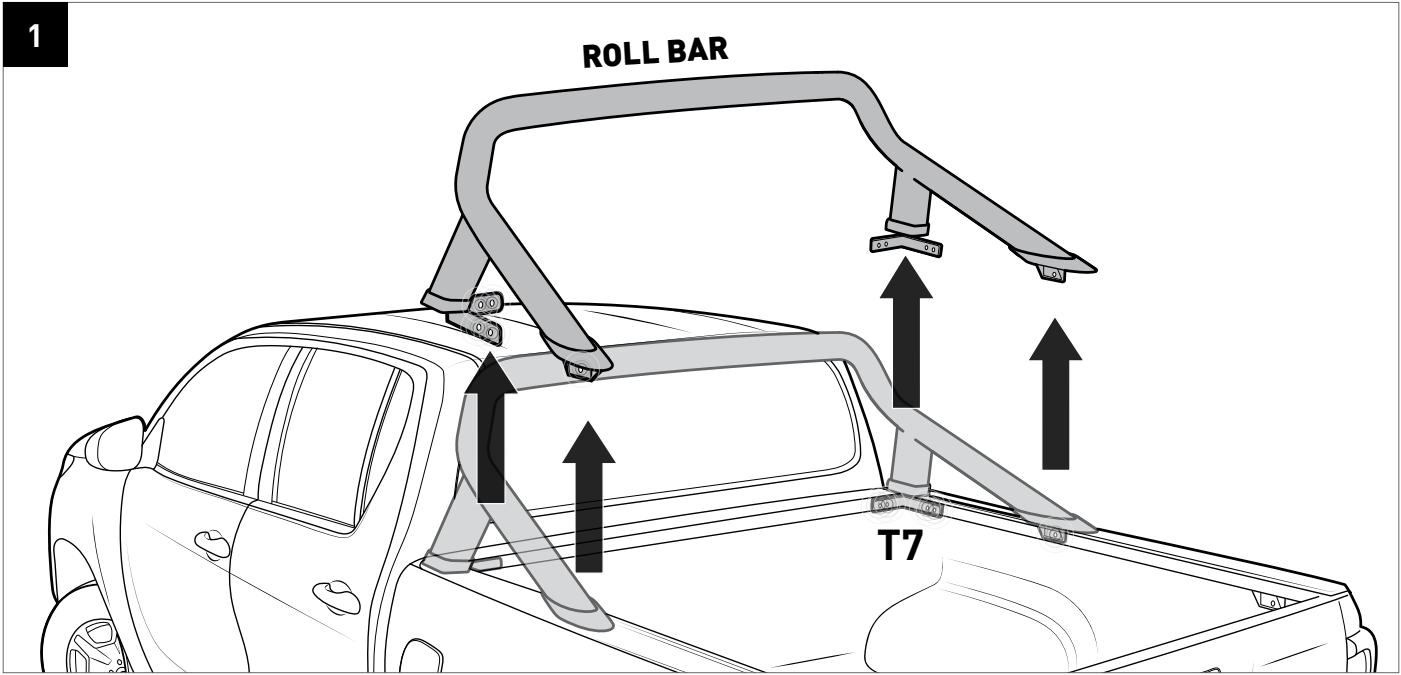

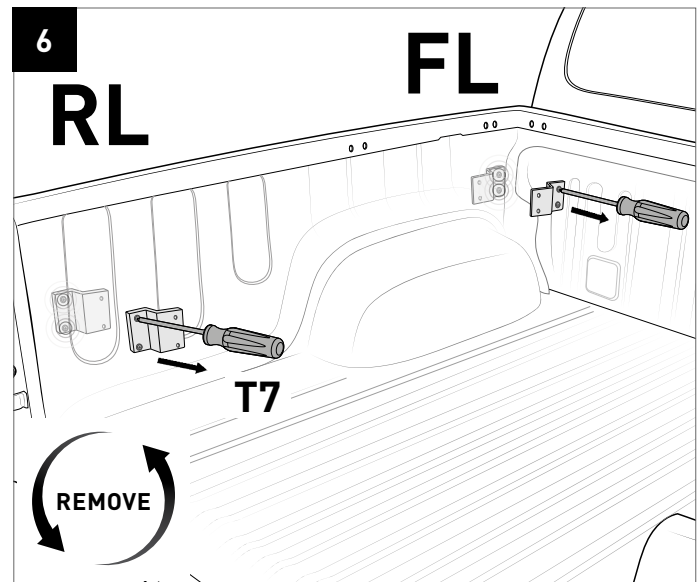
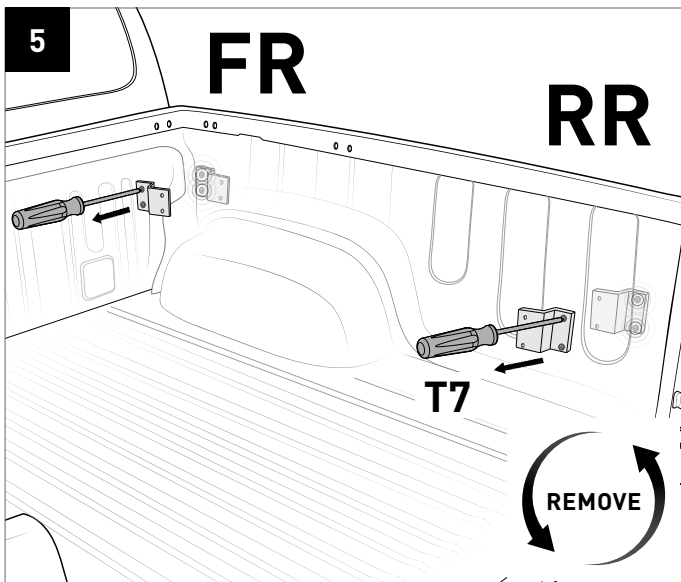

- 7** Protect the surface paint by adhering the rubber Bump on to the contact surfaces of the bracket then trim the rubber Bump on to shape around the bracket's edges.  
*Note: Prepare a bench as this will be repeated to all brackets. Begin with the Right Side brackets.*



When cutting Bump on, carefully cut away from fingers and body

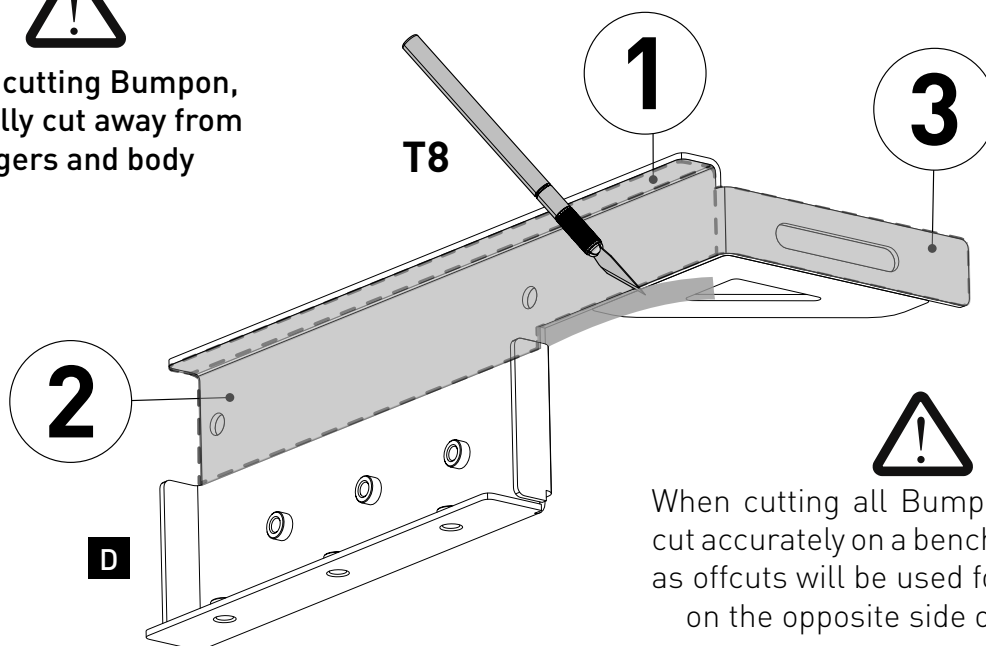

When cutting all Bump on, use **T12** to cut accurately on a bench. Cut sparingly as offcuts will be used for the brackets on the opposite side of the vehicle

Use **T12** to cut from 2 separate pieces of **M** 40 x 400mm Rubber Bump on

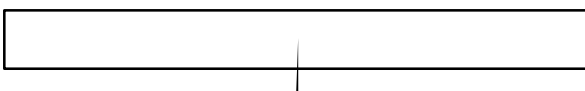

- 1** 2 off 17 x 375mm (1 for opposite side bracket **C**)
- 3** 2 off 30 x 140mm (1 for opposite side bracket **C**)

Use **T12** to cut from **N** 60 x 400mm Rubber Bump on

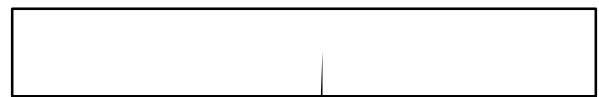

- 2** 60 x 375mm
- Stick to bracket then trim this section

**8** Cut out rubber Bumpon through bracket holes using the bracket holes as templates.



When cutting Bumpon, carefully cut away from fingers and body

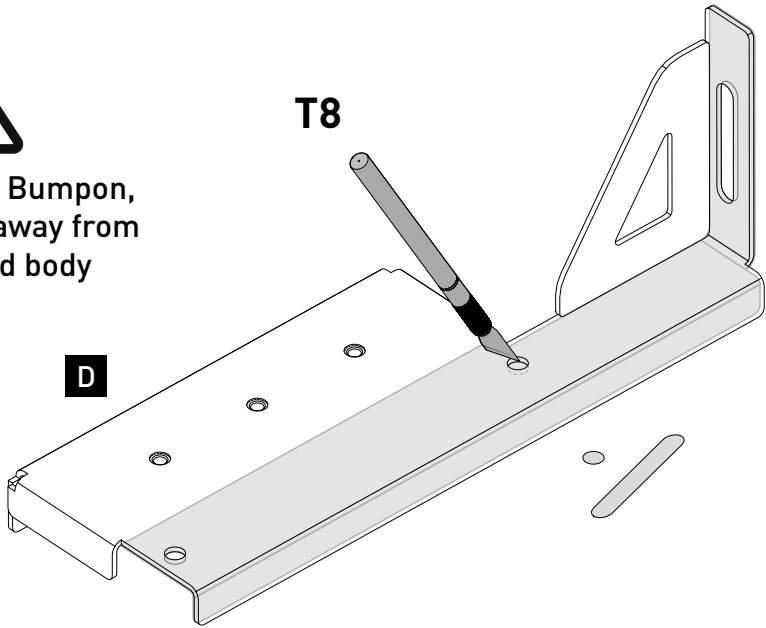

**FR**

**9**



When cutting Bumpon, carefully cut away from fingers and body

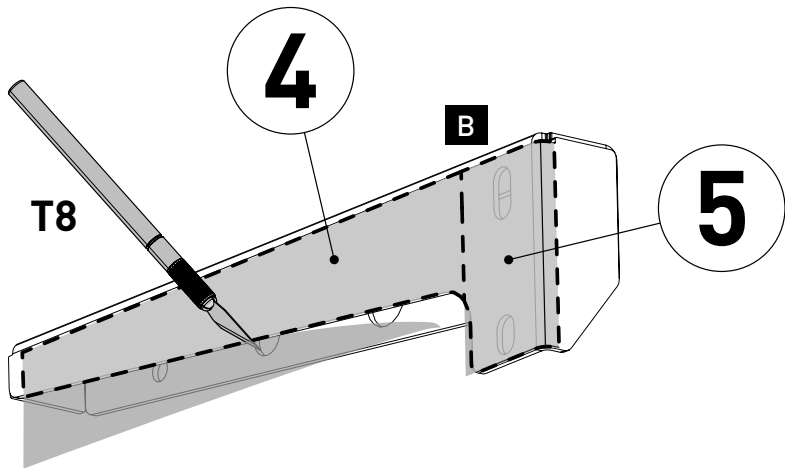

Use **T12** to cut from  
**N** 60 x 400mm Rubber Bumpon

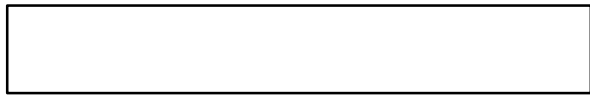

**4**

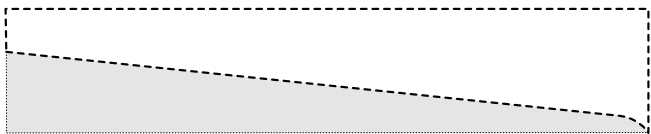

60 x 300mm

Stick to bracket then trim this section

**5**



60 x 100mm

Stick to bracket then trim this section

10

FR

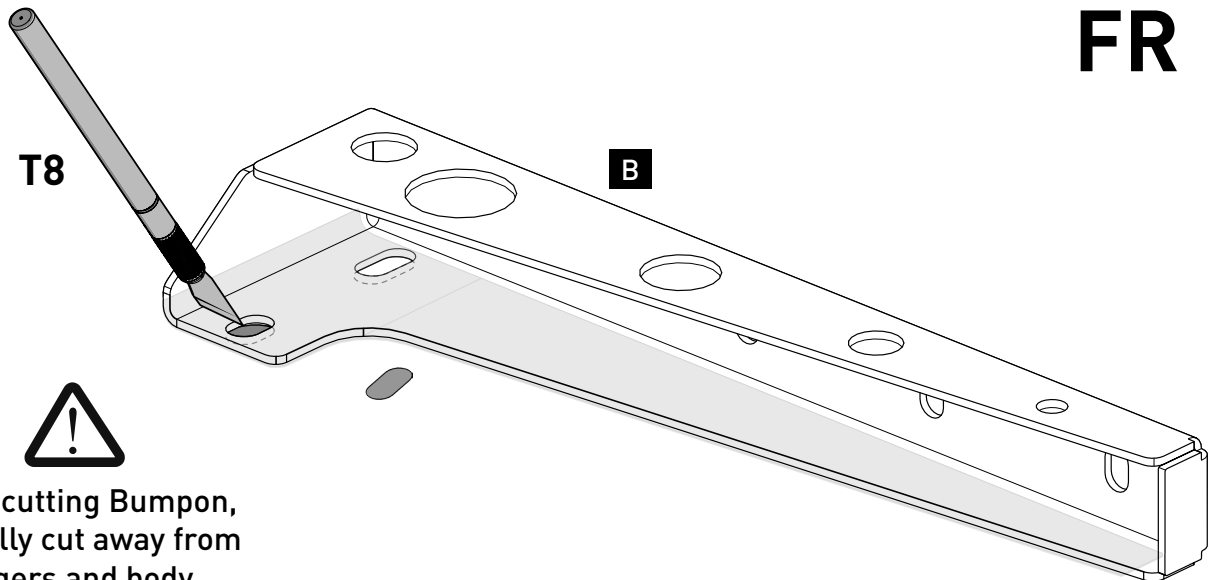

11

RR

When cutting Bumpon, carefully cut away from fingers and body

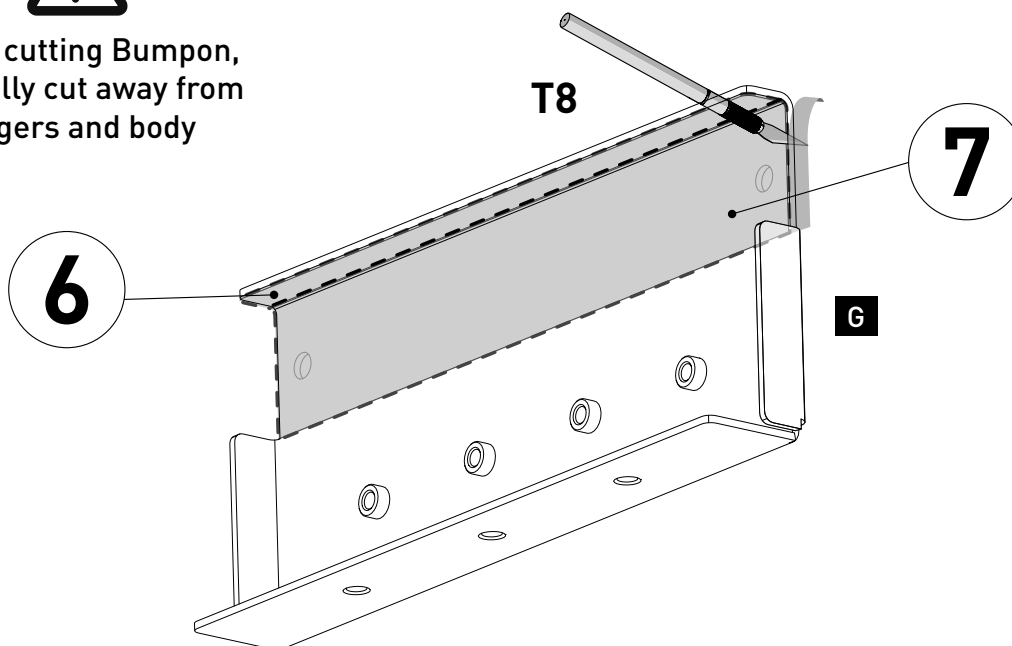
**M**

Use **T12** to cut from  
40 x 400mm Rubber Bumpon

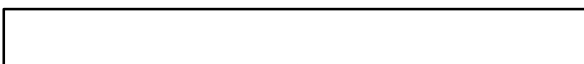
**6**

2 off 17 x 312mm [1 for opposite side bracket **G**]

**N**

Use **T12** to cut from  
60 x 400mm Rubber Bumpon

**7**

60 x 312mm

12

T9



When cutting Bumpon, carefully cut away from fingers and body

13

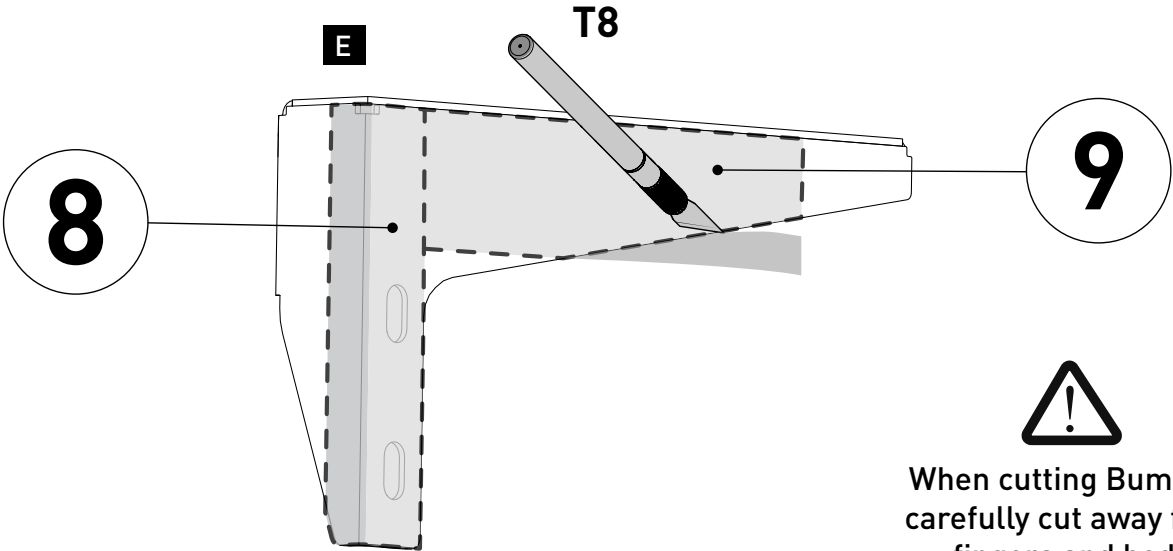

When cutting Bumpon, carefully cut away from fingers and body

Use **T12** to cut from  
**N** 60 x 400mm Rubber Bumpon

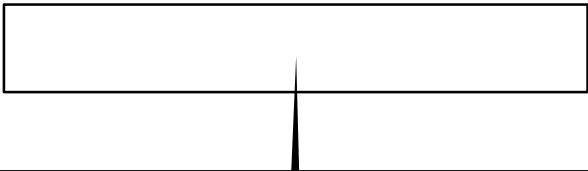

8



60 x 180mm

Stick to bracket then trim this section

9



60 x 220mm

Stick to bracket then trim this section

14

Repeat Steps 7 - 13 to the left hand side brackets

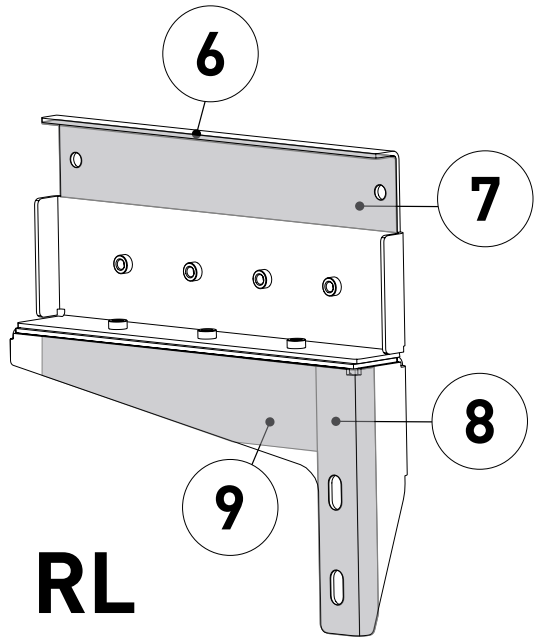
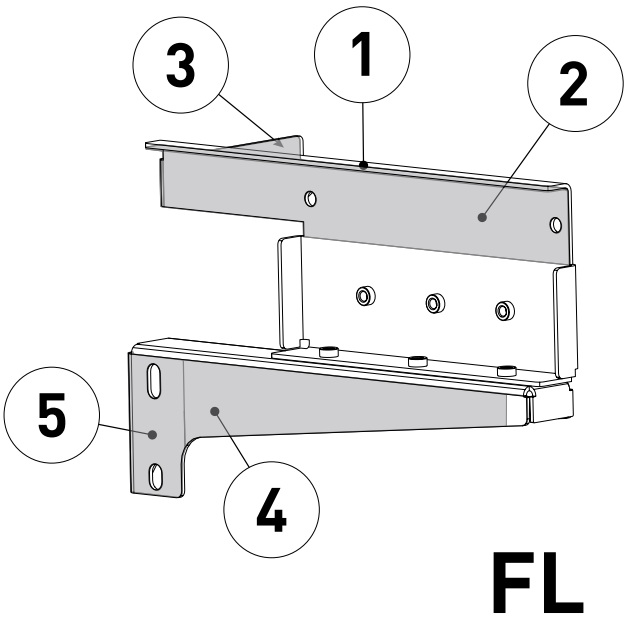

15

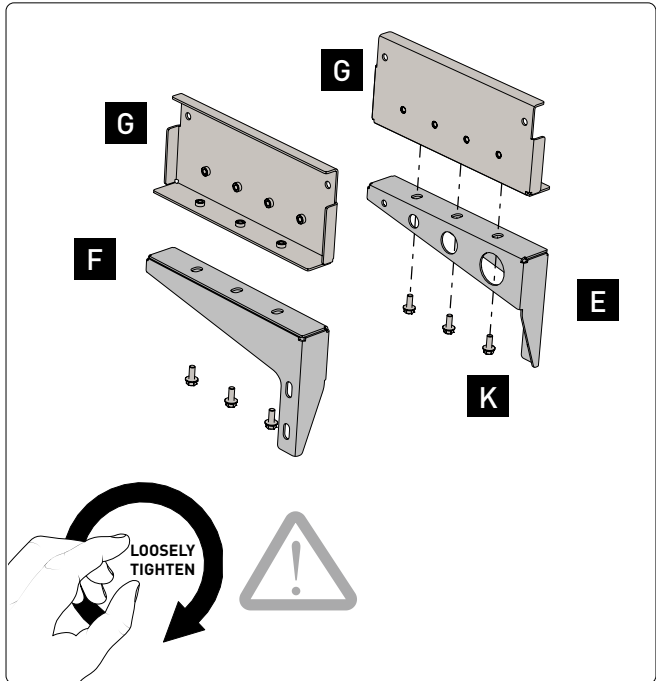
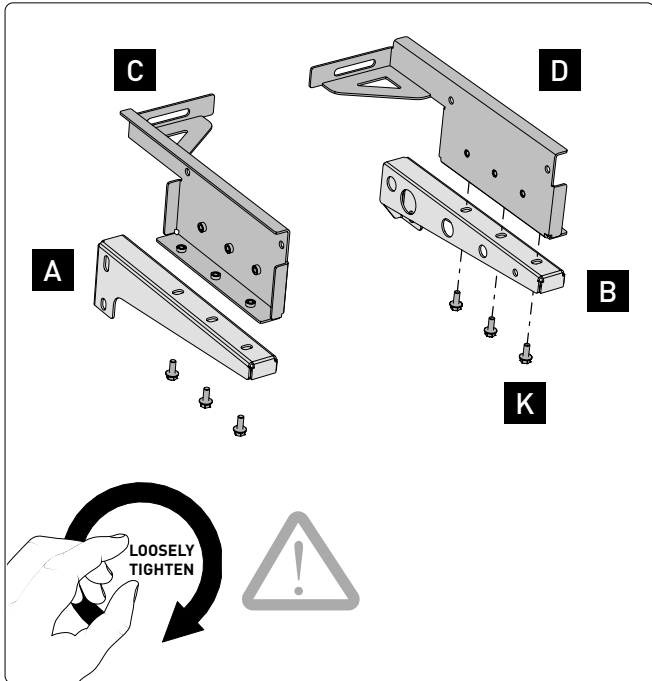
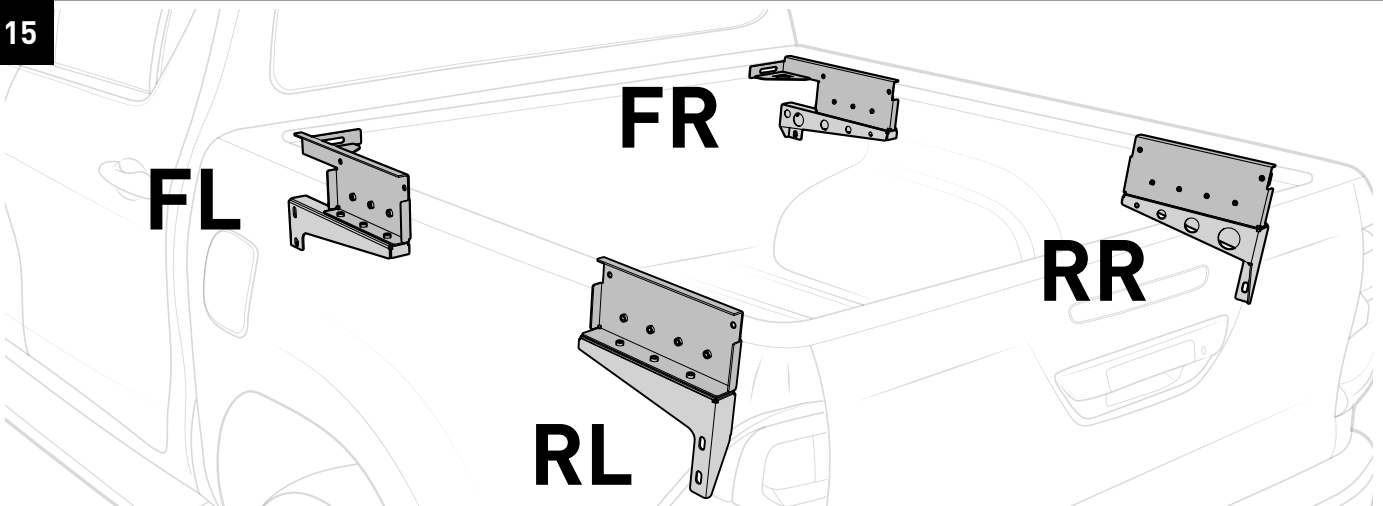

16

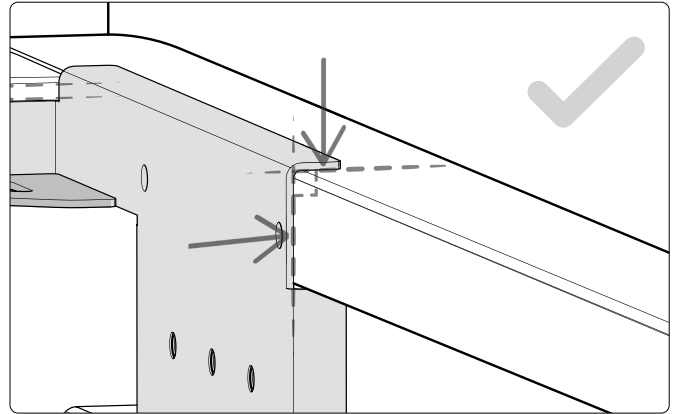
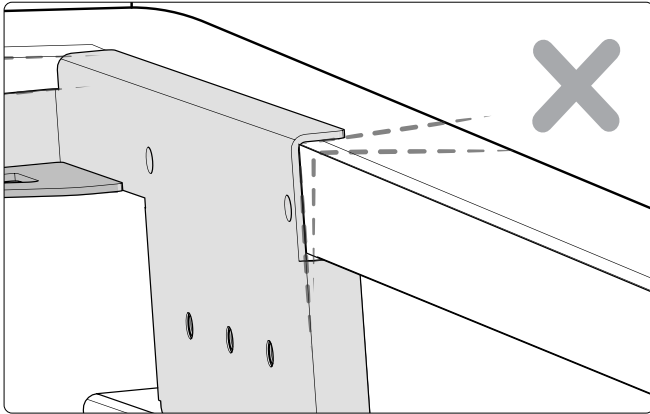
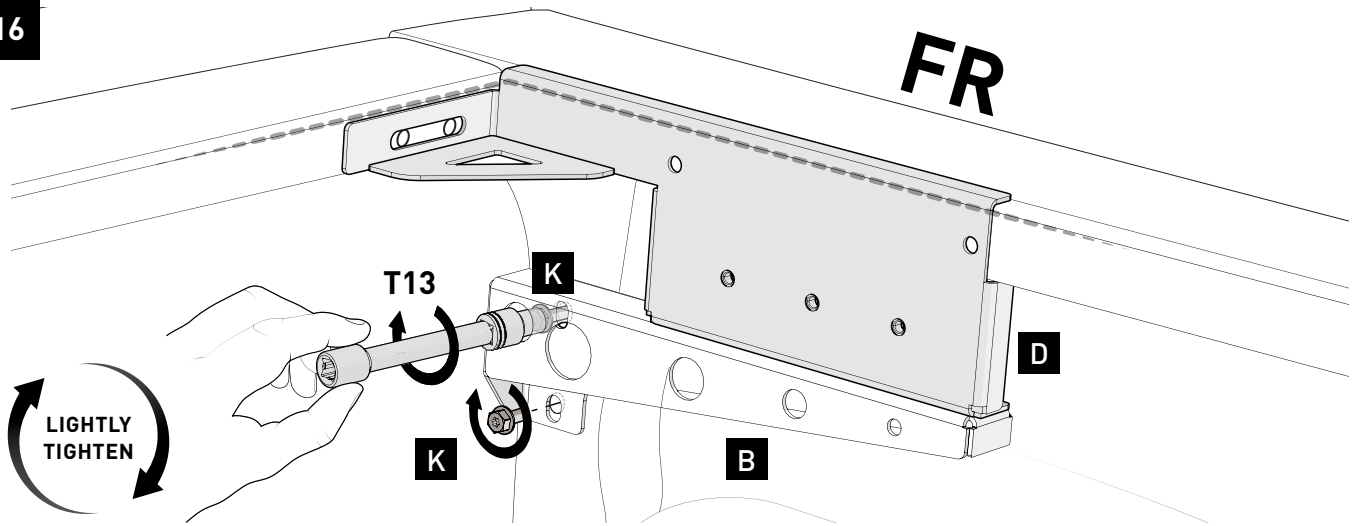
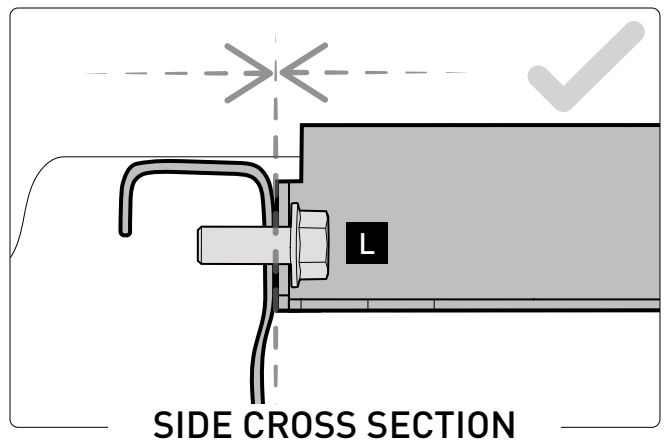
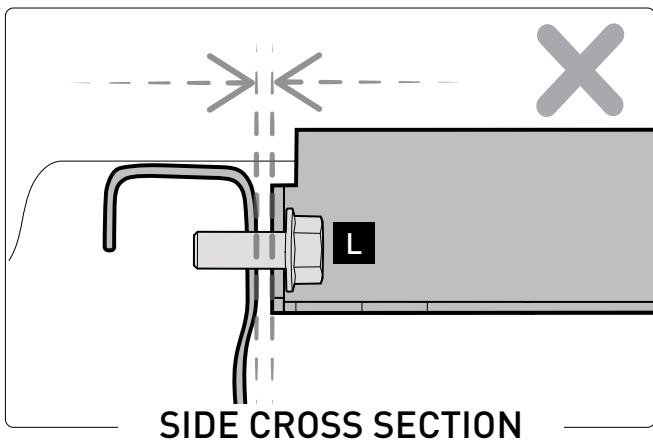
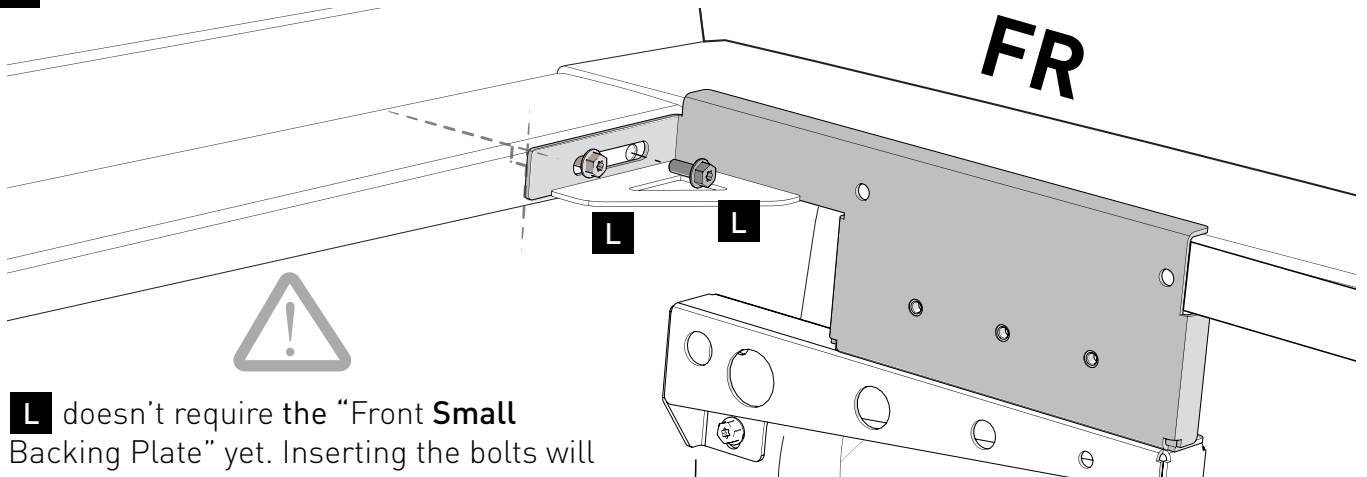
17 Check **L** aligns with pre-existing holes

18

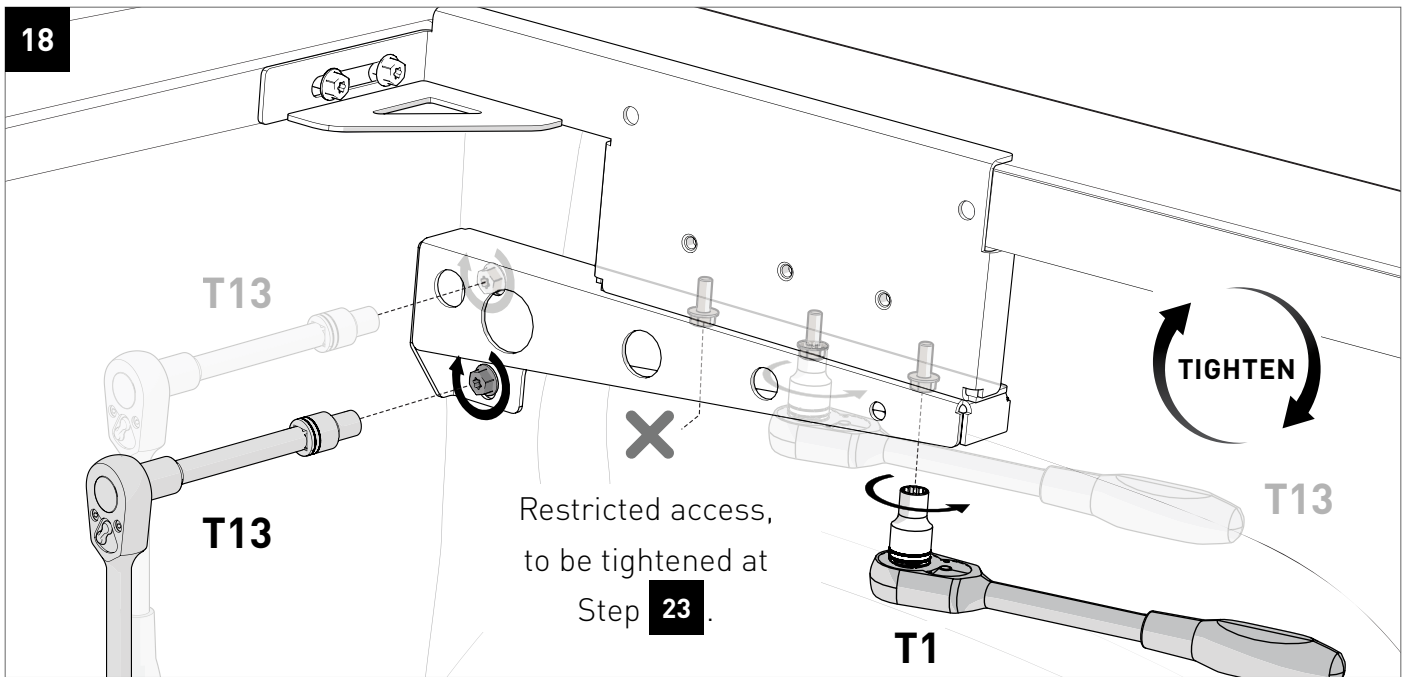

19a

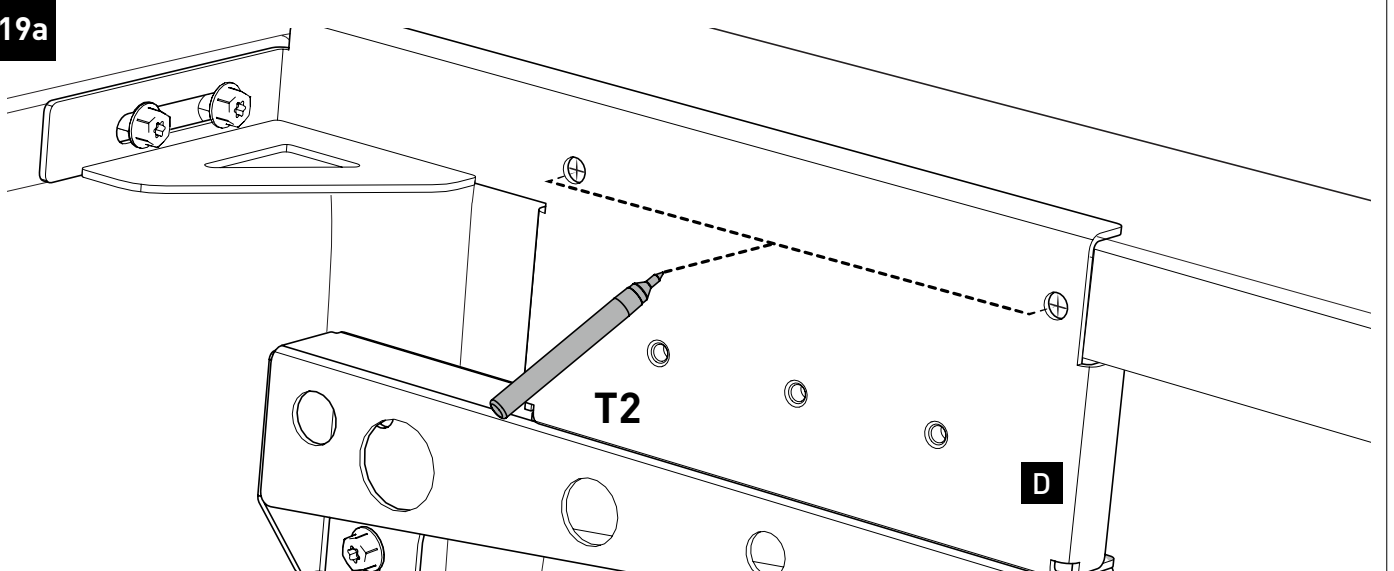

For tubs with pre drilled roll bar holes refer to Step **19b** otherwise proceed to Step **20**

### 19b FOR TUBS WITH ROLL BARS REMOVED

If pre-existing hole from Roll Bar (removed at Step **1**) is misaligned to bracket hole, trace the edge of the bracket hole onto the tub ready to enlarge the hole in Step **24b**.

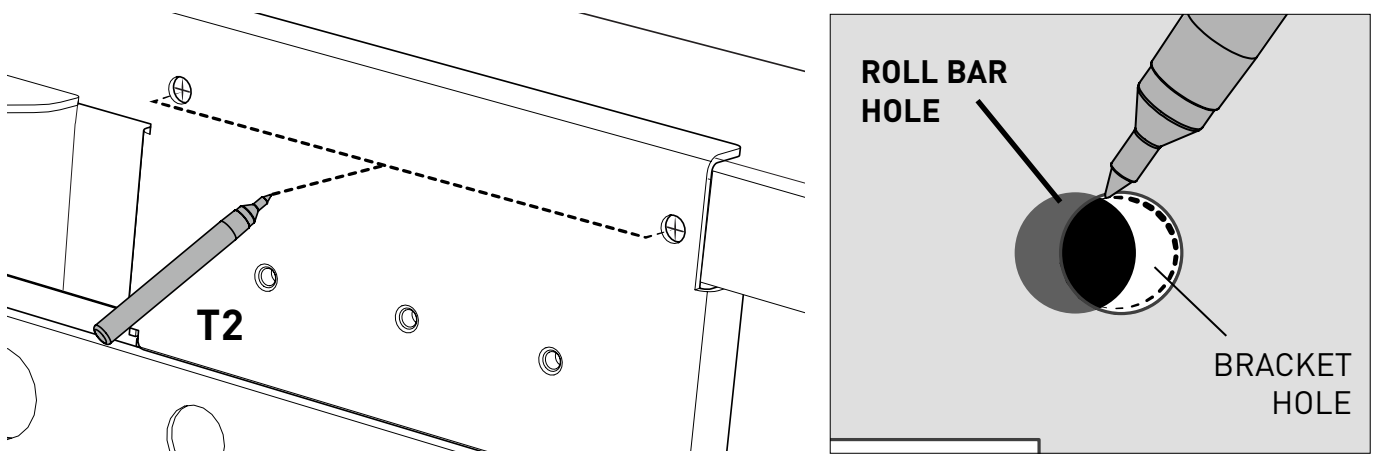



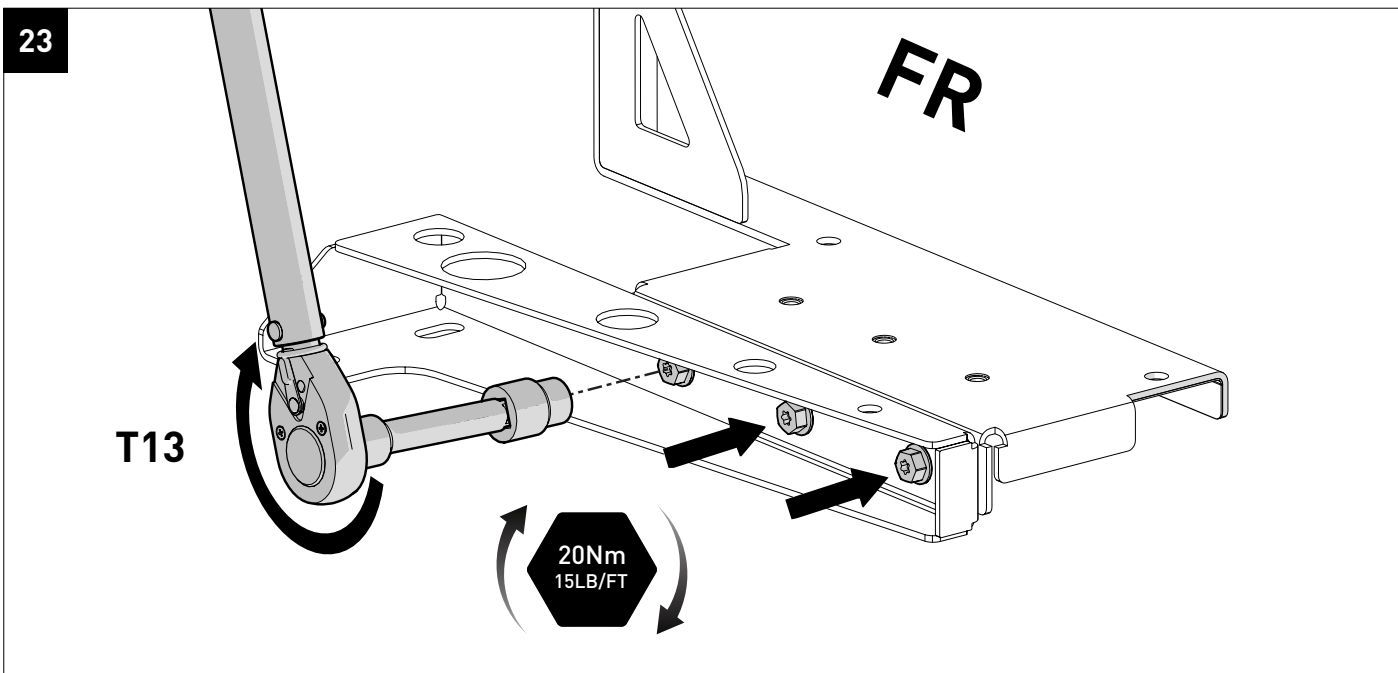
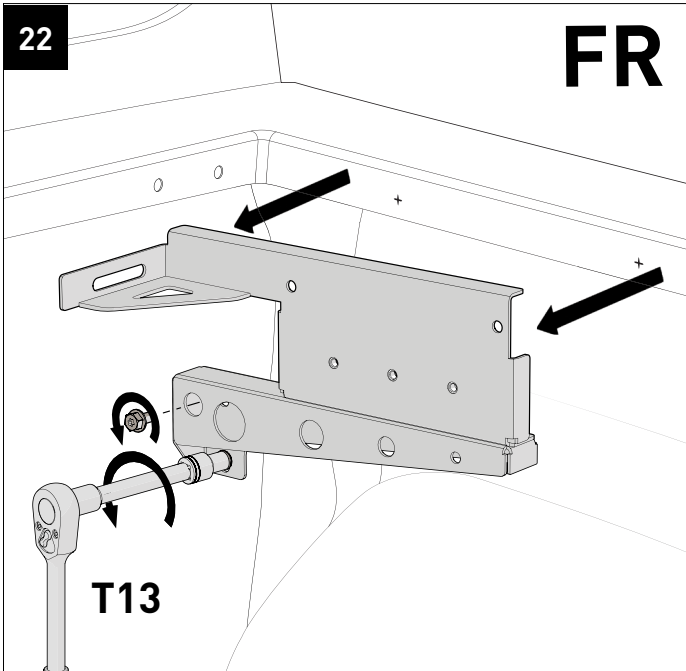
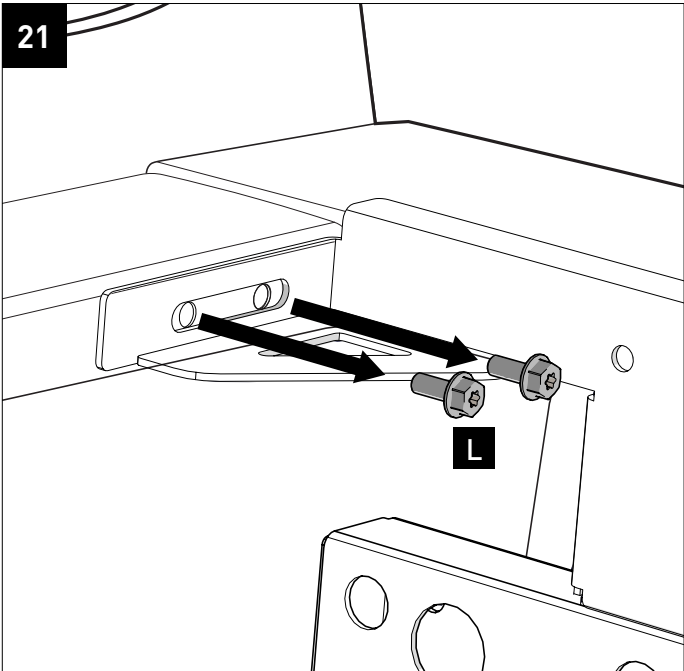
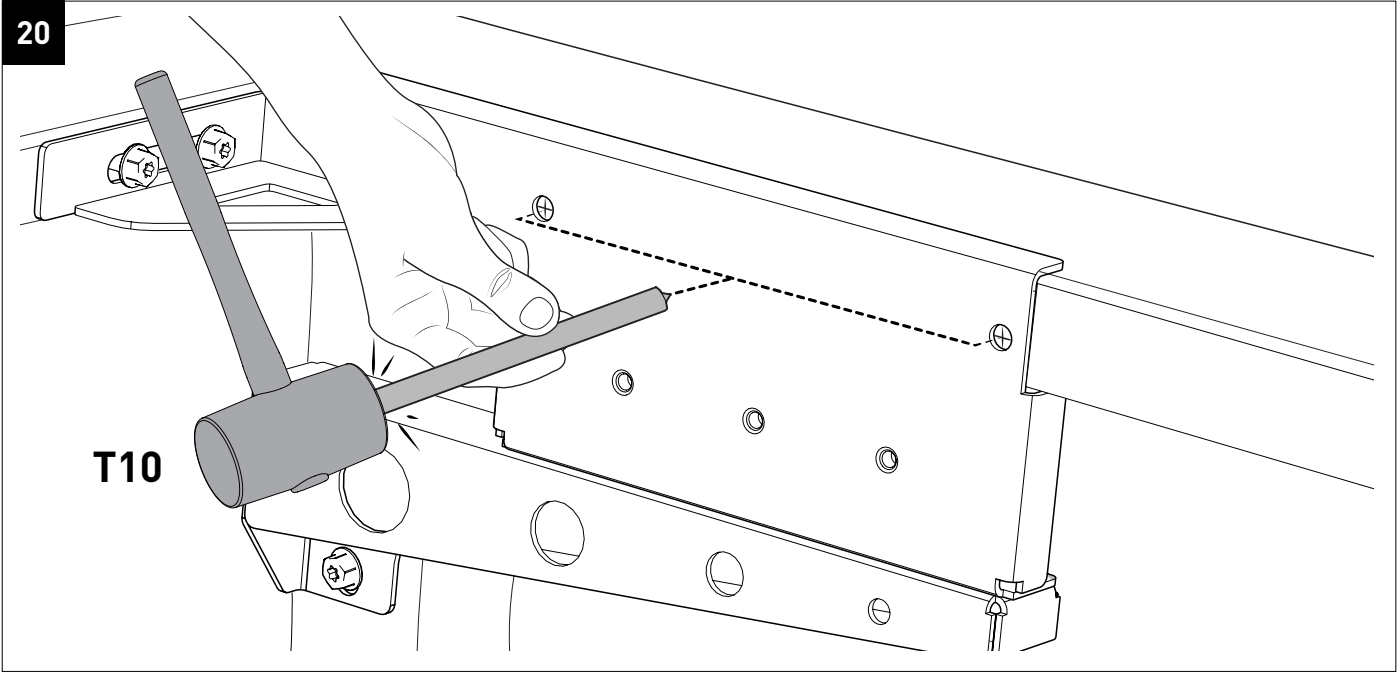

- 24a** If pre-existing Roll Bar hole was marked, proceed to Step **24b** to enlarge hole.

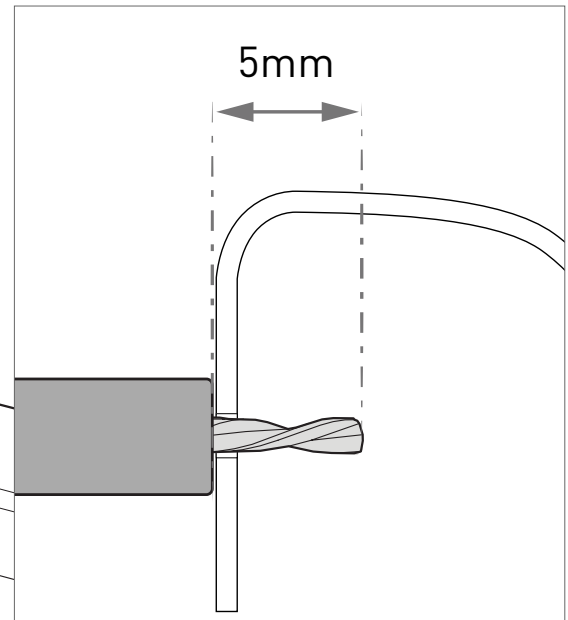
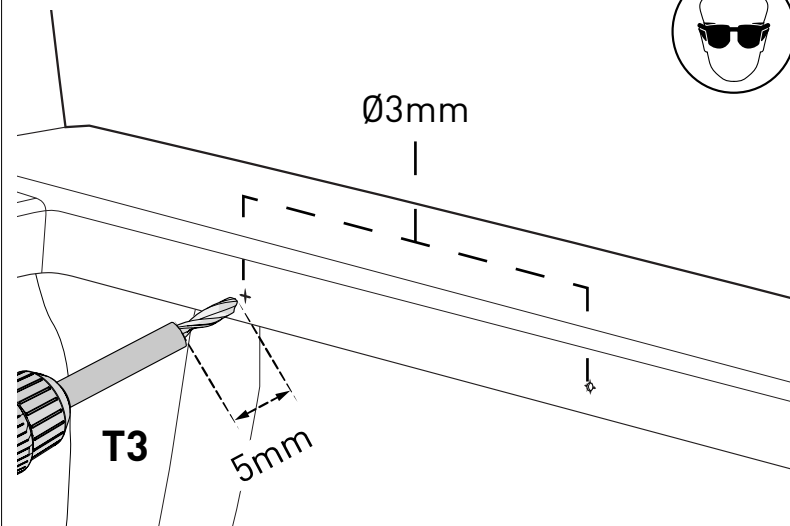

**24b FOR TUBS WITH ROLL BARS REMOVED**

If required, enlarge and/or extend the existing hole to the marked outline made at Step **19b**

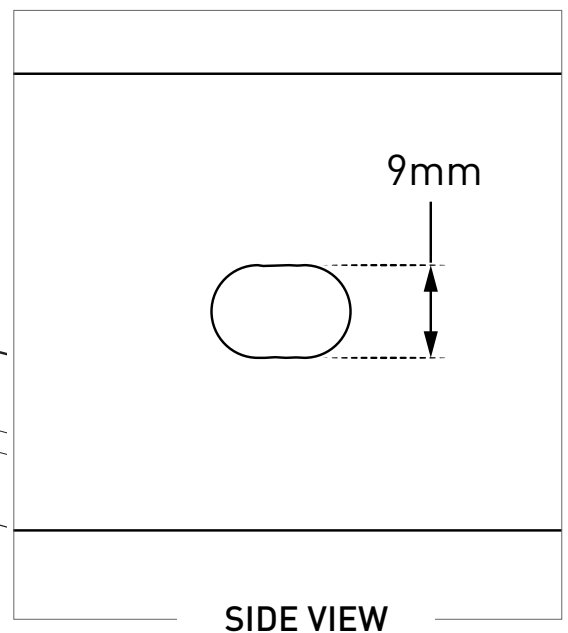
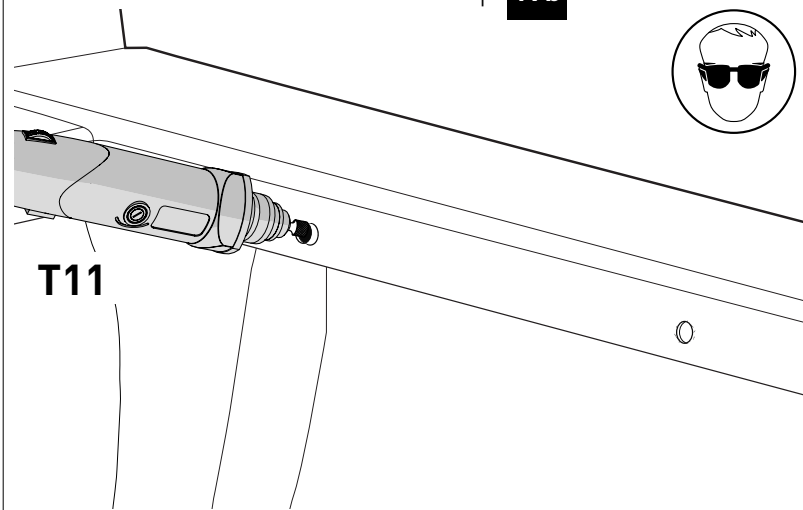

**25**

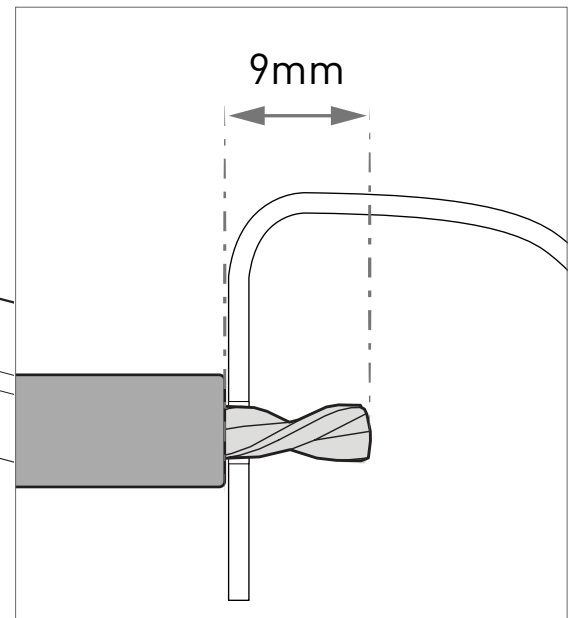
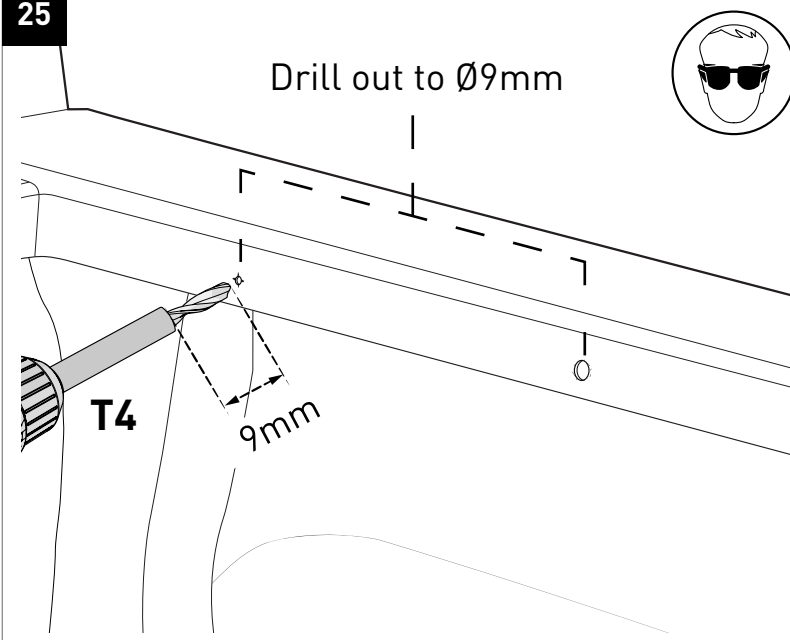

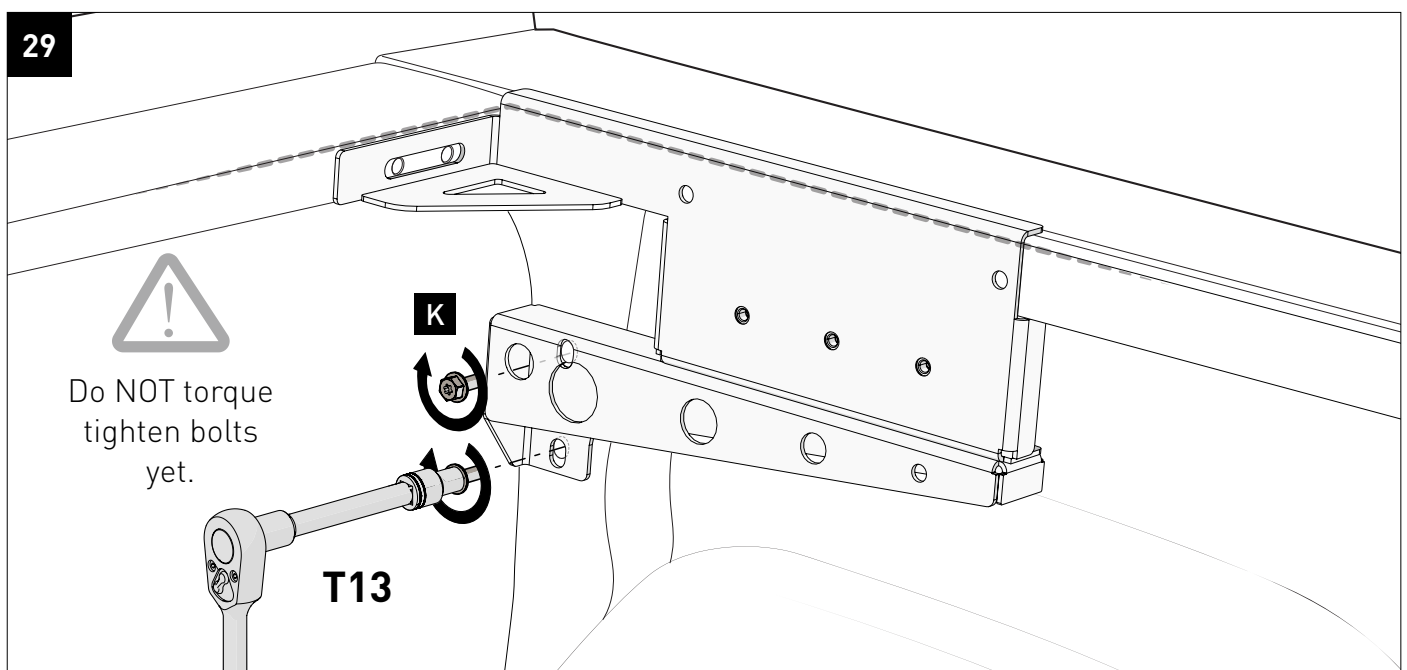
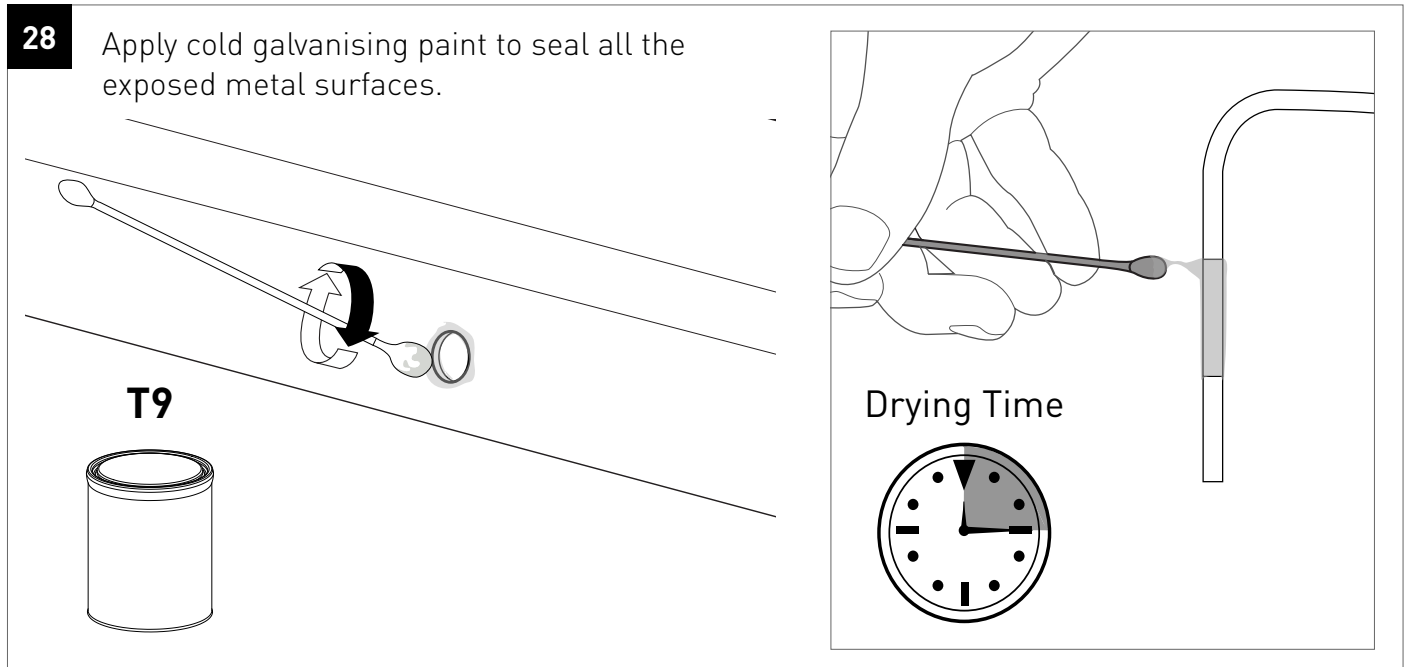
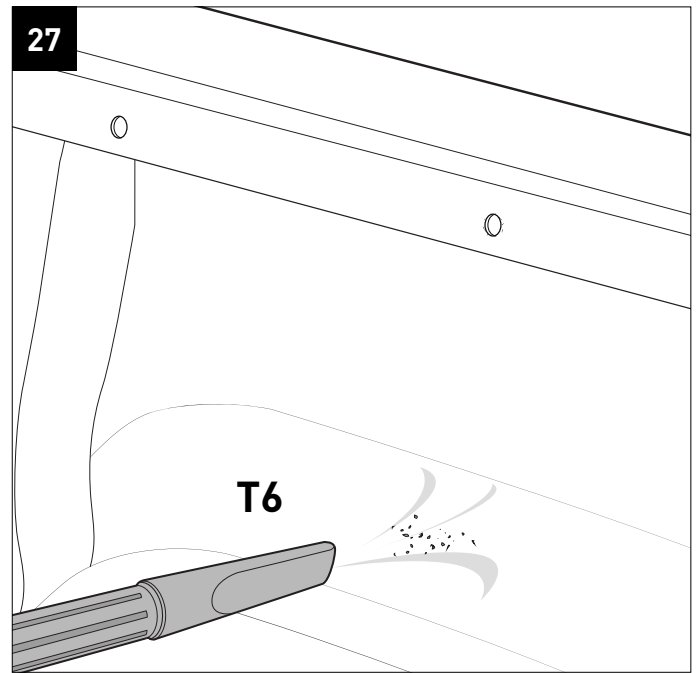
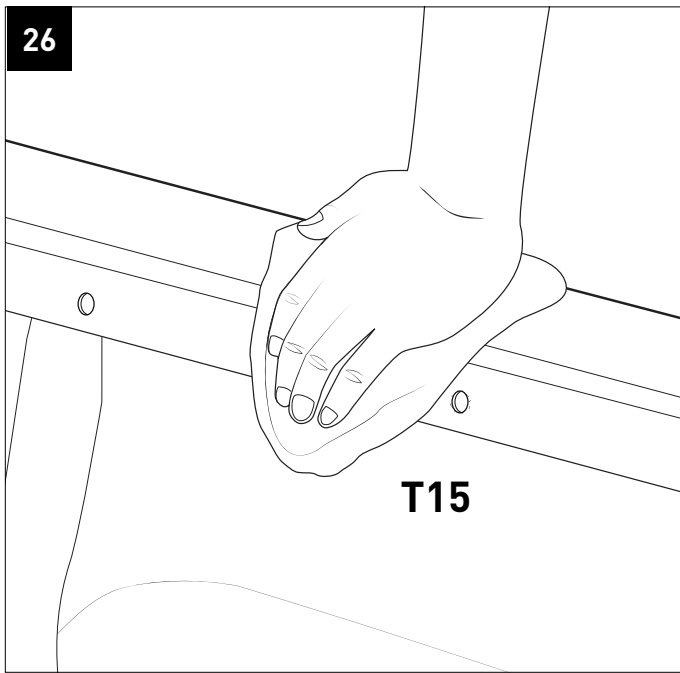

30



Remove tonneau cover if access is restricted between the cabin and tub

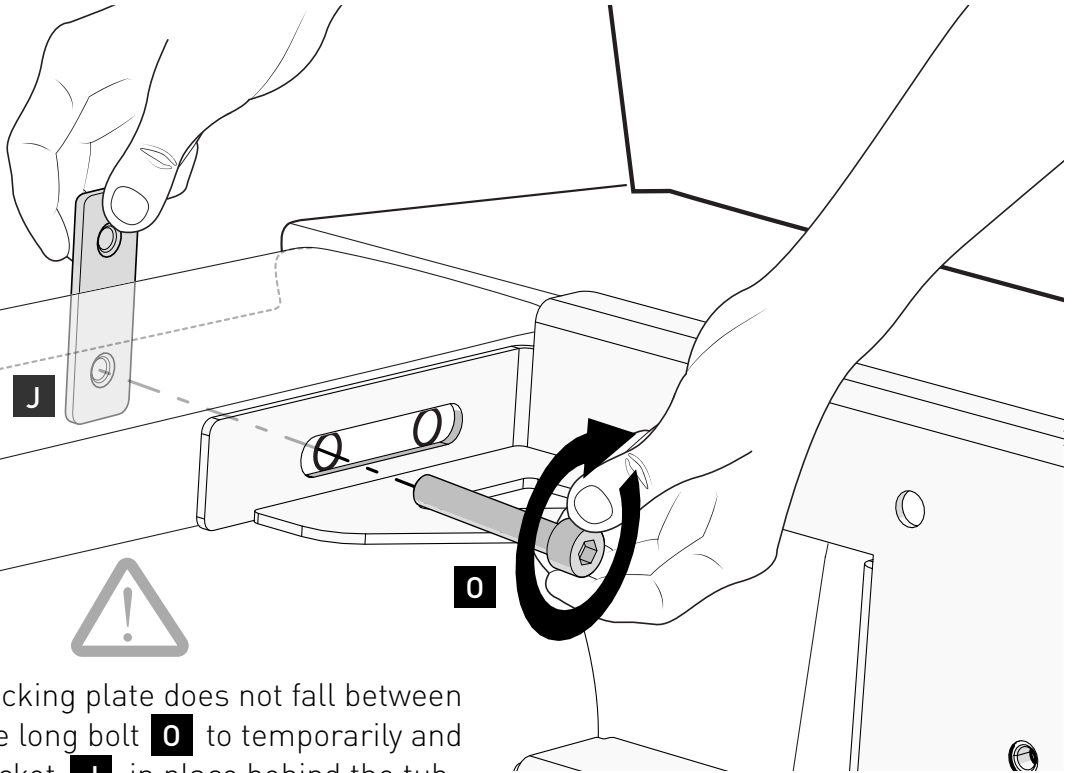

Take care that backing plate does not fall between cab and tub - Use long bolt **O** to temporarily and loosely hold bracket **J** in place behind the tub

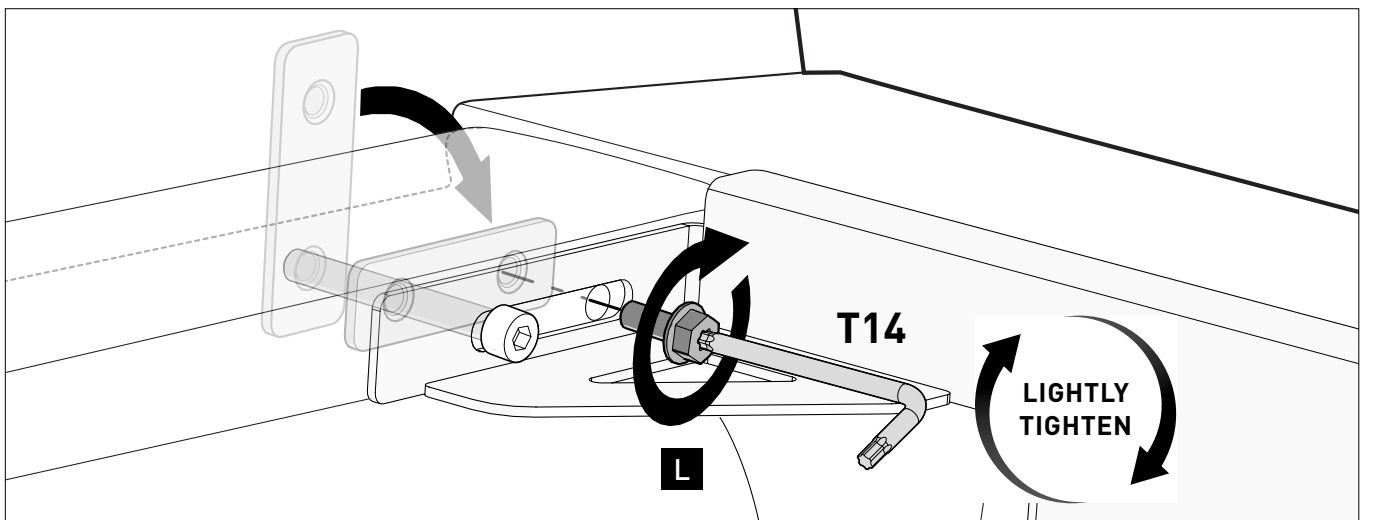

31



Store **O** in a safe place to use on the opposite side

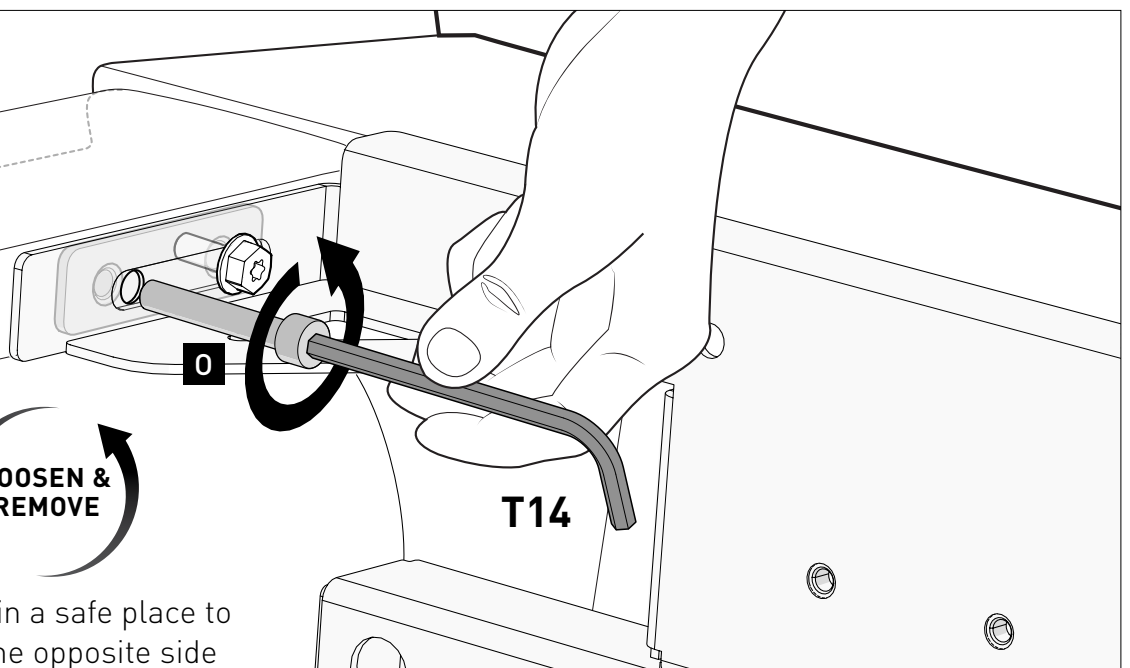

32

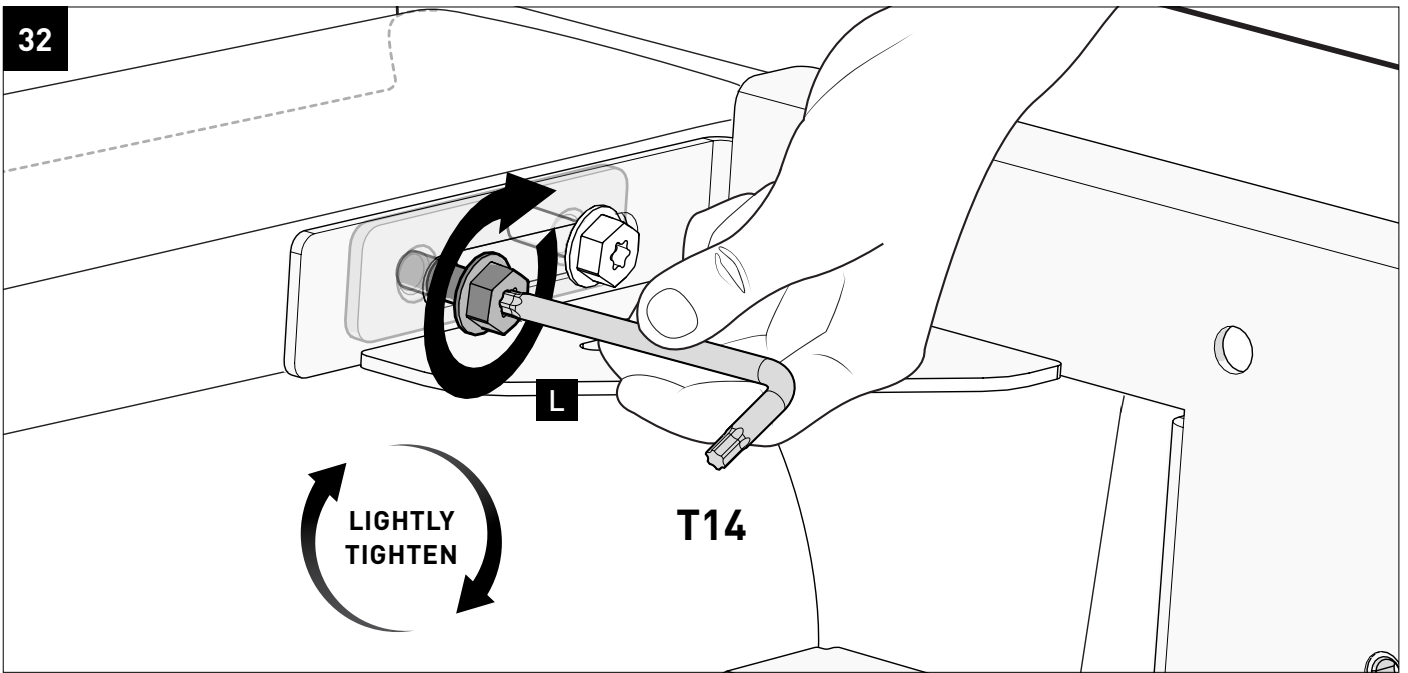

33

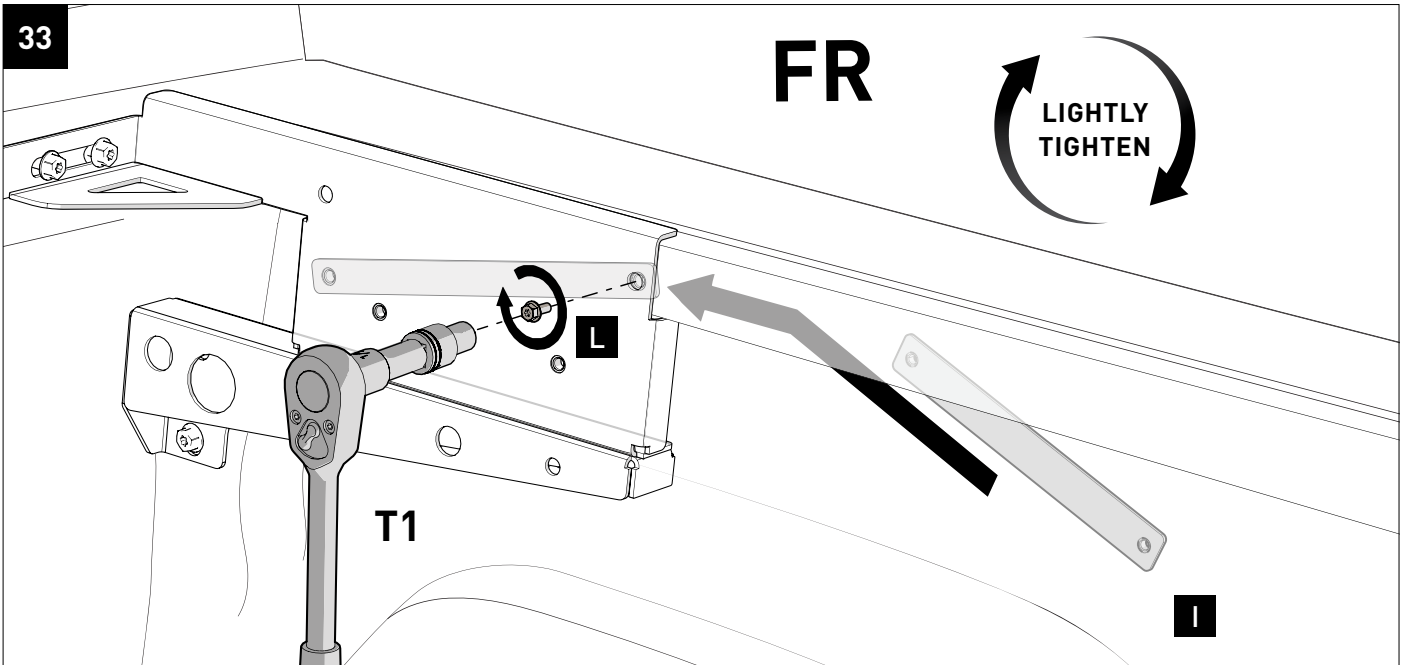

34

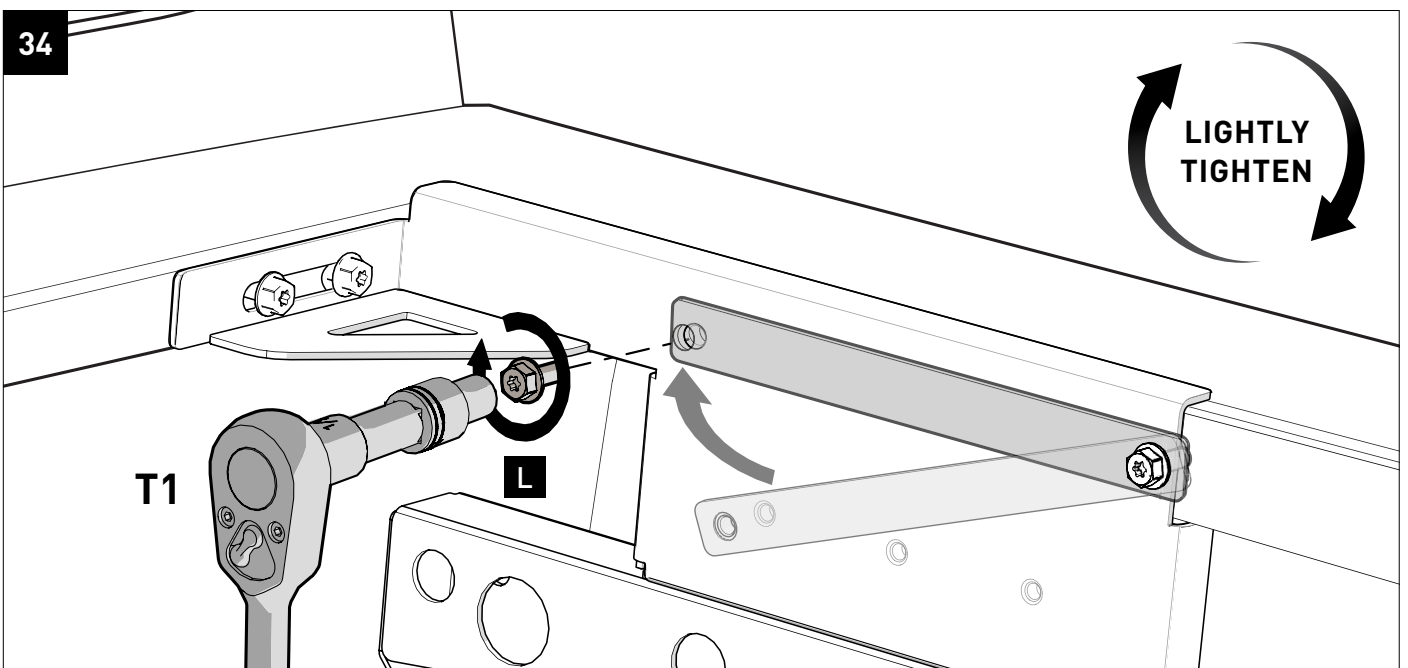

35

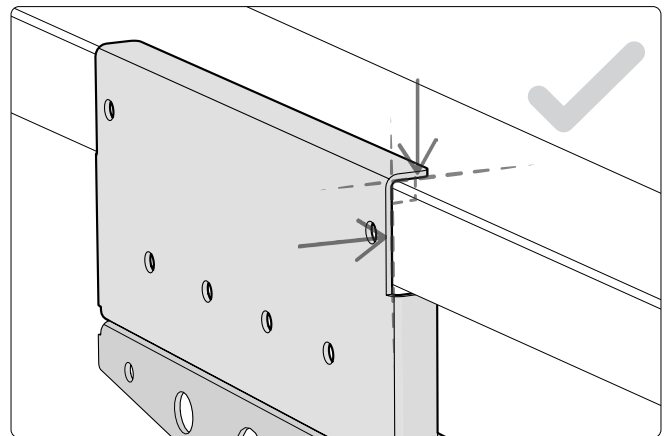
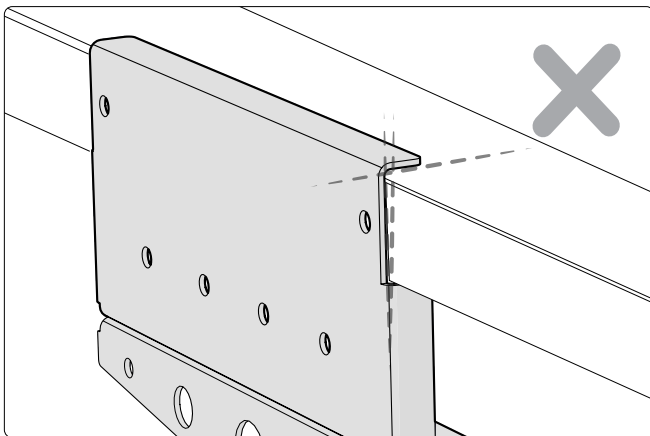
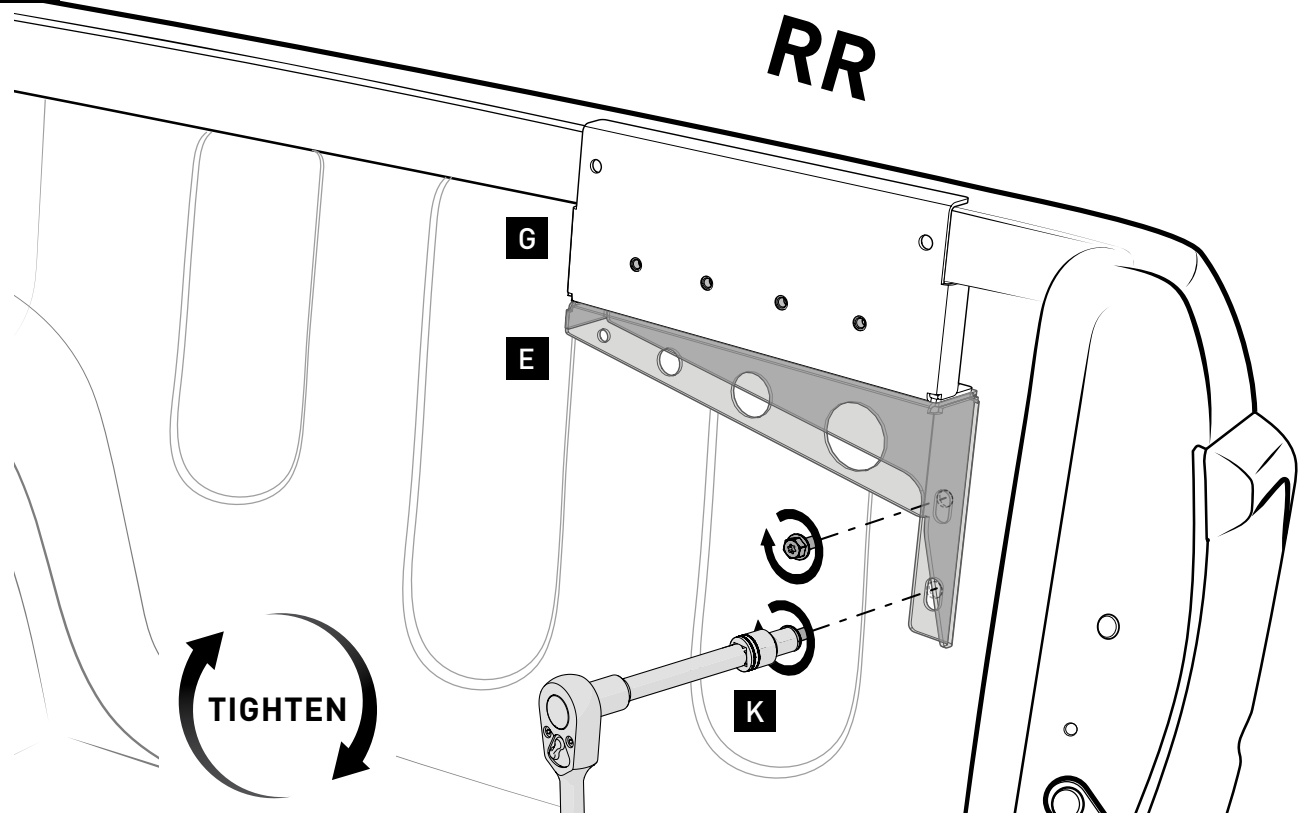

36

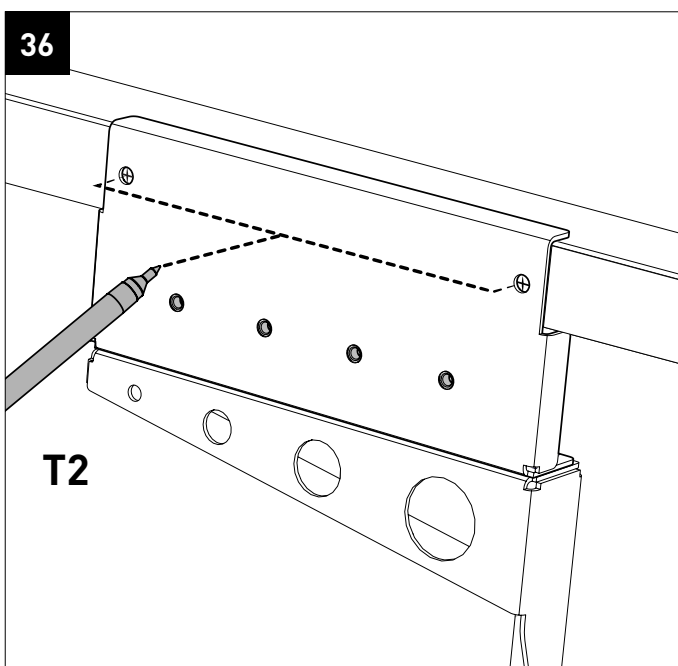

37

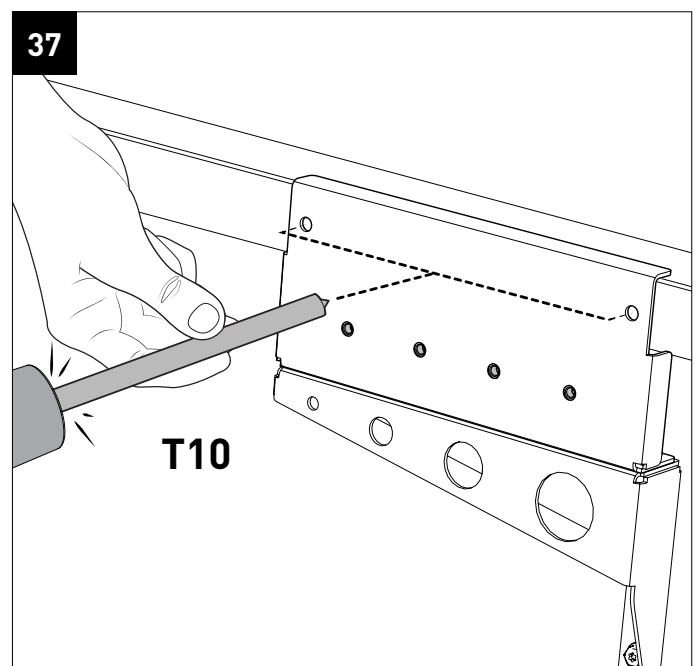

38

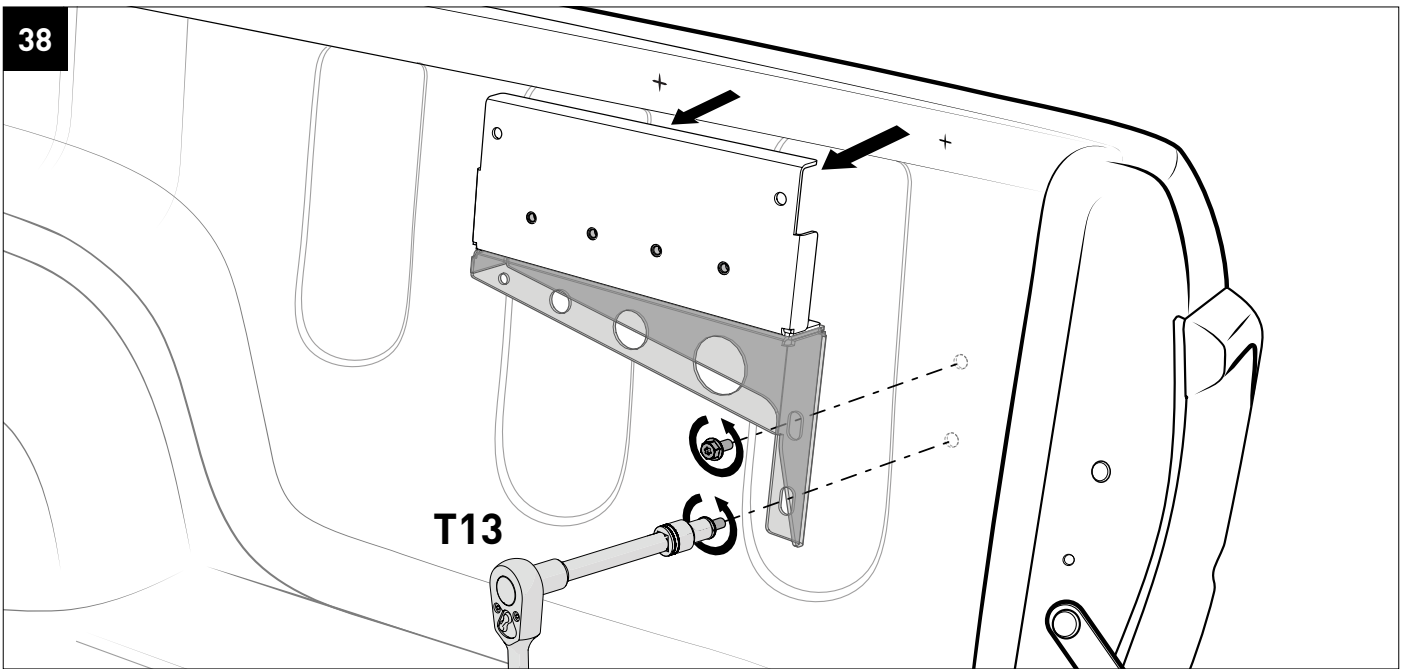

39

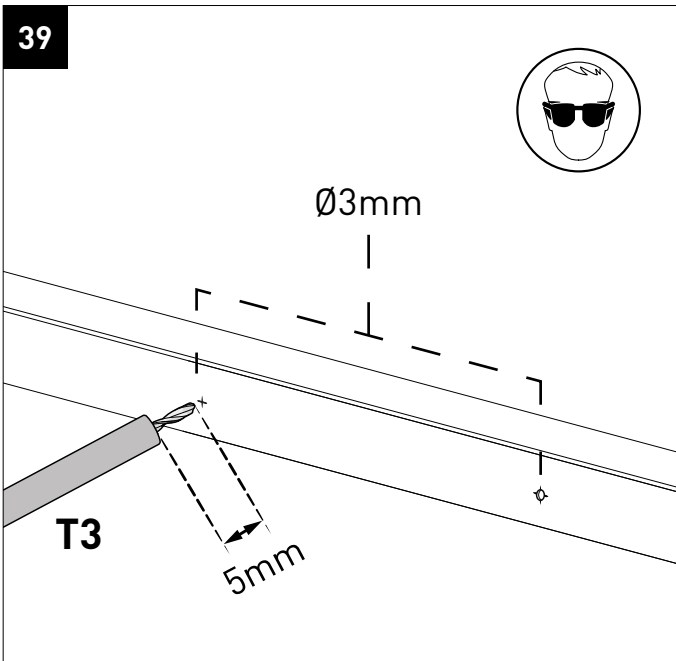

40

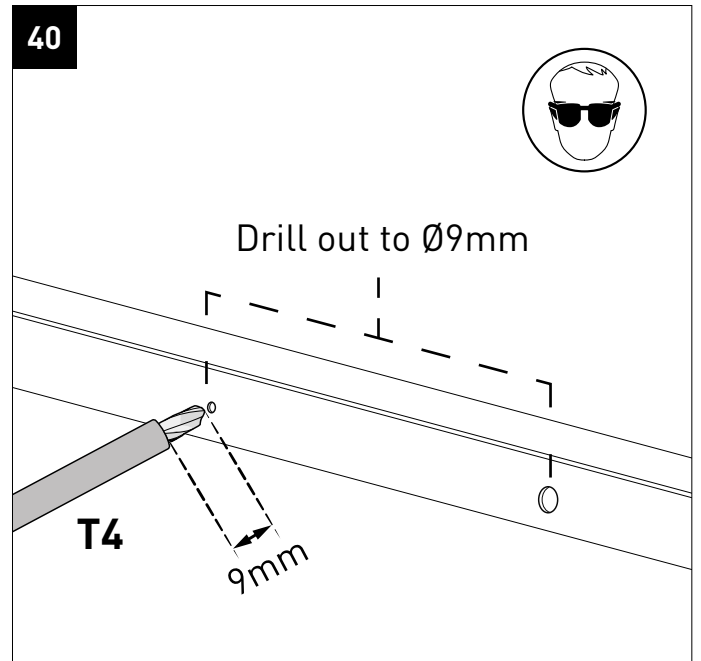

41

Apply cold galvanising paint to seal all the exposed metal surfaces.

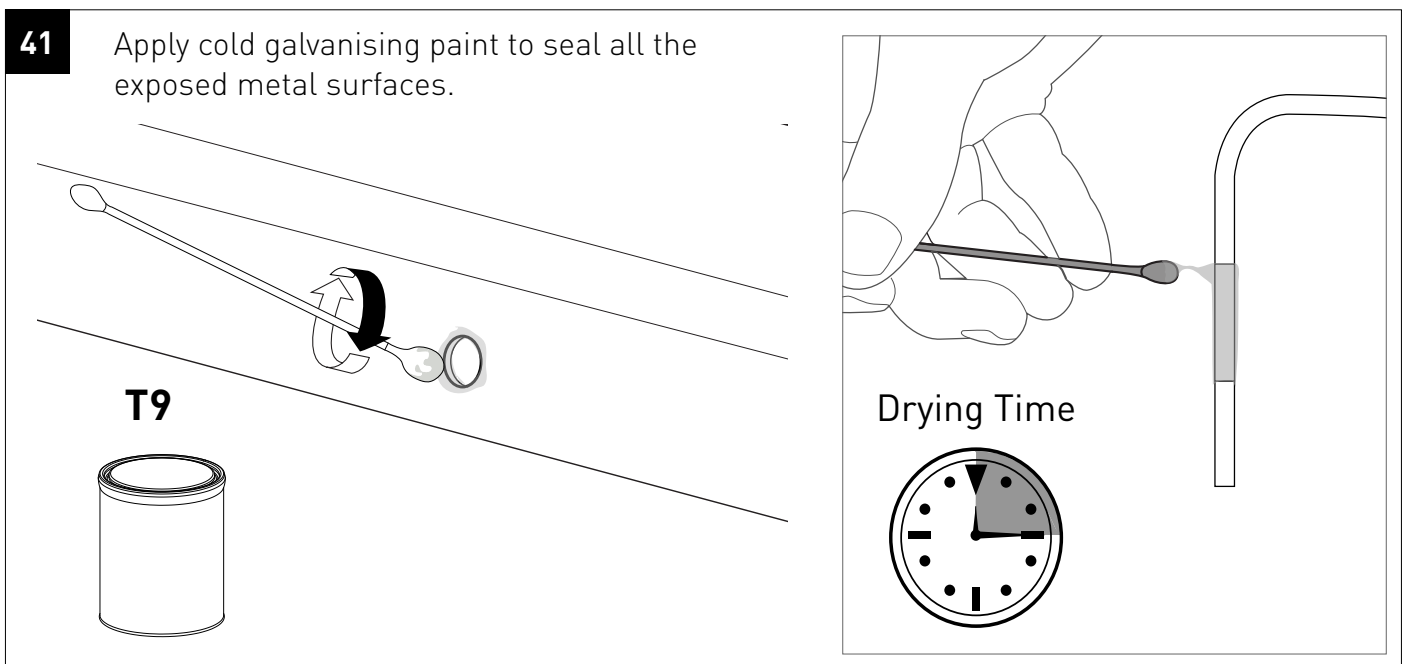

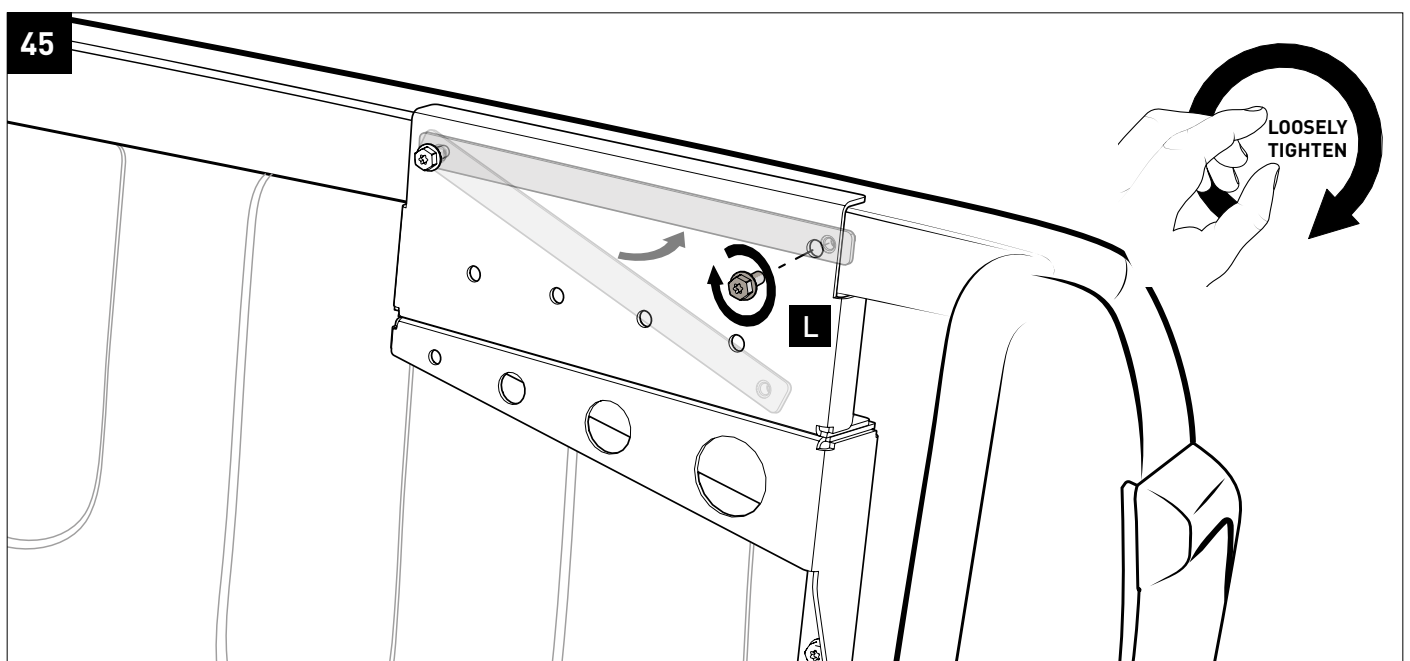
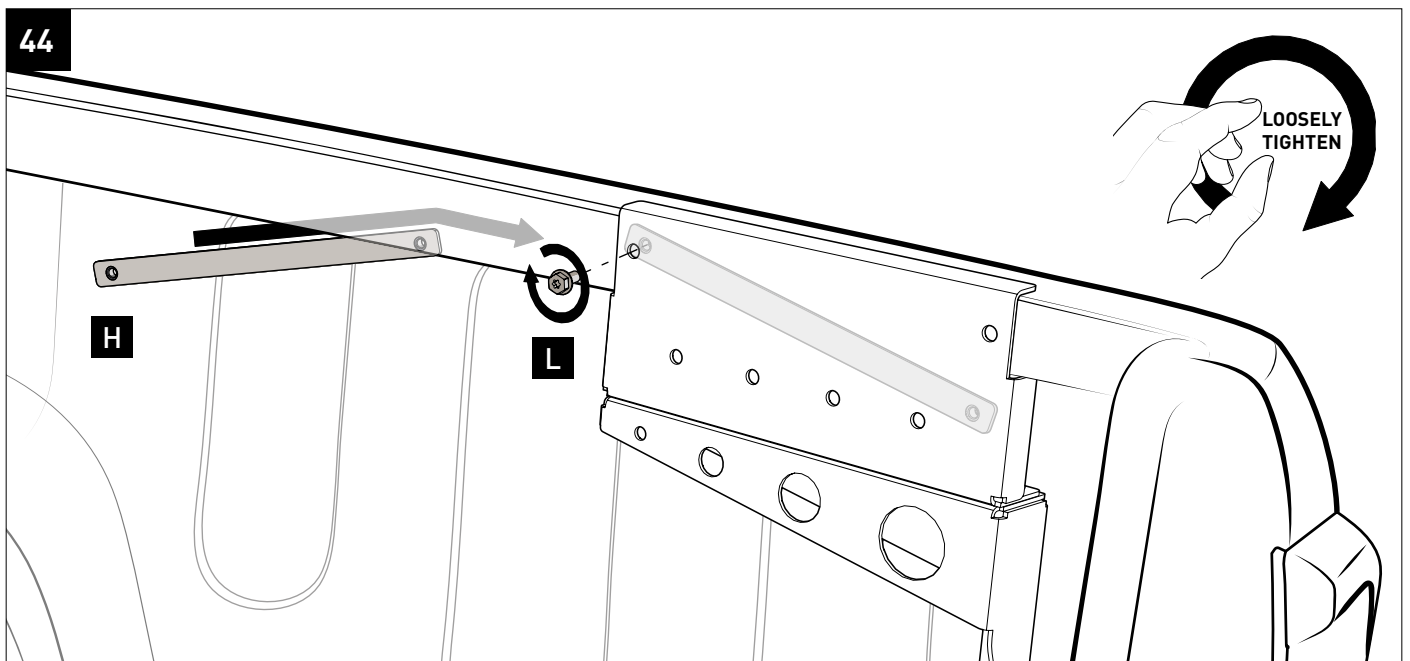
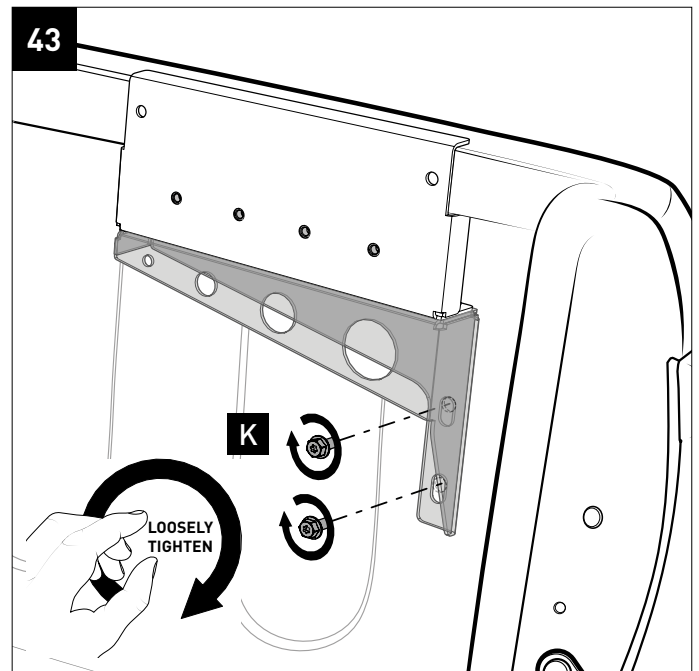
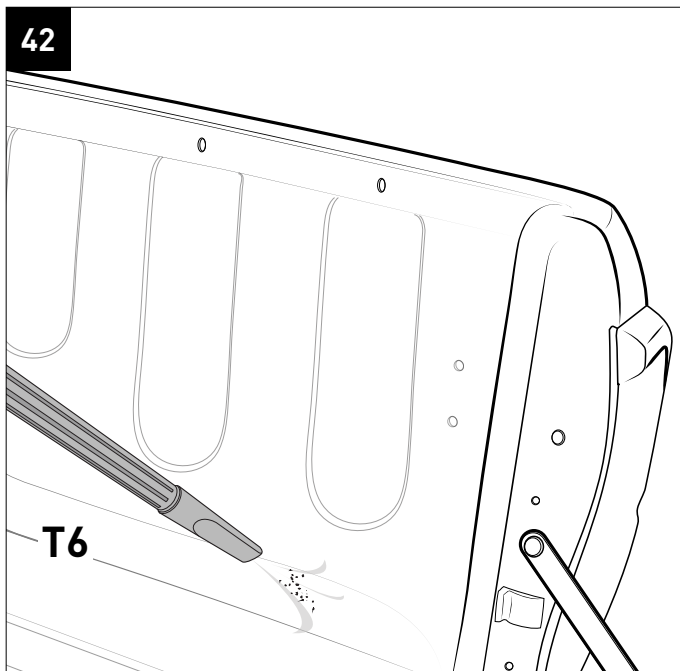



46

Torque tighten all bolts

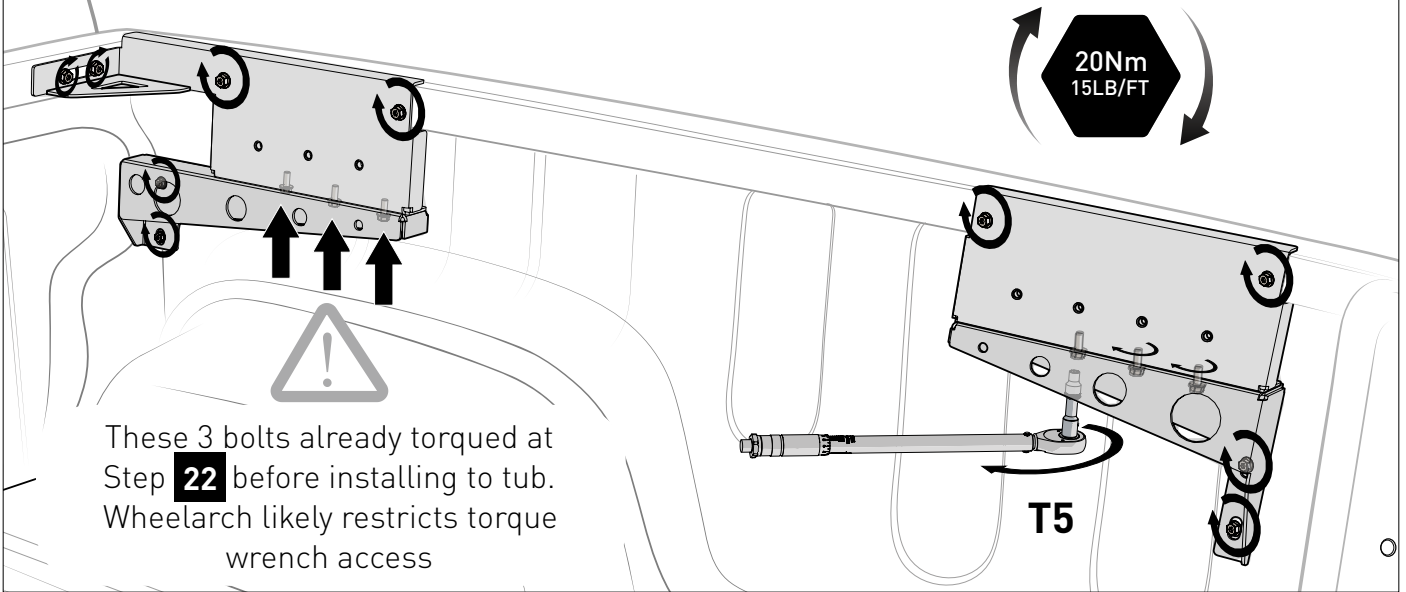

47

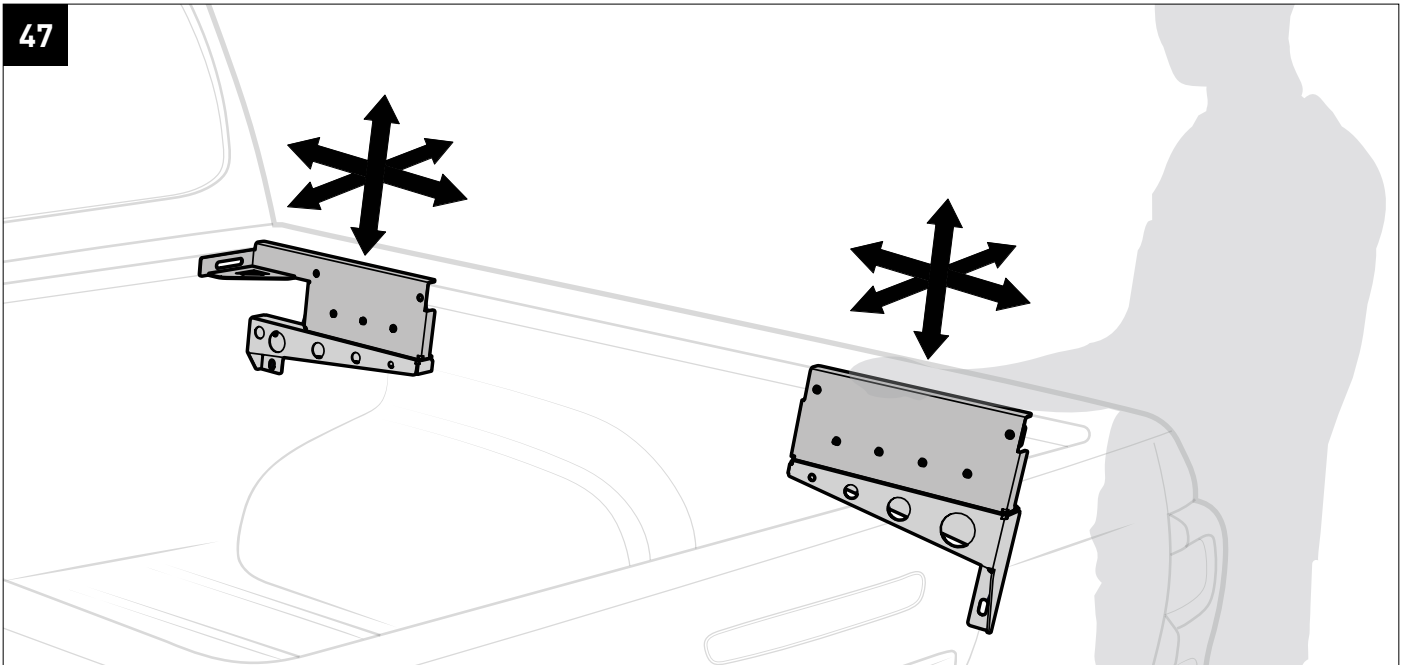

48

REPEAT STEPS 16 -47 TO INSTALL TO THE OPPOSITE SIDE

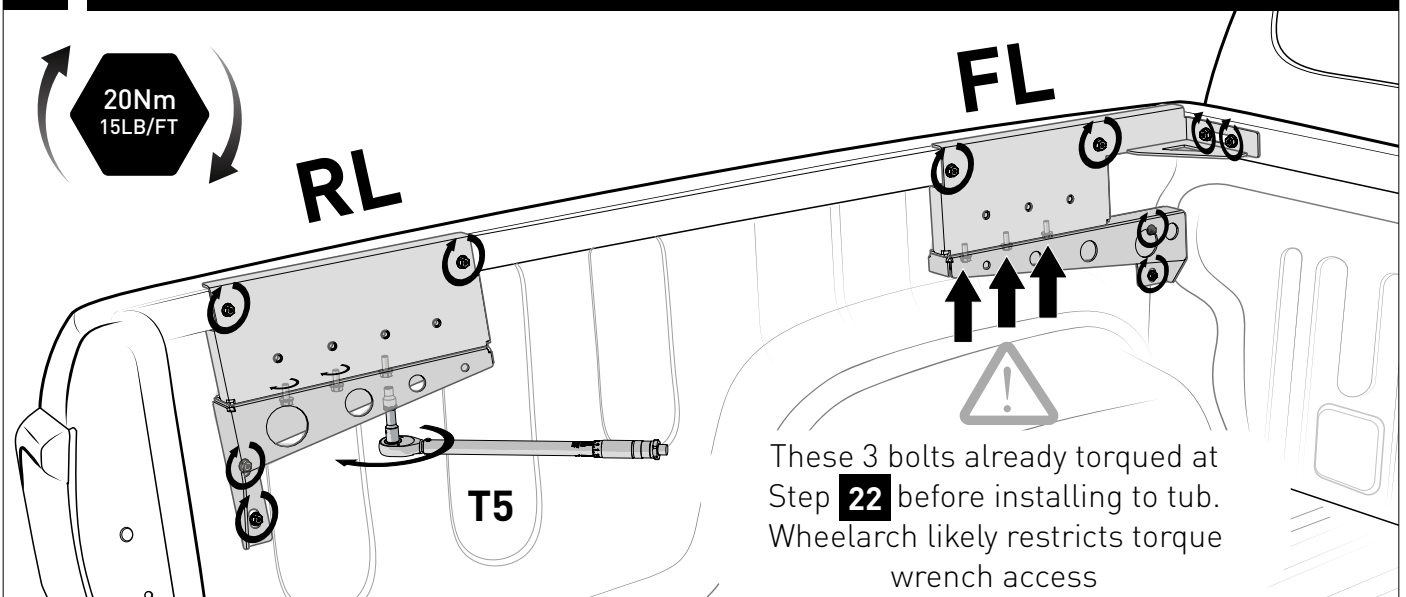

Use the remaining **L** x 12 bolts to proceed to Reconn Deck Towers Installation.

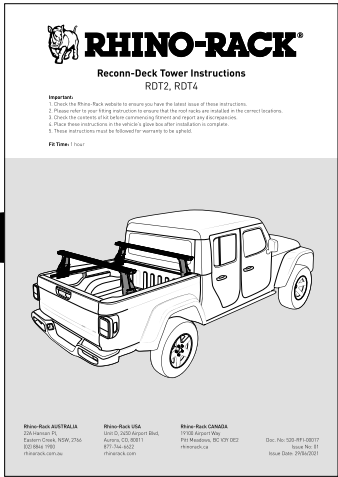
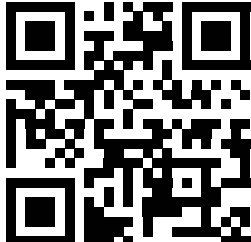

**STANDARD TOWER POSITION**

SUITS FITMENT TO THE BELOW RACKS:

**PIONEER PLATFORM**

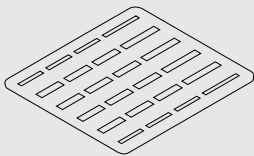

**RECONN-DECK CROSSBAR WITH  
750mm NS BAR (RDNSB75):**



**STANDARD TOWER POSITION**

For larger distance between Reconn-Deck or VA crossbars the rear Tower can be mounted in the rearmost three holes.

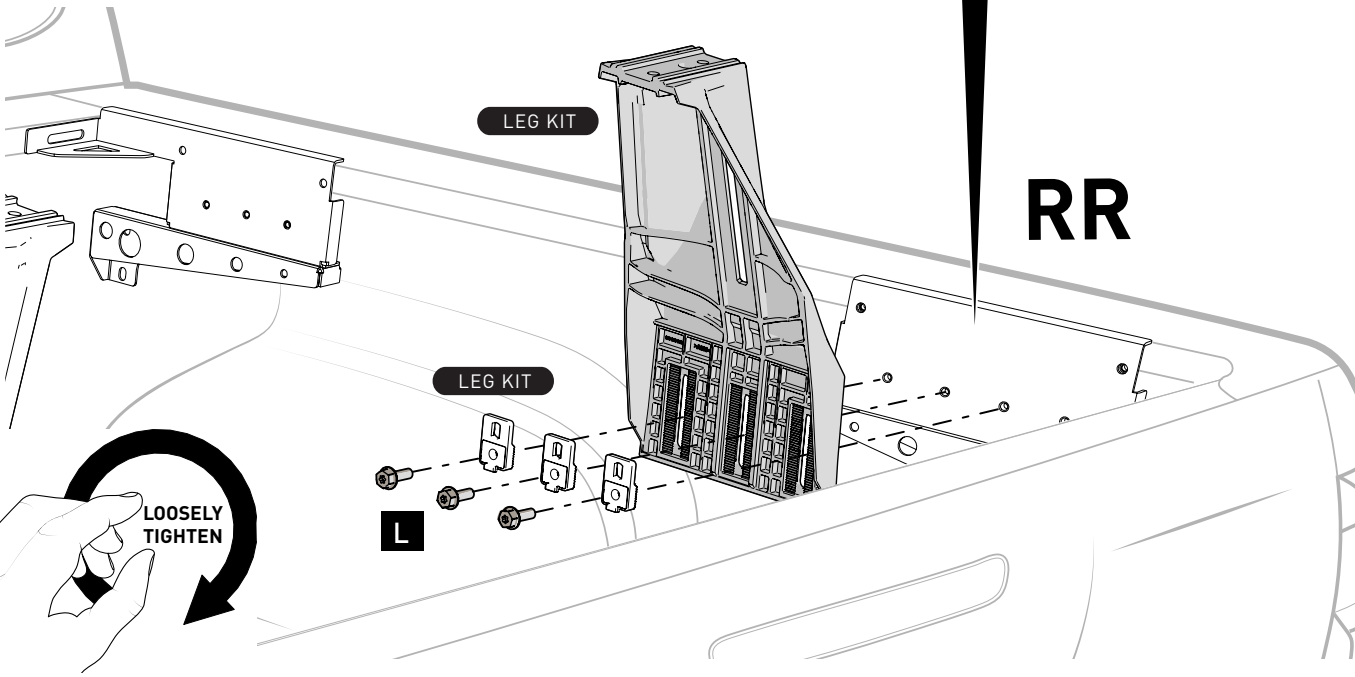
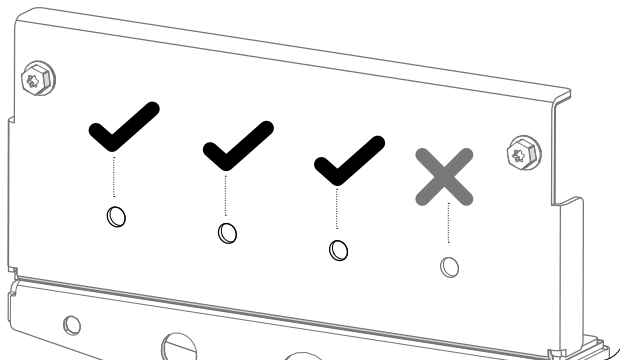

**NOTE**

Due to vehicle tub variance, the 3 bolts connecting each of the Towers to the tub RD-FK5 brackets may need to be loosened to fit the below tub rack systems. The towers can then be swivelled slightly to enable fitment of the tub rack systems, and then re-tightened

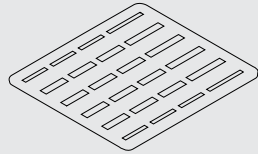
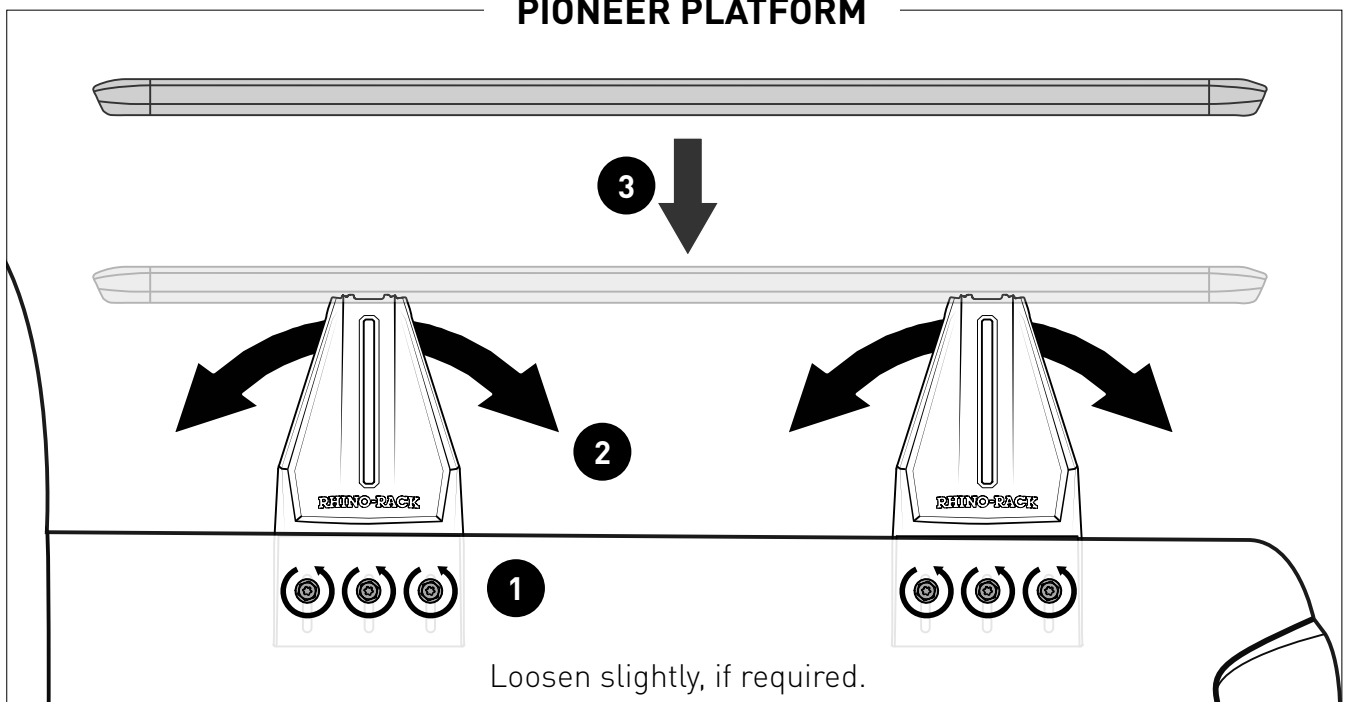
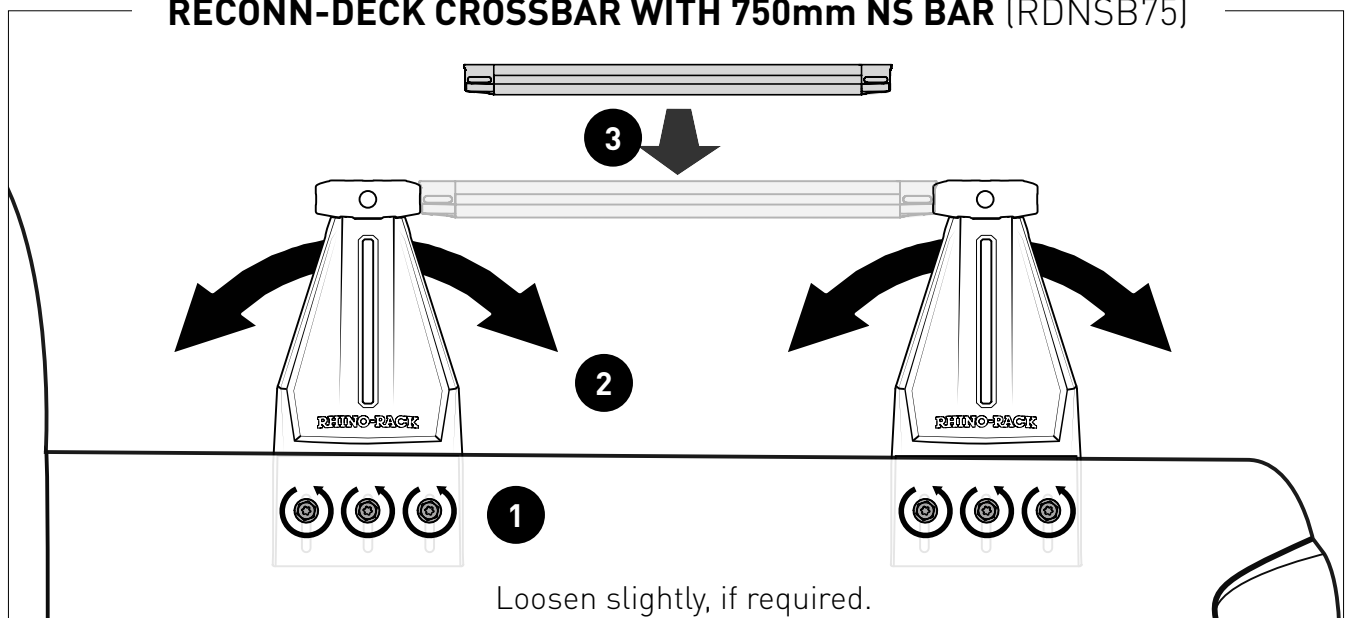
**PIONEER PLATFORM****RECONN-DECK CROSSBAR WITH 750mm NS BAR (RDNSB75):****PIONEER PLATFORM****RECONN-DECK CROSSBAR WITH 750mm NS BAR (RDNSB75)**

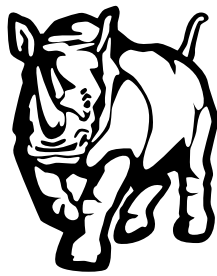

**RHINO-RACK®**

MAKE SPACE FOR ADVENTURE

**RHINORACK.COM**

**Rhino-Rack AUSTRALIA**

22A Hanson Pl,  
Eastern Creek, NSW, 2766

**Rhino-Rack USA**

19822 E 22nd Ave,  
Aurora, CO, 80011