

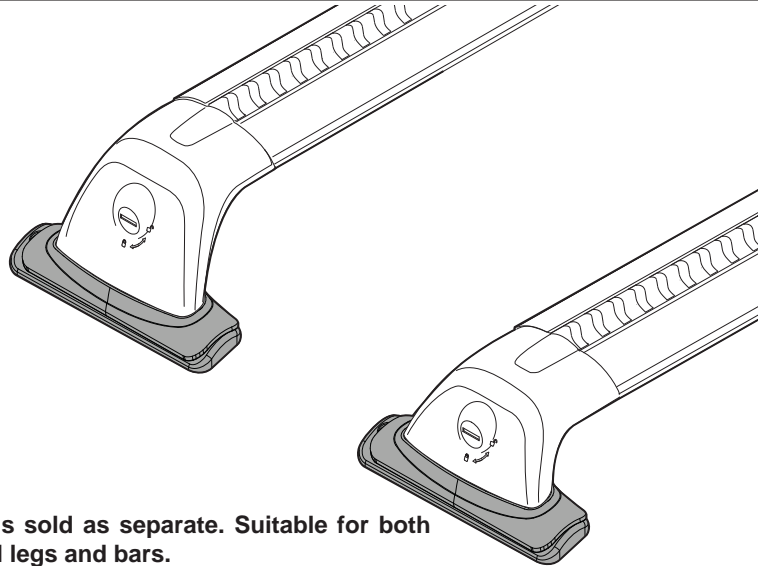

# RHINO-RACK

## RCP53-BK RFMPS2 Kit

**Important:** Please read these instructions carefully prior to installation. Please refer to your fitting instruction to ensure that the roof racks are installed in the correct locations. Check the contents of kit before commencing fitment and report any discrepancies



**Note: Crossbars and legs sold as separate. Suitable for both RVL , RVH, RCL and RCH legs and bars.**

### Important Information

1.  Check Part No./Kit is correct
2.  Read through instruction before installing
3.  Fit roof rack accessory
4.  Check and recheck all fasteners are secure

**Maximum carrying capacity: 75kg (165lbs) evenly distributed over crossbars when mounted on the strongest section of the roof. Please refer to your vehicle manufacturers handbook for maximum roof loading. Always use the lower of the two figures. Note: Be sure to check the Rhino-Rack website to see if you have the latest version of instructions before beginning.**

#### Advisory:

It is essential that all bolt connections be checked after 48hrs from when you first install your crossbars. Bolt connections should be checked again at regular intervals (once a week is enough, depending on road conditions, usage, loads and distances travelled). You should also check the crossbars each time they are refitted. Make sure to fasten your load securely. Please ensure that all loads are evenly distributed and that the centre of gravity is kept as low as possible.

**Use only non-stretch fastening ropes or straps.**

#### Load Ratings

When these roof racks are to be used on a vehicle that is driven off sealed roads, the manufacturer maximum roof load rating (to be found in the vehicle's User Manual) should be divided by a safety factor of **2**. For example, if the vehicle's maximum roof load rating is 75kgs\165lbs, these racks, when fitted to this vehicle should have no more than 37.5kgs/82lbs loaded on them.

#### Caution:

The handling characteristics of the vehicle changes when you transport a load on the roof. For safety reasons we recommend you exercise extreme care when transporting wind-resistant loads. Special consideration must be taken into account when cornering and braking. **Please remove crossbars when putting vehicle through an automatic car wash.**

**Note for Dealers and Fitters:** It is your responsibility to ensure instructions are given to the end user or client.

Rhino-Rack  
3 Pike Street, Rydalmere,  
NSW 2116, Australia.  
(Ph) (02) 9638 4744  
(Fax) (02) 9638 4822

Document No: R1458  
Prepared By: Kayle Everett  
Authorised By: Chris Murty

Fit Time: 30min  
Issue No: 01  
Issue Date: 18/08/2017

These instructions remain the property of Rhino-Rack Australia Pty. Ltd. and may not be used or changed for any other purpose than intended.



# RCP53-BK RFMPS2 Kit

## Parts List

Item	Components	Qty	Part No.
1	RCP sliding mounting pad	2	M508
2	M6 x 30mm hex screw	2	B202
3	Rivet	9	H021
4	RCP fixed pad	2	M507
5	M6 curved nut	2	N060
6	RCP curved nut retainer	2	M510
7	RVC foam block	2	C135
8	M6 spring washer	2	W004
9	M6 flat washer	2	W031
10	Instructions	1	R1458

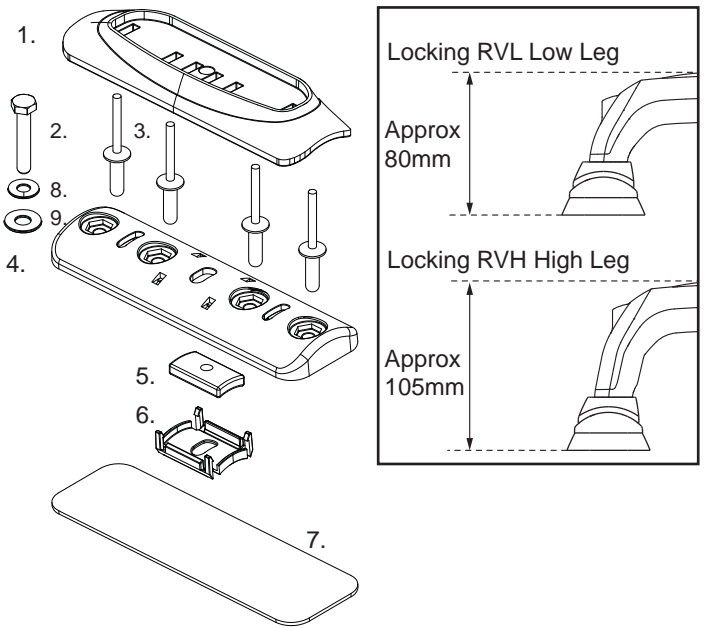

**Note:** Legs and Crossbars are sold separate. Be sure to obtain correct kits for your vehicle.

**Tools Required:** 10mm socket wrench.  
 Drill with 6.5mm drill bit  
 Knife or blade.  
 Butyl mastic.  
 Drill stop.

## Instructions

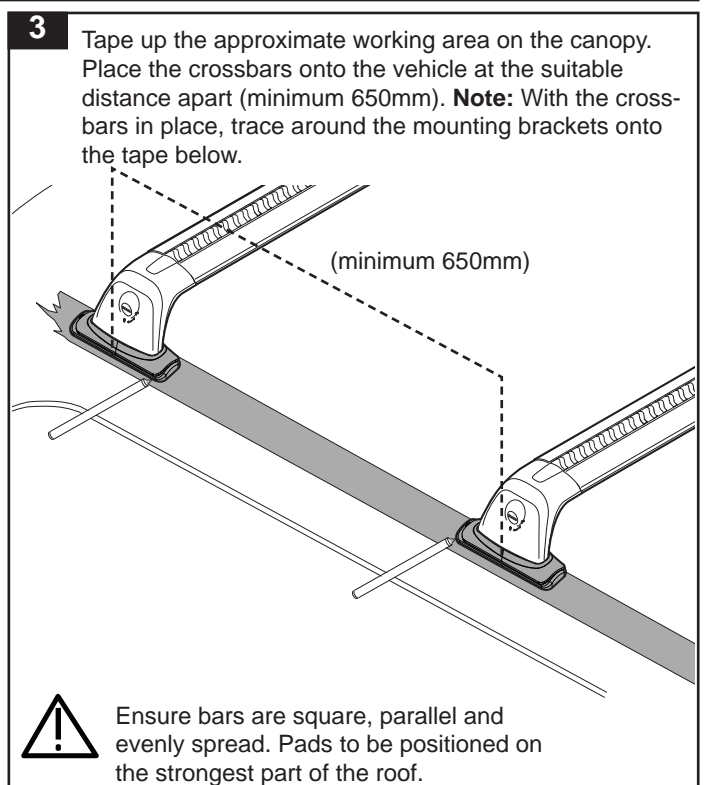
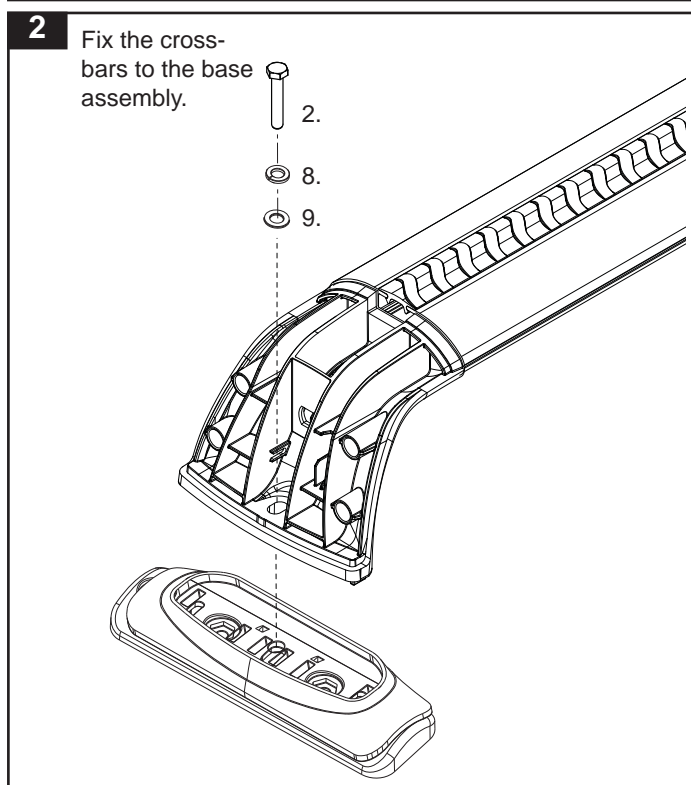
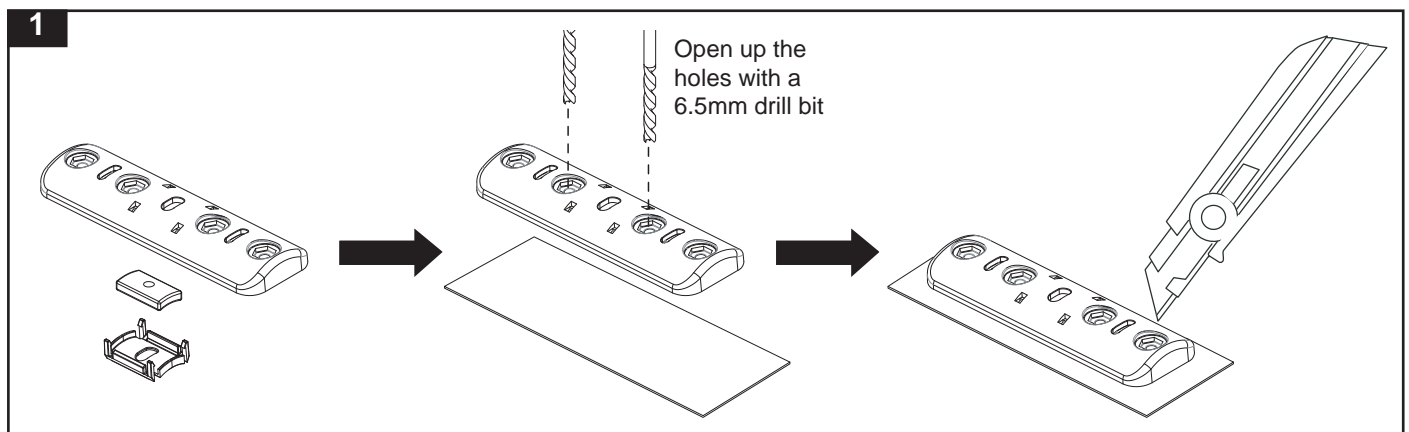



# RCP53-BK RFMPS2 Kit

**4** Disassemble the crossbars.

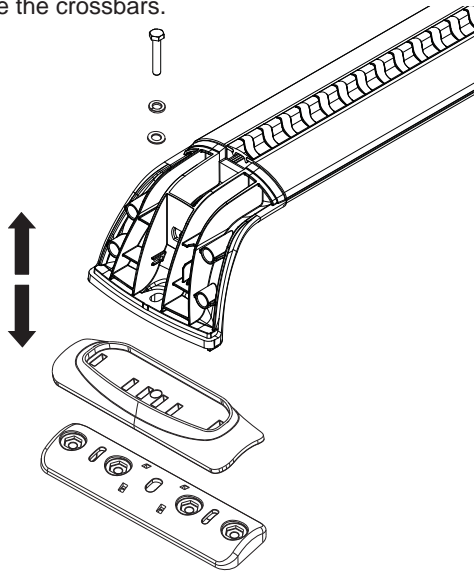

**5** Drop the fixed pad in place over the marks made in step 3. Mark the four holes of the pad onto the tape below.

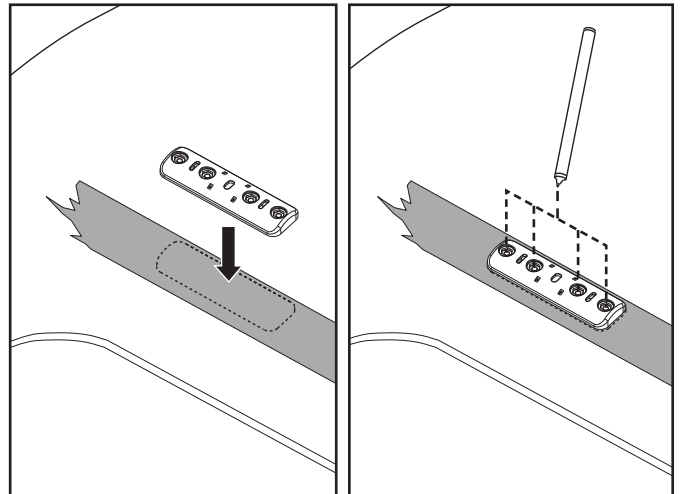

**6** Using a 6.5mm drill bit, drill through the references made in step 5.

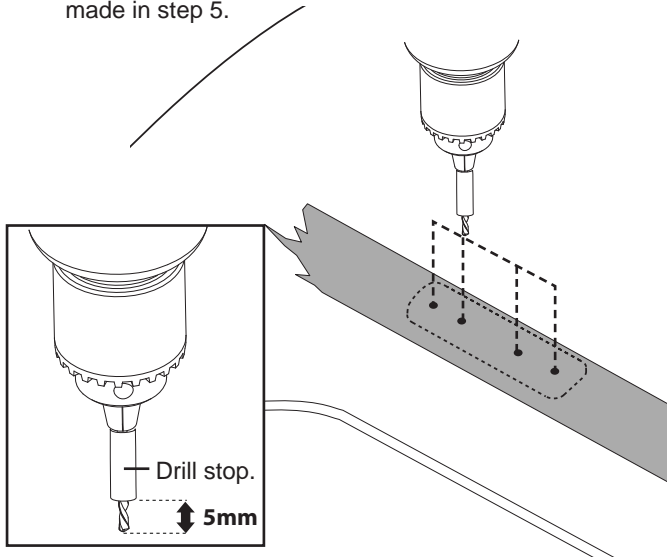

**7** Remove the tape. Vacuum away any swarf from the roof. Using a cold galvanising paint, cover any exposed surfaces.

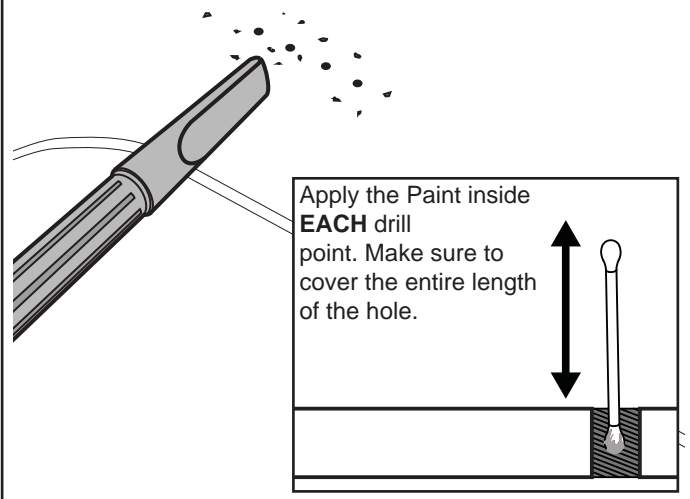

**7** A rivet must be located into each hole and checked that it fully penetrates. If a second skin is encountered, drill second skin then with a centre punch counter sink the hole to allow clearance for rivet.

Note: Failing to do this correctly may result in vehicle roof damage due to rivet catching on second skin.

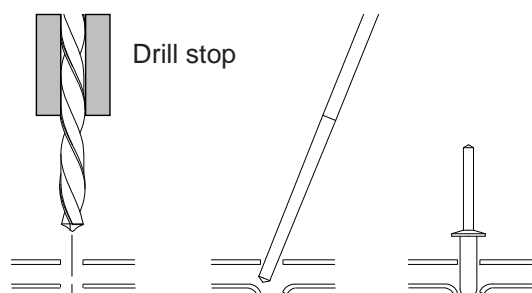

**8** Apply butyl mastic to the drilled holes in the canopy.

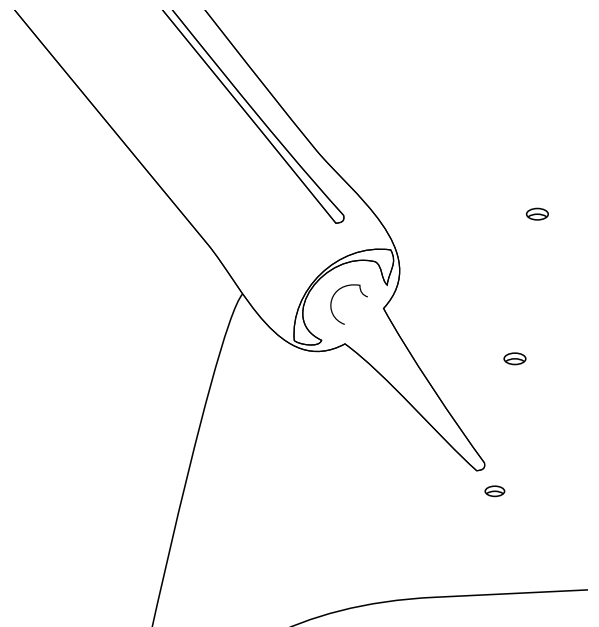



# RCP53-BK RFMPS2 Kit

**9** Place the assembly with the foam block below on top of the drilled holes. Rivet in place.

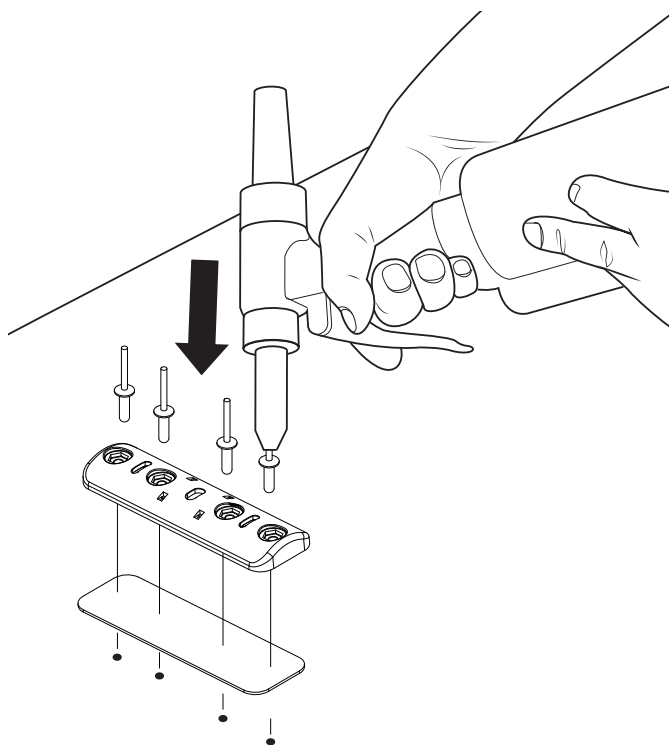

**10** Sit the sliding mounting pad onto the installed base. Install the legs as per corresponding instructions. Be sure all fixtures are secure before use.

