



# RHINO-RACK

## 1997-2002 Mercedes-Benz CLK supplement for DK289

**Important:** Please read these instructions carefully prior to and during installation.  
Check the contents of kit before commencing fitment and report any discrepancies.

### Note

For use with DK289 and RDM01 kit.

### Tools Required:

- Marking Pen
- Cold galvanising paint
- 5mm Drill stop
- Cotton buds
- Tape measure
- Power Drill
- 5 and 12mm drill bit
- Pneumatic Rivet Gun
- Blade
- Dremel
- Masking Tape

## Instructions

**1** Hook the inside edge of the Ditch Mould with a hand, towards the front of the vehicle. Carefully unclip the aluminium trim out from the Ditch moving backward.

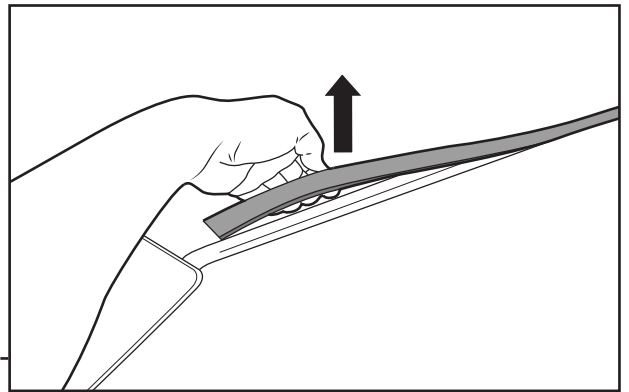
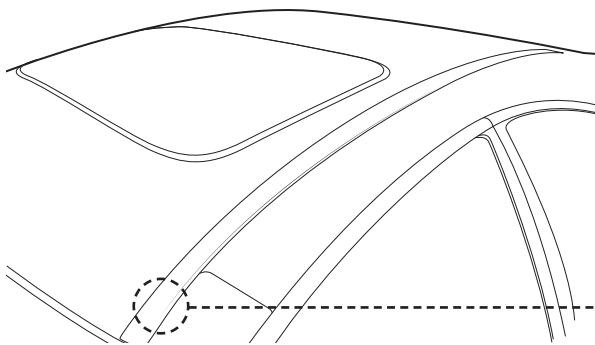

**2** Measure out from the door jamb 370mm forward and then 690mm backward in the roof ditch. Make a reference point for the centre of each bracket at these measurements.

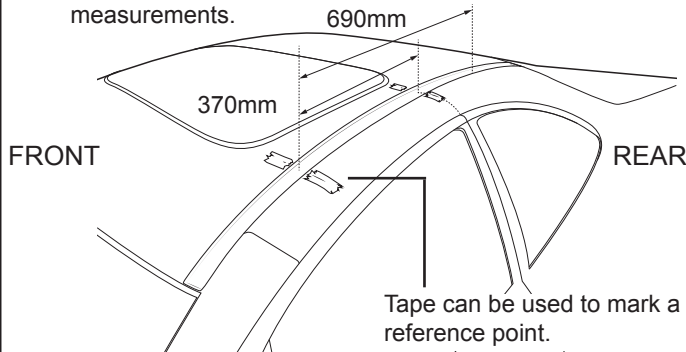

**3** Place the QMFK Bracket centred at the points previously made. Mark the two inner rivet holes of the bracket in the roof ditch.

Top View:

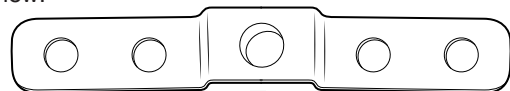

Create reference.



Reference previously made.

**4** Drill out the rivet holes with a 5mm drill bit. Use a drill stop set to 5mm.

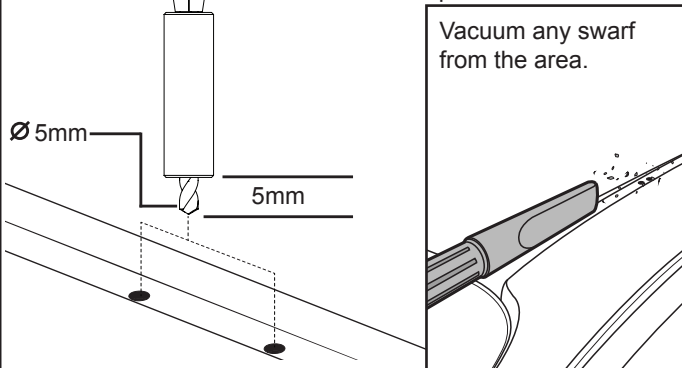

**5** Use cold galvanising paint on the drilled holes.

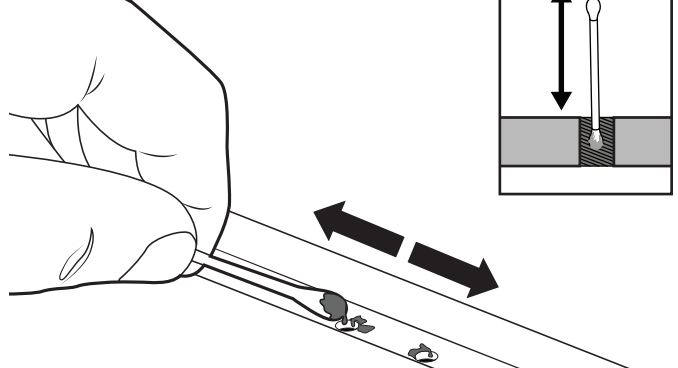

Rhino-Rack  
3 Pike Street, Rydalmere,  
NSW 2116, Australia.  
(Ph) (02) 9638 4744  
(Fax) (02) 9638 4822

Document No: R968  
Prepared By: Kayle Everett  
Authorised By: Chris Murty

Fit Time: 1 Hour  
Issue No: 01  
Issue Date: 07/03/16

These instructions remain the property of Rhino-Rack Australia Pty. Ltd. and may not be used or changed for any other purpose than intended.



# 97-02 Mercedes-Benz CLK supplement for DK289

- 6** 1: Cut the butyl patches to fit the underside of the bracket.  
2: Remove the backing tape from the patches and stick two to the inner holes of the brackets.

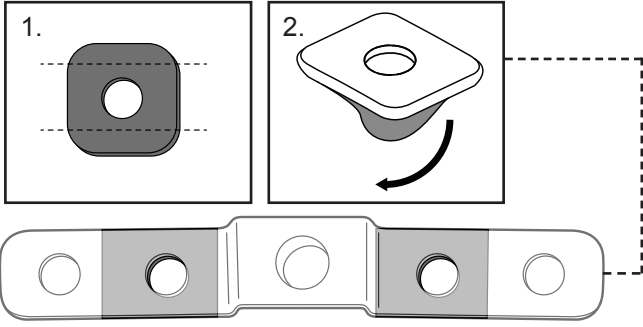

- 7** Remove final layer of backing tape from patches. Press the Ditch Brackets into position over the drilled holes. Using a Pneumatic Rivet Gun, fix the Brackets in place with Rivets provided. Be sure Brackets are aligned correctly.

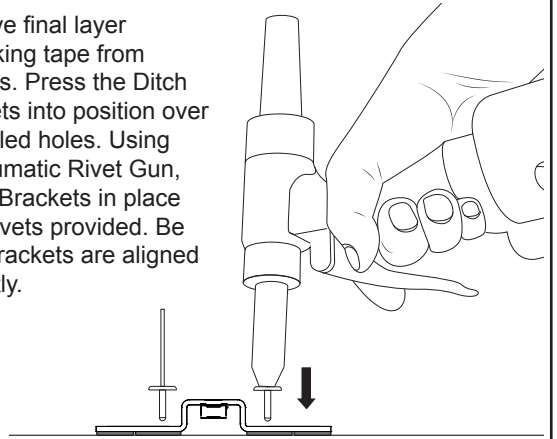

- 8** Lay the aluminium trim next to the ditch, parallel with its correct positioning. Measure 11mm out from the inside of the trim and create a reference as shown in line with the installed bracket.

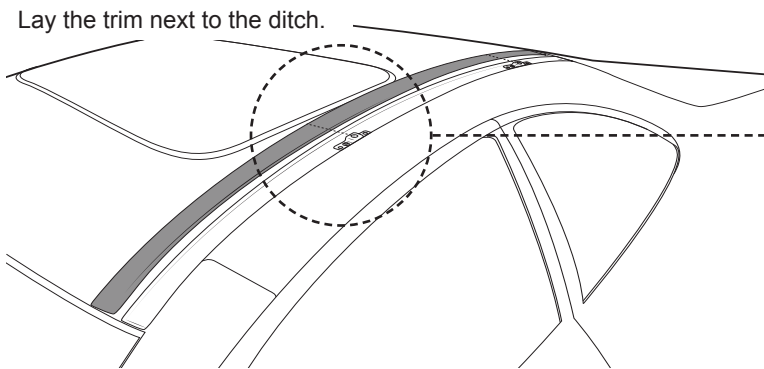

Create a reference 11mm from the inside of the trim.

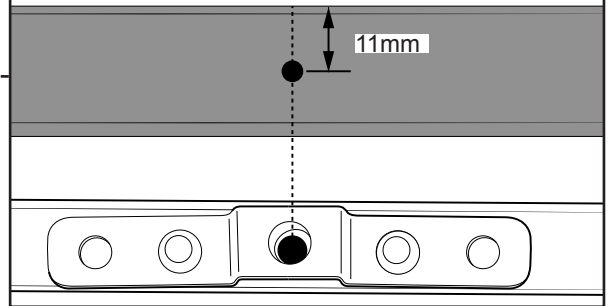

- 9** 1: Remove the ditch mould from the roof. 2: Use a 12mm drill bit and open up the reference marks made in step 8. 3: Clear any burring caused by drilling with a dremel.

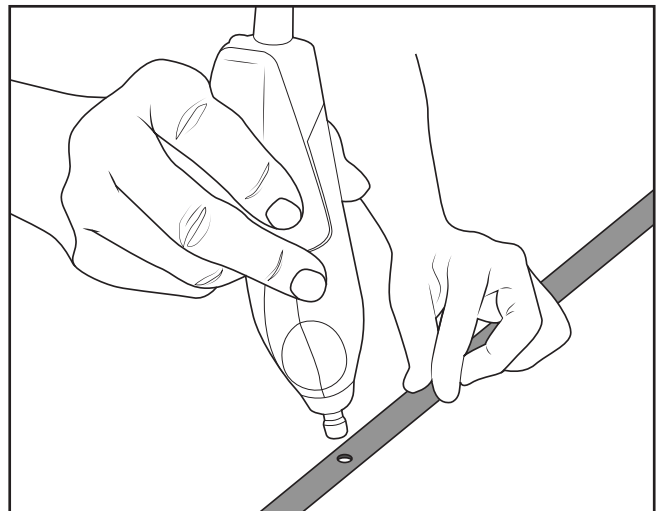
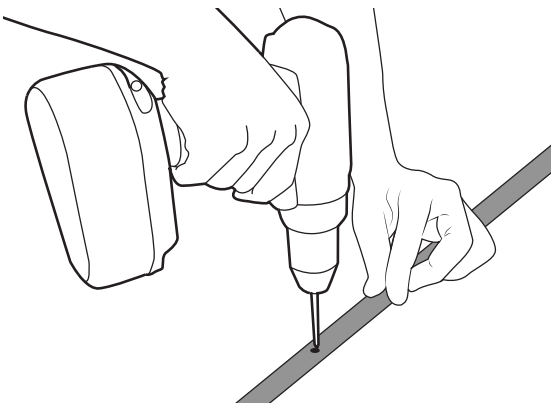

- 10** Attach Crossbars as per corresponding instructions.

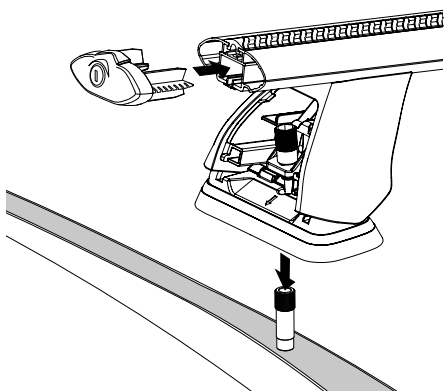

- 11** Note when crossbars are not in use, they can be removed. With a flat blade screwdriver install the plastic caps provided in their place.

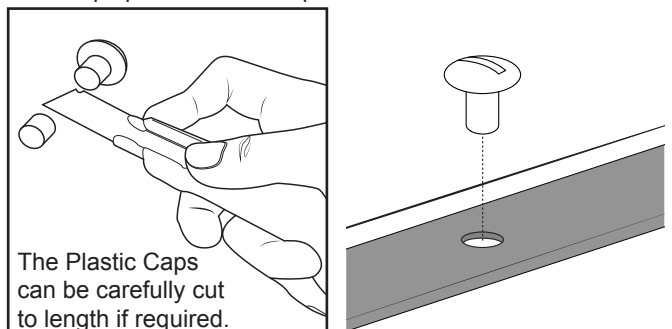

The Plastic Caps can be carefully cut to length if required.