

RHINO-RACK

Land Rover Discovery Backbone - RD4B1

Fit Time: 2 Hour

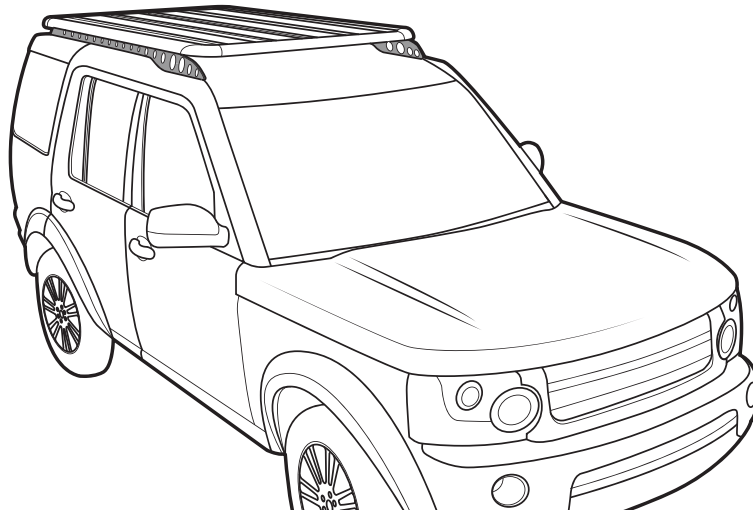

Important Information

Maximum carrying capacity:

Suitable Pioneers	On Road Cargo Allowance	Off Road Cargo Allowance	Static Allowance	Roof Allowance	Rack Weight
42104B	62kg / 137lb	42kg / 93lb	322kg / 710lb	100kg / 220lb	38kg / 84lb
45104B	59kg / 130lb	39kg / 86lb	319kg / 703lb		41kg / 90lb
41104	56kg / 124lb	36kg / 79lb	316kg / 697lb		44kg / 97lb
42107B	66.5kg / 147lb	46.5kg / 103lb	326.5kg / 720lb		33.5kg / 74lb
45107B	63.5kg / 140lb	43.5kg / 96lb	323.5kg / 713lb		36.5kg / 80lb
41107	61kg / 135lb	41kg / 90lb	321kg / 708lb		39kg / 86lb

Roof Allowance: Total permissible weight attached to the roof of the car. This is inclusive of the weight of the roof rack system
Cargo Allowance: Total permissible weight allowed on top, and attached to roof racks whilst the vehicle is in motion
Static Allowance: Total permissible weight allowed on top, and attached to roof racks whilst the vehicle is stationary
 Please refer to your vehicle manufacturers handbook for maximum carrying capacity. Always use the lower of the two figures. Load must be evenly distributed over the entire Pioneer. Weight of roof rack accessories is to be included in cargo allowance.

Torque settings

Unless stated otherwise in these instructions, all fasteners should be set to the following torque settings -
 M6: 4-5Nm (3-4lbs/ft), M8: 8-10Nm (6-7.5lbs/ft) and M10: 16-18Nm (12-13lbs/ft).

Warning:

- Check Part No. and/ or Kit is correct for use with your vehicle
- Do not attempt to fit the rack system to your vehicle unless you fully understand these fitting instructions. Please direct any questions regarding fitting to the dealer from where the roof racks were purchased.
- **Use only non-stretch fastening ropes or straps.**
- The handling characteristics of the vehicle changes when you transport a load on the roof. For safety reasons we recommend you exercise extreme care when transporting wind-resistant loads. Special consideration must be taken into account when cornering and braking.
- Although the system is tested and approved to AS1235-2000 / ISO 11154, off-road conditions can be much more rigorous. Extreme care must be taken in off road conditions

Recommendations:

It is essential that all bolt connections be checked after driving a short distance when you first install your roof racks. Bolt connections should be checked again at regular intervals (once a week is enough, depending on road conditions, usage, loads and distances travelled). You should also check the roof racks each time they are re-fitted. Always make sure to fasten your load securely. Please also ensure that all loads are evenly distributed and that the centre of gravity is kept as low as possible and must be entirely contained within the extents of the roof racks.

Note for Dealers and Fitters:

It is your responsibility to ensure these fitting instructions are given to the end user or client

Rhino-Rack, 3 Pike St, Rydalmere
 NSW 2116, Australia
 (02) 8846 1900
 rhinorack.com.au

Document No: R802
Prepared By: Kayle Everett
Authorised By: Chris Murty

Issue No: 06
Issue Date: 12/07/2018

These instructions remain the property of Rhino-Rack Australia Pty. Ltd. and may not be used or changed for any other purpose than intended.

Land Rover Discovery Backbone - RD4B1

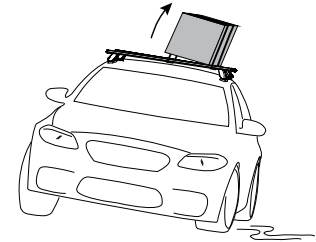
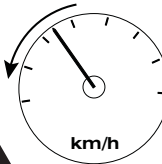
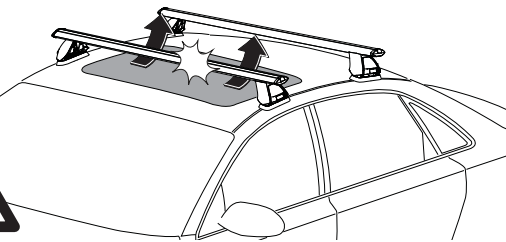
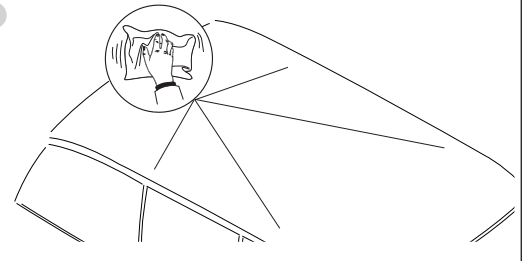
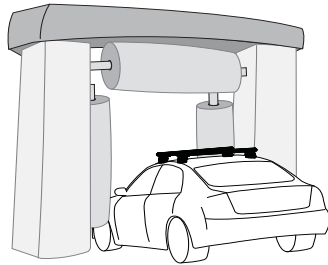
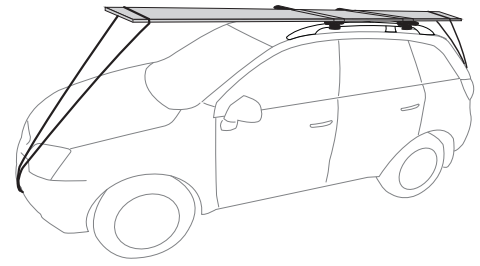
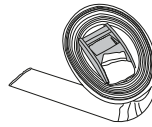
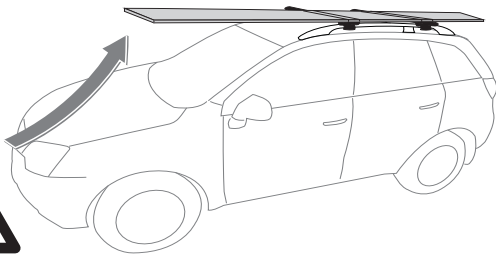

The handling characteristics of the vehicle changes when you transport a load on the roof. For safety reasons we recommend you exercise extreme care when transporting wind-resistant loads. Special consideration must be taken into account when cornering and braking.

Although the system is tested and approved to AS1235-2000 / ISO 11154, off-road conditions can be much more rigorous. Extreme care must be taken in off road conditions

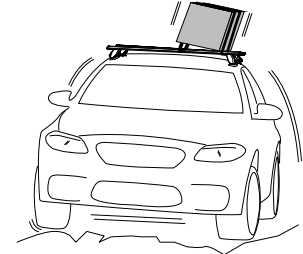
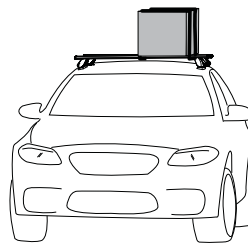

System Weight: 33.5kg - 44kg

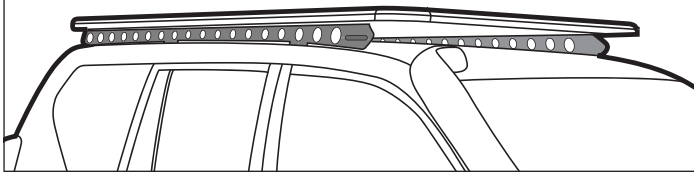

? kg

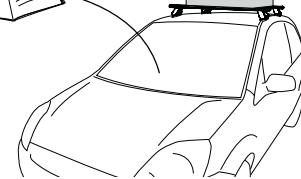

Static Load Rating: refer to front page



Ensure Ladder is well supported on the ground to help support tent. Take extreme caution when climbing heights above 1.2m/4ft.

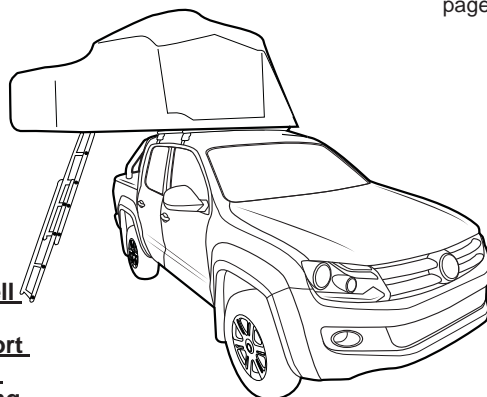

Paddle/ Surfboards should be fixed to the front of the vehicle.

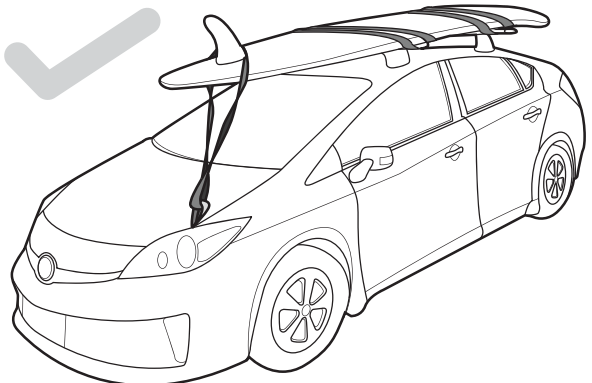

Land Rover Discovery Backbone - RD4B1

Parts List

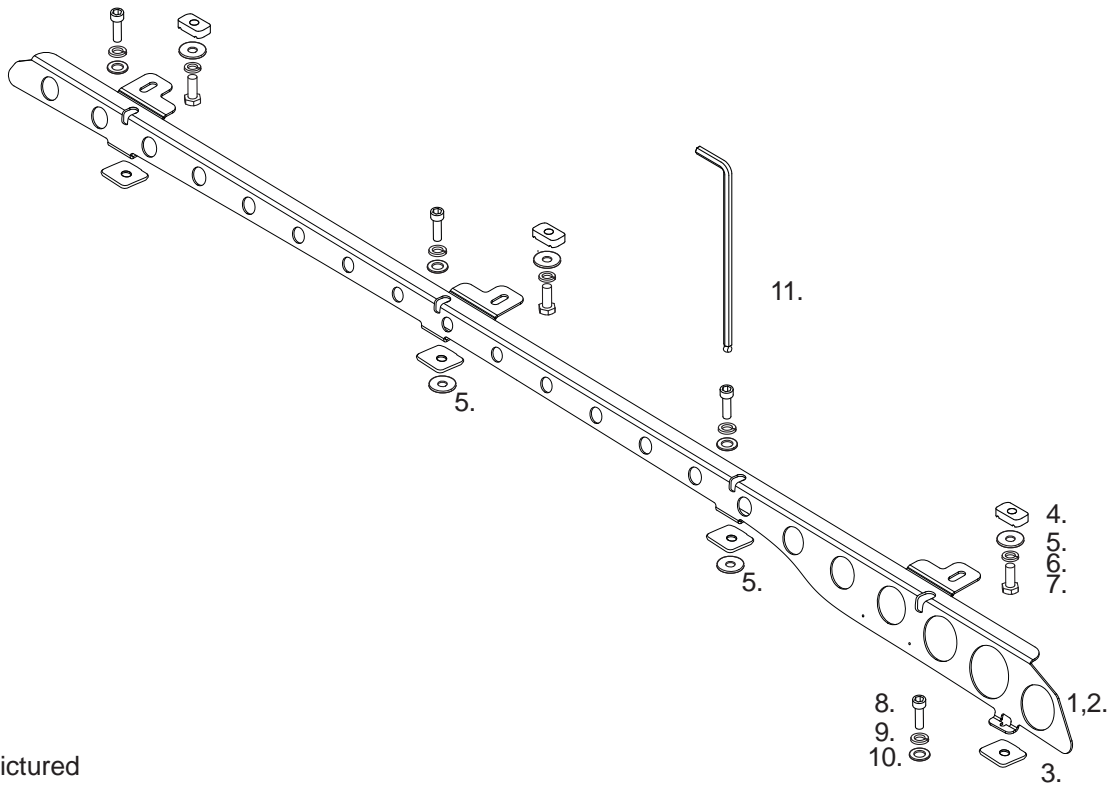

Right Side Pictured

Item	RD4B1 Kit	Qty	Part No.
1	Land Rover Discovery Left Rail	1	CA1437
2	Land Rover Discovery Right Rail	1	CA1438
3	Butyl Patch 20x20 M5 Hole	8	CA1266
4	M8 Channel Nut	6	N003
5	M8x19x2.5 Flat Washer	10	W043
6	M8 Spring Washer	6	W019
7	M8x20 Hex Setscrew	6	B020-BLK
8	M6x16 Socket Head Screw	8	B031
9	M6x12.5mm Flat Washer	8	W003
10	M6 Spring Washer	8	W004
11	5mm Ball Allen Key	1	-
12	Instructions	1	R802

Tools Required:

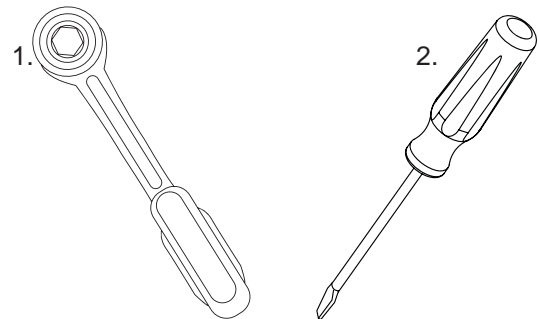

1. Socket Wrench
2. Flat blade Screw Driver

TDV6 Ditch Rubber Mold Removal

Move to the roof of the vehicle. If your car is not fitted with factory roof rails, remove the Ditch Molding by lifting at the front and twisting in an outward direction to unhook plastic clips. Do not use excessive force otherwise clips may break. Store the Ditch Mold in a safe place. Move to step 7 pg 5.

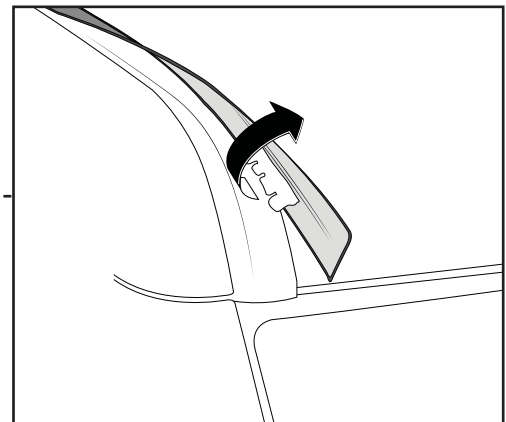
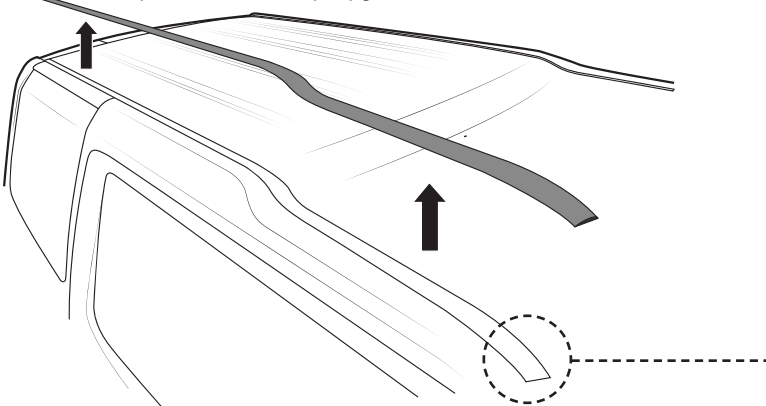

Land Rover Discovery Backbone - RD4B1

Removing Factory Elevated Roof Rails

- 1** If the Land Rover Discovery has factory elevated roof rails you will need to remove these before installing the Backbone. To access the hardware fixing the roof rails to the roof, you must first remove the Plastic Covers. You will need a flat head screwdriver to pry the Plastic Covers off. To minimise potential damage to the vehicle, it's recommended to pad the metal shaft of the screwdriver with multiple layers of masking tape. This will protect the bodywork of the vehicle.

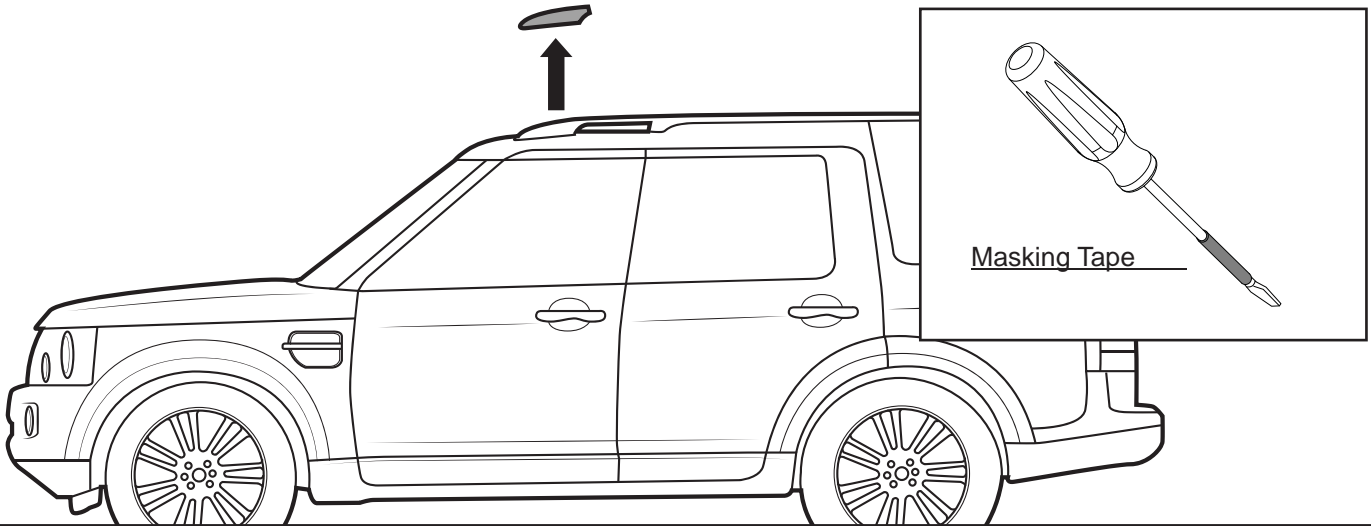

- 2** Using the tape covered screwdriver, slide into the very front of the Factory Rail. The screwdriver should fit in between the Plastic Cover and the Rubber Base of the unit. Carefully pry the Plastic Cover upward. Do not use excessive force.

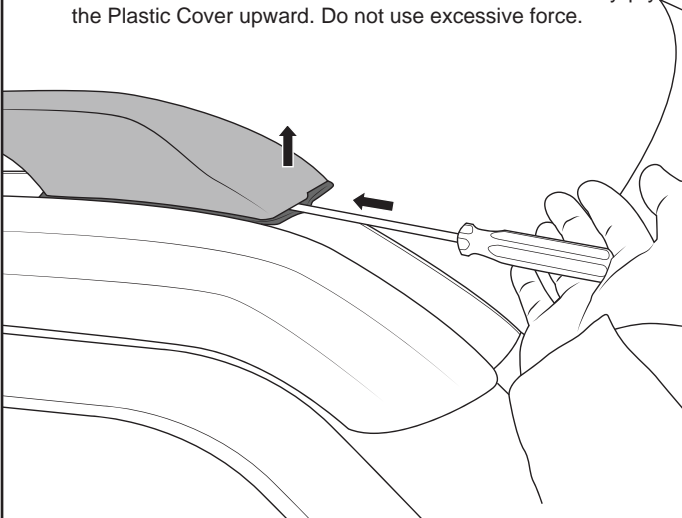

- 3** With the Plastic Cover lifted into an upright position, rotate the unit 90 degrees, freeing it from the Factory Rail. Remove the Plastic Cover.

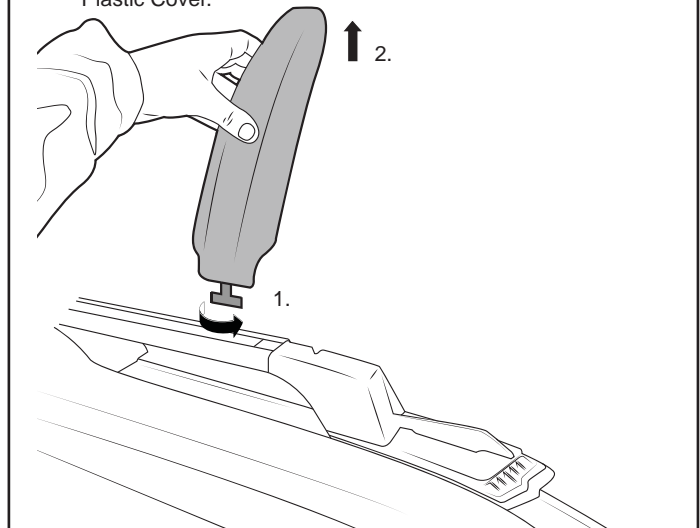

- 4** Locate the fixture points along the Factory Rail. Remove the covers from 3rd, 4th and 5th fixture point from the front of the vehicle. Using a screwdriver, carefully remove the covers as shown.

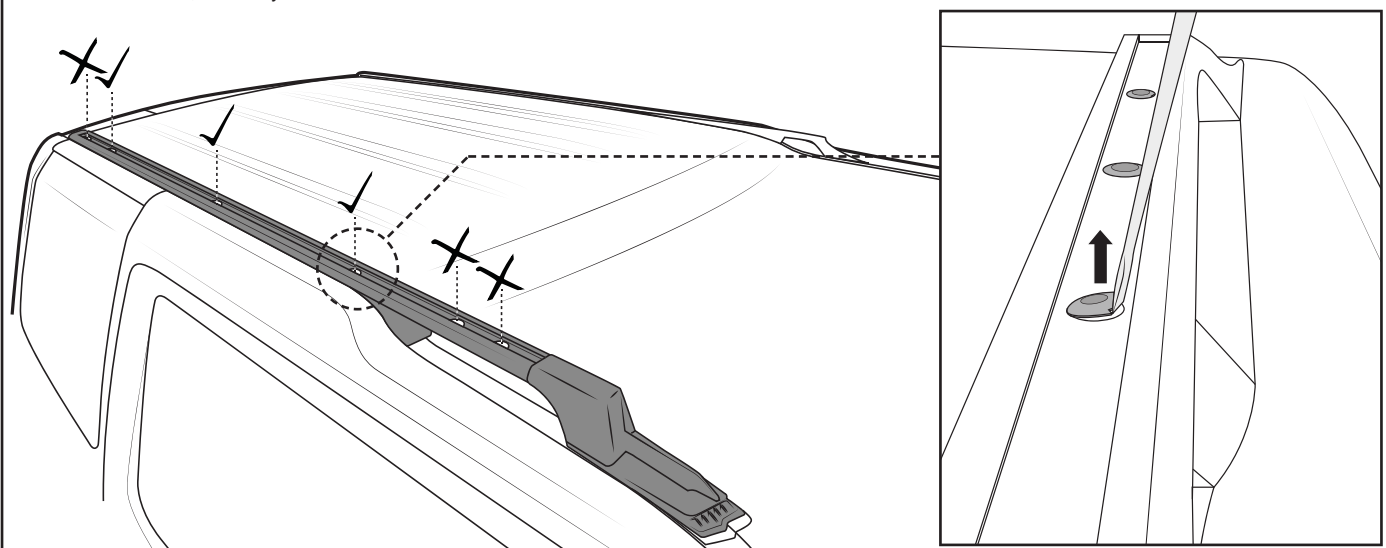

Land Rover Discovery Backbone - RD4B1

6 Using a T30 Torx Key, remove the hardware holding the Factory Rail in place. Store in a safe place.

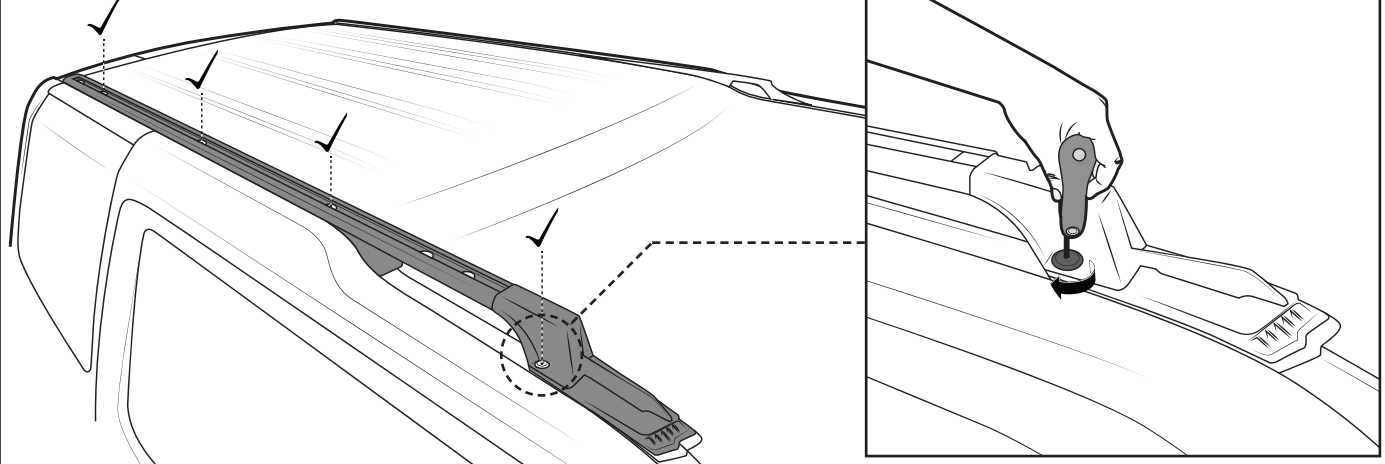

7 Clean the exposed ditch with a clean cloth.

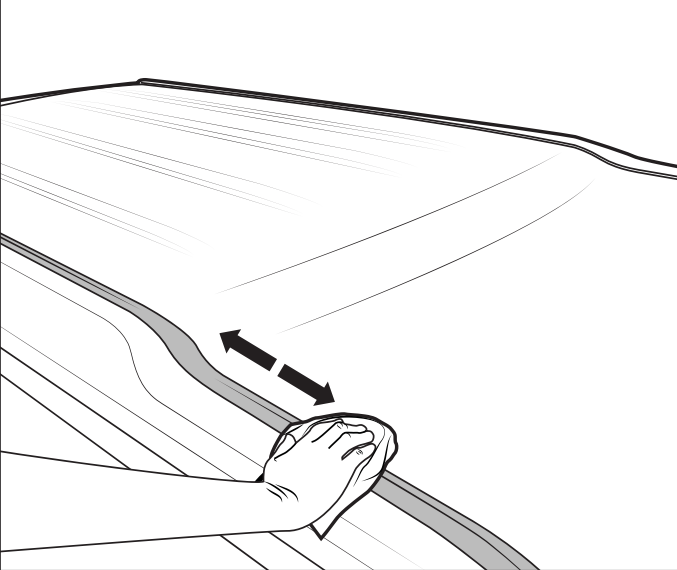

8 Remove the backing tape from both sides of the Butyl Patches and place onto the underside of the Backbone. Be sure to line up with the Backbone's bolt holes.

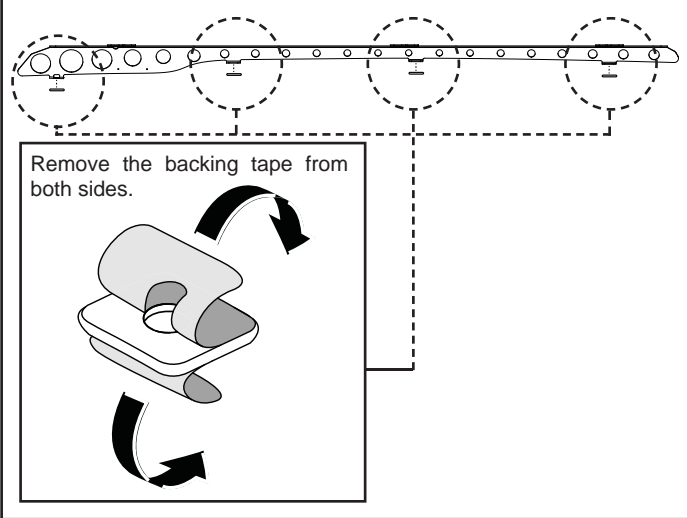

Fitment Instructions

1 Place the Backbone onto the vehicle. Be sure to use correct orientation. 1: Finger tighten in place with M6 Socket head Screws, M6 Sping and Flat Washers. 2: Tighten with an M5 Ball Head Allen Key. Be sure all fixtures are secure.

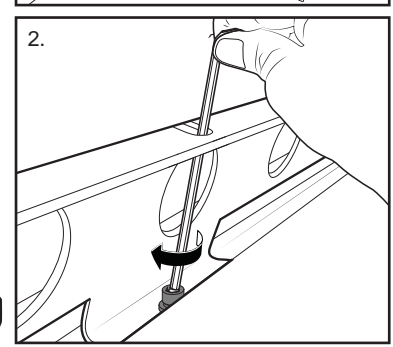
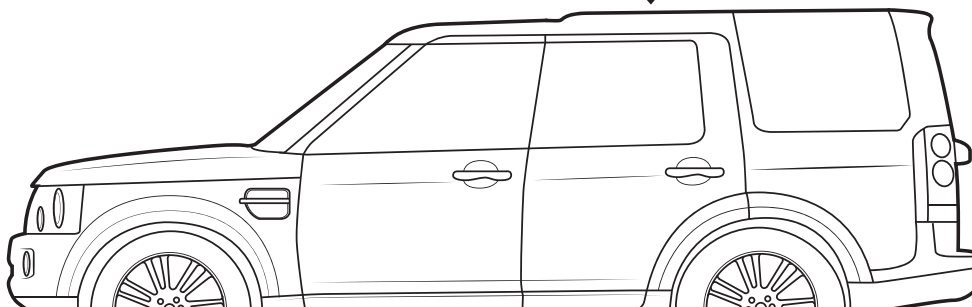
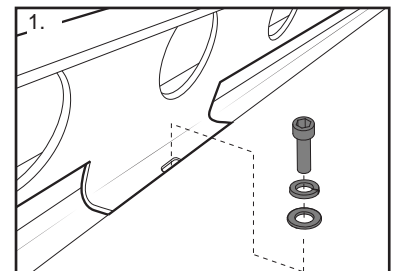
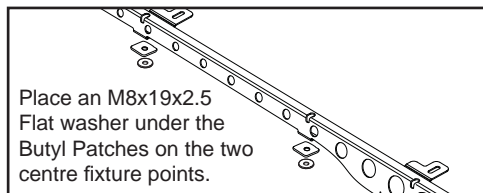
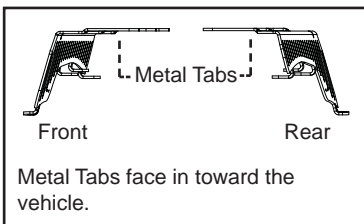

Land Rover Discovery Backbone - RD4B1

Mounting Pioneer Platform

- 10** Repeat previous steps for securing opposite side Backbone rail.

Ensure both Assemblies are securely positioned on the car. Check each bolt before proceeding to attaching the Pioneer Platform to the Backbone.

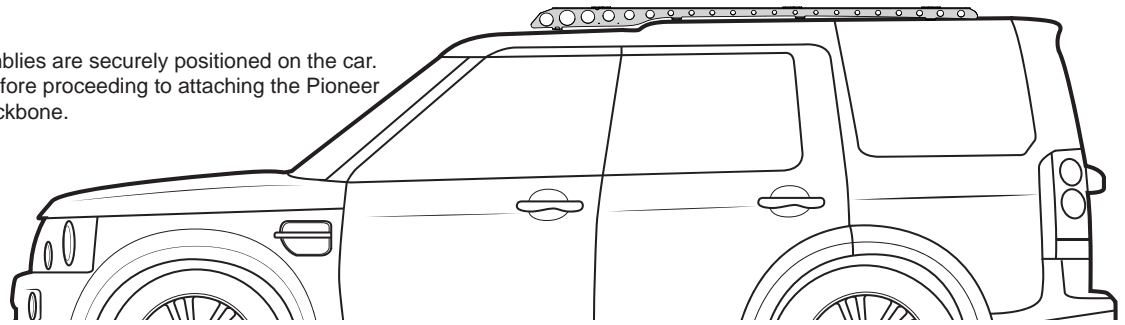

- 11** Assemble M8 hardware as pictured below. Complete this for the six tabs on top of the backbone rails (3 each rail).

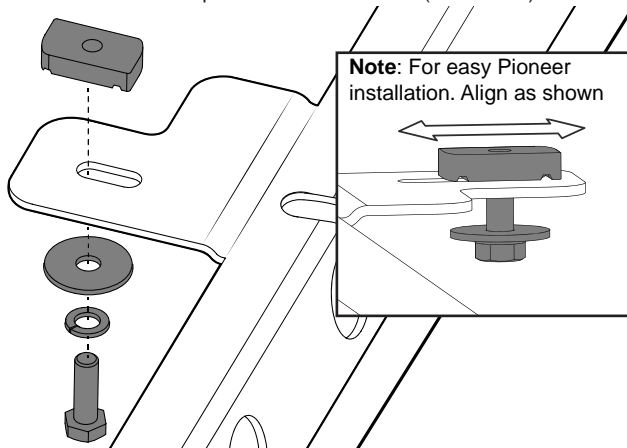

- 12** Install Pioneer Underbars with slots indicated

Front: 100mm from Rear

Middle: 808mm from Rear

Rear: 1730mm from Rear

For detailed underbar installation instructions, refer to Pioneer fitting instructions.

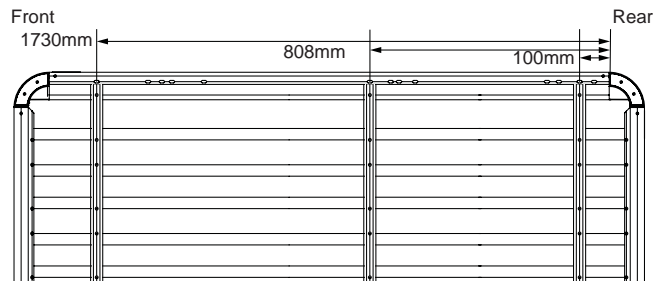

- 13** After underbars have been correctly fitted, place the Pioneer tray on top of the Backbone. Align the underbars with the top tabs and ensure the M8 hardware fits into underbar channel.

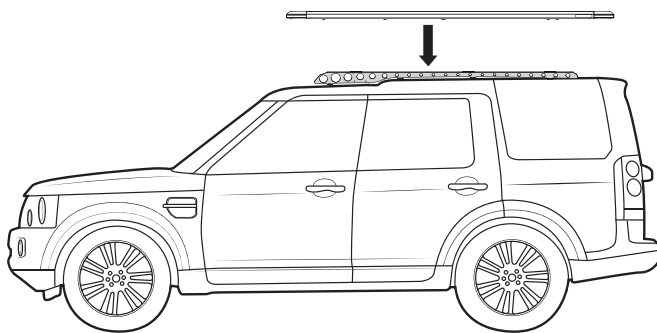

- 14** Once Pioneer Underbars have been aligned properly, tighten all M8 hardware using 13mm socket wrench or 13mm spanner. Ensure channel nut has rotated within Pioneer underbar and is fixing Pioneer securely.

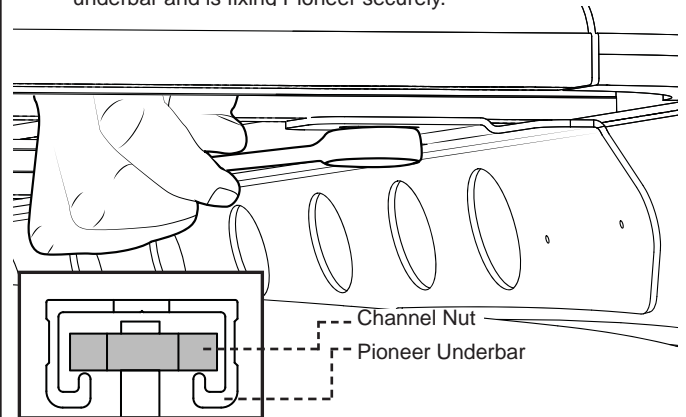

Note The Ditch Moulding can be cut to length and fit around the Backbone Brackets. Measure the distance of the gaps on either side of the Bracket. Translate this measurement to the previously removed Ditch Fill and cut (be sure to use sharp cutters). Replace the newly cut Fill.

