



RHINO-RACK

RBCA034 VA Fit Kit for RBC050.

CONTROLLED

| Item | Component Name | Qty | Part No. |
|------|-------------------------|-----|----------|
| 1 | M6 x 16mm Cap Screw | 1 | B031 |
| 2 | M6 x 25mm Cap Screw | 2 | B039 |
| 3 | M6 Spring Washer | 1 | W004 |
| 4 | M6 x 12.5mm Flat Washer | 1 | W003 |
| 5 | M6 x Square Washer | 3 | N025 |
| 6 | Torque Allen Key | 1 | TORKEY-S |
| 7 | Instructions | 1 | R909 |

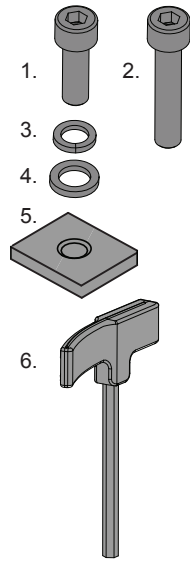

Note: Fitting instructions found in RBC050 main instruction (step 9,10 and 11 on page 9).

Issue: 01

Document No: R909

Prepared: Kayle Everett



RHINO-RACK

RBCA034 VA Fit Kit for RBC050.

CONTROLLED

| Item | Component Name | Qty | Part No. |
|------|-------------------------|-----|----------|
| 1 | M6 x 16mm Cap Screw | 1 | B031 |
| 2 | M6 x 25mm Cap Screw | 2 | B039 |
| 3 | M6 Spring Washer | 1 | W004 |
| 4 | M6 x 12.5mm Flat Washer | 1 | W003 |
| 5 | M6 x Square Washer | 3 | N025 |
| 6 | Torque Allen Key | 1 | TORKEY-S |
| 7 | Instructions | 1 | R909 |

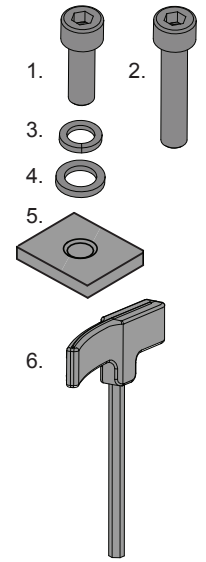

Note: Fitting instructions found in RBC050 main instruction (step 9,10 and 11 on page 9).

Issue: 01

Document No: R909

Prepared: Kayle Everett



RHINO-RACK

RBCA034 VA Fit Kit for RBC050.

CONTROLLED

| Item | Component Name | Qty | Part No. |
|------|-------------------------|-----|----------|
| 1 | M6 x 16mm Cap Screw | 1 | B031 |
| 2 | M6 x 25mm Cap Screw | 2 | B039 |
| 3 | M6 Spring Washer | 1 | W004 |
| 4 | M6 x 12.5mm Flat Washer | 1 | W003 |
| 5 | M6 x Square Washer | 3 | N025 |
| 6 | Torque Allen Key | 1 | TORKEY-S |
| 7 | Instructions | 1 | R909 |

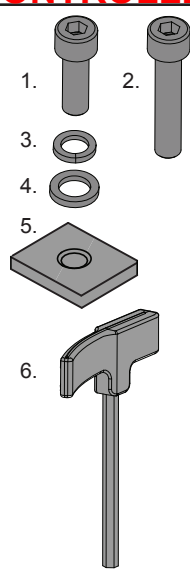

Note: Fitting instructions found in RBC050 main instruction (step 9,10 and 11 on page 9).

Issue: 01

Document No: R909

Prepared: Kayle Everett



RHINO-RACK

RBCA034 VA Fit Kit for RBC050.

CONTROLLED

| Item | Component Name | Qty | Part No. |
|------|-------------------------|-----|----------|
| 1 | M6 x 16mm Cap Screw | 1 | B031 |
| 2 | M6 x 25mm Cap Screw | 2 | B039 |
| 3 | M6 Spring Washer | 1 | W004 |
| 4 | M6 x 12.5mm Flat Washer | 1 | W003 |
| 5 | M6 x Square Washer | 3 | N025 |
| 6 | Torque Allen Key | 1 | TORKEY-S |
| 7 | Instructions | 1 | R909 |

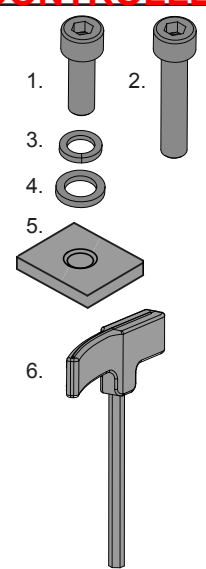

Note: Fitting instructions found in RBC050 main instruction (step 9,10 and 11 on page 9).

Issue: 01

Document No: R909

Prepared: Kayle Everett



RHINO-RACK

RBCA034 VA Fit Kit for RBC050.

CONTROLLED

| Item | Component Name | Qty | Part No. |
|------|-------------------------|-----|----------|
| 1 | M6 x 16mm Cap Screw | 1 | B031 |
| 2 | M6 x 25mm Cap Screw | 2 | B039 |
| 3 | M6 Spring Washer | 1 | W004 |
| 4 | M6 x 12.5mm Flat Washer | 1 | W003 |
| 5 | M6 x Square Washer | 3 | N025 |
| 6 | Torque Allen Key | 1 | TORKEY-S |
| 7 | Instructions | 1 | R909 |

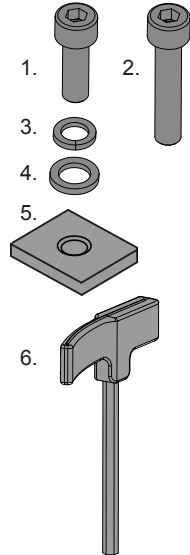

Note: Fitting instructions found in RBC050 main instruction (step 9,10 and 11 on page 9).

Issue: 01

Document No: R909

Prepared: Kayle Everett



RHINO-RACK

RBCA034 VA Fit Kit for RBC050.

CONTROLLED

| Item | Component Name | Qty | Part No. |
|------|-------------------------|-----|----------|
| 1 | M6 x 16mm Cap Screw | 1 | B031 |
| 2 | M6 x 25mm Cap Screw | 2 | B039 |
| 3 | M6 Spring Washer | 1 | W004 |
| 4 | M6 x 12.5mm Flat Washer | 1 | W003 |
| 5 | M6 x Square Washer | 3 | N025 |
| 6 | Torque Allen Key | 1 | TORKEY-S |
| 7 | Instructions | 1 | R909 |

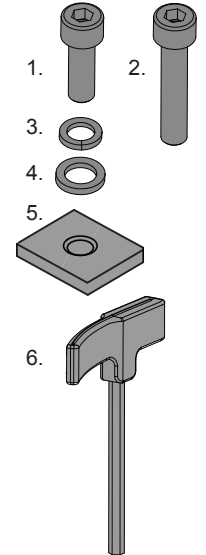

Note: Fitting instructions found in RBC050 main instruction (step 9,10 and 11 on page 9).

Issue: 01

Document No: R909

Prepared: Kayle Everett