



# RHINO-RACK

## Toyota Tacoma QMFK Fit Supplement

**Important:** Please read these instructions carefully prior to and during installation.  
Check the contents of kit before commencing fitment and report any discrepancies.

Rhino-Rack  
3 Pike Street, Rydalmere,  
NSW 2116, Australia.  
(Ph) (02) 9638 4744  
(Fax) (02) 9638 4822

Document No: R1219  
Prepared By: Kayle Everett  
Authorised By: Chris Murty

Fit Time: 1 Hour  
Issue No: 01  
Issue Date: 14/12/16

These instructions remain the property of Rhino-Rack Australia Pty. Ltd. and may not be used or changed for any other purpose than intended.

### Parts List

Item	Components	VA Qty	HD	Part No.
1	Vortex Crossbar	2	-	VA126S/B
2	Heavy Duty Crossbars	-	2	RB1250S/B
3	Quick Mount Roof Ditch Bracket	2	2	QMFK03
4	Quick Mount HD Spacer 5mm	-	2	QMHD05
5	Leg and Base Kit	1	1	RLT600
6	Fitting Instructions	1	1	R1219

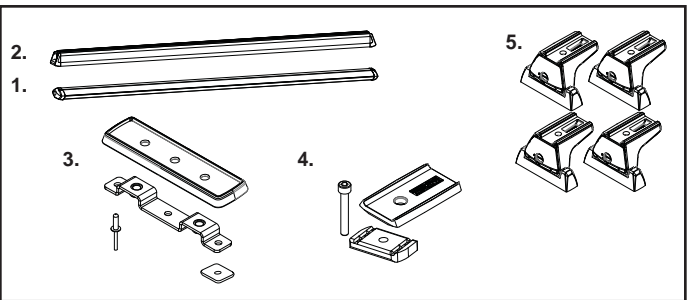

#### Note:

All 4 kits are sold as separate.  
Ensure you have the required  
kits to complete your fitment.

#### Tools Required:

- Masking tape
- Marking Pen
- Cold galvanising paint
- 5-6mm Drill stop
- Cotton buds
- Tape measure
- Cordless Drill
- 5.0mm drill bit (#9 Gauge Drill bit).
- Pneumatic Rivet Gun
- Knife or Shears

### Instructions

**1** Starting at the front of the vehicle, carefully lift the Ditch Mould.

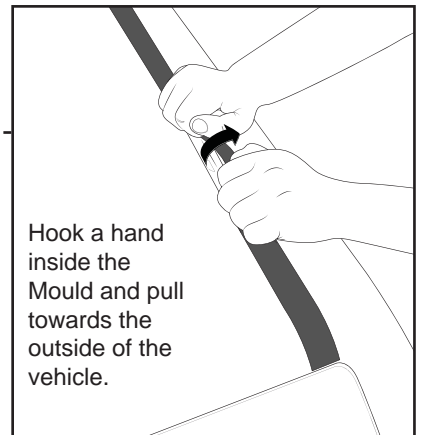
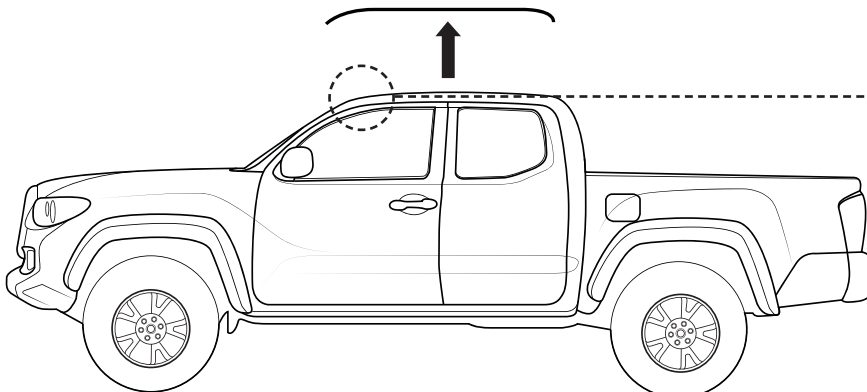

**2** Measure forward from the Windshield 385mm/ 15 5/32" and create a reference point in the Ditch. Measure back 700mm/ 27 9/16" from this point and create a second reference. Complete for both sides.

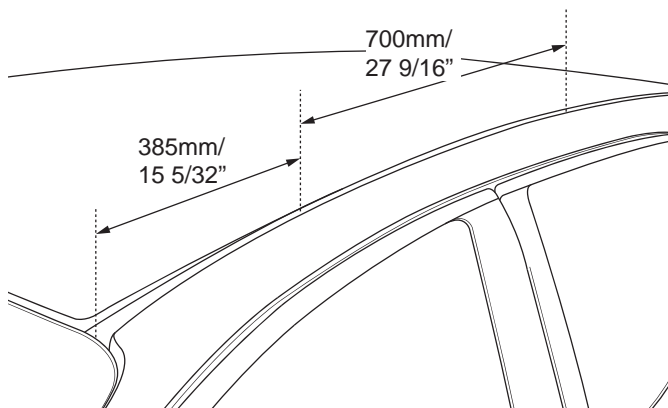

**3** Place the QMFK Bracket centred onto these points previously made. Mark out the rivet holes onto the ditch. Be sure Brackets are parallel.

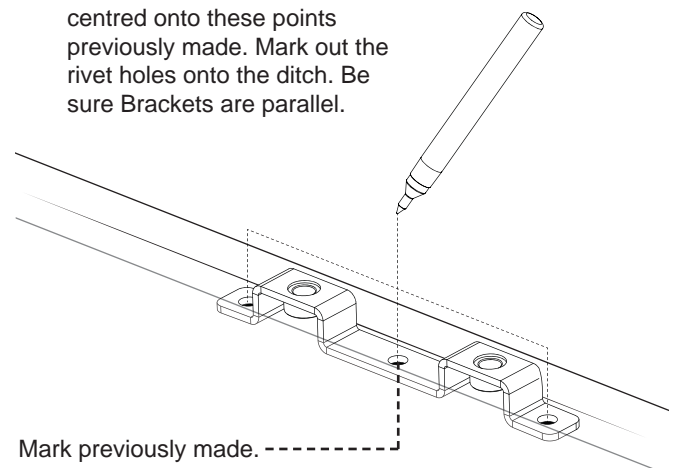



# Toyota Tacoma QMFK Fit Supplement

**4** Drill out all marked holes with a 5mm (3/16") Drill Bit. Use a Drill Stop set to 5mm (3/16").

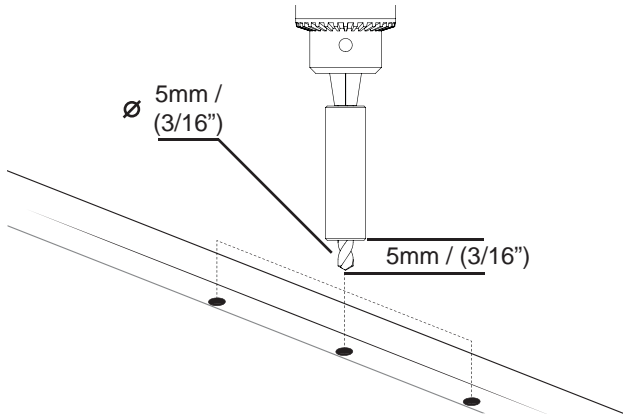

**5** Vacuum and swarf from the roof ditch.

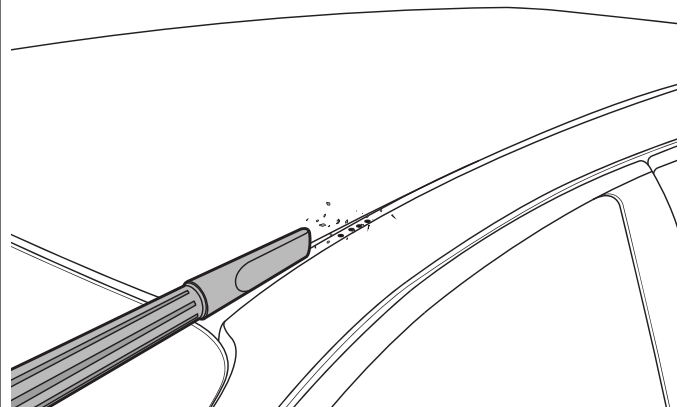

**6** Using Cold Galvanising Paint, cover all drilled areas and any exposed body work.

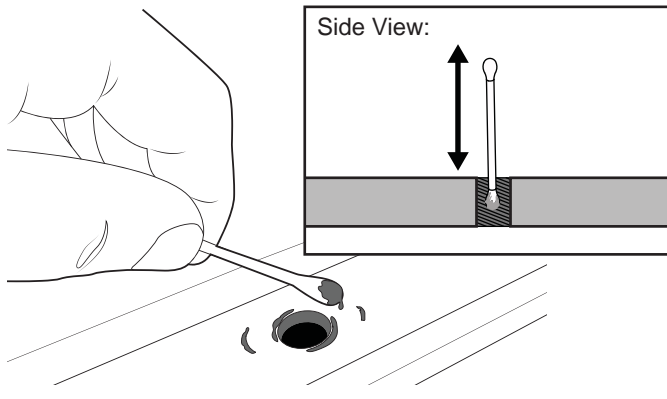

**7** Peel off the one side of backing tape on the Butyl Patches provided. Place these carefully over all holes drilled. Remove the top layer of backing tape as shown.

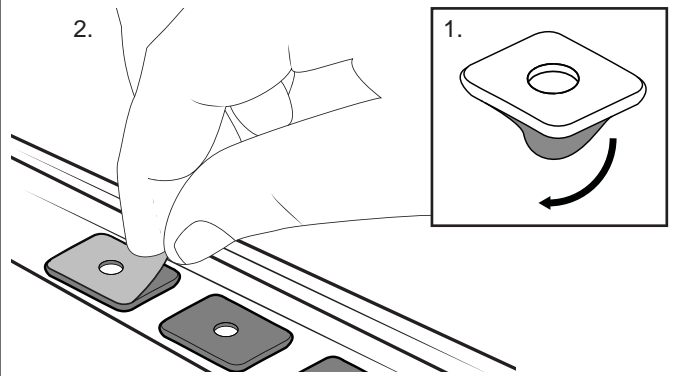

**8** Press the Ditch Brackets into position over the drilled holes. Using a Pneumatic Rivet Gun, fix the Brackets in place with Rivets provided. Be sure Brackets are aligned correctly.

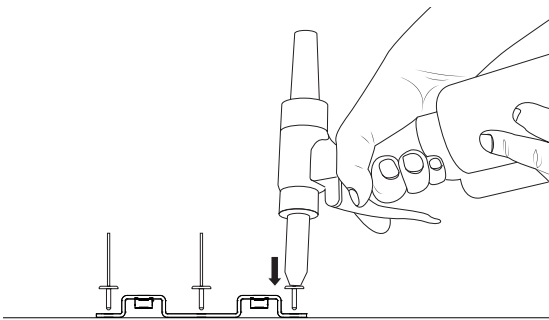

**9** The Ditch Mould can be cut to fit around the Brackets seated to the vehicle.

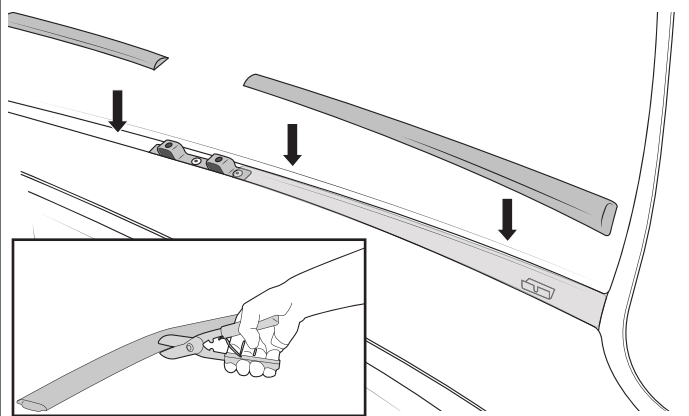

**10** Install leg kits as per corresponding instructions.

QMHD05 (Heavy Duty Crossbars only)

RLT600

\*QMW10

M830\*

\*M830 will sit on top of the installed Bracket. The Gasket will cover exposed areas of the Bracket and Ditch Mould. QMW05/10 used when fitting Pioneer Tray.

\*QMW05

