



RHINO-RACK

Suzuki APV QMFK15 Fitment

Important: Please read these instructions carefully prior to and during installation.
Check the contents of kit before commencing fitment and report any discrepancies.

Item	Components	VA Qty	HD	Part No.
1	Vortex Crossbar	2	-	VA126S/B
2	Heavy Duty Crossbars	-	2	RB1250S/B
3	Quick Mount Roof Ditch Bracket	2	2	QMFK15
*4	Quick Mount HD Spacer 5mm	-	2	QMHD05
5	Leg and Base Kit	1	1	RLT600
6	Fitting Instructions	1	1	R1015

* For use with Pioneer Tray/ Platform. Optional when using HD or Vortex Bars.

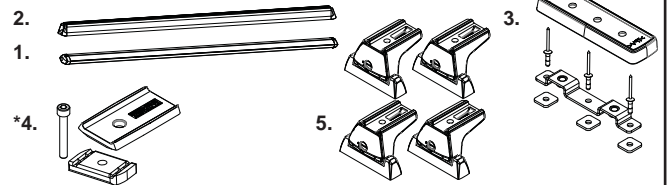

Note:

All parts are sold as separate. Ensure you have the required kits to complete your fitment.

Tools Required:

- Masking tape
- Cold Galvanising Paint
- Vacuum
- Pneumatic Rivet Gun
- Cotton buds
- Tape measure
- Power Drill
- 5mm drill bit and Stop
- Marking Pen
- Scrape of similar

Instructions

1 Starting at the B Pillar of the vehicle, place Masking Tape next to the Ditch. Move backward toward the rear of the vehicle approximately 1200mm and place Masking Tape in the same fashion.

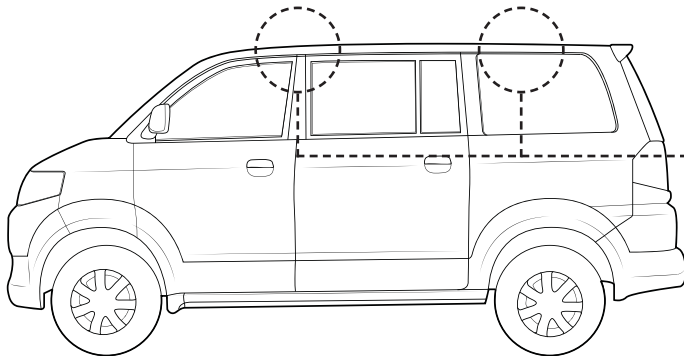

Apply a layer of Masking Tape next to the Ditch.

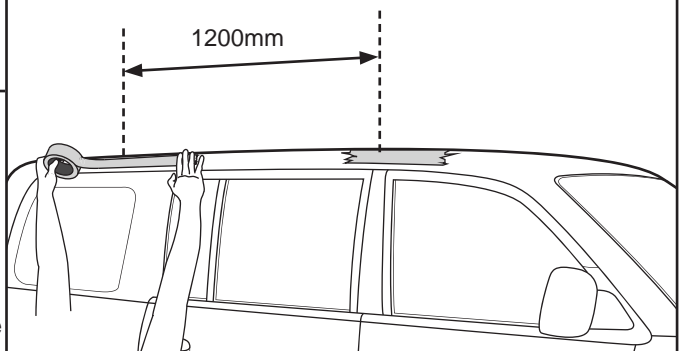

Note: Wider spacing is selected for commercial applications. Use 800mm for carrying other accessories.

2 Mark the Tape in line with the rear section of the B Pillar as shown. From this point move to the rear 1200mm and create a reference on the Tape.

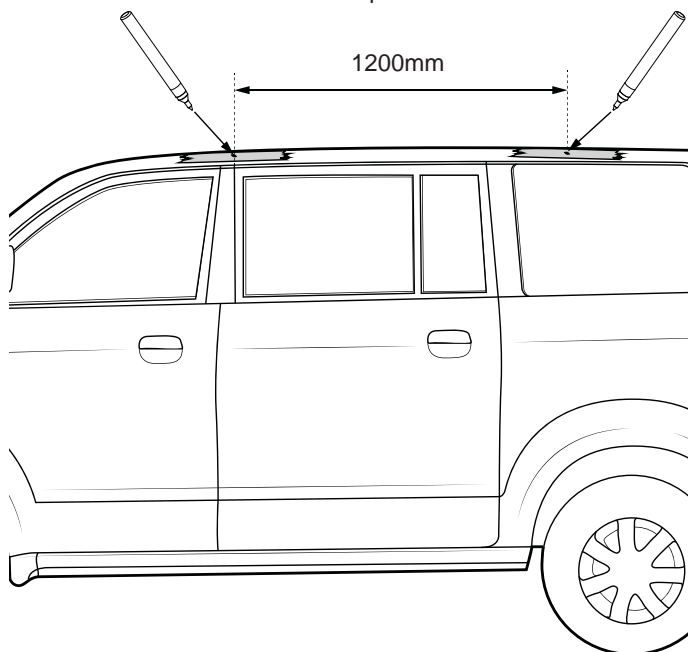

3 Place a Bracket into the Ditch with the centre hole of the Bracket in line with the reference made previous. The Bracket will sit at the front of the Ditch partially on top of the body fill as shown.

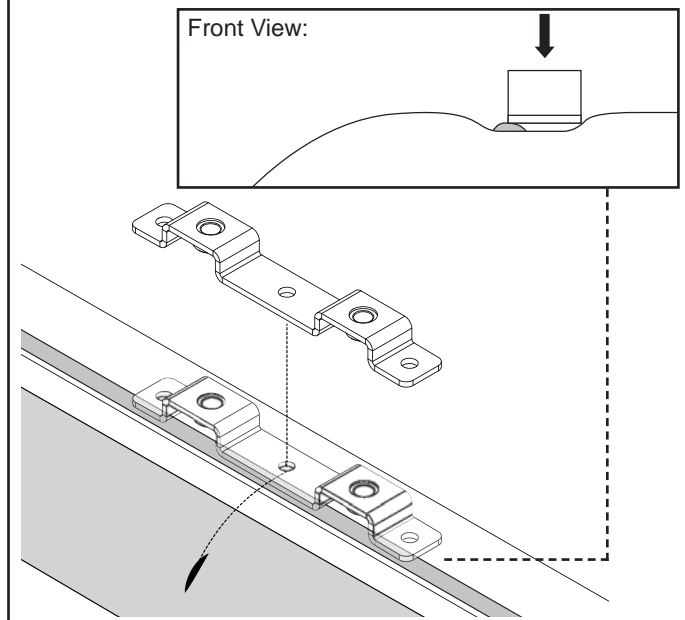



Suzuki APV QMFK15 Fitment

4 Mark the front and rear edges of the Bracket onto the body fill.

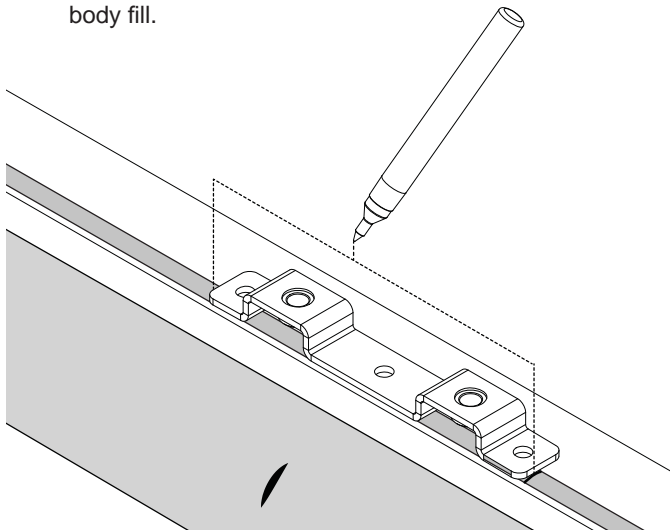

5 Carefully cut through the body fill using the references made previous. Create a third cut between the slices on both reference marks. Avoid excessive damage to the roof below.

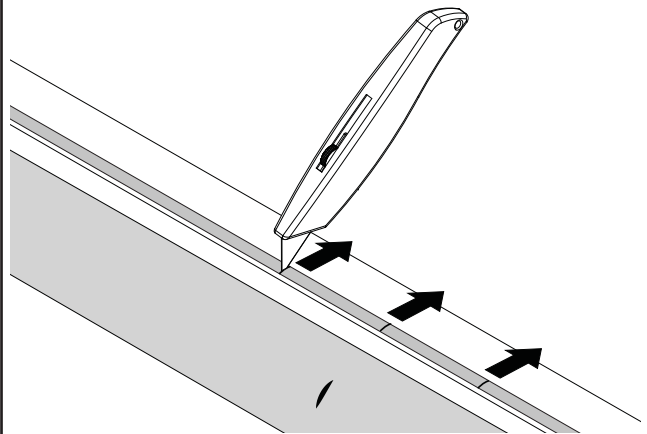

6 Starting at the centre slit made previous, use a Scrape or similar and remove the body fill as shown. Be careful to not do excessive damage to the bodywork.

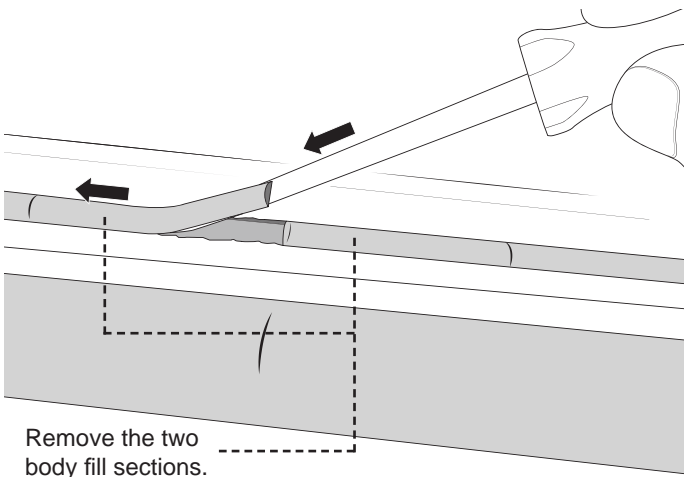

6 Place the Brackets as shown. They should be about halfway through the body fill, moving closer to the centre of the vehicle. Spot drill all Rivet Holes. Do not drill through roof at this stage.

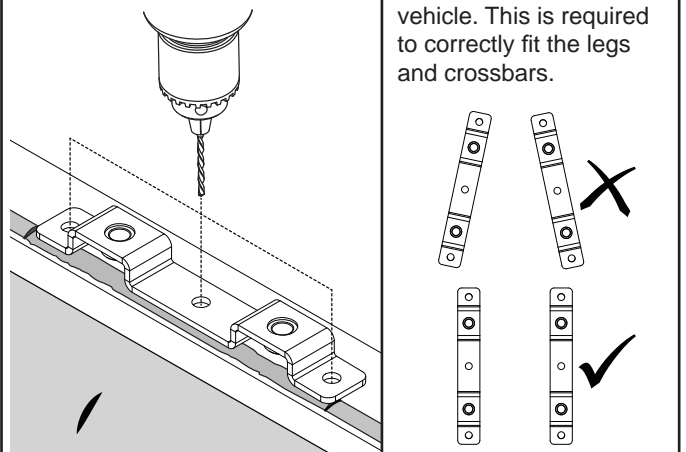

7 Remove the Bracket and drill out spot drill marks. Use a 5mm Drill Bit with a Drill Stop set to 5mm.

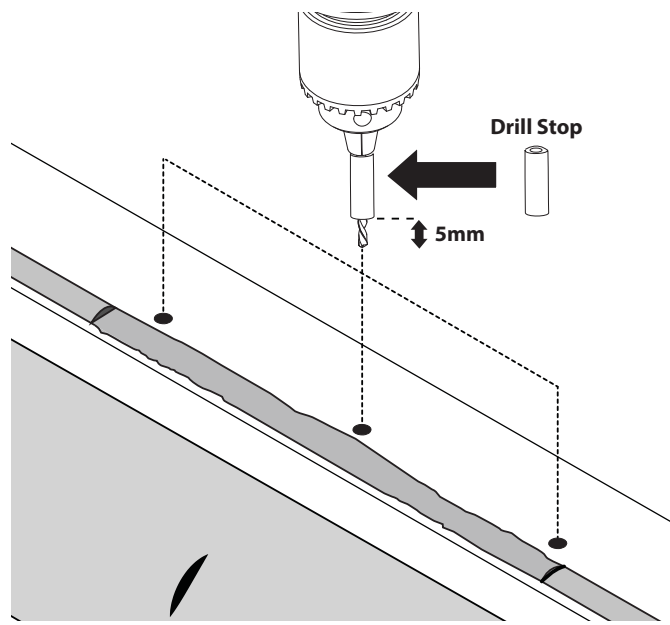

8 Vacuum any swarf from the drilled areas.

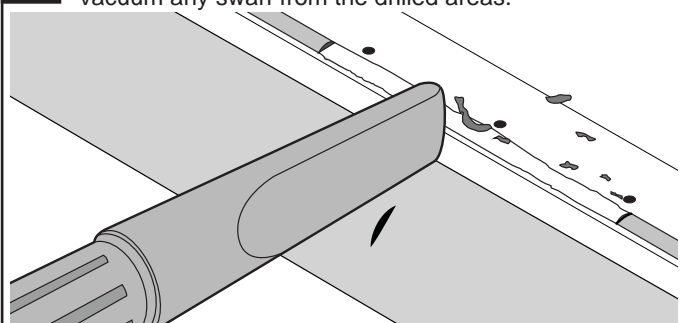

9 Using Cold Galvanising Paint, cover all drilled areas and any exposed body work. Allow to dry.

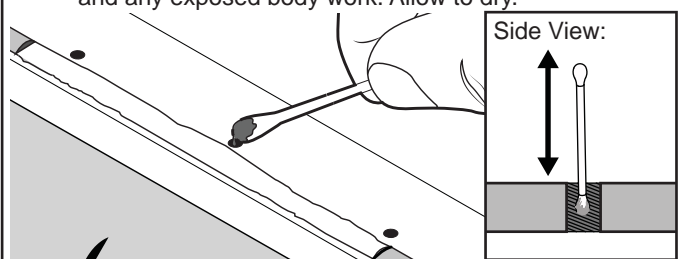



Suzuki APV QMFK15 Fitment

10 Peel off the one side of backing tape on the Butyl Patches provided. Place these carefully over all holes drilled. Remove the top layer of backing tape as shown. If needed Butyl Patches can be trimmed slightly to fit into location.

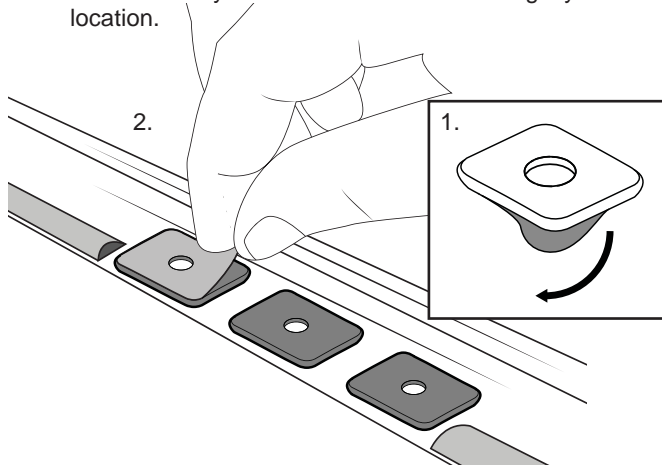

11 Press the Ditch Brackets into position over the drilled holes. Using a Pneumatic Rivet Gun, fix the Brackets in place with Rivets provided. Be sure Brackets are aligned correctly.

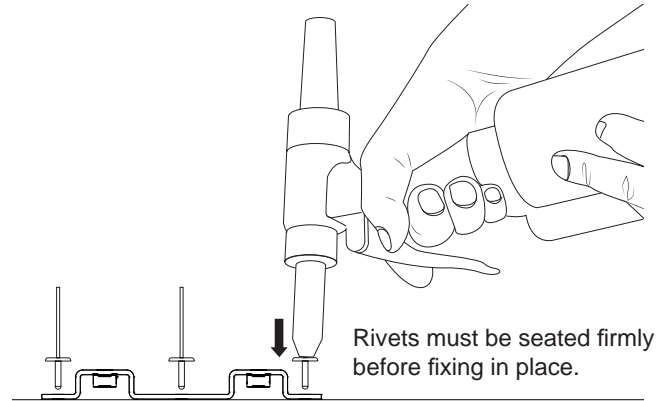

12 Install leg kits as per corresponding instructions.

QMHD05 (Heavy Duty Crossbars/ Pioneer only)

RLT600

*M829

***NOTE:** M829 will sit on top of the installed Bracket. The Gasket will cover exposed areas of the Bracket and Ditch Mould.

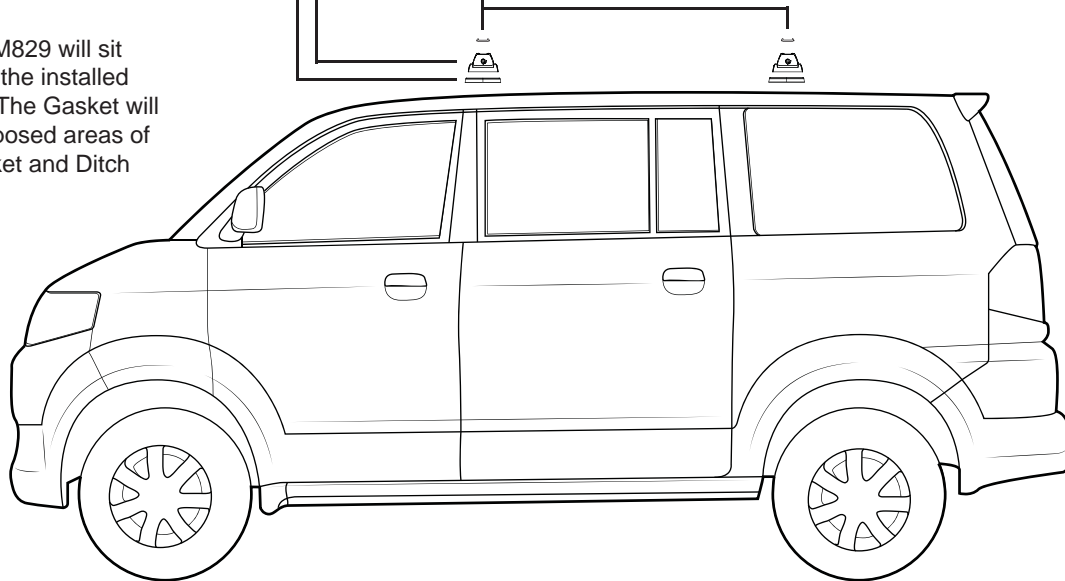

Rhino-Rack
3 Pike Street, Rydalmere,
NSW 2116, Australia.
(Ph) (02) 9638 4744
(Fax) (02) 9638 4822

Document No: R1015
Prepared By: Kayle Everett
Authorised By: Chris Murty

Fit Time: 1 Hour
Issue No: 02
Issue Date: 15/07/16

These instructions remain the property of Rhino-Rack Australia Pty. Ltd. and may not be used or changed for any other purpose than intended.