



# RHINO-RACK

## Mercedes-Benz Sprinter Dual Cab QMFK15 Fitment

**Important:** Please read these instructions carefully prior to and during installation.  
Check the contents of kit before commencing fitment and report any discrepancies.

Item	Components	VA Qty	HD	Part No.
1	Vortex Crossbar	2	-	VA150S/B
2	Heavy Duty Crossbars	-	2	RB1500S/B
3	Quick Mount Roof Ditch Bracket	2	2	QMFK15
*4	Quick Mount HD Spacer 5mm	-	2	QMHD05
5	Leg and Base Kit	1	1	RLT600
6	Fitting Instructions	1	1	R1160

\* For use with Pioneer Tray/ Platform. Optional when using HD or Vortex Bars.

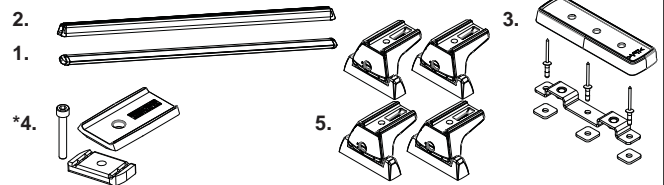

**Note:**

All parts are sold separately. Ensure you have the required kits to complete your fitment.

**Tools Required:**

- Masking tape
- Cold Galvanising Paint
- Vacuum
- Pneumatic Rivet Gun
- Cotton buds
- Tape measure
- Power Drill
- 5mm drill bit and Stop
- Marking Pen

### Instructions

**1** Apply a layer of tape into the ditch in the approximate working area.

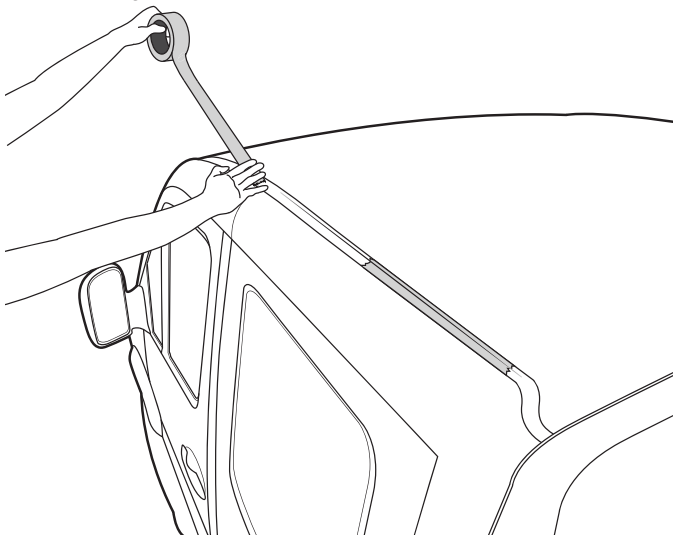

**2** Measure forward from the Door Jamb 150mm and create a reference. From this point measure backward 830mm and create a second reference.

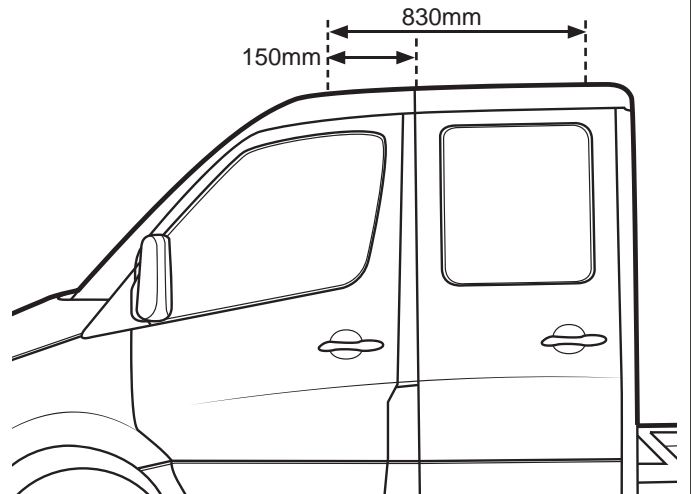

**3** Place a Bracket centred at these points. Be sure Brackets are parallel. Be sure Brackets are parallel across the vehicle. This is required to correctly fit the legs and crossbars.

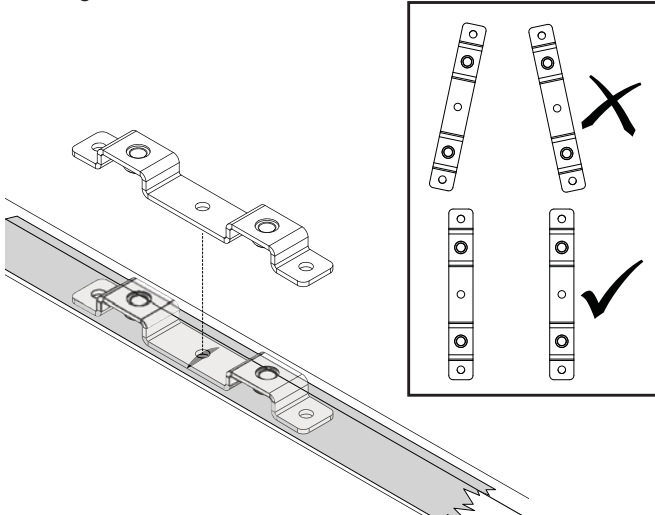

**4** Create a reference in each of the Rivet holes as shown.

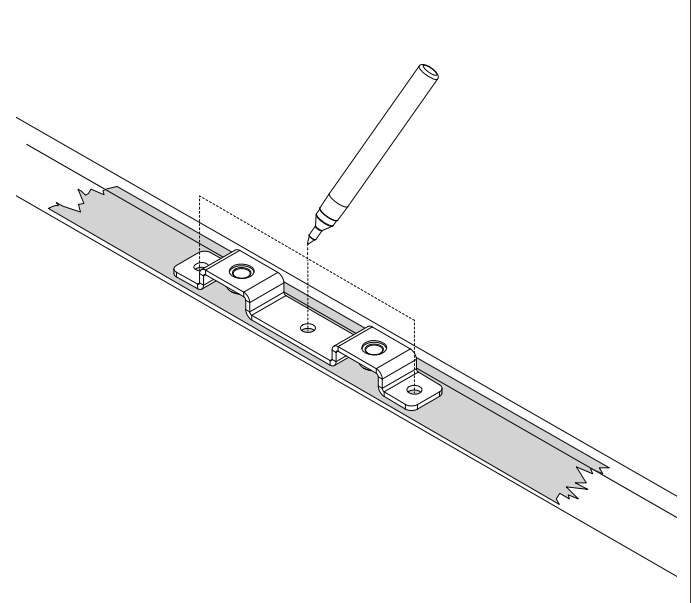



# Mercedes-Benz Sprinter Dual Cab - QMFK

**5** Remove the Bracket and drill out spot drill marks. Use a 5mm Drill Bit with a Drill Stop set to 5mm.

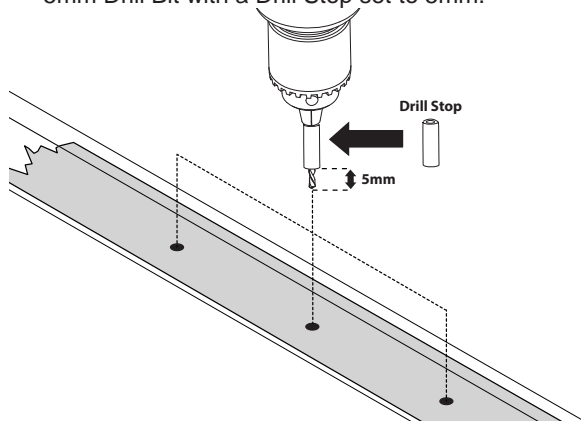

**6** Vacuum any swarf from the roof caused by drilling. Remove the Masking Tape from the roof.

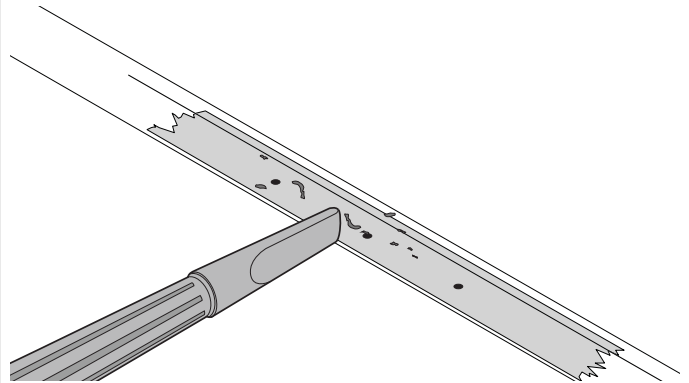

**7** 1: Using Cold Galvanising Paint, cover all drilled areas and any exposed body work. Allow to dry.

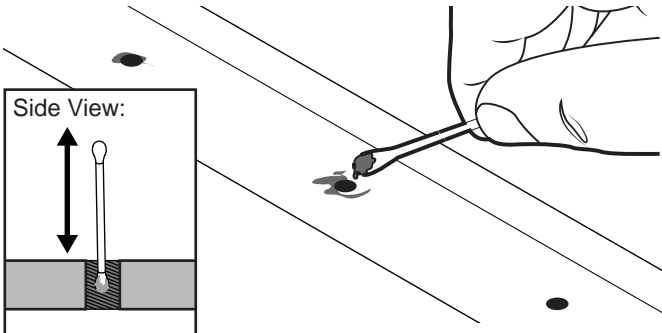

2: Peel off the one side of backing tape on the Butyl Patches provided. Place these carefully over all holes drilled. Remove the top layer of backing tape as shown.

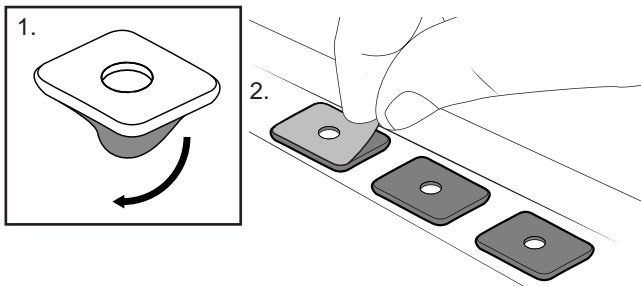

**8** Press the Ditch Brackets into position over the drilled holes. Using a Pneumatic Rivet Gun, fix the Brackets in place with Rivets provided. Be sure Brackets are aligned correctly.

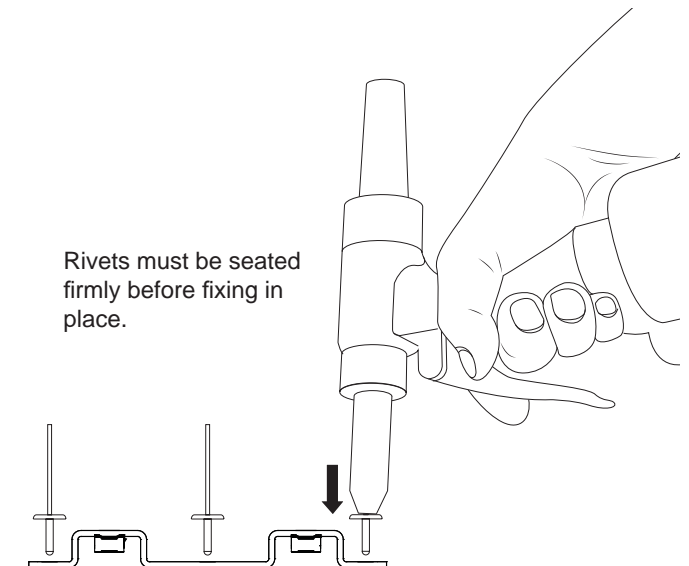

**9** Install leg kits as per corresponding instructions.

**\*NOTE:** M829 will sit on top of the installed Bracket. The Gasket will cover exposed areas of the Bracket and Ditch.

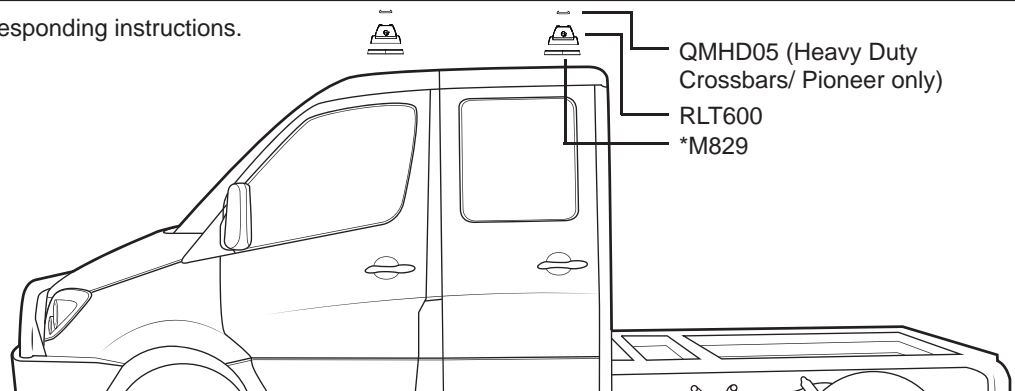

Rhino-Rack  
3 Pike Street, Rydalmere,  
NSW 2116, Australia.  
(Ph) (02) 9638 4744  
(Fax) (02) 9638 4822

Document No: R1160  
Prepared By: Kayle Everett  
Authorised By: Chris Murty

Fit Time: 1 Hour  
Issue No: 01  
Issue Date: 17/10/16

These instructions remain the property of Rhino-Rack Australia Pty. Ltd. and may not be used or changed for any other purpose than intended.