



RHINO-RACK

QMFK09, QMFK10 Mitsubishi Triton MQ Double Cab

Important: Please read these instructions carefully prior to and during installation.
Check the contents of kit before commencing fitment and report any discrepancies.

Item	Components	VA Qty	HD	Part No.
1	Vortex Crossbar	2	-	VA126S/B
2	Heavy Duty Crossbar	-	2	RB1250S/B
3	Quick Mount Roof Ditch Bracket	1	1	QMFK09
4	Quick Mount Roof Ditch Bracket	1	1	QMFK10
5	Quick Mount Base Wedge 10mm	1	1	QMW10
6	Quick Mount Base Wedge 5mm	1	1	QMW05
7	Quick Mount HD Spacer 5mm	-	1	QMHD05
8	Quick Mount HD Spacer 20mm	-	1	QMHD20
9	Quick Mount VA Spacer 15mm	1	-	QMVA15
10	Leg and Base Kit	1	1	RLT600
11	Fitting Instructions	1	1	R974

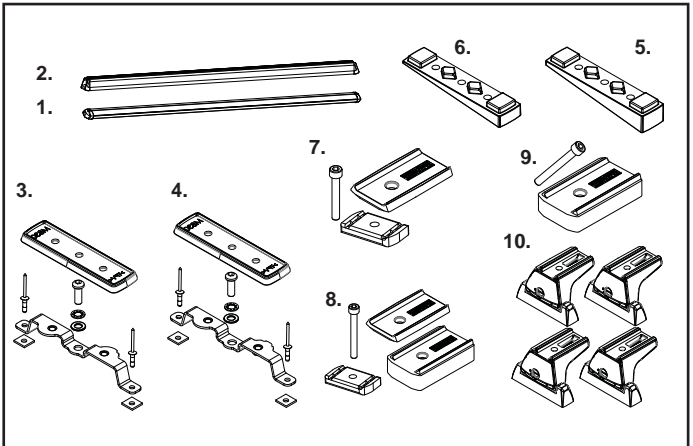

Note:
All parts are sold as separate. Ensure you have the required kits to complete your fitment.

- Tools Required:**
- Pneumatic Rivet Gun
 - Masking tape
 - Cold Galvanising Paint
 - Vacuum
 - 5mm drill bit and Stop
 - Cotton buds
 - Tape measure
 - Power Drill
 - Cutters
 - Marking Pen

Instructions

1 Starting at the front of the vehicle, carefully lift the Ditch Mould.

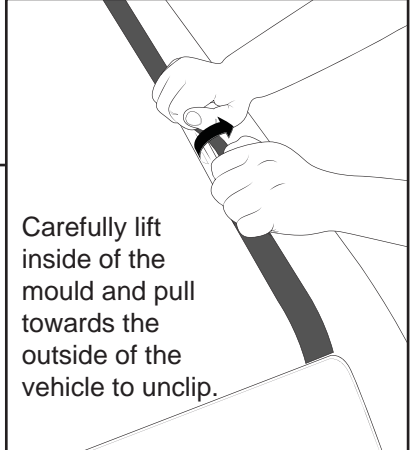
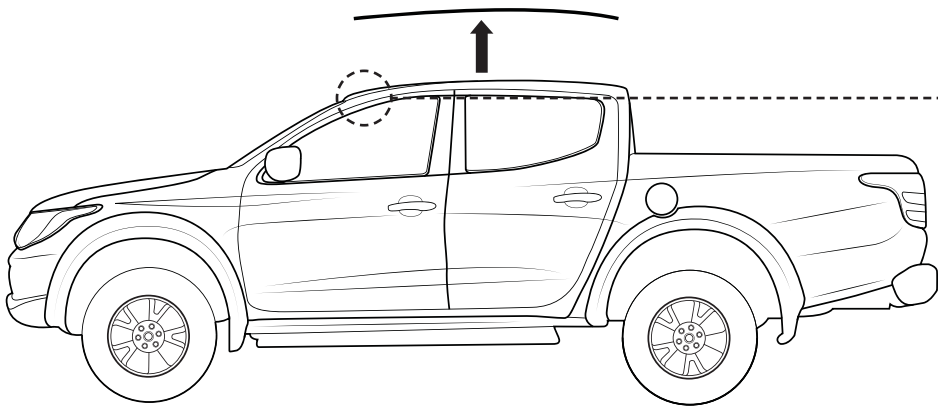

2 Place the QMFK Brackets into position above the mounting points on the vehicle, both sides.

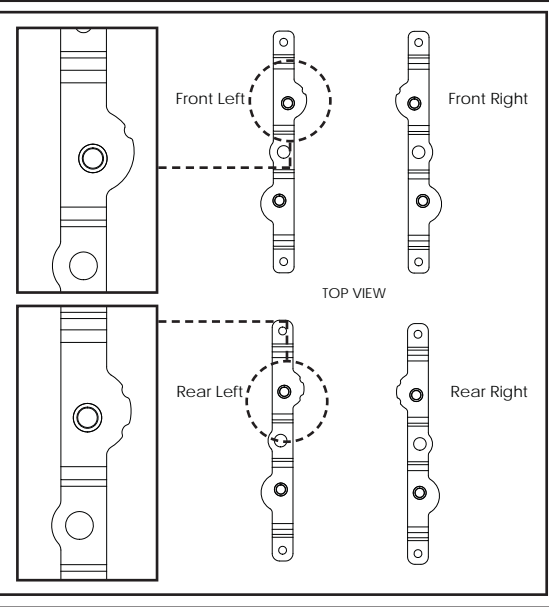
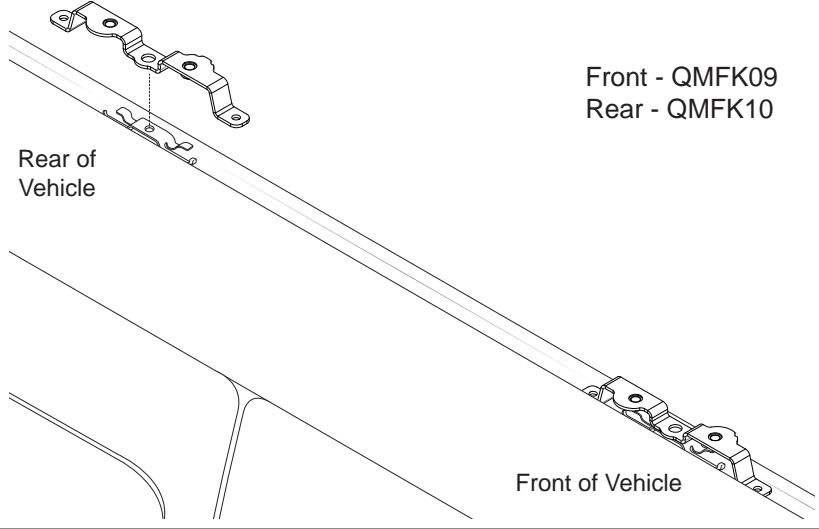



QMFK09, QMFK10 Mitsubishi Triton MQ Double Cab

3 Insert the M8 Screws, Shake Proof Washer and Flat Washers to hold the Brackets in place. Use a marker and create a reference in both rivet holes.

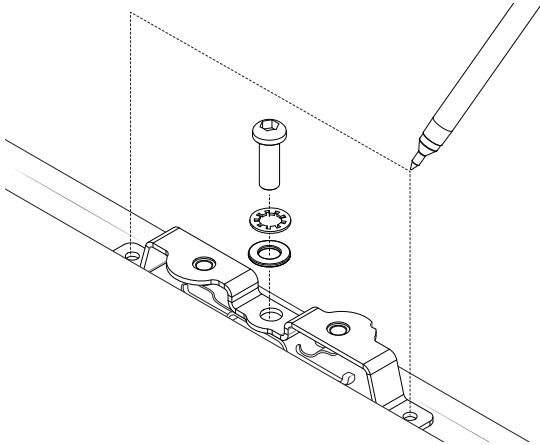

4 Remove the Bracket. Use a 5mm Drill Bit with a Drill Stop set to 8-9mm. Open up all marked rivet holes.

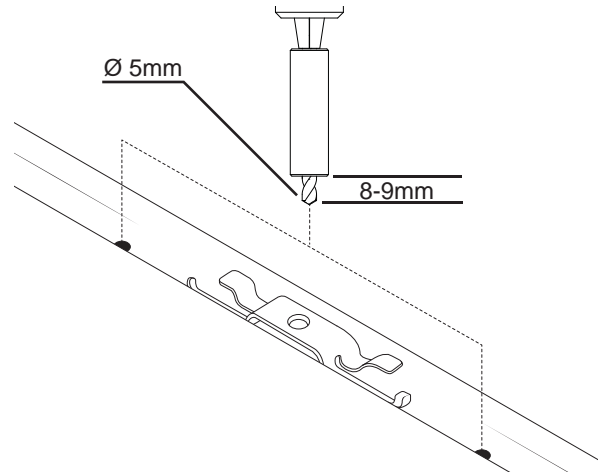

5 Using Cold Galvanising Paint, cover all drilled areas and any exposed body work.

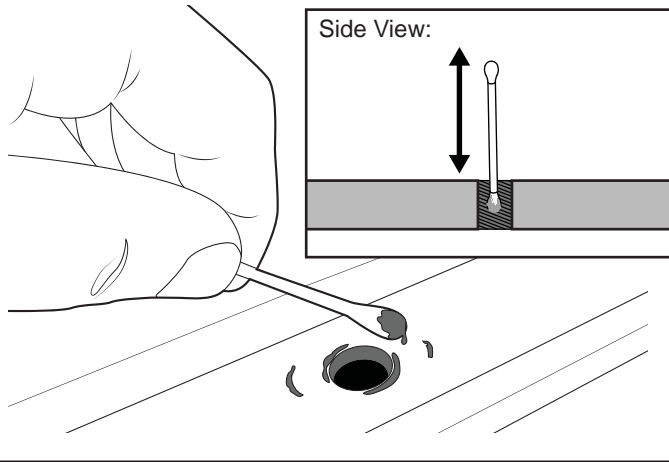

6 Vacuum any swarf from the roof.

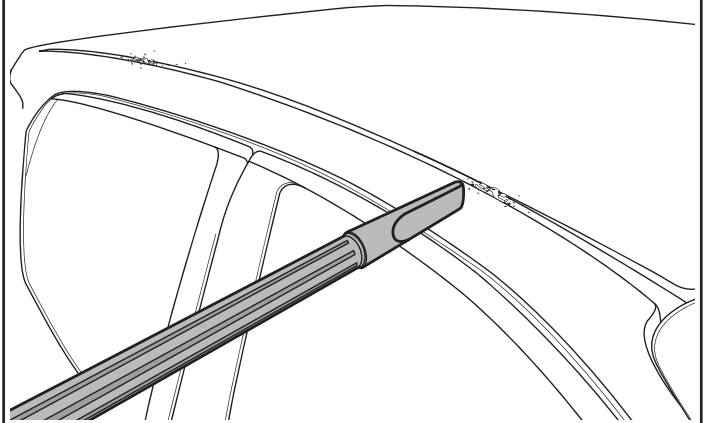

7 1: Peel off one side of backing tape on the Butyl Patches provided. Place these carefully under the two rivet holes on each Bracket.

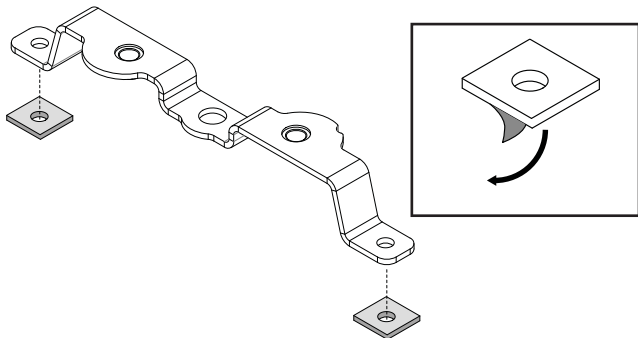

2: Remove the final layer of backing tape from the patches.

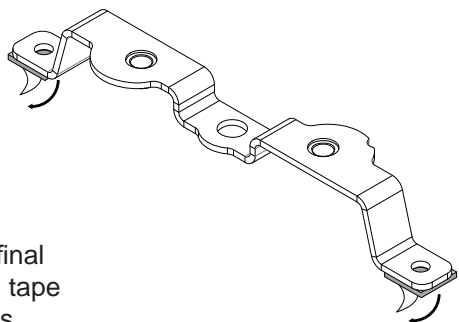

8 Refer Step 2 for correct orientation: Place Ditch Brackets into position. 1: Install M8 Hardware to fasten the Bracket. 2: Using a Pneumatic Rivet Gun, fix the Brackets in place with Rivets provided.

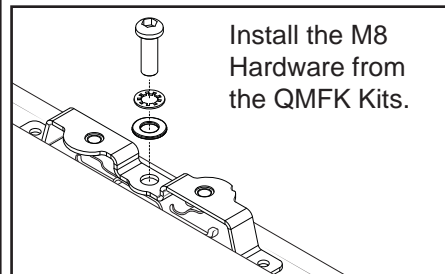

Bracket orientation:
CA1634 - Front Right
CA1635 - Front Left
CA1636 - Rear Right
CA1637 - Rear Left

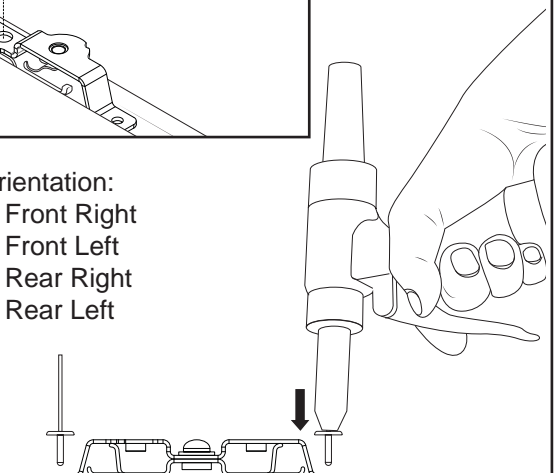



QMFK09, QMFK10 Mitsubishi Triton MQ Double Cab

9 The Ditch Mould must be cut to fit around the brackets.

1: Lay the Mould next to the roof ditch. Mark the positions of the installed Brackets onto the Mould. Use measurements provided as a guide. Check against your vehicle in case of variance.

2: With Cutters, carefully snip the Mould to suit.

Discard

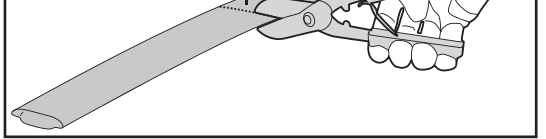

3: Replace the Mould around the Brackets.

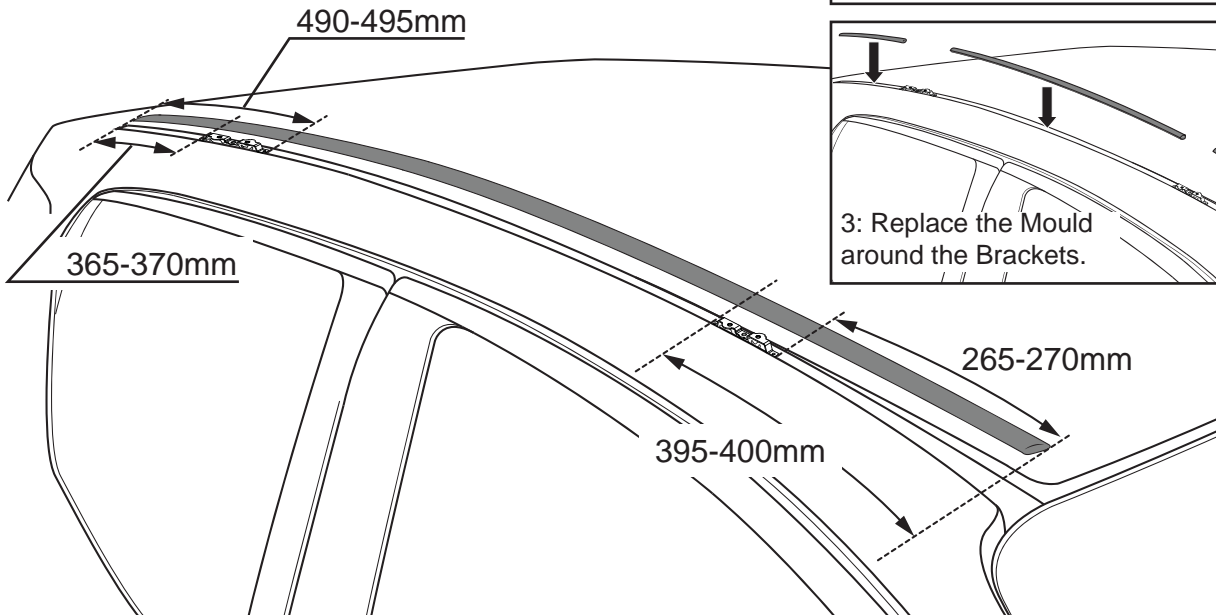
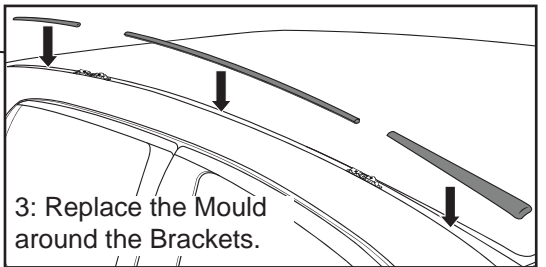

10 Install leg kits as per corresponding instructions.

- QMVA15 _____
- QMHD20 - Heavy Duty bars, Pioneer only. _____
- RLT600 _____
- QMW10 _____
- *M829 _____

***NOTE:** Rubber Skirt M829 will sit on top of the installed Bracket to cover exposed areas of the Bracket and Ditch Mould.

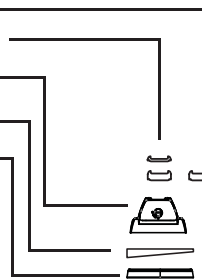

- _____ QMHD05. Heavy Duty bars, Pioneer only.
- _____ QMW05
- _____ *M829

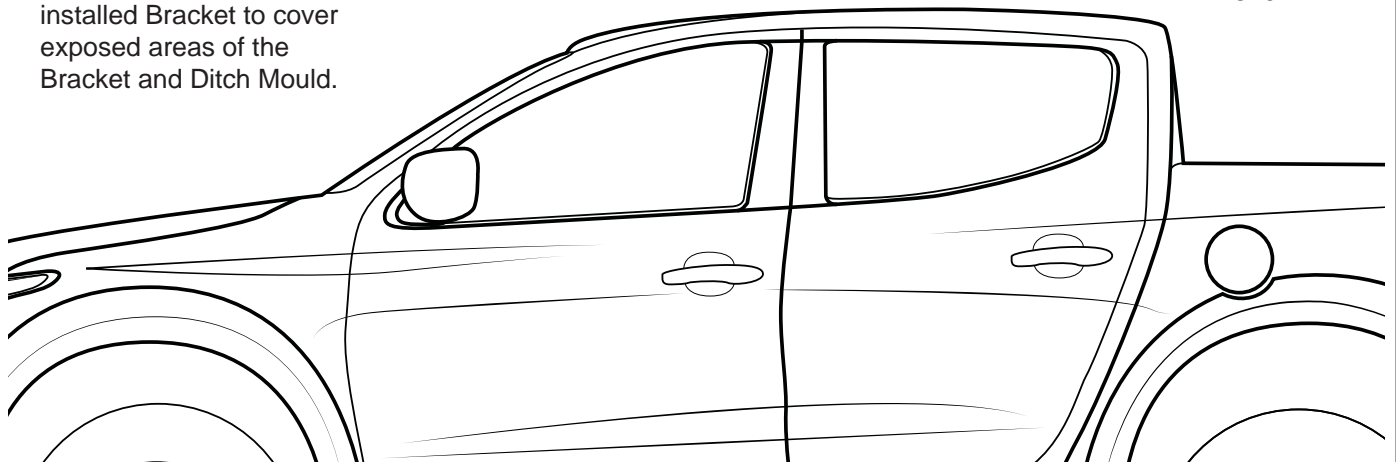

Rhino-Rack
3 Pike Street, Rydalmere,
NSW 2116, Australia.
(Ph) (02) 8846-1900
(Fax) (02) 9638-4822

Document No: R974
Prepared By: Kayle Everett
Authorised By: Chris Murty

Fit Time: 1 Hour
Issue No: 03
Issue Date: 24/02/17

These instructions remain the property of Rhino-Rack Australia Pty. Ltd. and may not be used or changed for any other purpose than intended.