



RHINO-RACK

Ford Ranger/ BT50 2011-on QMFK Supplement

Important: Please read these instructions carefully prior to and during installation.
Check the contents of kit before commencing fitment and report any discrepancies.

Rhino-Rack
3 Pike Street, Rydalmere,
NSW 2116, Australia.
(Ph) (02) 9638 4744
(Fax) (02) 9638 4822

Document No: R1070
Prepared By: Kayle Everett
Authorised By: Chris Murty

Fit Time: 1 Hour
Issue No: 01
Issue Date: 01/07/16

These instructions remain the property of Rhino-Rack Australia Pty. Ltd. and may not be used or changed for any other purpose than intended.

Parts List

Item	Components	VA Qty	HD	Part No.
1	Vortex Crossbar	2	-	VA137S/B
2	Heavy Duty Crossbars	-	2	RB1375S/B
3	Quick Mount Roof Ditch Bracket	2	2	QMFK08
4	Quick Mount Base Wedge 10mm	1	1	QMW10
5*	Quick Mount HD Spacer 5mm	-	2	QMHD05
6	Leg and Base Kit	1	1	RLT600
7	Fitting Instructions	1	1	R1070

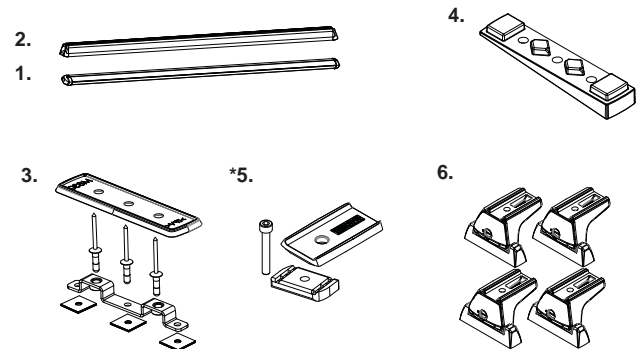

Instructions

- 1** Move to the Roof of the vehicle. Apply Masking Tape to either side of the Ditch Mould in the approximate working area. Apply at least 4 layers of Tape to either side of the Ditch.

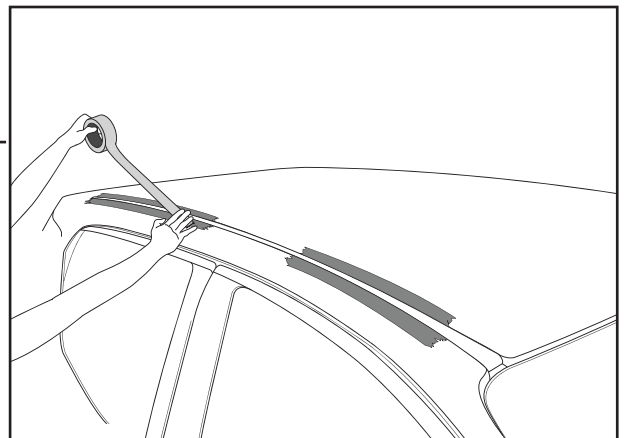
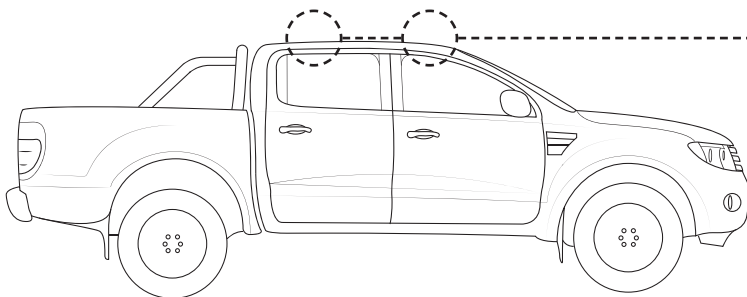

- 2** Starting from the Door Jamb of the vehicle, measure out the references below. With a Marker, indicate these points onto the Tape next to the Ditch Mould.

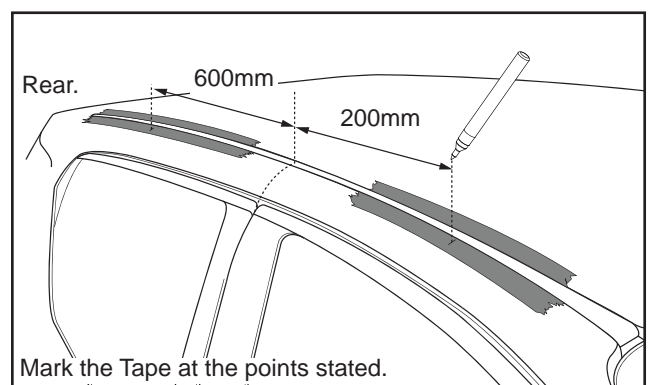
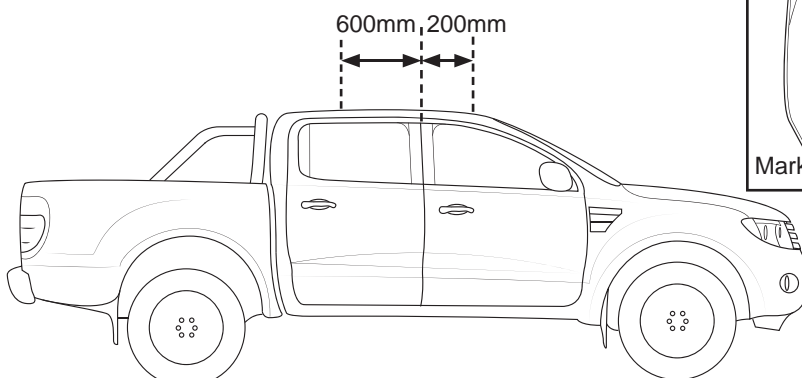



Ford Ranger/ BT50 2011-on QMFK Supplement

- 3** Place a QMFK Bracket next to the references previously made as shown.

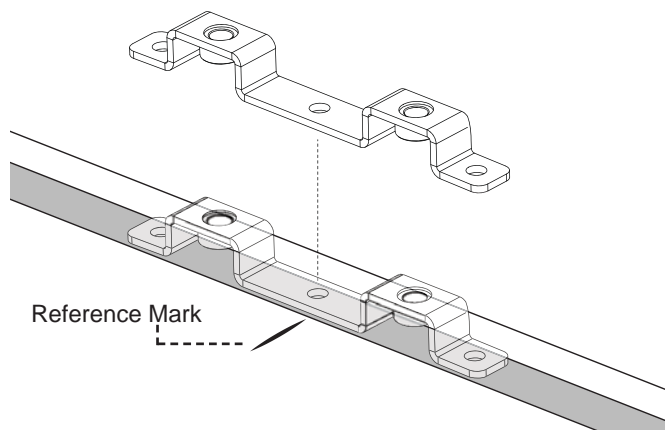

- 4** Mark either end of the Bracket onto the Ditch Mould.

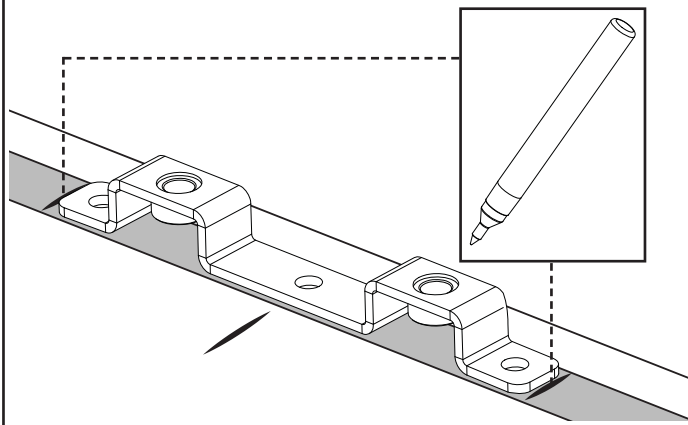

- 5** Use a Blade and carefully score the Ditch Mould. Be sure to not cut right through and damage the paint work.

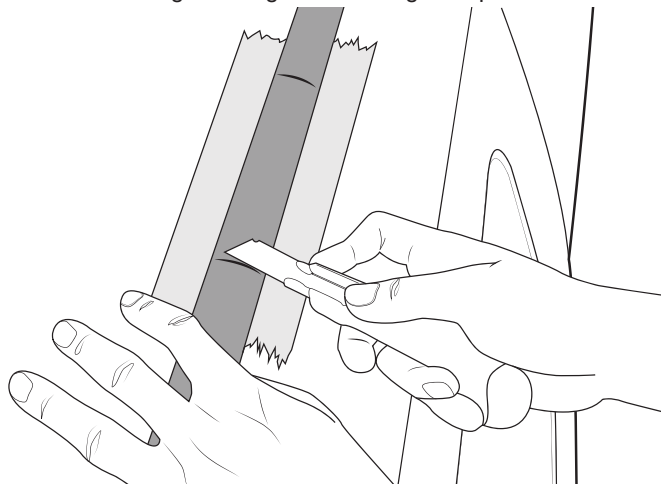

- 7** Use a Nylon Scrape or similar ad remove any material left in the Ditch after removing the Mould.

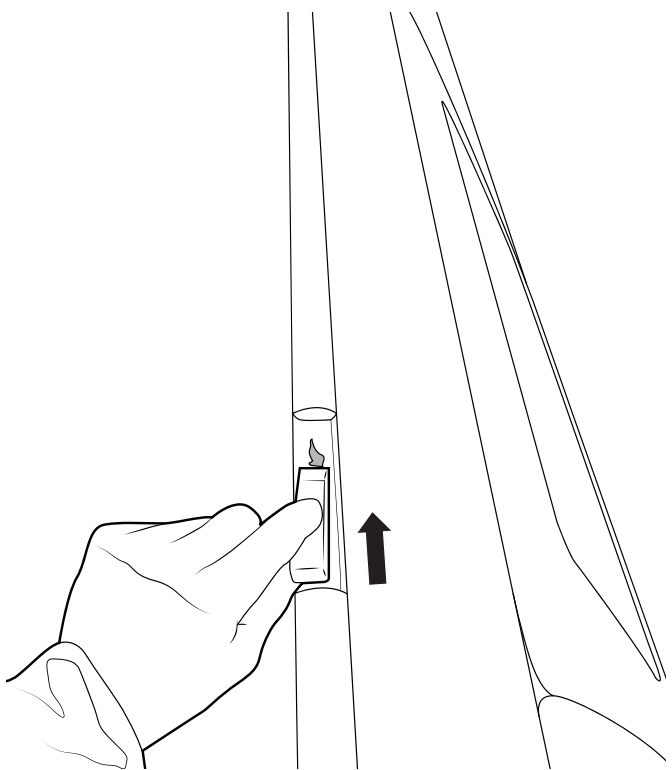

- 6** 1: Hook a hand inside the Mould and pull towards the outside of the vehicle. 2: With assistance, cut out the areas of Mould marked out previous. Use extreme caution with cutters, ensuring the tool doesn't touch the paintwork.

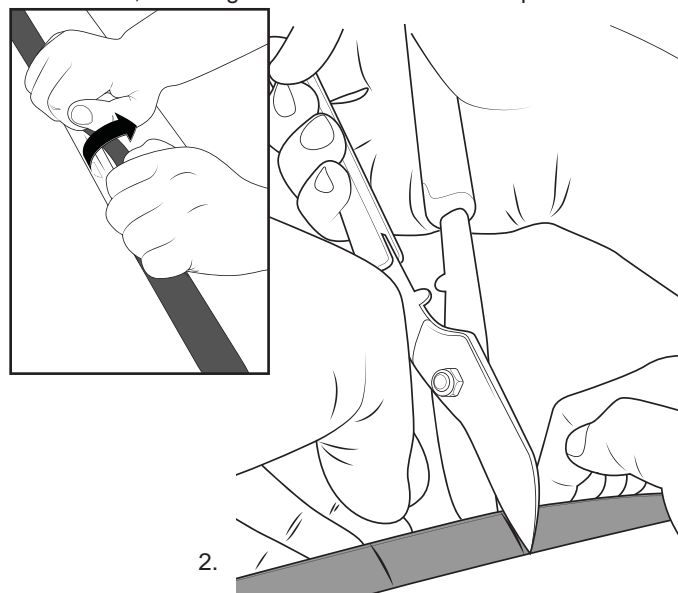

- 8** Replace the Brackets into the Ditch. The leading edge of the Front Bracket **must pivot 5mm in toward the centre of the vehicle**. This will ensure all Brackets are parallel in the Ditch.

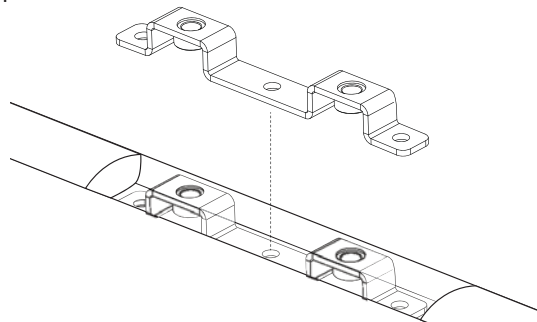

Top View: Front Bracket. Bracket must pivot 5mm in toward the centre of the vehicle.

Rear

Front

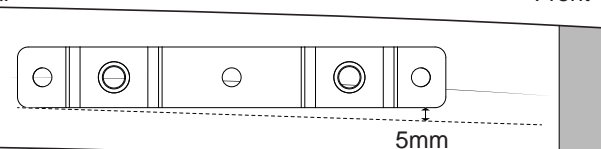



Ford Ranger/ BT50 2011-on QMFK Supplement

- 9** With the Brackets in place, spot drill all Rivet Holes in each Bracket. Do not Drill through the Roof at this stage.

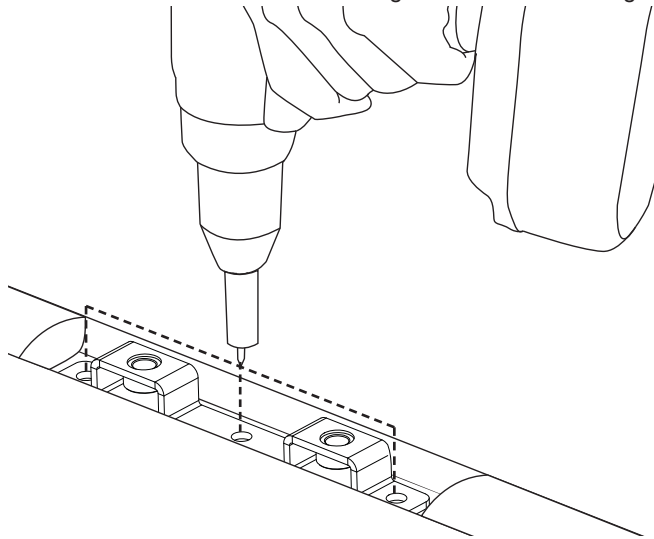

- 10** Remove the Bracket. Drill through all spot marks with a 5mm Drill Bit. Use a Drill Stop set to 5-7mm

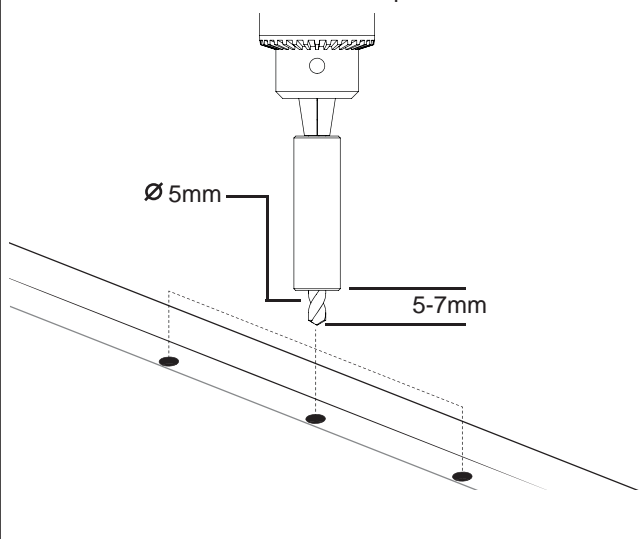

- 11** Vacuum any swarf from the roof.

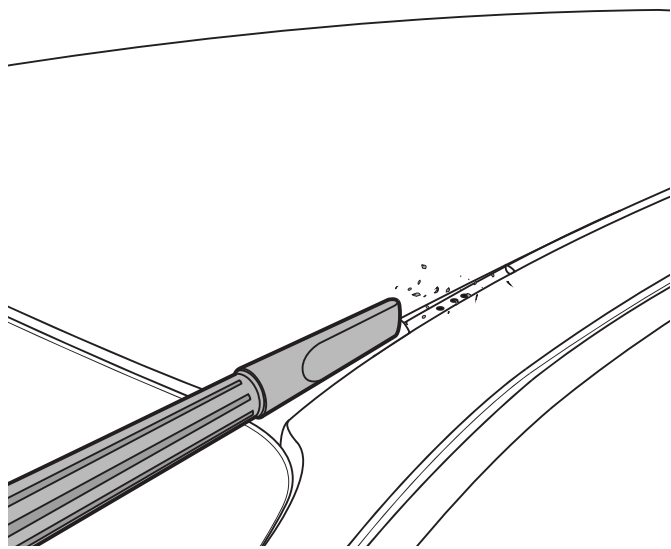

- 12** Using Cold Galvanising Paint, cover all drilled areas and any exposed body work.

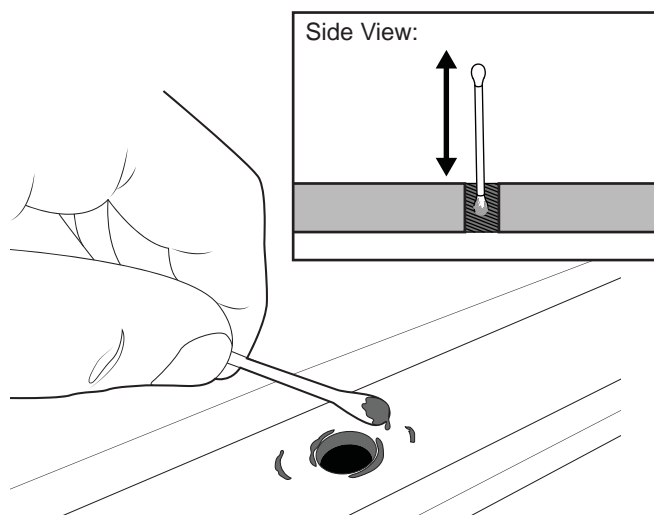

- 13** Peel off the one side of backing tape on the Butyl Patches provided. Place these carefully over all holes drilled. Remove the top layer of backing tape as shown.

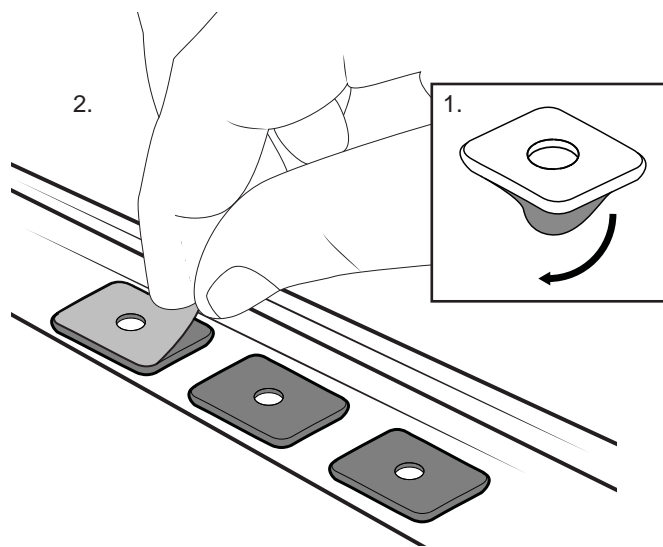

- 14** Press the Ditch Brackets into position over the drilled holes. Using a Pneumatic Rivet Gun, fix the Brackets in place with Rivets provided. Be sure Brackets are aligned correctly.

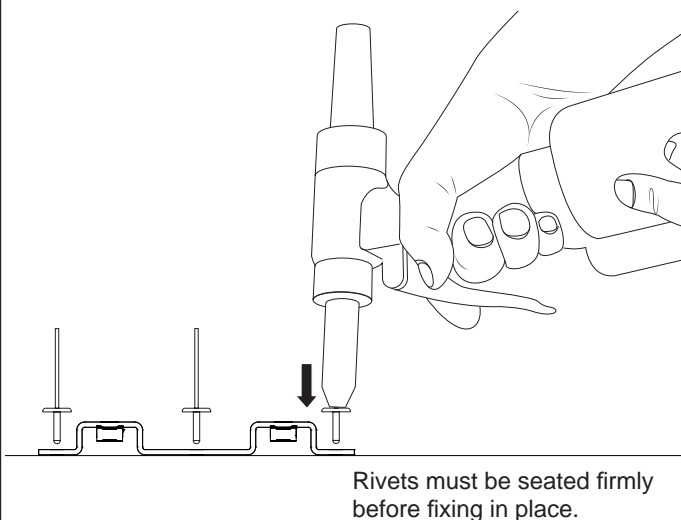



Ford Ranger/ BT50 2011-on QMFK Supplement

15

Install leg kits as per corresponding instructions.

QMHD05 (Heavy Duty Crossbars/ Pioneer only) -----

RLT600 -----

QMW10 -----

M830* -----



*M830 will sit on top of the installed Bracket. The Gasket will cover exposed areas of the Bracket and Ditch Mould.

