



RHINO-RACK

Ford F250,F350,F450 QMFK Supplement

Important: Please read these instructions carefully prior to and during installation.
Check the contents of kit before commencing fitment and report any discrepancies.

Rhino-Rack
3 Pike Street, Rydalmere,
NSW 2116, Australia.
(Ph) (02) 9638 4744
(Fax) (02) 9638 4822

Document No: R914
Prepared By: Kayle Everett
Authorised By: Chris Murty

Fit Time: 1 Hour
Issue No: 02
Issue Date: 08/03/16

These instructions remain the property of Rhino-Rack Australia Pty. Ltd. and may not be used or changed for any other purpose than intended.

Parts List

Item	Components	VA Qty	HD	Part No.
1	Vortex Crossbar	2	-	VA150/B
2	Heavy Duty Crossbars	-	2	RB1500S/B
3	Quick Mount Roof Ditch Bracket	2	2	QMFK08
4	Quick Mount HD Spacer 5mm	-	2	QMHD05
5	Leg and Base Kit	1	1	RLT600
6	Fitting Instructions	1	1	R914

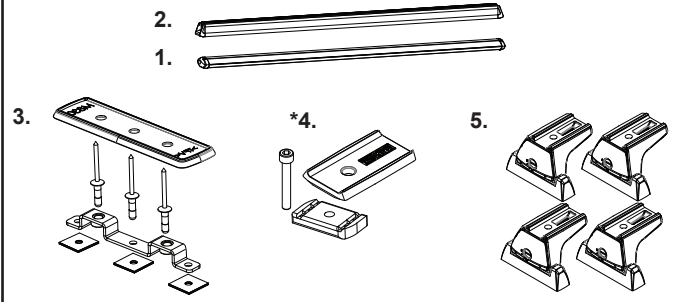

Note:

All parts are sold as separate.
Ensure you have the required
kits to complete your fitment.

Tools Required:

- Masking tape
- Marking Pen
- Cold galvanising paint
- Ø5-6mm Drill stop

- Cotton buds
- Tape measure
- Power Drill
- 5mm drill bit
- Pneumatic Rivet Gun

-Nylon Scrape/Blade

*Use with Pioneer/ Heavy
Duty Fitment

Instructions

1 Starting at the rear of the vehicle, measure toward the front 102mm (4") along the roof ditch Mould. Create a reference at this point.

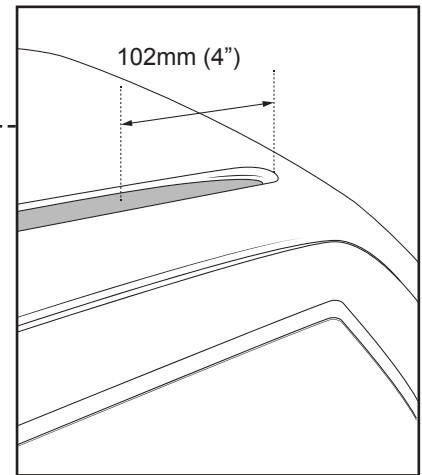
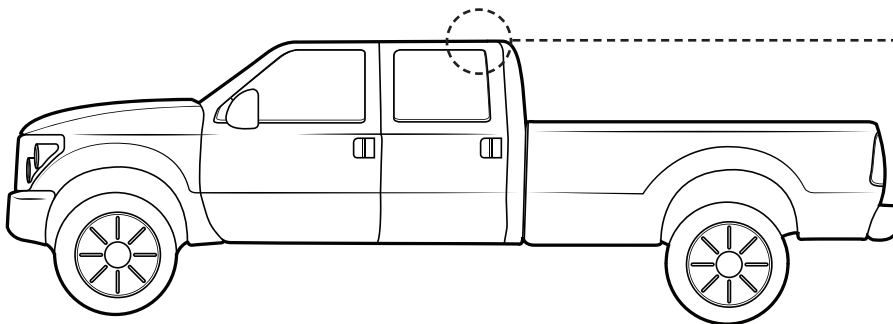

2 Create another reference 800mm (31 1/2") from the point made in step 1, toward the front of the vehicle.

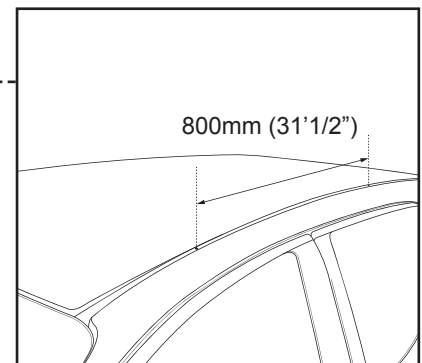
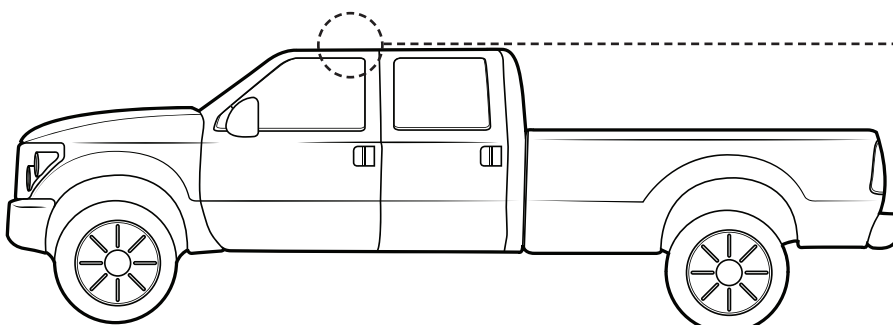



Ford F250,F350,F450 QMFK Supplement

2 Place a QMFK Bracket at these points. The centre hole of the Bracket will sit on the reference previously made. Using a marker, trace around the Bracket onto the Ditch Mould.

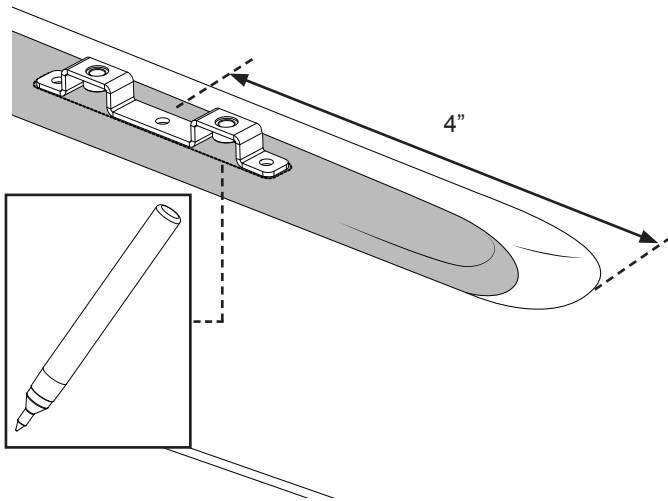

3 Using a Blade and a Nylon Scrape, remove the Ditch Mould Material within areas marked in the previous step. Be sure to reveal the body work below. Marked areas must be free of all Ditch Material.

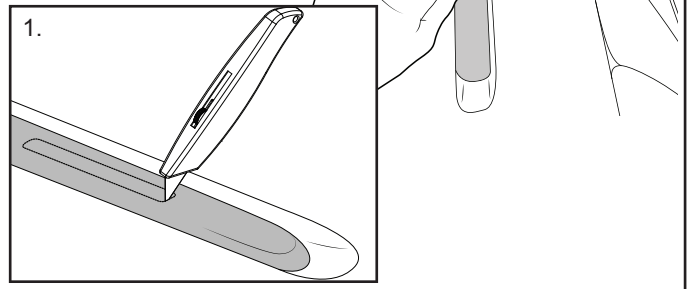

4 Place a QMFK Bracket into the holes made in the Ditch Mould. Using a Marker, create a reference at each of the 3 Rivet holes in the Bracket.

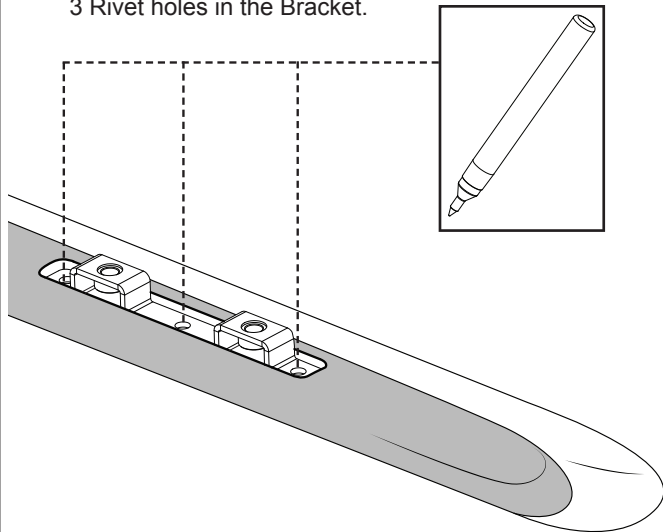

5 Use a Drill Bit (diameter 5mm) to spot mark all Rivet Holes in the Bracket as shown. Be sure the Brackets are parallel on both sides. Use a Drill Stop set to 5-7mm (0.19-0.27") and drill out all spot marks.

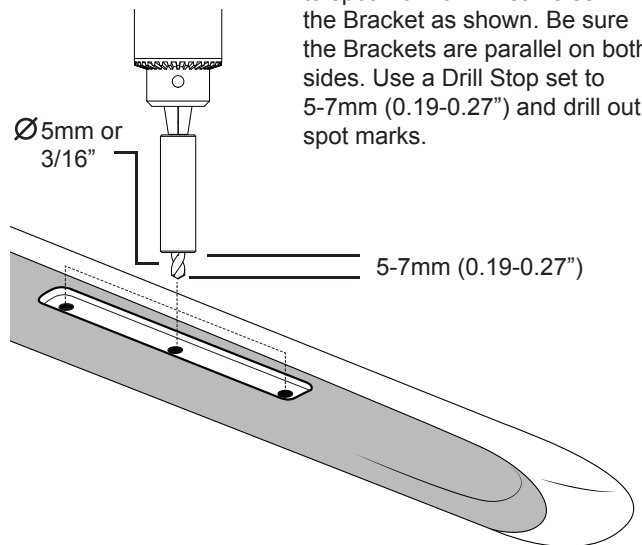

6 Vacuum any swarf from the roof ditch.

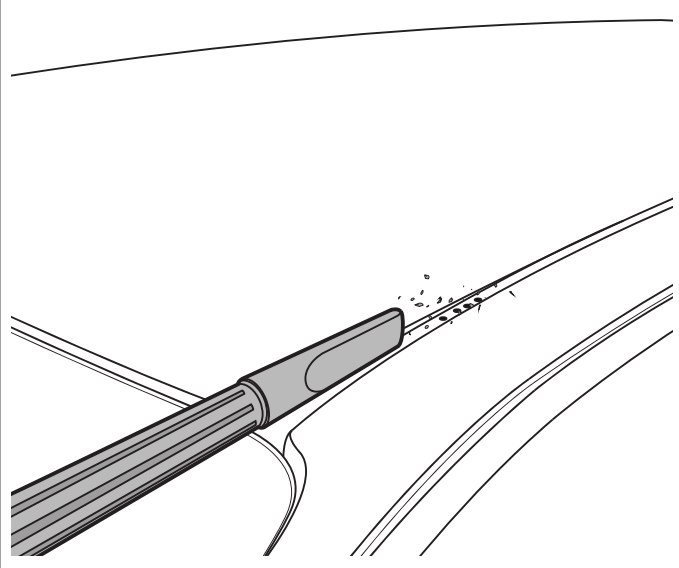

7 Using Cold Galvanising Paint, cover all drilled areas and any exposed body work.

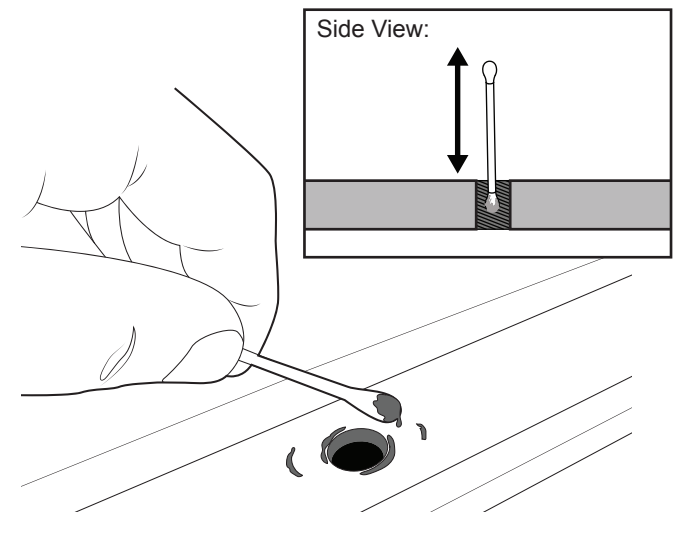



Ford F250,F350,F450 QMFK Supplement

8 Peel off the one side of backing tape on the Butyl Patches provided. Place these carefully over all holes drilled. Remove the top layer of backing tape as shown. If needed Butyl Patches can be trimmed slightly to fit into location.

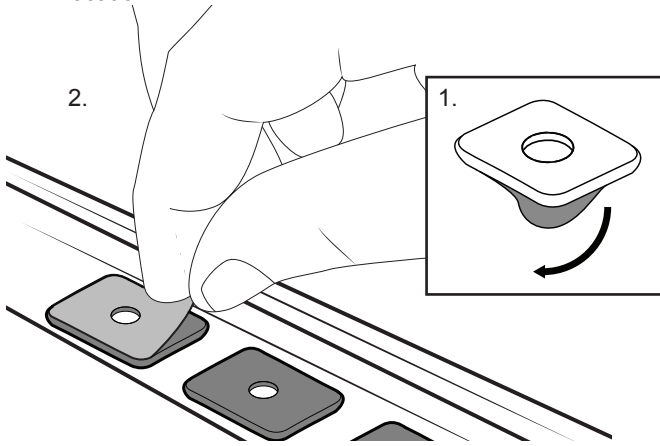

9 Press the Ditch Brackets into position over the drilled holes. Using a Pneumatic Rivet Gun, fix the Brackets in place with Rivets provided. Be sure Brackets are aligned correctly.

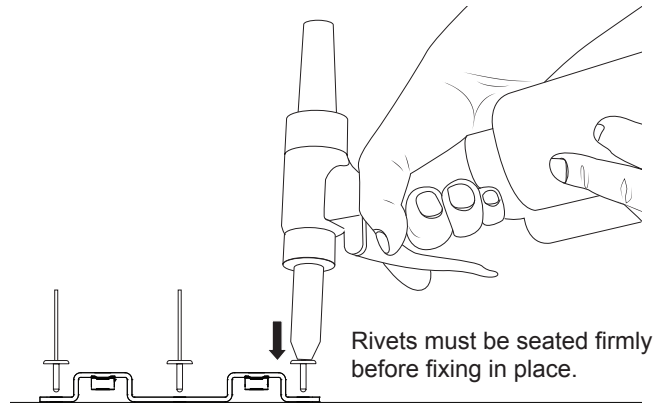

10 Install leg kits as per corresponding instructions.

QMHD05 (Heavy Duty Crossbars/ Pioneer only) -----

RLT600 -----

M830* -----

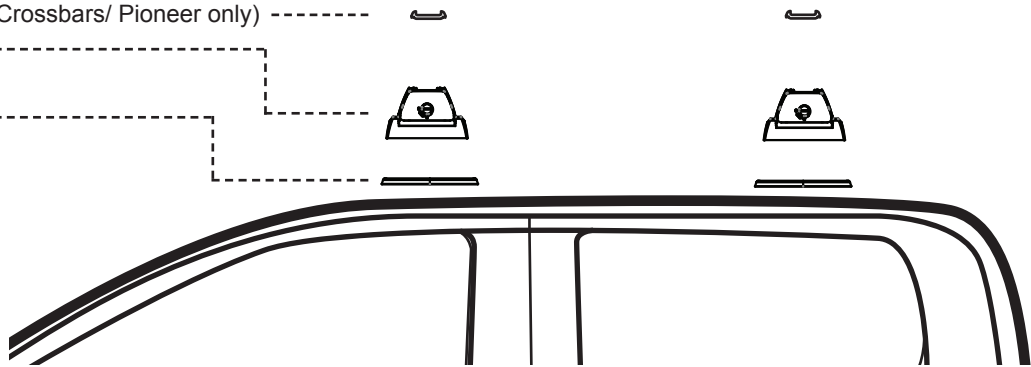

*M830 will sit on top of the installed Bracket and is optional. The Gasket will cover exposed areas of the Bracket and Ditch Mould.