



RHINO-RACK

Aerodynamic & Heavy Duty Roof Rack Systems

CONTROLLED

Rhino-Rack - Mounting Pad Cover Plate To Suit All RSP & RCP Kits

Place these instructions in the vehicle's glove box after installation is complete.

Important:

Please read these instructions carefully prior to installation.
Please refer to your fitting instruction to ensure that the roof racks are installed in the correct locations.
Check the contents of kit before commencing fitment and report any discrepancies.

Parts List

Item	Component Name	Part No.
1	Mounting Pad Cover Plate	M126
2	Fitting Instruction	RS44

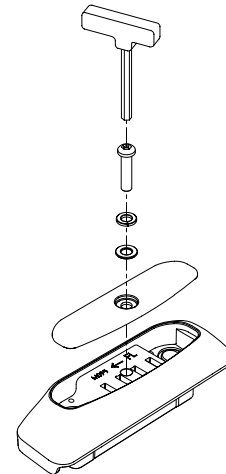

When the crossbars have been removed from the mounting pads, place the cover into the mounting pad recess.

1

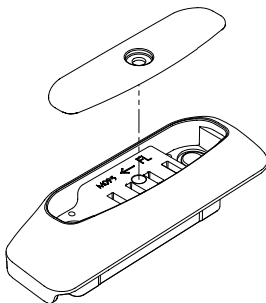

2

Assemble the spring washer and flat washer onto the leg attachment screw used to attach the leg to the mounting pad. Insert the screw assembly through the cover plate hole and screw into the mounting pad.

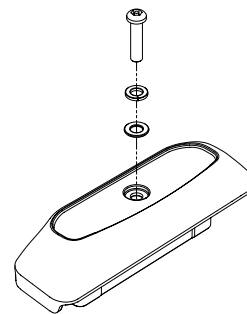

Tighten the screw with the allen key provided.
Do not over tighten.

3

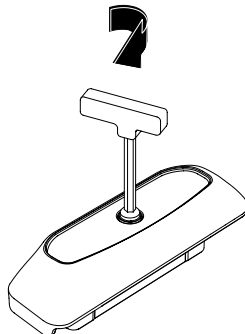

Rhino-Rack
3 Pike Street, Rydalmere,
NSW 2116, Australia.
(Ph) (02) 9638 4744 (Fax) (02) 9638 4822

Document No: RS-44
Prepared By: Sheila Oliveira
Authorised By: Gary England

Issue No: 02
Issue Date: 25/11/2003

These instructions remain the property of Fetovu Pty Ltd T/as Rhino-Rack and may not be used or changed for any other purpose than intended.