

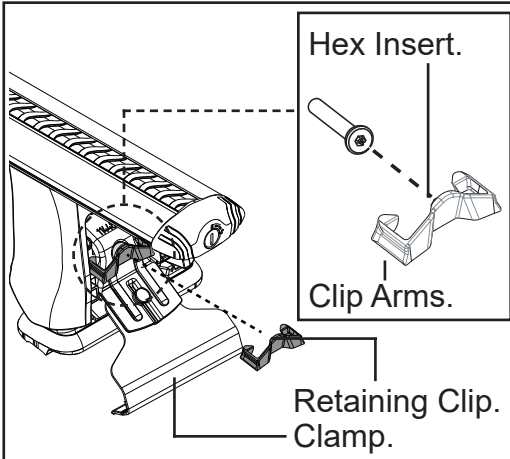

# RHINO-RACK ARD01

**CONTROLLED**



Line the Hex Insert on the Torque Retaining Clip up with the Hex Bolt on the 2500 Leg.

Push the Retaining Clip home into the Bolt.

The Arms of the Torque Retaining Clip will wrap around the Clamp, securing it in place.

| Item | Component Name      | Qty | Part No. |
|------|---------------------|-----|----------|
| 1    | 2500 Retaining Clip | 4   | M955     |
| 2    | Instructions        | 1   | R798     |

Issue: 03 Document No: R798 Prepared: Kayle Everett



# RHINO-RACK ARD01

**CONTROLLED**

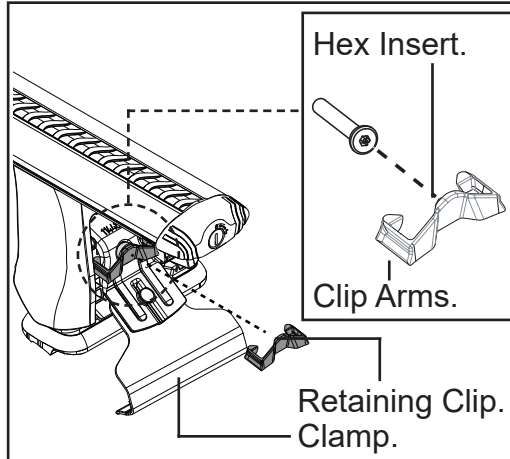

Line the Hex Insert on the Torque Retaining Clip up with the Hex Bolt on the 2500 Leg.

Push the Retaining Clip home into the Bolt.

The Arms of the Torque Retaining Clip will wrap around the Clamp, securing it in place.

| Item | Component Name      | Qty | Part No. |
|------|---------------------|-----|----------|
| 1    | 2500 Retaining Clip | 4   | M955     |
| 2    | Instructions        | 1   | R798     |

Issue: 03 Document No: R798 Prepared: Kayle Everett



# RHINO-RACK ARD01

**CONTROLLED**

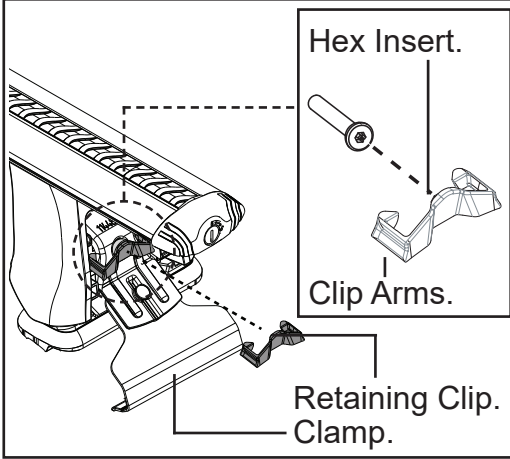

Line the Hex Insert on the Torque Retaining Clip up with the Hex Bolt on the 2500 Leg.

Push the Retaining Clip home into the Bolt.

The Arms of the Torque Retaining Clip will wrap around the Clamp, securing it in place.

| Item | Component Name      | Qty | Part No. |
|------|---------------------|-----|----------|
| 1    | 2500 Retaining Clip | 4   | M955     |
| 2    | Instructions        | 1   | R798     |

Issue: 03 Document No: R798 Prepared: Kayle Everett



# RHINO-RACK ARD01

**CONTROLLED**

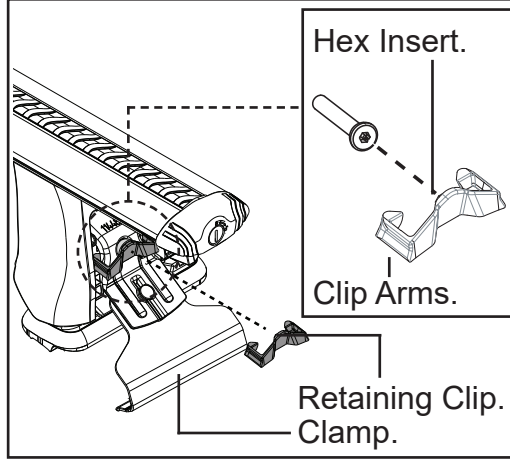

Line the Hex Insert on the Torque Retaining Clip up with the Hex Bolt on the 2500 Leg.

Push the Retaining Clip home into the Bolt.

The Arms of the Torque Retaining Clip will wrap around the Clamp, securing it in place.

| Item | Component Name      | Qty | Part No. |
|------|---------------------|-----|----------|
| 1    | 2500 Retaining Clip | 4   | M955     |
| 2    | Instructions        | 1   | R798     |

Issue: 03 Document No: R798 Prepared: Kayle Everett



# RHINO-RACK ARD01

**CONTROLLED**

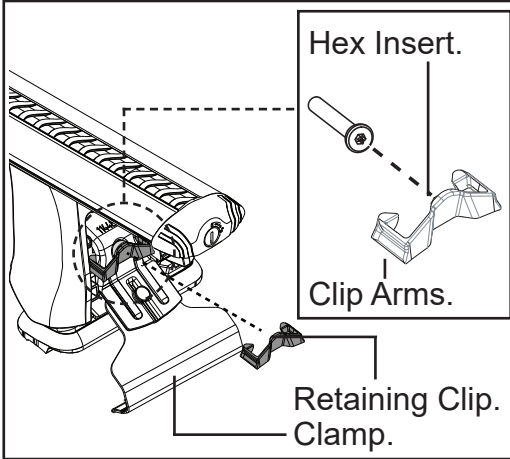

Line the Hex Insert on the Torque Retaining Clip up with the Hex Bolt on the 2500 Leg.

Push the Retaining Clip home into the Bolt.

The Arms of the Torque Retaining Clip will wrap around the Clamp, securing it in place.

| Item | Component Name      | Qty | Part No. |
|------|---------------------|-----|----------|
| 1    | 2500 Retaining Clip | 4   | M955     |
| 2    | Instructions        | 1   | R798     |

Issue: 03 Document No: R798 Prepared: Kayle Everett



# RHINO-RACK ARD01

**CONTROLLED**

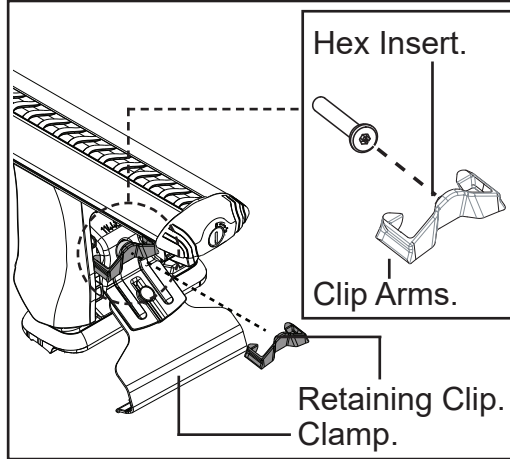

Line the Hex Insert on the Torque Retaining Clip up with the Hex Bolt on the 2500 Leg.

Push the Retaining Clip home into the Bolt.

The Arms of the Torque Retaining Clip will wrap around the Clamp, securing it in place.

| Item | Component Name      | Qty | Part No. |
|------|---------------------|-----|----------|
| 1    | 2500 Retaining Clip | 4   | M955     |
| 2    | Instructions        | 1   | R798     |

Issue: 03 Document No: R798 Prepared: Kayle Everett