

RHINO-RACK®

Rhino 2500FMP Crossbar System

Important:

1. Check the Rhino-Rack website to ensure you have the latest issue of these instructions.
2. Please refer to your fitting instruction to ensure that the roof racks are installed in the correct locations.
3. Check the contents of kit before commencing fitment and report any discrepancies.
4. Place these instructions in the vehicle's glove box after installation is complete.
5. These instructions must be followed for warranty to be upheld.

Fit Time: 30 mins

Instruction includes new **SPORTZ** Bar steps.

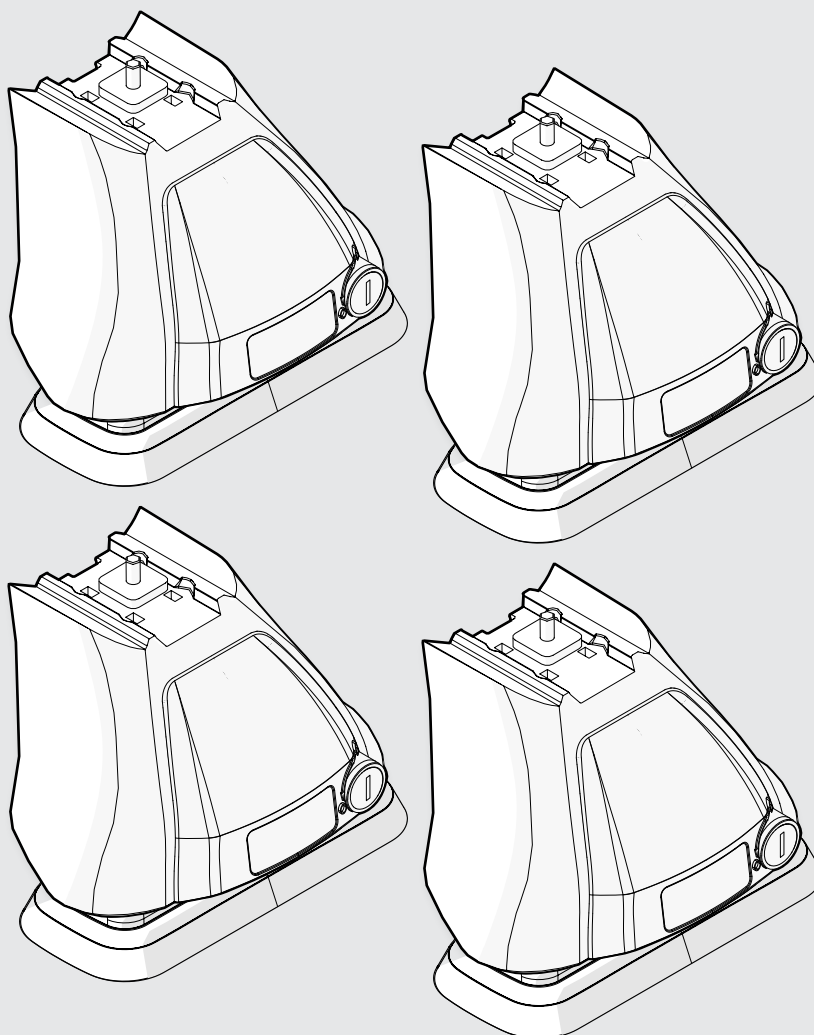

RHINORACK.COM

Document No: R083

Issue No: 8

Issue Date: 24/02/2025

Carrying Capacity

Check the website and the **vehicle owners hand book** for your vehicle manufacturer's maximum carrying capacity. Load must be evenly distributed over the system.

2 BARS



DYNAMIC ROAD LOAD LIMIT (NOTE: DIFFERENT ON AND OFF ROAD CARGO LIMIT) *USE THE VEHICLE MANUFACTURER'S MAXIMUM ROOF ALLOWANCE IF IT IS LOWER THAN THE FIGURE LISTED			
 LOAD LIMIT	 SYSTEM WEIGHT	 ON ROAD CARGO LIMIT	 OFF ROAD CARGO LIMIT (ON ROAD CARGO LIMIT / 2)
UP TO 75 kg * 165 lb	5 kg 11lb	=	OR UP TO 70 kg 154 lb OR UP TO 35 kg 77 lb

1 BAR



DYNAMIC ROAD LOAD LIMIT (NOTE: DIFFERENT ON AND OFF ROAD CARGO LIMIT) *USE THE VEHICLE MANUFACTURER'S MAXIMUM ROOF ALLOWANCE IF IT IS LOWER THAN THE FIGURE LISTED			
 LOAD LIMIT	 SYSTEM WEIGHT	 ON ROAD CARGO LIMIT	 OFF ROAD CARGO LIMIT (ON ROAD CARGO LIMIT / 2)
UP TO 35 kg * 77 lb	2.5 kg 6lb	=	OR UP TO 32.5 kg 72 lb OR UP TO 16 kg 35 lb



Cargo Load Limit

Total permissible weight allowed on top, and attached to roof racks whilst the vehicle is in motion.



System Weight

Total weight of the roof rack system. (e.g. Crossbars, Backbone, Platform)



Max System Load Capacity

Please ensure you use the vehicle manufacturer's maximum roof allowance if it is lower than the figure listed in the fitting chart/supplement.



Vehicle Manufacturer's Load Limit

Total permissible weight attached to the roof of the car. This is inclusive of the weight of the roof rack system.

In service maintenance checks

- All bolt connections should be checked after driving a short distance when you first install your roof racks.
- All bolted connections should be checked again at regular intervals (weekly is recommended, depending on road conditions, usage, loads and distances travelled).
- All bolted connections should be checked each time they are re-fitted.
- Off-road conditions are more rigorous. Check all bolted connections and your load more regularly.
- Ensure that your vehicle manufacturer's GVM, and gross axle weights are not exceeded (refer to vehicle owner's manual).

Torque Settings:

Unless stated otherwise in these instructions, all fasteners should be set to the following torque settings:



4-5Nm
3-4lbs/ft



8-10Nm
6-7.5lbs/ft



16-18Nm
12-13lbs/ft

Note for Dealers and Fitters

It is your responsibility to ensure these fitting instructions are given to the end user or client. These instructions remain the property of Rhino-Rack Australia Pty. Ltd. and may not be used or changed for any other purpose than intended.

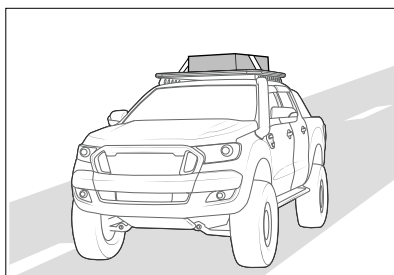

Exercise extreme care when transporting wind-resistant loads. Special consideration must be taken when cornering and braking.



Off-road conditions can be much more rigorous. Extreme care must be taken on any driven path that does not contain a surface protection layer (tar/bitumen).

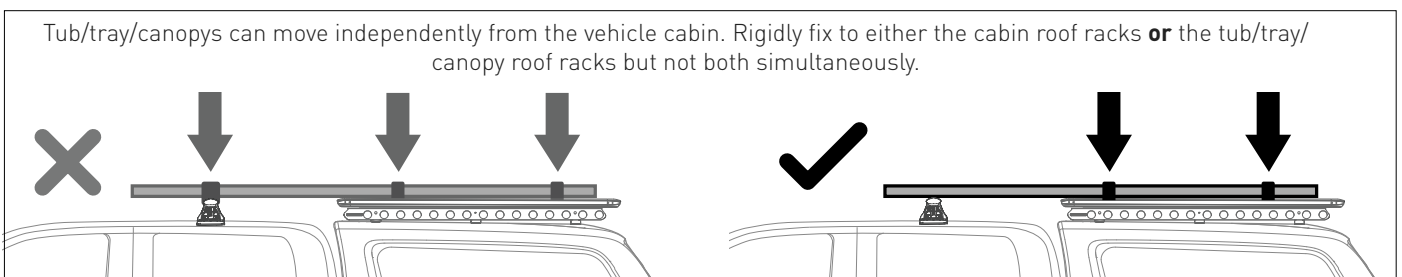
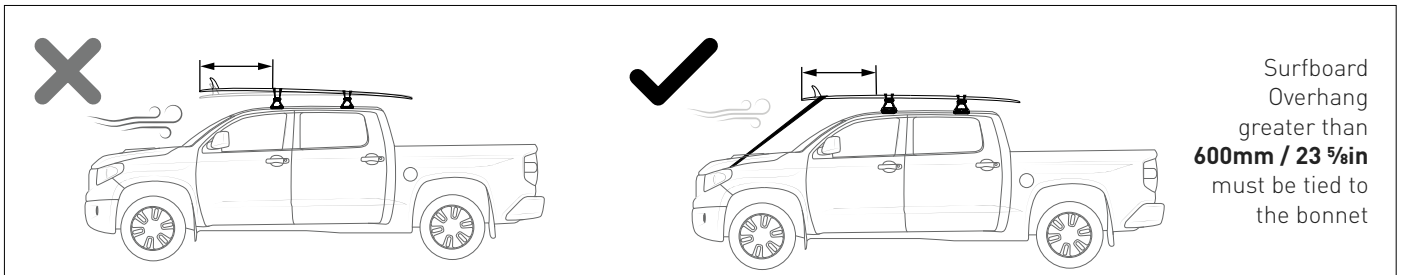
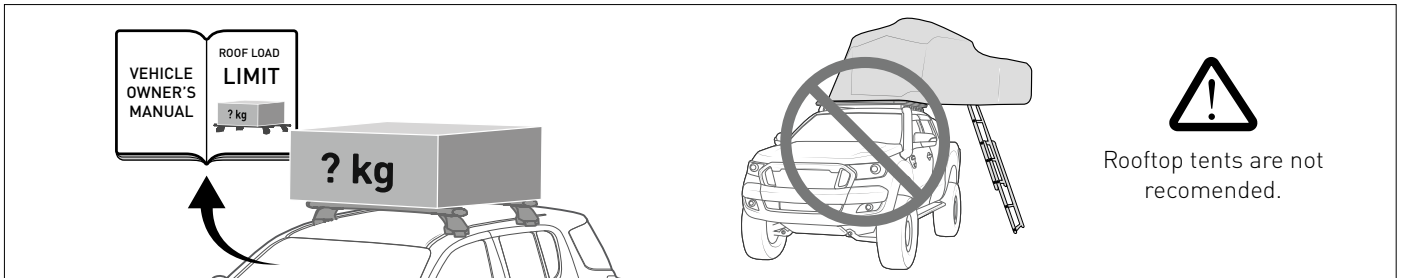
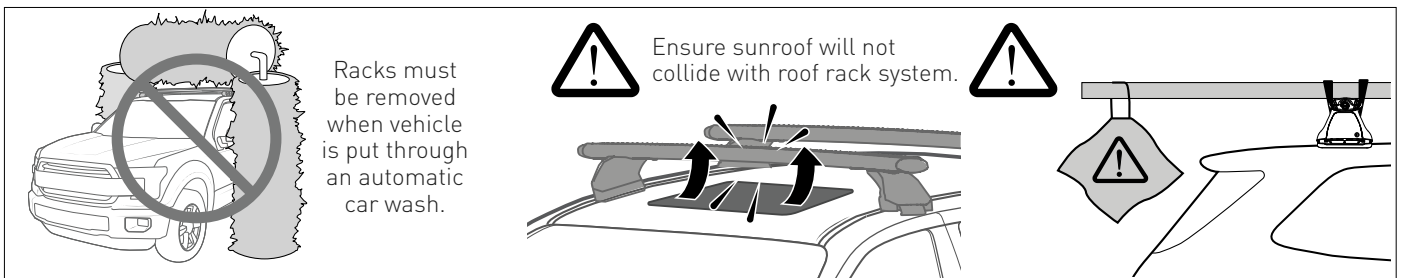
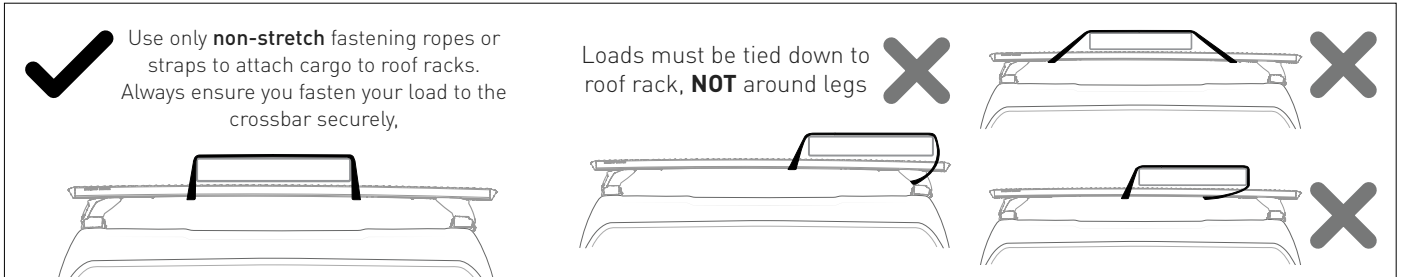
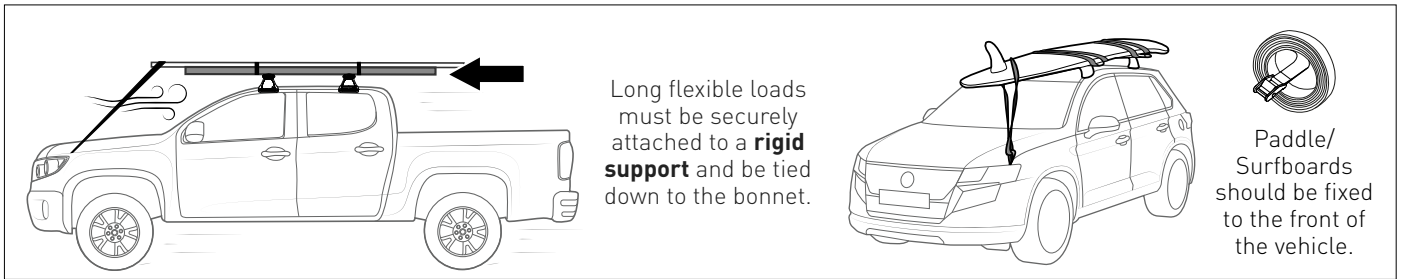

Parts List

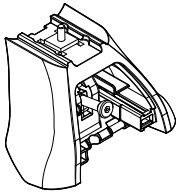
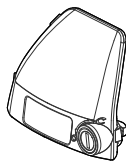
P1 LEG PARTS (Included in Leg Kit)Leg *(Preassembled)*
A (RLKVAH) **x2**
 (RLKVA) **x4**
Cover *(Preassembled)*
B (RLKVAH) **x2**
 (RLKVA) **x4**

Metal Key (Pair)

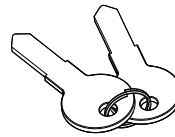
**C**

Foot Plate

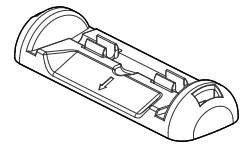
D (RLKVAH) **x2**
 (RLKVA) **x4**

Torque Key

**E** **x1**

Location Decals Sheet

**F** **x1**

Positioning Decals Sheet

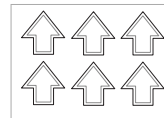
**G** **x1**

Instruction

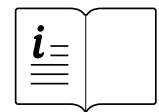
**H** **x1****P2 DK PARTS** (Included in Base Kit)

Pad

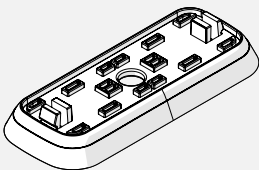
**I** **x4**

Rear Mount Bracket

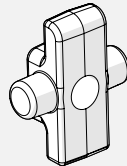
**J** **x4**

Front Mount Bracket

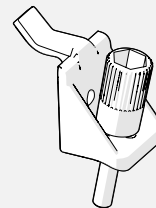
**K** **x4** *(Preassembled)*

Stud

**L** **x4**

Security Screw

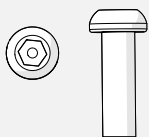
**M** **x4**

Spring Washer

**N** **x4**

Washer

**O** **x4**

Hex Spanner

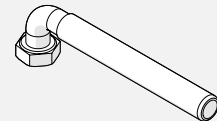
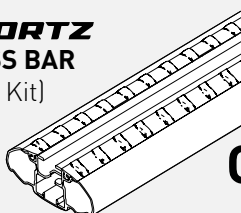
**P** **x1****P3 CROSS BAR** (Included in Bars Kit)
SPORTZ
CROSS BAR
 (Bars Kit)

Q **x1** (RLKVAH)
Q **x2** (RLKVA)

VA CROSS BAR
 (Bars Kit)

Q **x1** (RLKVAH)
Q **x2** (RLKVA)
OR**TOOLS REQUIRED:**

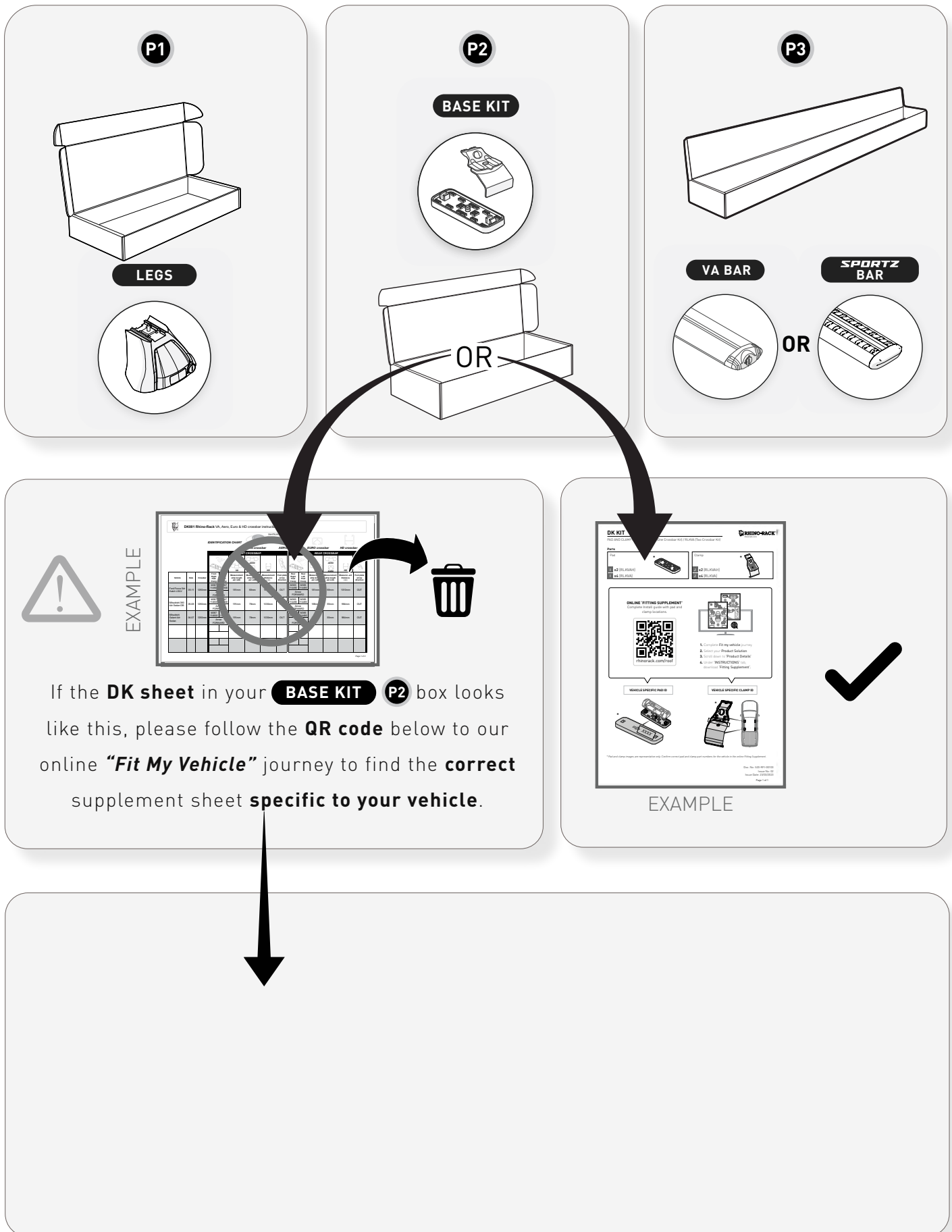
- T1** - Scissors / Cutters
- T2** - Measuring Tape
- T3** - Torque Wrench
- T4** - 10mm Spanner



Proceed to the next step to see **examples** of the sheet you need.

SEE THE EXAMPLES OF SUPPLEMENT SHEETS BELOW. PROCEED TO THE CORRESPONDING STEPS DEPENDING ON YOUR BAR PROFILE.

SPORTZ BAR

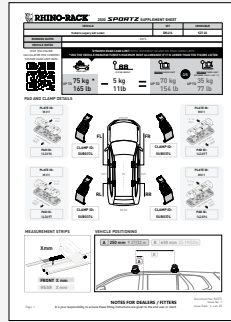
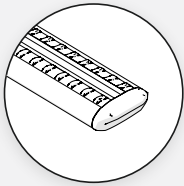

EXAMPLE



For RLKVA Leg with **SPORTZ** Bar go to Step **1** - **22**.

VA BAR

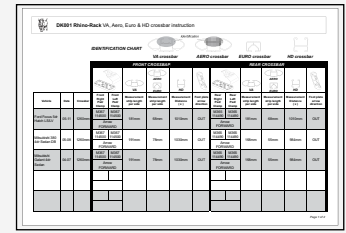
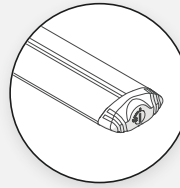

EXAMPLE



For RLKVA Leg with **VORTEX** Bar go to Step **1** - **7** & **24** - **36**.

OR

System Components

To complete the installation ensure you have **Base Kit**, **Legs** and **Crossbars**.

LEGS

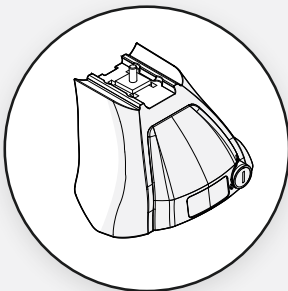

P1

BASE

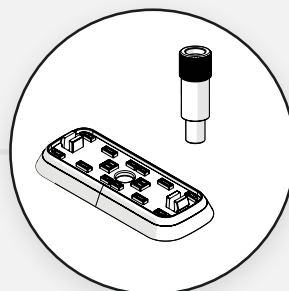

P2

BARS

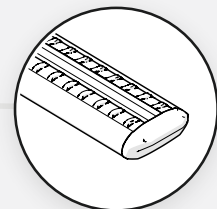

P3

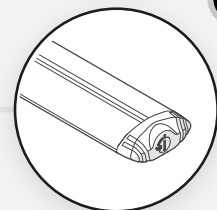

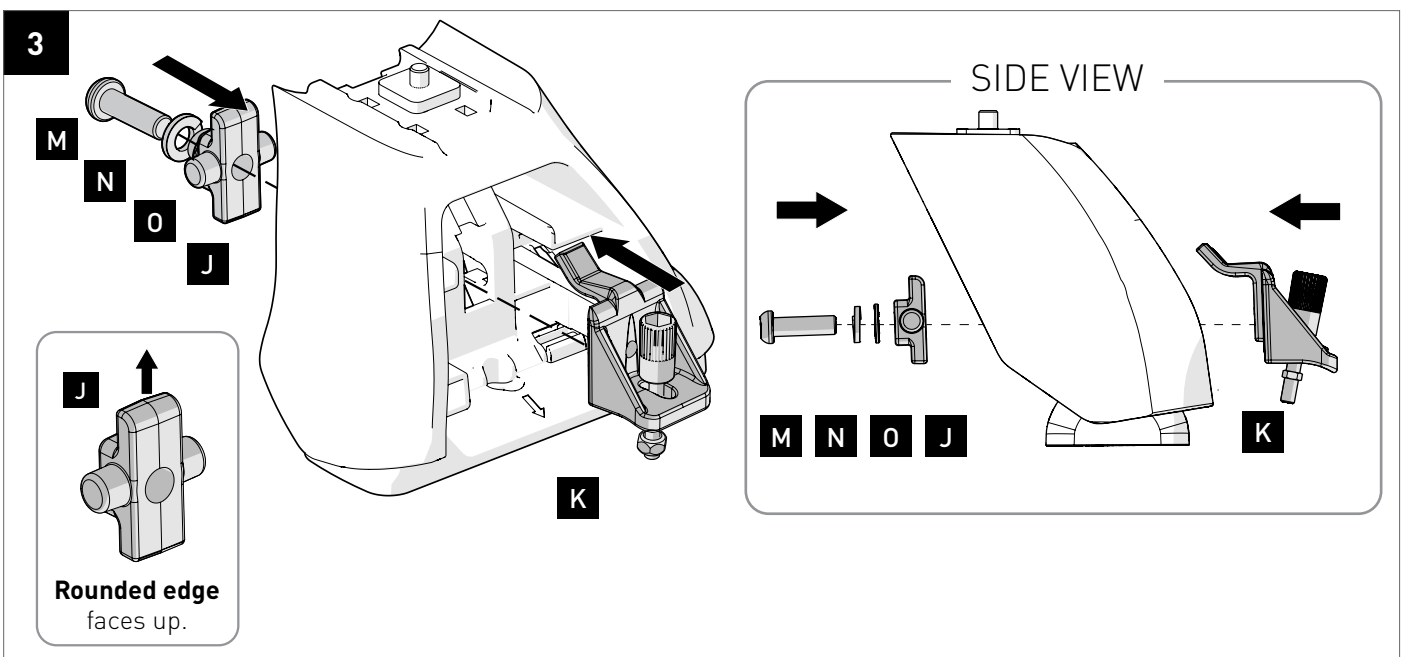
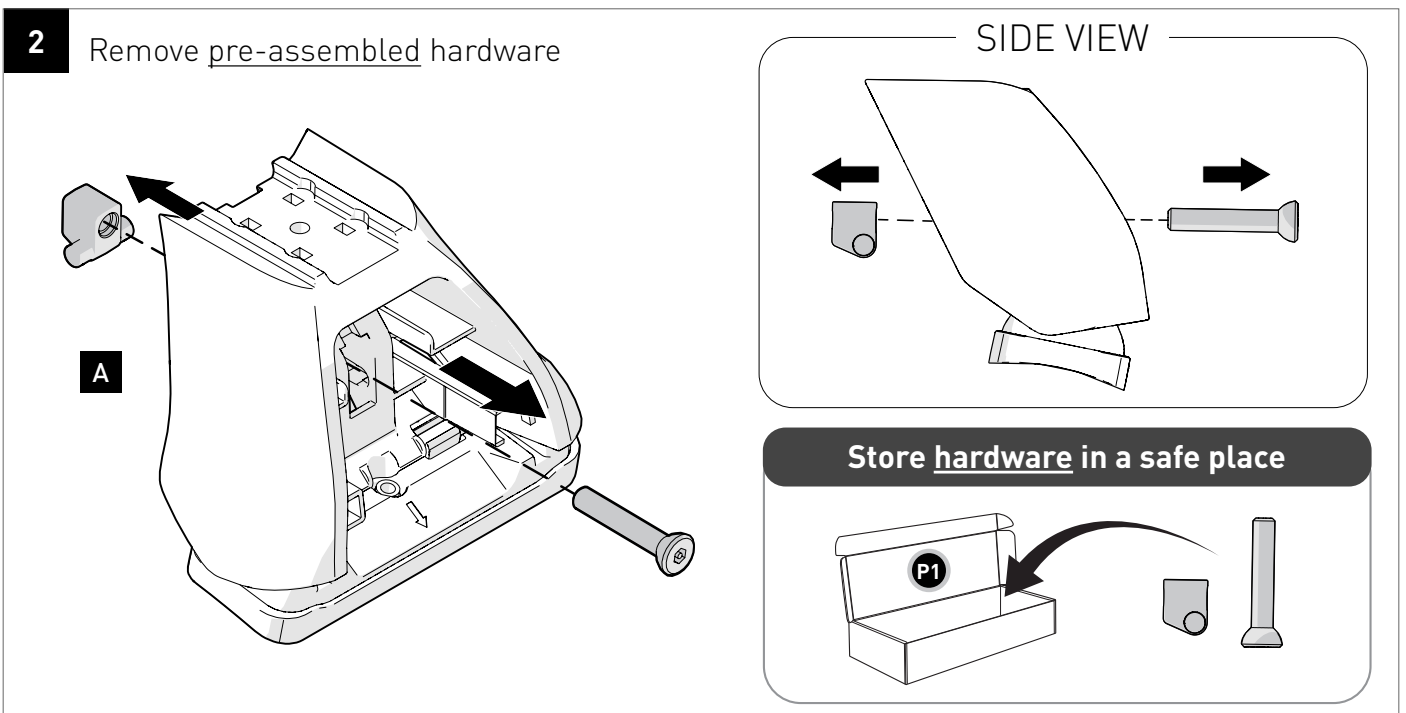
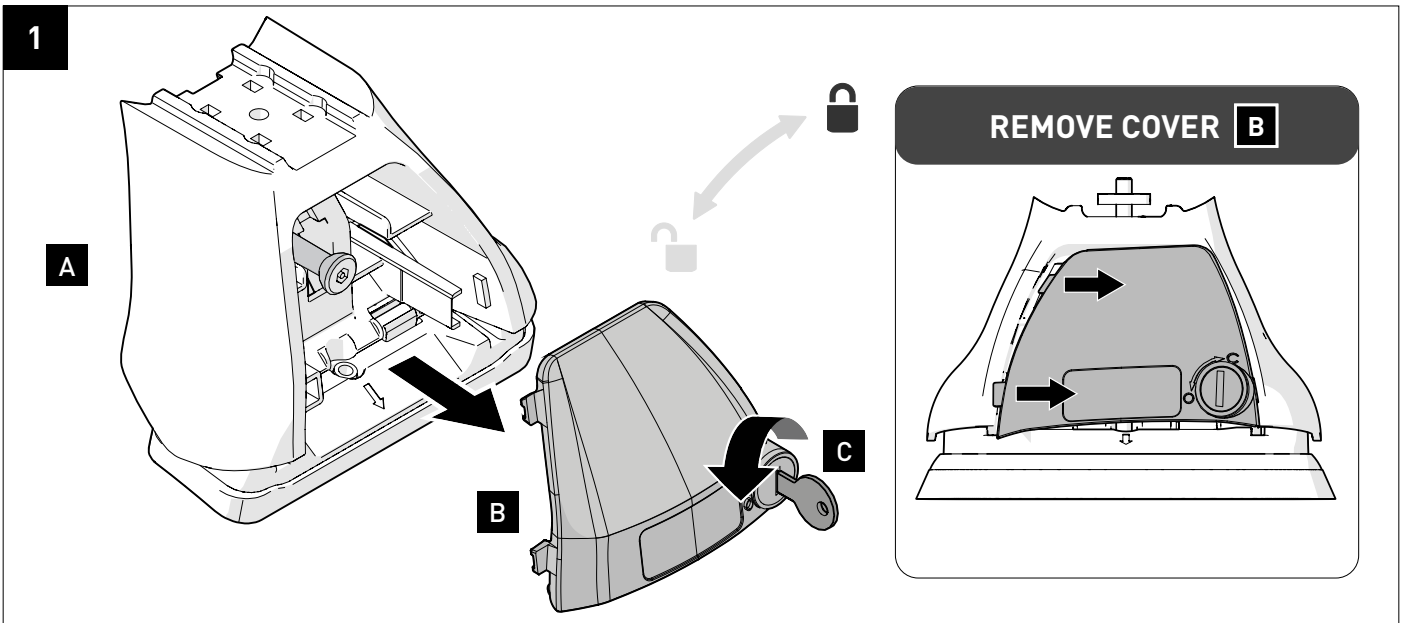

4

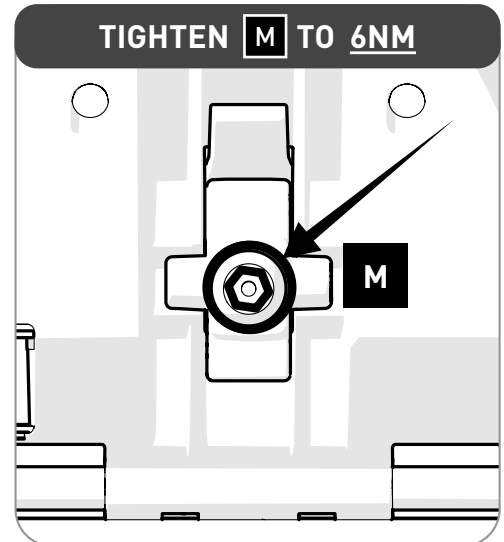
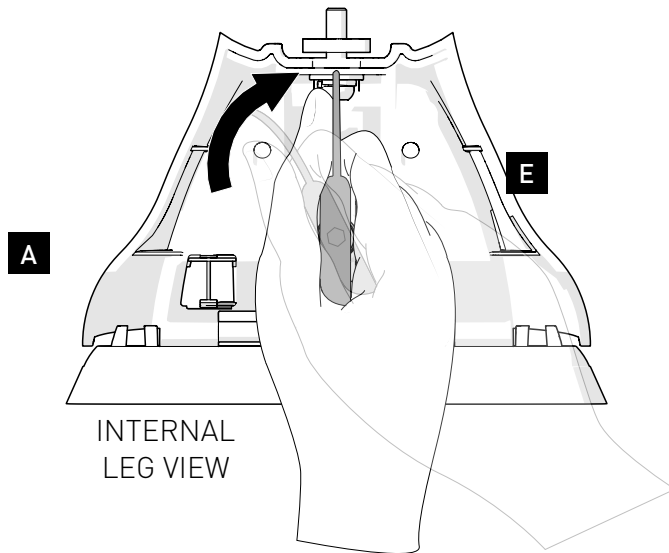

5



rhinorack.com/roof

IMPORTANT NOTE:

Refer to **Page. 05** to find your supplement sheet, or follow this link to the “Fit My Vehicle” journey online.

PAD AND CLAMP DETAILS

M6 Screw Length:

XXmm

Plate ID:

MXXX

Direction:

OUT

M6 Stud Length:

XXmm

Pad ID:

MXXX

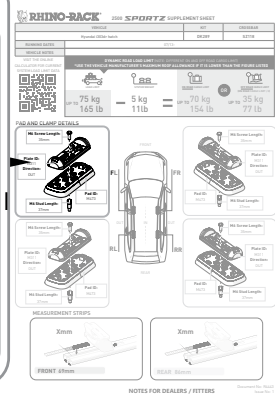

EXAMPLE

REFER TO ONLINE FITTING SUPPLEMENT SHEET

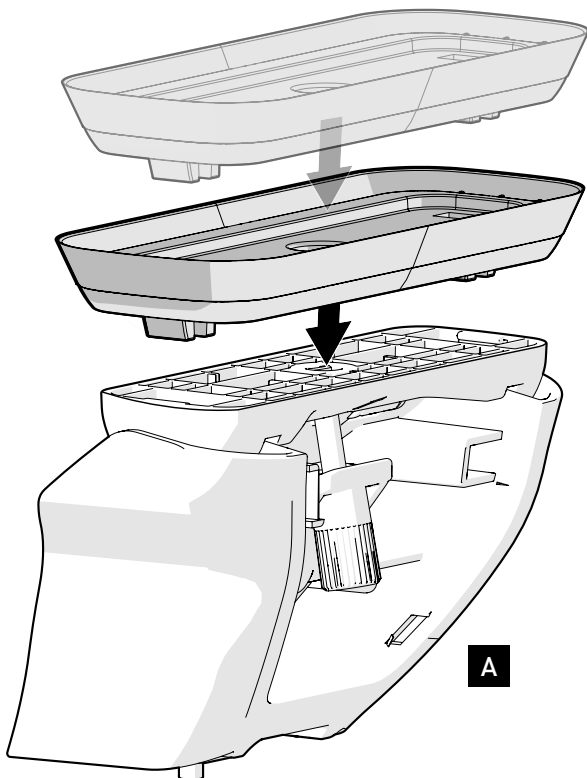
I PAD

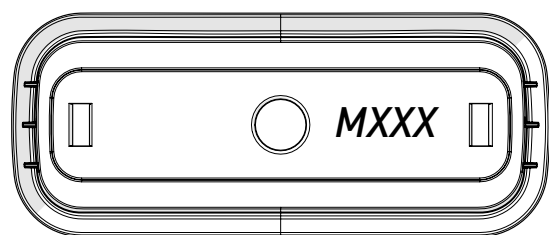
PAD **I** UNDERSIDE:

EXAMPLE

6

Repeat Step **1** - **5** for ALL LEGS required for your fit.

1 BAR

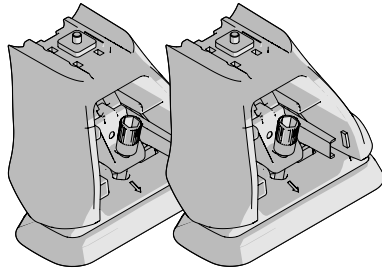

2 BARS

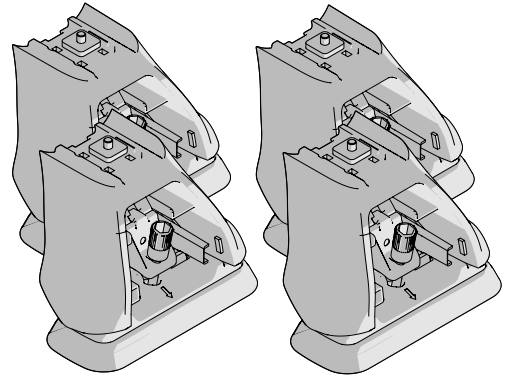

7

FL

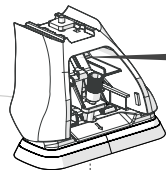
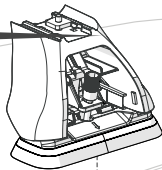

RL

FRONT

OUTSIDE - LEFT

RR

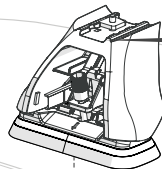
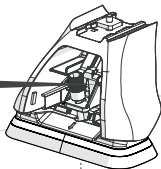

FR

OUTSIDE - RIGHT

FRONT

LEG LOCATION LABELS **F**



Place labels to help identify the leg's location on the vehicle roof when re-fitting crossbars.

Place label

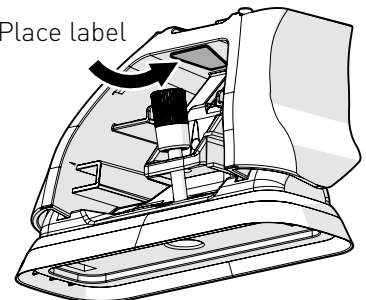

FOR **VA** BAR SKIP TO STEP. **24**

8

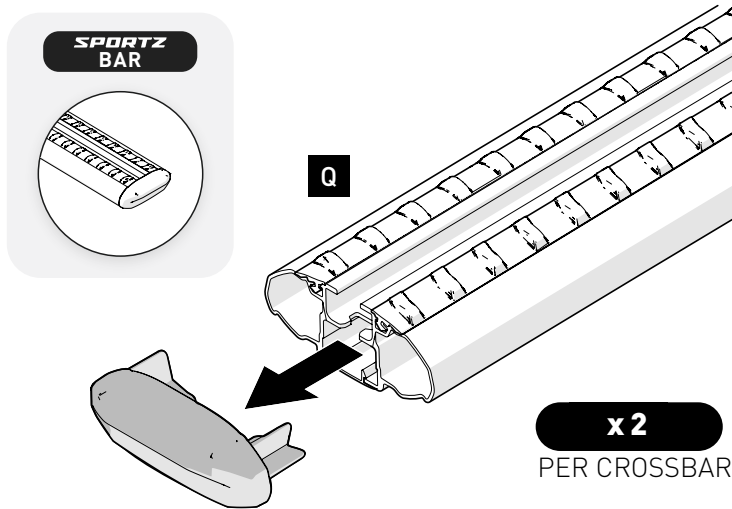

TOP VIEW

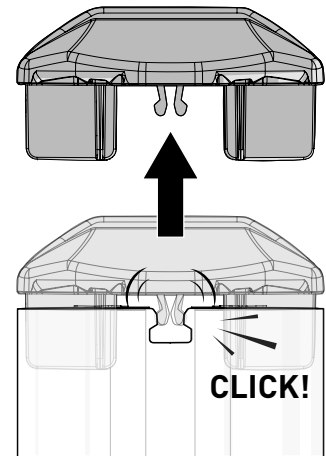

9

Your **BAR** should look like this.

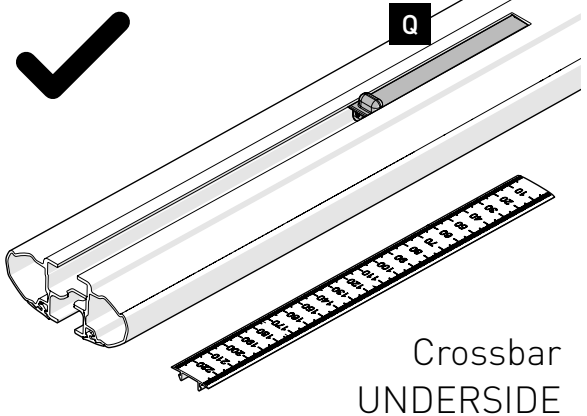

10

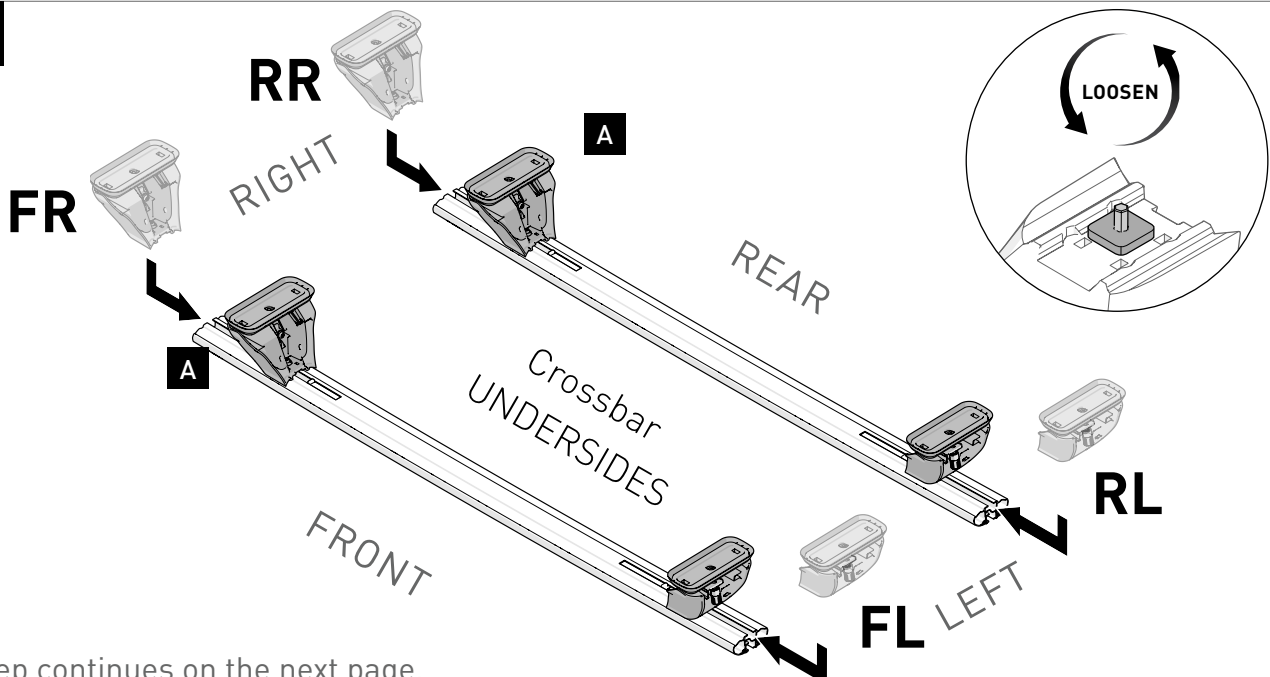

Step continues on the next page.

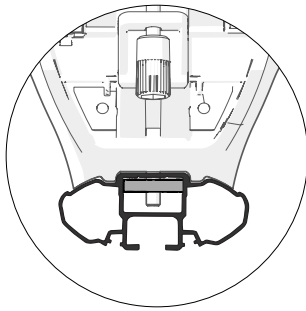

Channel nut slides into
underbar channel

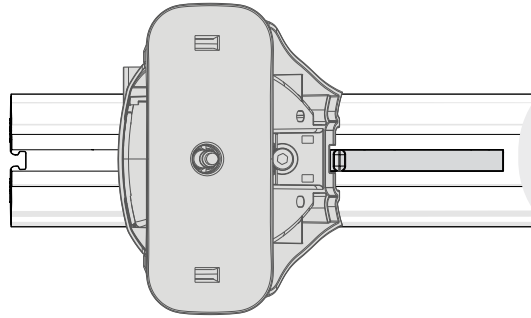

BOTTOM VIEW:



NOTE:
Ensure that the
Internal Slider is in
the bar.

11

EXAMPLE

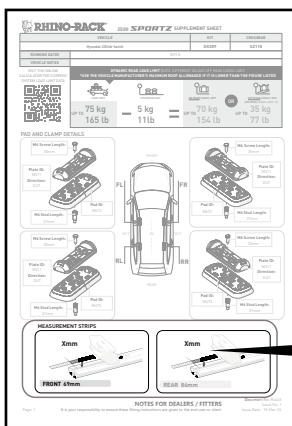

MEASUREMENT STRIPS

Xmm



FRONT xxx mm

Xmm



REAR xxx mm

REFER TO ONLINE FITTING
SUPPLEMENT SHEET

FRONT

x 2

PER CROSSBAR

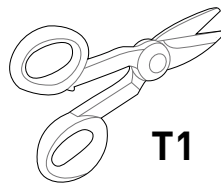
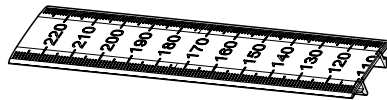
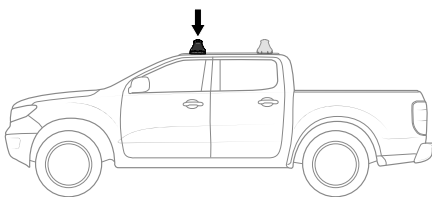

T1

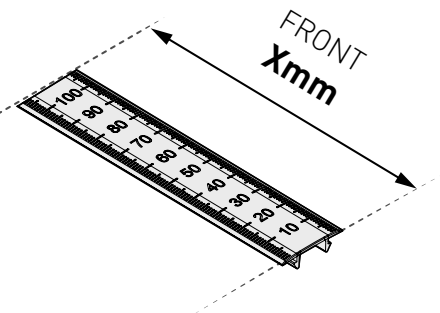

REAR

x 2

PER CROSSBAR

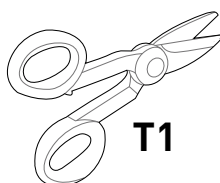
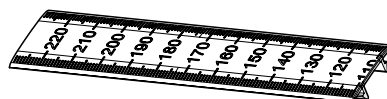
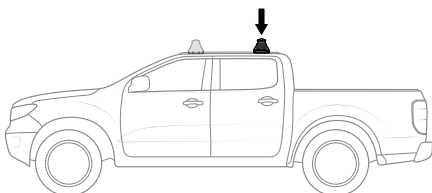

T1

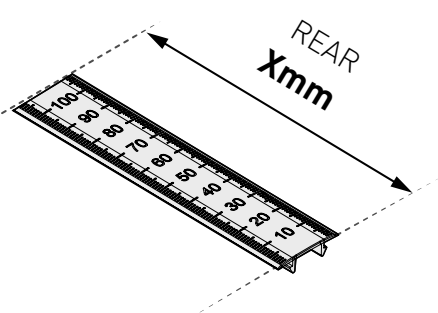

12

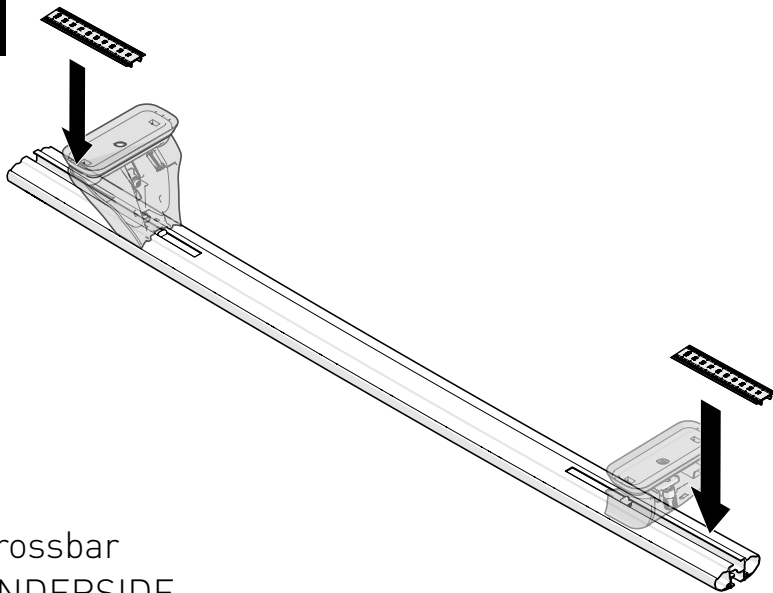

Crossbar
UNDERSIDE

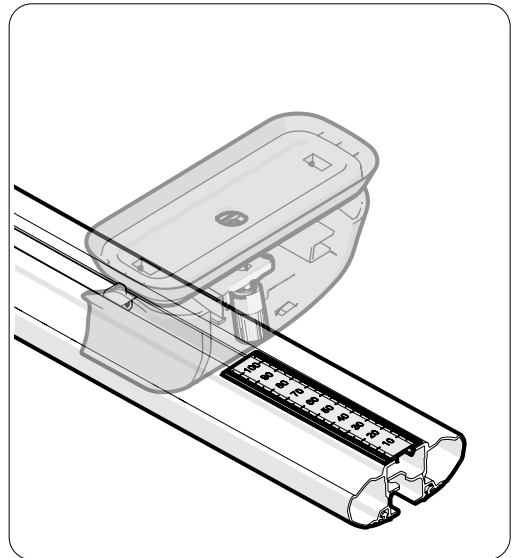

13

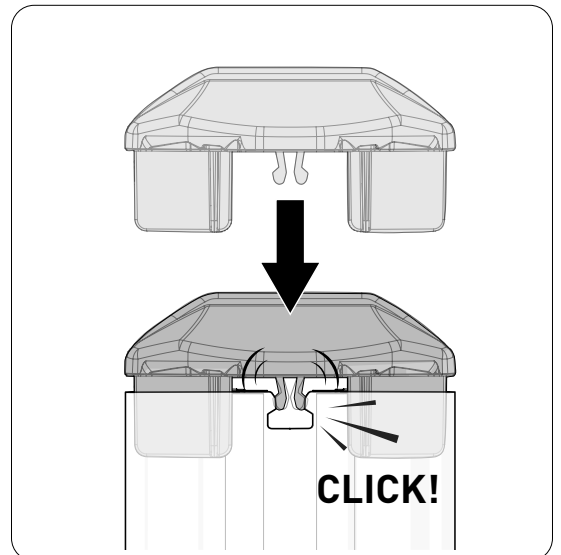
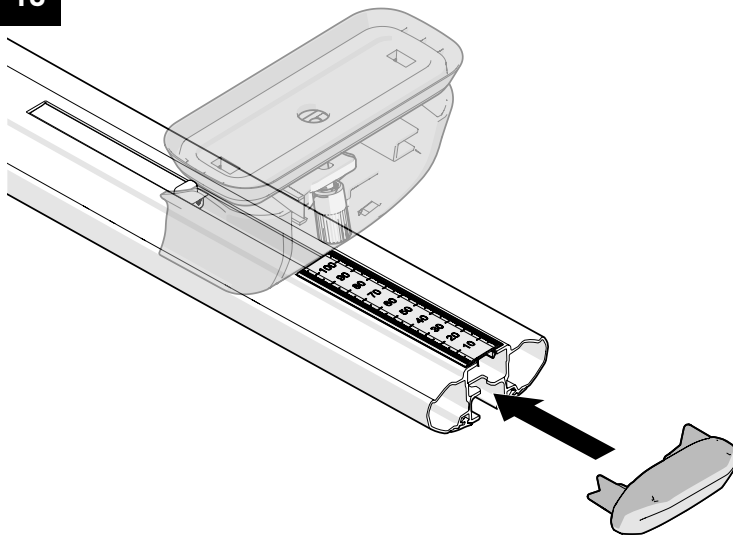

14

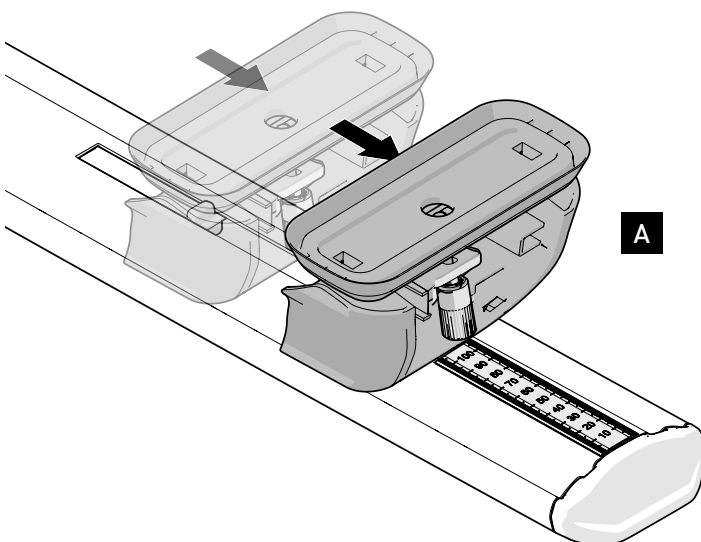

A

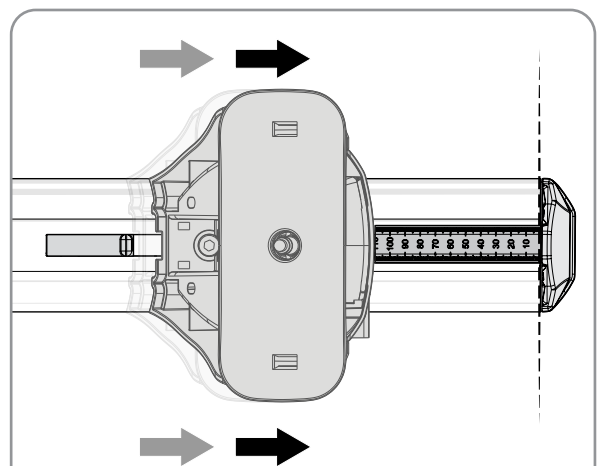

Measurment Strip must be flush with
end of **Bar**.

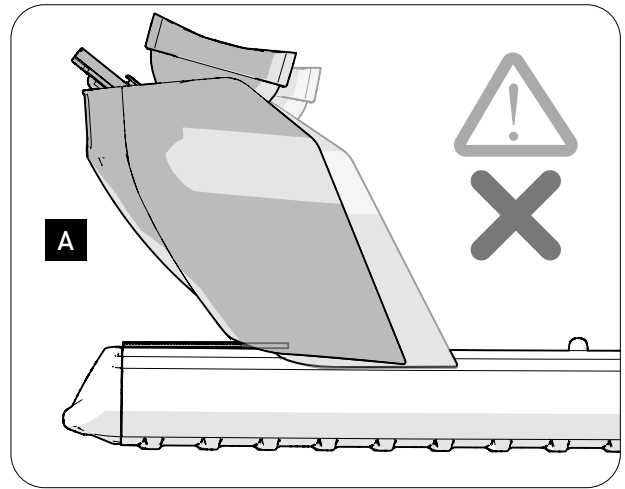
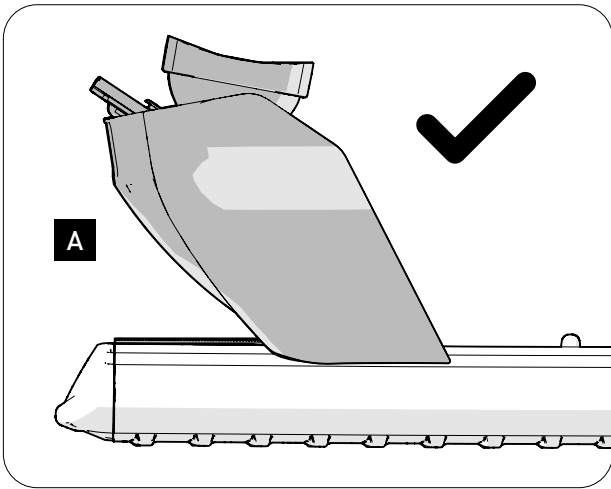

Ensure the legs (A) **DO NOT** sit on top of the measuring strip.

15

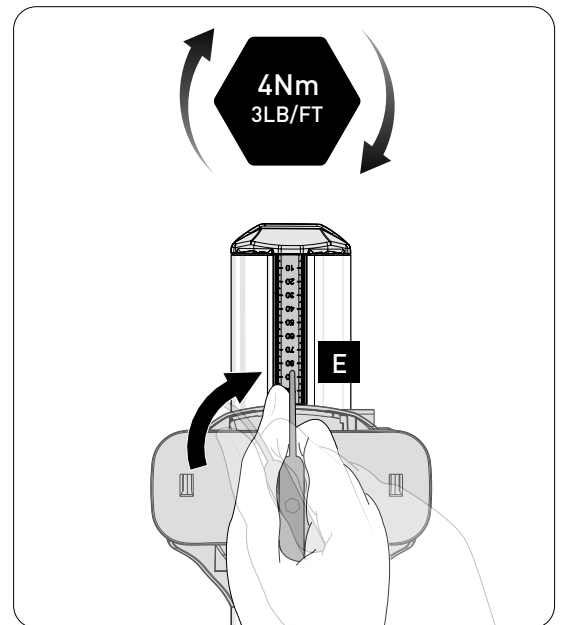
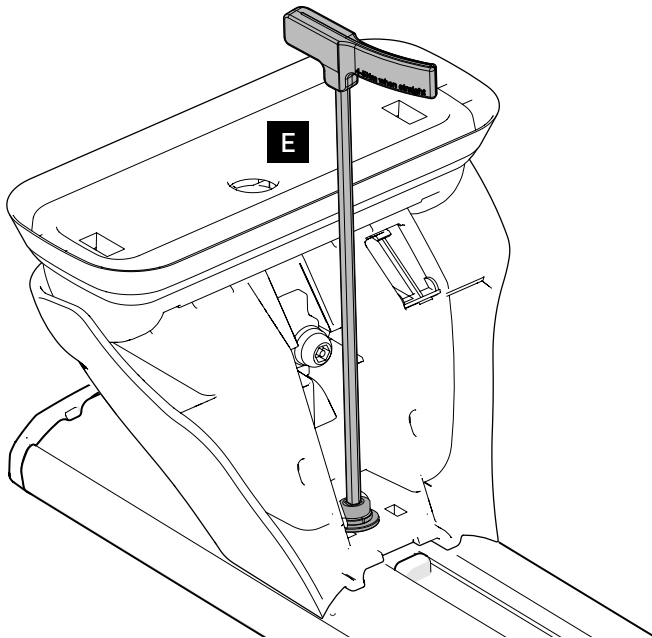

16

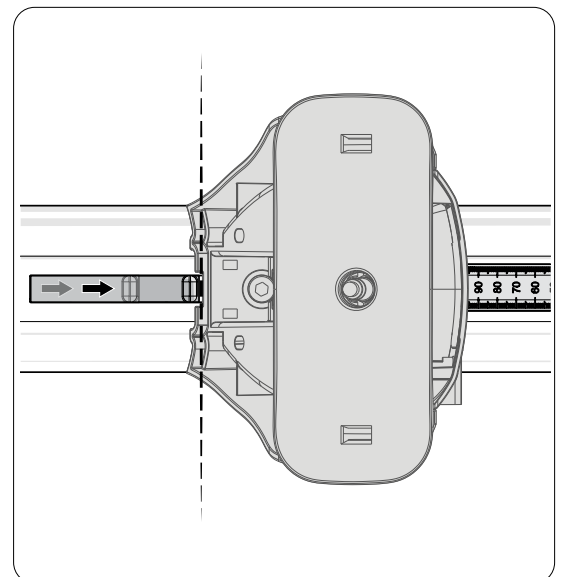
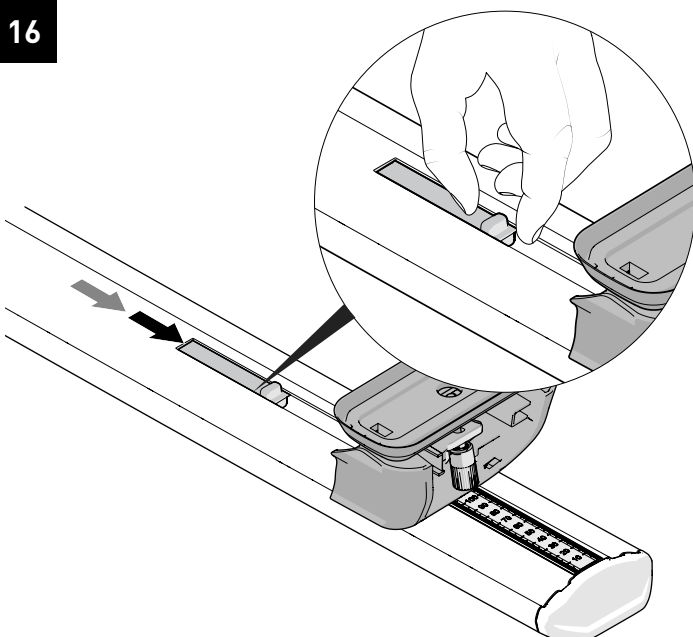

17

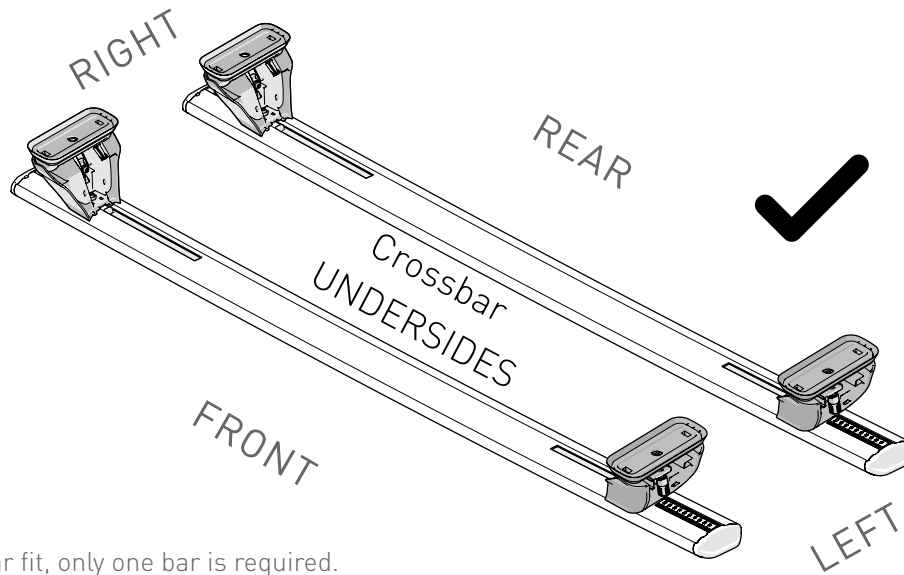

Note: If a single bar fit, only one bar is required.

18

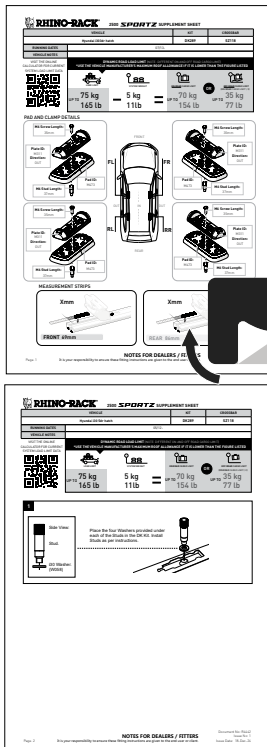

EXAMPLE

EXAMPLE

NOTE

Check to see if your supplement sheet includes an **extra page** explaining how to access your vehicle-specific fixed point attachments.

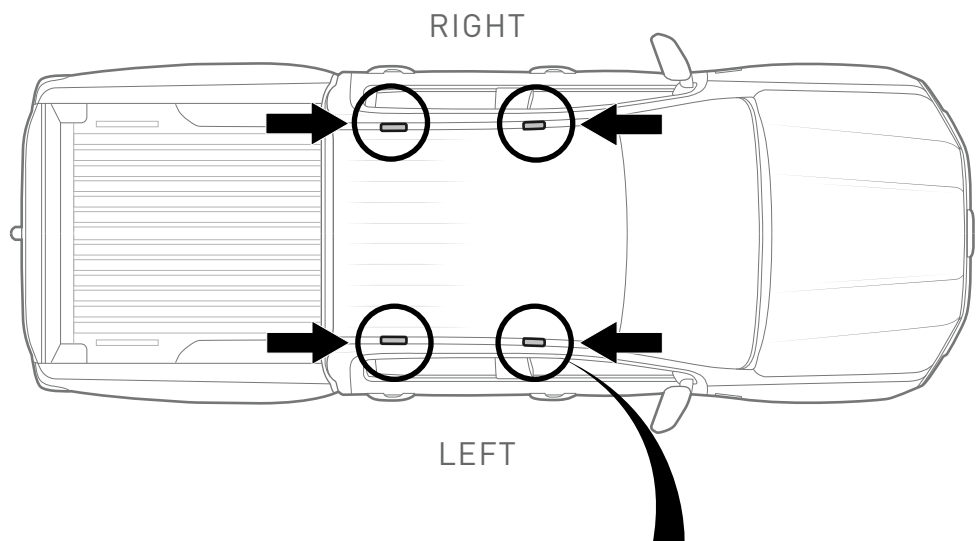

i Open all 4 Roof Caps.

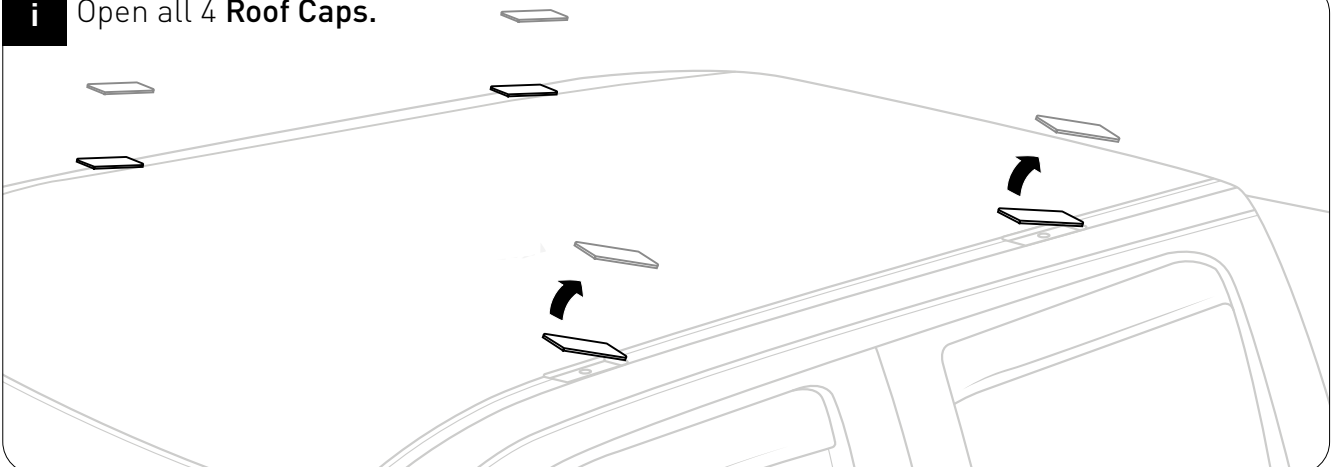

Step continues to the next page.

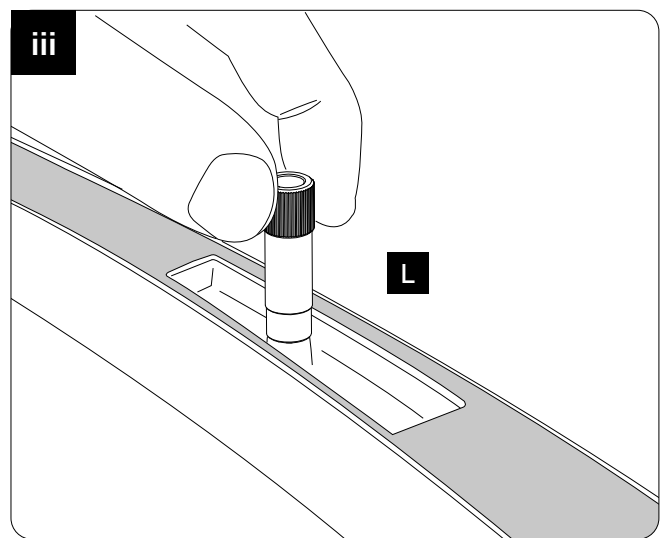
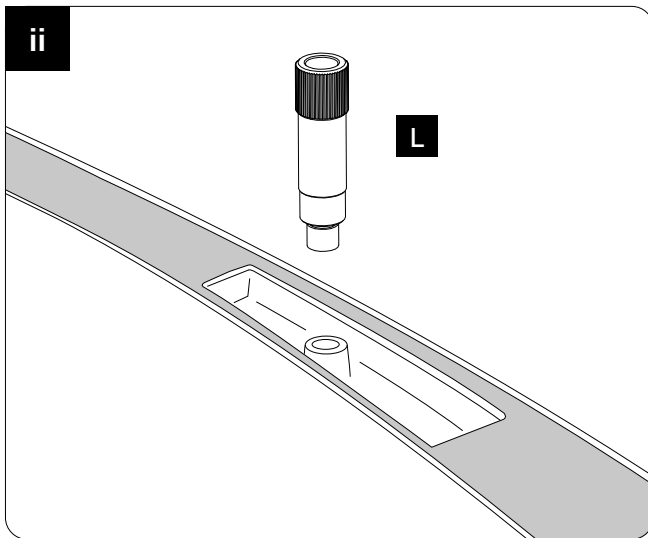

19

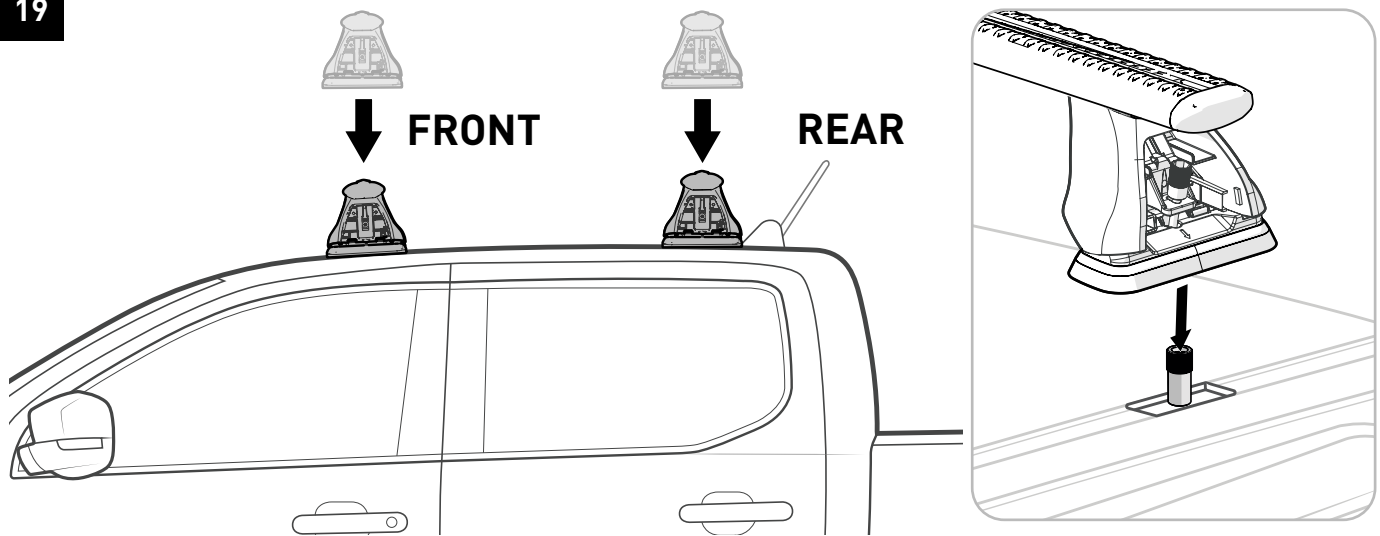

20

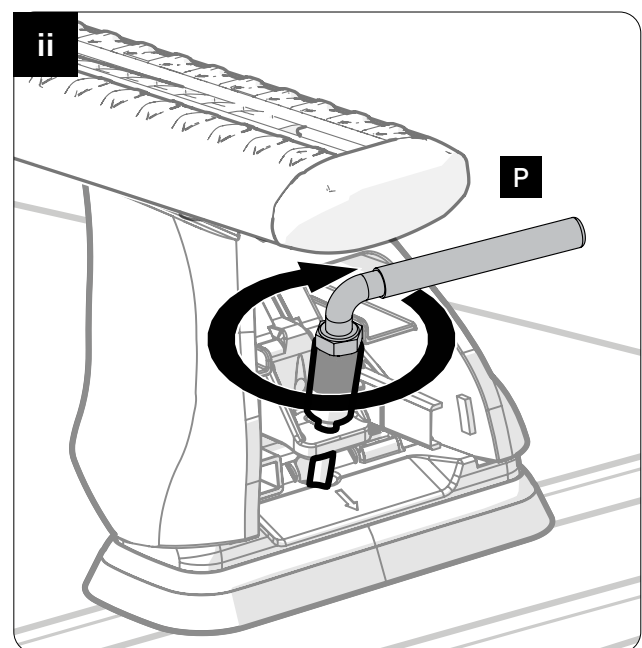
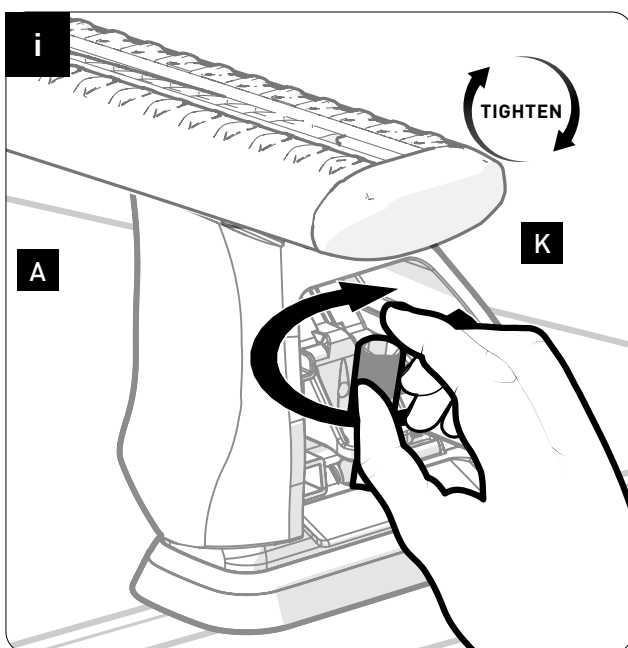

21 Tighten Lock Nut using **T4**

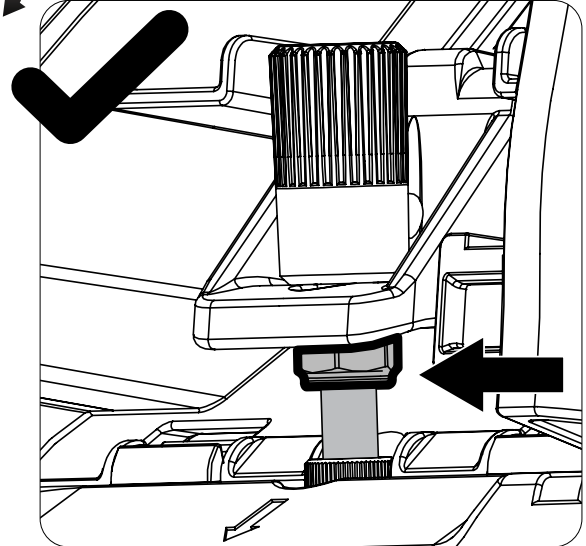
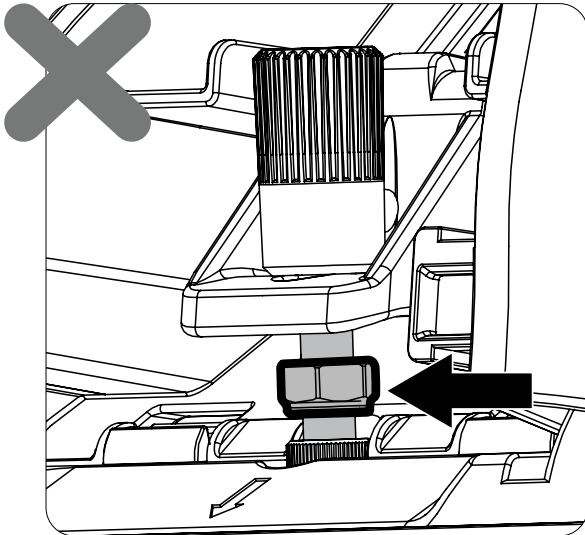

22

Check fitment is secure

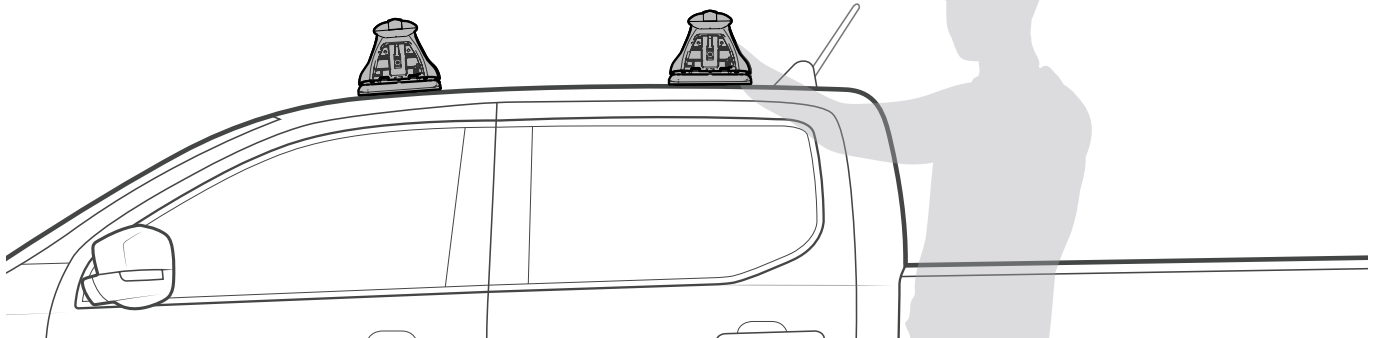
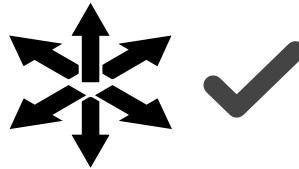

23

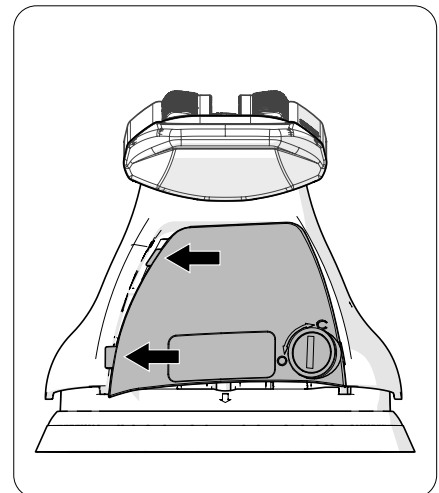
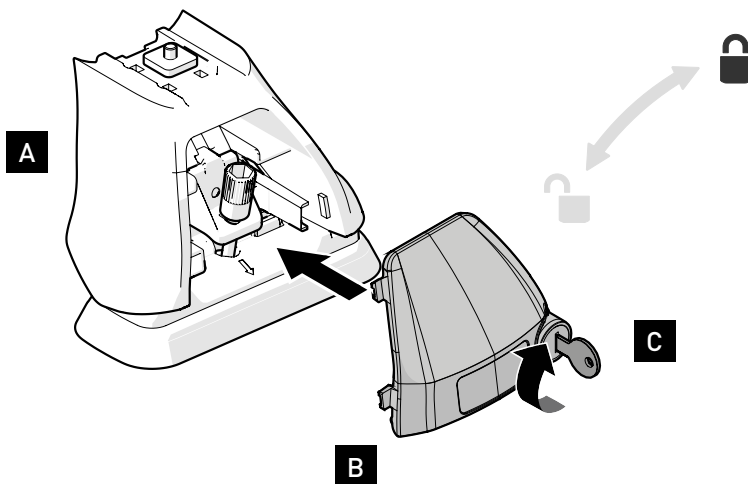

SPORTZ Bar Installation Complete.





Refer to **Page. 05** to find your supplement sheet, or follow this link to the “Fit My Vehicle” journey online.

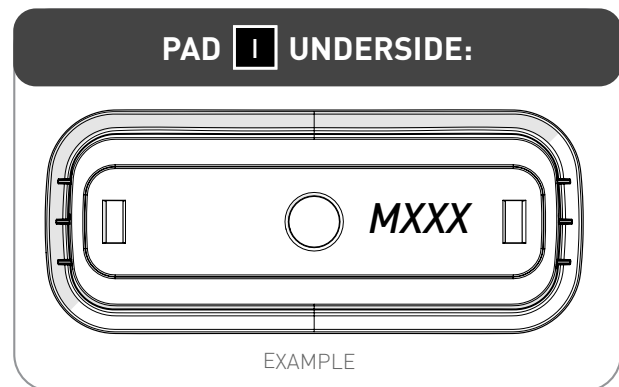
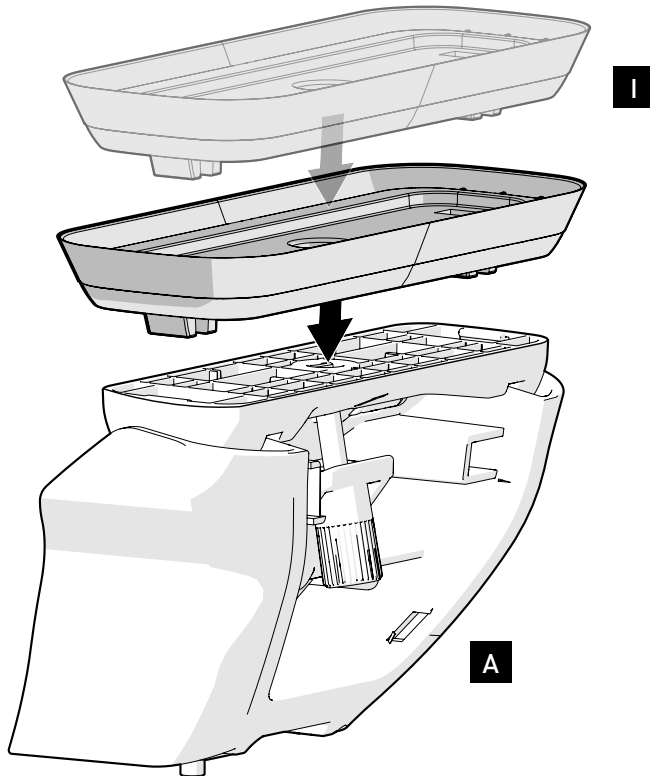

25 Insert crossbar rubber. Refer VA kit for parts.

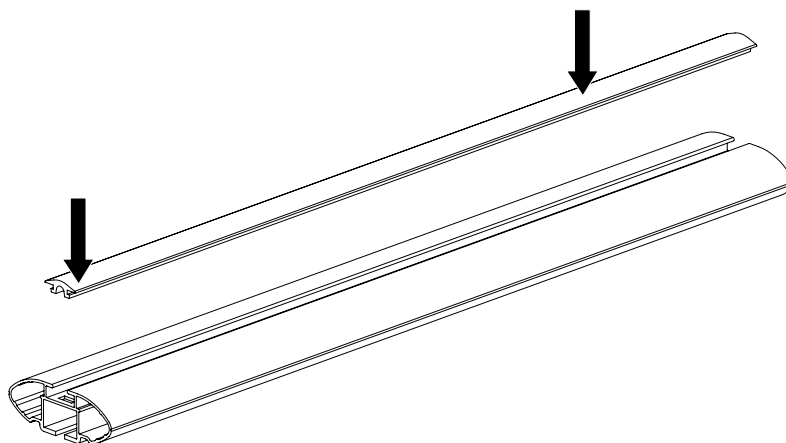

Measurement strip length per side

Xmm

Xmm

FACE THIS END TOWARDS
CENTRE OF CROSSBAR

CHECK UNDERSIDE OF MEASUREMENT
STRIP FOR ORIENTATION:

T1

Xmm

“0mm”
Centre of Bar

Crossbar
UNDERSIDE

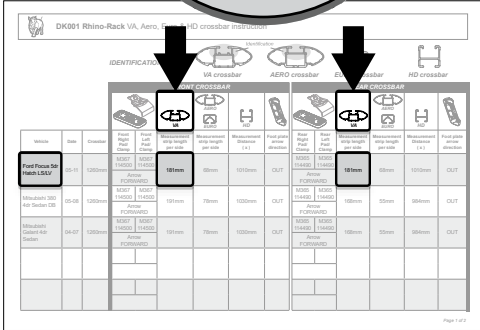

27

i

A

ii

iii

E

4Nm
3LB/FT

28

i

A

Q

ii

iii

T1

29 Attach location decals.

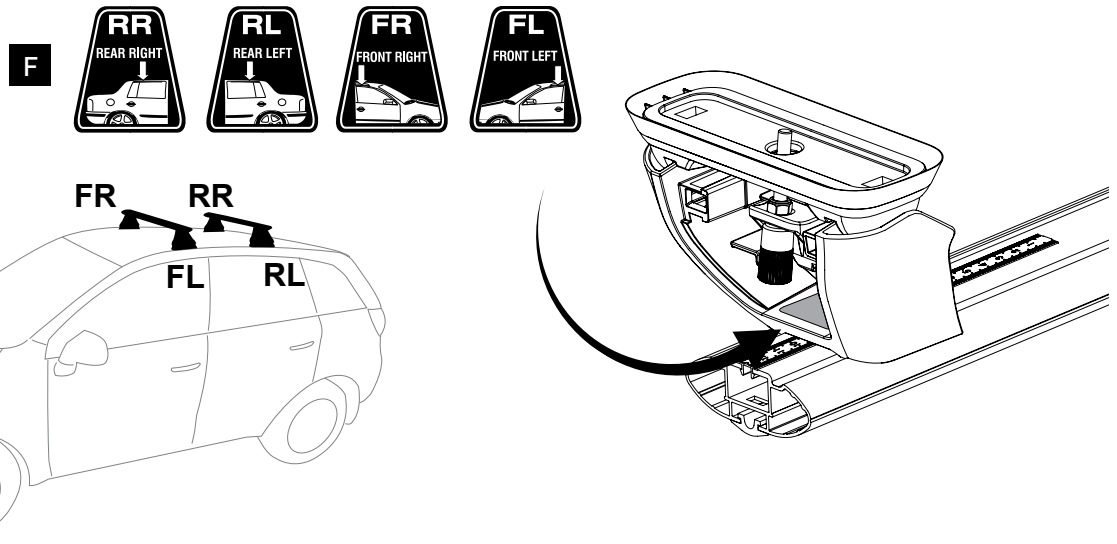

30 Open Roof Caps and Attach 4 Studs. (Finger tighten only.)

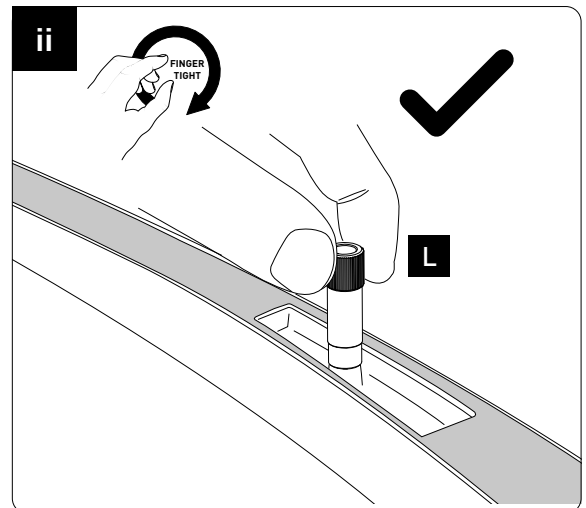
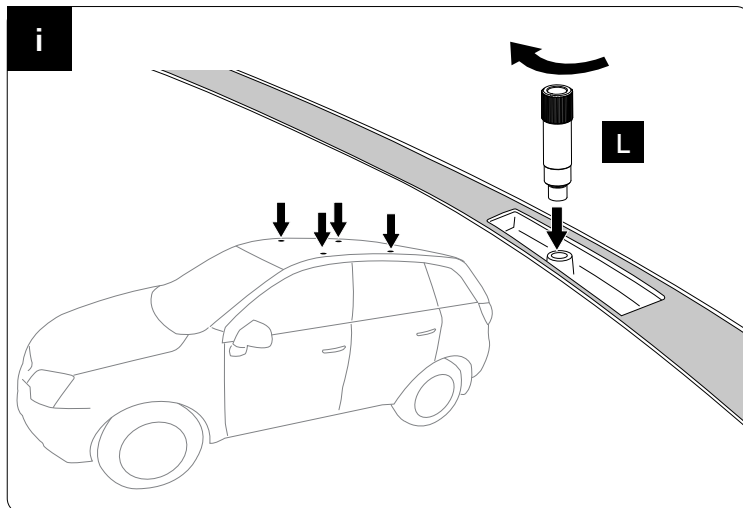

31

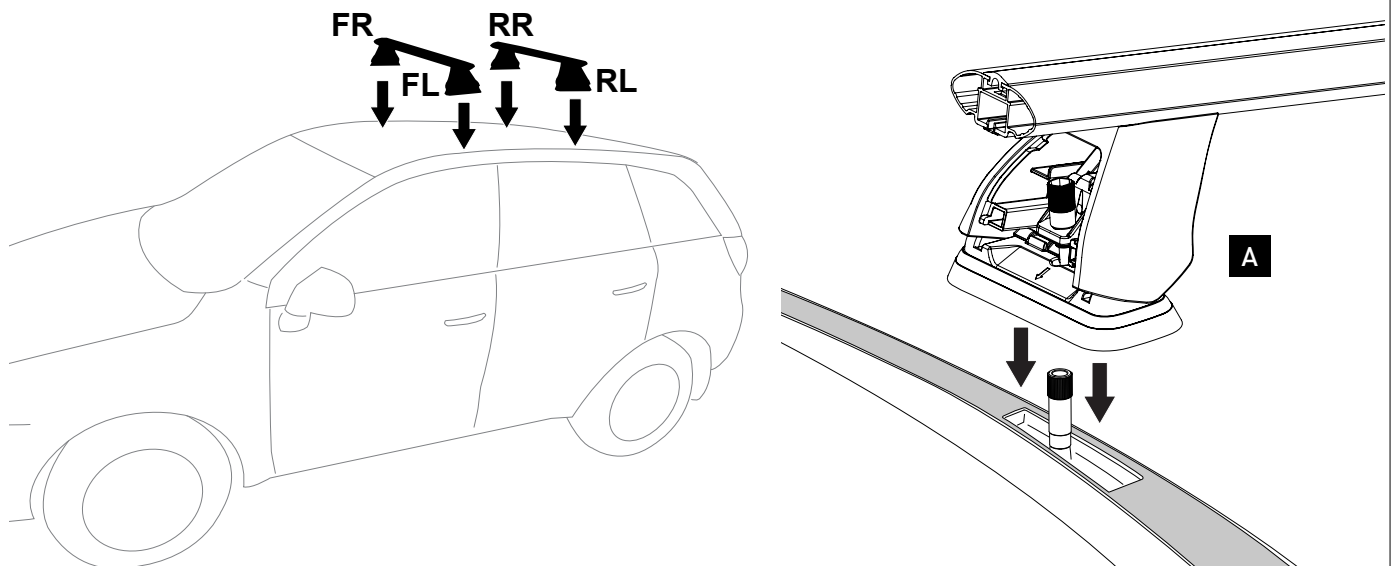

- 32** Attach crossbars. Tighten plastic bolt housing alternating both sides. Tighten to 3-4 Nm.

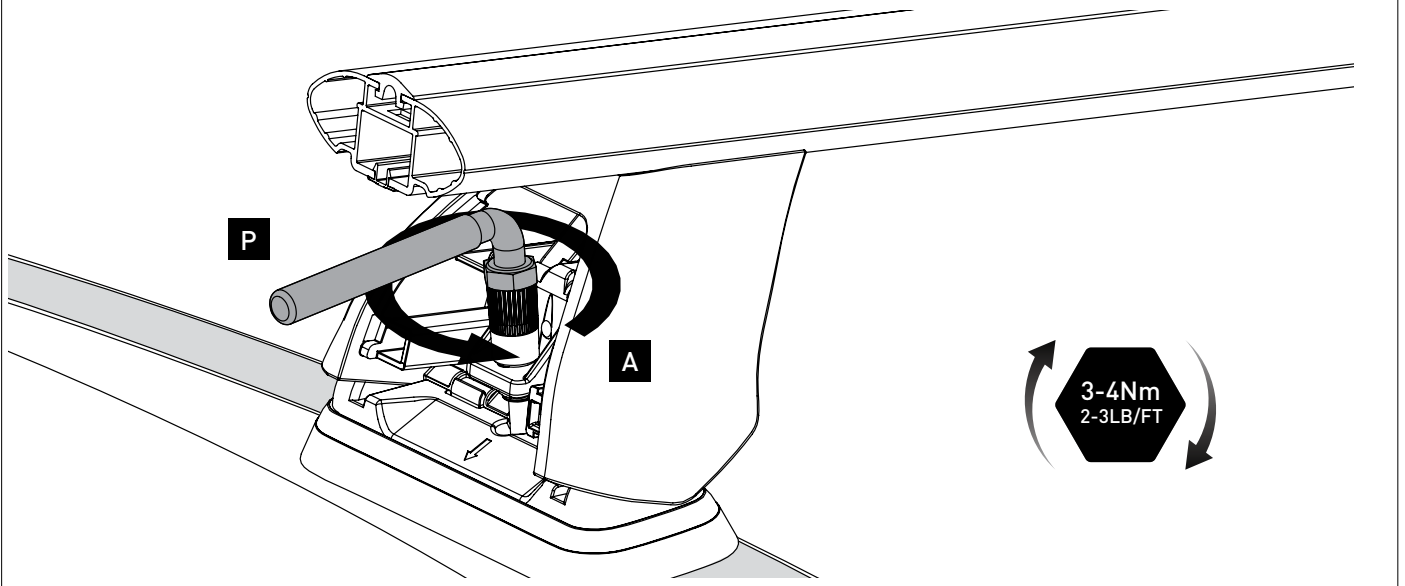

33

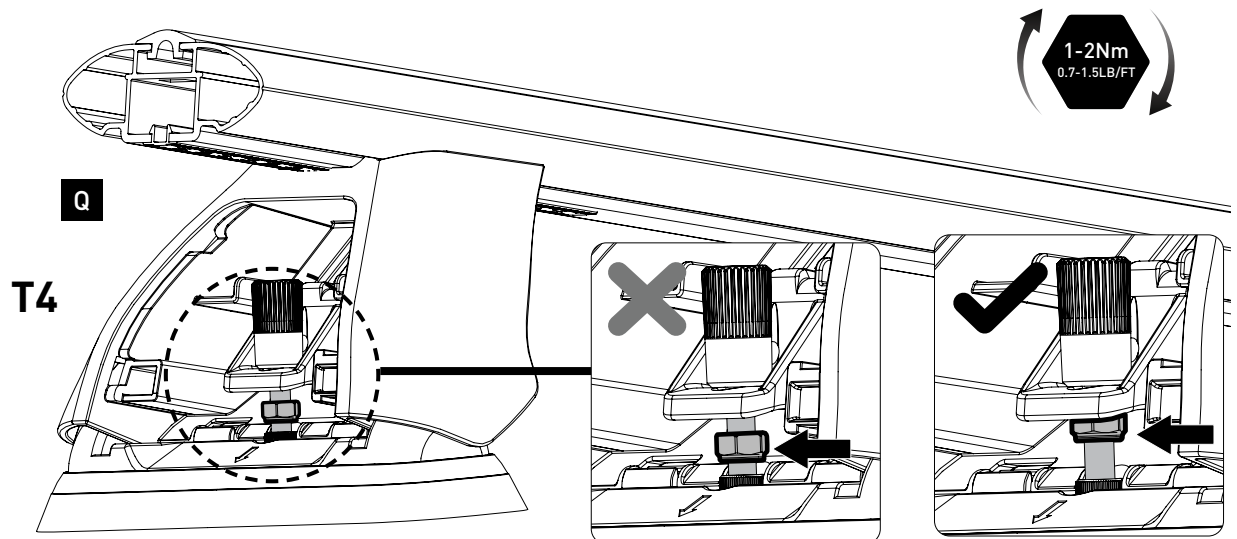

34

Check fitment is secure

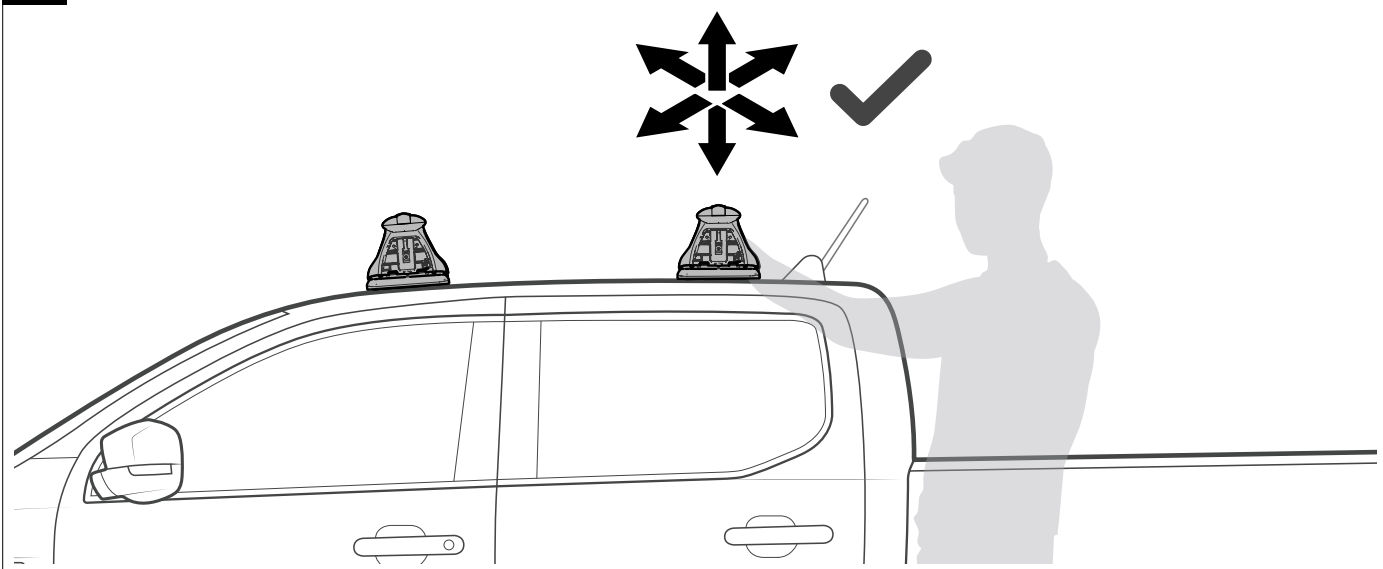

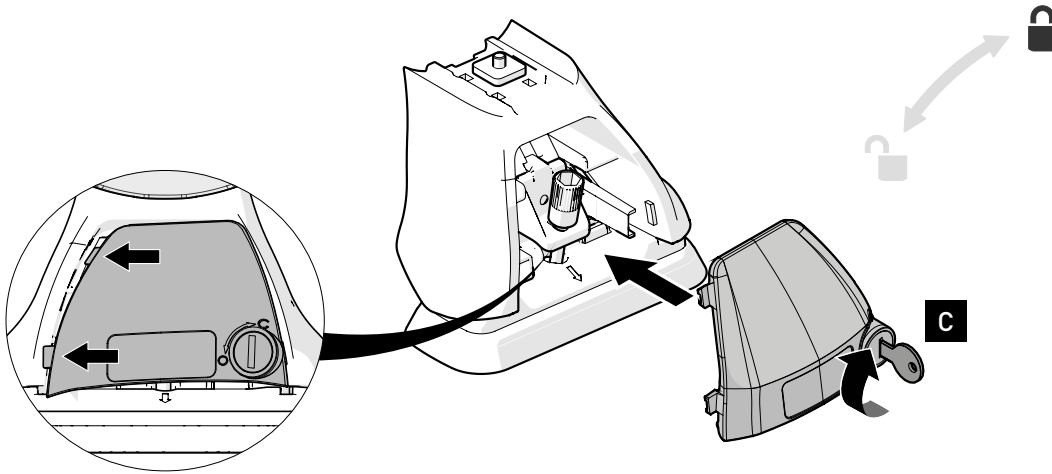
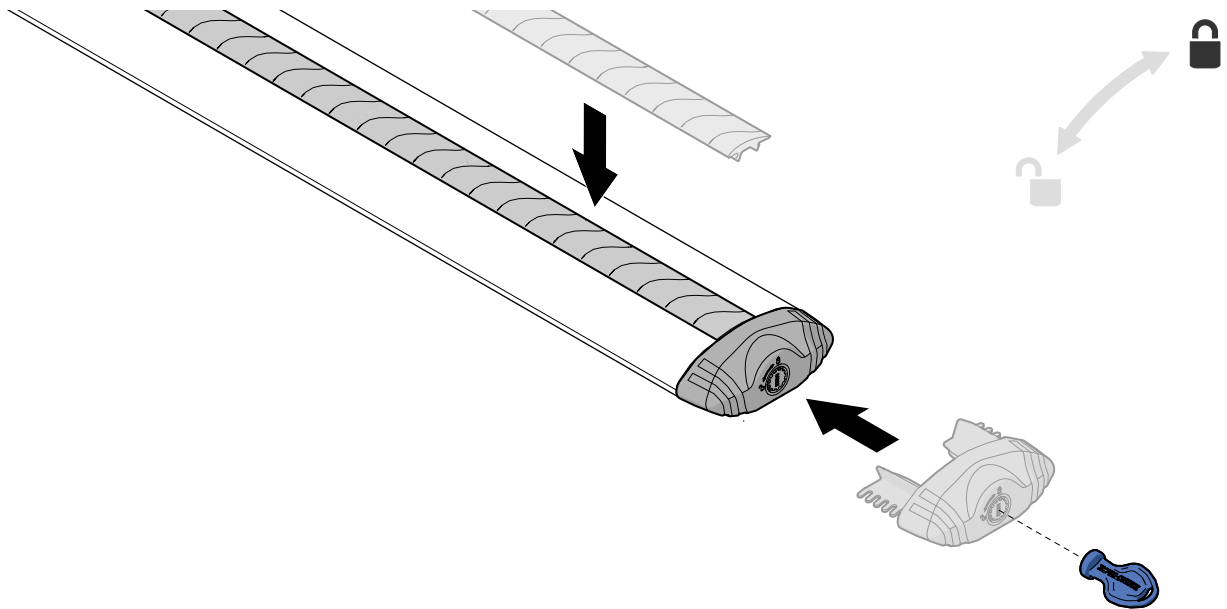
35 Attach front cover.**36****Vortex Bar Installation** Complete.

NOTES

NOTES



RHINORACK.COM

Rhino-Rack AUSTRALIA

22A Hanson Pl,
Eastern Creek, NSW, 2766

Rhino-Rack USA

19822 E 22nd Ave,
Aurora, CO, 80011