



# RHINO-RACK

Aerodynamic & Heavy Duty Roof Rack Systems

## RMPH 1 Rhino Multi Purpose Holder European/Rola Sports Bar

Place these instructions in the vehicle's glove box after installation is complete.

**Important:** Please read these instructions carefully prior to installation. Please refer to your fitting instruction to ensure that the roof racks are installed in the correct locations. Check the contents of kit before commencing fitment and report any discrepancies

### Parts List

| Item | Component Name                  | Qty | Part No. |
|------|---------------------------------|-----|----------|
| 1    | Multi Purpose Holder Body       | 2   | M218     |
| 2    | Multi Purpose Holder Strap      | 2   | M220     |
| 3    | Euro Square Wrap                | 2   | M212     |
| 4    | Rola Wrap                       | 2   | M209     |
| 5    | Multi Purpose Holder Rubber Pad | 2   | M219     |
| 6    | Fitting Instruction             | 1   | RS-85    |

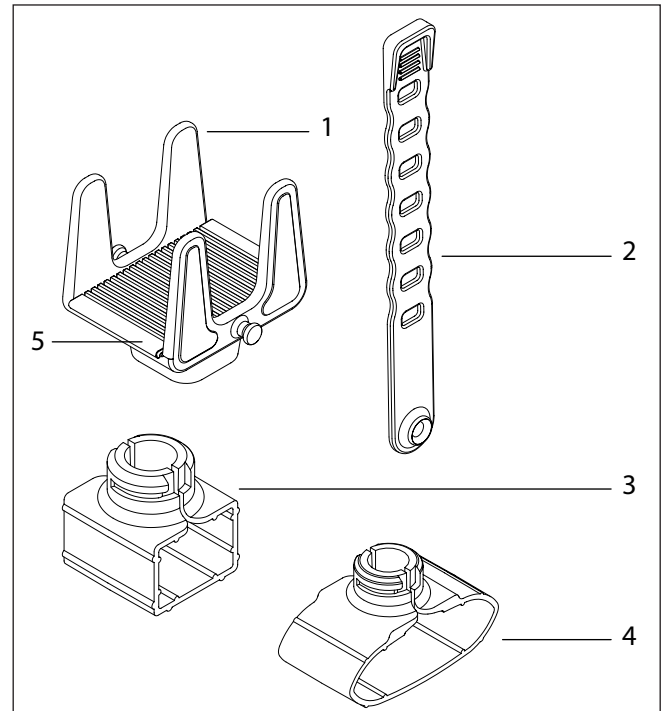

### Care Instruction:

Thoroughly clean vehicle roof racks prior to fitting the Rhino Multi Purpose Holders.

### Tools Required

Tape Measure

### Layout:

#### NOTE:

Measure to make sure the Multi Purpose Holders are spaced equally.

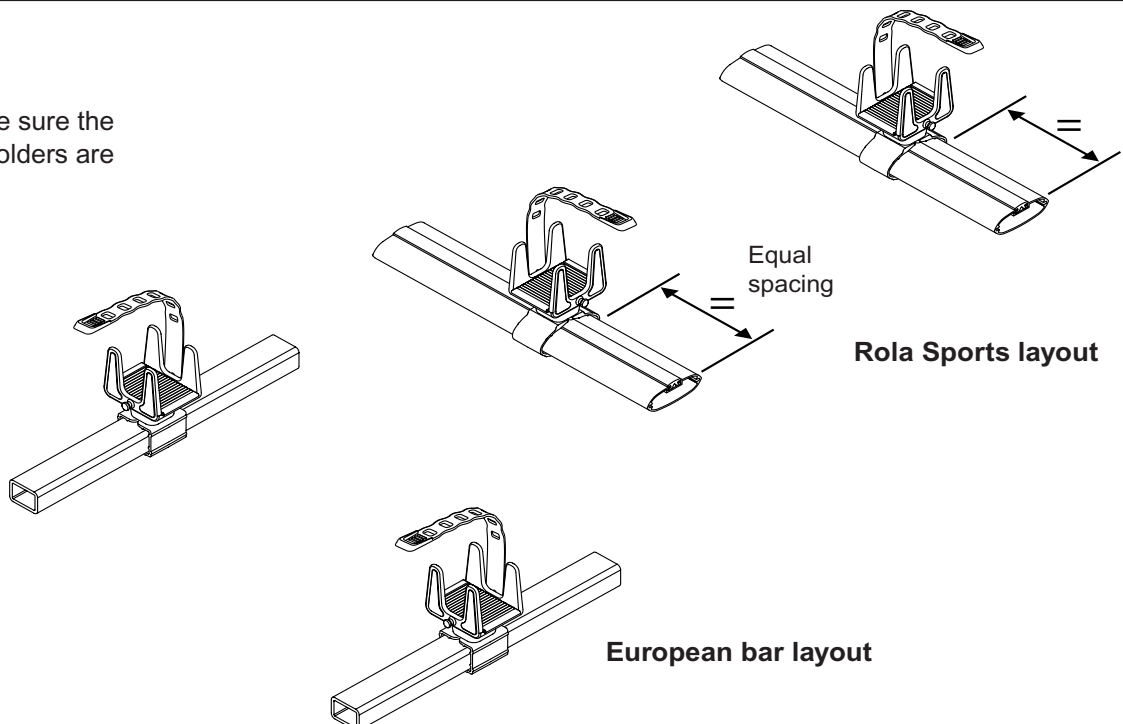

**1**

**Assemble the Multi Purpose Holder:**

- a. Push the Rubber Multi Purpose Holder Strap onto the locating boss on one side of the Multi Purpose Holder Body. Lubrication may be needed around the boss to assist with fitment.

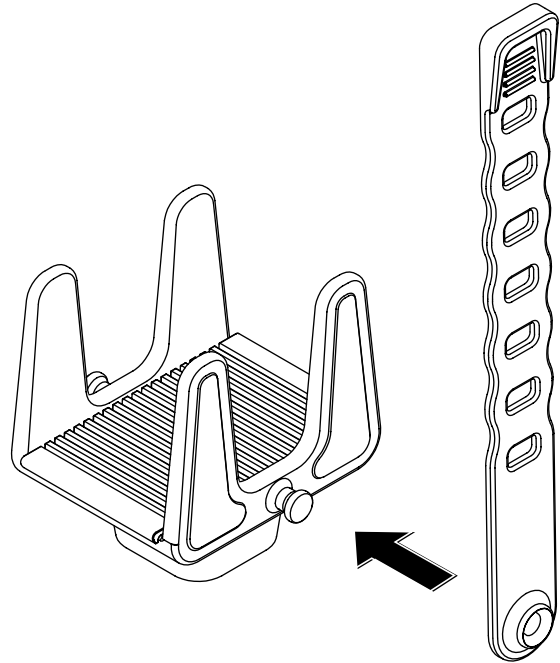

**ROLA Sports fitment:**

Spread and twist the Rola wrap and wrap under the bar. The material will allow quite a bit of flexing. The rubber buffer strip on the cross bar does not need to be cut or removed for fitment

**2a**

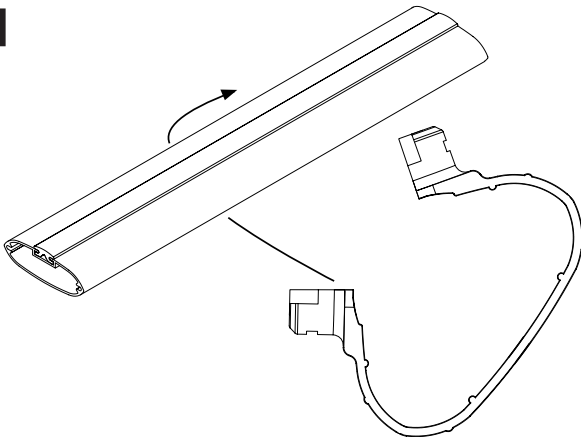

**ROLA Sports fitment:**

Push the Multi Purpose Holder Body onto the Rola Wrap boss and turn 90° to lock in position.

**2b**

Push down and turn to lock.

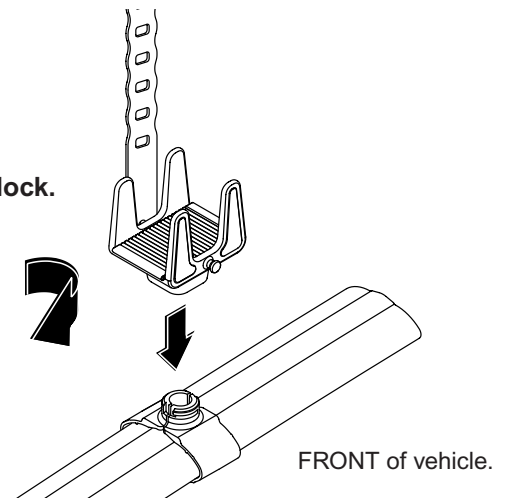

**Euro Square bar fitment:**

Spread and twist the Euro Square wrap and wrap under the bar. The material will allow quite a bit of flexing.

**3a**

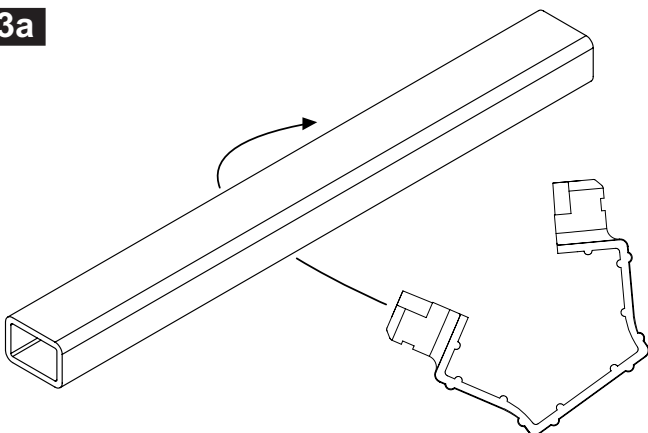

**Euro Square bar fitment:**

Push the Multi Purpose Holder Body onto the Euro Square Wrap boss and turn 90° clockwise to lock in position.

**3b**

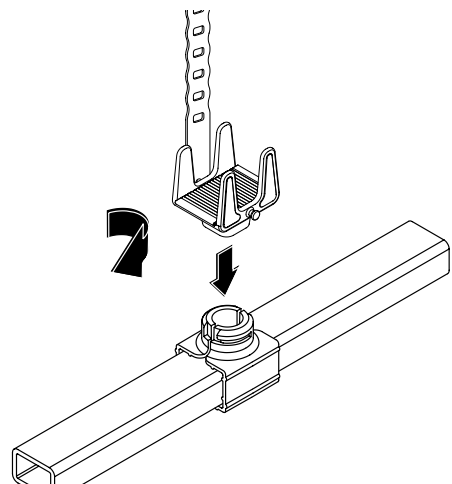

**STRAP Installation:**

Once installed the strap folds over and hooks onto the location spigot on the opposing side of the Body retaining your load.

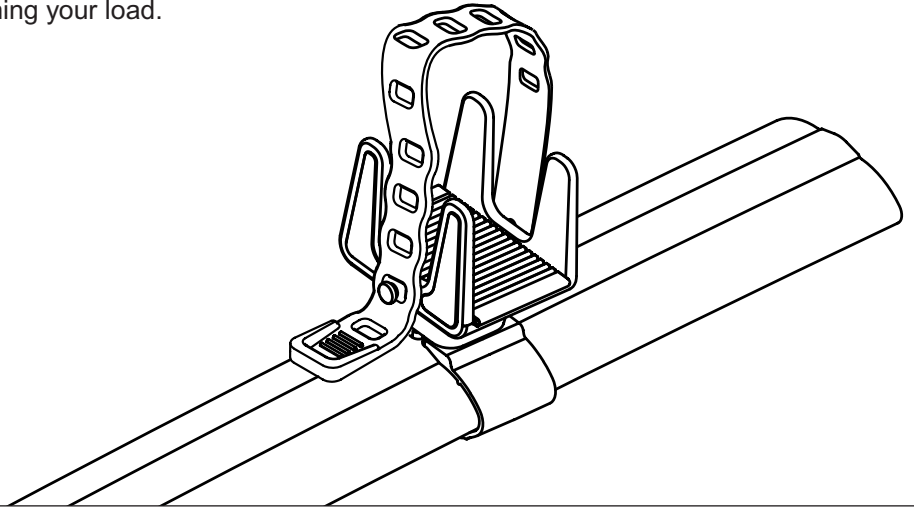
**4****Important Information****Recommendations**

It is essential that all bolt connections be checked after driving a short distance when you first install your Rhino Rack accessory. Bolt connections should be checked again at regular intervals (probably once a week is enough, depending on road conditions, usage, loads and distances travelled). You should also check the roof bars and accessories each time they are refitted.

Make sure to fasten your load securely. Please ensure that all loads are evenly distributed and that the centre of gravity is kept as low as possible.

**Use only non-stretch fastening ropes or straps.**

**Sensitivity to Crosswinds, Behaviour in Curves and Braking**

The handling characteristics of the vehicle, changes when you transport a load on the roof. For safety reasons, we recommend you exercise extreme care when transporting wind-resisting loads; special consideration must be taken into account when braking.

**Please remove crossbars when putting vehicle through an automatic car wash.**

**Load Ratings**

Refer to vehicle manufactures carrying capacity for roof bars. When roof racks are to be used in off-road conditions, please build a safety factor of 1.5 into this load limit. Although the roof racks are tested and approved to AS1235-2000, Australian road conditions can be much more rigorous. However, increasing the number of crossbars does not increase the vehicles maximum permissible roof loading.

**Note for Dealers and Fitters**

It is your responsibility to ensure instructions are given to the end user or client

Rhino-Rack  
3 Pike Street, Rydalmere,  
NSW 2116, Australia.  
(Ph) (02) 9638 4744  
(Fax) (02) 9638 4822

Document No: RS-85  
Prepared By: Craig Jones  
Authorised By: Gary England

Issue No: 01  
Issue Date: 30/08/2005

These instructions remain the property of Fetovu Pty Ltd T/as Rhino-Rack and may not be used or changed for any other purpose than intended.