



RHINO-RACK

Aerodynamic & Heavy Duty Roof Rack Systems

CONTROLLED

RFMPS2 Rhino Fixed Mount System (with RLCP leg)

Important: Please read these instructions carefully prior to installation. Please refer to your fitting instruction to ensure that the RFMPS2 is installed in the correct locations. Check the contents of kit before commencing fitment and report any discrepancies. Place these instructions in the vehicle's glove box after installation is complete.

Layout

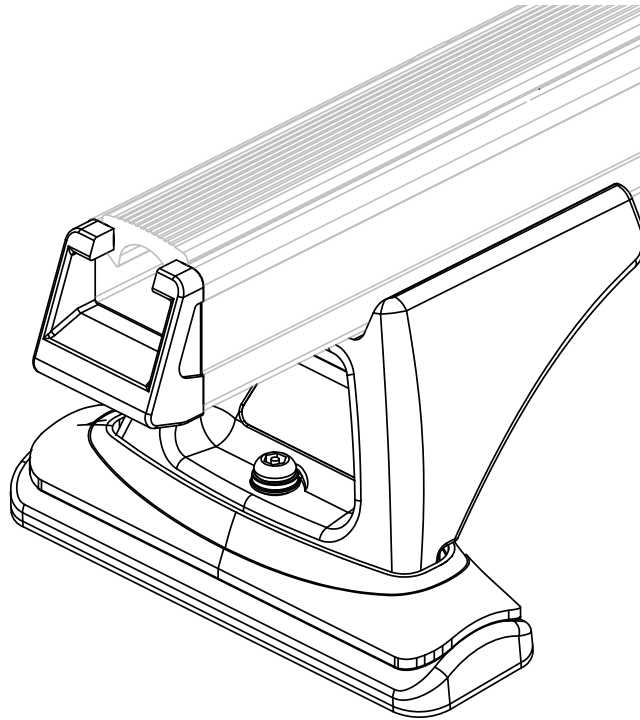

**Heavy Duty Crossbar
SOLD SEPARATELY**

Maximum carrying capacity:

Please refer to your vehicle manufacturers handbook for maximum carrying capacity of your roof racks. Always use the lower of the two figures. Load must be evenly distributed over the crossbars. **Warning:** Do not attempt to fit the RFMPS2 to your vehicle unless you fully understand this fitting instructions. Please direct any questions regarding fitting to the dealer from where the RFMPS2 was purchased. **Use only non-stretch fastening ropes or straps.**

Recommendations:

It is essential that all bolt connections be checked after driving a short distance when you first install your roof racks and RFMPS2. Bolt connections should be checked again at regular intervals (once a week is enough, depending on road conditions, usage, loads and distances travelled). You should also check the roof racks and RFMPS2 each time they are re-fitted. Always make sure to fasten your load securely. Please also ensure that all loads are evenly distributed and that the centre of gravity is kept as low as possible. Long loads (e.g. canoes and kayaks) must be secured front and rear with non-stretch fastening ropes or straps. **Roof racks must be removed when putting vehicle through an automatic car wash.**

Caution: The handling characteristics of the vehicle changes when you transport a load on the roof. For safety reasons we recommend you exercise extreme care when transporting wind-resistant loads. Special consideration must be taken into account when cornering and braking.

Note for Dealers and Fitters

It is your responsibility to ensure this fitting instruction is given to the end user or client

Rhino-Rack
3 Pike Street, Rydalmere,
NSW 2116, Australia.
(Ph) (02) 9638 4744
(Fax) (02) 9638 4822

Document No: R149
Prepared By: Andy Wana
Authorised By: Chris Murty

Issue No: 01
Issue Date: 11/11/2011

These instructions remain the property of Rhino-Rack Australia Pty Ltd and may not be used or changed for any other purpose than intended.



RFMPS2 Rhino Fixed Mount System (with RLCP leg)

Parts List

Item	Component Name	Qty	Part No.
1	Bar End Cap	2	M002
2	M6 x 27mm Button Security	2	B063
3	M6 Spring Washer	2	W004
4	M6 Flat Washer	2	W003
5	M10 Channel Nut	2	N024
6	RCP Leg 52mm High	2	M123
7	M10 Flat Washer	2	W022
8	M10 Shakeproof Washer	2	W021
9	M10 x 20 Hex Screw	2	B003
10	RCP Sliding Mounting Pad	2	M508
11	Rivet	9	H042
12	RCP Fixed Pad	2	M507
13	M6 Curved Cast Nut	2	N060
14	RCP Curved Nut Retainer	2	M510
15	PVC Foam Block	2	C135
16	5mm Security Key	1	H021
17	Fitting Instruction	1	R149

Tools Required

Stanley knife, Marking pen, Masking tape, Centre punch, Power or cordless drill, 5mm drill bit, Drill stop, Vacuum cleaner, Pneumatic or concertina type rivet gun, Galvanised paint, Selleys Butyl Mastic, Measuring tape, 16mm or 5/8" spanner

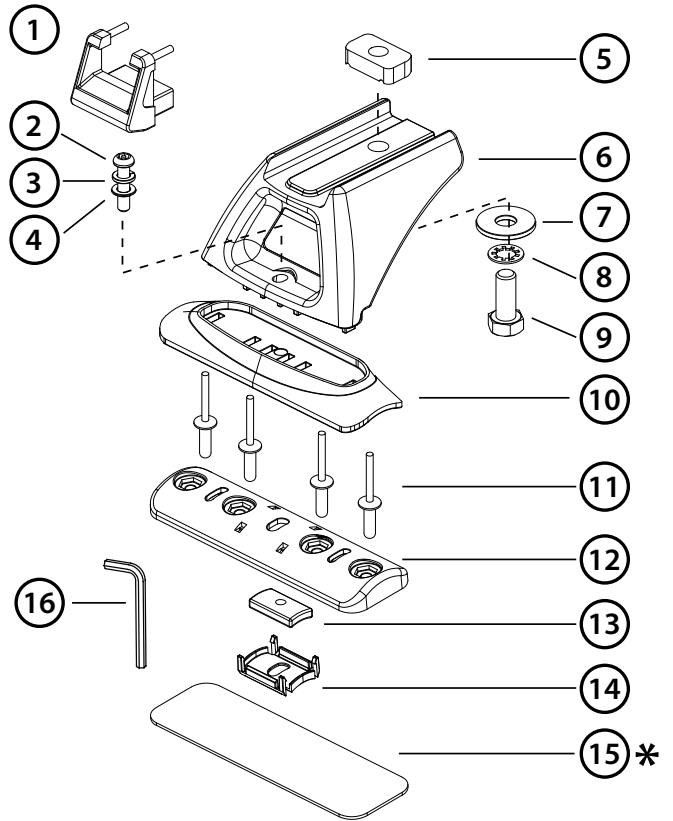

* Needs to be cut to suit the RCP Fixed Pad

1 Assemble leg as shown. Do not tighten fully at this point.

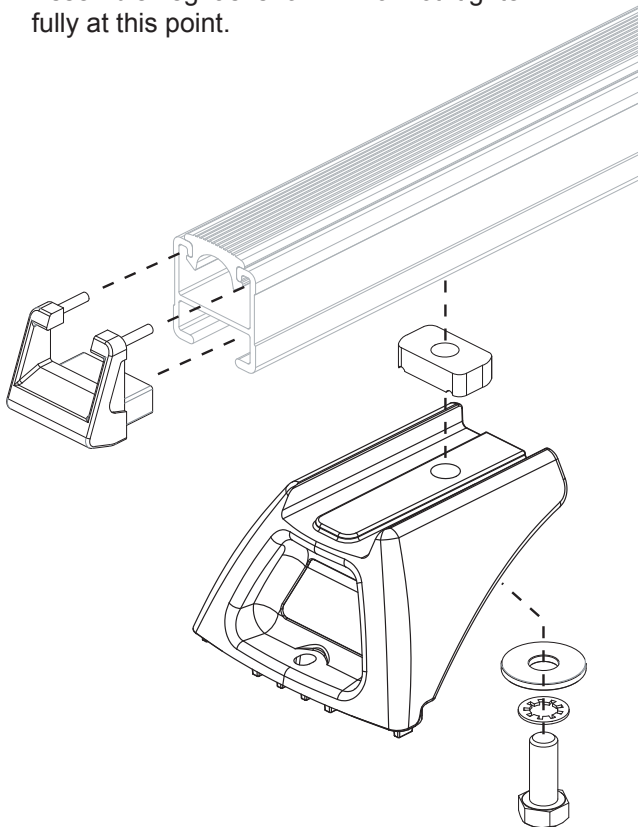

2

Channel nut must locate fully across the cross bar.

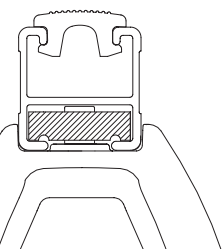



RFMPS2 Rhino Fixed Mount System (with RLCP leg)

3

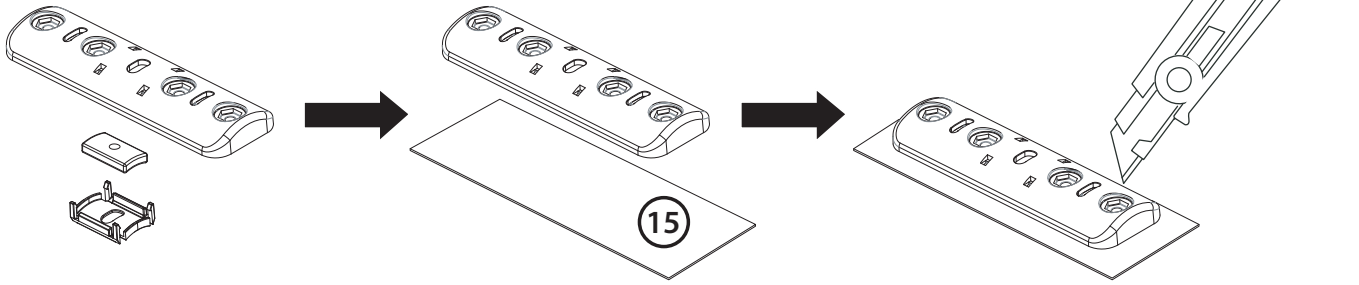

4

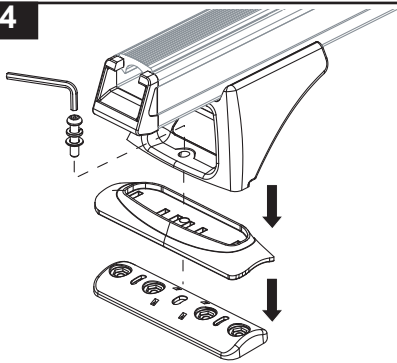

Assemble legs

5

Mask the roof area with masking tape and mark where you want to position the legs at.

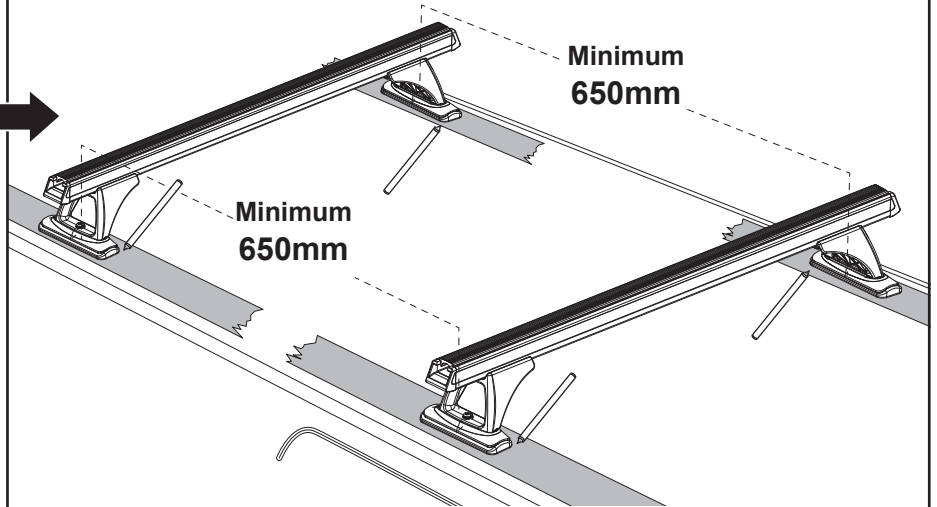

Minimum 650mm

Minimum 650mm



Ensure bars are square, parallel and evenly spread. Pads to be positioned on the strongest part of the roof.

EQUAL OVERHANG DISTANCE



6

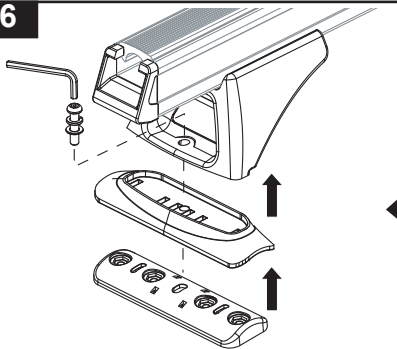

Disassemble legs

7

Drill the holes carefully (see step 8 for details), make sure that you vacuum the excess swarf from the roof

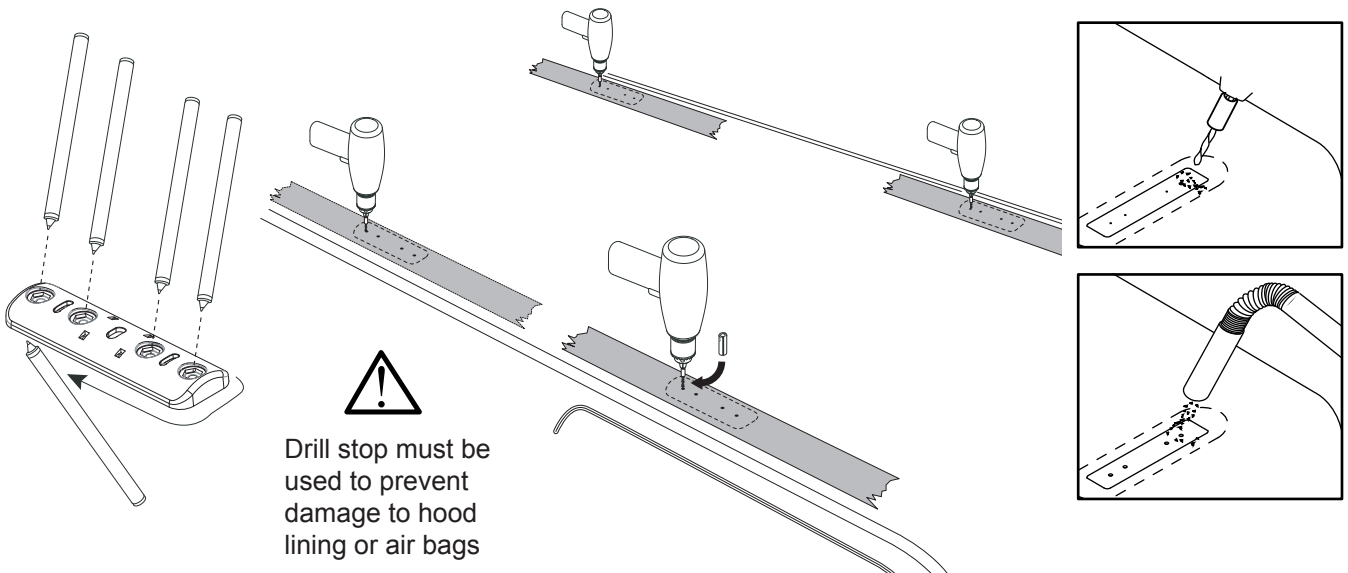

Drill stop must be used to prevent damage to hood lining or air bags



RFMPS2 Rhino Fixed Mount System (with RLCP leg)

8 A rivet must be located into each hole and checked that it fully penetrates. If a second skin is encountered, drill second skin then with a centre punch counter sink the hole to allow clearance for rivet.

Note: Failing to do this correctly may result in vehicle roof damage due to rivet catching on second skin.

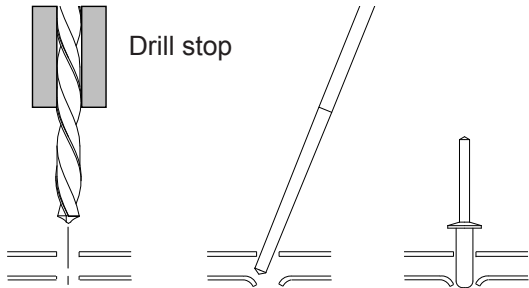

9 Apply cold galvanising paint around holes

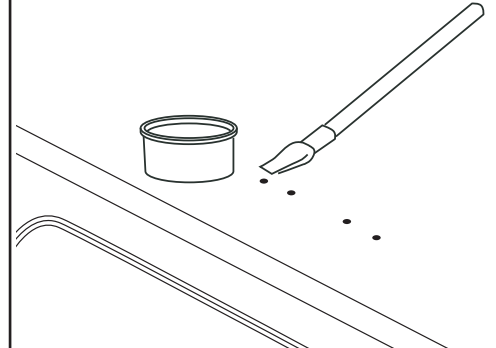

10 Once dry apply Selleys Butyl Mastic.

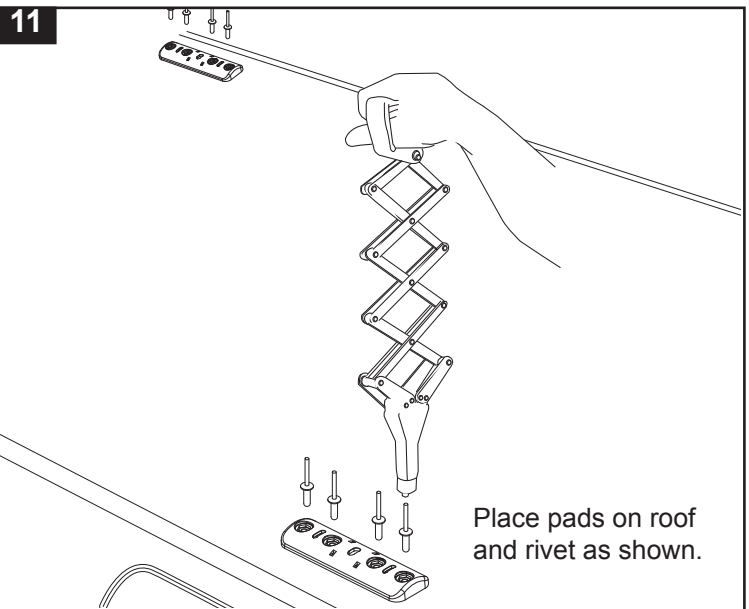
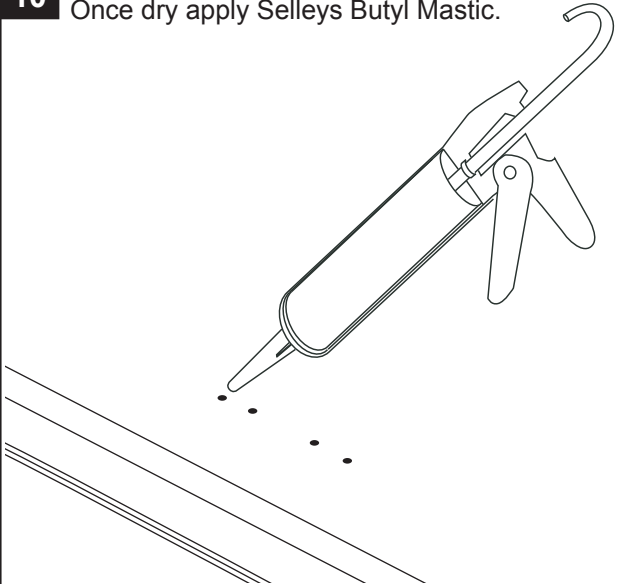

12 Attach crossbars to pads as shown. Tighten bolt to 3-4Nm. Ensure that the overhang on both ends are equal.

