



# RHINO-RACK

Aerodynamic & Heavy Duty Roof Rack Systems

## RESLK Rhino Commercial - Easy Pad Ladder Holder

Place these instructions in the vehicle's glove box after installation is complete.

**Important:** Please read these instructions carefully prior to installation. Please refer to your fitting instruction to ensure that the roof racks are installed in the correct locations.

### RESLK Three Crossbar Layout

Arrange crossbars on top of vehicle as pictured below. Ensure that the universal ladder hoops assembly is positioned toward the front of the vehicle and the ladder strap assembly is positioned toward the rear of the vehicle.

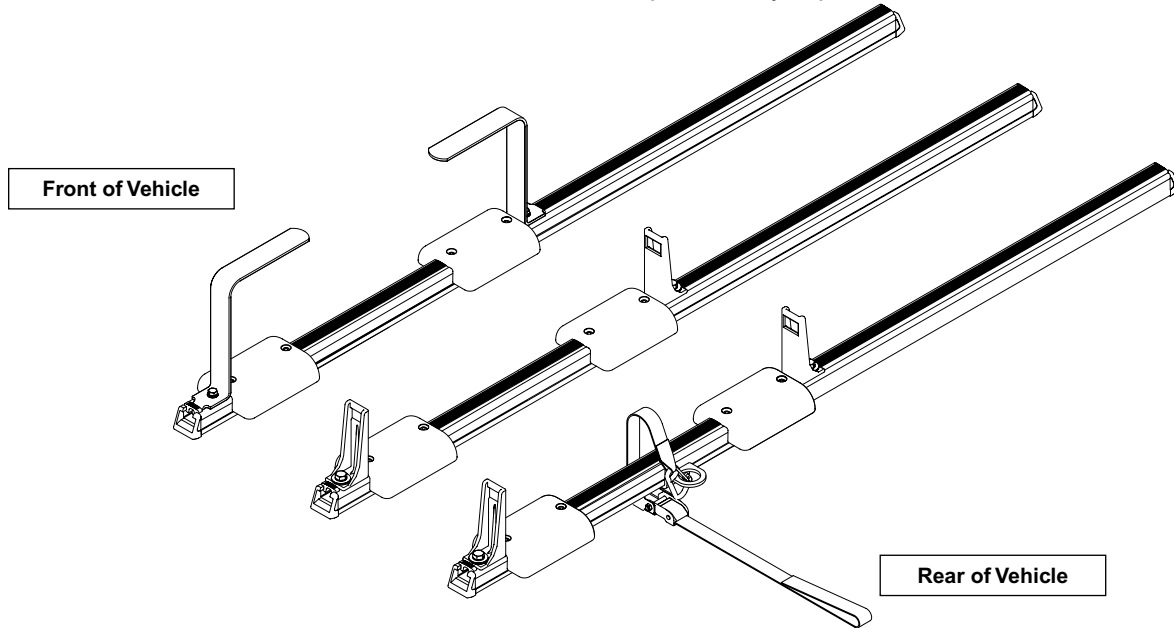

**Important:** Check the contents of kit before commencing fitment and report any discrepancies.

### Parts List Easy Pad Assembly

Item	Component Name	Qty.	Part No.
1	M6 x 20mm Socket Head Capscrew	12	B054
2	M6 Spring Washer	12	W004
3	M6 x 12.5mm Flat Washer	12	W003
4	Easyslide Ladder Pad	6	M060
5	M6 Channel Nut	12	N002
6	5mm Hex Allen Key	1	H002
7	Fitting Instruction	1	RR052

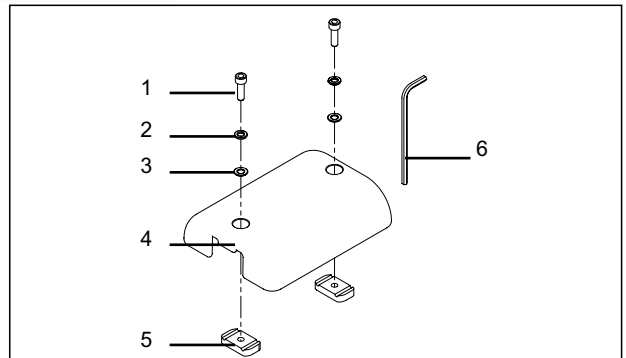

Assemble the spring and flat washers onto the button security screw. Insert the screw and washer assembly through the easy pad and screw on the channel nut, 2 turns. Insure the grooves in the channel nut are facing up.

**1**

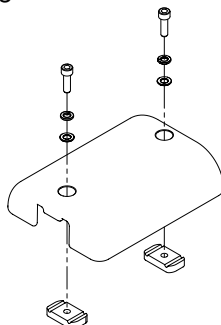

Place the easy pad onto the crossbar with the channel nuts down into the crossbar recess. Using the allen key provided tighten the button security screw. Check that the channel nuts have rotated and the grooves are fully located in the crossbar section. Cut rubber buffer strip to suit.

**2**

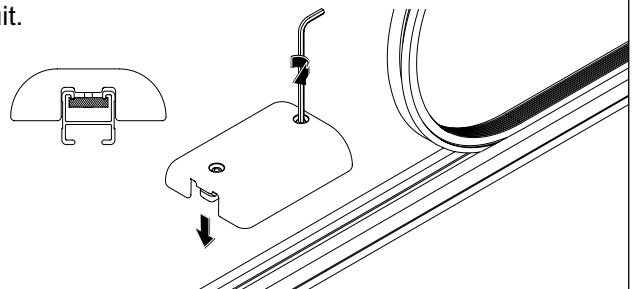

## Parts List

## Load Holder Assembly

Item	Component Name	Qty.	Part No.
1	M10 x 25mm Hex Bolt	4	B071
2	M10 Internal Shake Proof Washer	4	W021
3	M10 x 30mm Flat Washer	4	W023
4	Load Holder Peg	4	M005
5	M10 Channel Nut	4	N024
6	Fitting Instruction	1	RR052

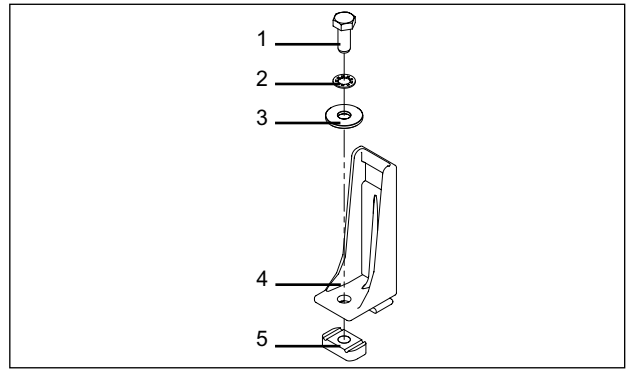

Loosen the channel nut and slide the load holder T-shaped section into the top recess of the Rhino crossbar with the channel nut grooves in line with the crossbar.

**3**

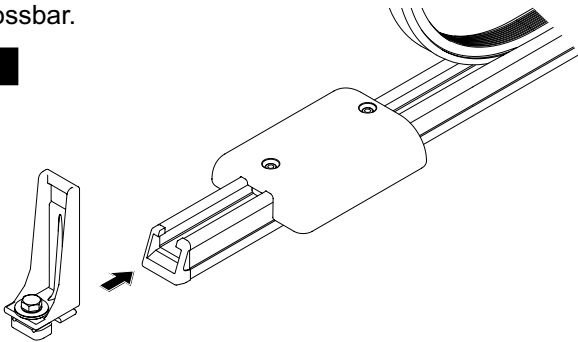

Position the load holder and tighten the bolt to secure. Check that the channel nut has rotated and the grooves are fully located in the crossbar. Cut rubber buffer strip to suit.

**4**

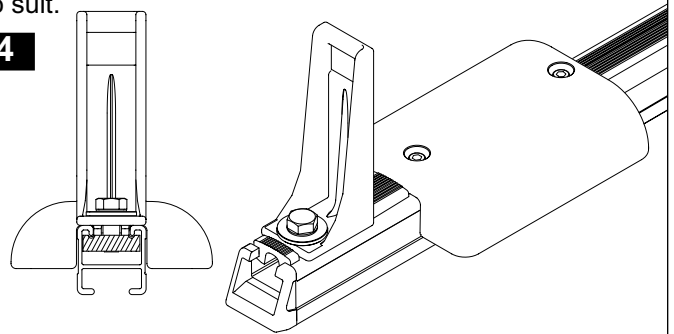

## Parts List

## Ladder Strap and Attachment Ring Assembly

Item	Component Name	Qty.	Part No.
1	Camlock, Strap & Snap Hook Bracket	1	C087
2	M6 Nyloc Nut	1	N013
3	M8 Channel Nut	1	N003
4	U-Section Strap Bracket	1	C033
5	M6 x 50mm Hex Bolt	1	B024
6	M8 Shake Proof Washer	1	W033
7	M8 x 16mm Hex Bolt	1	B019
8	M10 x 20mm Hex Bolt	1	B003
9	M10 Shake Proof Washer	1	W021
10	RLS4/5 Snap Hook Bracket	1	C122
11	M10 Channel Nut	1	N024
12	Fitting Instruction	1	RR052

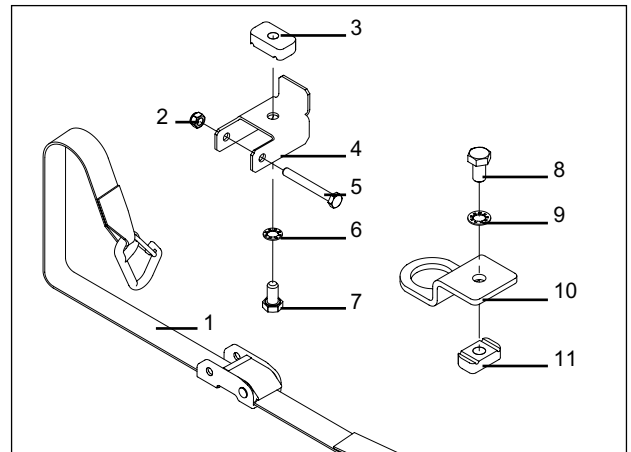

Locate the attachment ring to the under side recess of the crossbar, push the bolt and channel nut up into the recess. Position the snap hook bracket and tighten the bolt to secure. Check that the channel nut has rotated and the channel nut grooves are fully located in the crossbar.

**1**

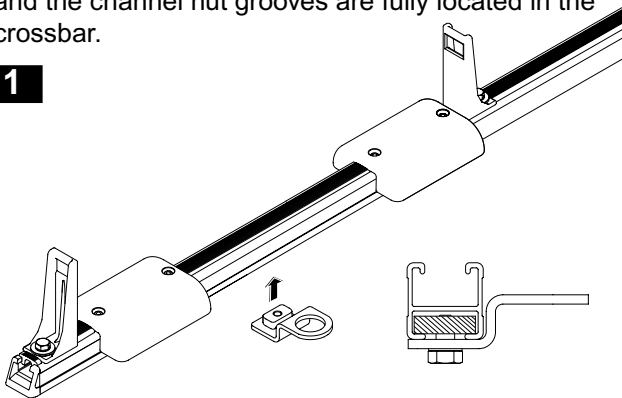

Locate the ladder strap to the under side recess on the crossbar. Push the bolt and channel nut up into the recess. Position the ladder strap and tighten the bolt to secure. Check that the channel nut has rotated and the channel nut grooves are fully located in the crossbar section.

**2**

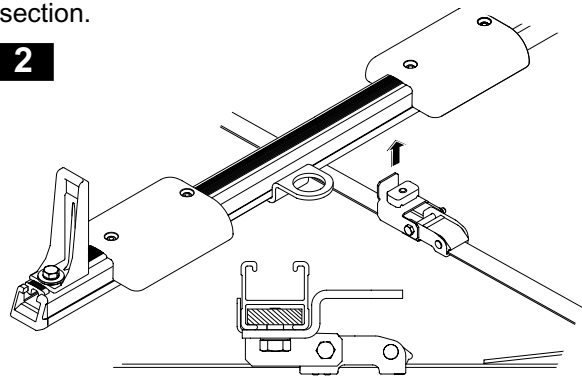

**Parts List****Universal Ladder Hoop Assembly**

Item	Component Name	Qty.	Part No.
1	M8 x 25mm Hex Bolt	2	B101
2	M8 Spring Washer	2	W019
3	M8 x 17mm Flat Washer	2	W020
4	Ladder Hoop Single Cross Bar	2	C034
5	M8 Channel Nut	2	N003
6	Fitting Instruction	1	RR052

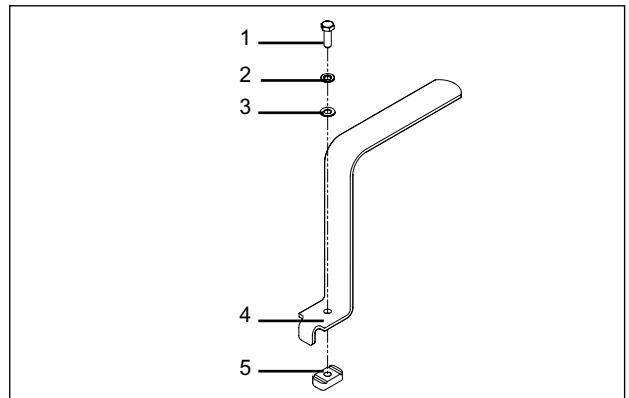

Insert the universal ladder hoop tang into the crossbar recess. Push the attachment bolt down and turn so that the channel nut locates across the crossbar.

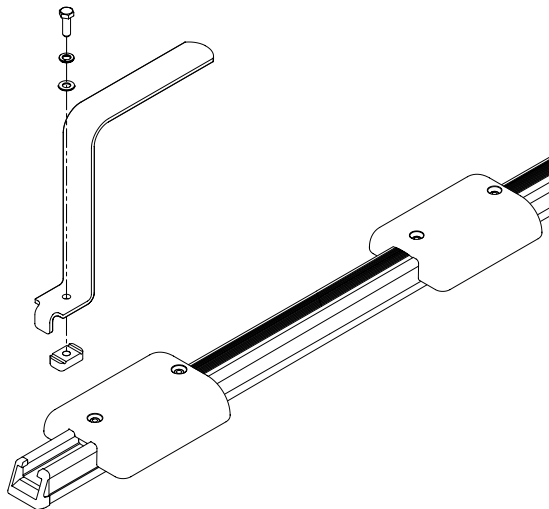
**1**

Adjust the ladder hoops to suit the ladder being loaded. Tighten the attachment bolt and check that the channel nut is fully located across the crossbar after tightening. Cut rubber buffer strip to suit.

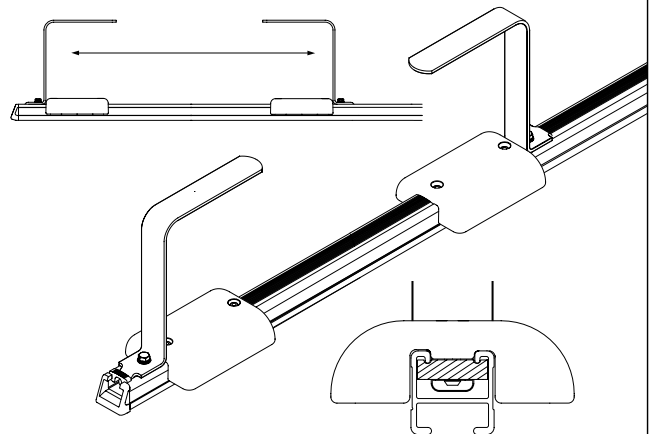
**2**

Rhino-Rack  
 3 Pike Street, Rydalmere,  
 NSW 2116, Australia.  
 (Ph) (02) 9638 4744 (Fax) (02) 9638 4822

Document No: RR-052  
 Prepared By: Sheila Oliveira Issue No: 03  
 Authorised By: Gary England Issue Date: 31/07/2003

These instructions remain the property of Fetovu Pty Ltd T/as Rhino-Rack and may not be used or changed for any other purpose than intended.