

HD BAR EYE BOLTS

REB

Item	Component Name	Qty
A	M10 Eye Bolts	2
B	M10 Shake Proof Washer	2
C	M10 x 38mm x 2.5mm Flat Washer	2
D	M10 Channel Nut	2
E	Fitting Instruction	1

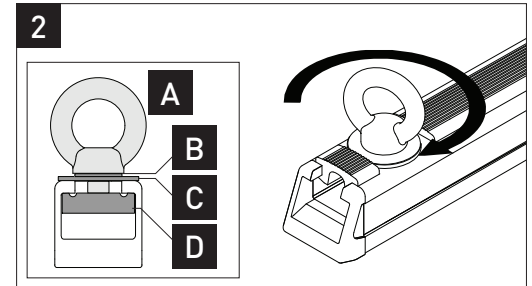
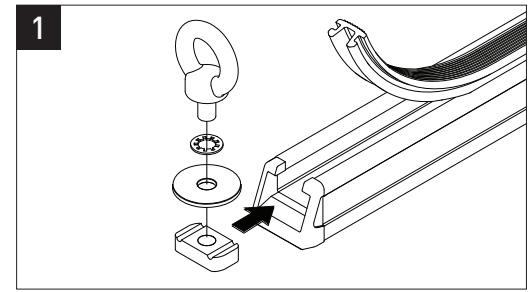
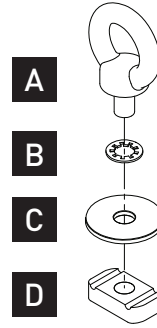

Important:

1. NOT for use with Pioneer Platforms and Reconn Deck Bars.
2. Place these instructions in the vehicle's glove box after installation is complete.
3. Check kit contents before commencing fitment and report any discrepancies.

Doc. No: RR-12

Issue No: 05

Issue Date: 02/03/2023

HD BAR EYE BOLTS

REB

Item	Component Name	Qty
A	M10 Eye Bolts	2
B	M10 Shake Proof Washer	2
C	M10 x 38mm x 2.5mm Flat Washer	2
D	M10 Channel Nut	2
E	Fitting Instruction	1

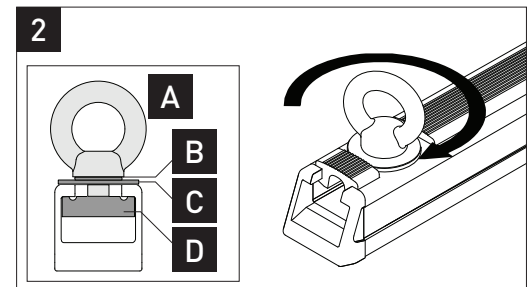
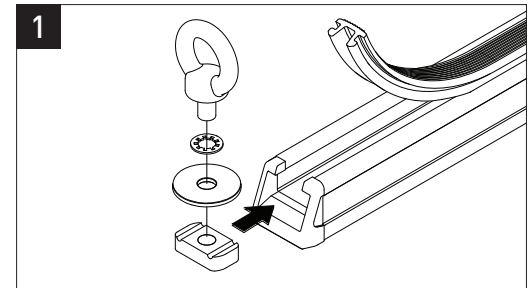
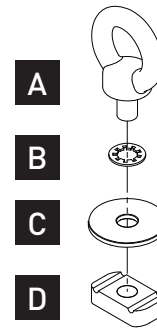

Important:

1. NOT for use with Pioneer Platforms and Reconn Deck Bars.
2. Place these instructions in the vehicle's glove box after installation is complete.
3. Check kit contents before commencing fitment and report any discrepancies.

Doc. No: RR-12

Issue No: 05

Issue Date: 02/03/2023

HD BAR EYE BOLTS

REB

Item	Component Name	Qty
A	M10 Eye Bolts	2
B	M10 Shake Proof Washer	2
C	M10 x 38mm x 2.5mm Flat Washer	2
D	M10 Channel Nut	2
E	Fitting Instruction	1

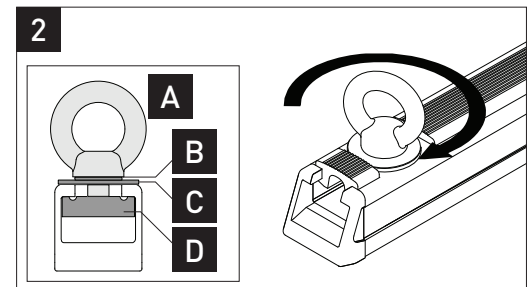
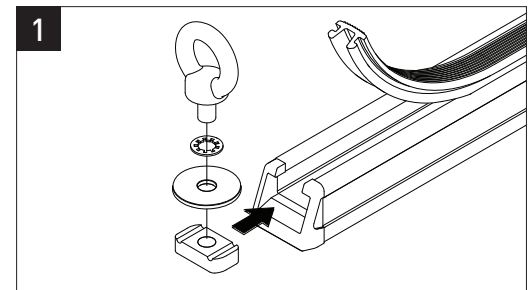
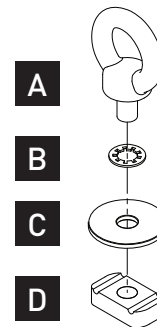

Important:

1. NOT for use with Pioneer Platforms and Reconn Deck Bars.
2. Place these instructions in the vehicle's glove box after installation is complete.
3. Check kit contents before commencing fitment and report any discrepancies.

Doc. No: RR-12

Issue No: 05

Issue Date: 02/03/2023