

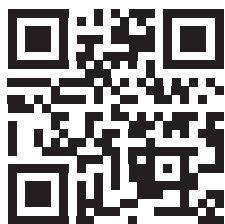

VEHICLE					PIONEER	CONNECTOR	HEIGHT ADDED (mm/in)	
NISSAN Patrol Y62 4WD/SUV Raised Rail 5 dr					52103	RX100	104 / 4.1	
VEHICLE NOTES	- Sunroof can be operated							
REGION	AUS	NZ	USA	CA	SA	UK	EU	ZA
AVAILABILITY	✓	✓	x	x	x	x	x	x
RUNNING DATES	2012 -	2012 -	-	-	-	-	-	-

VISIT THE ONLINE
CALCULATOR FOR
CURRENT SYSTEM
LOAD LIMIT DATA



DYNAMIC LOAD LIMIT (ON AND OFF-ROAD):
***USE THE VEHICLE MANUFACTURER'S MAXIMUM ROOF ALLOWANCE IF IT IS LOWER THAN THE FIGURE LISTED**

 CARGO
 UP TO **70 Kg**
154 lbs

+

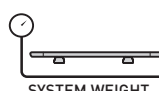
 SYSTEM WEIGHT
 UP TO **30 Kg**
66 lbs

=

 LOAD LIMIT
 UP TO **100 Kg**
220 lbs

OR

 Max kg
***VEHICLE
MANUFACTURER'S
ROOF LOAD LIMIT**

TOTAL STATIC LOAD LIMIT: UP TO 250 Kg / 551 lbs*

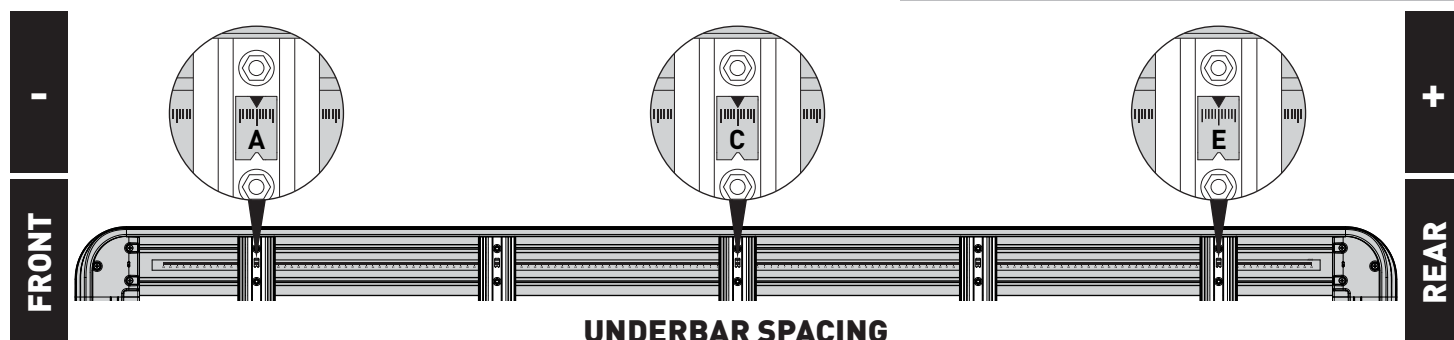

BAR NO.	A	B	C	D	E	F	G
DIMENSION (CM)	-63.2	-33.3	-3.4	26.5	56.4		
SPACERS REQ'D							
CONNECTOR	RX				RX		

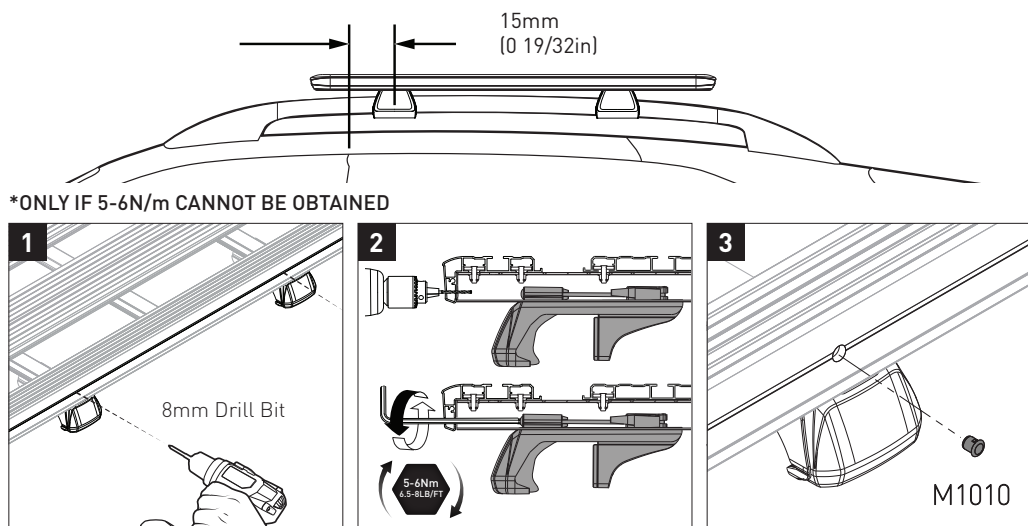

NOTES FOR DEALERS / FITTERS

It is your responsibility to ensure these fitting instructions are given to the end user or client.