

RHINO-RACK®

Sunseeker Freestanding Awning 2m

32148

Important:

1. Check the Rhino-Rack website to ensure you have the latest issue of these instructions.
2. Please refer to your fitting instruction to ensure that the roof racks are installed in the correct locations.
3. Check the contents of kit before commencing fitment and report any discrepancies.
4. Place these instructions in the vehicle's glove box after installation is complete.
5. These instructions must be followed for warranty to be upheld.

Fit Time: 15 mins

TWO-PERSON
INSTALLATION

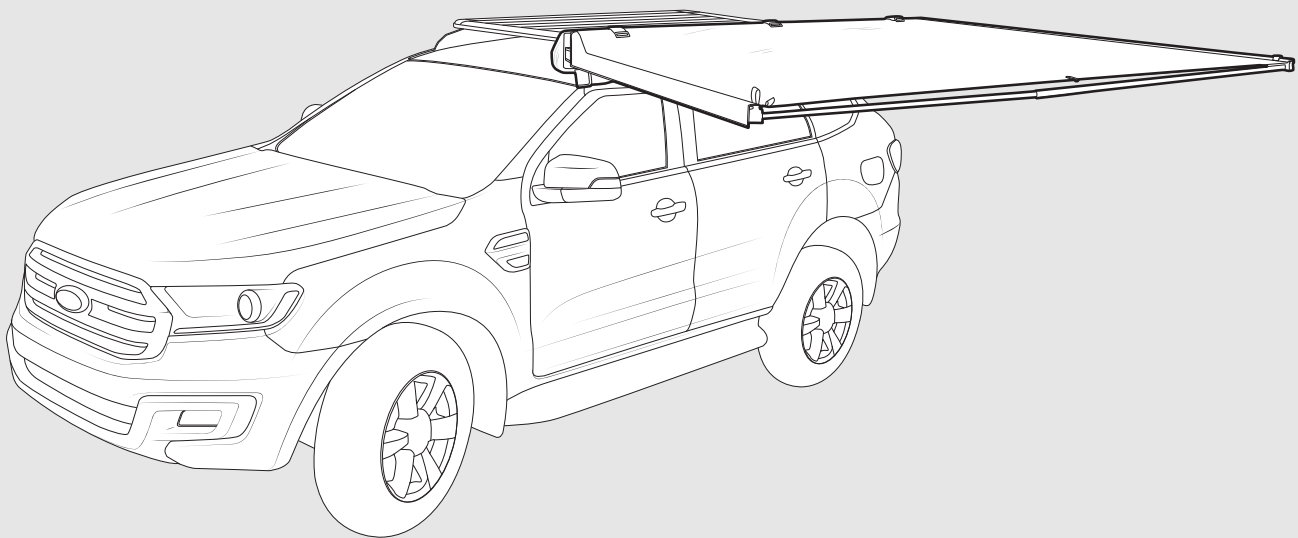

Thank you for choosing Rhino-Rack!



WELCOME TO THE HERD.

For peace of mind register
your product by heading to
rhinorack.com/register

Rhino-Rack AUSTRALIA
22A Hanson Pl,
Eastern Creek, NSW, 2766

Rhino-Rack USA
Unit D, 2450 Airport Blvd,
Aurora, CO, 80011

RHINORACK.COM
Document No:520-RFI-00211
Issue No: 03
Issue Date: 01/05/2025

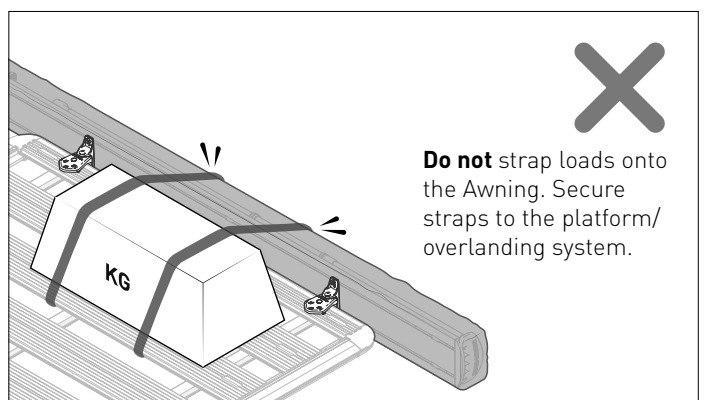
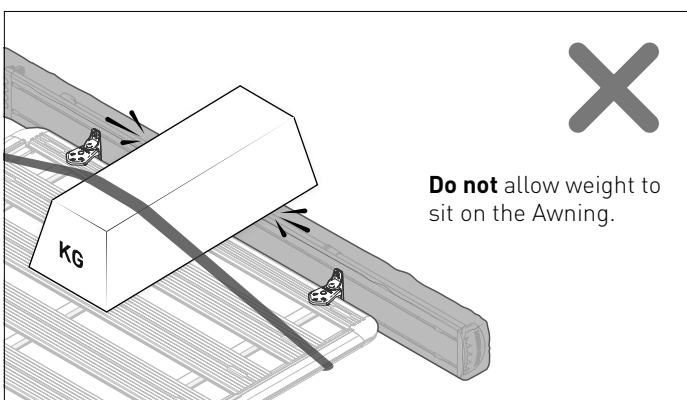
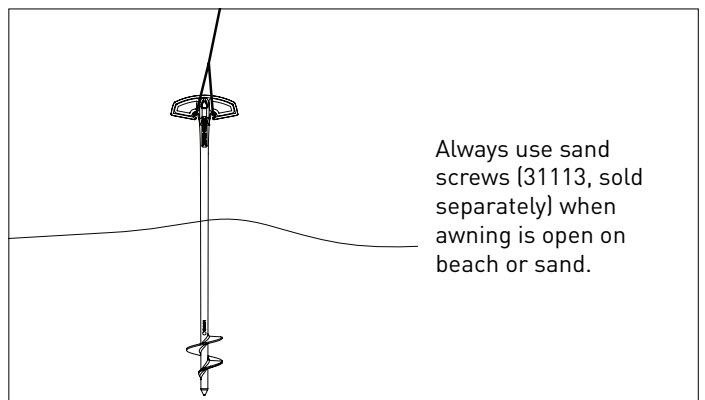
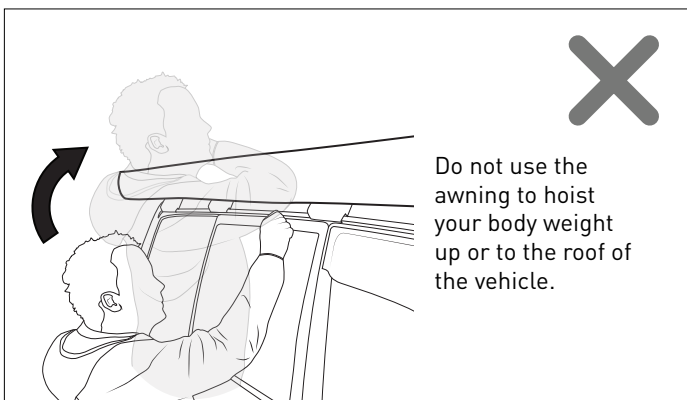
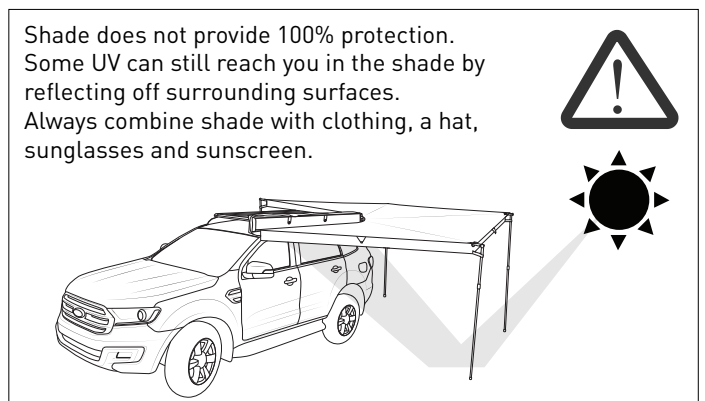
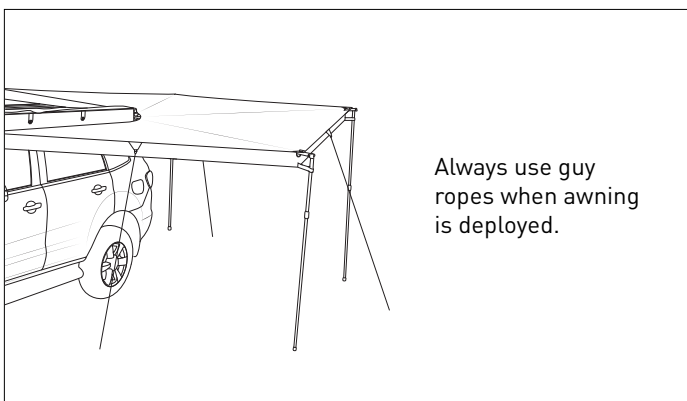
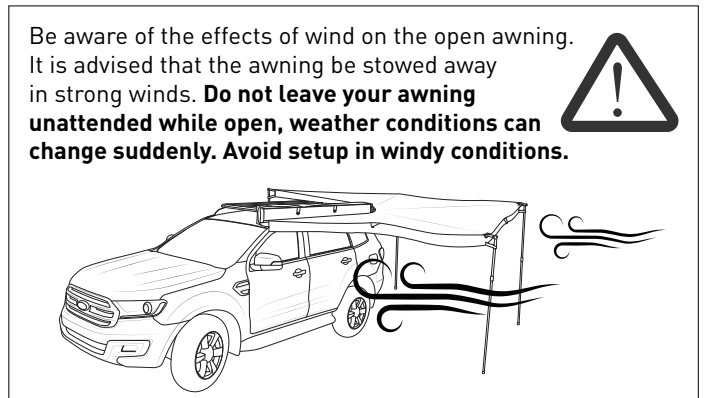
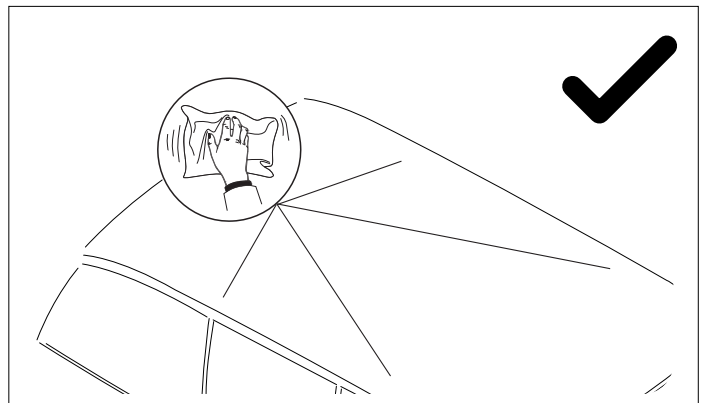
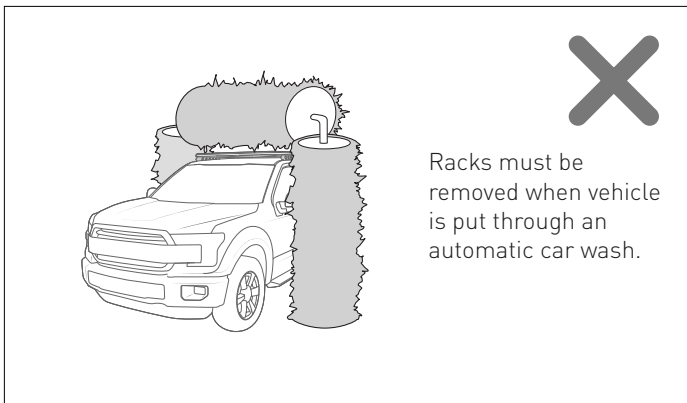

Important Information

Recommendations

Use only non-stretch fastening ropes or straps.

Please remove Sunseeker Freestanding and crossbars when putting vehicle through an automatic car wash. Do not stow away the awning for long periods if it is wet. You must allow the awning material to dry completely before storing for extended periods of time. When rolling up the awning, avoid excessive bunching up of the material before stowing. The awning should be rolled up as neatly as possible following the stowage instructions.

In service maintenance checks

- All bolt connections should be checked after driving a short distance when you first install your roof racks.
- All bolted connections should be checked again at regular intervals (weekly is recommended, depending on road conditions, usage, loads and distances travelled).
- All bolted connections should be checked each time they are re-fitted.
- Off-road conditions are more rigorous. Check all bolted connections and your load more regularly.
- Ensure that your vehicle manufacturer's GVM, and gross axle weights are not exceeded (refer to vehicle owner's manual).

Torque Settings:

Unless stated otherwise in these instructions, all fasteners should be set to the following torque settings:

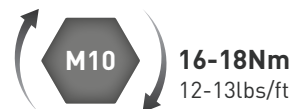

Load Ratings

With the addition of the Sunseeker Freestanding, the load capacity of your crossbars will have to be adjusted accordingly. The Batwing Awning with mounting brackets weighs approximately 20kg.

Note for Dealers and Fitters

It is your responsibility to ensure this fitting instruction is given to the end user or client. It is your responsibility to ensure these fitting instructions are given to the end user or client. These instructions remain the property of Rhino-Rack Australia Pty. Ltd. and may not be used or changed for any other purpose than intended.

Critical Dimensions

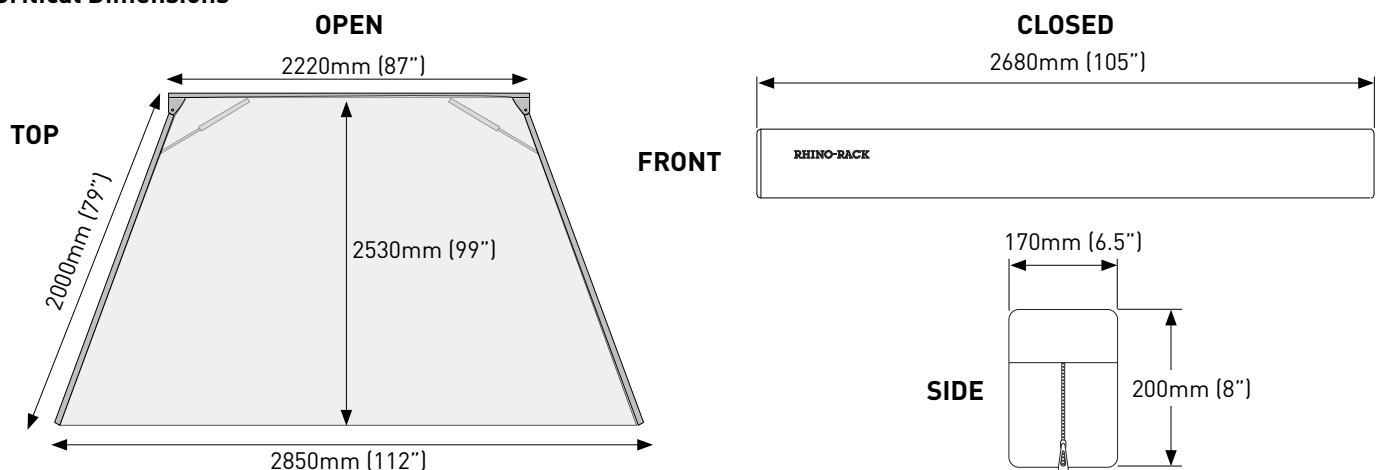

CONTENTS

Installation onto:

Pioneer Platforms	Steps	1 - 5	and	10 - 14
Reconn-Deck Bars	Steps	6 , 9	and	10 - 14
VA	Steps	6 - 7	and	10 - 14
Sportz	Steps	6 , 8	and	10 - 14
Operation	Steps	15 - 22		
Storage	Steps	23 - 29		
Accessories	Steps	30 - 31		

Parts List

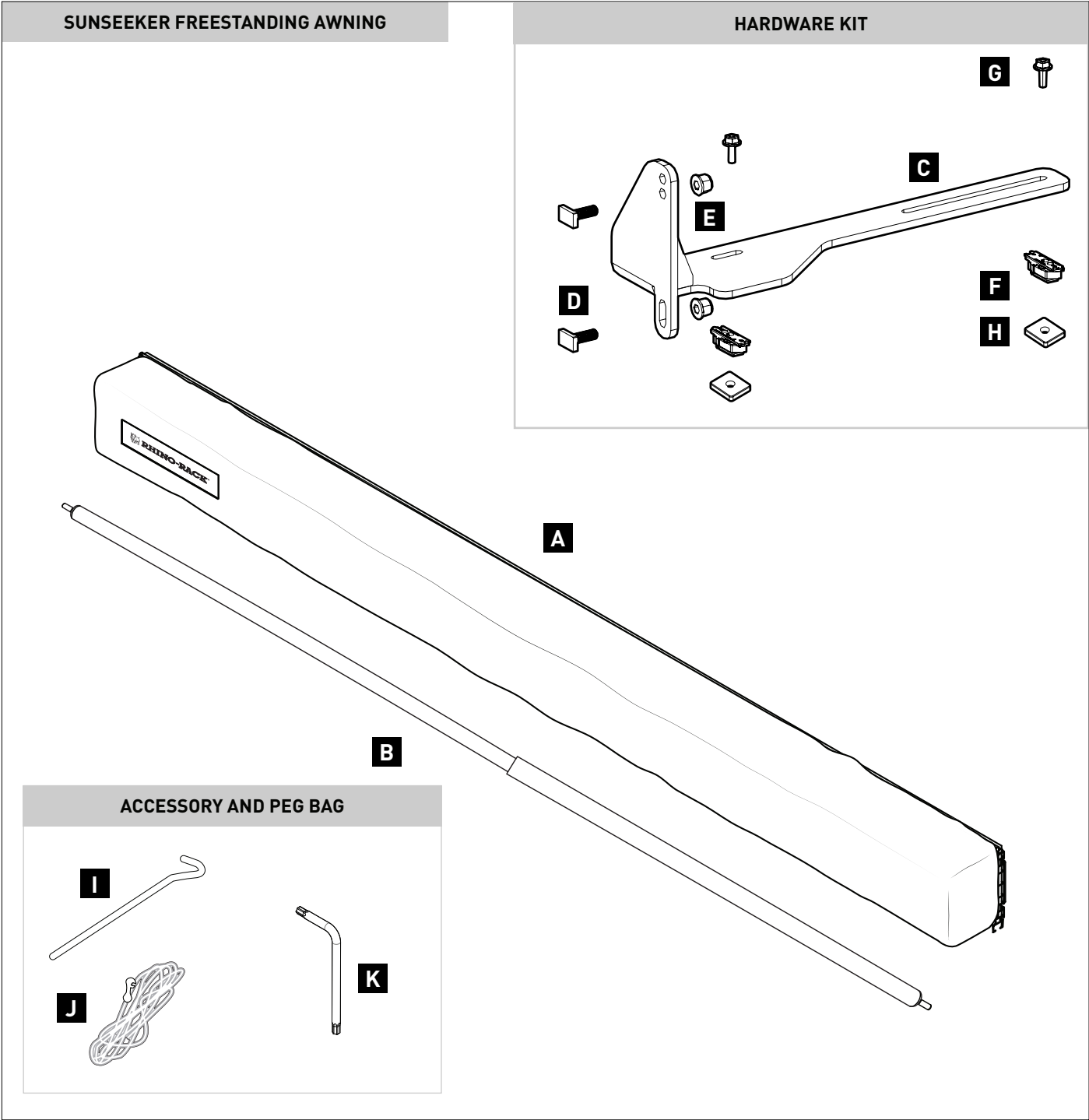

Item	ASSEMBLED SUNSEEKER	Qty
A	180 Awning Main Body	1
B	Extension Pole	1

Item	HARDWARE KITS	Qty
C	Base Bracket	2
D	M8 T-Bolt	4
E	M8 Flanged Nyloc Nut	4
F	Zwifloc Drop-In Nut	4
G	M6 Hex Head Flanged Bolt	4
H	Square Nut	4

Item	ACCESSORY + PEG BAG	Qty
I	Metal Peg	3
J	Guy Rope	3
K	Torx Key (T30)	1

TOOLS REQUIRED:
T1 - Step Ladder
T2 - Tape Measure
T3 - 10mm & 13mm Spanner
(or Socket wrench)

NOTE

The bracket can be used in two configurations: **HIGH** or **LOW**, (depending on *personal preference*)

For the purpose of this instruction, installation is shown in the **HIGH** configuration.

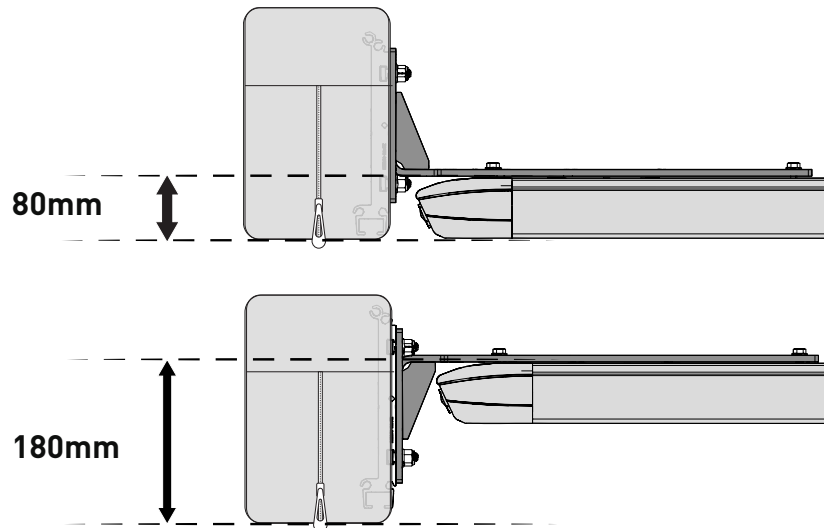

NOTE: Example depicts Pioneer Platforms. Also applies to Cross Bars

For **crossbars**, ensure the distance between the **front and rear bars** (or bars used for mounting) falls within the below bar spacing.

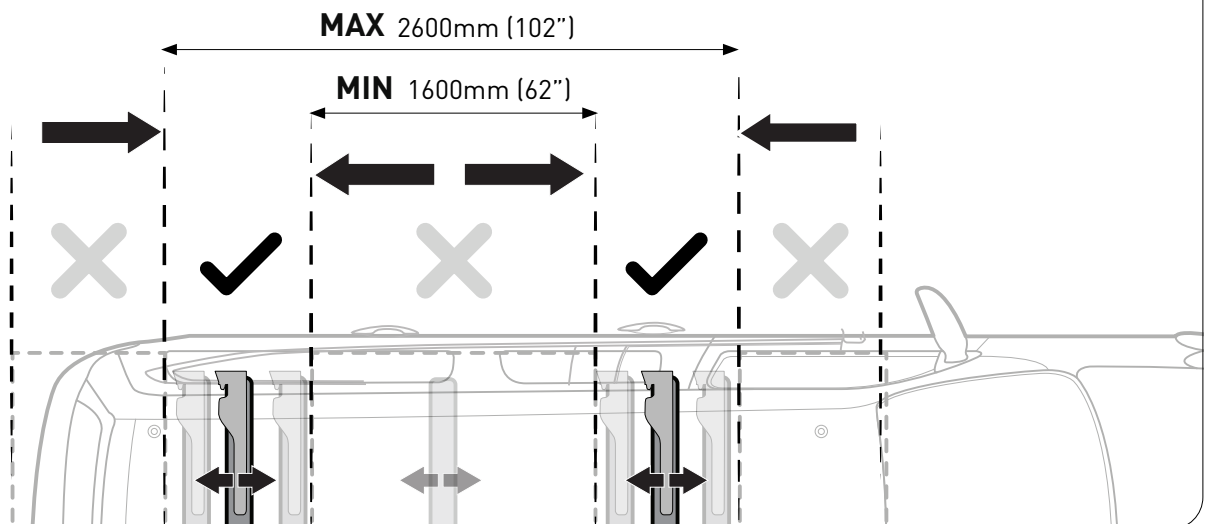

For Installation onto PIONEER PLATFORMS

(For Crossbars, skip to Step **6**)

1

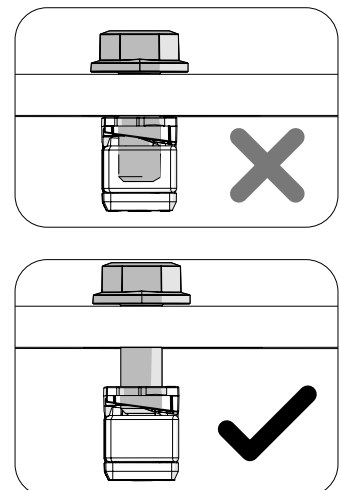
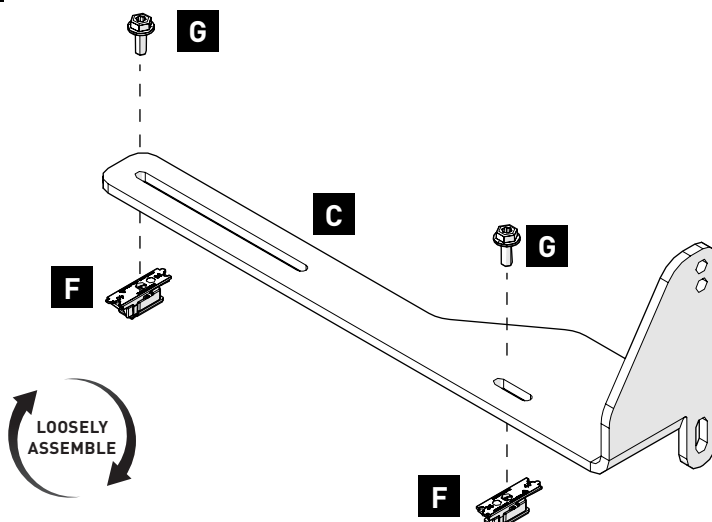

2

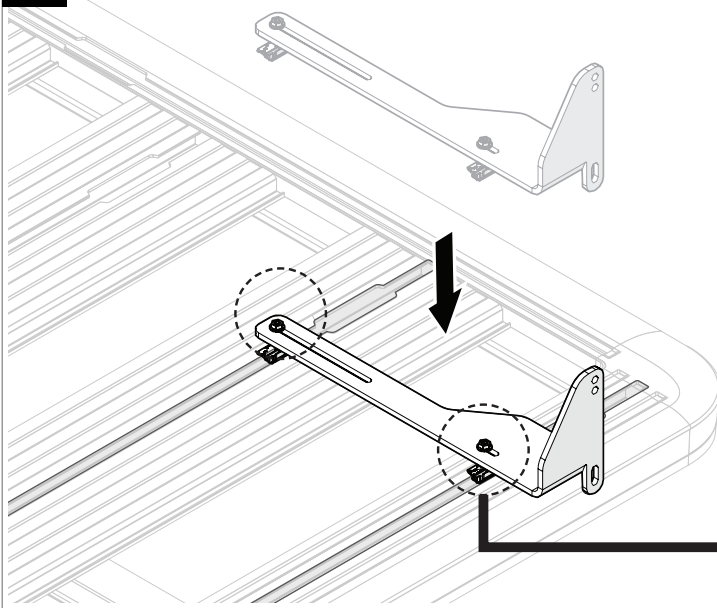

UNLOCKED

F

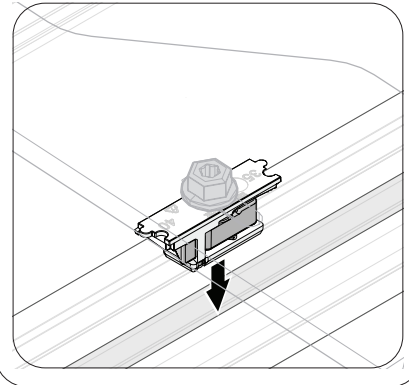
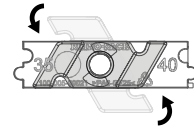

3

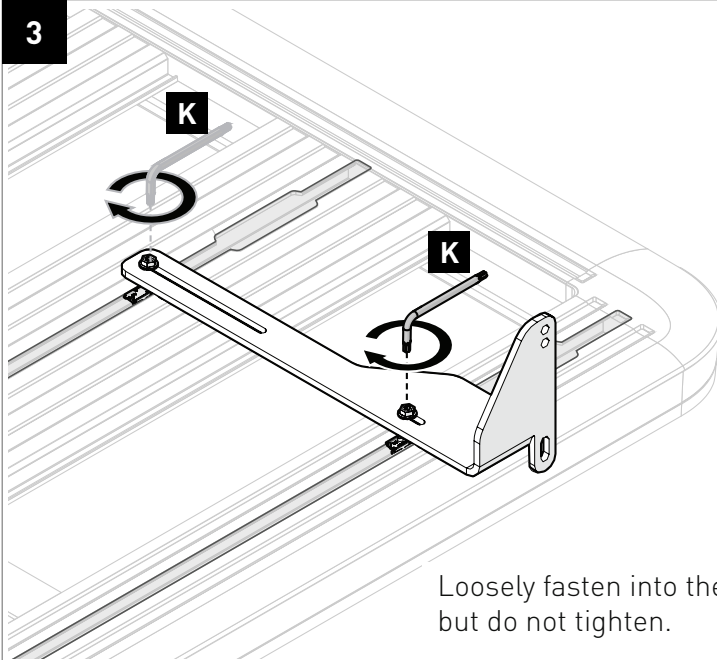

Loosely fasten into the channel,
but do not tighten.

LOCKED

F

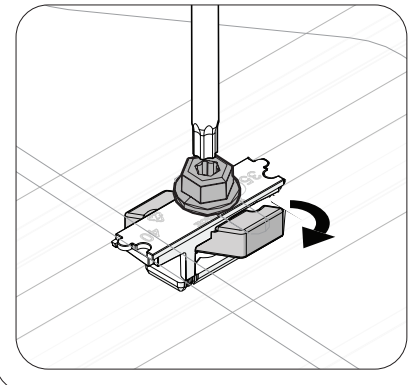
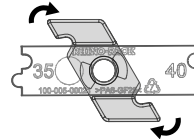

4

Move brackets to outermost edges of Platform, **avoiding channel apertures.**

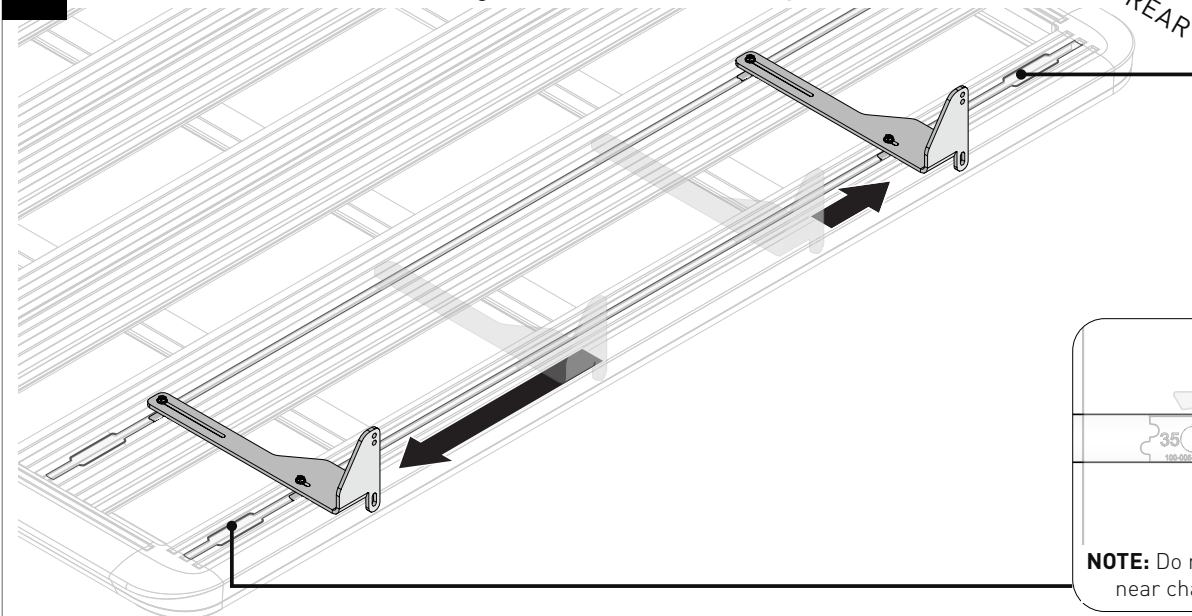

NOTE: Do not place bracket
near channel opening

5

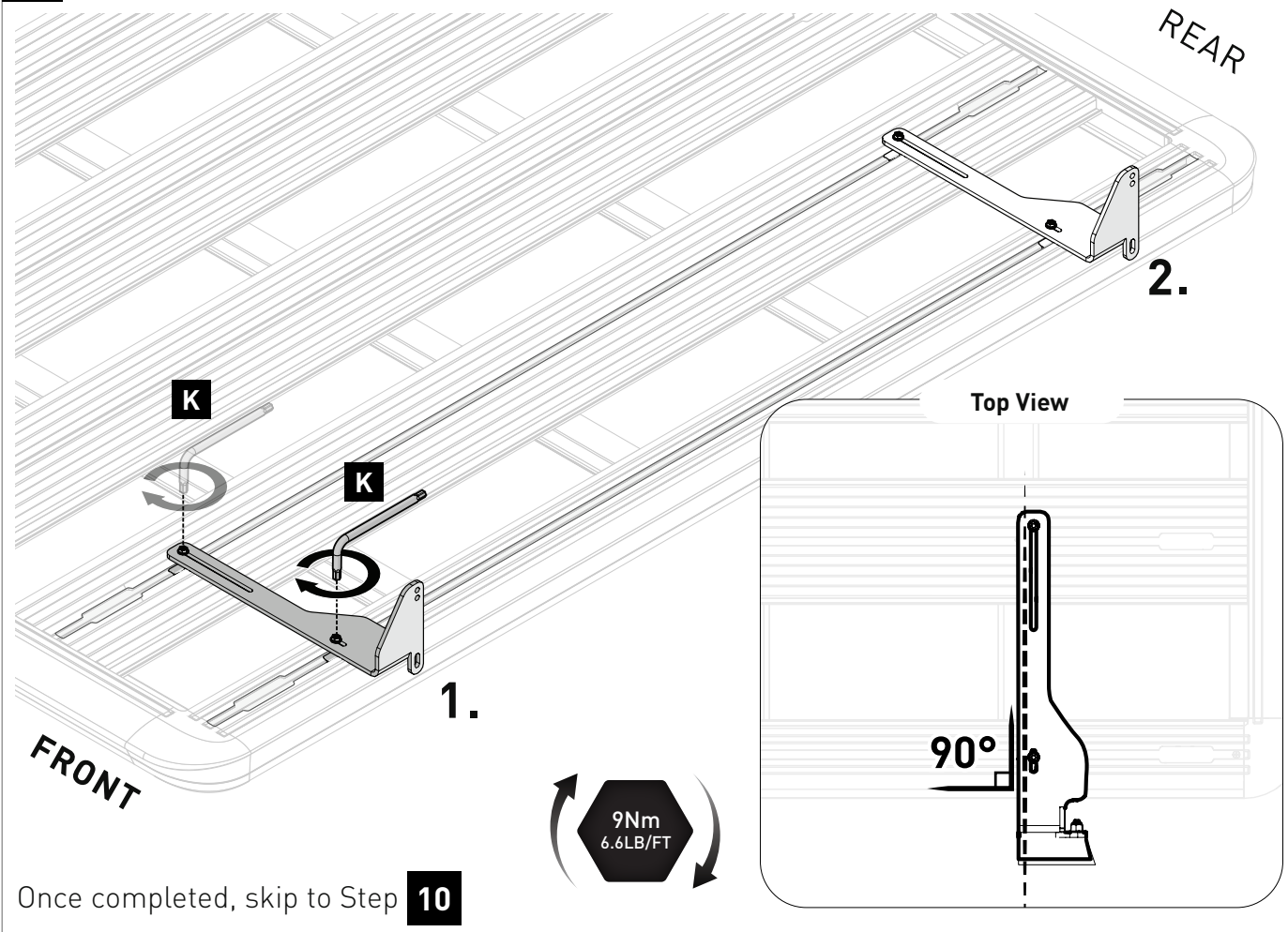

FOR INSTALLATION ONTO CROSSBARS

(For Platforms Skip to Step 10)

6

NOTE

For **crossbars**, ensure the distance between the **front and rear bars** (or bars used for mounting) falls within the required bar spacing.

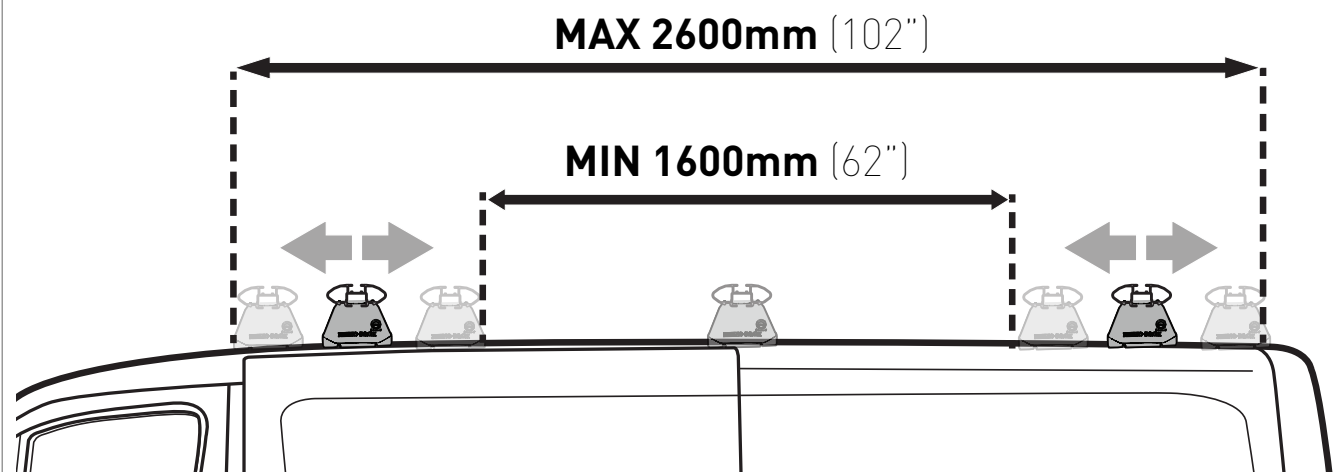

7

VORTEX CROSSBAR:

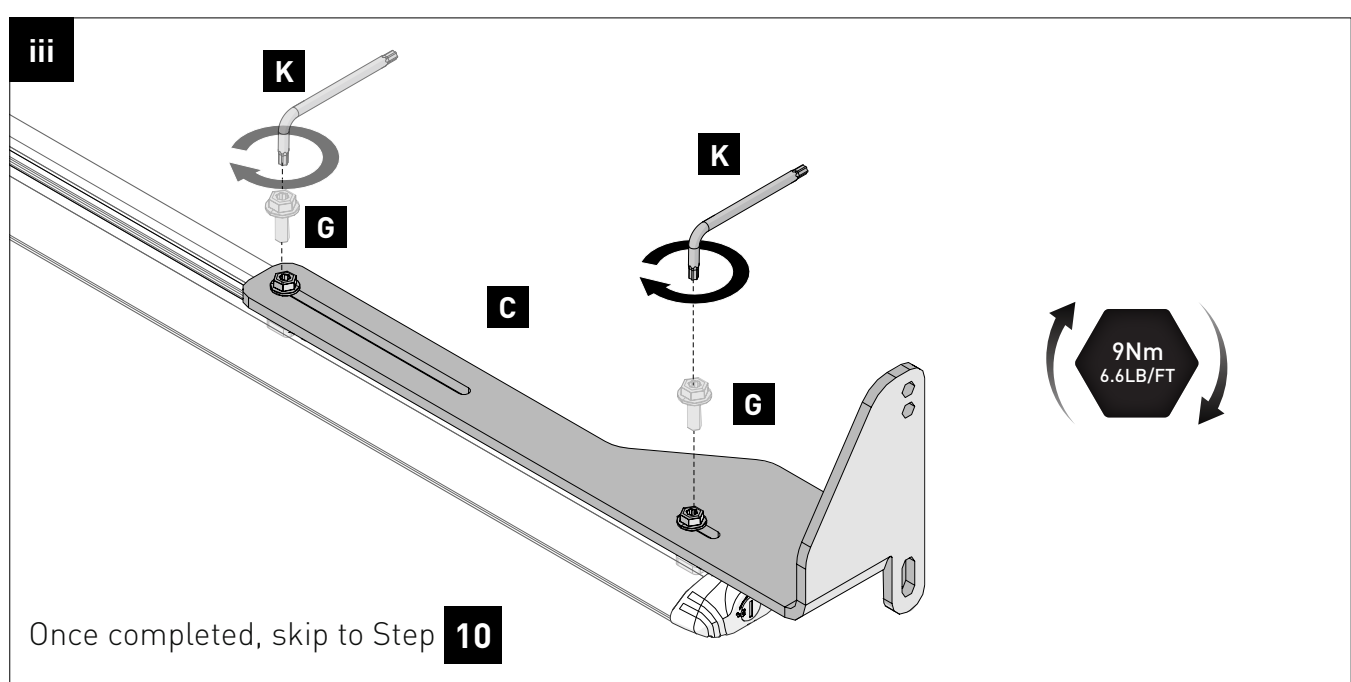
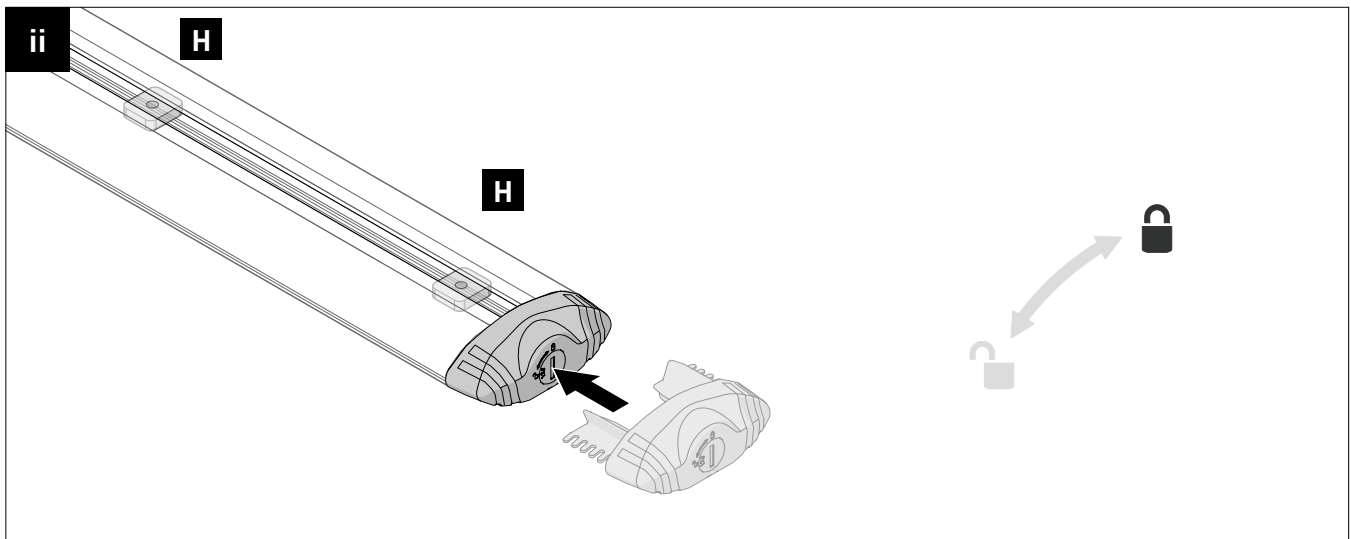
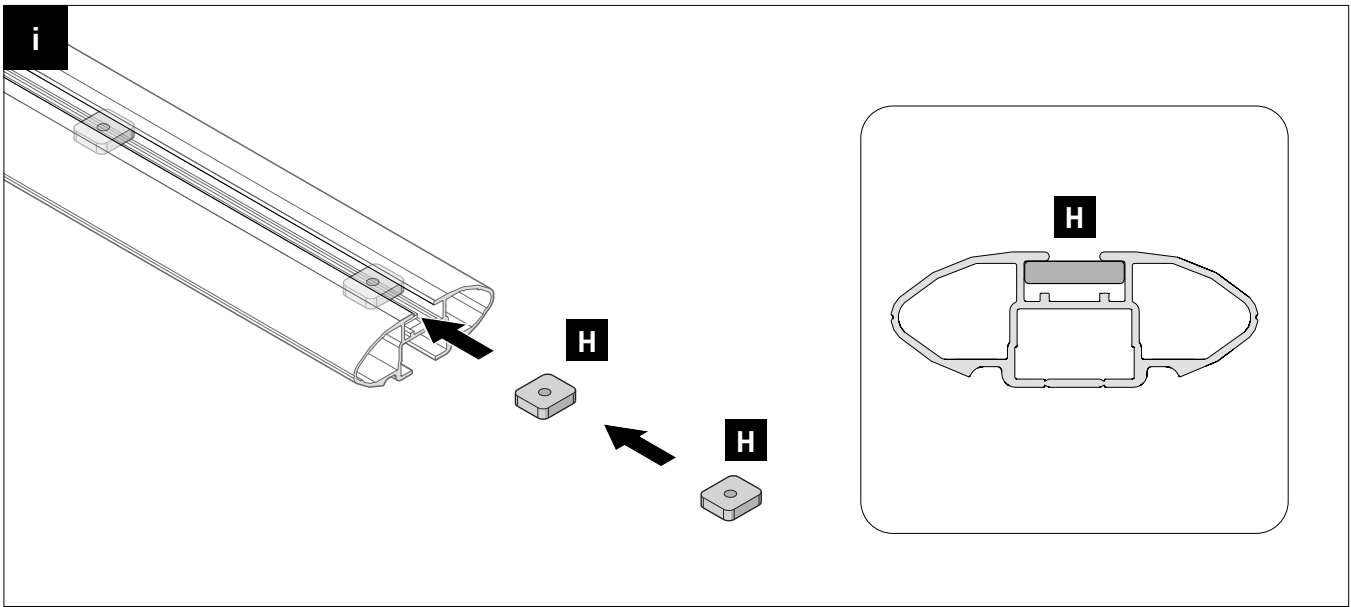

8

SPORTZ CROSSBAR:

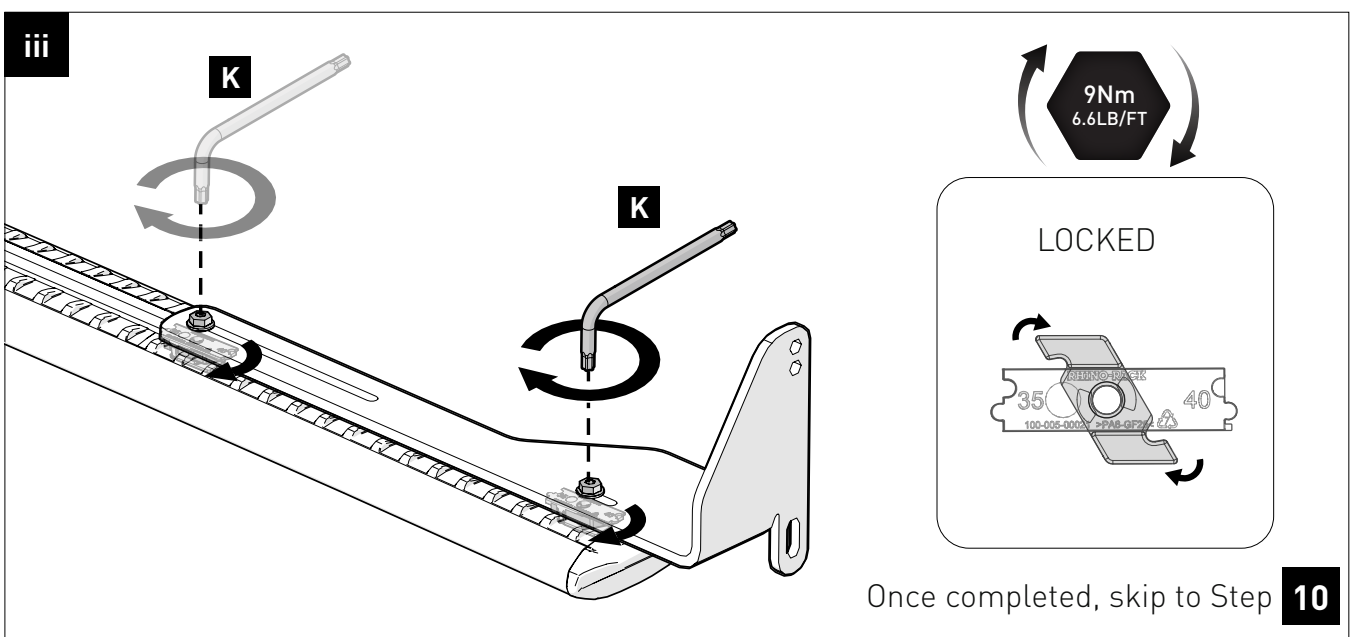
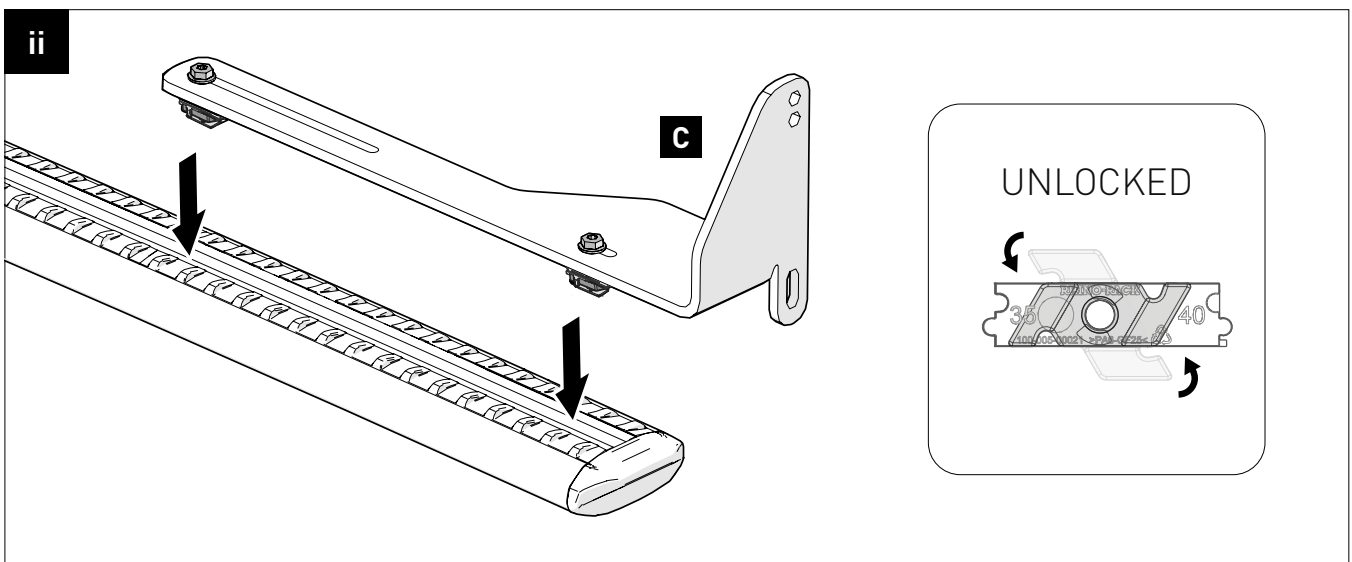
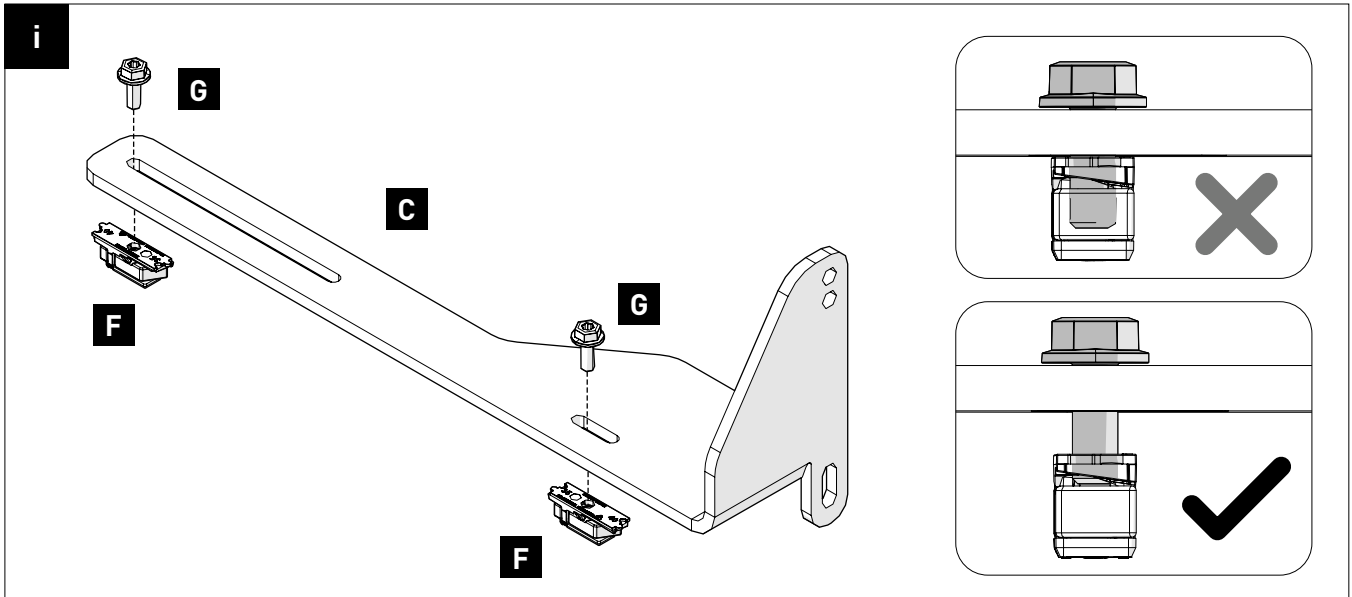
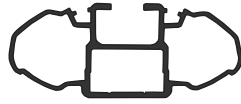

9

RECONN-DECK™ CROSSBAR:



i

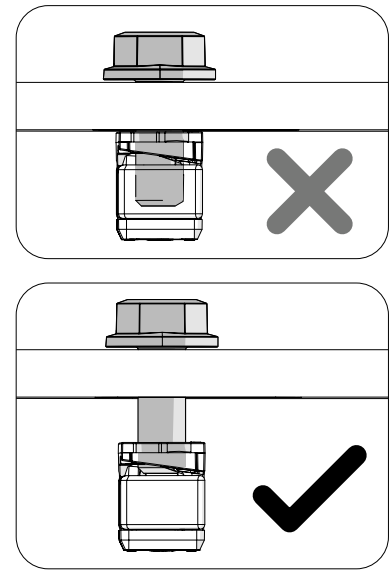
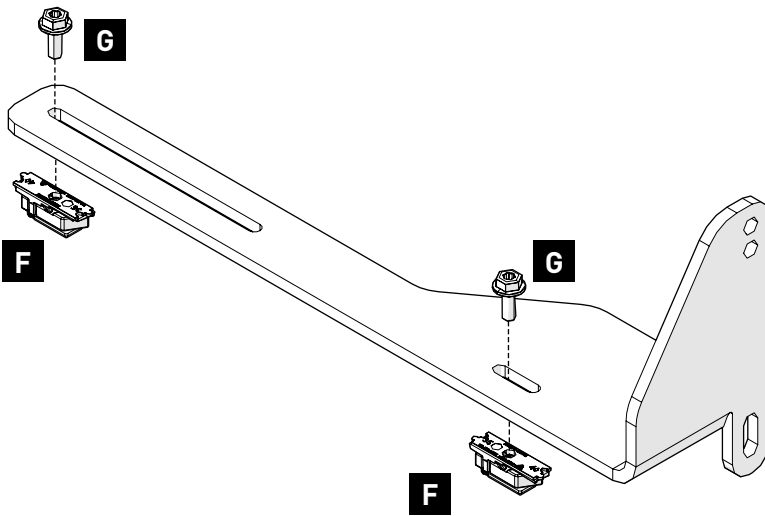

ii

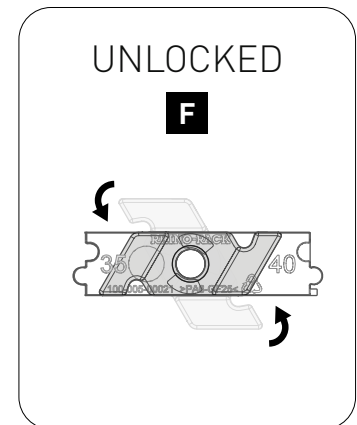
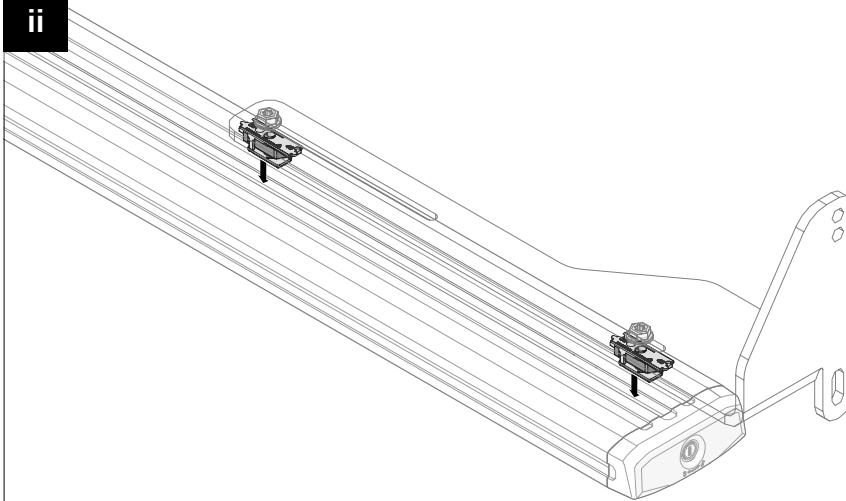

iii

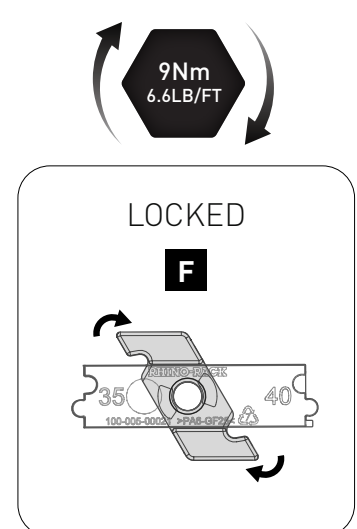
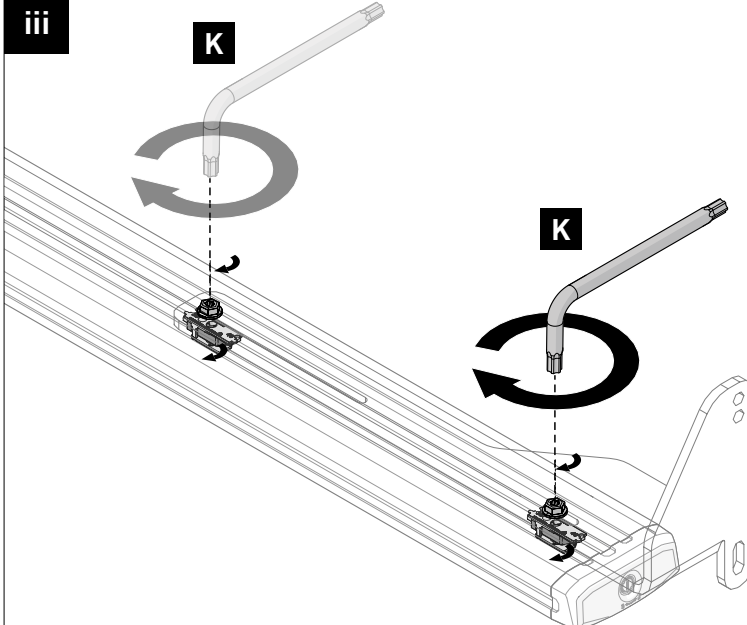

Once completed, skip to Step **10**

10

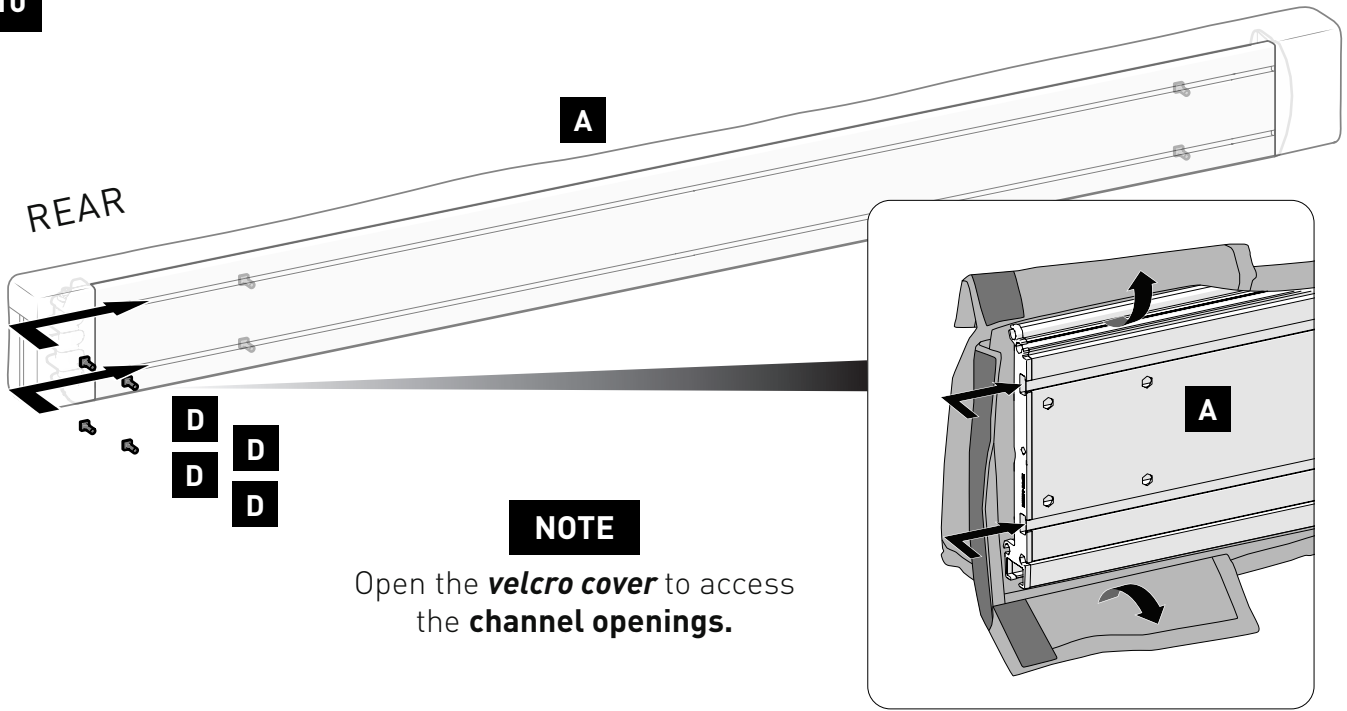

11 Lift awning up to brackets locating **D** bolts in to bracket.



NOTE: Step Ladder may be required for taller vehicles

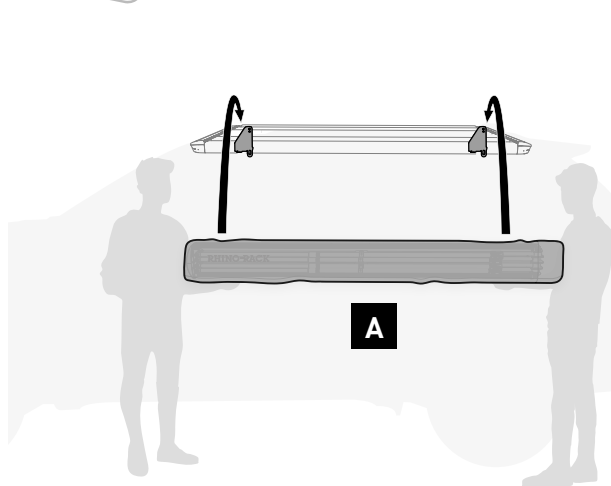
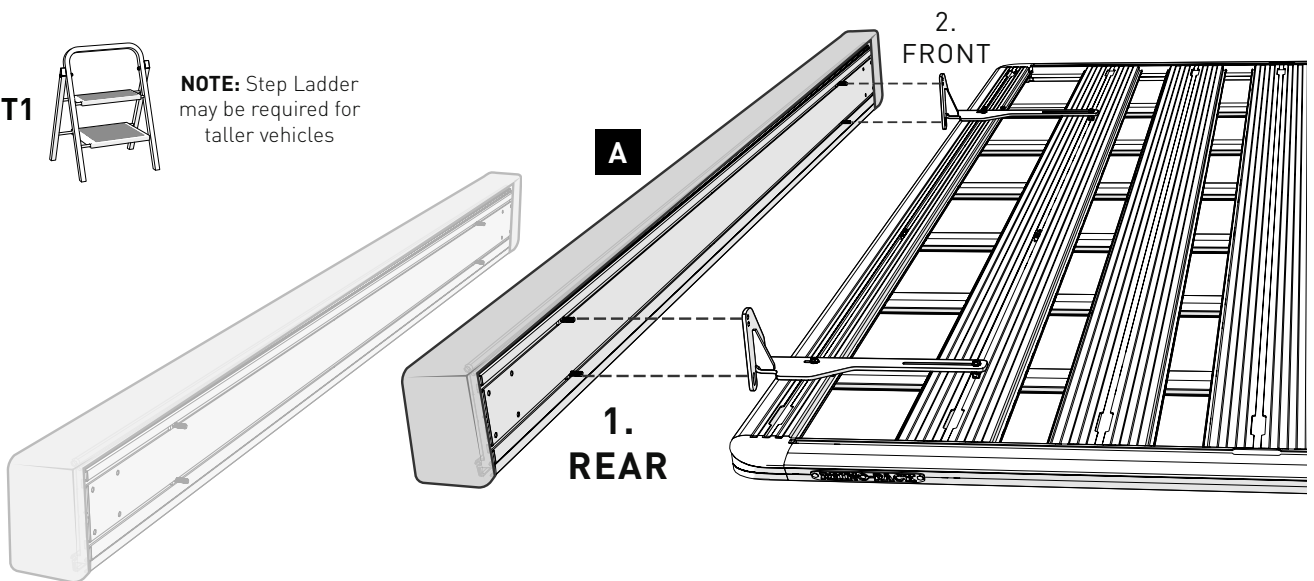

(Also applies to **Crossbar** fits)

12

**IMPORTANT:**

Ensure there is no more than a 700mm overhang from the end of the awning to the center bracket.
Inspect both ends before tightening.

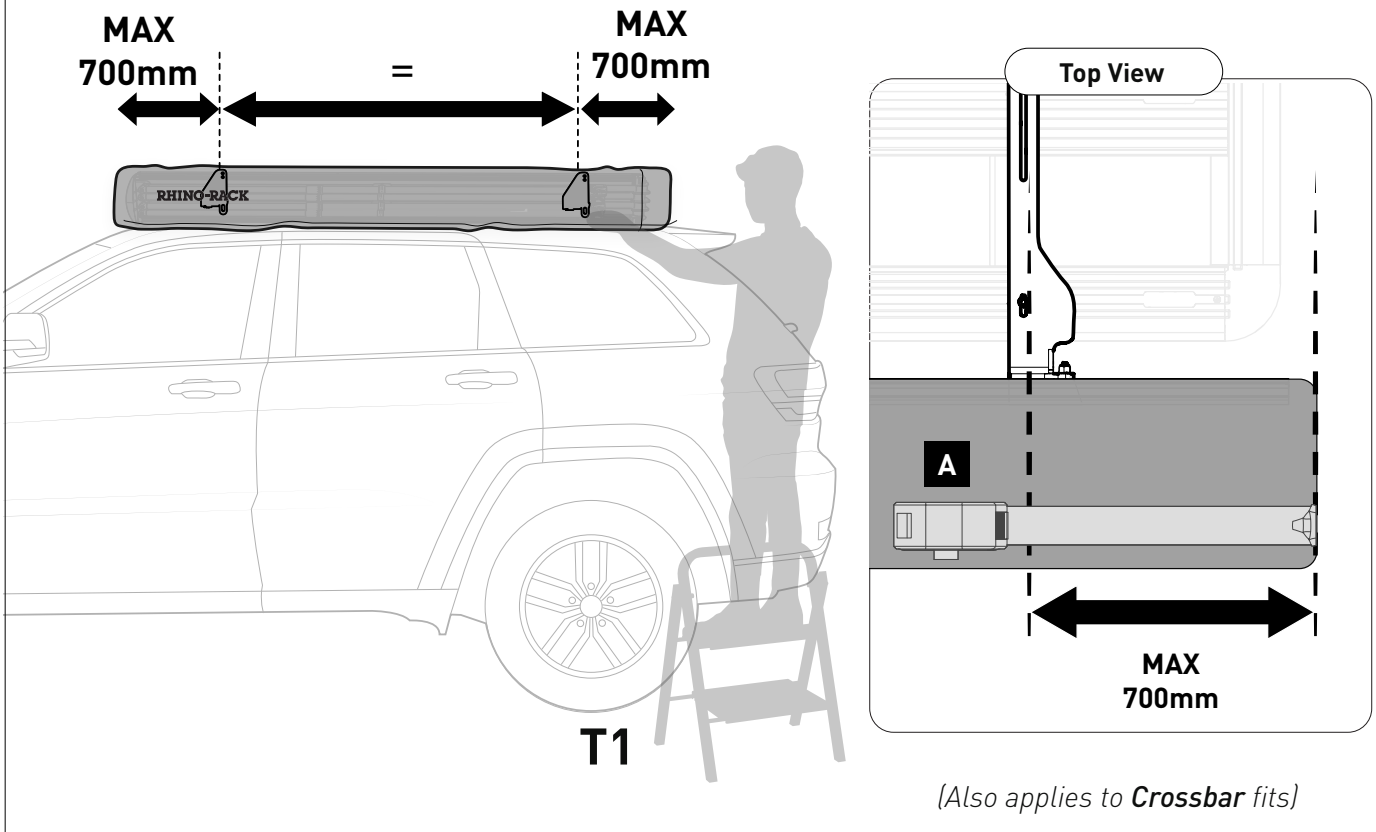

13 Tighten **D** at all 4 locations.

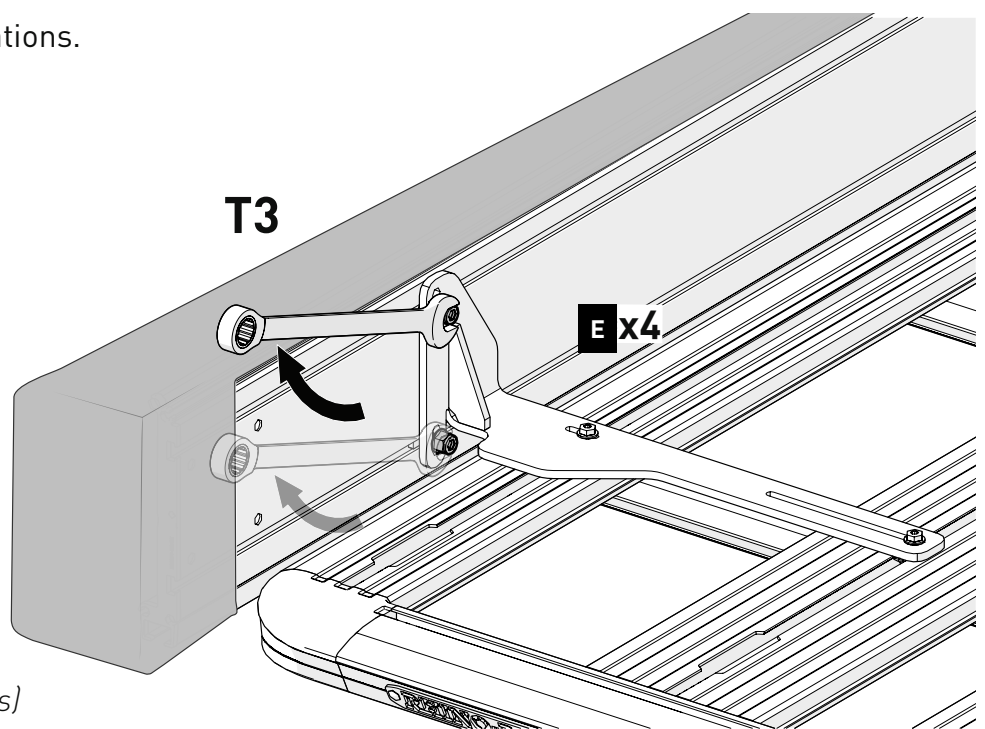

14 *(Also applies to Crossbar fits)*

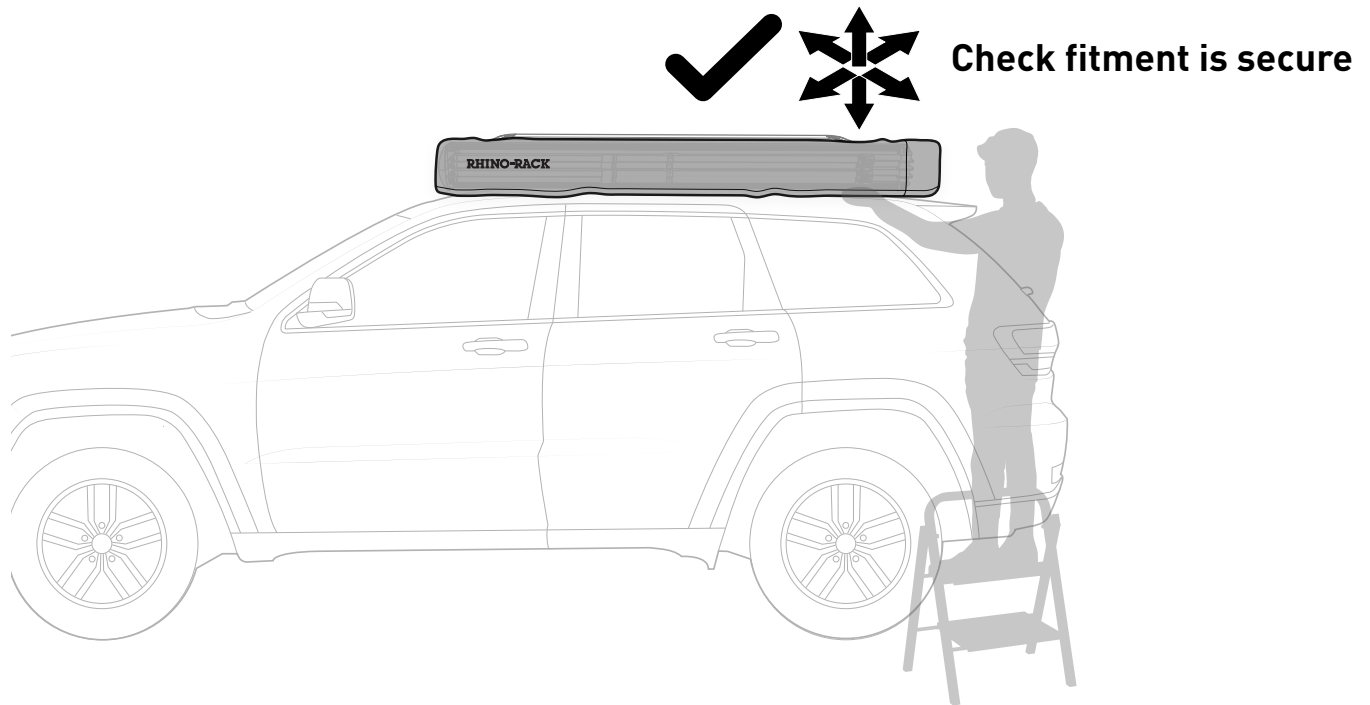

IMPORTANT: Ensure the weight of the awning is correctly supported by the brackets. Failure to check bracket engagement may lead to slippage of the awning and subsequent damage to side of vehicle. **Inspect all three connections overhead before releasing**

270 AWNING OPERATION

15

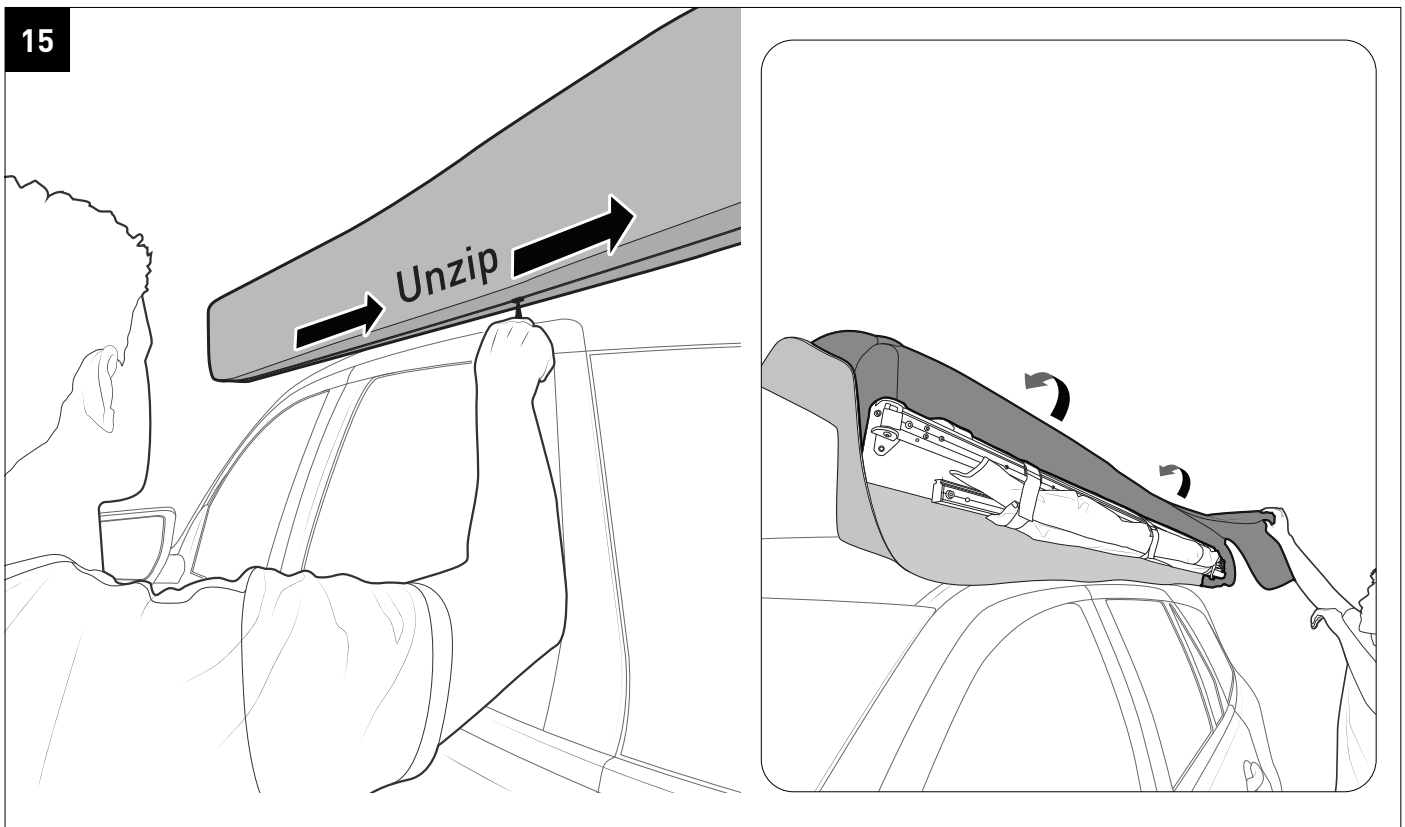

16

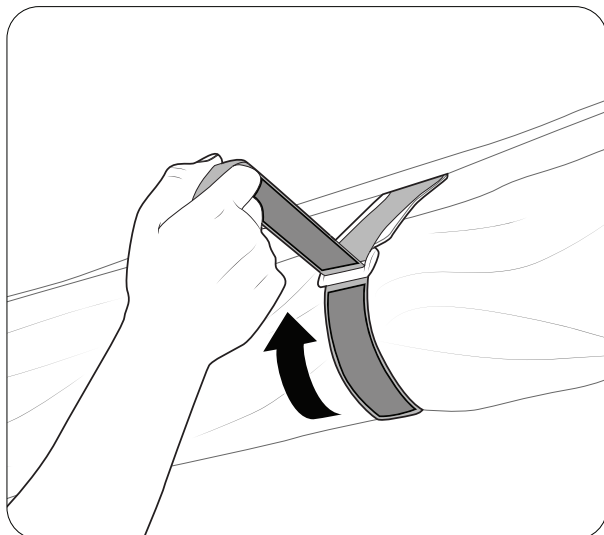
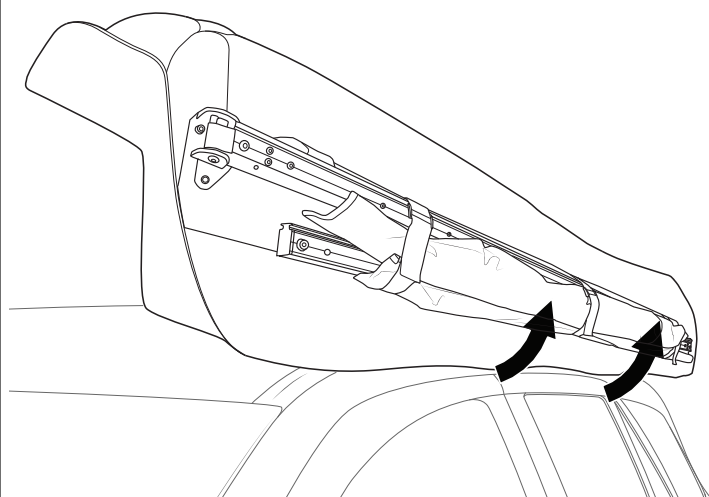

17 Open the **Left** towards the front of the vehicle.

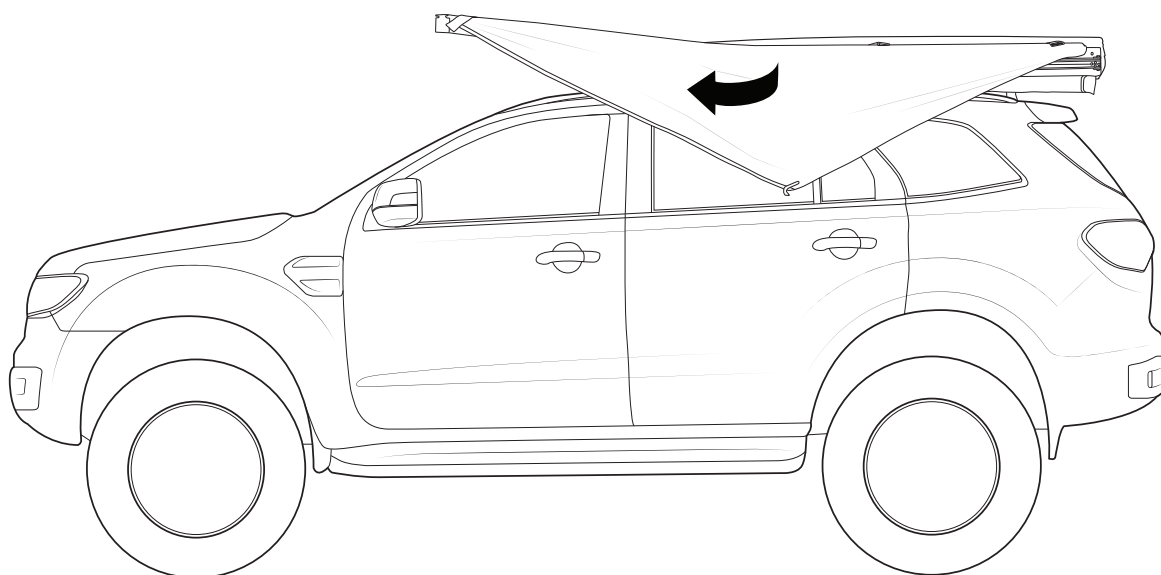

18 Locate the **Right** awning arm underneath the fabric and open towards the rear of the vehicle.

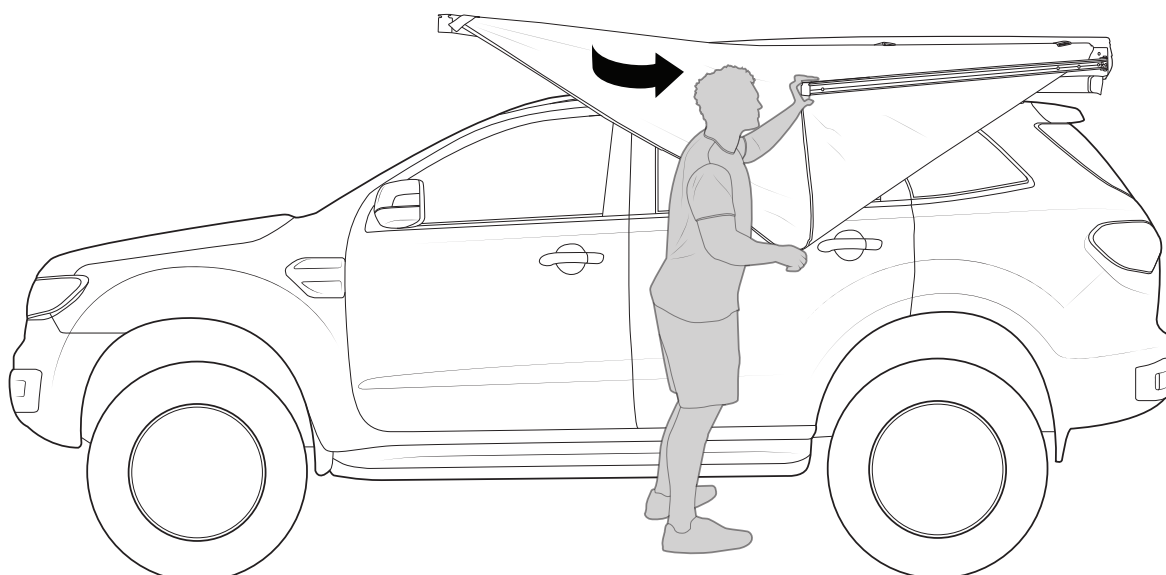

- 19** Find the extension pole in the long pouch under the awning, take it out and twist it to elongate.

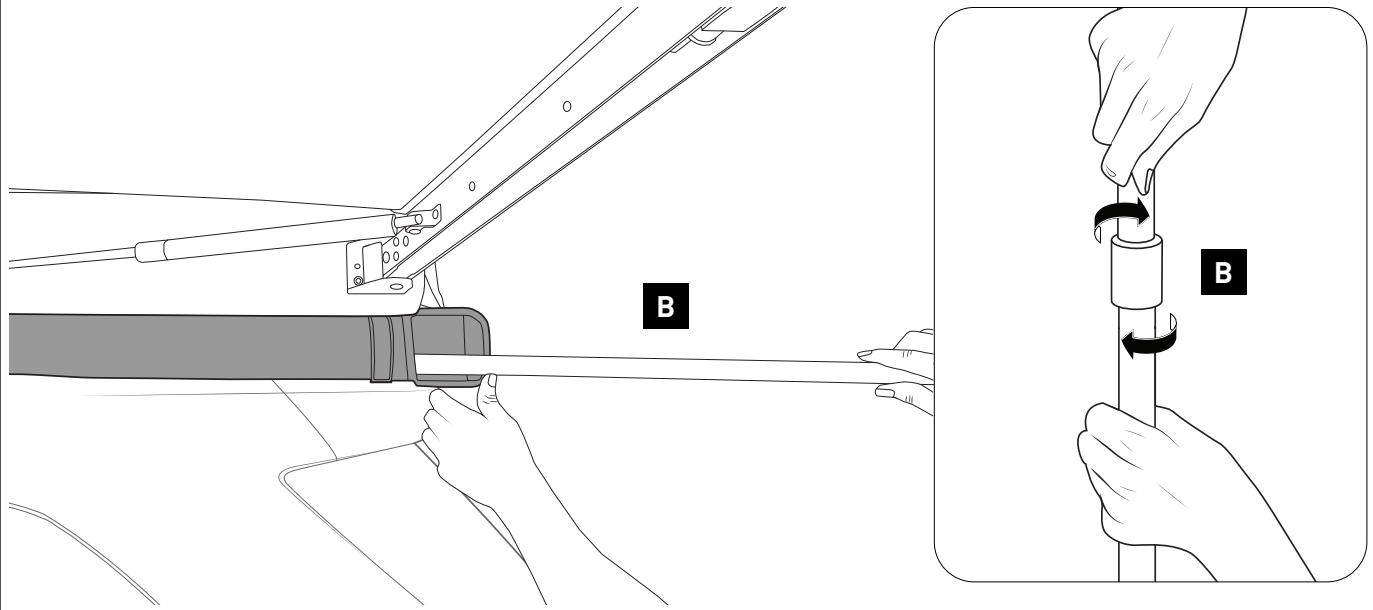

- 20** Attach extension pole to the two holes on the inner surfaces of the awning arms.

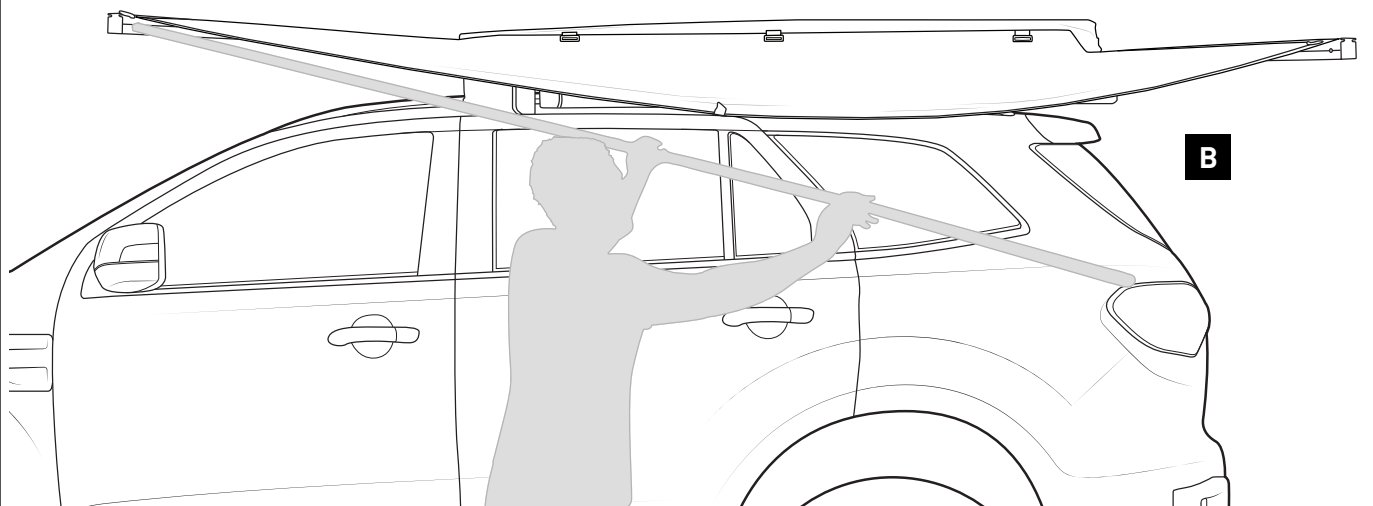

- 21** Twist the extension pole to secure it in place.

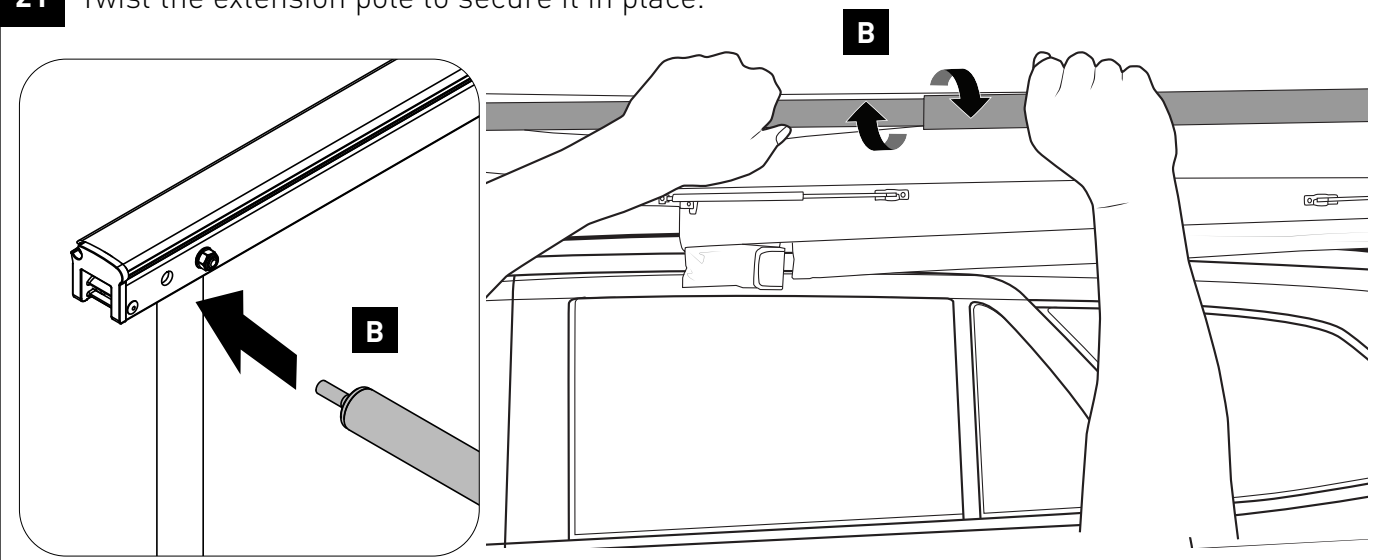

22

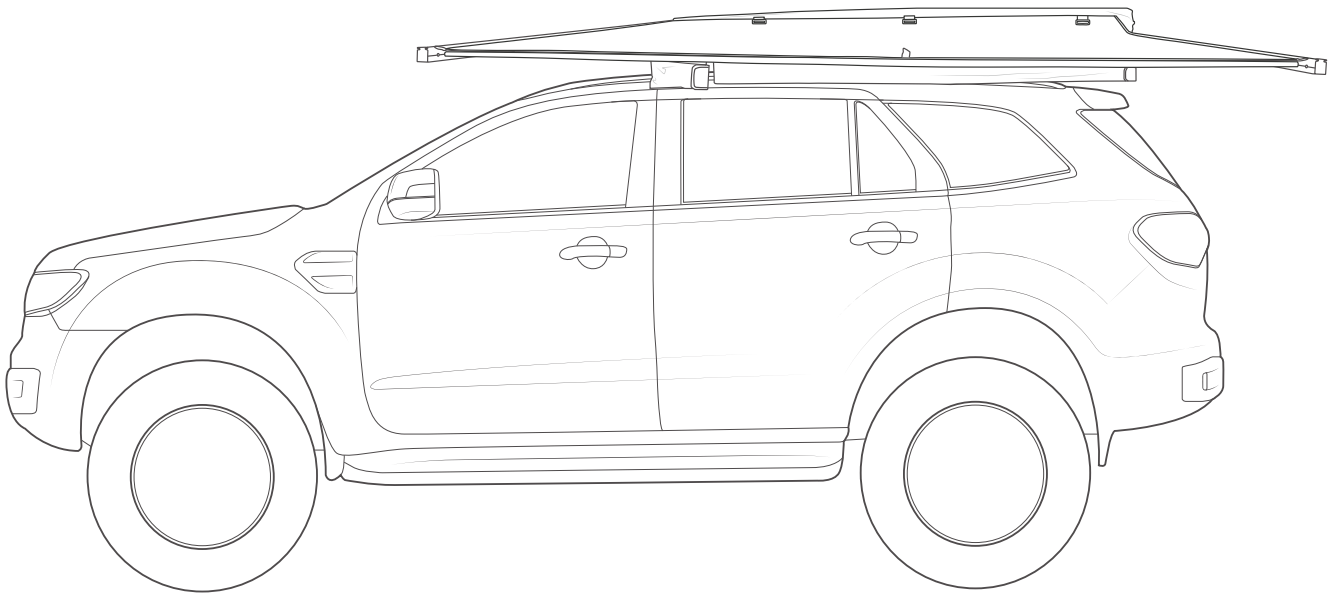

Set up Complete.



Support Pole Deployment (Optional)

(In **windy** or **rainy** conditions, support poles **must be used** to provide stability and prevent damage.)

- i** Lower the support poles located under the awning arms.

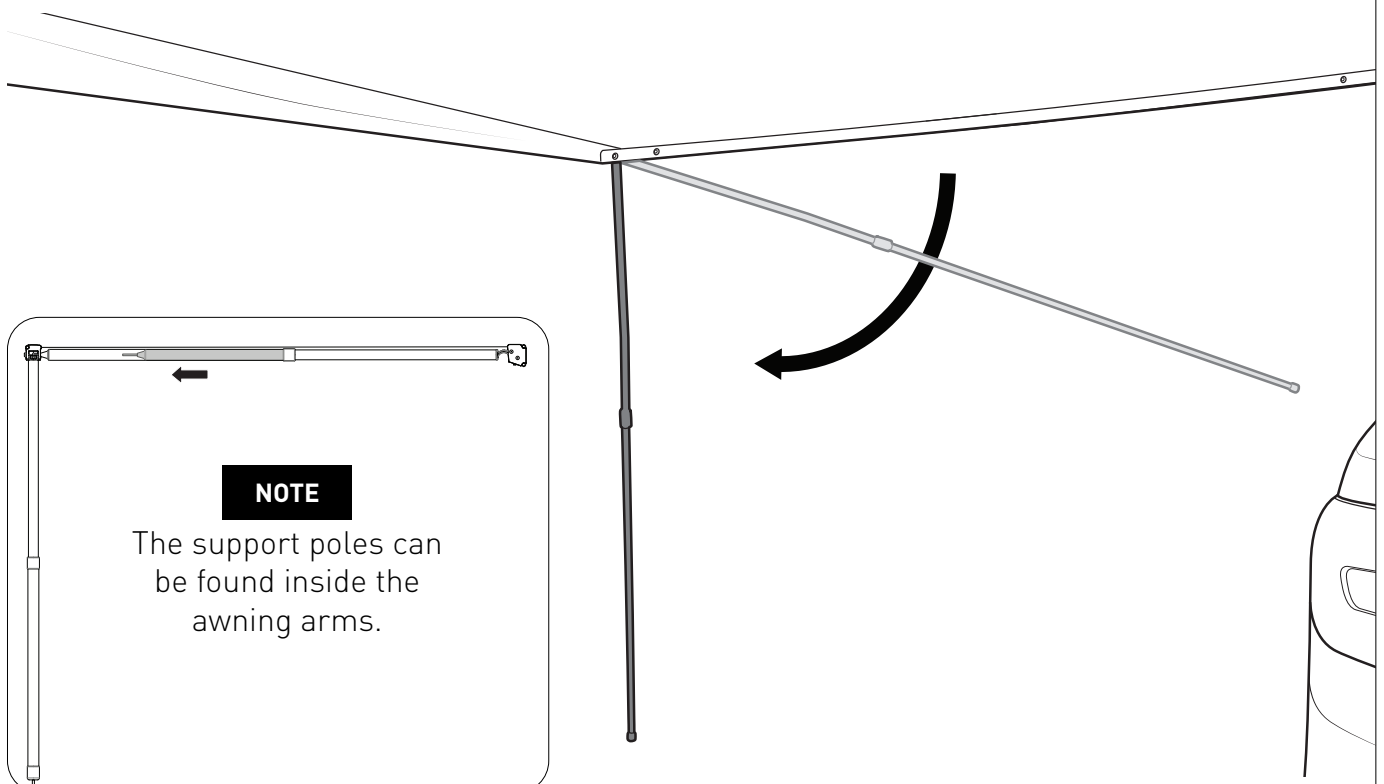

NOTE

The support poles can be found inside the awning arms.

ii Tighten the support poles in place at the selected height.

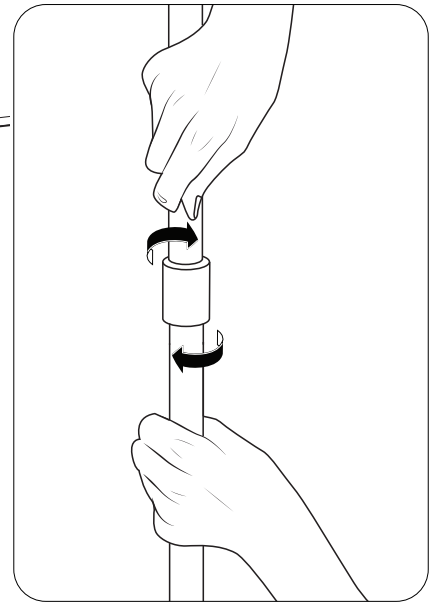
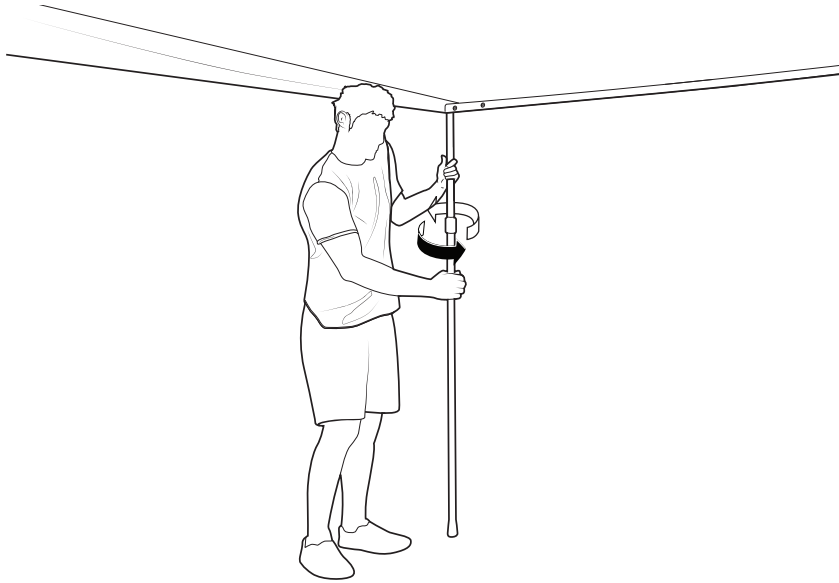

iii

NOTE

Guide ropes are stored in the **accessory bag** attached to the base of the awning.

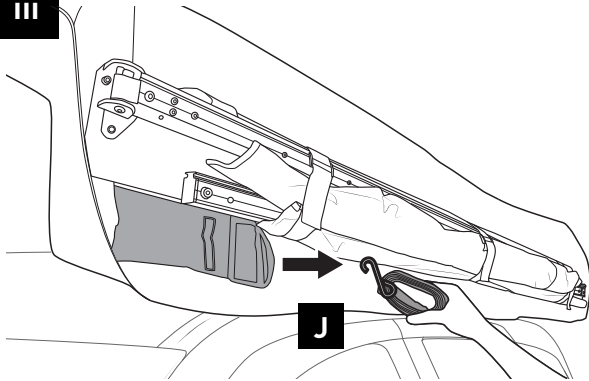

iv Hook the guy ropes to the awning, fixing it in place as shown.

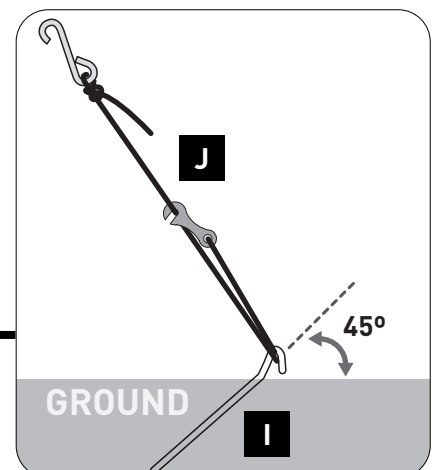
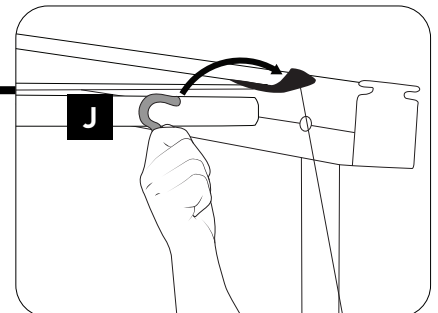
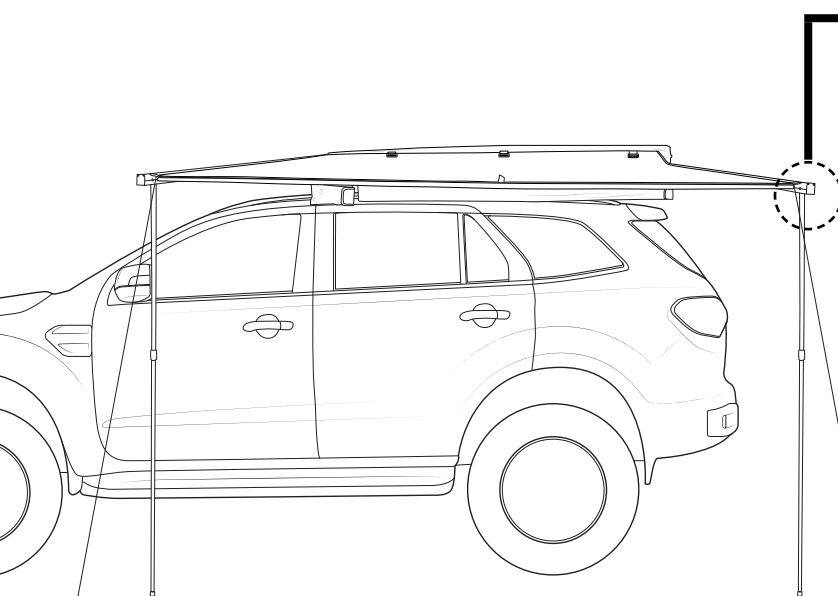

V

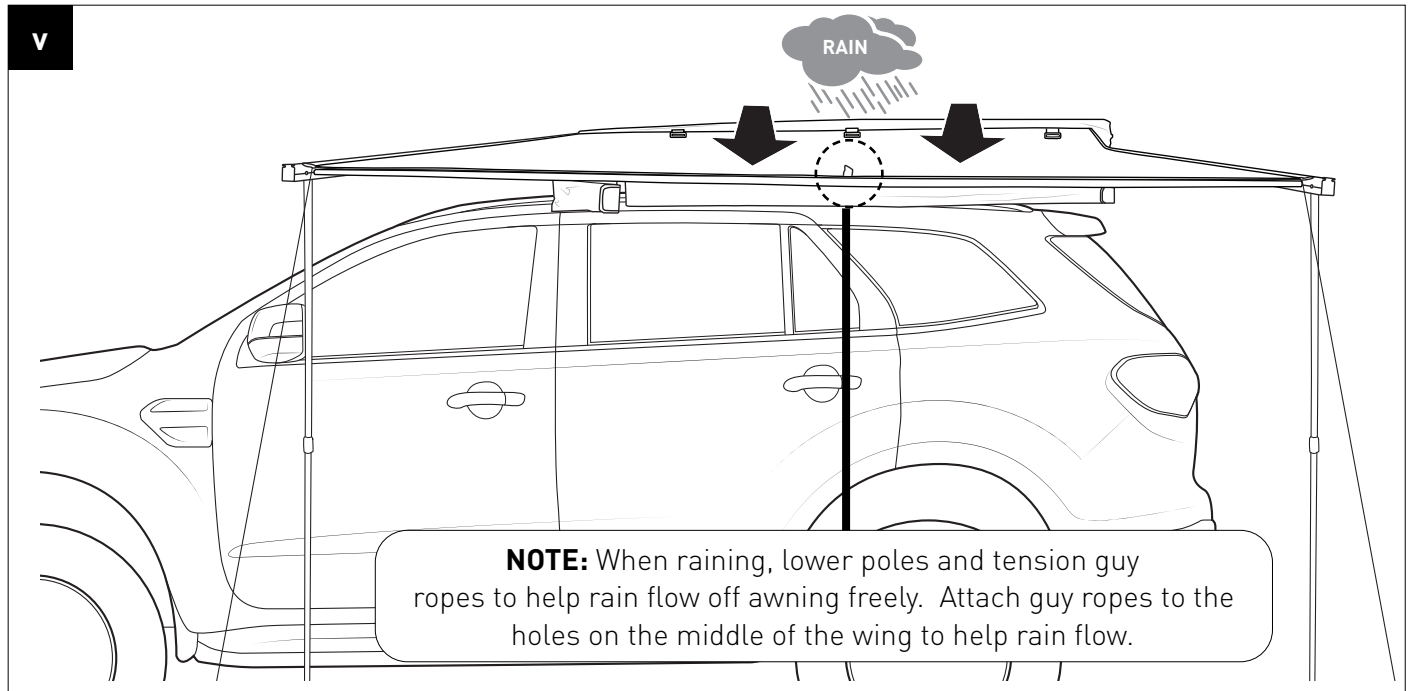

STOWAGE INSTRUCTIONS

(Completion of Steps **15** - **22** in REVERSE order. Use below steps for reference)

- 23** Twist the extension pole to loosen it from its place.

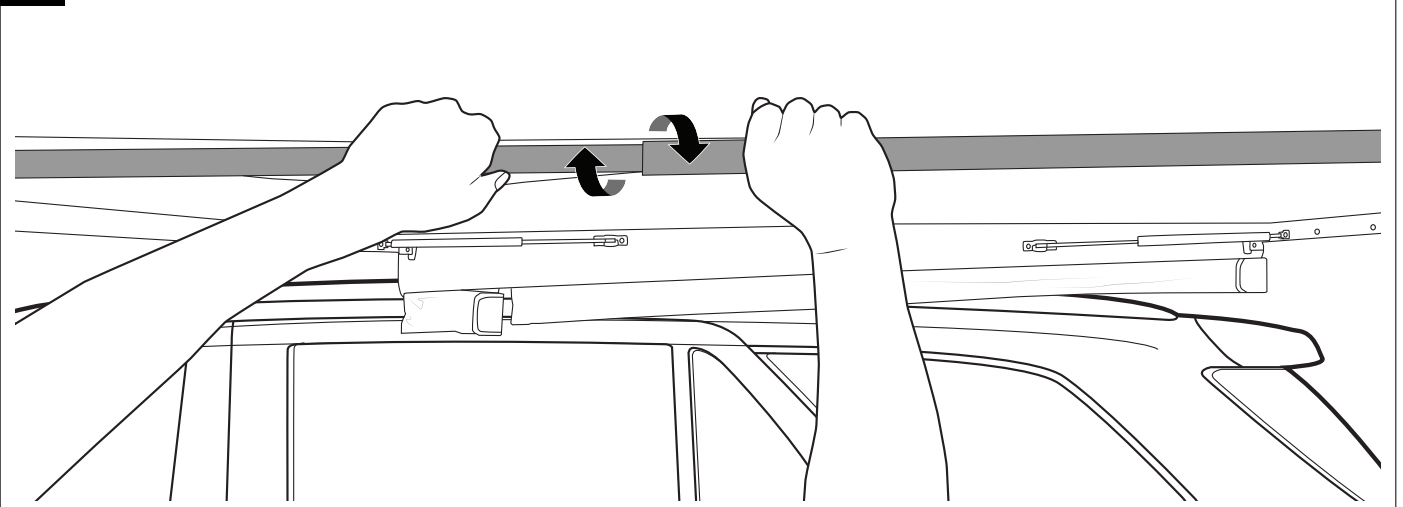

- 24** Detach extension pole from the two holes on the inner surfaces of the awning arms.

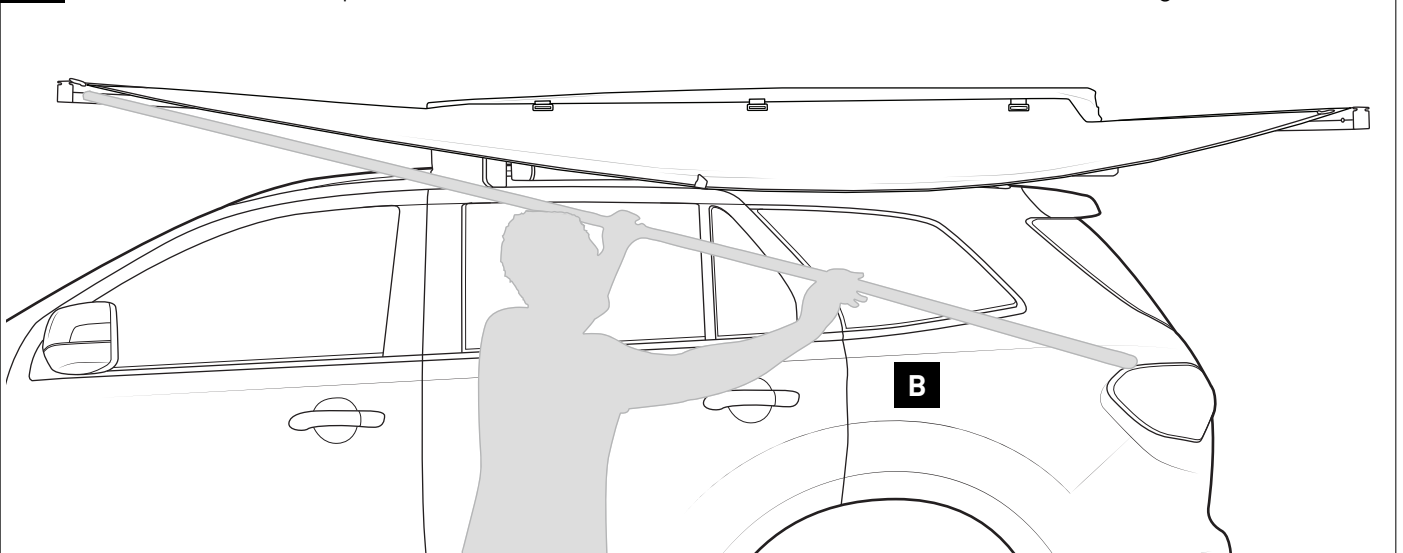

- 25** Twist the extension pole to shorten, then replace it in the long pouch under the awning.

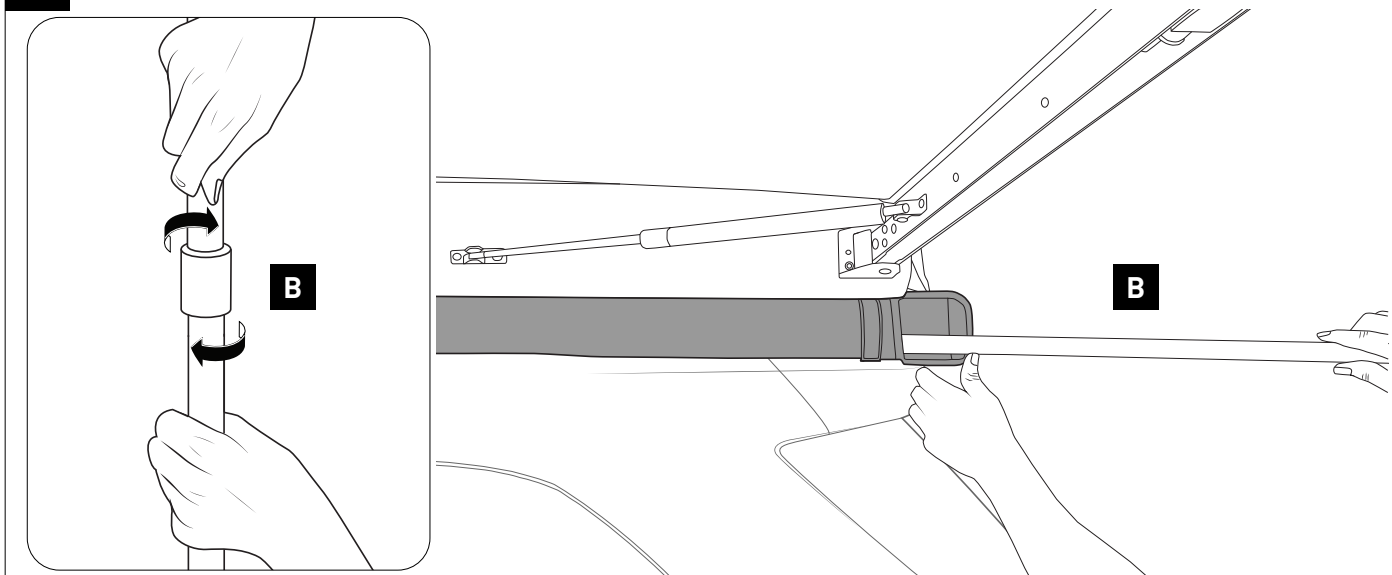

- 26** Close the **Right** awning arm towards the front of the vehicle.

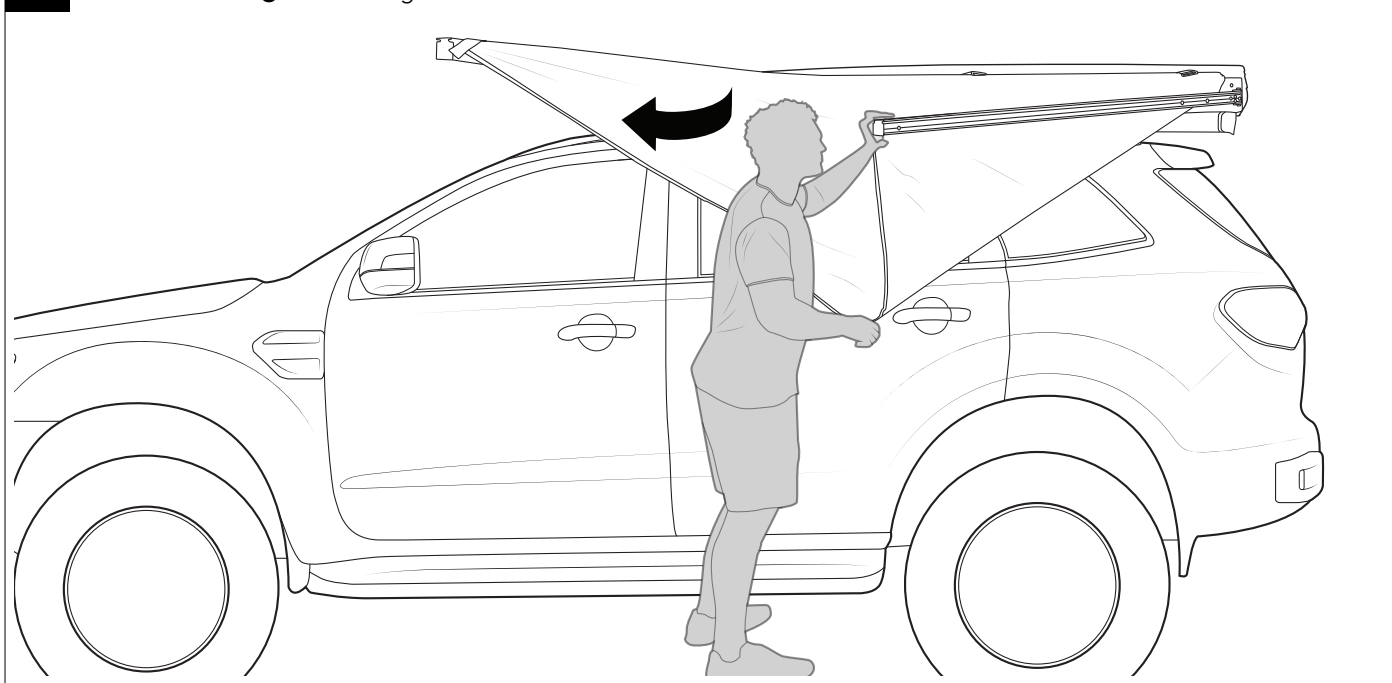

- 27** Close the **Left** awning arm towards the rear of the vehicle.

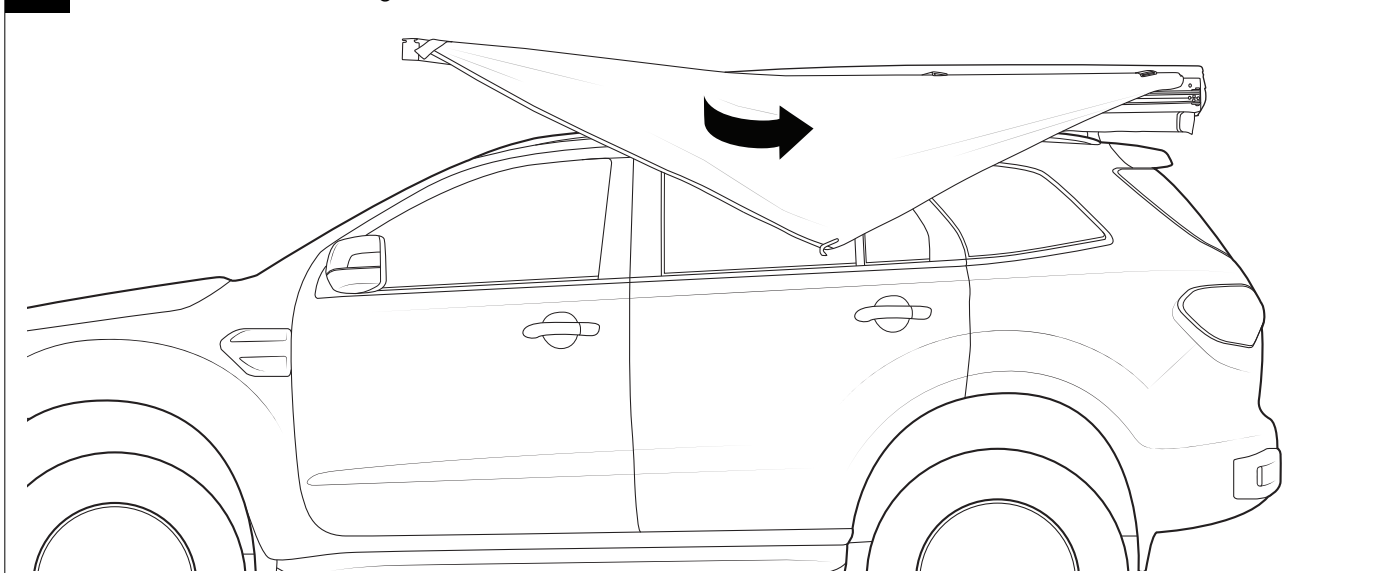

28a Fold the awning material in half.

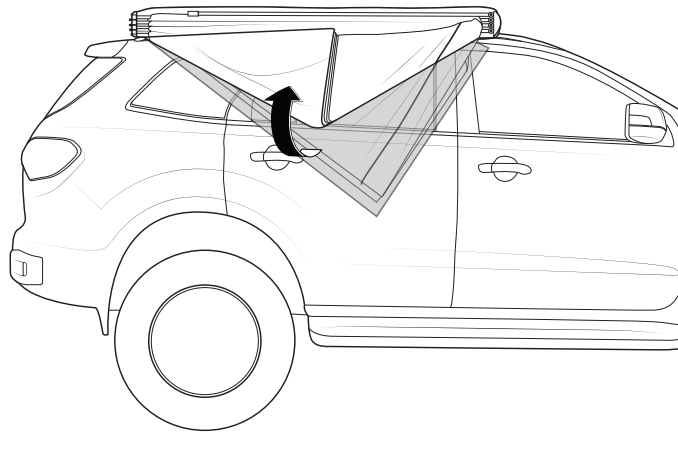

28b Roll the material from the front edge back up into its original setting.

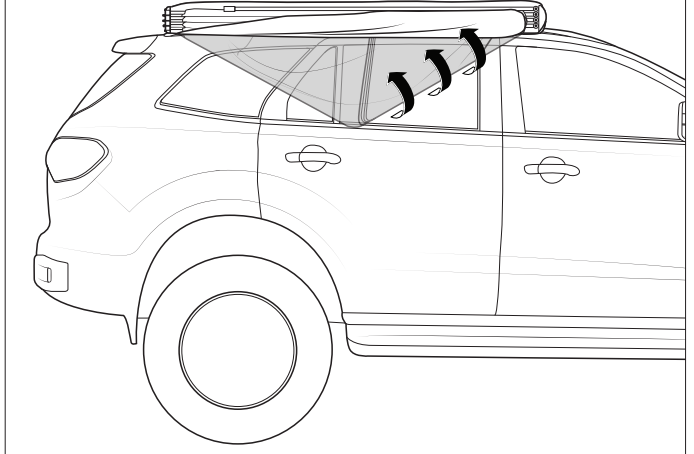

28c

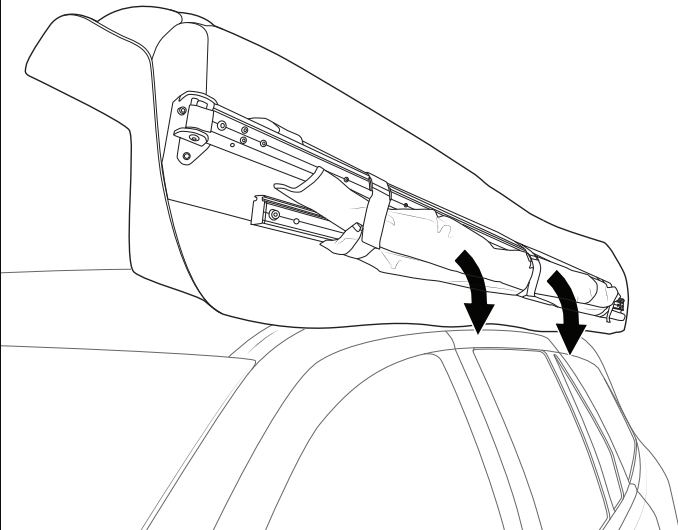

28d

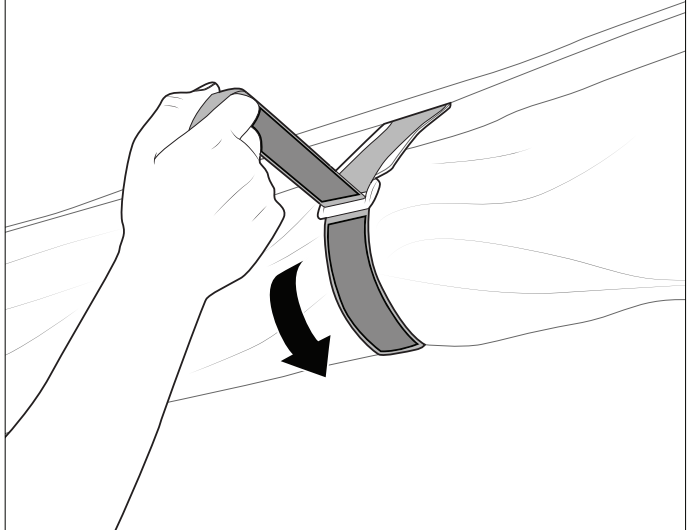

29 Replace the metal pegs and guy ropes to the accessory bag. Zip the outer bag closed.

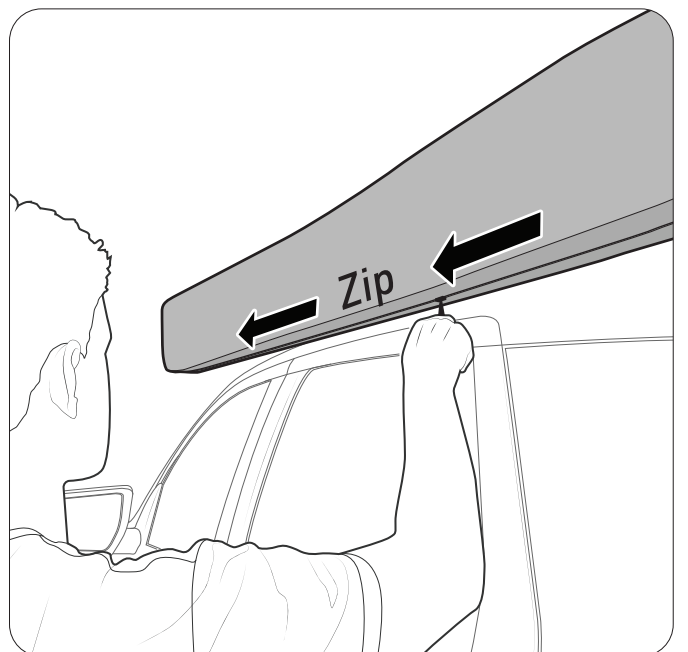
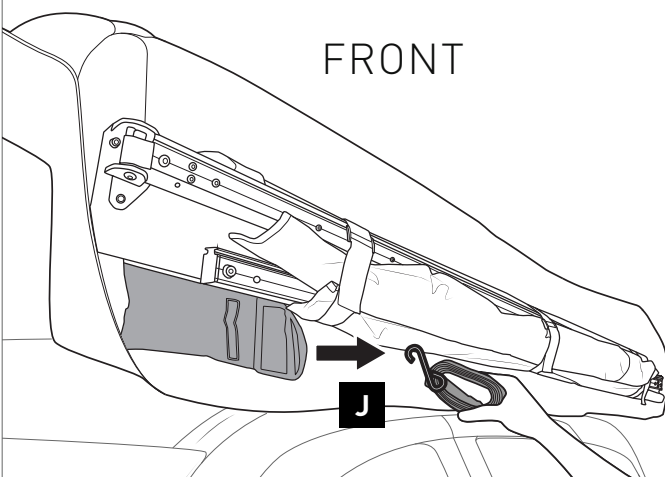

ACCESSORIES

- 30** Accessory channel located at the bottom of the base extrusion.

ZWIFLOC™

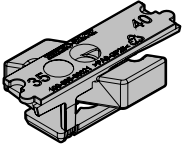

COMPATIBLE

SIDE VIEW

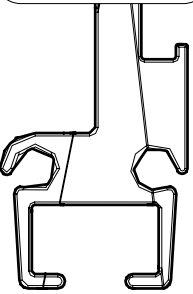

Additional eye bolt/Zwifloc not included.

- 31** Light mounting holes are located on the base extrusion.

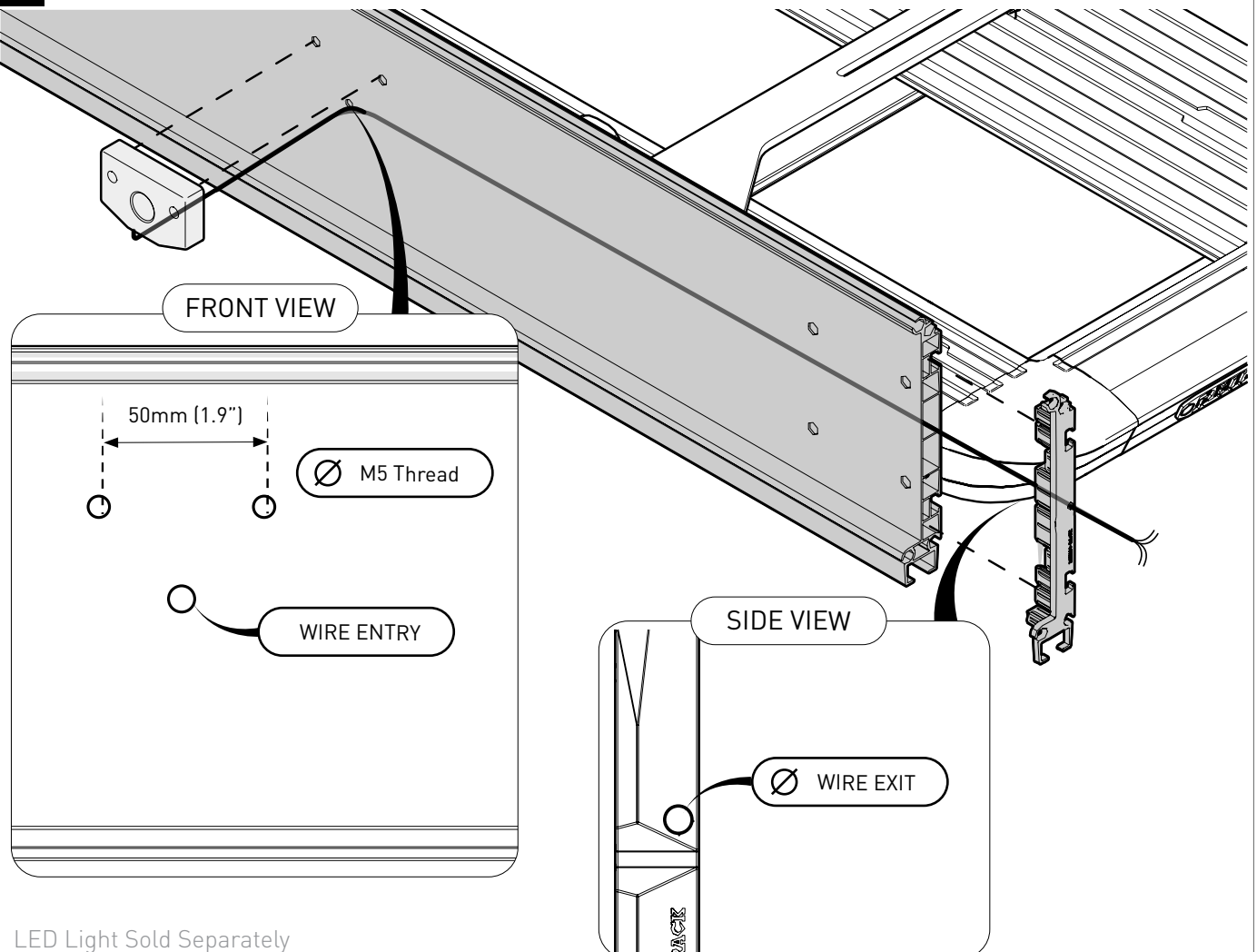

NOTES

NOTES



RHINO-RACK®

MAKE SPACE FOR ADVENTURE

RHINORACK.COM

Rhino-Rack AUSTRALIA

22A Hanson Pl,
Eastern Creek, NSW, 2766

Rhino-Rack USA

19822 E 22nd Ave,
Aurora, CO, 80011