

RHINO-RACK®

Batwing 180 Freestanding Awning

32147

Important:

1. Check the Rhino-Rack website to ensure you have the latest issue of these instructions.
2. Please refer to your fitting instruction to ensure that the roof racks are installed in the correct locations.
3. Check the contents of kit before commencing fitment and report any discrepancies.
4. Place these instructions in the vehicle's glove box after installation is complete.
5. These instructions must be followed for warranty to be upheld.

Fit Time: 15 mins

TWO-PERSON
INSTALLATION

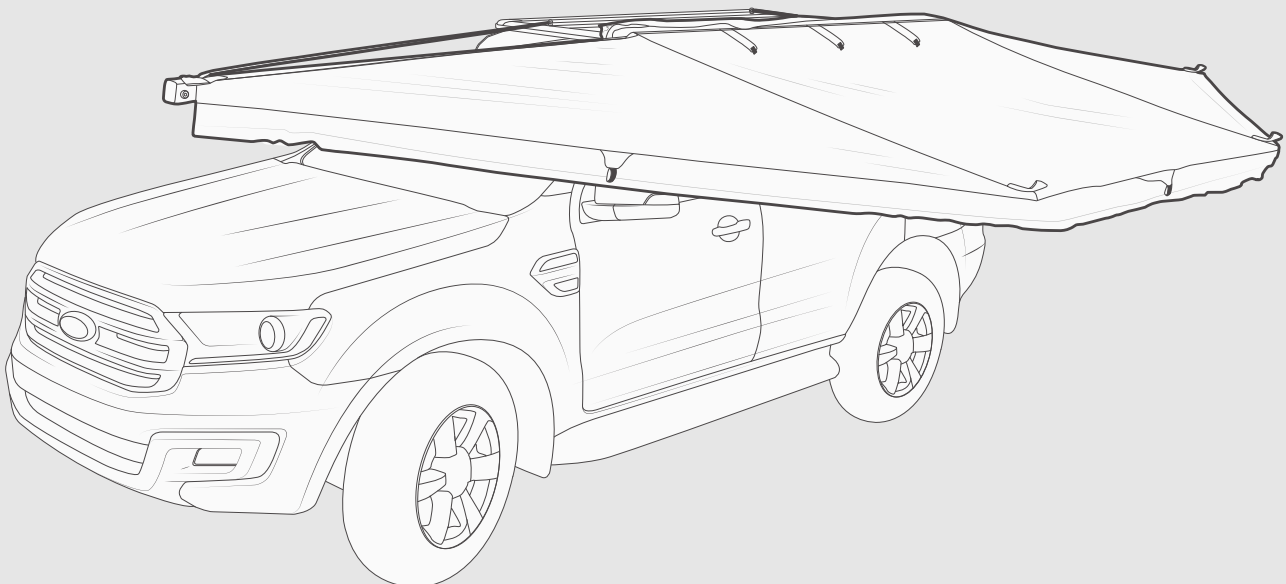

Thank you for choosing Rhino-Rack!



WELCOME TO THE HERD.

For peace of mind register your product by heading to rhinorack.com/register

Rhino-Rack AUSTRALIA
22A Hanson Place,
Eastern Creek, NSW 2766

Rhino-Rack USA
19822 E. 22nd Avenue,
Unit B, Aurora, CO 80011

RHINORACK.COM
Document No: 520-RFI-00209
Issue No: 02
Issue Date: 23/05/2025

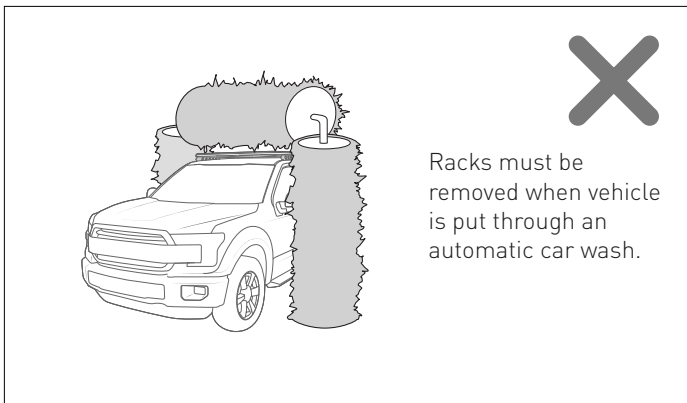

Racks must be removed when vehicle is put through an automatic car wash.

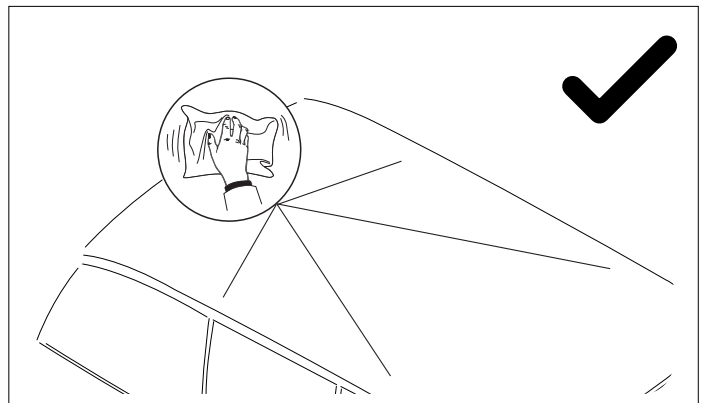

If awning is wet, dry before you stow.

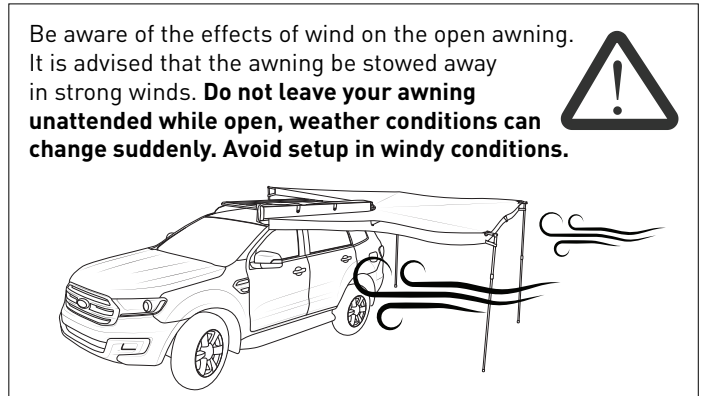

Be aware of the effects of wind on the open awning. It is advised that the awning be stowed away in strong winds. **Do not leave your awning unattended while open, weather conditions can change suddenly. Avoid setup in windy conditions.**

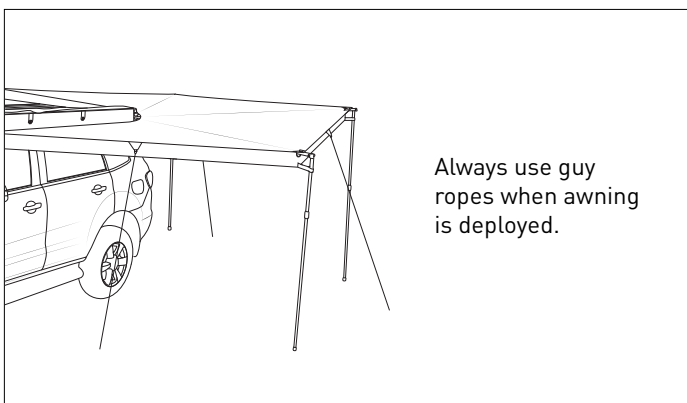

Always use guy ropes when awning is deployed.

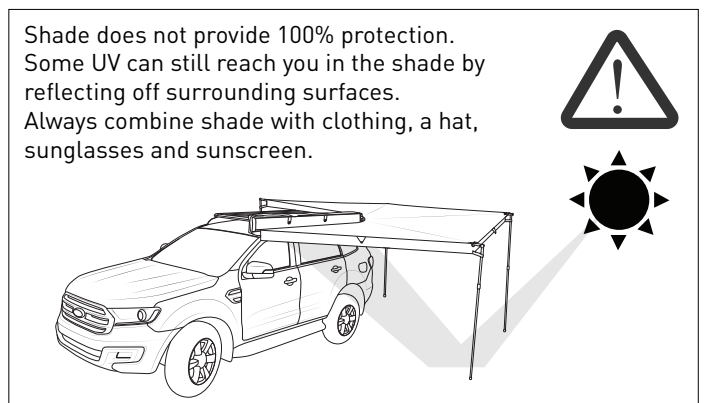

Shade does not provide 100% protection. Some UV can still reach you in the shade by reflecting off surrounding surfaces. Always combine shade with clothing, a hat, sunglasses and sunscreen.

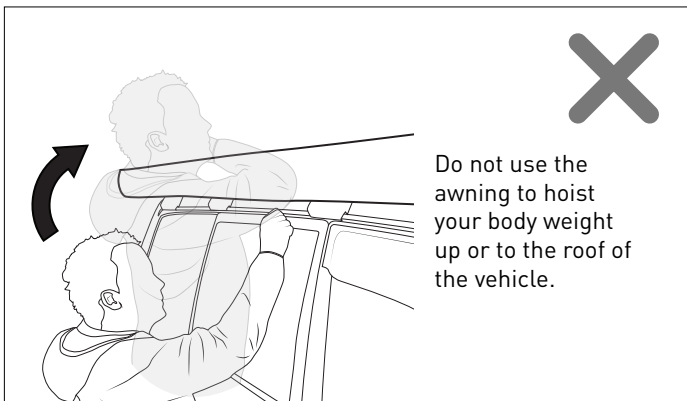

Do not use the awning to hoist your body weight up or to the roof of the vehicle.

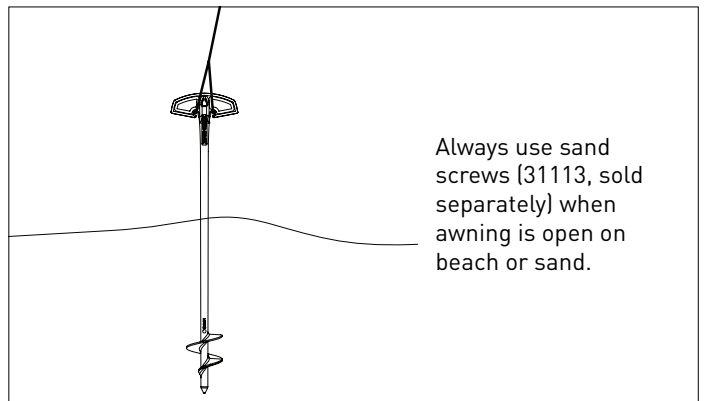

Always use sand screws (31113, sold separately) when awning is open on beach or sand.

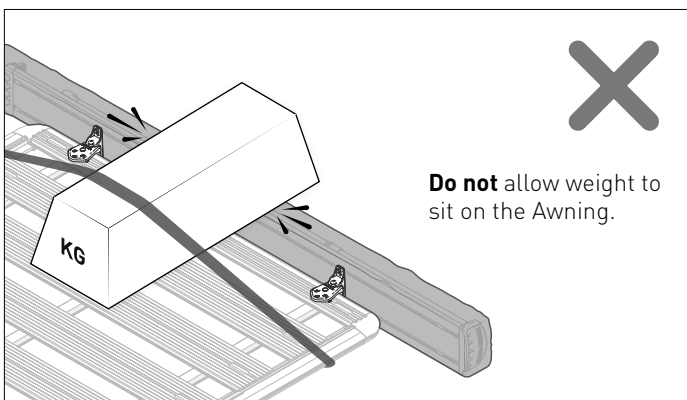

Do not allow weight to sit on the Awning.

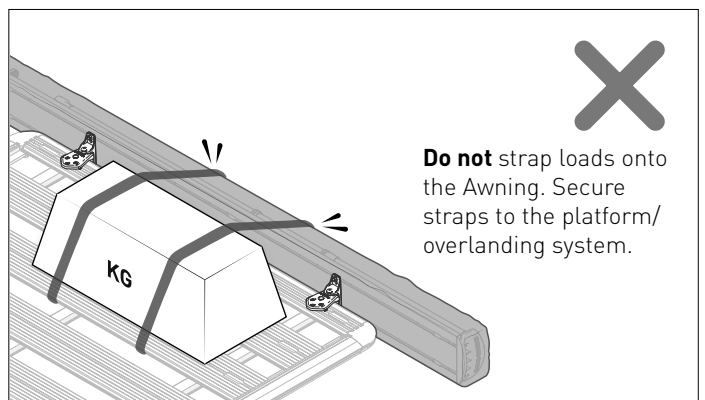

Do not strap loads onto the Awning. Secure straps to the platform/overlanding system.

Important Information

Recommendations

Use only non-stretch fastening ropes or straps.

Please remove Batwing Awning and crossbars when putting vehicle through an automatic car wash.

Do not stow away the awning for long periods if it is wet. You must allow the awning material to dry completely before storing for extended periods of time. When rolling up the awning, avoid excessive bunching up of the material before stowing. The awning should be rolled up as neatly as possible following the instruction on page 9.

In service maintenance checks

- All bolt connections should be checked after driving a short distance when you first install your roof racks.
- All bolted connections should be checked again at regular intervals (weekly is recommended, depending on road conditions, usage, loads and distances travelled).
- All bolted connections should be checked each time they are re-fitted.
- Off-road conditions are more rigorous. Check all bolted connections and your load more regularly.
- Ensure that your vehicle manufacturer's GVM, and gross axle weights are not exceeded (refer to vehicle owner's manual).

Torque Settings:

Unless stated otherwise in these instructions, all fasteners should be set to the following torque settings:



Load Ratings

With the addition of the Batwing Awning, the load capacity of your crossbars will have to be adjusted accordingly. The Batwing Awning with mounting brackets weighs approximately 20kg.

Note for Dealers and Fitters

It is your responsibility to ensure this fitting instruction is given to the end user or client. It is your responsibility to ensure these fitting instructions are given to the end user or client. These instructions remain the property of Rhino-Rack Australia Pty. Ltd. and may not be used or changed for any other purpose than intended.

Critical Dimensions

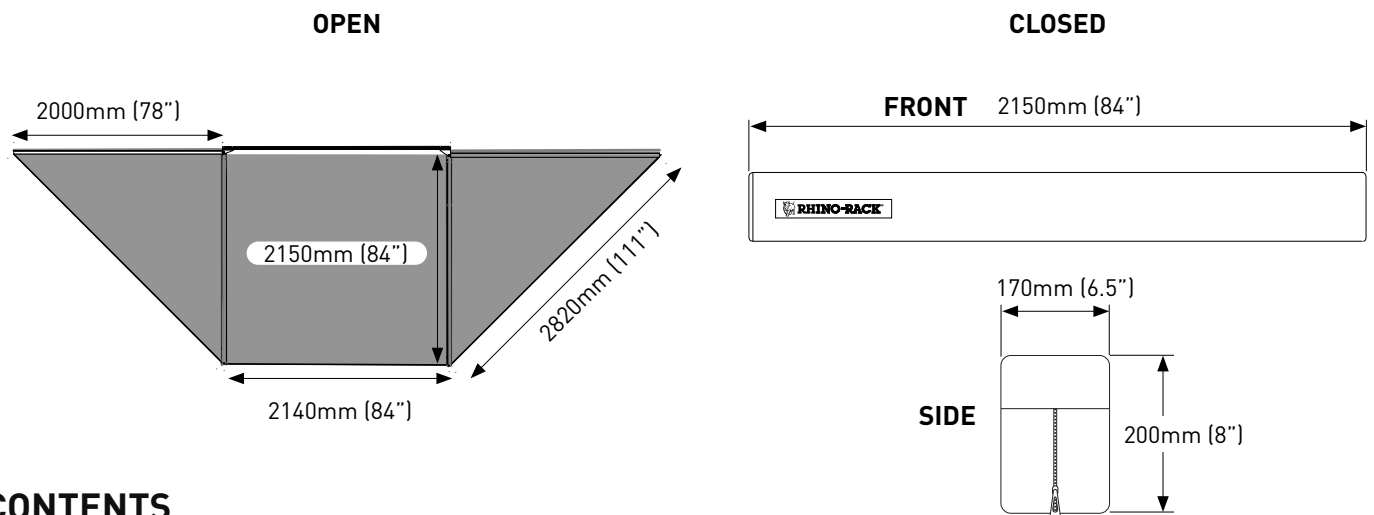

CONTENTS

Installation onto:

Pioneer Platforms	Steps	1 - 5 and 10 - 16
Reconn-Deck Bars	Steps	9 and 10 - 16
VA Crossbars	Steps	6 and 10 - 16
Sportz	Steps	8 and 10 - 16
Operation	Steps	17 - 26
Storage	Steps	27 - 30
Accessories	Steps	31 - 32

Parts List

ASSEMBLED 180

HARDWARE KIT

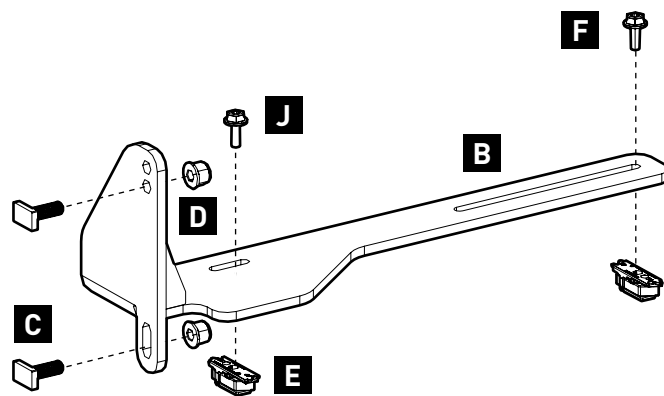

HARDWARE KIT

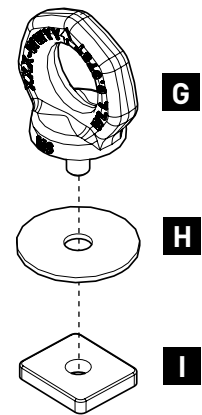

ACCESSORY AND PEG BAGS

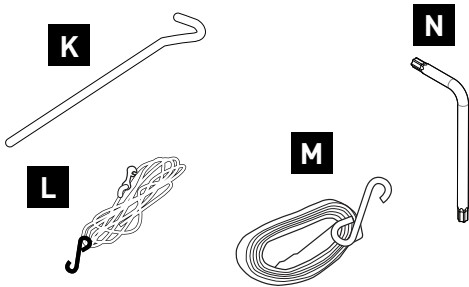

A

Item	ASSEMBLED 270	Qty
A	180 Awning Main Body	1
Item	HARDWARE KITS	Qty
B	Base Bracket	2
C	M8 T-Bolt	4
D	M8 Flanged Nyloc Nut	4
E	Zwifloc Drop-In Nut	6
F	M6x16mm Hex Head Flanged Bolt	4
G	Eye Bolt	2
H	Flat Washer	2
I	Square Nut	6
J	M6 x 12mm Hex Head Flanged Bolt	4

Item	ACCESSORY + PEG BAGS	Qty
K	Awning Peg	7
L	Guy Rope (Blue)	7
M	Awning Straps (Black)	2
N	Torx Key (T30)	1

TOOLS REQUIRED:

T1 - 10mm & 13mm Spanner (or Socket wrench)

T2 - Tape Measure

T3 - Step Ladder

T4 - Hammer/mallet

NOTE

The bracket can be used in two configurations: **HIGH** or **LOW**.

For the purpose of this instruction, installation is shown in the **HIGH** configuration.

80mm

180mm

NOTE: Example depicts Pioneer Platforms. Also applies to Cross Bars

For **crossbars**, ensure the distance between the **front and rear bars** (or bars used for mounting) falls within the required bar spacing.

MAX 2150mm (84")

MIN 1150mm (45")

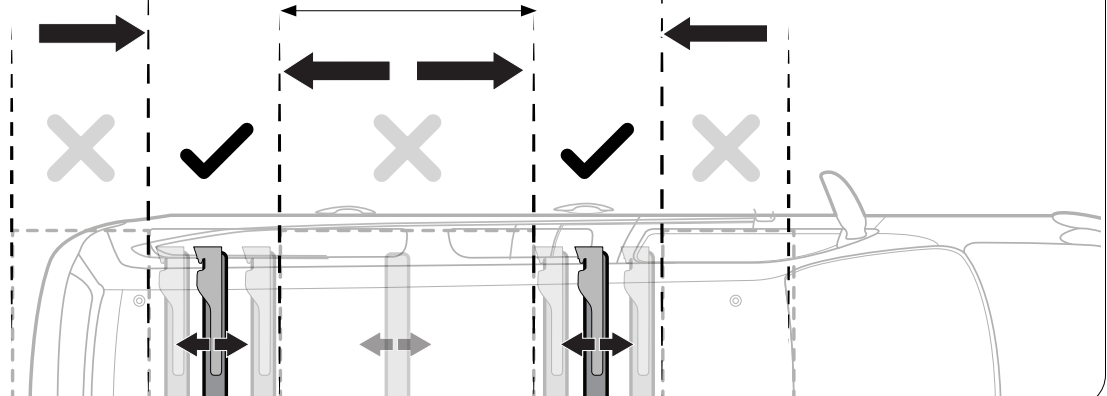

For Installation onto PIONEER PLATFORMS

(For Crossbars, skip to Step 6)

1

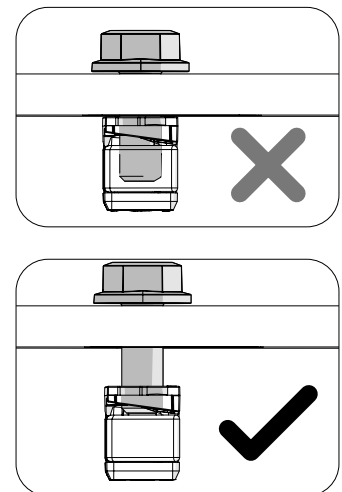
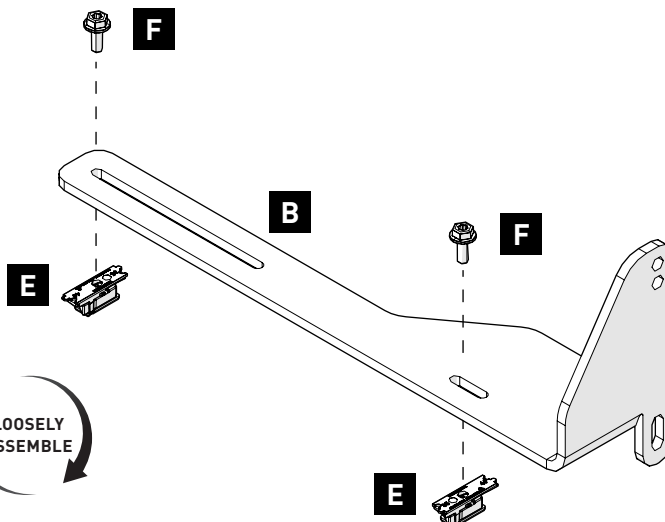

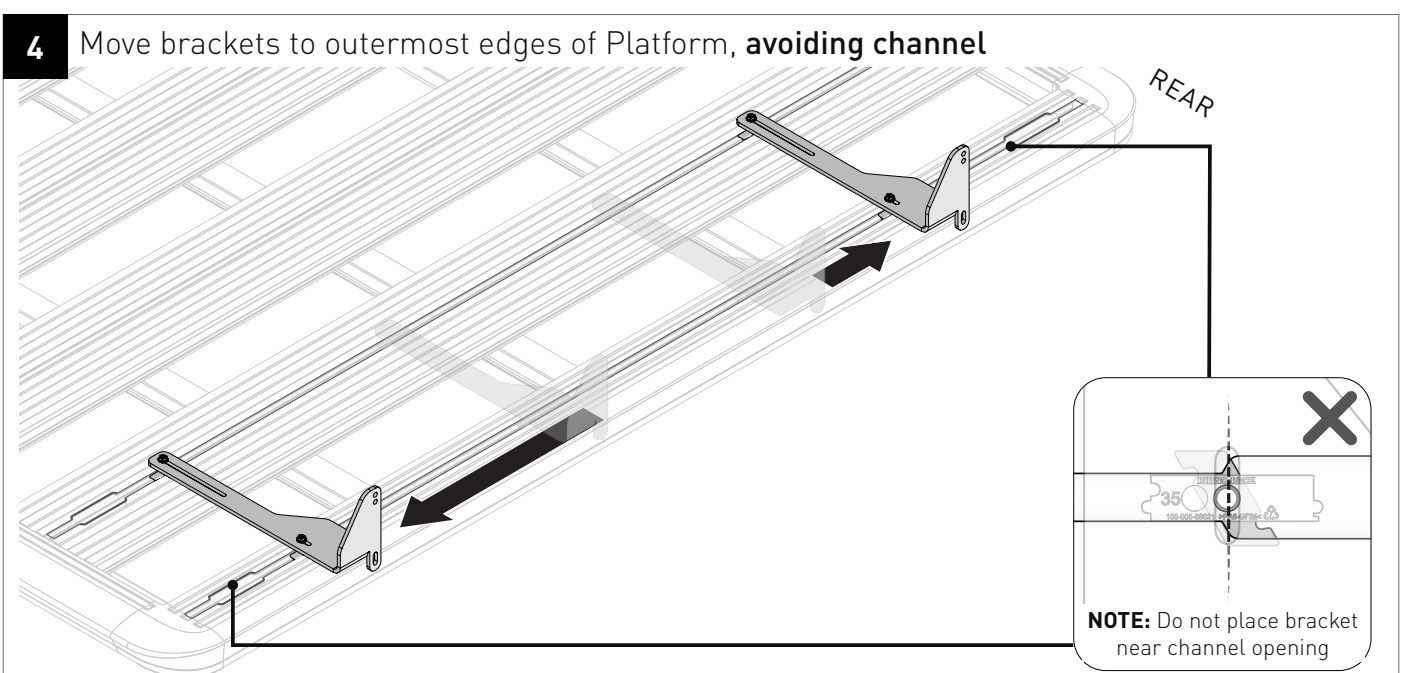
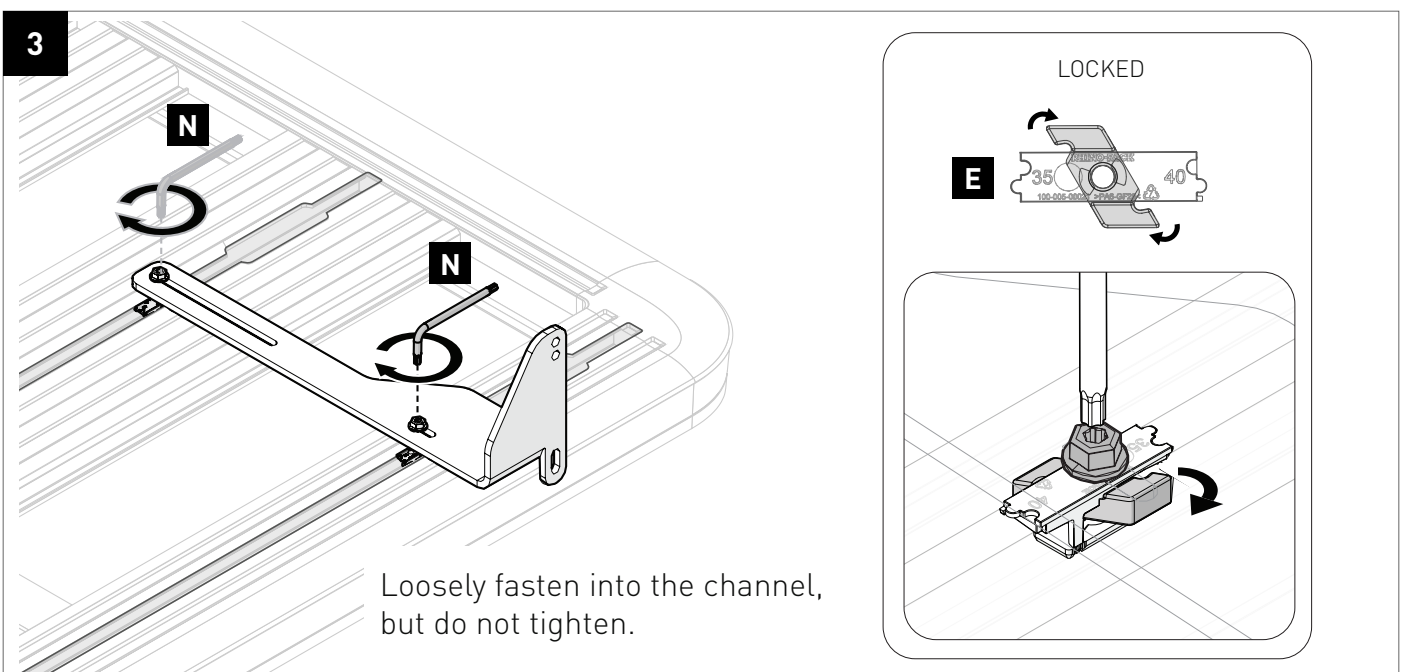
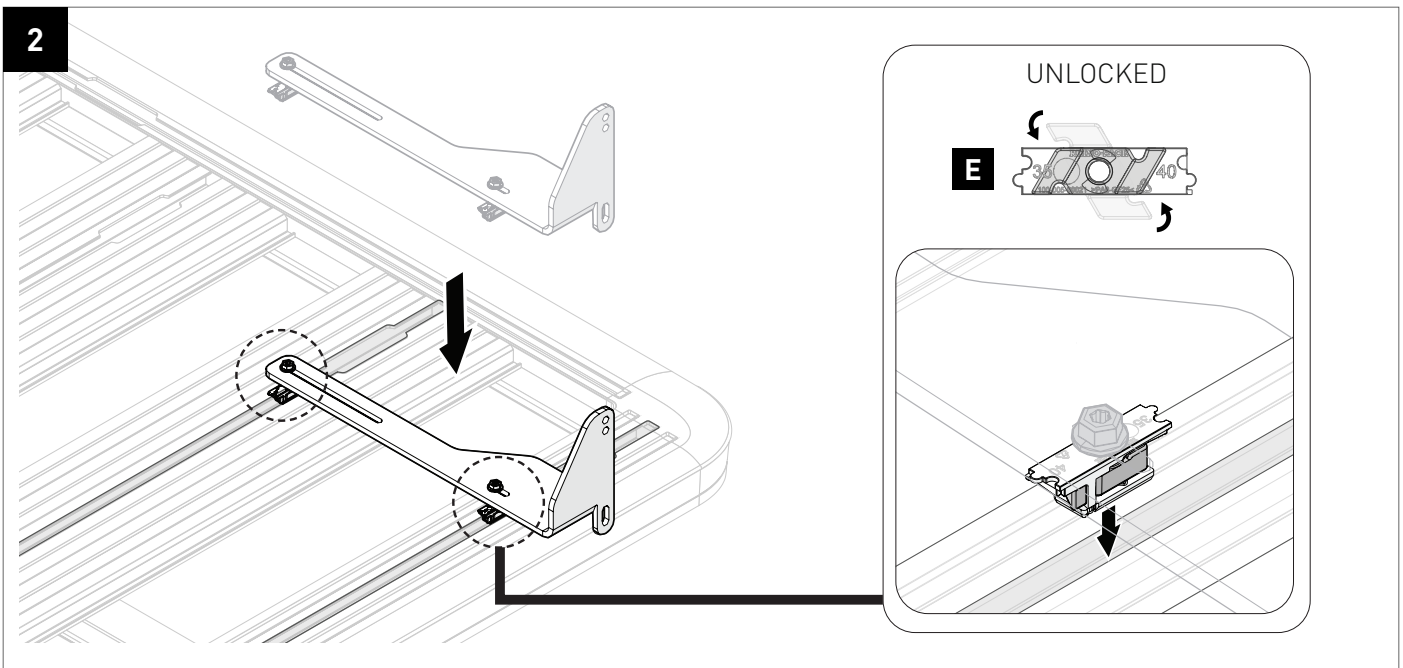

5

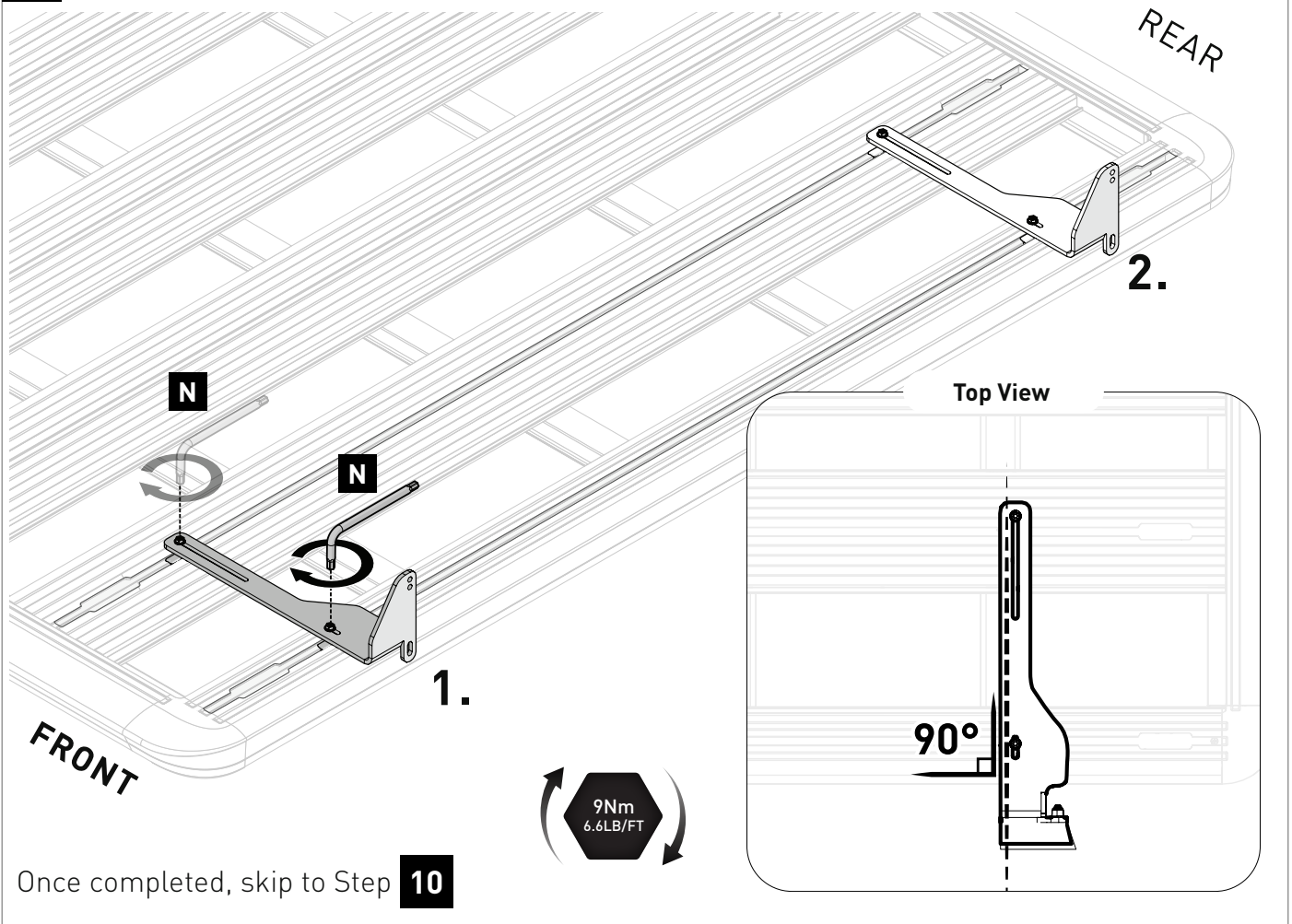

FOR INSTALLATION ONTO CROSSBARS

(For Platforms skip to Step 10)

6

NOTE

For **crossbars**, ensure the distance between the **front and rear bars** (or bars used for mounting) falls within the required bar spacing.

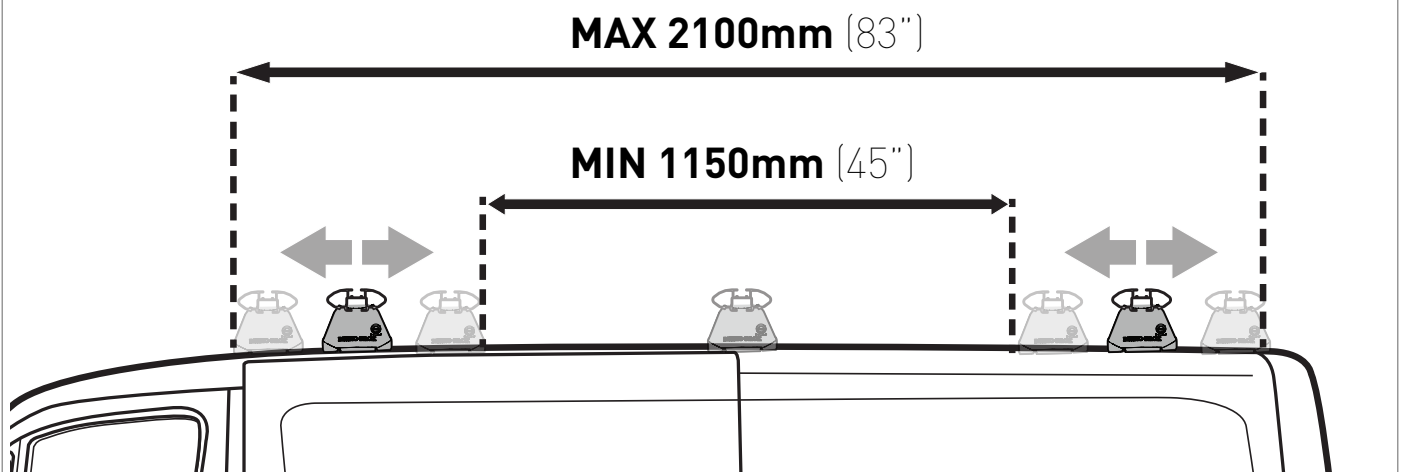

7

VORTEX CROSSBAR:

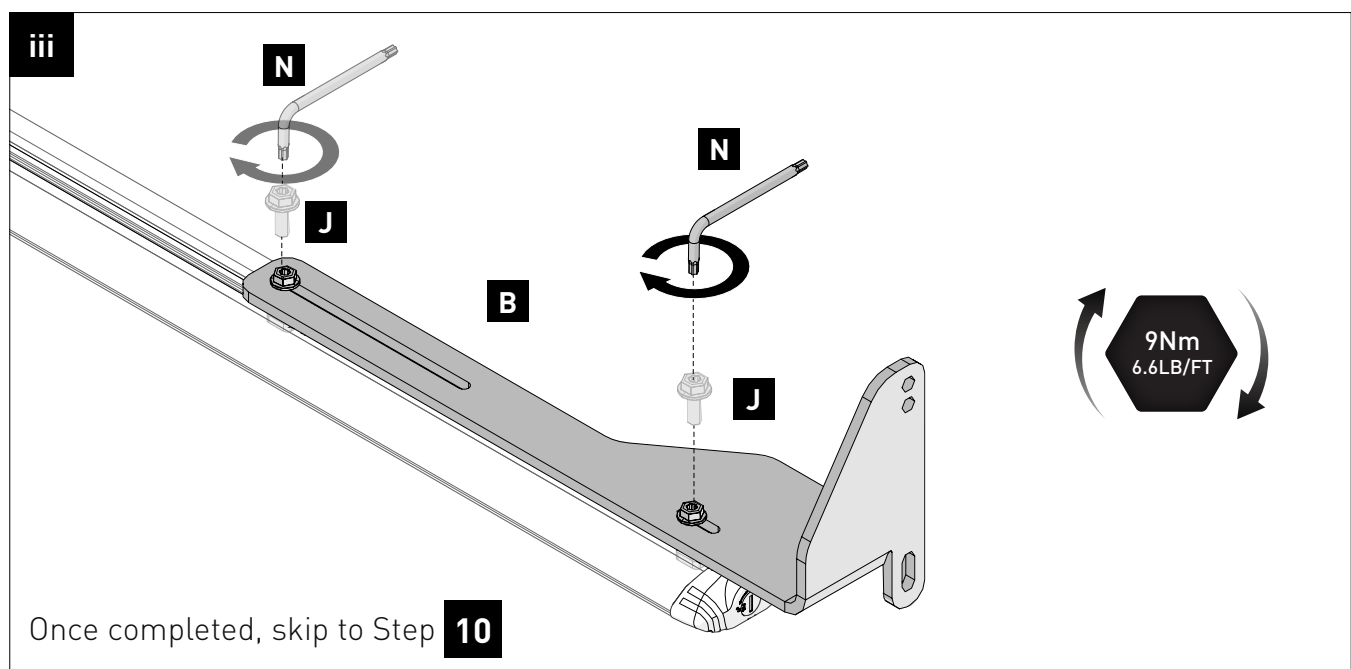
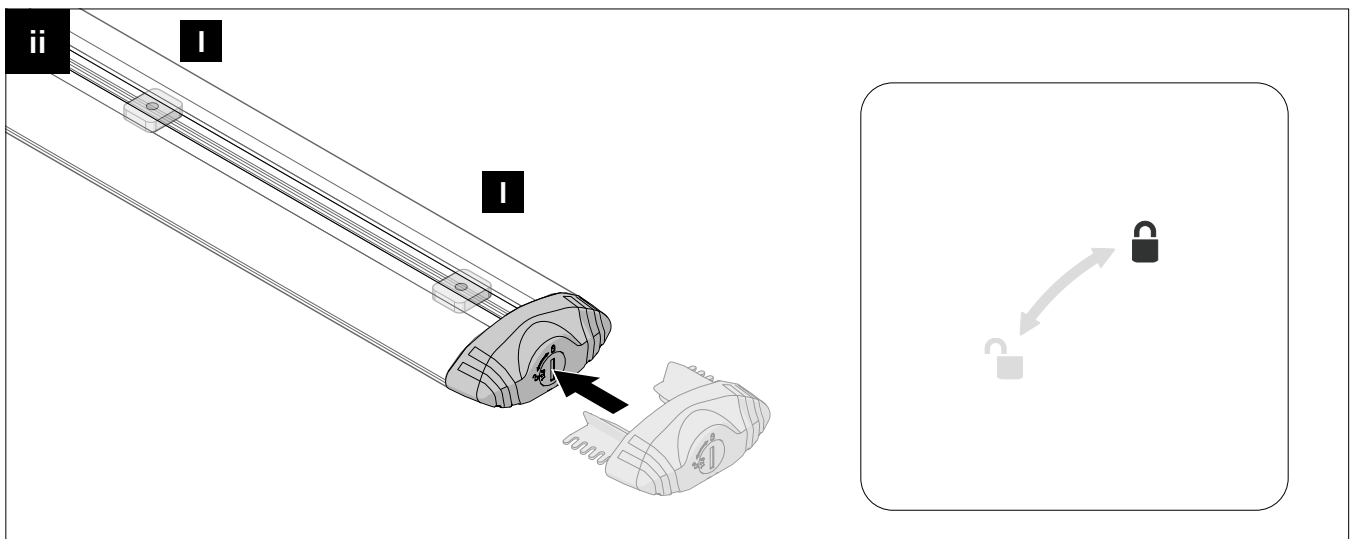
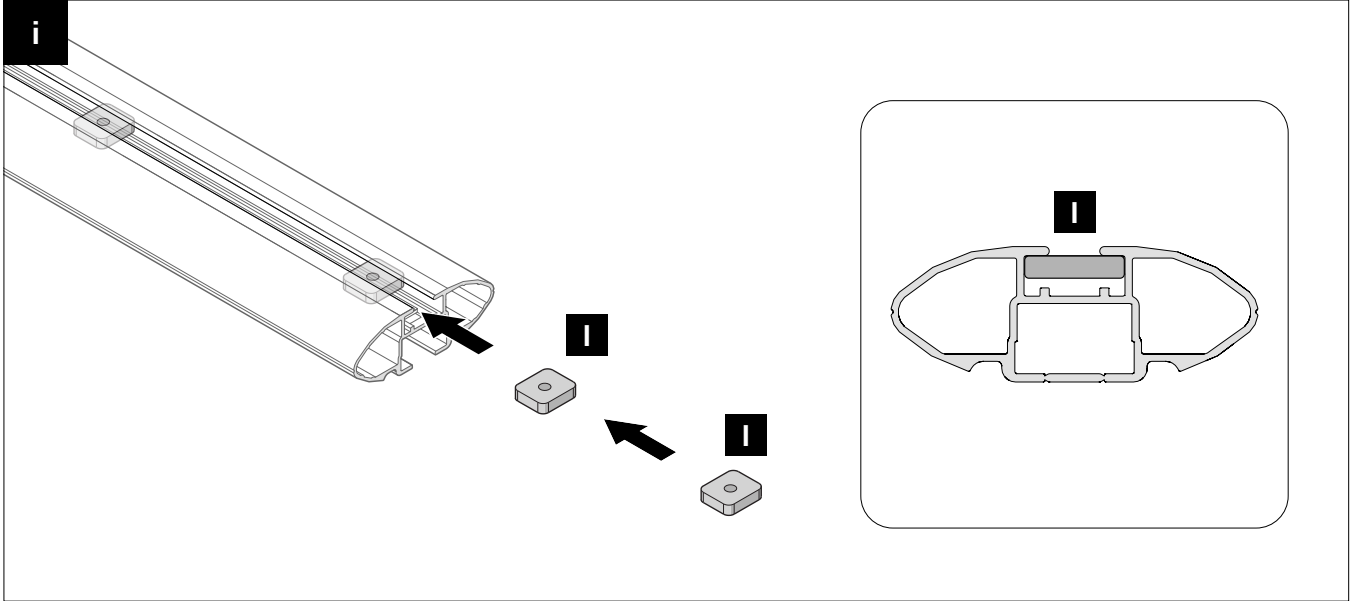
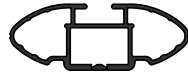

8

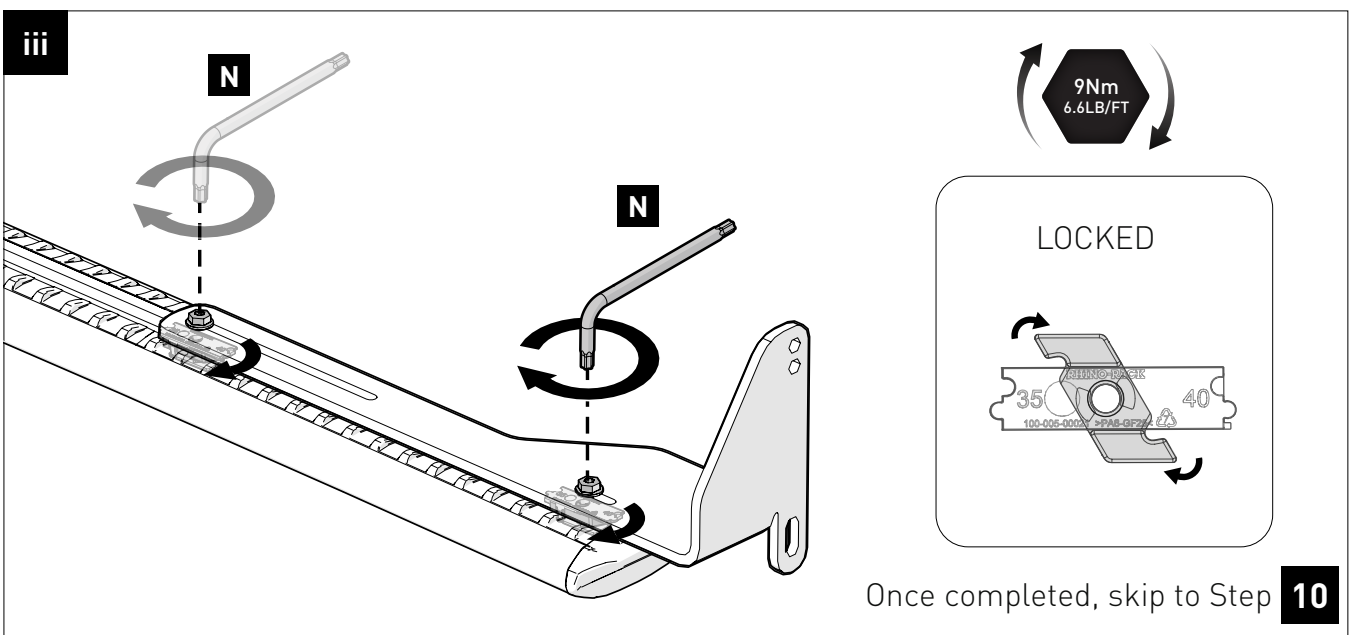
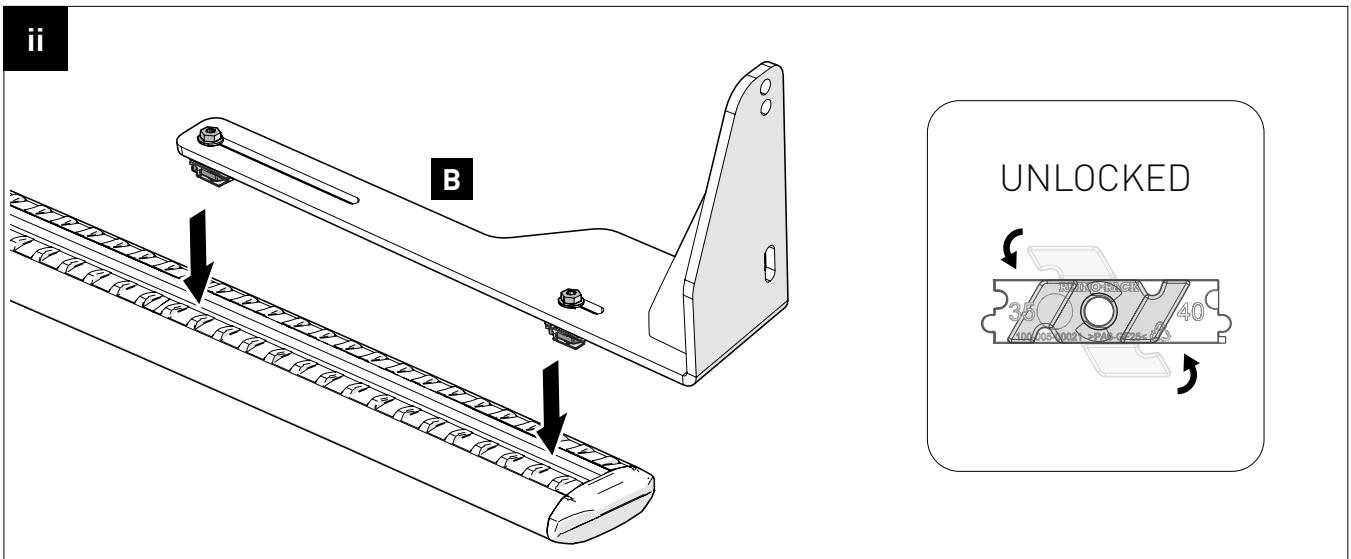
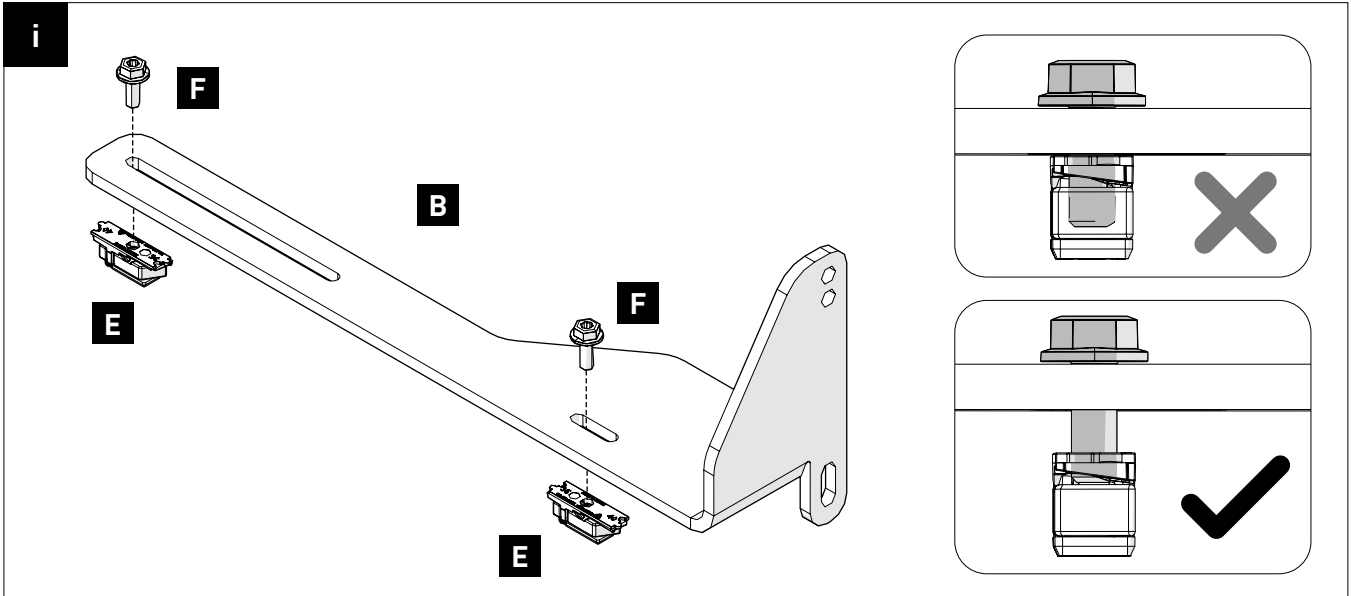
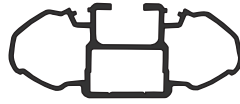
SPORTZ CROSSBAR:

9

RECONN-DECK™ CROSSBAR:



i

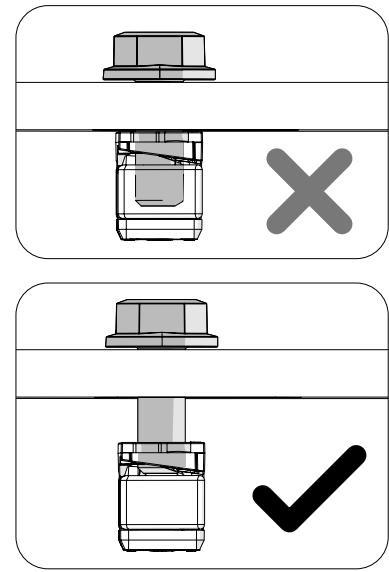
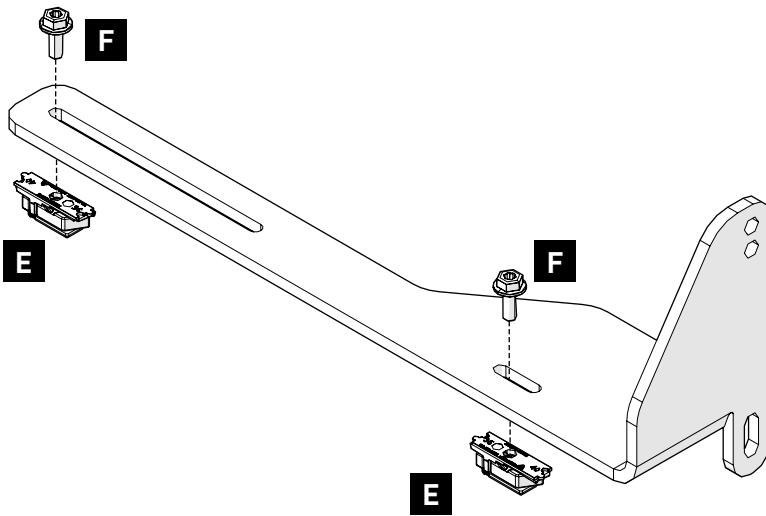

ii

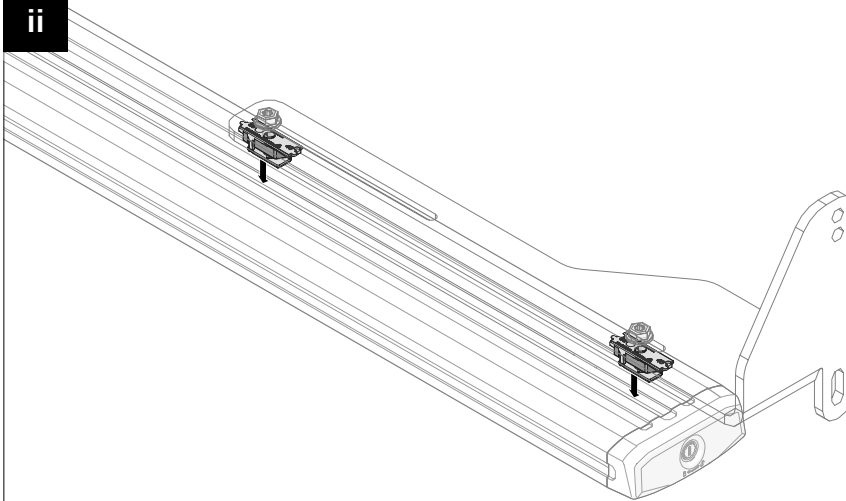

UNLOCKED

E

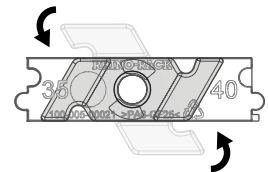

iii

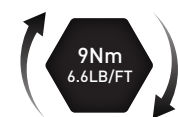
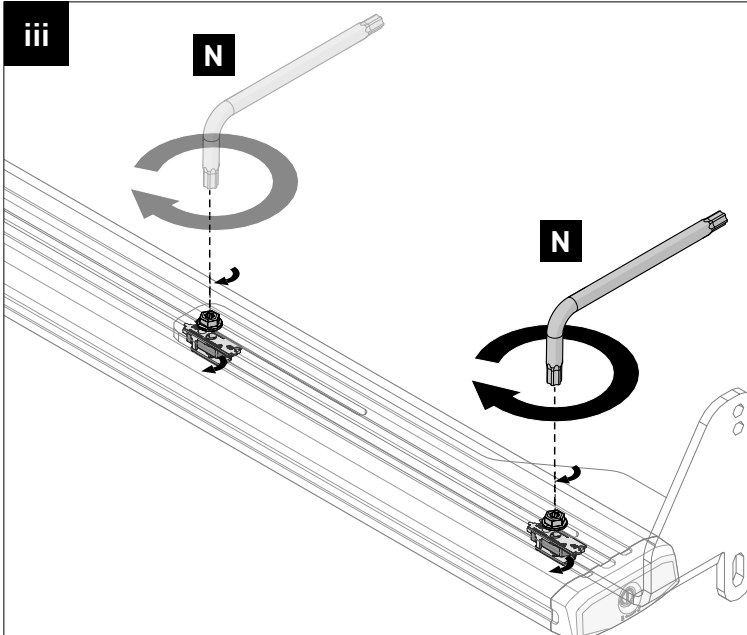

LOCKED

E

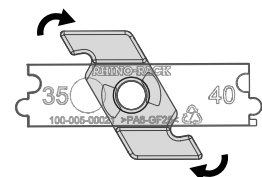

Once completed, skip to Step **10**

NOTE

Eye Bolts will be used as **tie-down points** for the awning when it is open.

For **RECONN-DECK**, **VORTEX BAR**,
& **SPORTZ** Skip to next page.

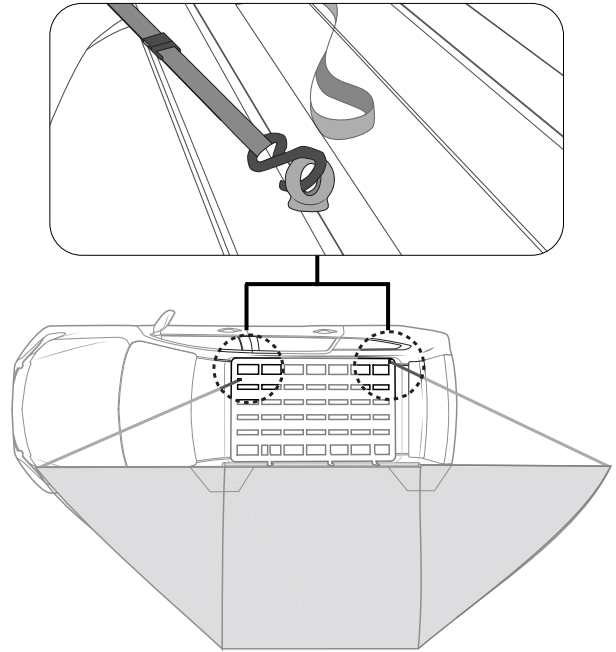

ZWIFLOC™ Lock Guide

UNLOCKED

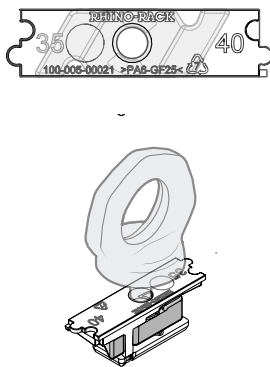

LOCKED

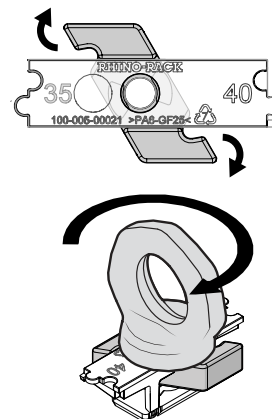

PIONEER™

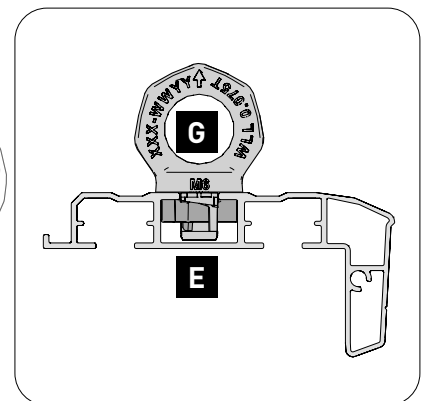
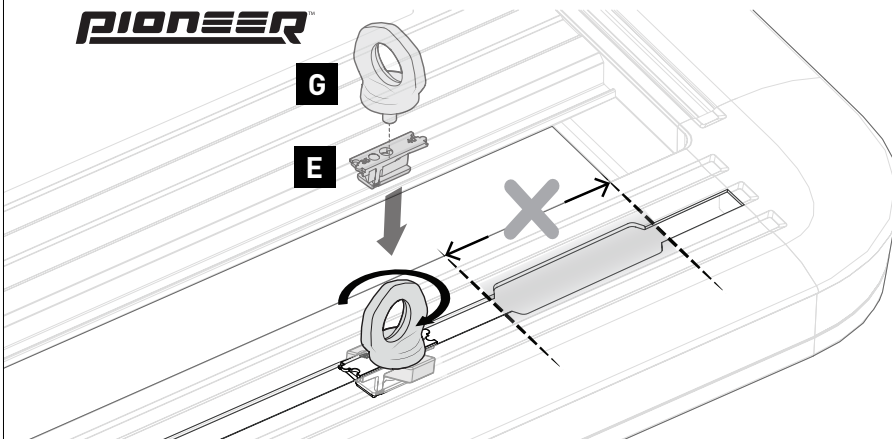

NOTE

For **crossbar** configurations, **bars** on the **opposite side** of the awning to attach the eyebolts.

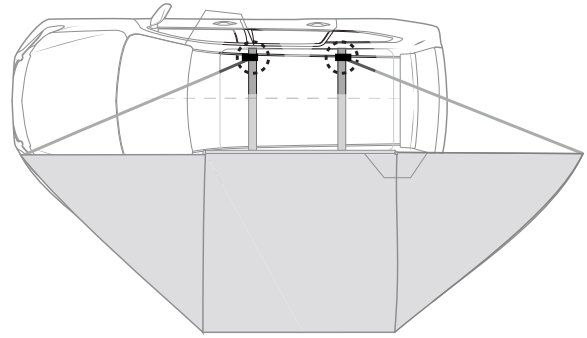

RECONN-DECK

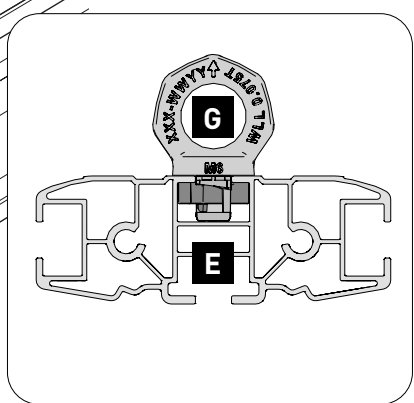
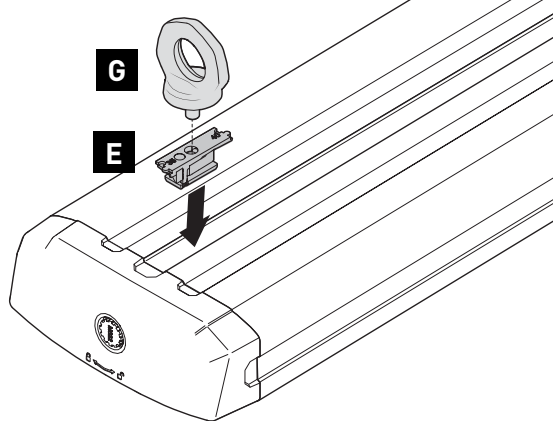

SPORTZ

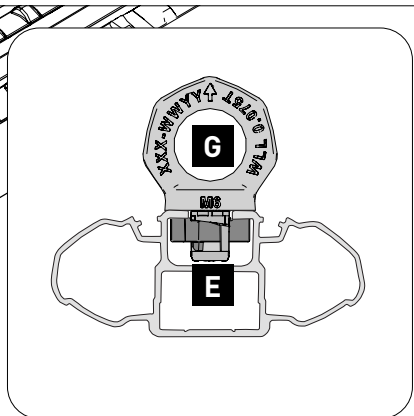
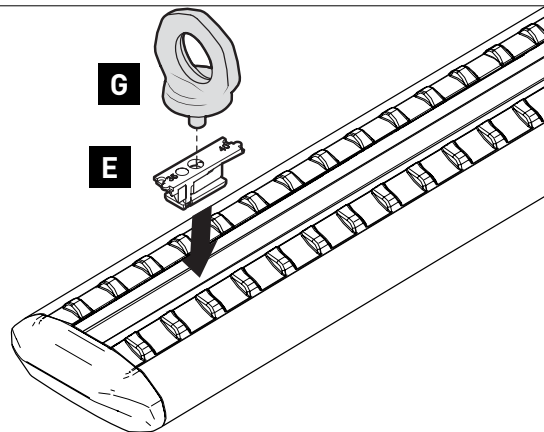

VORTEX BAR

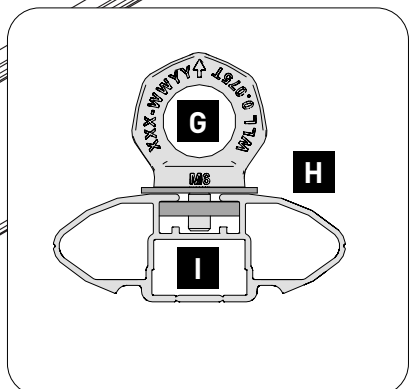
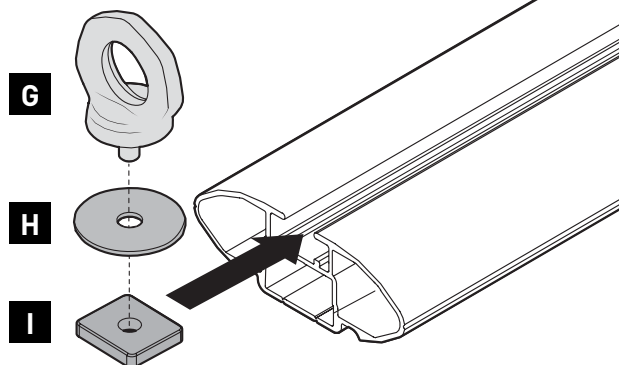

12

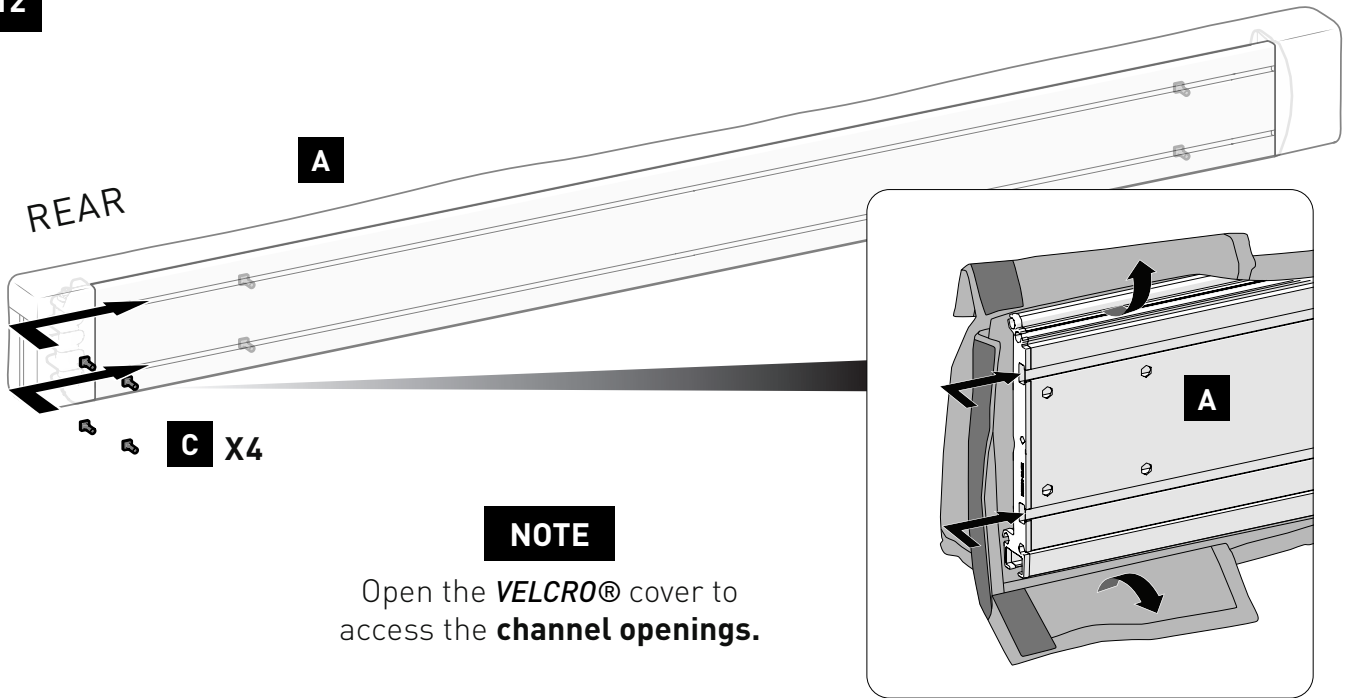

13 locate **T-bolts (C)** in to bracket holes and finger tighten **Nyloc Nuts (D)**.

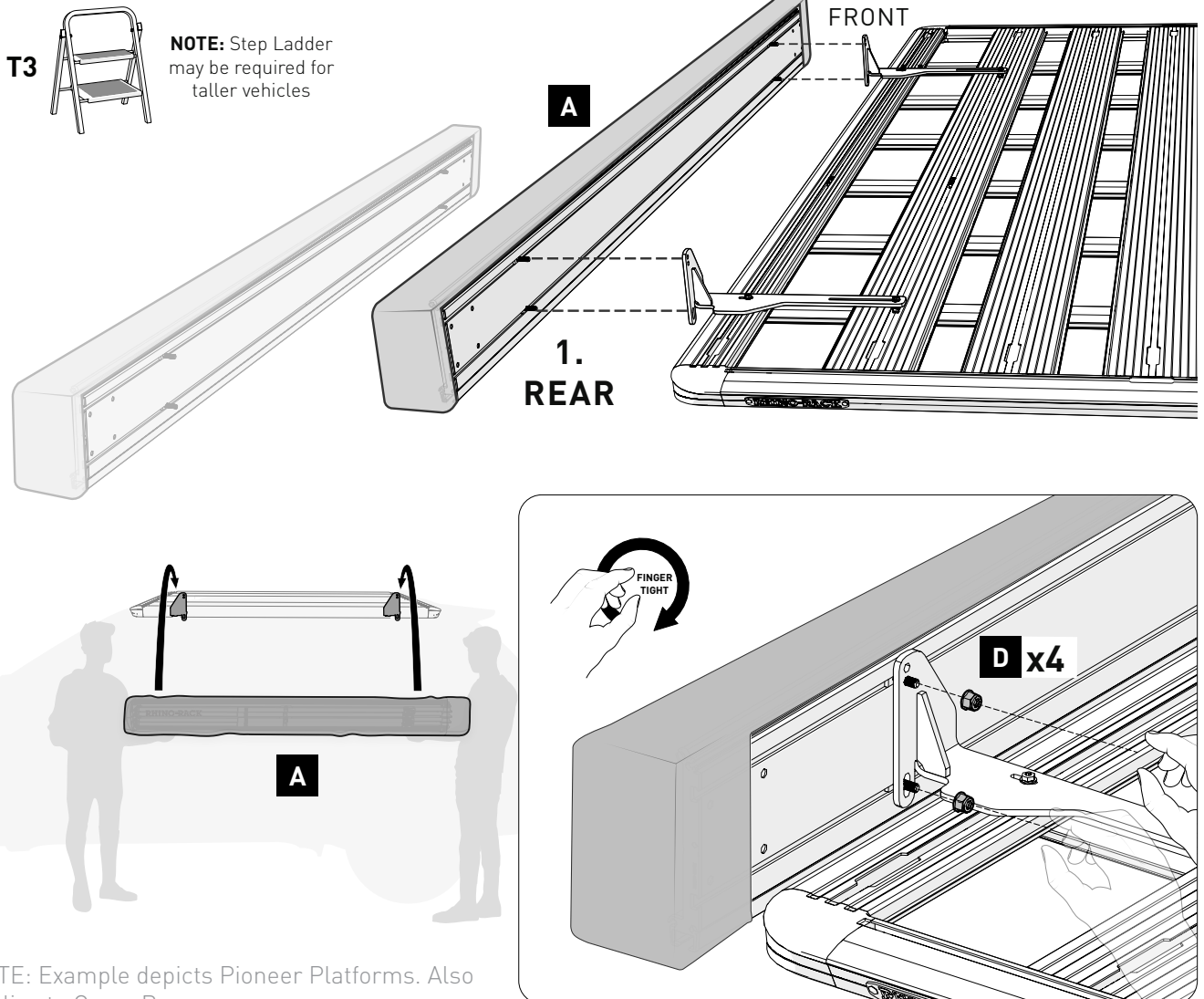

14

**IMPORTANT:**

Ensure there is no more than a 500mm overhang from the end of the awning to the center bracket.

Inspect both ends before tightening.

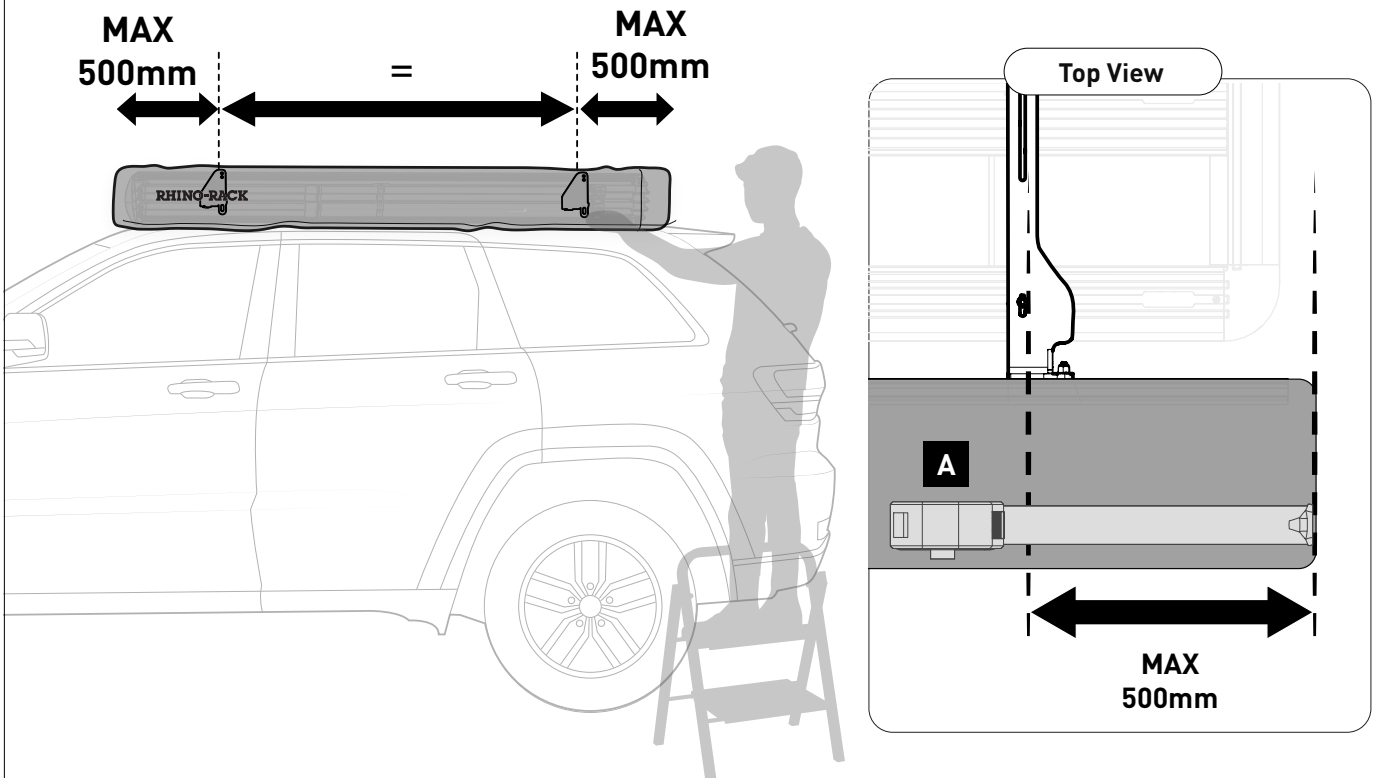

NOTE: Example depicts Pioneer Platforms. Also applies to Cross Bars.

15 Tighten Nyloc Nuts (**D**) at all 6 locations.

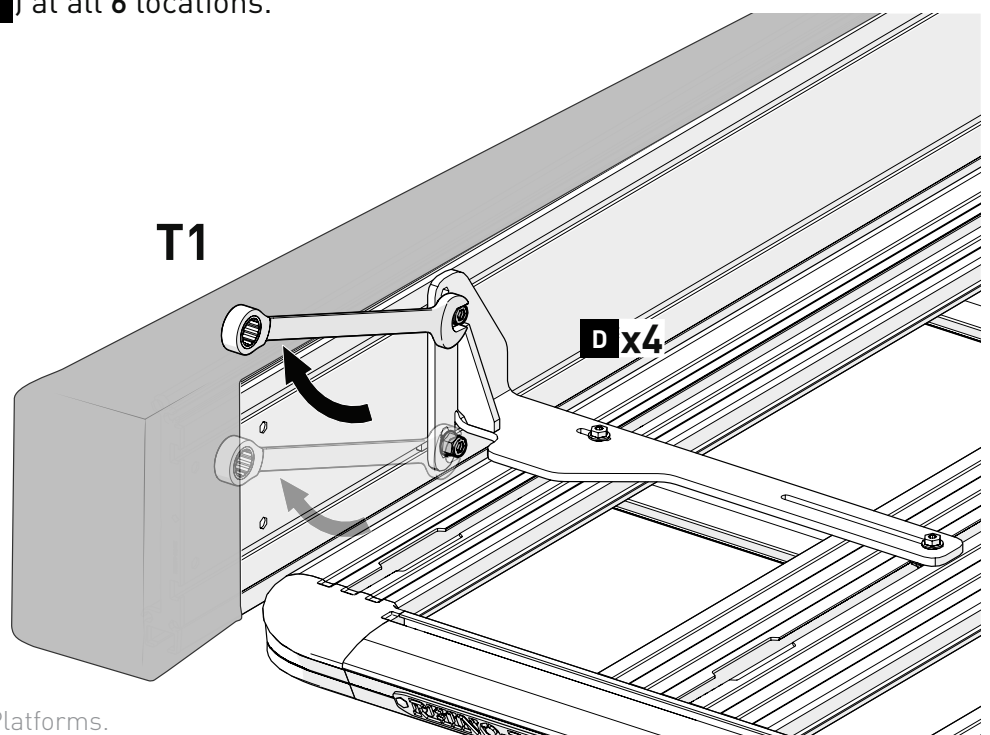

NOTE: Example depicts Pioneer Platforms.
Also applies to Cross Bars.

16

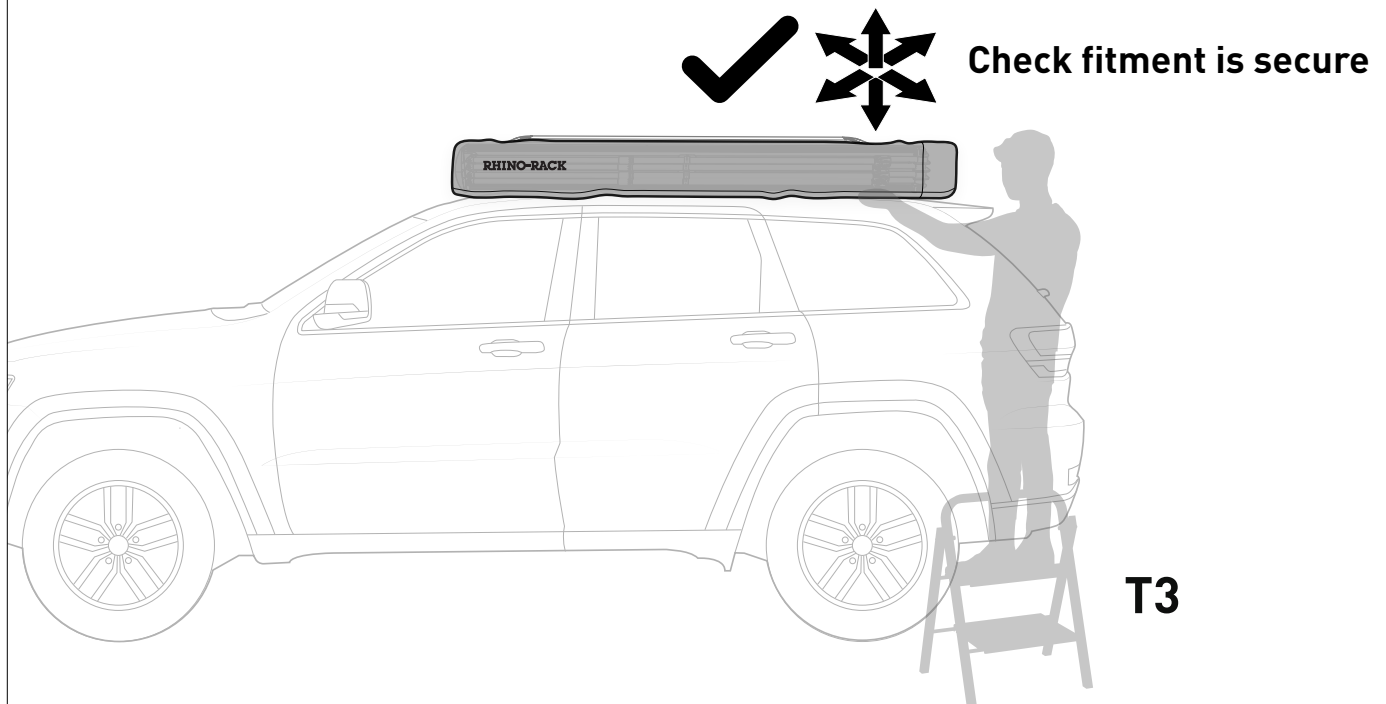

IMPORTANT: Ensure the weight of the awning is correctly supported by the brackets. Failure to check bracket engagement may lead to slippage of the awning and subsequent damage to side of vehicle. **Inspect all three connections overhead before releasing**



Installation Complete.



180 AWNING OPERATION

17

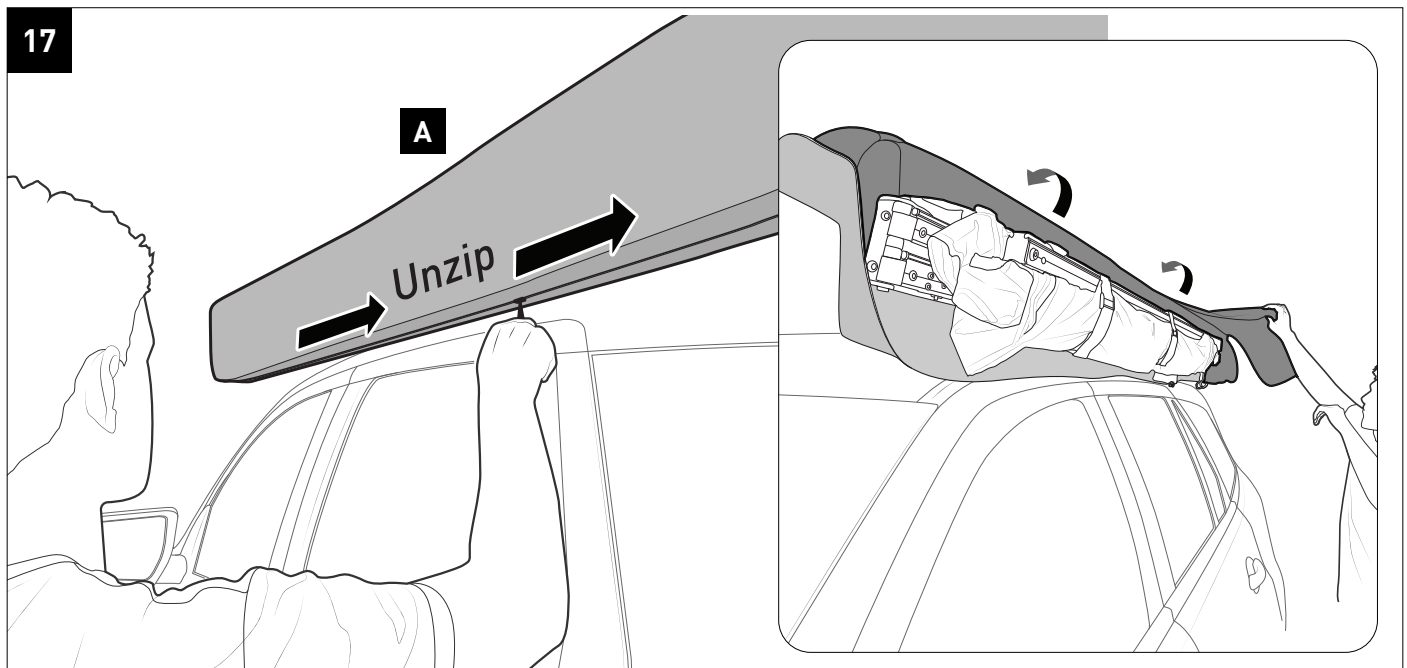

- 18 Retrieve the awning straps from the accessory bag.

REAR

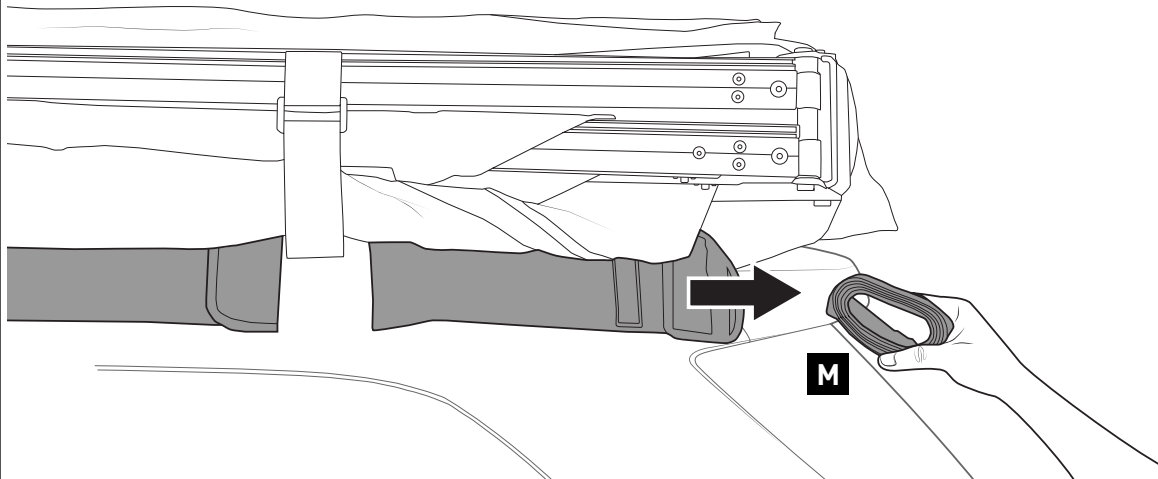

- 19

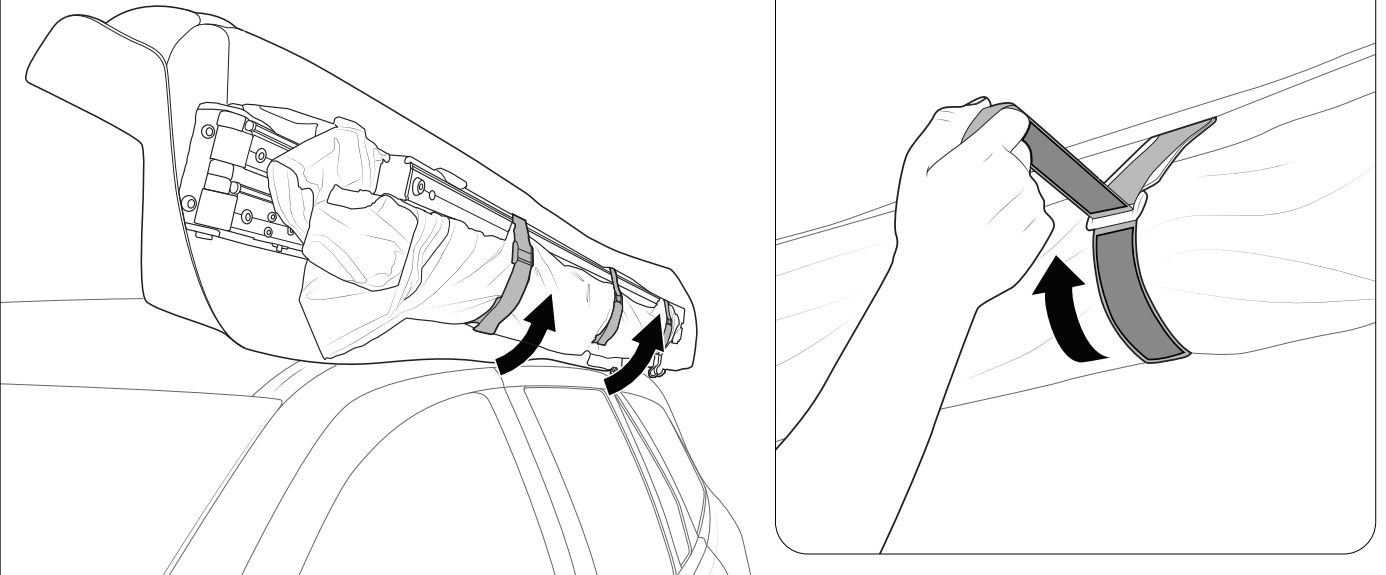

- 20 Open the **right** awning arms towards the back of the vehicle.

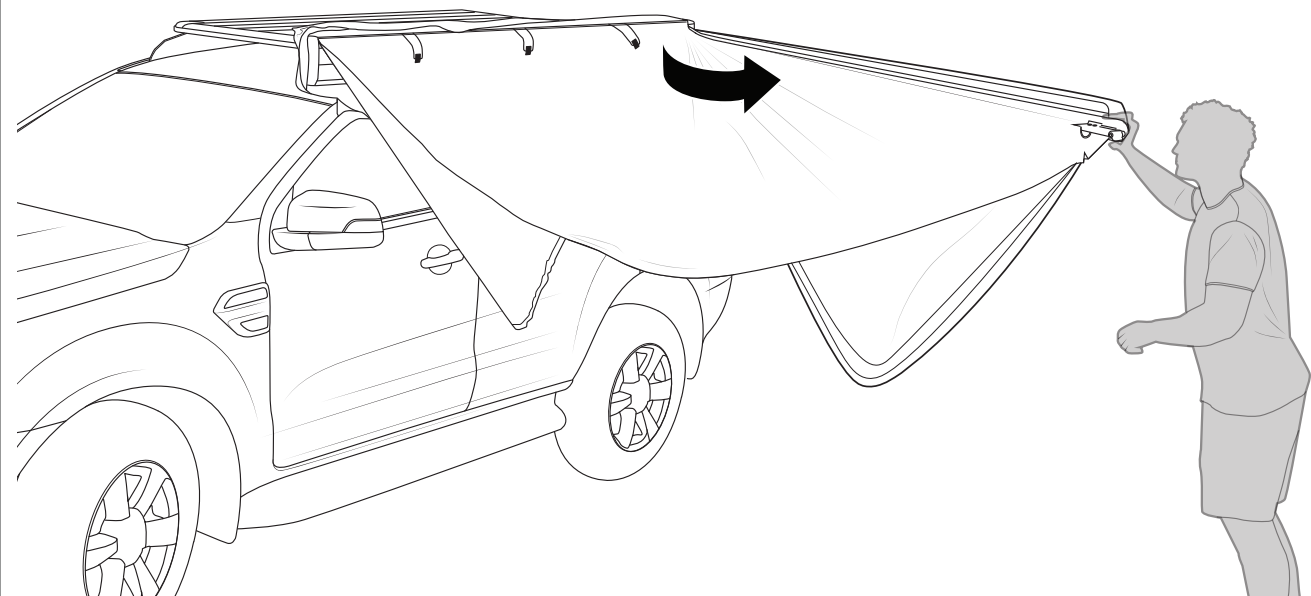

- 21** To attach straps to pioneer or crossbar, use eyebolt installed in steps **10** & **11** .

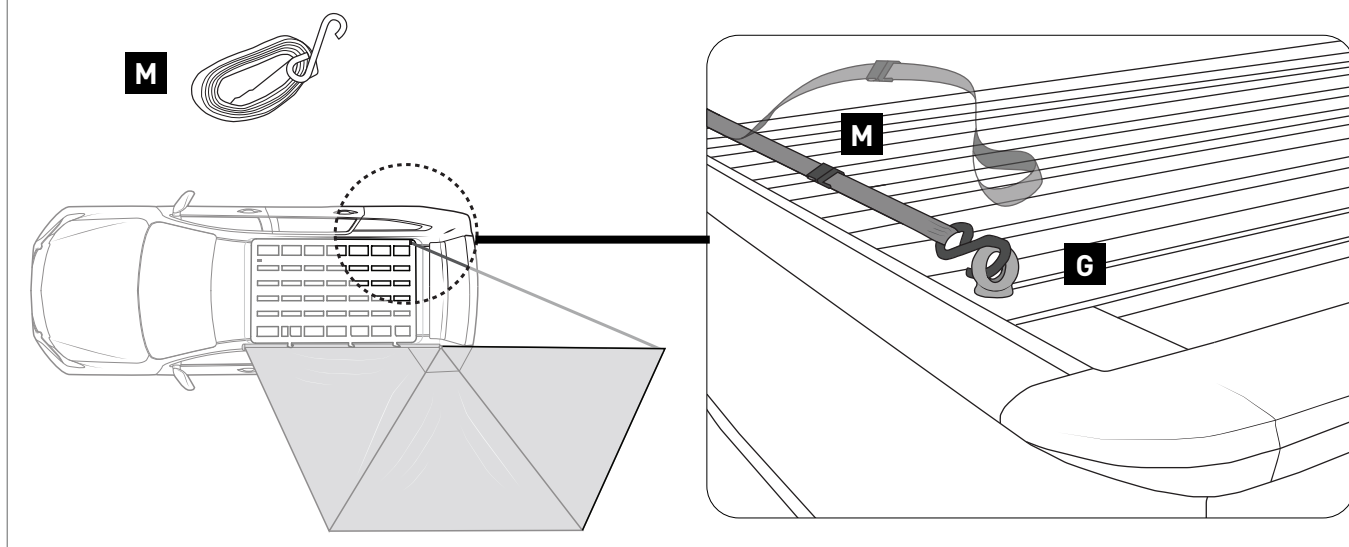

- 22** Tighten the strap to achieve a **180°** angle.

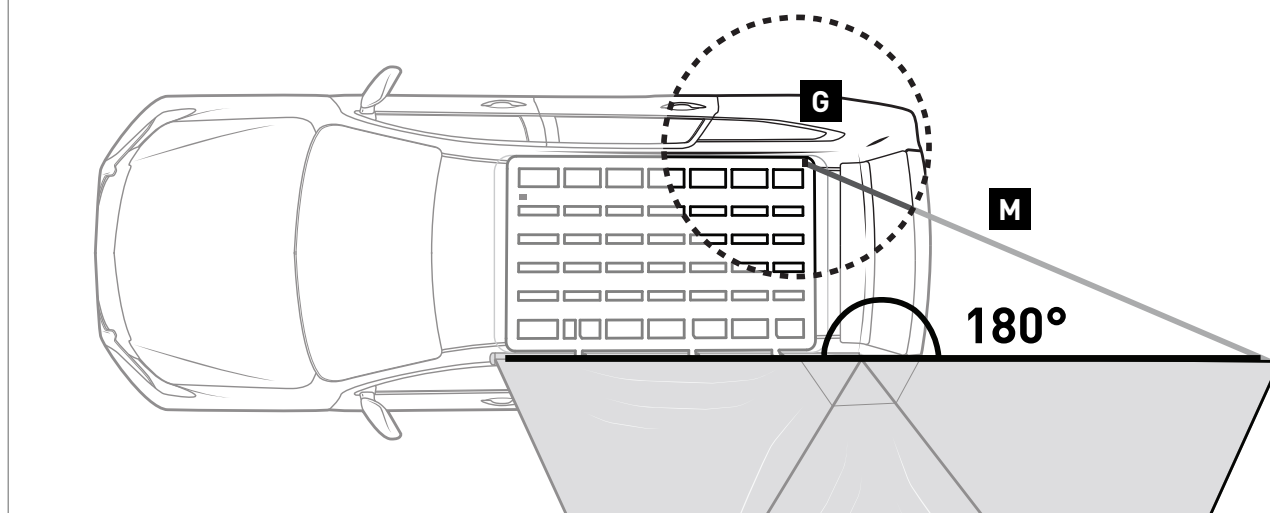

- 23** Open the **left** awning arms towards the front of the vehicle.

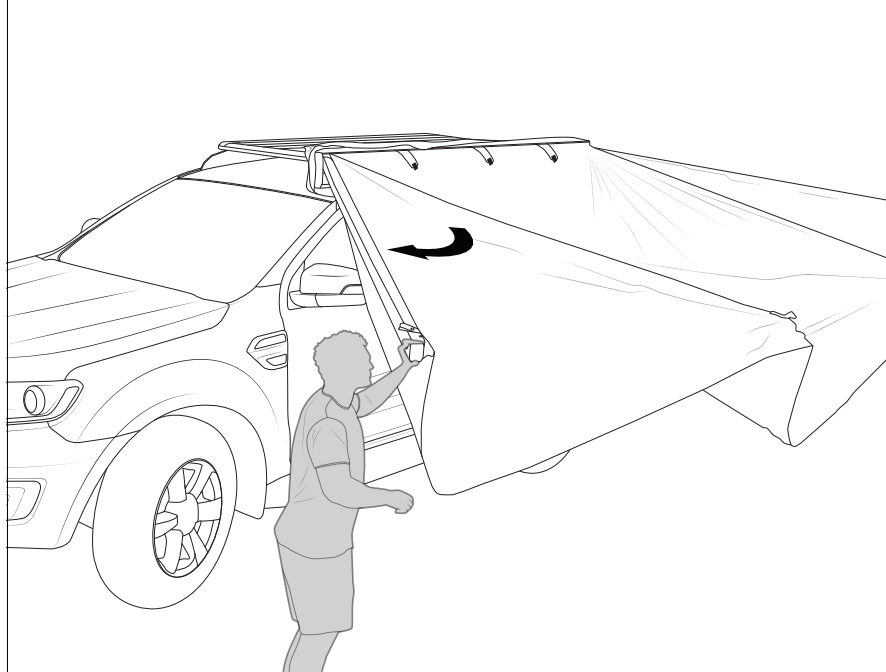

NOTE

Hold the **awning fabric up** to locate the remaining awning arms.



24 Attach straps to eyebolt installed in steps (**10** & **11**).

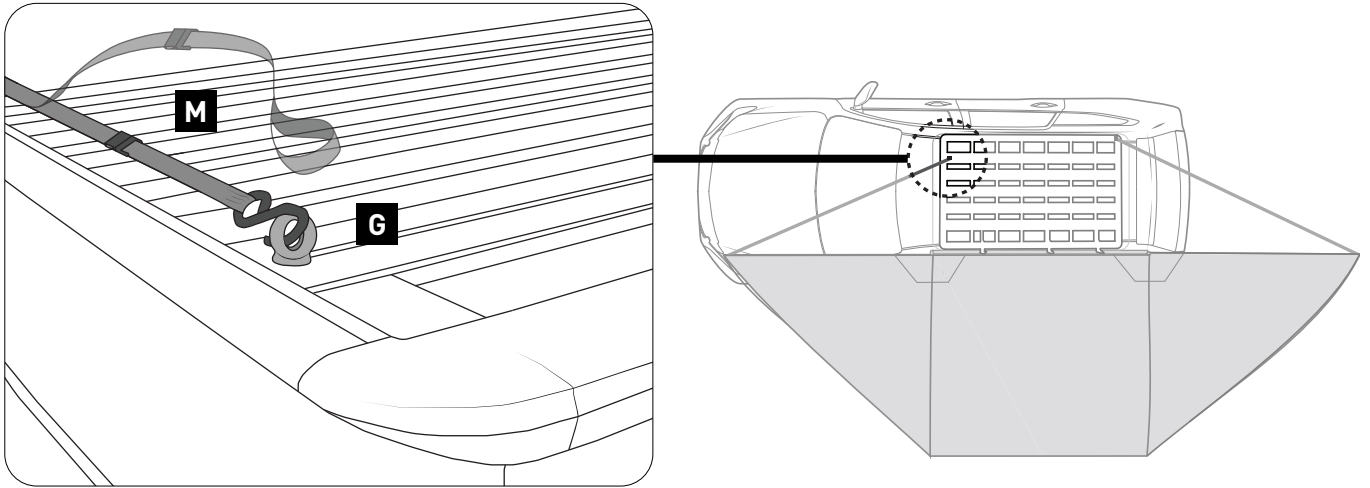

25 Tighten the strap to achieve a **180°** angle.

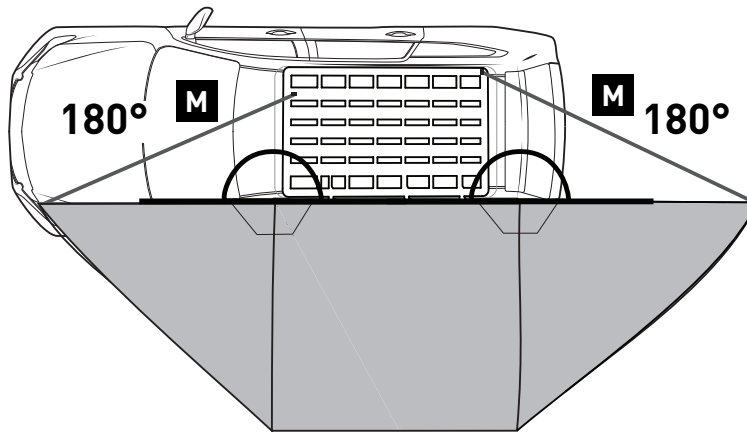

26

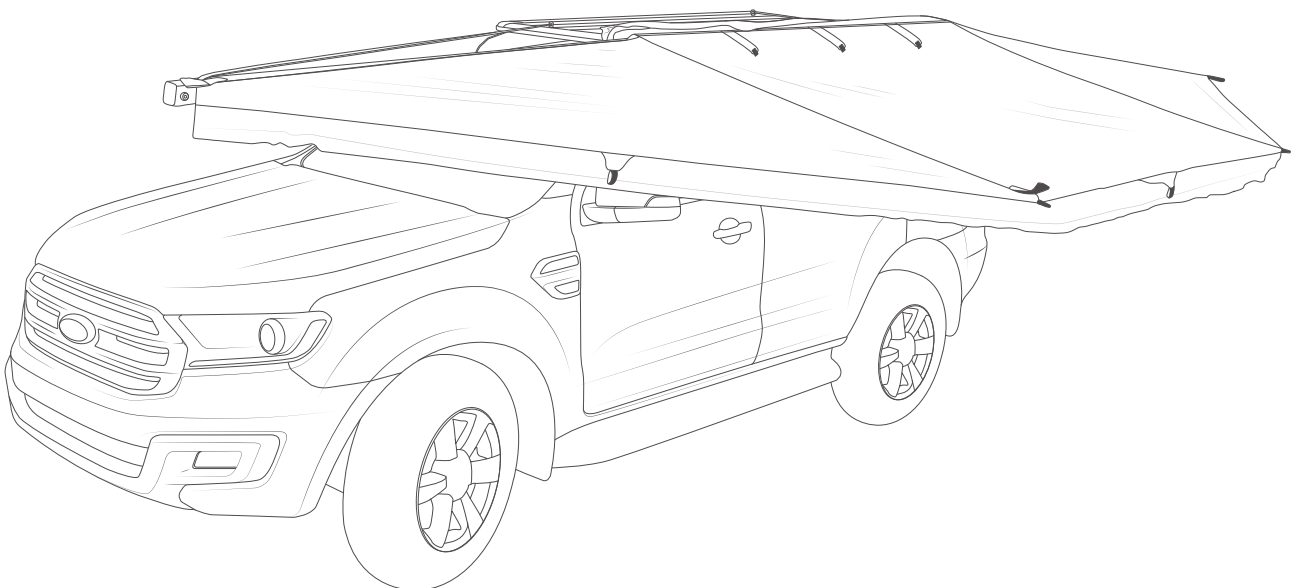

Set up Complete.



Support Pole Deployment (Optional)

(In **windy** or **rainy** conditions, support poles must be used to provide stability and prevent damage.)

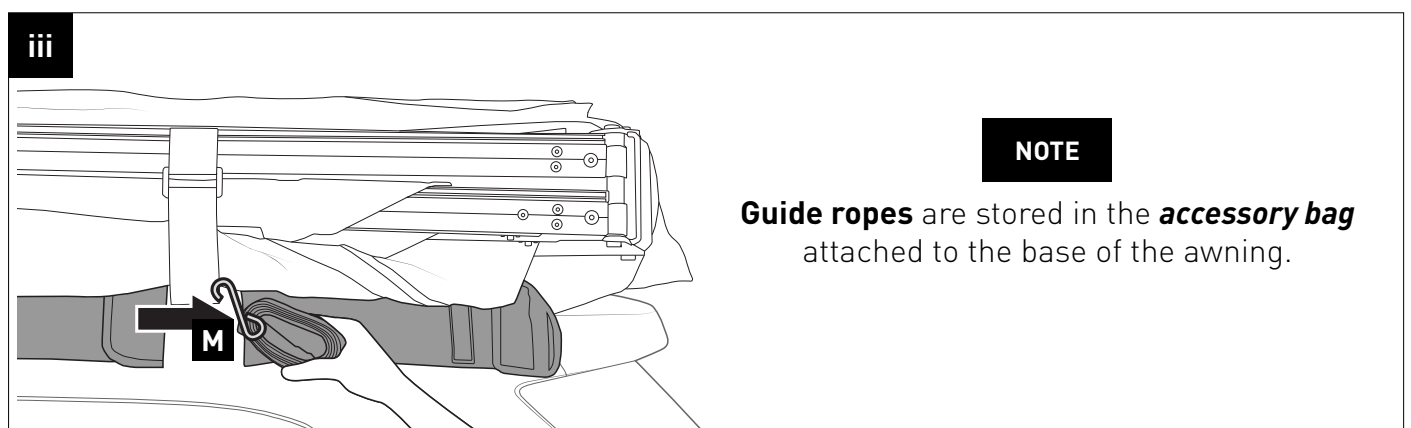
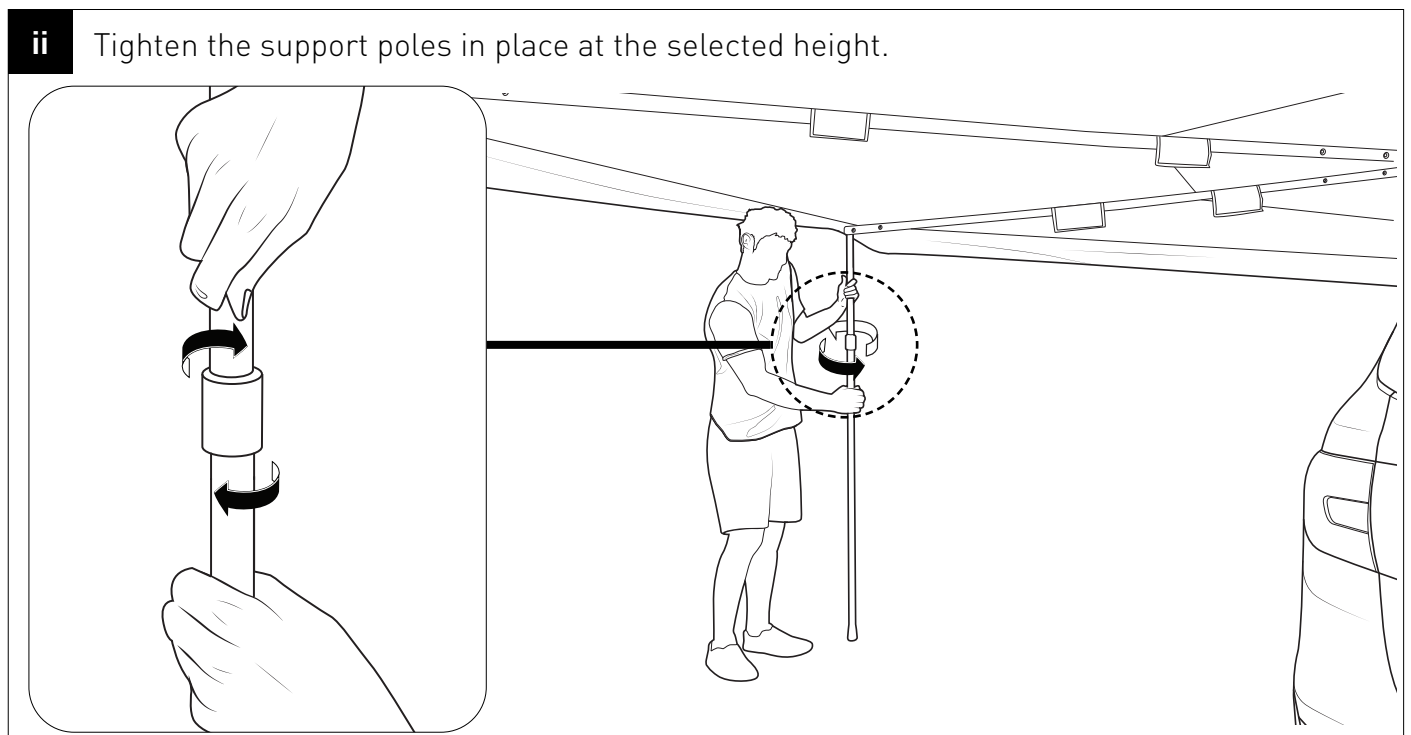
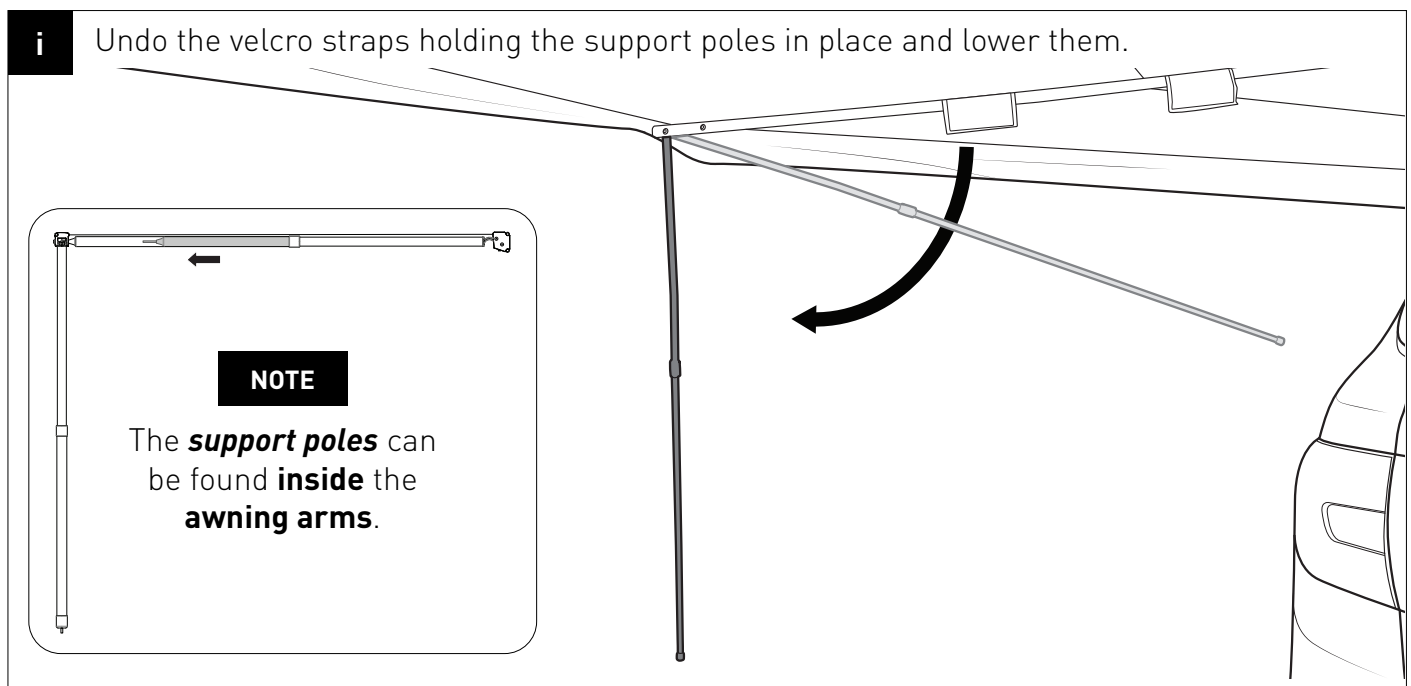

iv Hook the guy ropes to the awning, fixing it in place as shown.

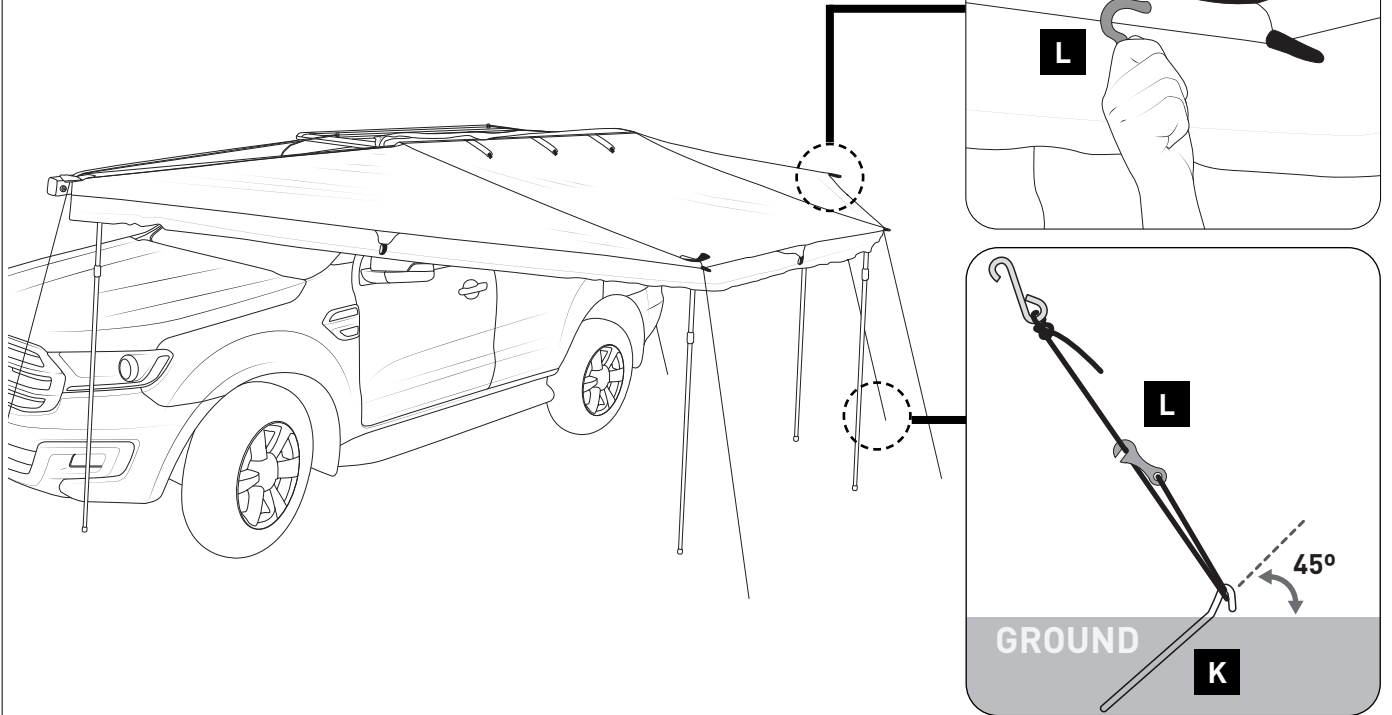

v

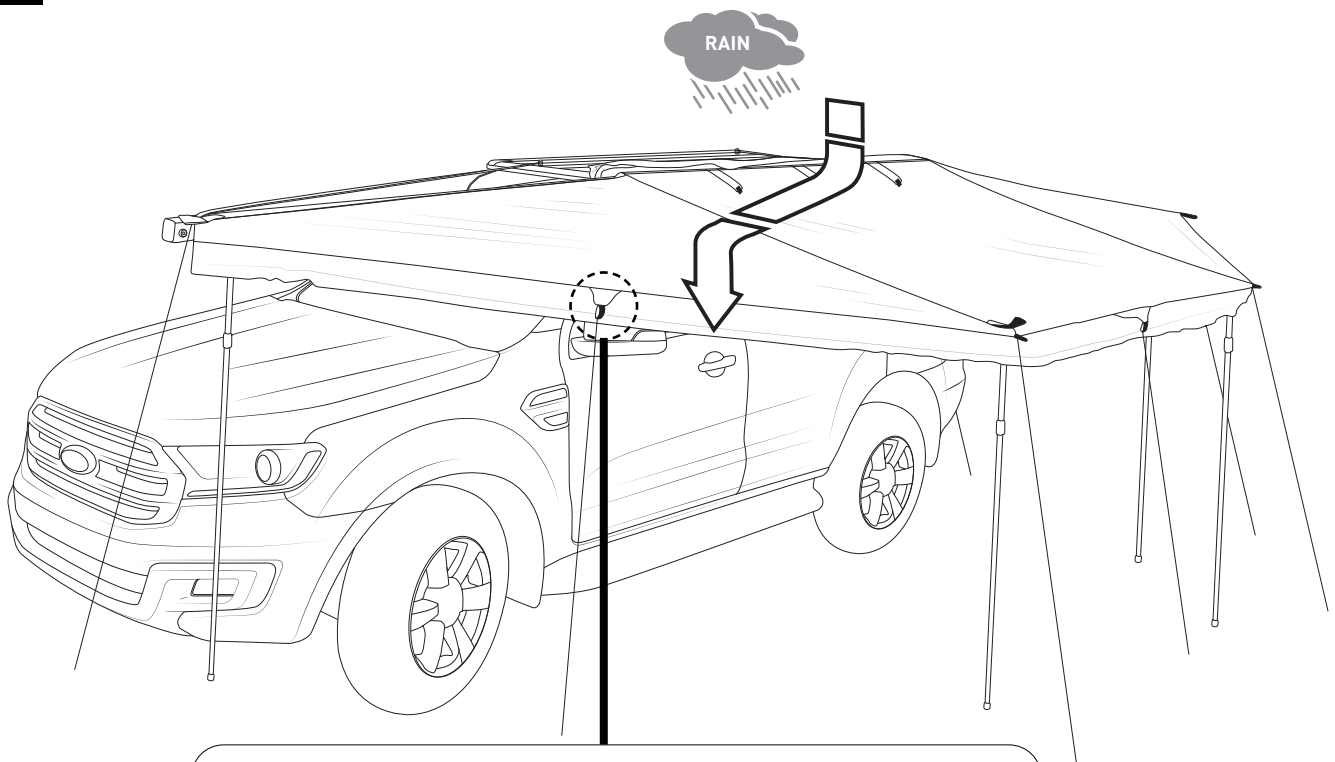

NOTE: When raining, lower poles and tension guy ropes to help rain flow off awning freely. Attach guy ropes to the holes on the middle of the wing to help rain flow.

STOWAGE INSTRUCTIONS

(Completion of Steps **17** - **26** in REVERSE order. Use below steps for reference)

- 27** Release the front strap and proceed to close the **left** awning arms.

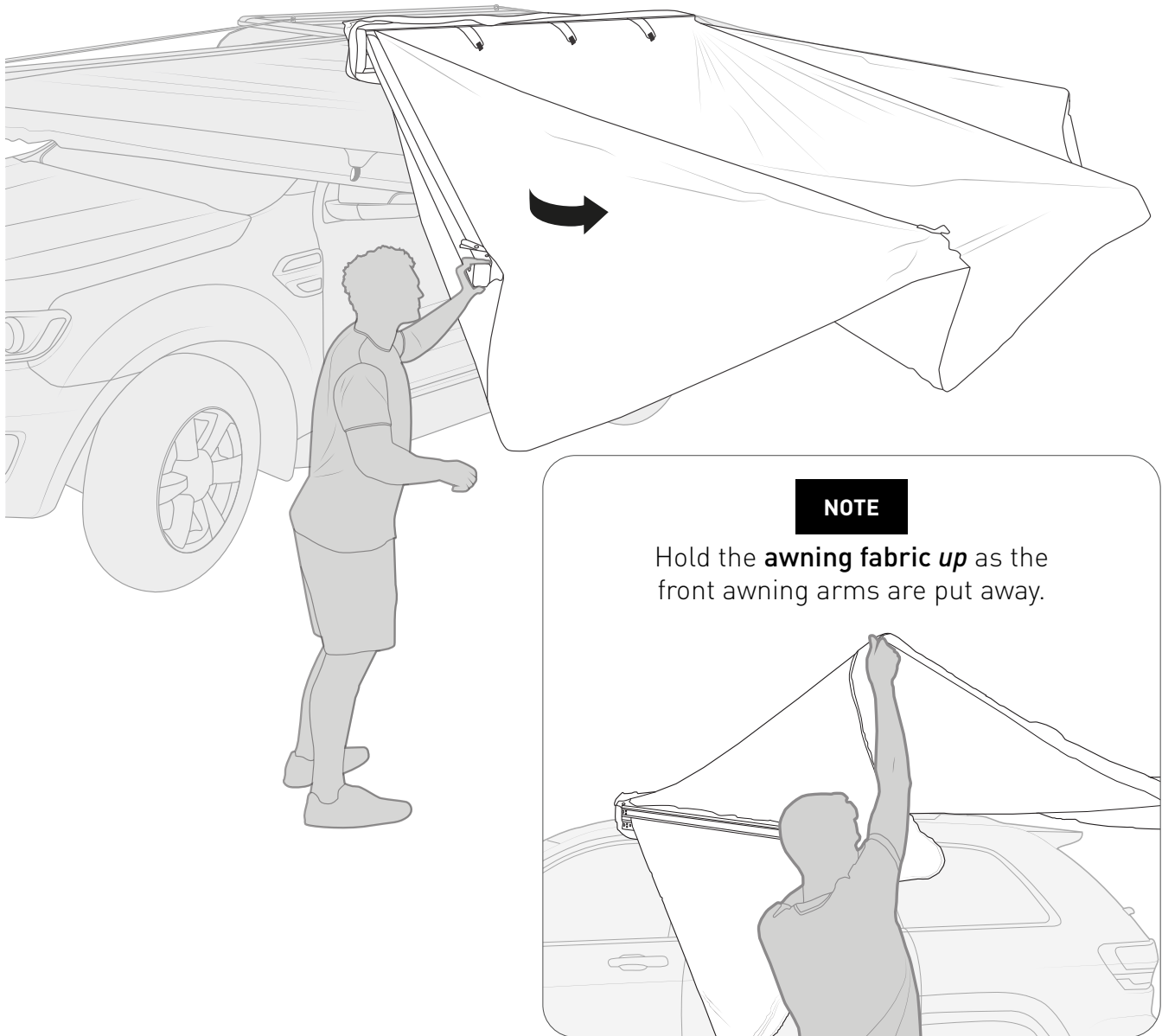

- 28** Release the rear strap and proceed to close the **right** awning arms.

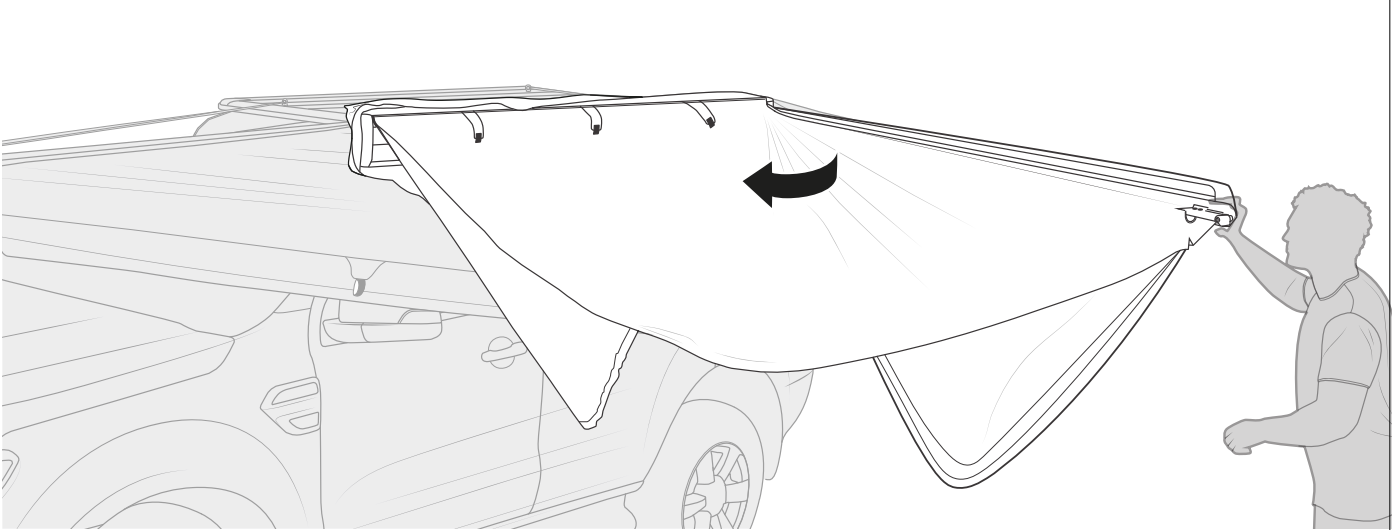

29 Fold the awning material and tighten the straps.

29a Fold the awning material in half.

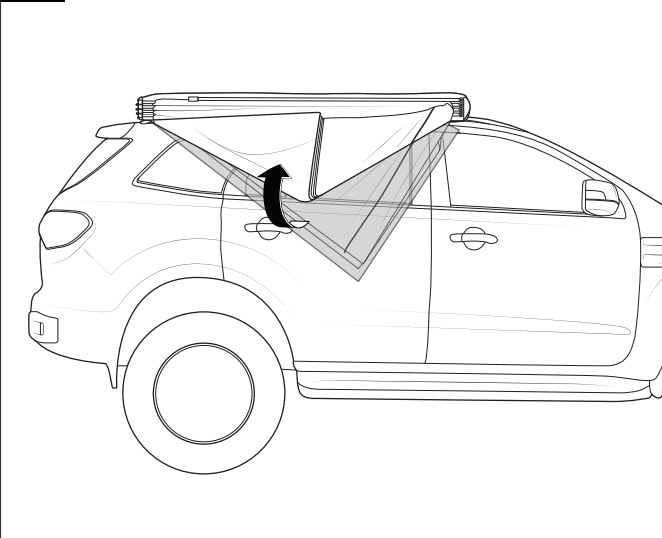

29b Roll the material from the front edge back up into its original setting.

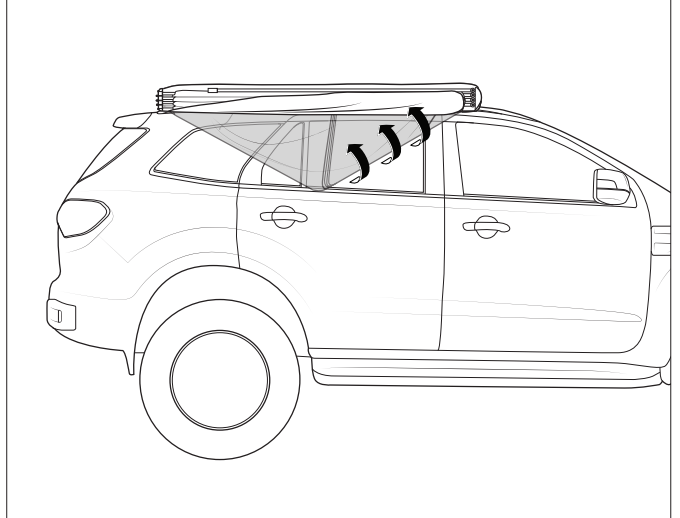

29c

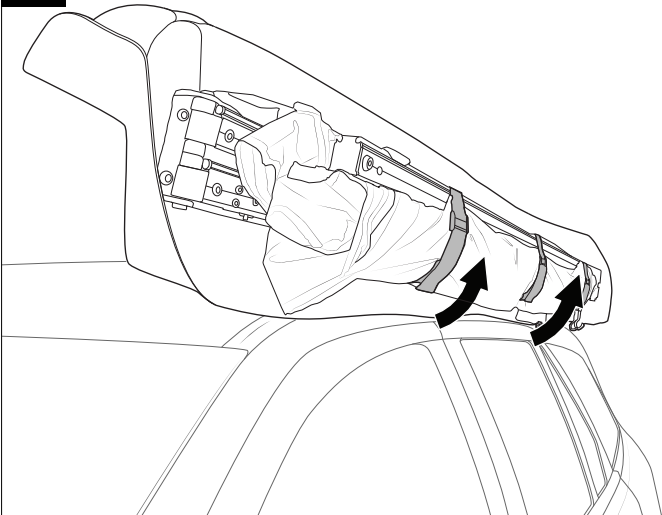

29d

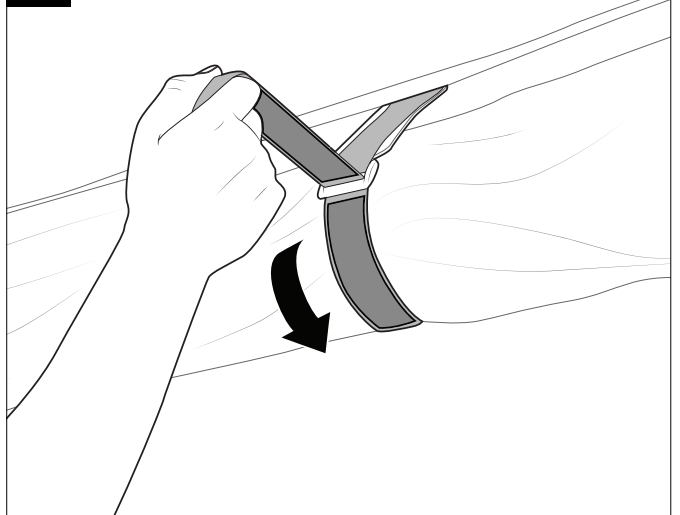

30 Replace the metal pegs and awning straps to the accessory bag. Zip the outer bag closed.

REAR

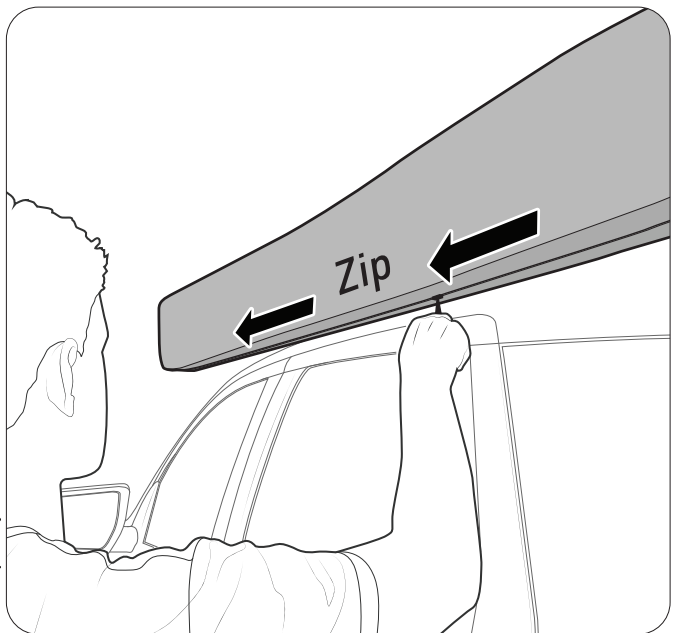
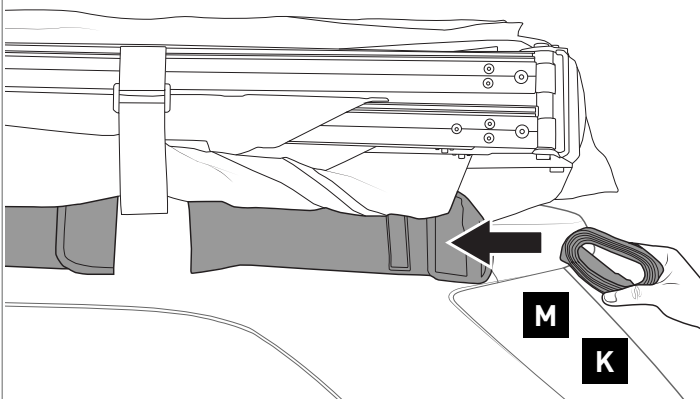

ACCESSORIES

- 31** Accessory channel located at the bottom of the base extrusion.

ZWIFLOC™

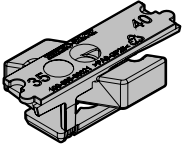

COMPATIBLE

SIDE VIEW

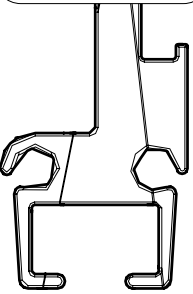

Additional eye bolt/Zwifloc not included.

- 32** Light mounting holes are located on the base extrusion.

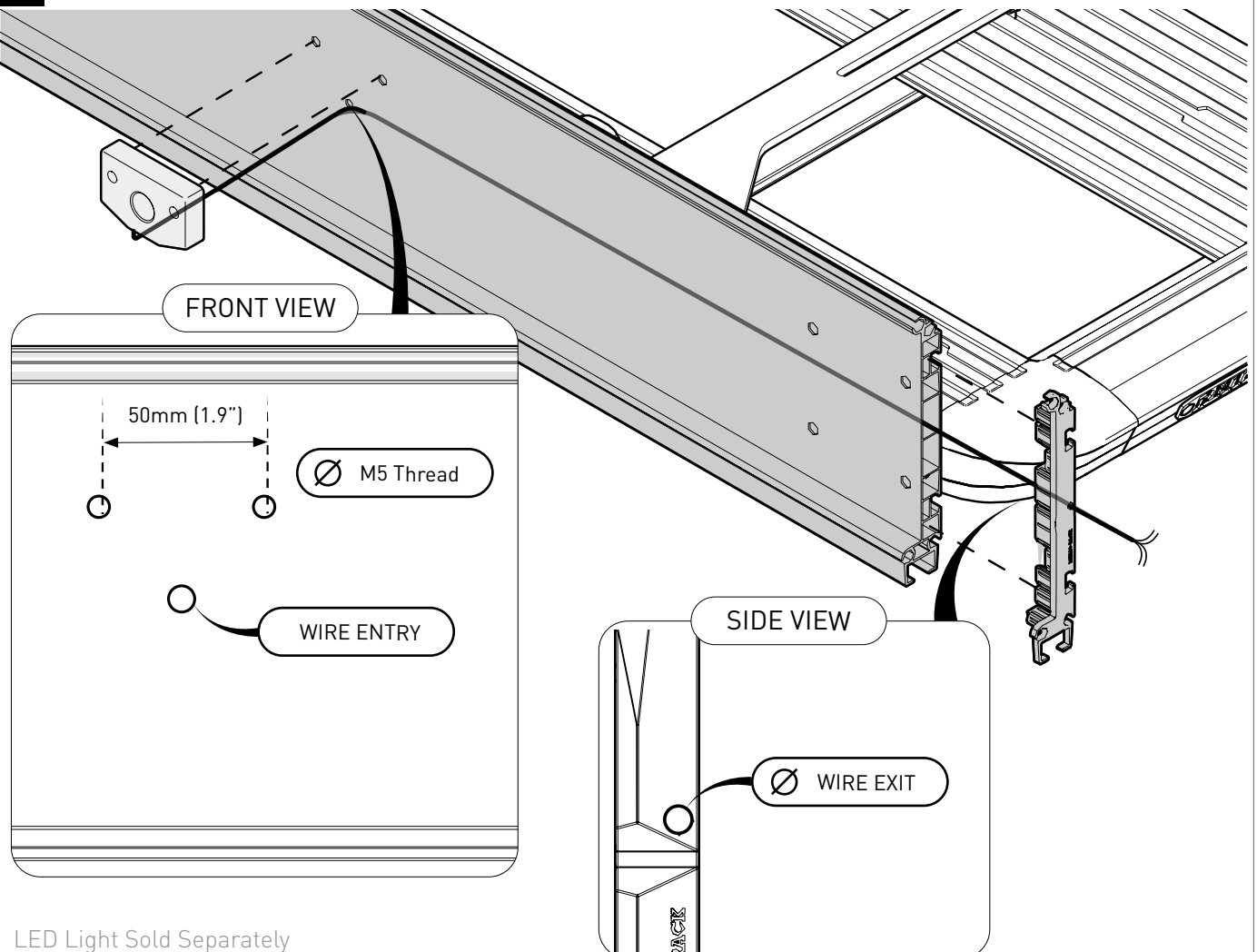



RHINO-RACK®

MAKE SPACE FOR ADVENTURE

RHINORACK.COM

Rhino-Rack AUSTRALIA

22A Hanson Pl,
Eastern Creek, NSW, 2766

Rhino-Rack USA

19822 E 22nd Ave,
Aurora, CO, 80011