



RHINO-RACK

CONTROLLED

Leg Fitting Supplement ISUZU D-MAX Gen 3, 4dr Crew Cab MAZDA BT-50 Gen 3, 4dr Dual Cab

VEHICLE LOAD LIMIT (VLL) KG/LBS	SYSTEM WEIGHT (SW) KG/LBS (Complete-incl. cross bars)	ON-ROAD CARGO ALLOW. (OR)	OFF-ROAD CARGO ALLOW. (OFR)
Up to 100/220*	5/11	OR=VLL - SW	OFR = OR/1.5

*CHECK YOUR VEHICLE OWNERS HAND BOOK FOR VEHICLE MAXIMUM CARRYING CAPACITY. PLEASE ENSURE YOU USE THE VEHICLE MANUFACTURERS MAXIMUM ROOF ALLOWANCE IF IT IS LOWER THAN THE FIGURE LISTED IN THIS INSTRUCTION.

PARTS/TOOLS REQUIRED:

T1 - 10mm Spanner/Socket Wrench

T2 - Marker

T3 - Saw (flush bar only - if converting overhang bars)

REFER RCP71-BK INSTRUCTION FOR BASE KIT LEG ATTACHMENT HARDWARE

O P Q

1a

OVERHANG CROSS BARS (SEE 1B FOR FLUSH CROSSBARS)

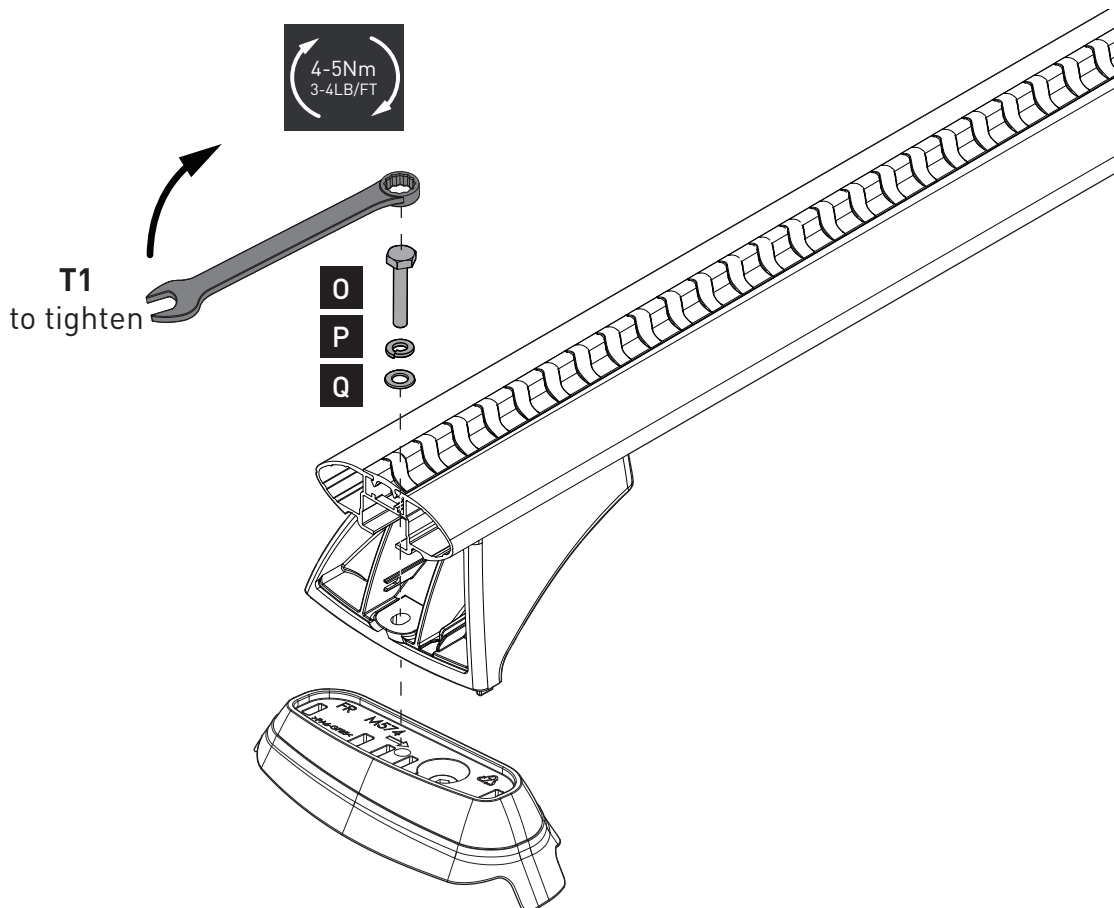

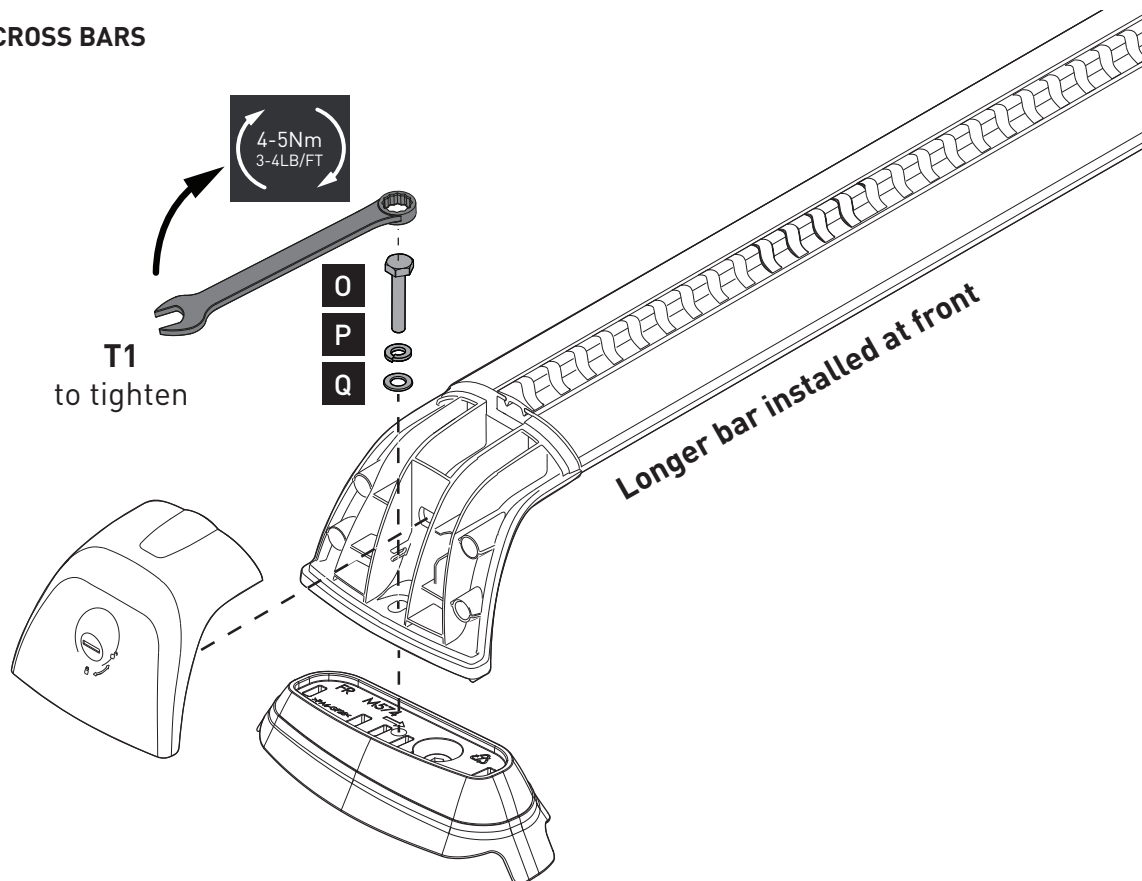

Note: Overhang crossbars can be cut to length to make flush bars fit this vehicle.

1. Mark the centre of the Front and Rear Overhang Vortex Bar
2. Measure from the centre of the front & rear bar out to the below desired lengths and mark on both ends
3. Carefully cut the bar at these markings using a Saw with an Alloy Cutting Blade.

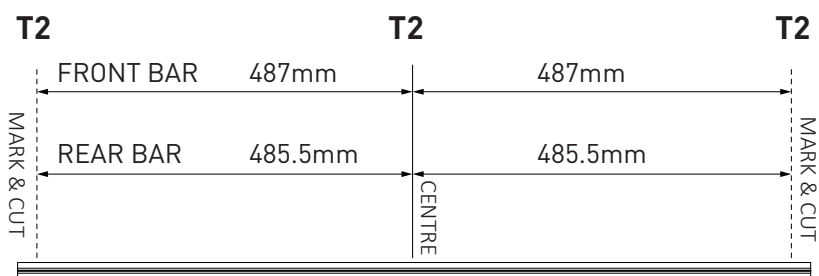

Note for dealers when altering RSP kits:
Add 38mm to sports bar measurement for RVL.
Add 40mm to sports bar measurement for RVH.

T3 to cut

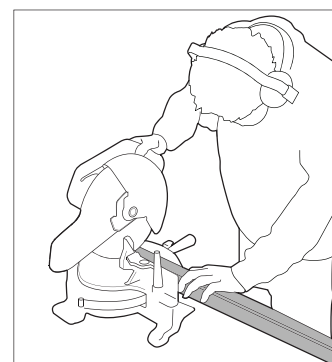

Note for Dealers and Fitters

It is your responsibility to ensure these fitting instructions are given to the end user or client. These instructions remain the property of Rhino-Rack Australia Pty. Ltd. and may not be used or changed for any other purpose than intended.

Rhino-Rack,
22A Hanson Pl, Eastern Creek
NSW 2766, Australia
(02) 8846 1900
rhinorack.com.au

Document No: R2637
Issue No: 01
Issue Date: 02/11/20