

FITTING CHART - JEEP Gladiator JT 4dr 4WD Hard Top Pick Up with Backbone and RLT600 Legs

PIONEER 42121BF_(Flat Pack)

(1228 x 1426mm) (4' 22/64" x 4' 8 9/64")

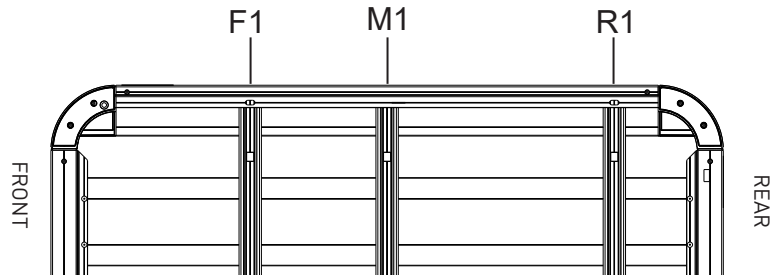

| FRONT CROSSBAR | | MIDDLE CROSSBAR | | REAR CROSSBAR | | ADDITIONAL HEIGHT ADDED TO VEHICLE WITH RACKS |
|--------------------------------|------------|-----------------|------------|---------------|------------|---|
| FRONT SLOT | SPACER KIT | MIDDLE SLOT | SPACER KIT | REAR SLOT | SPACER KIT | |
| F1 663mm FROM REAR CROSSBAR | QMPS10 | M1 | N/A | R1 | QMPS10 | ~115mm FROM HIGHEST POINT OF VEHICLE |

| COUNTRY | VEHICLE | RUNNING DATE | VEHICLE ROOF LOAD RATING (kg / lbs) | FIT KIT | IMPORTANT NOTES |
|----------------|--|--------------|---|---------------------------------------|--|
| Australia & NZ | JEEP Gladiator JT 4dr 4WD Hard Top Ute with Backbone | 2020 - on | Up To 100 kg / 220 lbs (incl. Legs and Pioneer) | 1 x RJTB1 1 x RLT600 2 x QMPS10 | Position the centreline of the Pioneer evenly between mounting points of RJTB1 |
| USA & Canada | JEEP Gladiator JT 4dr 4WD Hard Top Pick Up with Backbone | 2020 - on | | | |

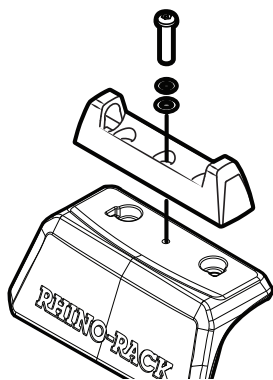
INSTALLATION NOTE

Install RLT600 Base kit to the castings utilising M6 hardware supplied in leg kit.

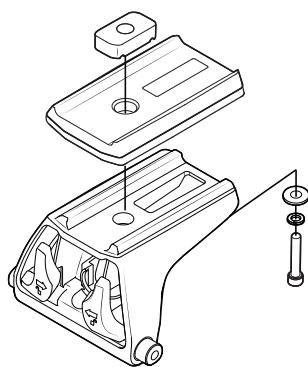

Combine RLT600 legs with corresponding spacer kits.

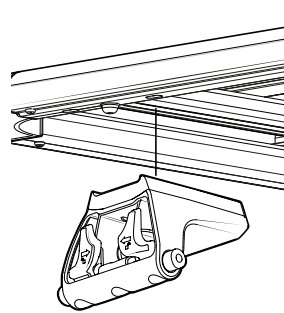

Attach leg assemblies to the Pioneer underside bars. Tighten leg hardware to a firm sliding fit.

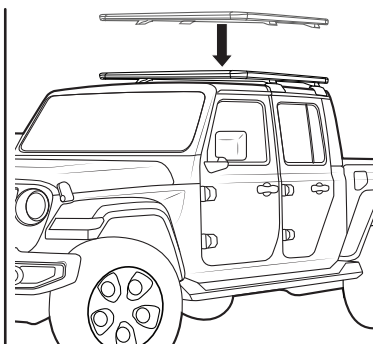

Place Pioneer assembly onto RJTB1 castings. Slide legs into position and attach to castings. Centre Pioneer between legs and tighten all hardware to final torque.

Note for Dealers and Fitters:

It is your responsibility to ensure these fitting instructions are given to the end user or client.

Rhino-Rack, 22 Hanson Pl, Eastern Creek

NSW 2766, Australia

(02) 8846 1900

rhinorack.com.au

Document No: R2507

Issue No: 01

Issue Date: 07/05/2020

These instructions remain the property of Rhino-Rack Australia Pty. Ltd. and may not be used or changed for any other purpose than intended.