

FITTING CHART - Jeep Gladiator JT 4dr 4WD Pick Up with Backbone and RCL Legs

PIONEER 42121BF (Flat Pack)

(1228 x 1426mm) (4' 22/64" x 4' 8 9/64")

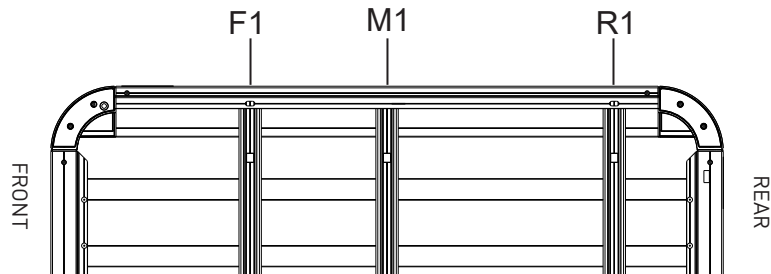

FRONT CROSSBAR		MIDDLE CROSSBAR		REAR CROSSBAR		ADDITIONAL HEIGHT ADDED TO VEHICLE WITH RACKS
FRONT SLOT	SPACER KIT	MIDDLE SLOT	SPACER KIT	REAR SLOT	SPACER KIT	
F1 663mm FROM REAR CROSSBAR	QMHD05	M1	N/A	R1	QMHD05	~115mm FROM HIGHEST POINT OF VEHICLE

COUNTRY	VEHICLE	RUNNING DATE	VEHICLE ROOF LOAD RATING (kg / lbs)	FIT KIT	IMPORTANT NOTES
Australia & NZ	JEEP Gladiator JT 4dr 4WD Hard Top Ute with Backbone	2020 - on	Up To 100 kg / 220 lbs (incl. Legs + Pioneer)	1 x RJTB1 1 x RCL4 2 x QMHD05	Position the centreline of the Pioneer evenly between mounting points of RJTB1
USA & Canada	JEEP Gladiator JT 4dr 4WD Hard Top Pick Up with Backbone	2020 - on			

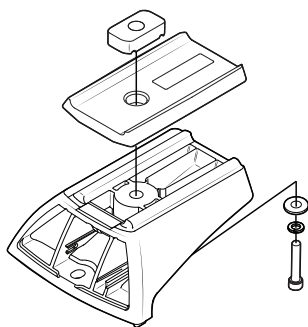
INSTALLATION NOTE

Combine RCL legs with QMHD05 spacer kits.

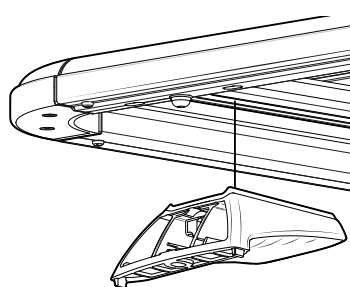

Attach leg assemblies to the Pioneer underside bars. Tighten leg hardware to a firm sliding fit.

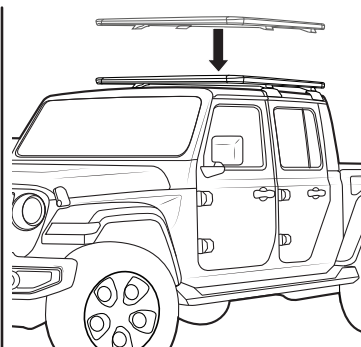

Place Pioneer assembly onto RJTB1 castings. Slide legs into position and attach to castings. Centre Pioneer between legs and tighten all hardware to final torque.

Note for Dealers and Fitters:

It is your responsibility to ensure these fitting instructions are given to the end user or client.

Rhino-Rack, 22 Hanson Pl, Eastern Creek

NSW 2766, Australia

(02) 8846 1900

rhinorack.com.au

Document No: R2506

Issue No: 01

Issue Date: 07/05/2020

These instructions remain the property of Rhino-Rack Australia Pty. Ltd. and may not be used or changed for any other purpose than intended.